



ASSEMBLY INSTRUCTIONS

LIFT STEP

VSD8000 BOAT LIFT

P/N 511-95076-00

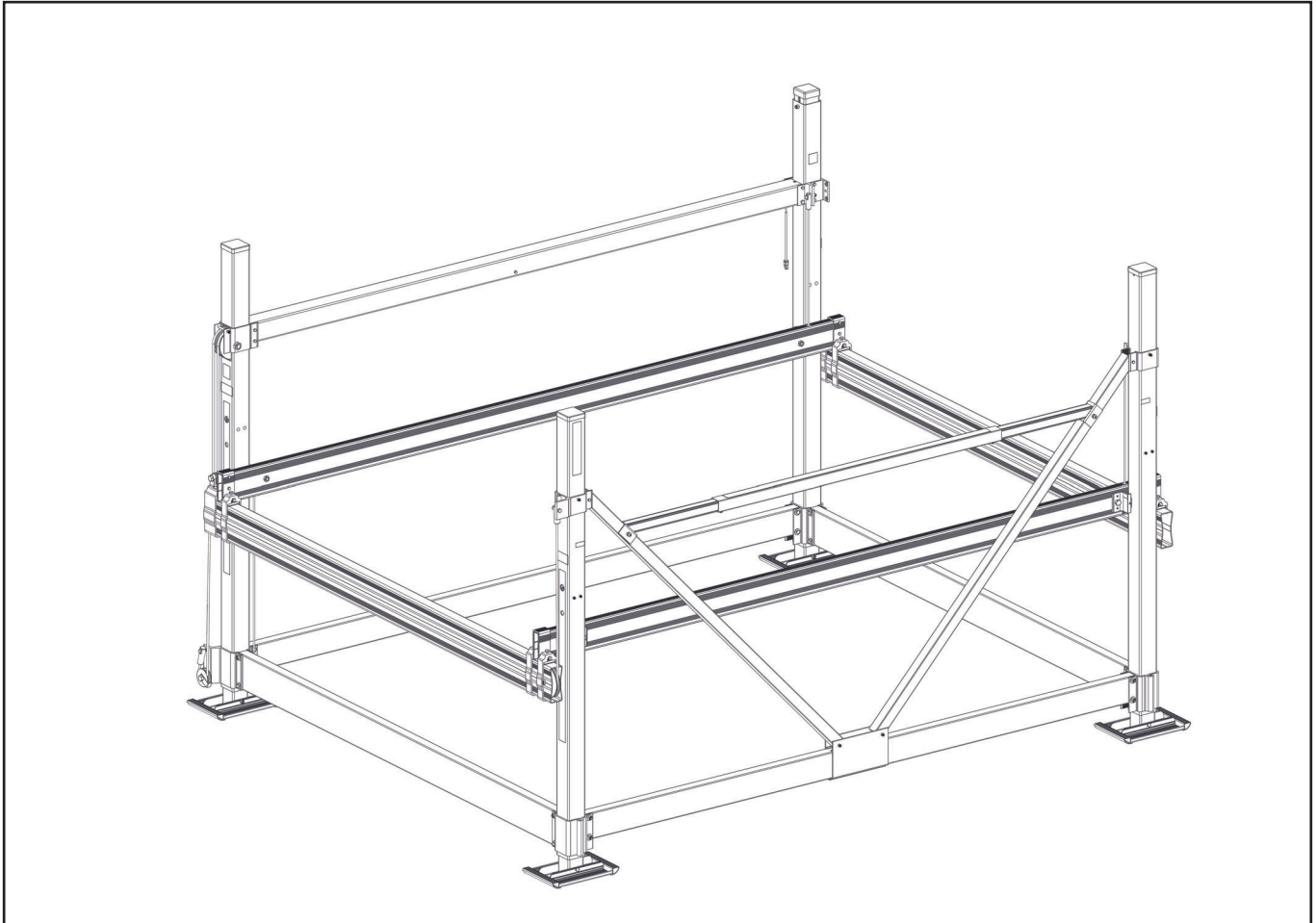

For more information, go to the owner support tab on the FLOE website

*LIFT NOT INCLUDED

TOOLS REQUIRED

- 3/4" SOCKET/WRENCH
- 5/16" HEX KEY/SOCKET
- TORQUE WRENCH
- TAPE MEASURE
- RUBBER Mallet

BILL OF MATERIALS/EXPLODED VIEW

P/N 511-95076-00	STEP, VSD8000 PONTOON BOAT LIFT		
NUMBER	PART NUMBER	QTY.	DESCRIPTION
1	001-70205-00	2	HHCS, 1/2-13 X 1" SS 18-8
2	001-71021-00	2	FLAT WASHER, 1/2" 18-8 SS
3	001-73834-00	2	BHCS, 1/2-13 X 1" 18-8 SS
4	001-76072-00	2	NUT, NYLOCK 1/2-13 ALUM.
5	111-95088-00	1	ASS'Y, OUTER TUBE LIFT STEP 74"
6	111-95106-00	1	WELD'T, LIFT STEP SUPPORT "A"
7	111-95107-00	1	WELD'T, LIFT STEP SUPPORT "B"

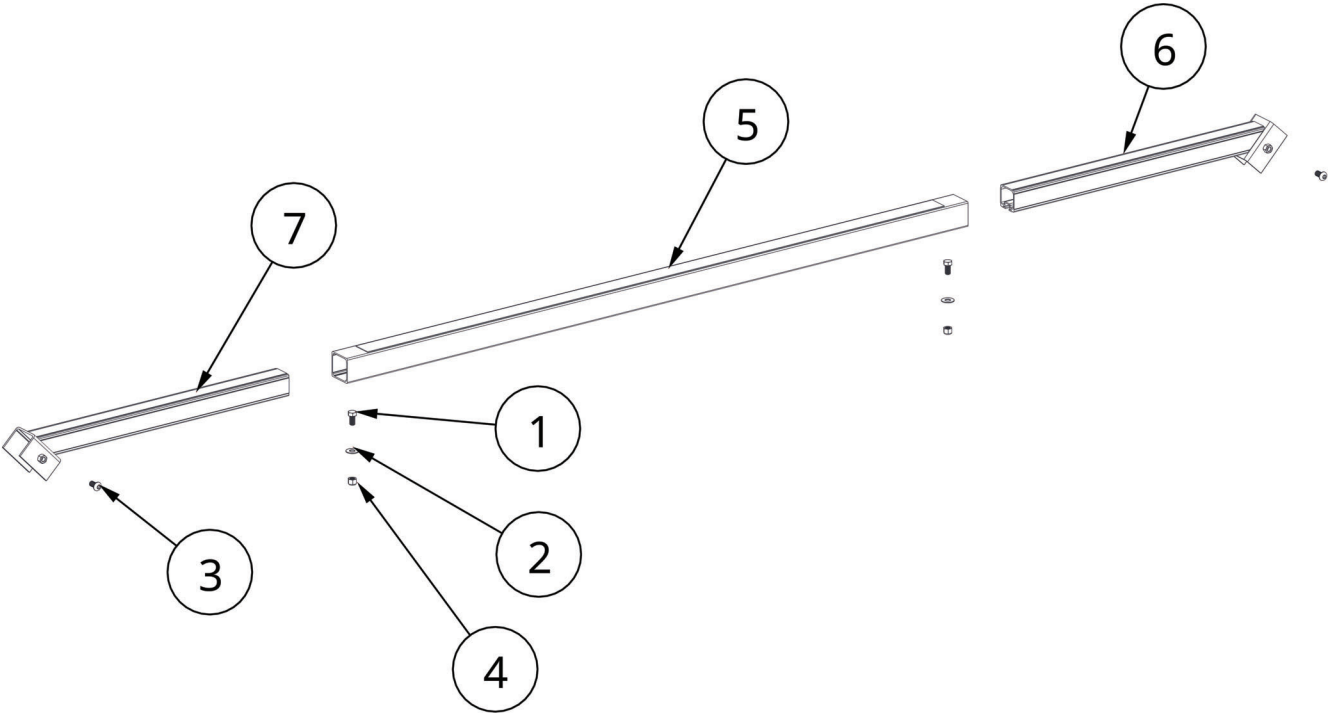

ASSEMBLY

LOOSEN BUT DO NOT REMOVE THE INSTALLED HARDWARE (FIGURE 1.1). LOOSEN THE TWO 1/2-13 NYLOCK NUTS UNTIL INNER SUPPORTS CAN BE ADJUSTED IN THE LIFT STEP TUBE. LOOSEN THE TWO 1/2-13 X 1" BUTTON HEAD BOLTS UNTIL THE ENDS NO LONGER PROTRUDE INTO THE CLAMPS (FIGURE 1.2).

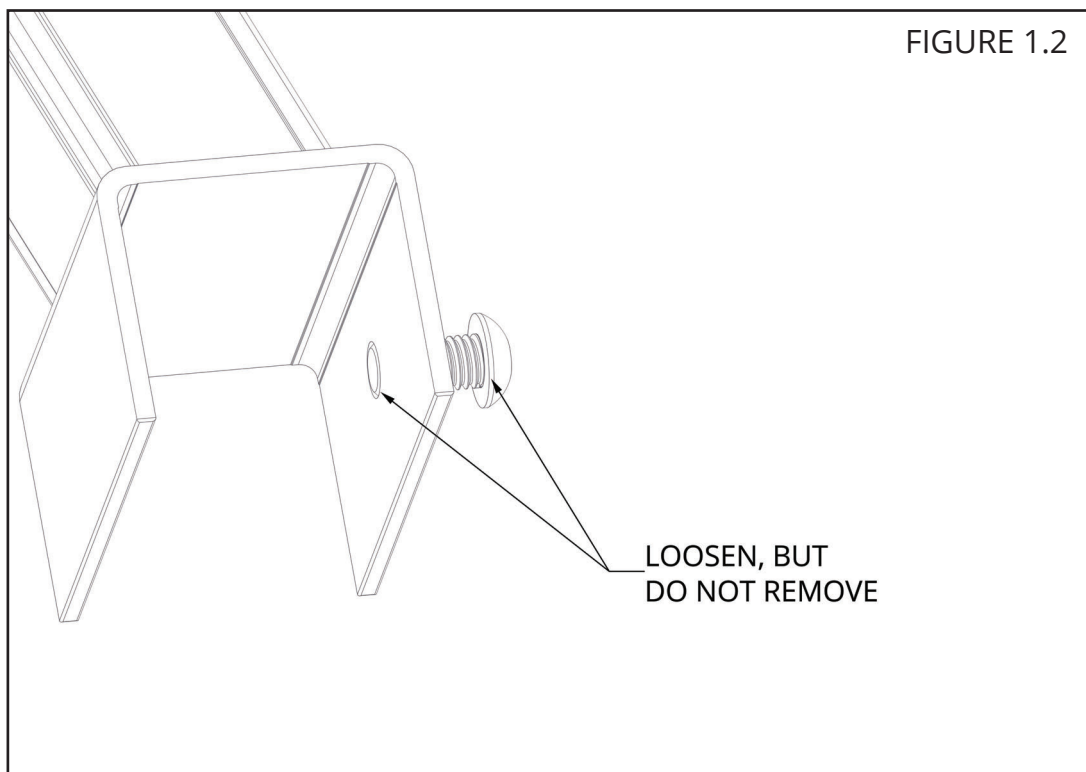
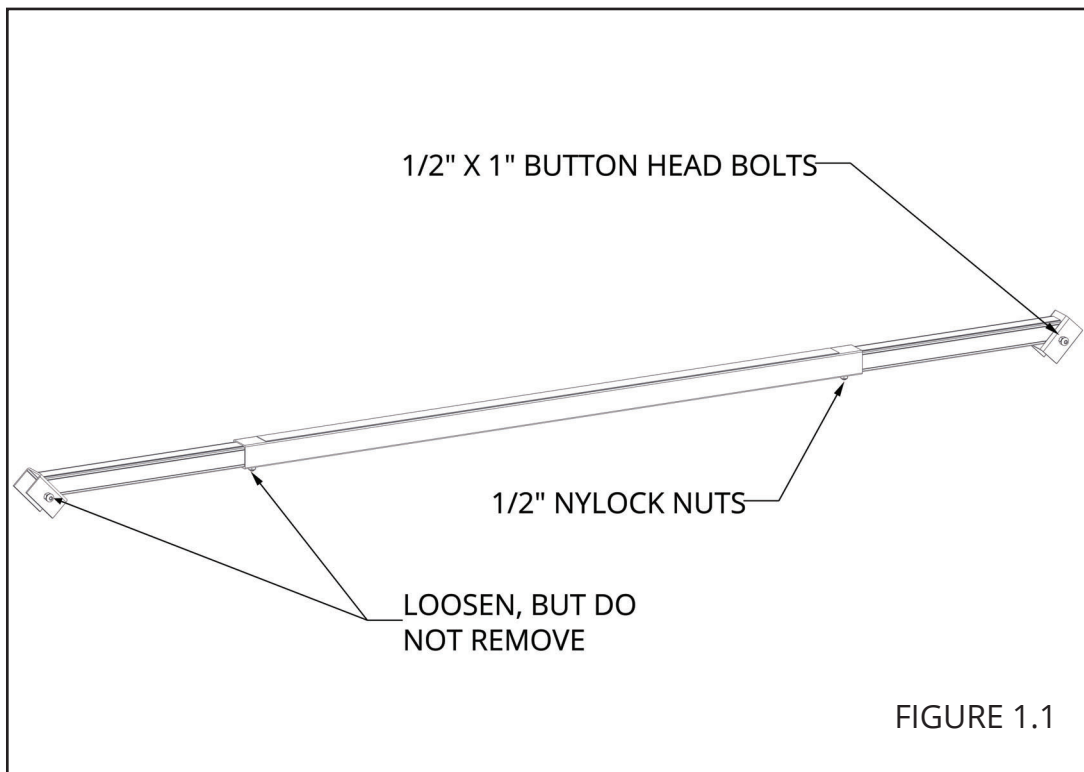

ALIGN STEP ON LIFT V-BRACE AND ADJUST INNER SUPPORTS FOR DESIRED HEIGHT LOCATION ACCOUNTING FOR A MAXIMUM OF 24 INCHES EXTENSION PAST THE TOP OF THE OUTER LIFT STEP TUBE. PLACE END CLAMPS ONTO V-BRACE AT DESIRED LOCATION, TAP WITH RUBBER Mallet TO ENSURE CLAMPS ARE FULLY SEATED. TORQUE 1/2-13 NYLOCK NUTS TO 40 FT-LBS (FIGURE 1.3). TORQUE BUTTON HEAD BOLTS TO 5 FT-LBS (FIGURE 1.4).

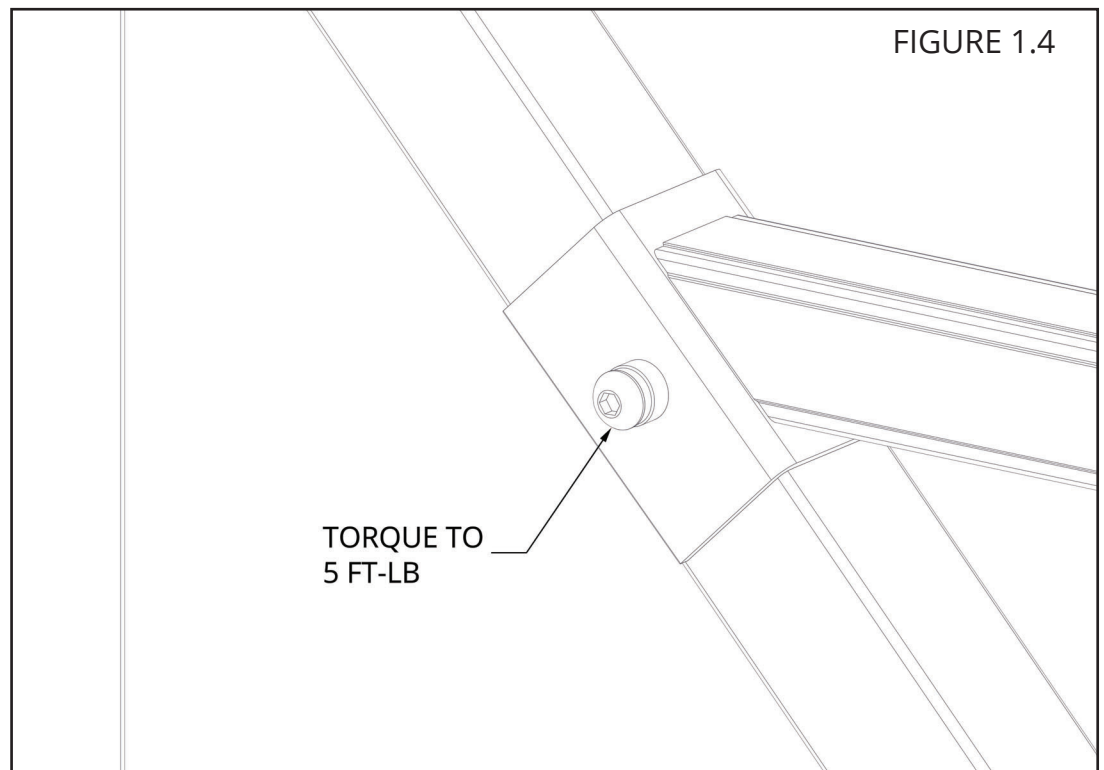
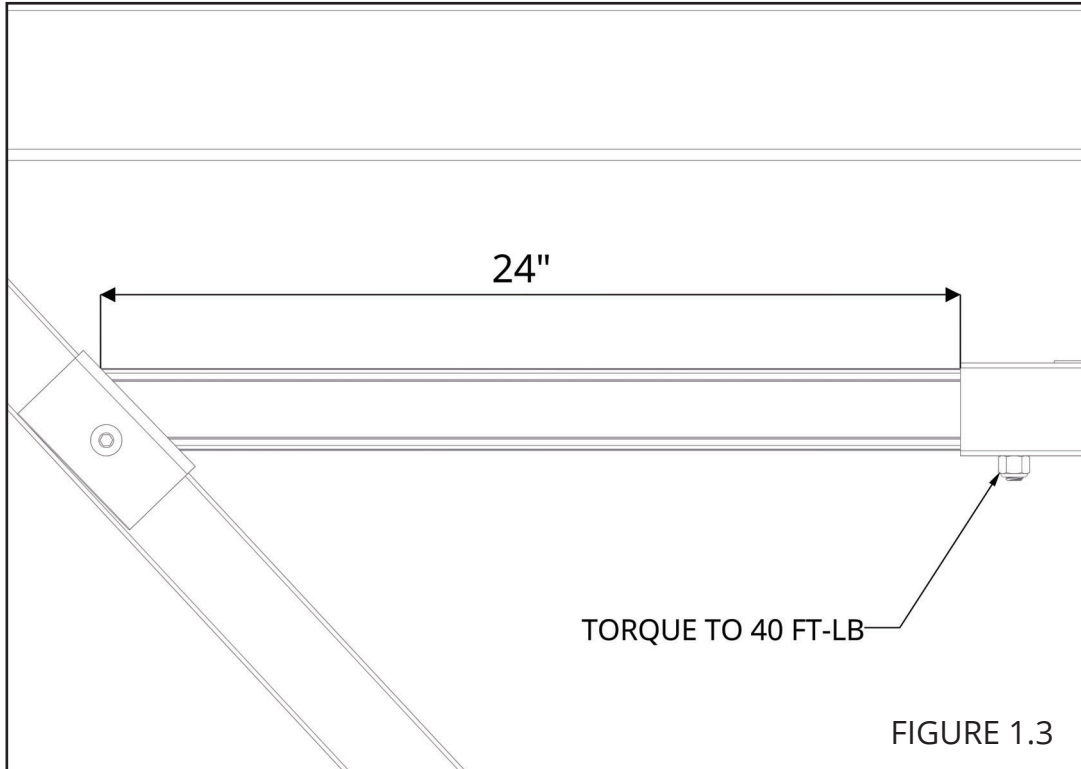

NOTES

NOTES

NOTES



FLOE INTERNATIONAL, INC.
48473 STATE HIGHWAY 65 • MCGREGOR, MN 55760
www.floeintl.com

*All material copyright © 2023 FLOE International, Inc.
Specifications subject to change without notice.*