

# FLOE FULL LENGTH BUNKS

## ASSEMBLY INSTRUCTIONS

KIT P/N 511-02706-00, 511-02707-00

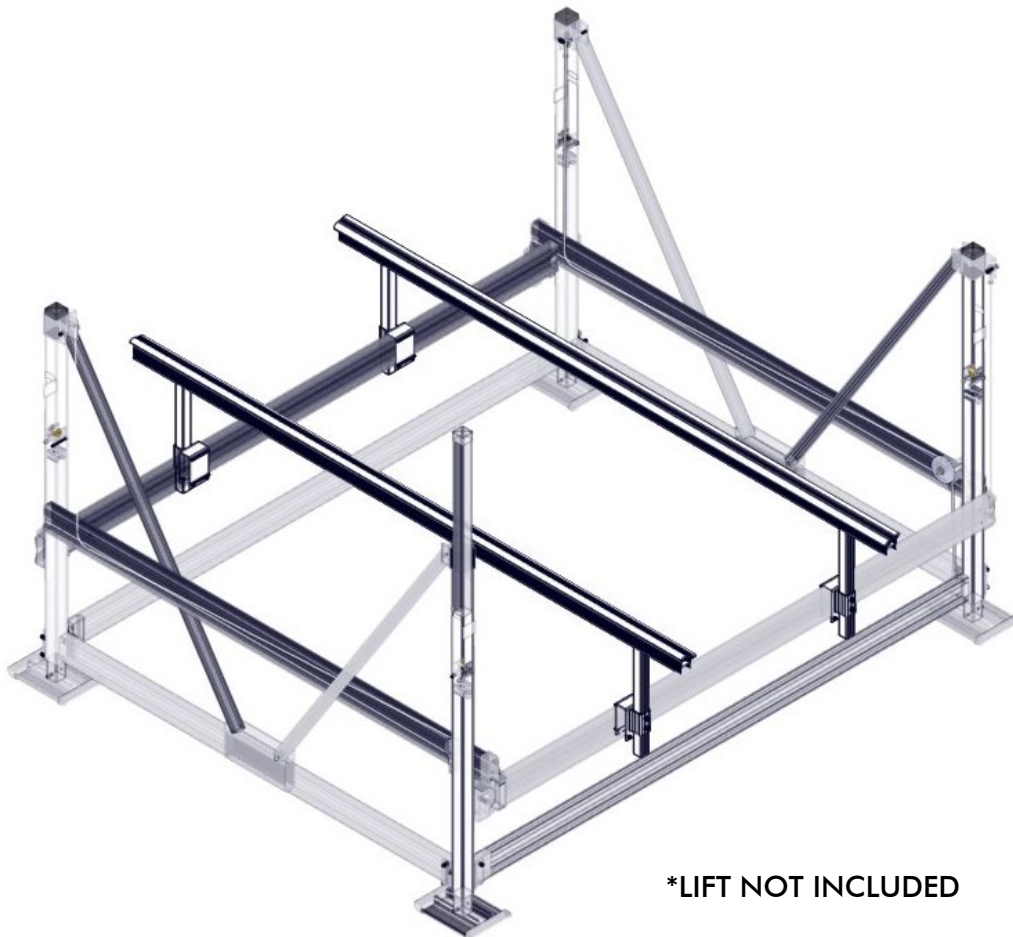

\*LIFT NOT INCLUDED

### TOOLS REQUIRED

- (2) 9/16" SOCKET
- (3/4" SOCKET
- TAPE MEASURE
- TORQUE WRENCH
- RECIPROCATING SAW OR EQUIVALENT WITH METAL BLADE (OPTIONAL, SEE SHEET 4 & 7)

### BUNK/CRADLE PAD DISCLAIMER

DUE TO THE LARGE VARIETY OF BOAT HULL DESIGNS, WE STRONGLY RECOMMEND THAT YOU CONSULT WITH YOUR BOAT'S MANUFACTURER TO ENSURE THAT YOU ARE SUPPORTING YOUR BOAT PROPERLY TO AVOID ANY POTENTIAL DAMAGE.

# BILL OF MATERIALS/EXPLODED VIEW

P/N 511-02706-00	BUNK SYS, FULL LENGTH V3600-VSD5000		
P/N 511-02707-00	BUNK SYS, FULL LENGTH V-2000		
NUMBER	PART NUMBER	QTY.	DESCRIPTION
1	001-70114-00	4	HHCS, 3/8-16 x 2 3/4" 18-8 ss
2	001-70115-00	8	HHCS, 3/8-16 x 3" 18-8 ss
3	001-70205-00	8	HHCS, 1/2-13 x 1" SS 18-8
4	001-71027-00	8	FLAT WASHER, 1/2" USS ss 18-8
5	001-76349-00	12	NUT, 3/8-16 ALUM
6	001-76350-00	8	NUT, 1/2-13 ALUM
7	002-04088-00	4	TUBE, FULL BUNK SUPPORT
8	111-00486-00	4	WELD'T, TUBE POCKET 2 HOLE
9	111-00166-00 OR 111-00195-00	2	ASS'Y, FL BUNK (IN KIT 511-02706) OR ASS'Y, 2000# FL BUNK (IN KIT 511-02707-00)

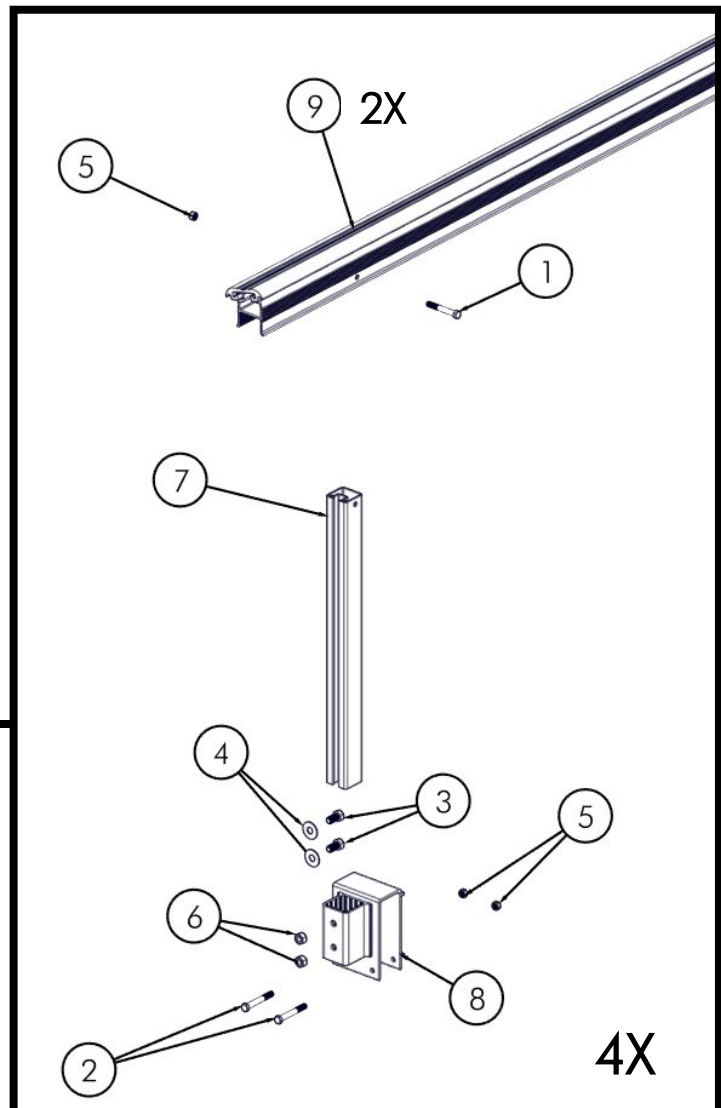
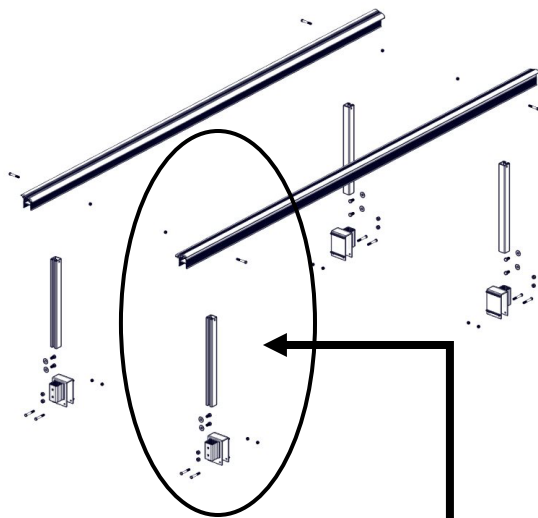

# STEP 1

511-02706-00 & 511-02707-00

SLIDE CLAMP WELDMENTS OVER CRADLE BEAM WITH POCKETS FACING OUTWARDS (FIGURE 1.1).  
PLACE (2) 1/2" X 1" BOLTS AND (2) 1/2" WASHERS INTO EACH CLAMP BRACKET (FIGURE 1.2)

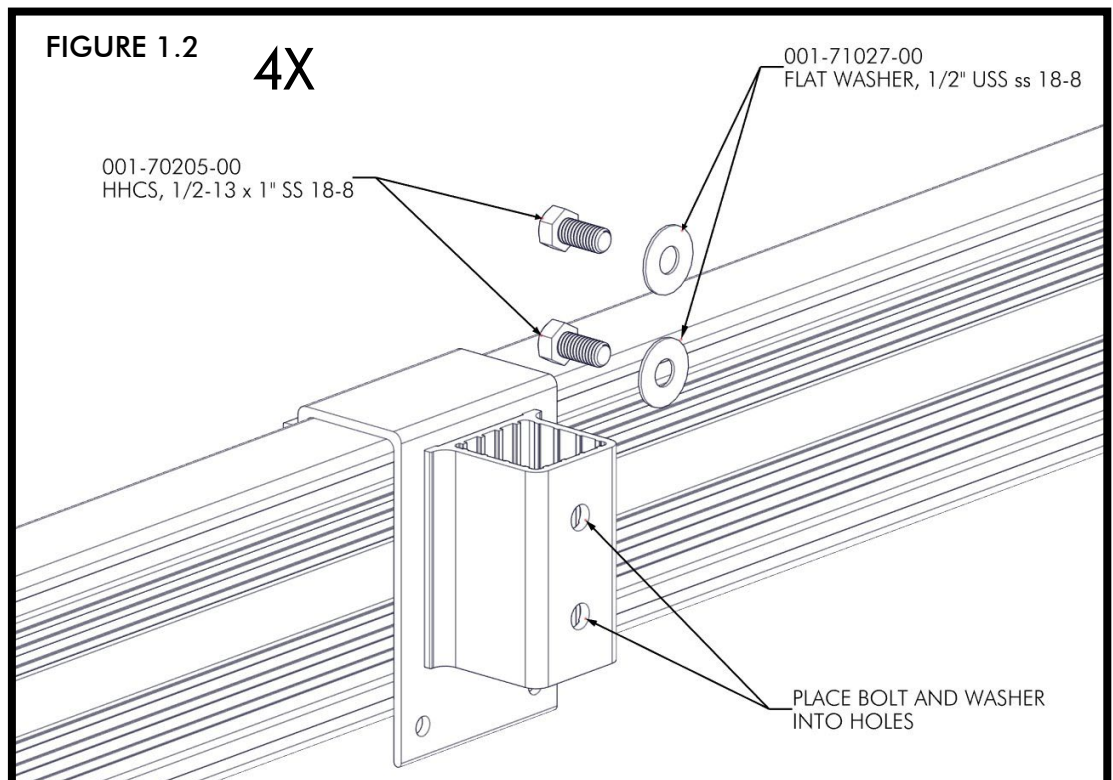
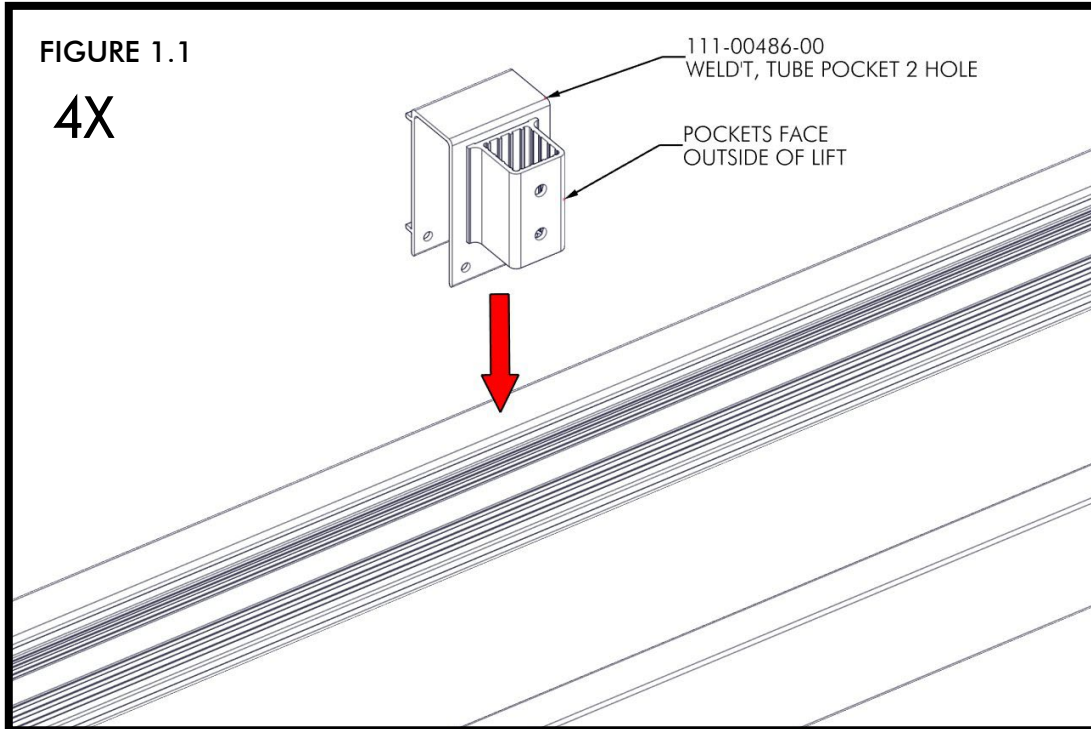

INSERT UPRIGHT TUBES INTO CLAMP WELDMENTS AND ATTACH USING (2) 1/2" NUTS, HAND TIGHT ONLY (FIGURE 1.3). ADJUST HEIGHT AND TORQUE TO 70 FT-LBS (FIGURE 1.4).

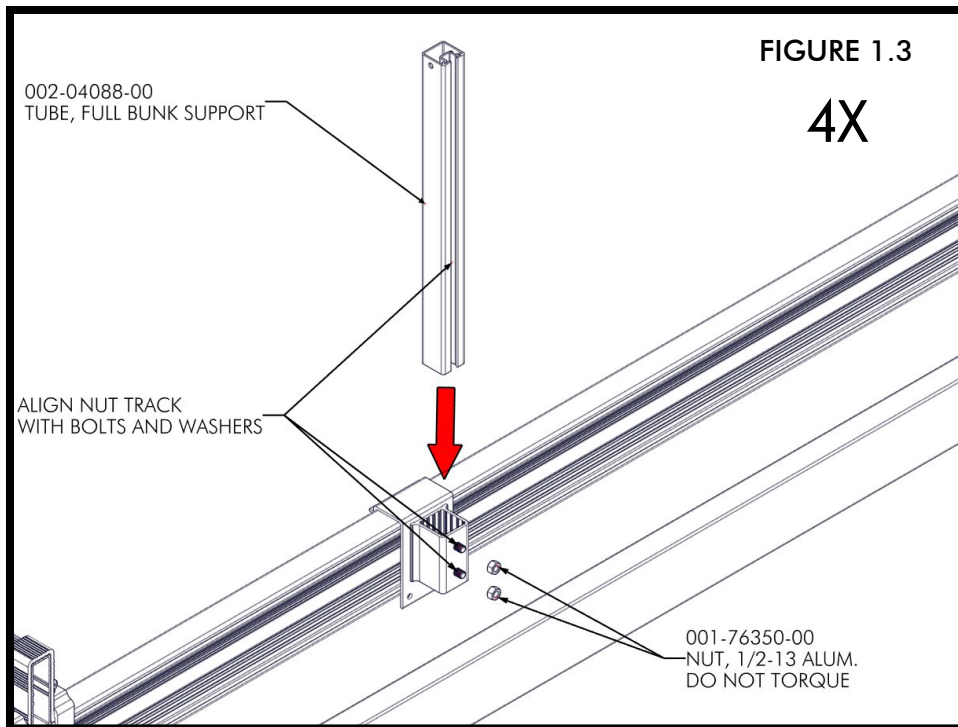

**NOTE:**

**UPRIGHTS MAY HAVE TO  
BE CUT TO ALLOW FULL  
TRAVEL OF CRADLE ONCE  
FINAL PLACEMENT IS  
ESTABLISHED.**

**BUNK/CRADLE PAD  
DISCLAIMER**

**DUE TO THE LARGE  
VARIETY OF BOAT  
HULL DESIGNS, WE  
STRONGLY  
RECOMMEND THAT  
YOU CONSULT WITH  
YOUR BOAT'S  
MANUFACTURER TO  
ENSURE THAT YOUR  
ARE SUPPORTING  
YOUR BOAT  
PROPERLY TO AVOID  
ANY POTENTIAL  
DAMAGE.**

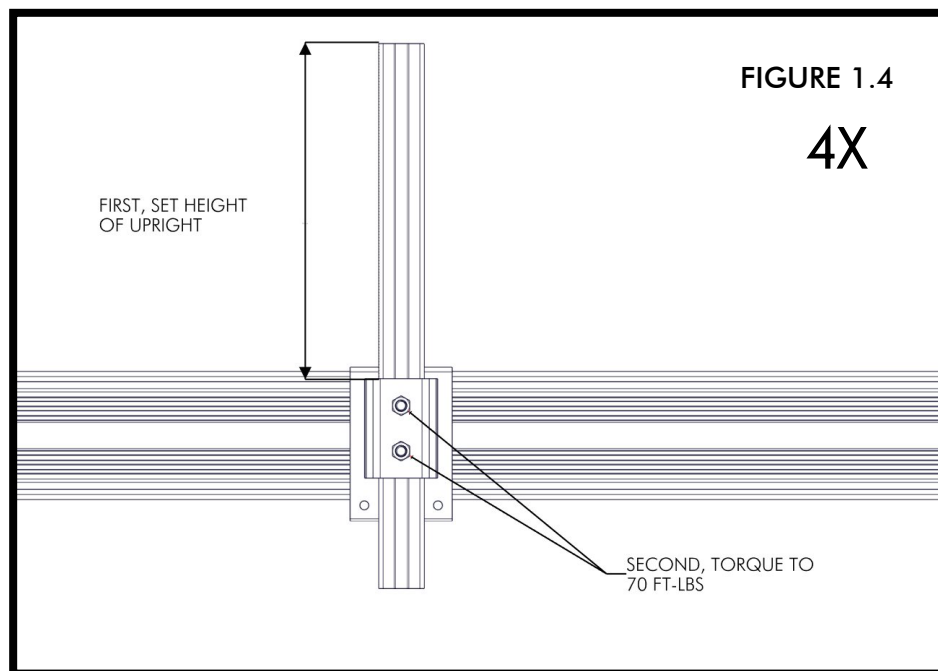



## STEP 2

PLACE BUNKS ONTO UPRIGHTS (FIGURE 2.1) AND ATTACH USING (2) 3/8" X 2 3/4" BOLTS AND (2) 3/8" NUTS PER UPRIGHT (FIGURE 2.2).

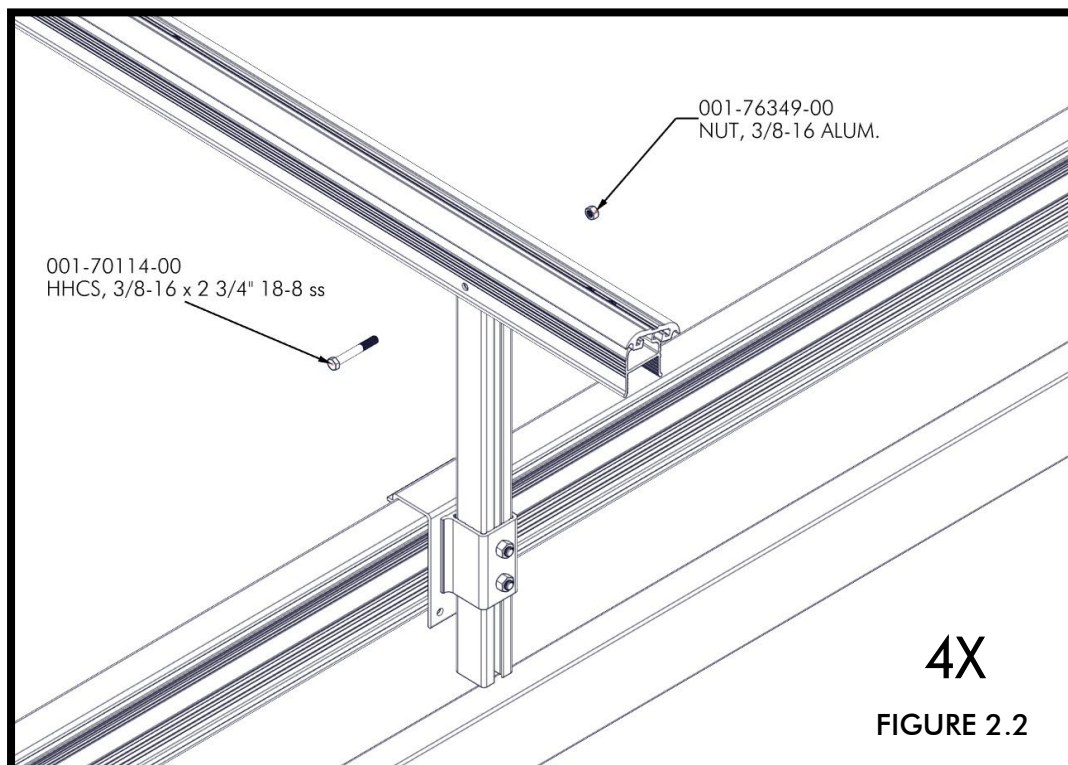
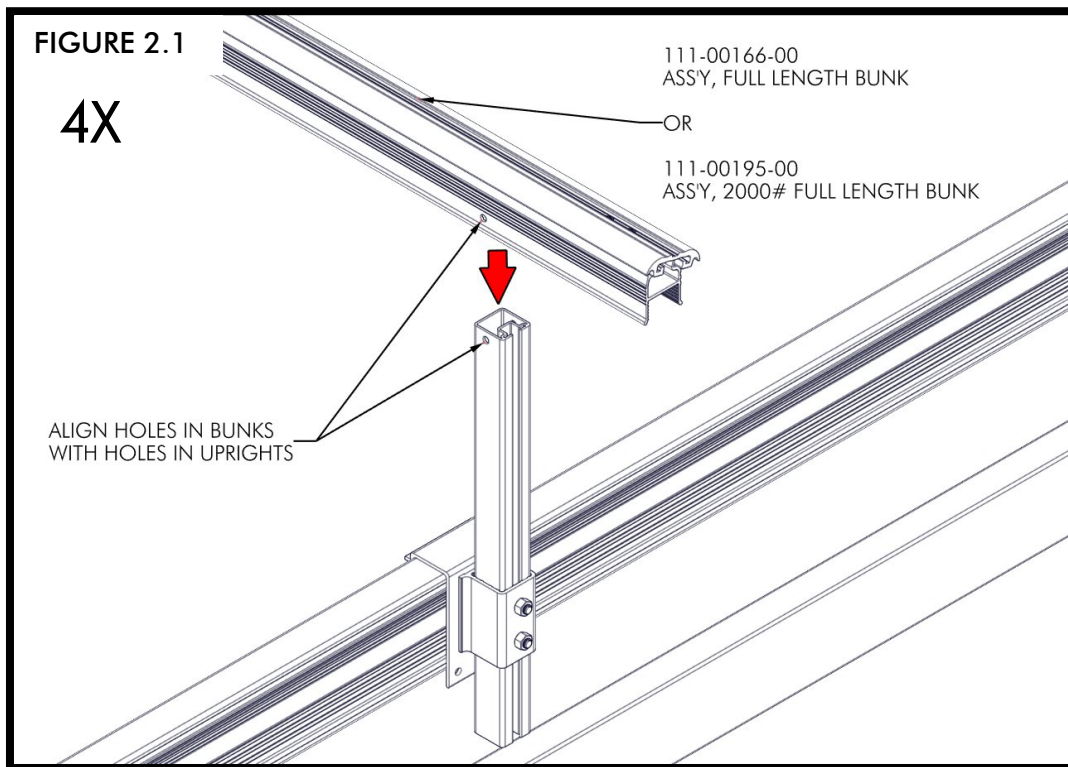

TORQUE TO 35 FT-LBS (FIGURE 2.3).

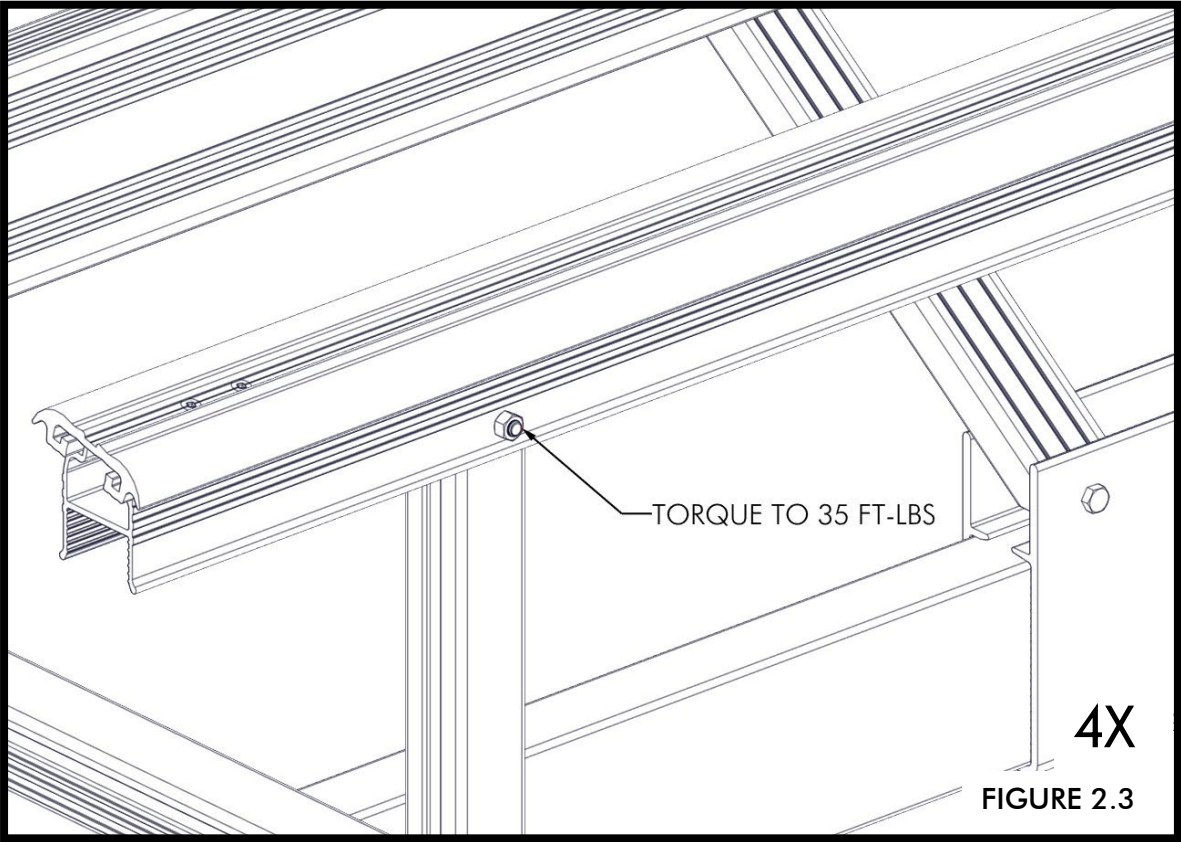

ATTACH CLAMP WELDMENT TO CRADLE BEAM USING (2) 3/8" X 3" BOLTS AND (2) 3/8" NUTS, HAND TIGHTEN ONLY (FIGURE 2.4).

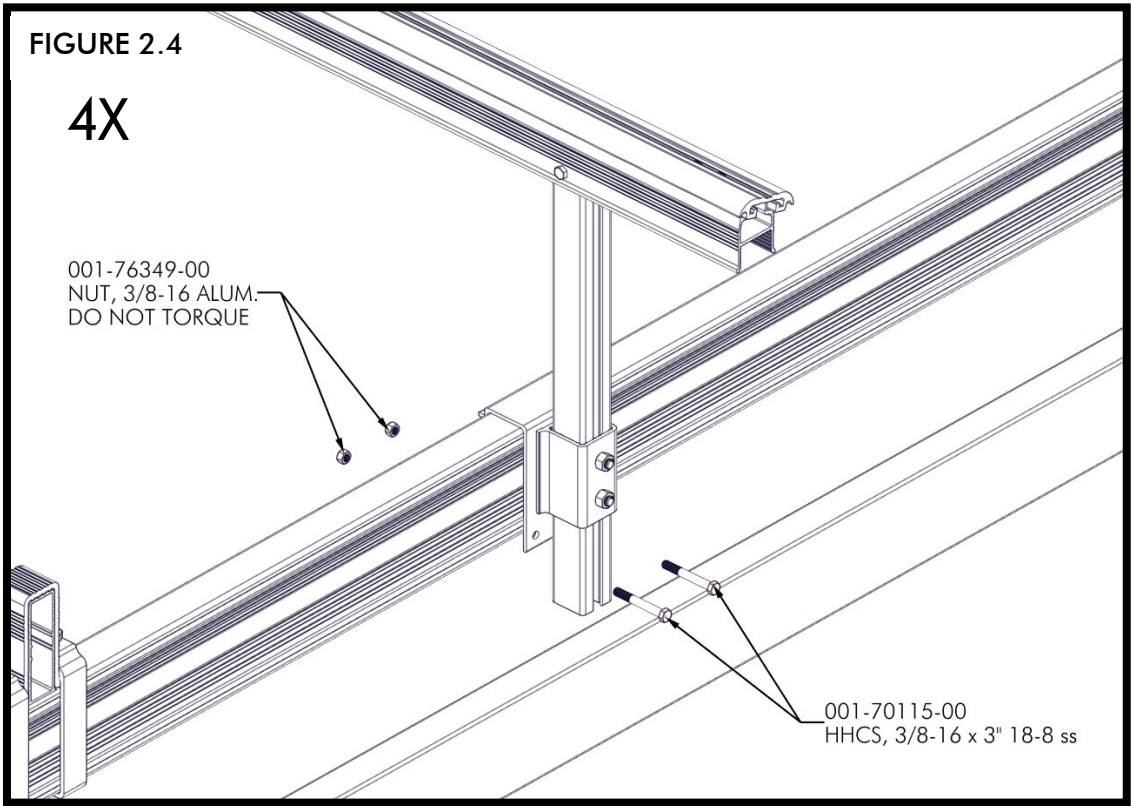

FIRST, FIND CENTER OF CRADLE BEAM, THEN SET WIDTH OF BUNKS BASED ON BOAT (FIGURE 2.5).

**NOTE:**

**UPRIGHTS  
MAY HAVE TO  
BE CUT TO  
ALLOW FULL  
TRAVEL OF  
CRADLE ONCE  
FINAL  
PLACEMENT  
IS  
ESTABLISHED.**

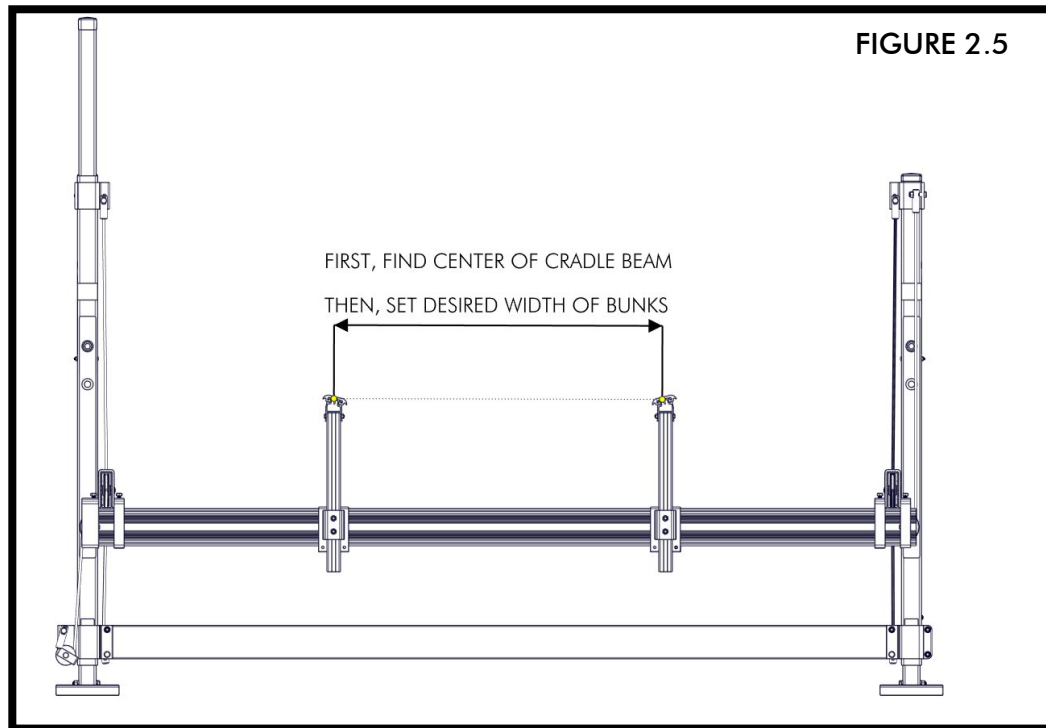

ONCE FINAL POSITION IS SET, TORQUE TO 35 FT-LBS (FIGURE 2.6).

