

FLOE PONTOON GUIDE-IN/BUNK V2600-VSD5000 PONTOON ASSEMBLY INSTRUCTIONS

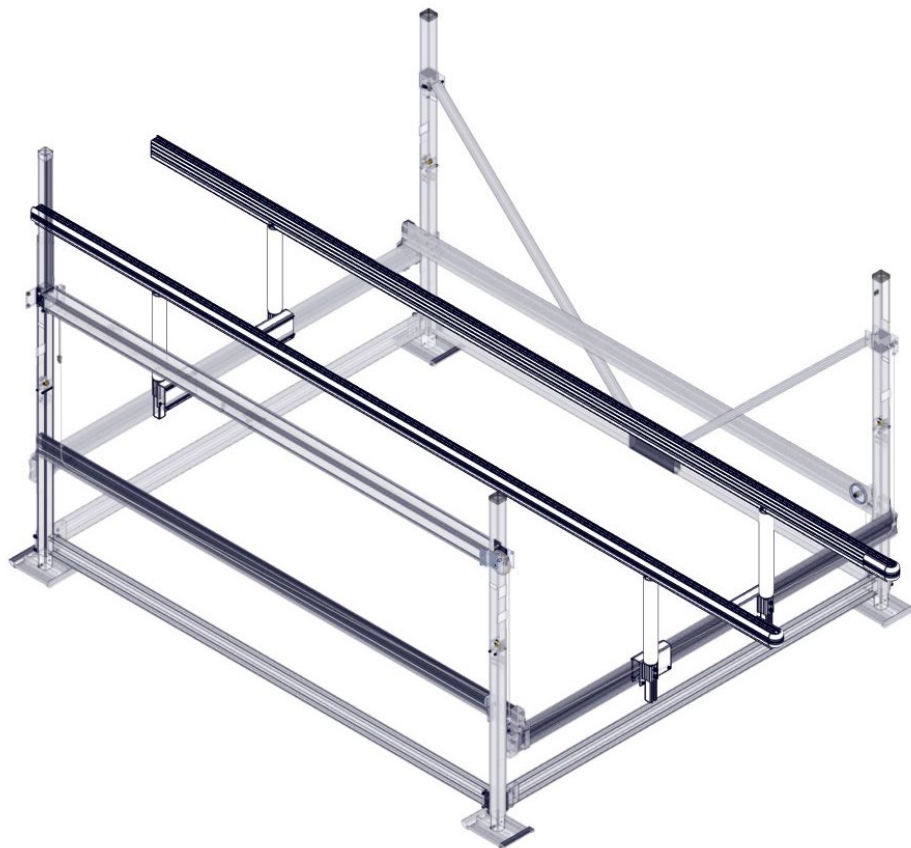

KIT P/N 511-02480-01, 511-02481-01, 511-02483-01



TOOLS REQUIRED

- (2) 9/16" SOCKETS/WRENCHES
- 3/4" SOCKET/WRENCH
- TAPE MEASURE
- MARKER
- TORQUE WRENCH
- RECIPROCATING SAW OR EQUIVALENT WITH METAL BLADE & PVC BLADE (OPTIONAL, SEE SHEET 7, 8 & 12)

*LIFT NOT INCLUDED

BUNK/CRADLE PAD DISCLAIMER

DUE TO THE LARGE VARIETY OF BOAT HULL DESIGNS, WE STRONGLY RECOMMEND THAT YOU CONSULT WITH YOUR BOAT'S MANUFACTURER TO ENSURE THAT YOU ARE SUPPORTING YOUR BOAT PROPERLY TO AVOID ANY POTENTIAL DAMAGE.

BILL OF MATERIALS

P/N 511-04219-01	FASTENERS, FL BUNK/PON. GUIDE BUNK		
<u>NUMBER</u>	<u>PART NUMBER</u>	<u>QTY.</u>	<u>DESCRIPTION</u>
1A	001-70114-00	4	HHCS, 3/8-16 x 2 3/4" 18-8 ss
1B	001-70115-00	8	HHCS, 3/8-16 x 3" 18-8 ss
1C	001-70205-00	8	HHCS, 1/2" x 1" 18-8 ss
1D	001-71027-00	8	FLAT WASHER, 1/2" SAE 18-8 ss
1E	001-76349-00	12	NUT, 3/8-16 ALUM.
1F	001-76350-00	8	NUT, 1/2-13 ALUM.

P/N 511-02480-01	GI/BUNK, PONTOON 16' V3600-VSD5000		
P/N 511-02481-01	GI/BUNK, PONTOON 18' V3600-VSD5000		
P/N 511-02483-01	GI/BUNK, PONTOON 20' VSD5000		
<u>NUMBER</u>	<u>PART NUMBER</u>	<u>QTY.</u>	<u>DESCRIPTION</u>
1	511-04219-01	1	FASTENERS, FL BUNK/PON. GUIDE BUNK
2	002-04375-00	4	TUBE, SUPPORT – PONTOON BUNK
3	111-00002-01	2	WELD'T, POCKET – CLAMP SIDE (1) 2 HOLE
4	111-00003-01	2	WELD'T, POCKET – CLAMP SIDE (2) 2 HOLE
5	111-00370-00	1	ASS'Y, BUNK – PONTOON 192" (A) (PART OF 511-02480-01)
6	111-00371-00	1	ASS'Y, BUNK – PONTOON 192" (B) (PART OF 511-02480-01)
7	111-00385-00	1	ASS'Y, BUNK – PONTOON 216" (A) (PART OF 511-02481-01)
8	111-00386-00	1	ASS'Y, BUNK – PONTOON 216" (B) (PART OF 511-02481-01)
9	111-00413-00	1	ASS'Y, BUNK – PONTOON 240" (A) (PART OF 511-02483-01)
10	111-00414-00	1	ASS'Y, BUNK – PONTOON 240" (B) (PART OF 511-02483-01)

P/N 211-02430-00	KIT, PONTOON GI/BUNK PVC – 3" DIA.		
<u>NUMBER</u>	<u>PART NUMBER</u>	<u>QTY.</u>	<u>DESCRIPTION</u>
11	958-00505-00	4	TUBE, 3" SCH 40 PVC – 23.813"

EXPLODED VIEW

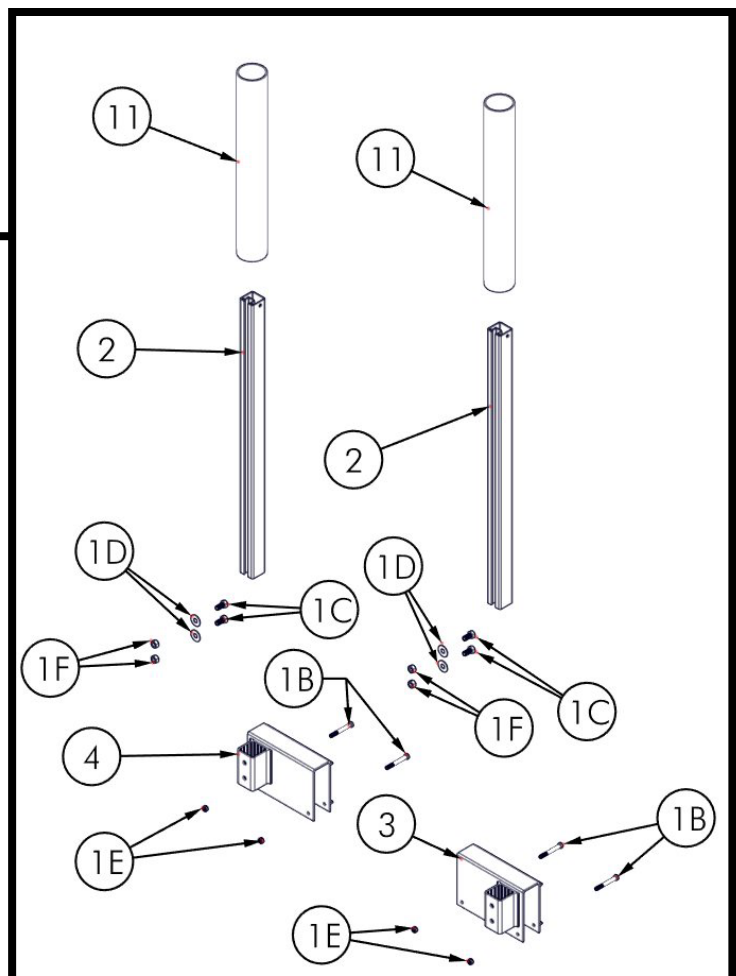
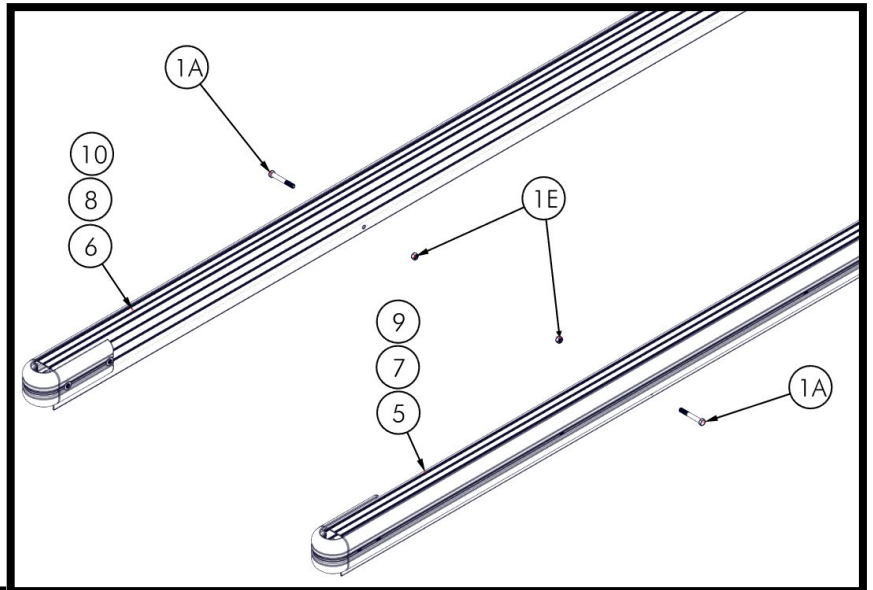
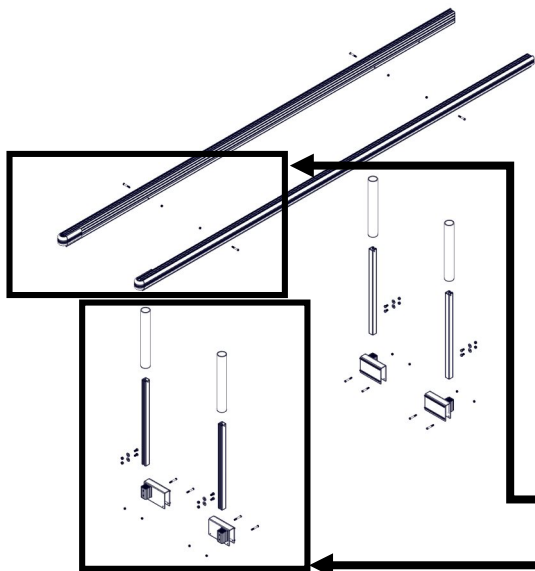

BILL OF MATERIALS - BUNKS

P/N 111-00370-00	ASS'Y, BUNK – PONTOON 192" (A)		
P/N 111-00371-00	ASS'Y, BUNK – PONTOON 192" (B)		
P/N 111-00385-00	ASS'Y, BUNK – PONTOON 216" (A)		
P/N 111-00386-00	ASS'Y, BUNK - PONTOON 216" (B)		
P/N 111-00413-00	ASS'Y, BUNK – PONTOON 240" (A)		
P/N 111-00414-00	ASS'Y, BUNK – PONTOON 240" (B)		
NUMBER	PART NUMBER	QTY.	DESCRIPTION
5	111-00370-00	1	ASS'Y, BUNK – PONTOON 192" (A)
A	001-29825-00	11	SCREW, 10-24 X 1" SQWFRTEK
B	001-71000-00	2	FLAT WASHER, 5/16 ID X 7/8" OD SS
5A	958-00320-00	1	PVC, BUMPER EXTRUSION – 204.5"
6	111-00371-00	1	ASS'Y, BUNK – PONTOON 192" (B)
A	001-29825-00	11	SCREW, 10-24 X 1" SQWFRTEK
B	001-71000-00	2	FLAT WASHER, 5/16 ID X 7/8" OD SS
6A	958-00320-00	1	PVC, BUMPER EXTRUSION – 204.5"
7	111-00385-00	1	ASS'Y, BUNK – PONTOON 216" (A)
A	001-29825-00	12	SCREW, 10-24 X 1" SQWFRTEK
B	001-71000-00	2	FLAT WASHER, 5/16 ID X 7/8" OD SS
7A	958-00322-00	1	PVC, BUMPER EXTRUSION – 228.5"
8	111-00386-00	1	ASS'Y, BUNK – PONTOON 216" (B)
A	001-29825-00	12	SCREW, 10-24 X 1" SQWFRTEK
B	001-71000-00	2	FLAT WASHER, 5/16 ID X 7/8" OD SS
8A	958-00322-00	1	PVC, BUMPER EXTRUSION – 228.5"
9	111-00413-00	1	ASS'Y, BUNK – PONTOON 240" (A)
A	001-29825-00	13	SCREW, 10-24 X 1" SQWFRTEK
B	001-71000-00	2	FLAT WASHER, 5/16 ID X 7/8" OD SS
9A	958-00323-00	1	PVC, BUMPER EXTRUSION – 252.5"
10	111-00414-00	1	ASS'Y, BUNK – PONTOON 240" (B)
A	001-29825-00	13	SCREW, 10-24 X 1" SQWFRTEK
B	001-71000-00	2	FLAT WASHER, 5/16 ID X 7/8" OD SS
10A	958-00323-00	1	PVC, BUMPER EXTRUSION – 252.5"

EXPLODED VIEW - BUNKS

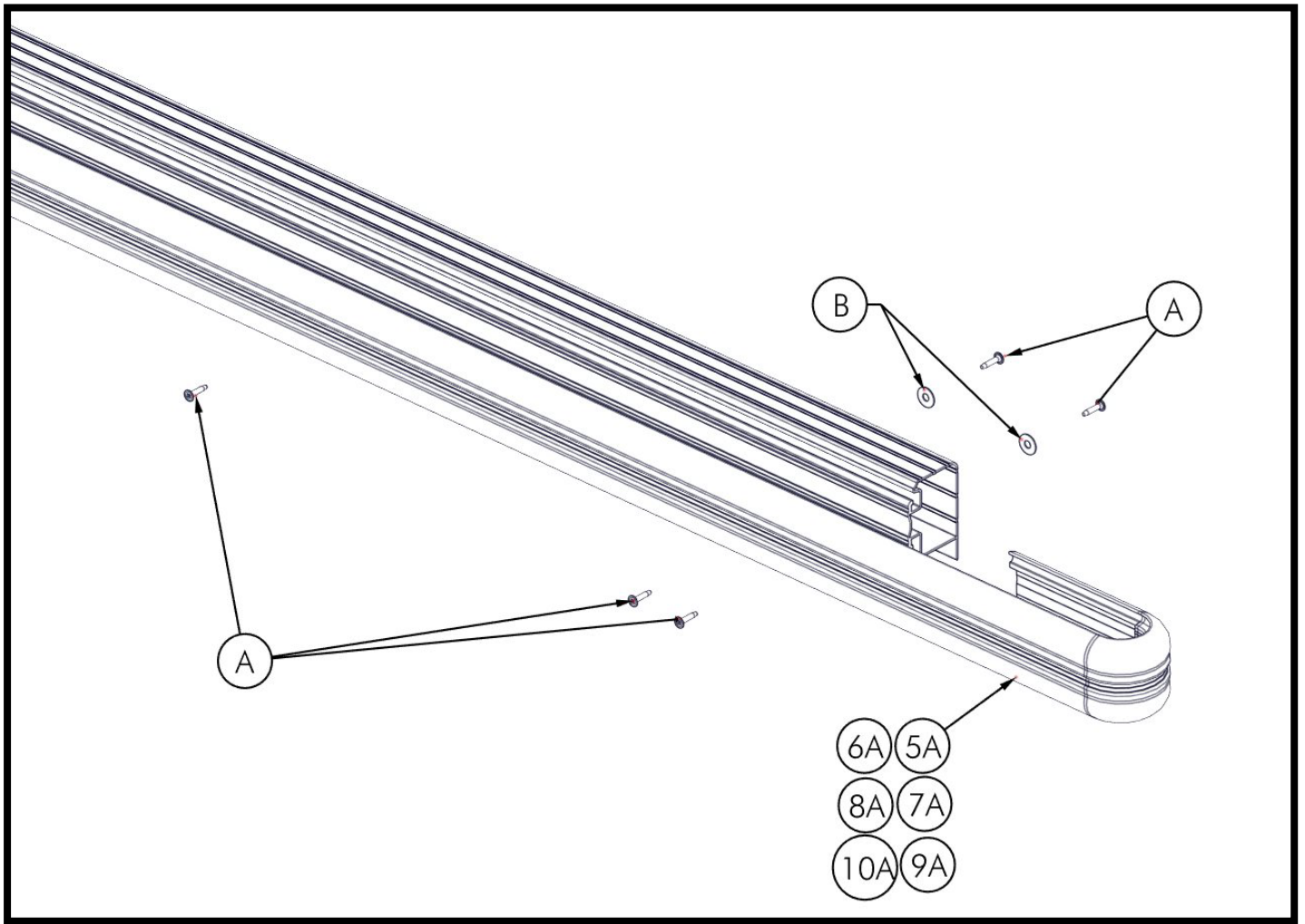

STEP 1

SLIDE CLAMPS OVER CRADLE BEAM WITH POCKETS FACING OUTWARDS AND AWAY FROM THE CENTER OF THE LIFT (FIGURE 1.1). PLACE (2) 1/2" X 1" BOLTS AND (2) 1/2" WASHERS INTO EACH POCKET (FIGURE 1.3).

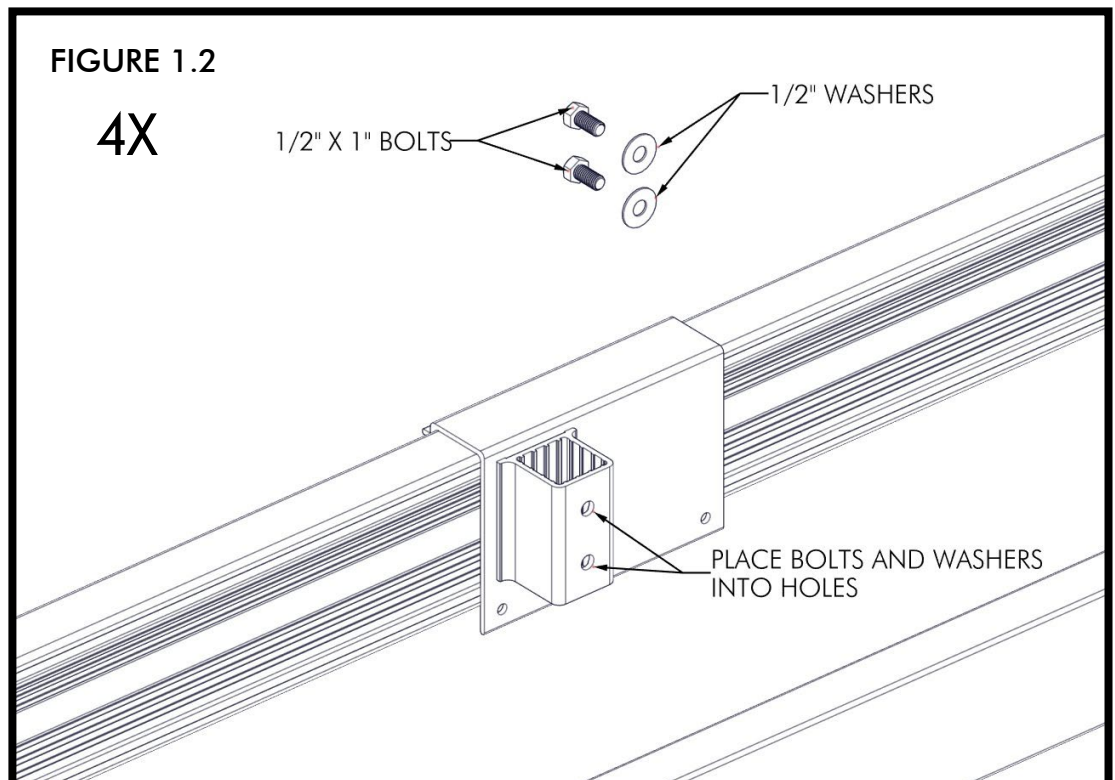
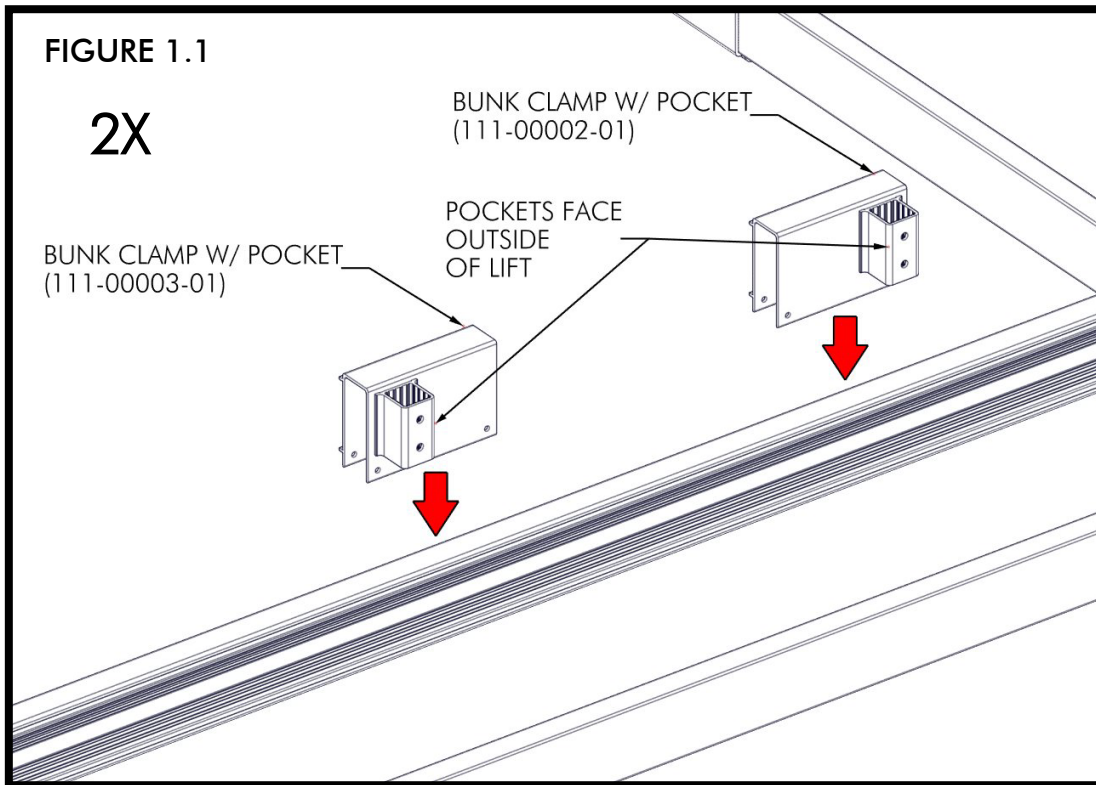

INSERT BUNK SUPPORT TUBES INTO CLAMP WELDMENTS AND ATTACH USING (2) 1/2" NUTS, HAND TIGHT ONLY (FIGURE 1.3). ADJUST HEIGHT WHILE REFERRING TO *FIGURE 2.5A AND TORQUE TO 70 FT-LBS (FIGURE 1.4).

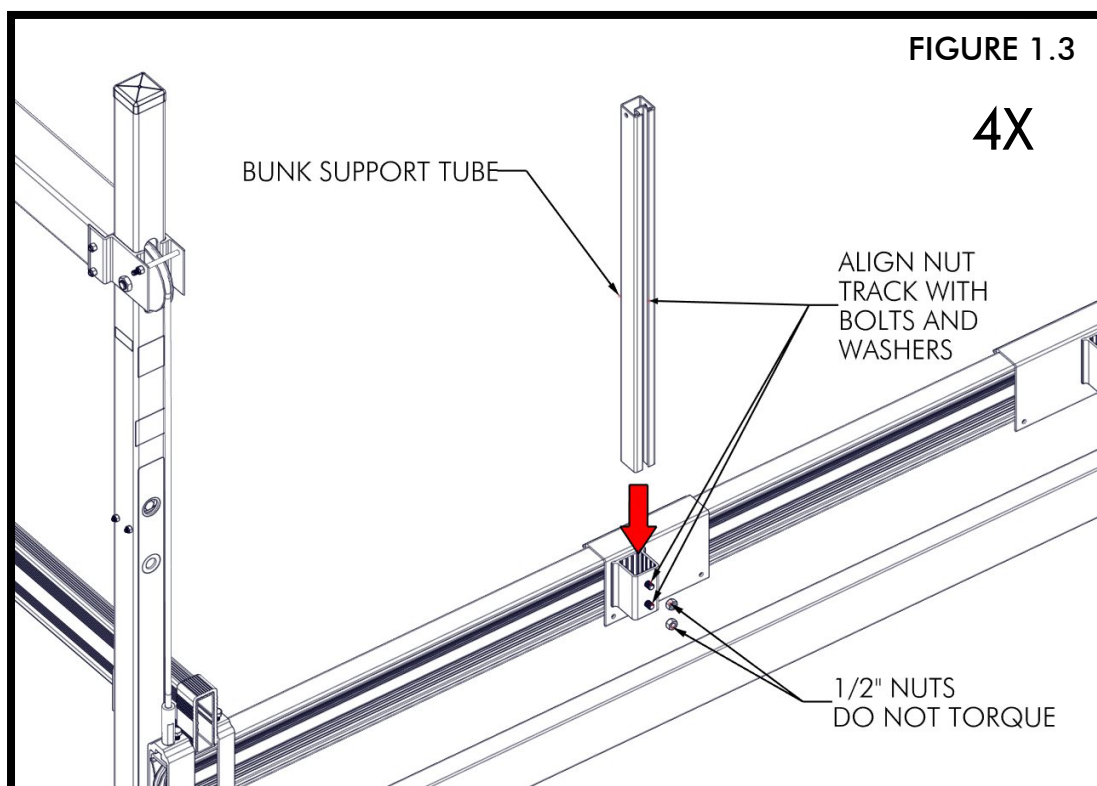

NOTE:

UPRIGHTS MAY HAVE TO BE CUT TO ALLOW FULL TRAVEL OF CRADLE ONCE FINAL PLACEMENT IS ESTABLISHED. PVC MAY ALSO HAVE TO BE CUT TO FIT BETWEEN THE BUNK AND CLAMP.

BUNK/CRADLE PAD **DISCLAIMER**

DUE TO THE LARGE VARIETY OF BOAT HULL DESIGNS, WE STRONGLY RECOMMEND THAT YOU CONSULT WITH YOUR BOAT'S MANUFACTURER TO ENSURE THAT YOUR ARE SUPPORTING YOUR BOAT PROPERLY TO AVOID ANY POTENTIAL DAMAGE.

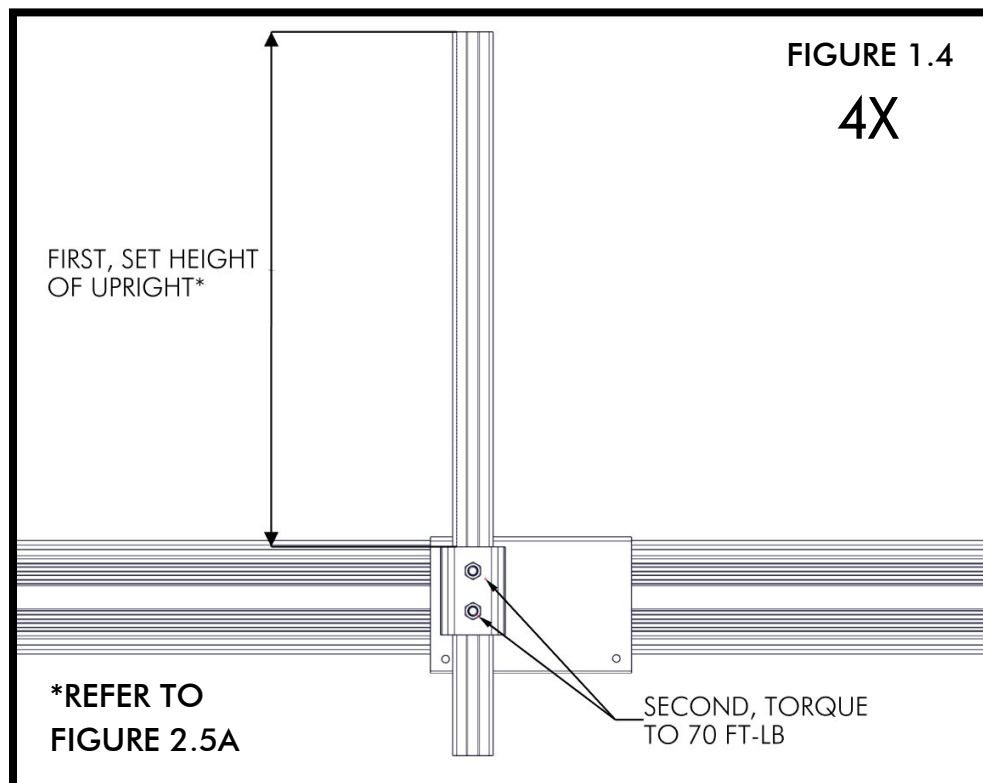

ONCE THE HEIGHT OF THE BUNK UPRIGHTS ARE SET, SLIDE THE PVC TUBES OVER THEM (FIGURE 1.5). **NOTE: IF THE SET HEIGHT OF THE UPRIGHTS IS LESS THAN THE LENGTH OF THE PVC TUBES, FIRST MEASURE THE DISTANCE FROM THE TOP OF THE TUBE TO THE TOP OF THE CLAMP, NOT THE TOP OF THE POCKET. THEN, SUBTRACT 1-1/4" FROM THAT MEASUREMENT AND CUT THE PVC TUBE TO THAT LENGTH (FIGURE 1.6).**

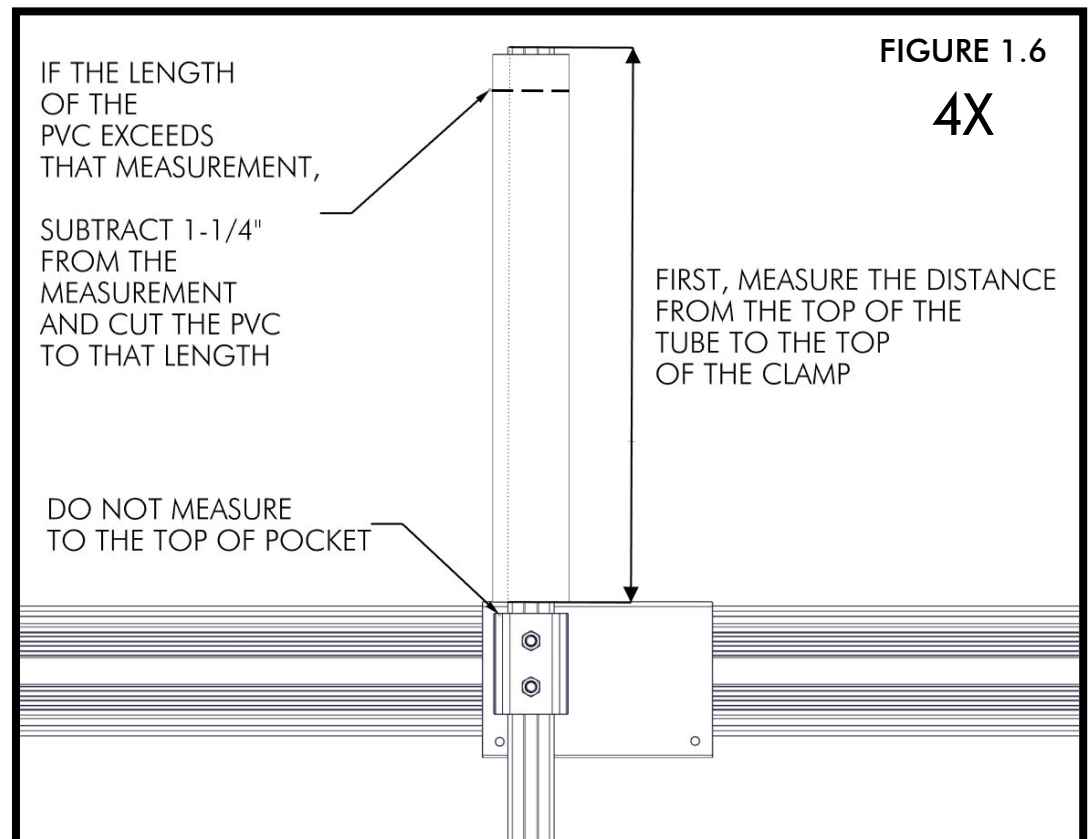
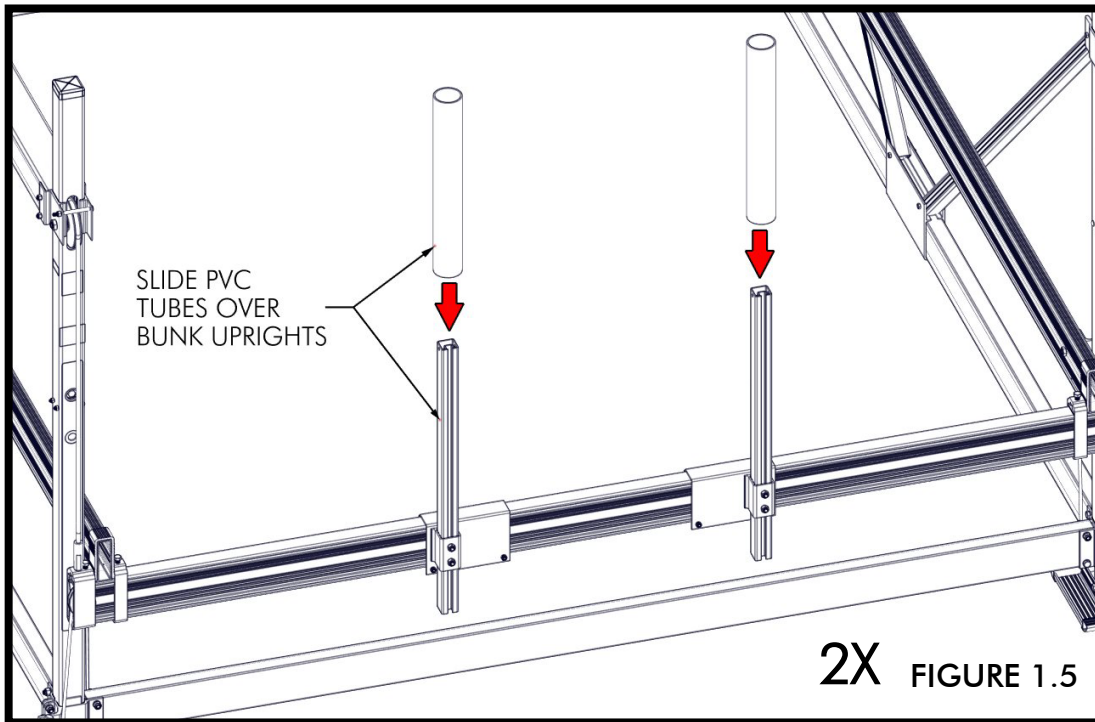
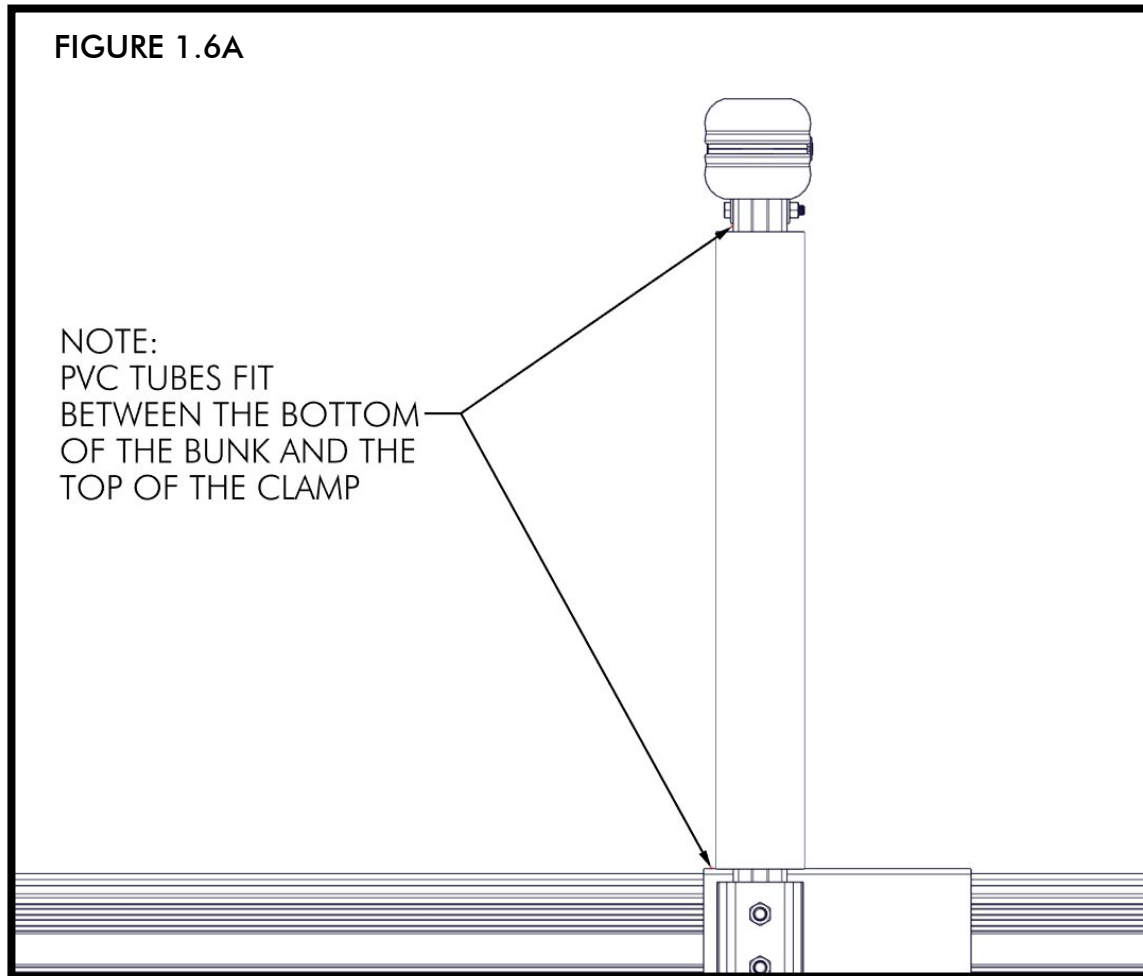
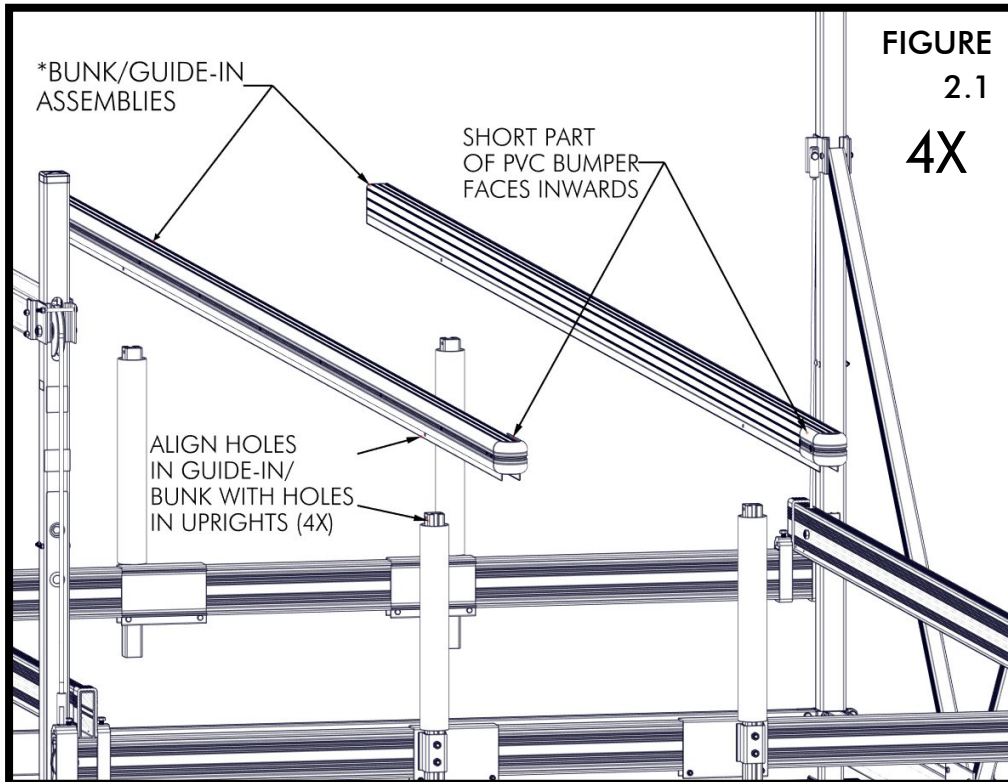

FIGURE 1.6A SHOWS THE BUNK INSTALLED WITH THE PVC TUBE FITTING BETWEEN THE BUNK AND THE TOP OF THE CLAMP.



STEP 2

PLACE BUNKS ONTO UPRIGHTS (FIGURE 2.1) AND ATTACH USING (2) 3/8" X 3-3/4" BOLTS AND (2) 3/8" NUTS PER BUNK (FIGURE 2.2).



*111-00370-00 & 111-00371-00 INCLUDED WITH 511-02480-01 (16' PONTOON BUNKS/GUIDE-INS.

*111-00385-00 & 111-00386-00 INCLUDED WITH 511-02481-01 (18' PONTOON BUNKS/GUIDE-INS.

*111-00413-00 & 111-00414-00 INCLUDED WITH 511-02483-01 (20' PONTOON BUNKS/GUIDE-INS.

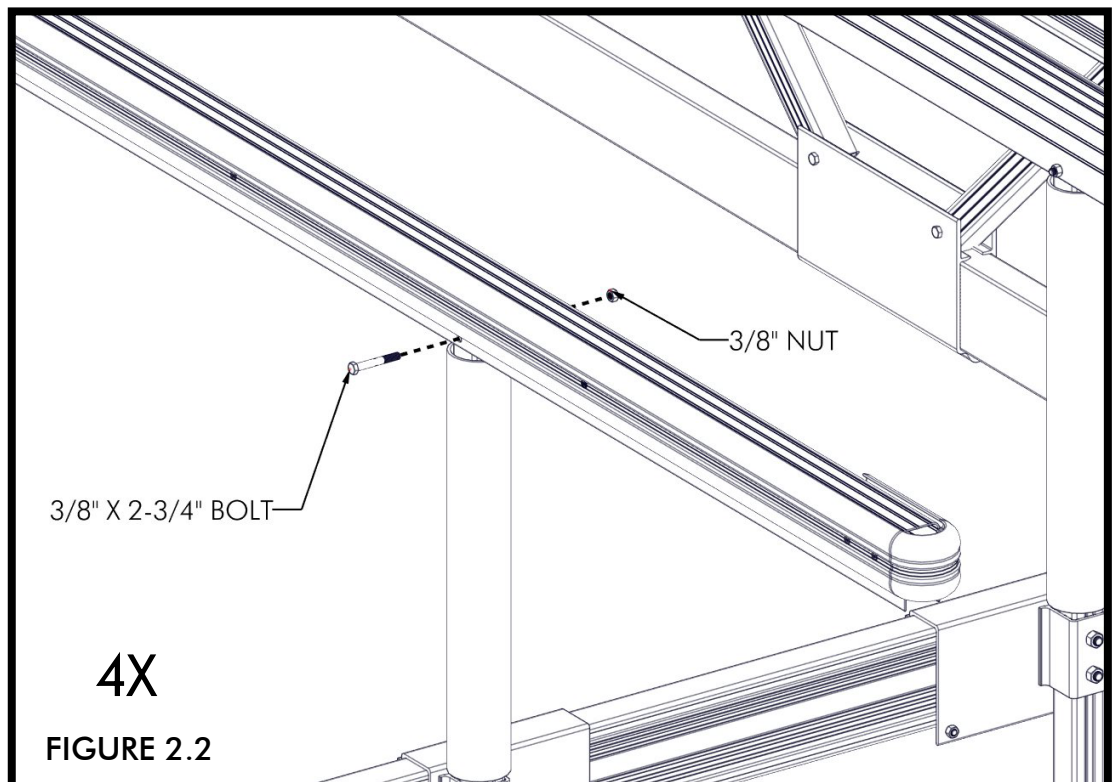

TORQUE NUTS TO 35 FT-LBS (FIGURE 2.3). ATTACH CLAMP WELDMENTS TO CRADLE BEAM USING (2) 3/8" X 4" BOLTS AND (2) 3/8" NUTS (FIGURE 2.4).

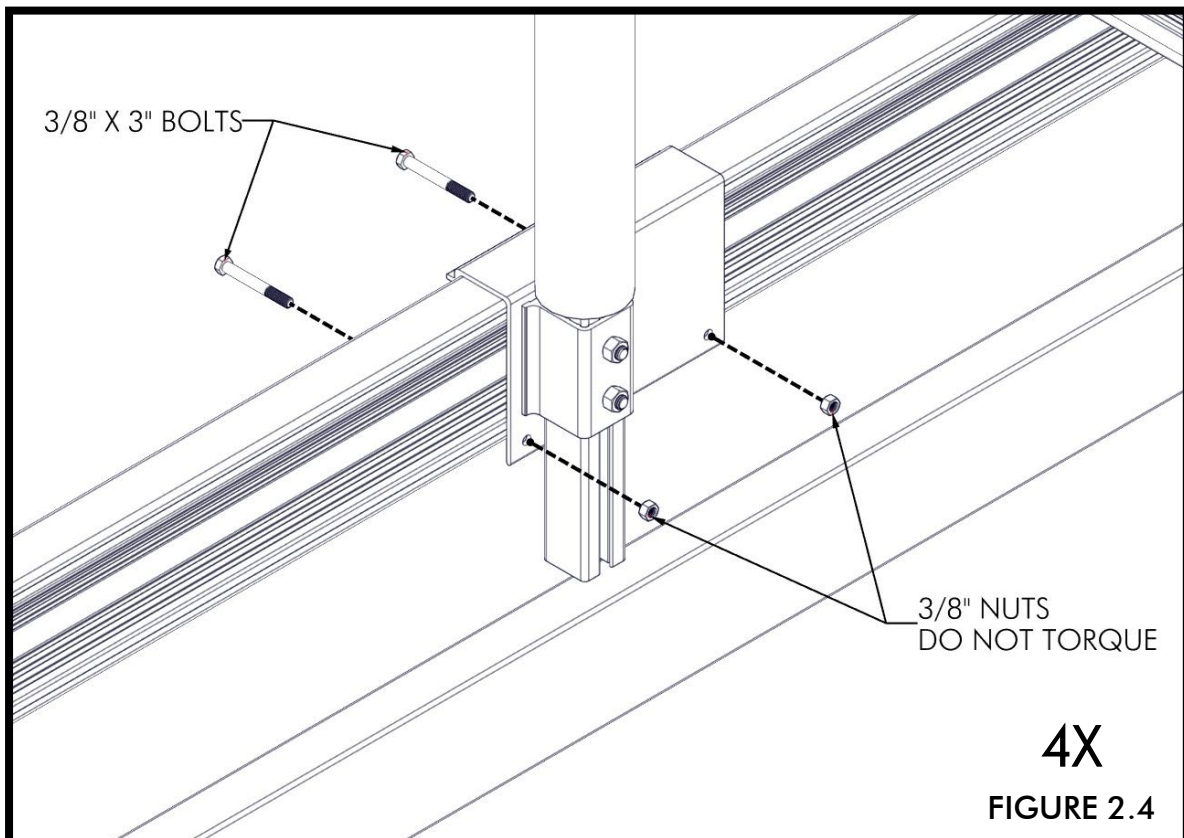
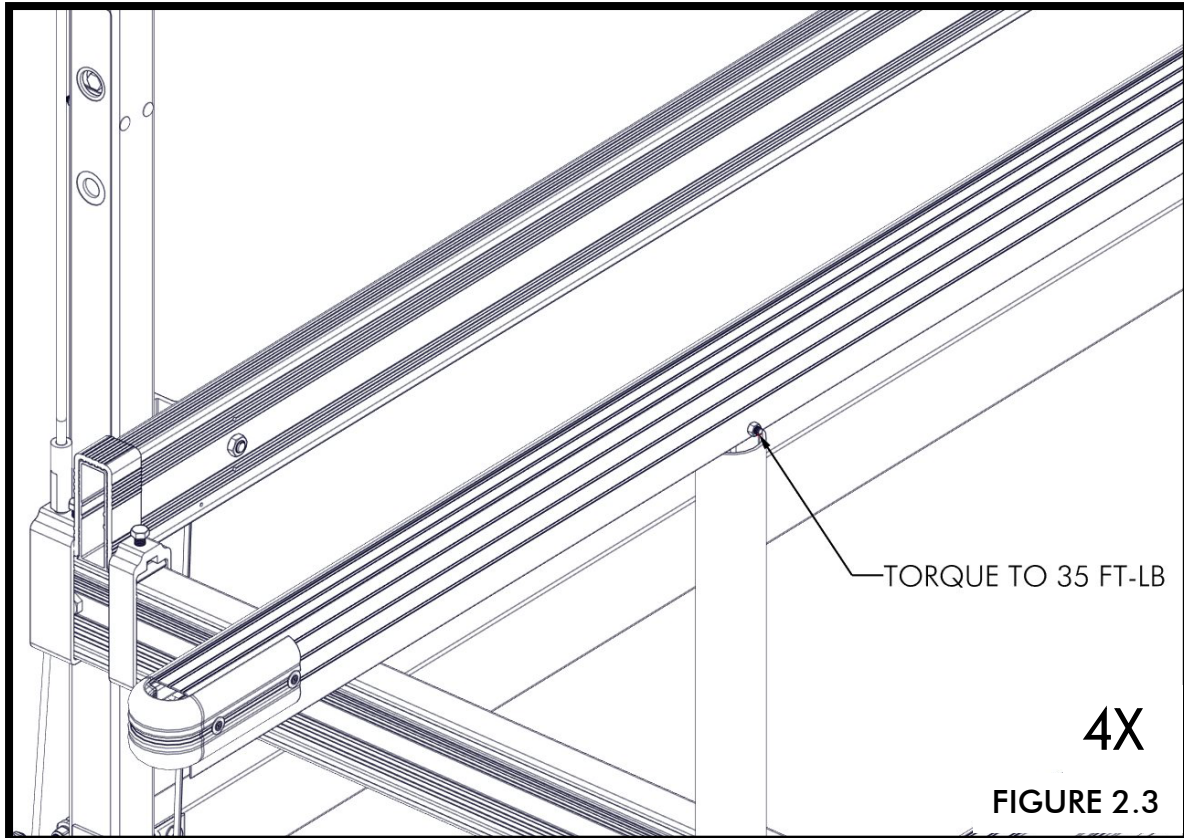

FOLLOW THESE GUIDELINES FOR USING AND LOCATING THE PONTOON BUNKS (FIGURE 2.5A & 2.5B).

-THE WIDTH OF THE BUNKS SHOULD BE 1-2 INCHES LESS THAN THE DISTANCE BETWEEN THE PONTOONS.

-TO SET BUNK HEIGHT, MEASURE FROM THE BOTTOM OF THE PONTOON DECK TO THE BOTTOM OF THE PONTOON, THEN ADD 1" TO THAT MEASUREMENT.

-THE REAR OF A 21 FOOT PONTOON BOAT SHOULD OVERHANG PAST THE LIFT BY 3 FEET. FOR EVERY ADDITIONAL FOOT IN LENGTH OF THE BOAT, IT SHOULD OVERHANG BY AN ADDITIONAL 6 INCHES BEYOND THE REAR OF THE LIFT.

THESE ARE THE GENERAL GUIDELINES THAT CAN BE ADJUSTED FOR AN INDIVIDUAL'S CIRCUMSTANCES.

ONCE FINAL POSITION IS SET, TORQUE 3/8" NUTS ON CLAMPS TO 35 FT-LBS (FIGURE 2.6).

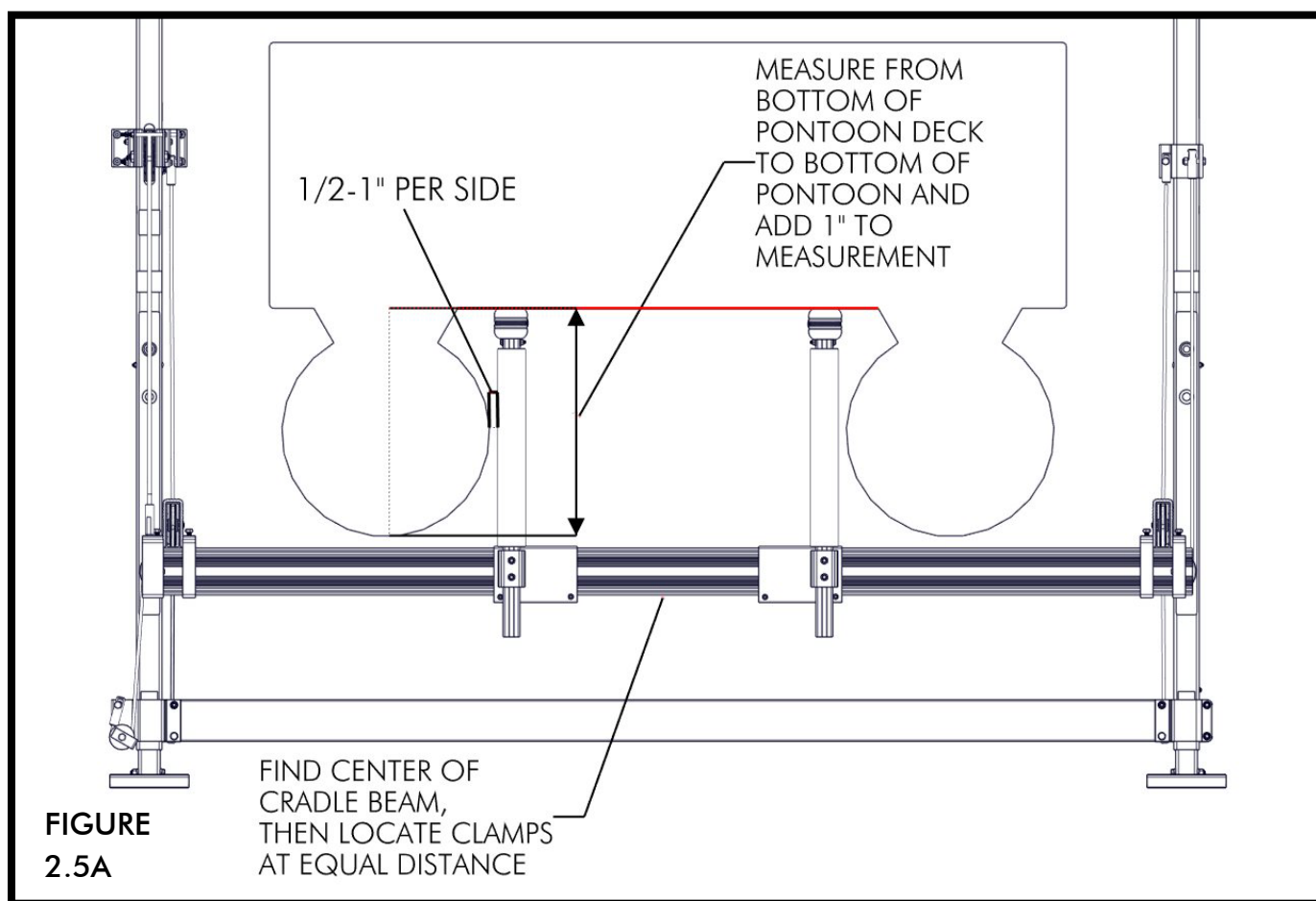

NOTE:

UPRIGHTS MAY HAVE TO BE CUT TO ALLOW FULL TRAVEL OF CRADLE ONCE FINAL PLACEMENT IS ESTABLISHED. PVC MAY ALSO HAVE TO BE CUT TO FIT BETWEEN THE BUNK AND CLAMP.

-WHEN ENTERING OR EXITING LIFT, THE TOP OF THE BUNKS SHOULD BE APPROXIMATELY 4 TO 5-1/2 INCHES OUT OF THE WATER, DEPENDING ON BOAT AND AMOUNT OF DRAFT (FIGURE 2.5B).

IMPORTANT: FAILURE TO SET BUNK HEIGHT CORRECTLY WILL RESULT IN DAMAGE TO BOAT, BUNKS, AND/OR LIFT.

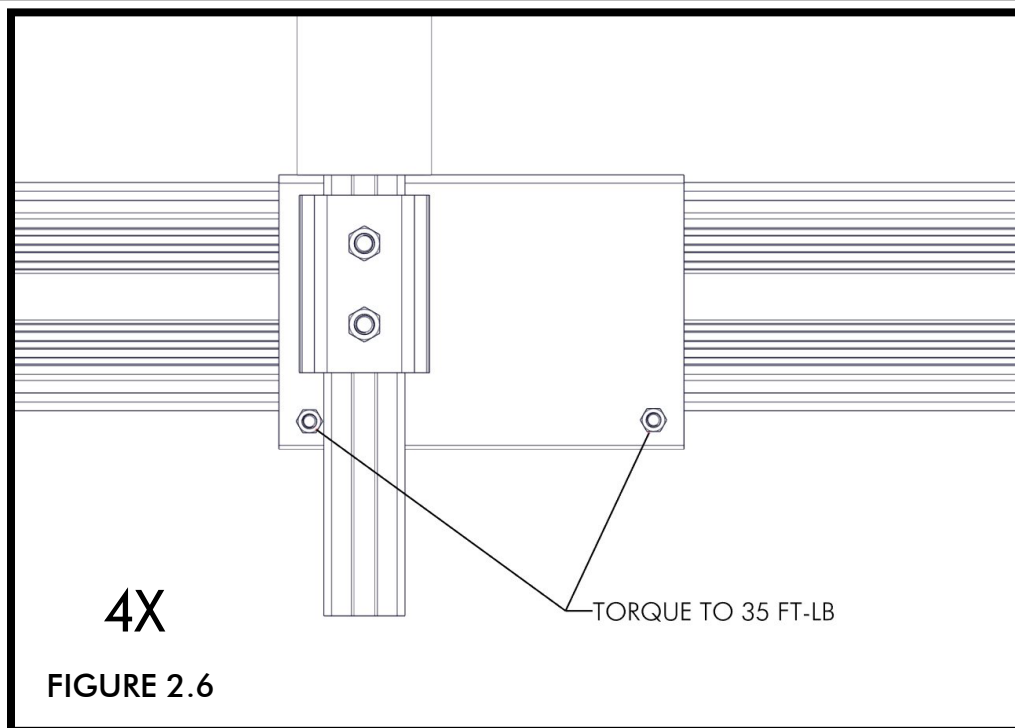
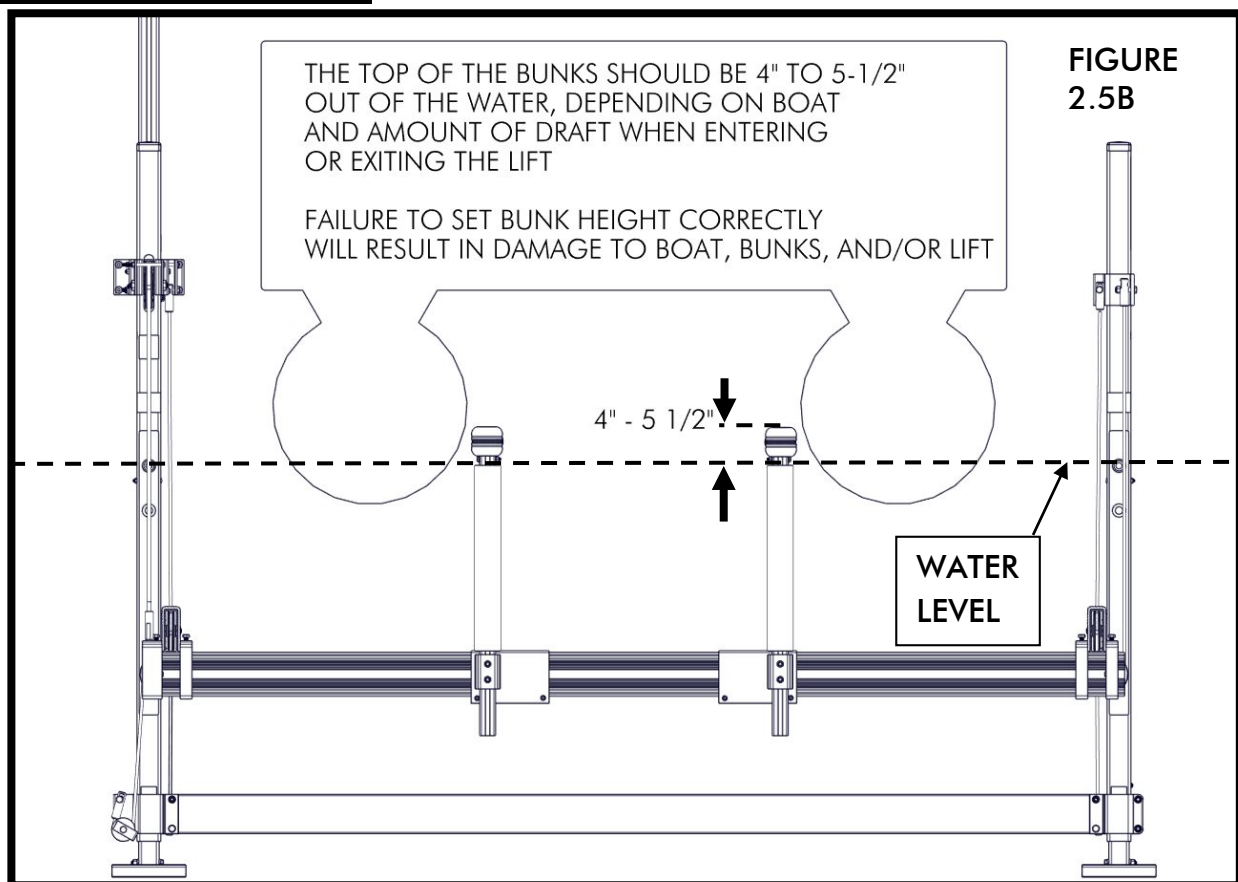

NOTES

NOTES

