

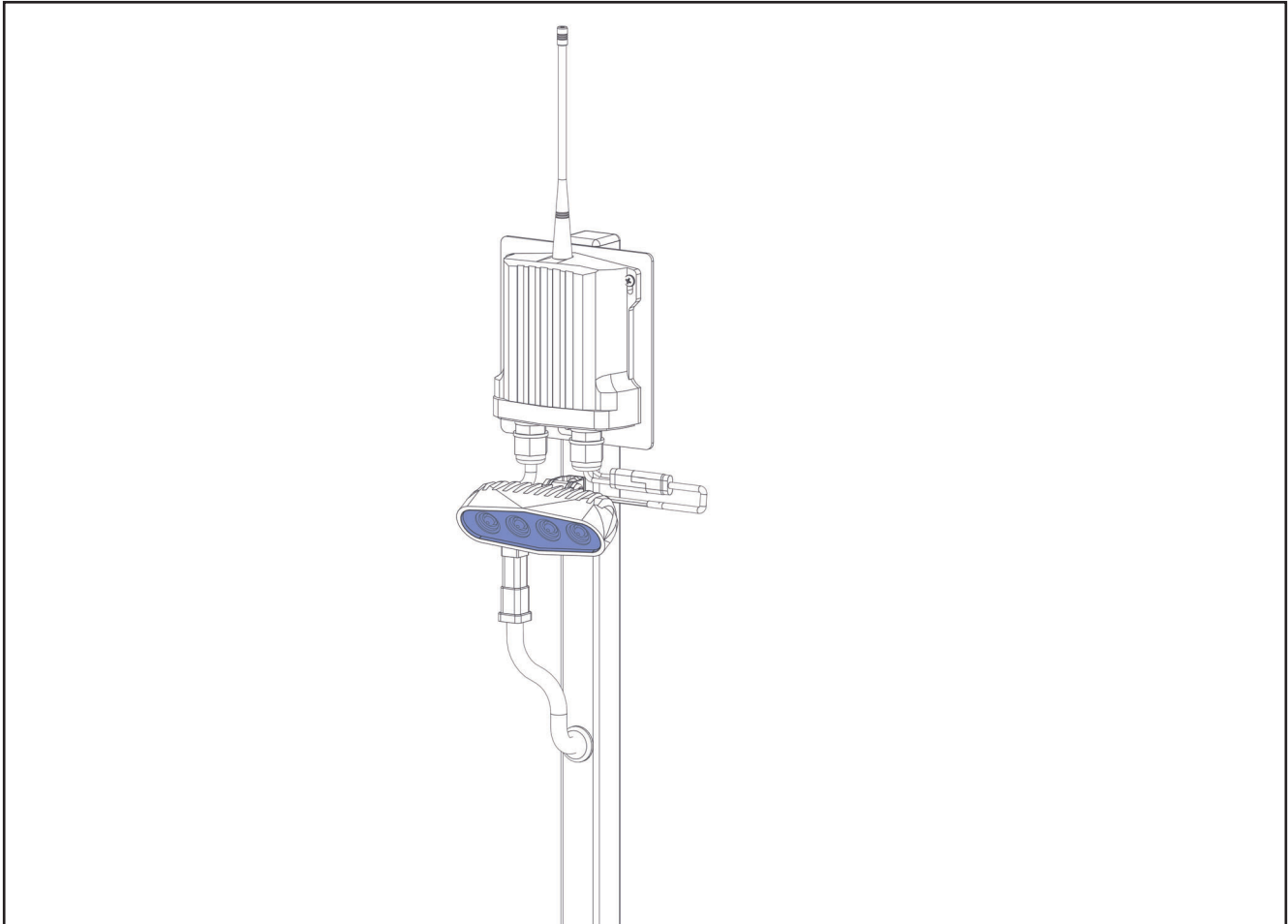

ASSEMBLY INSTRUCTIONS

SPREADER LIGHT 12/24V

V-LIFT & VSD LIFTS



For more information, go to the owner support tab on the FLOE website

***WIRELESS KIT (P/N 511-00832-01) IS REQUIRED (NOT INCLUDED).**

TOOLS REQUIRED

- 7/16" SOCKET/WRENCH
- WIRELESS SYSTEM INSTRUCTIONS

BILL OF MATERIALS/EXPLODED VIEW

P/N 511-00842-00		SPREADER LIGHT, 12/24 - BLACK		
NUMBER	PART NUMBER	QTY.	DESCRIPTION	
1	001-70010-00	1	HHCS, 1/4-20 X 1-3/4" 18-8 SS	
2	001-75001-00	1	NUT, NYLOCK 1/4-20 ALUM.	
3	002-05605-00	1	ADAPTER, SPREADER LIGHT TO PRE 2024 WIRELESS	
4	111-00838-00	1	ASS'Y, LIGHT 12/24V - BLACK	

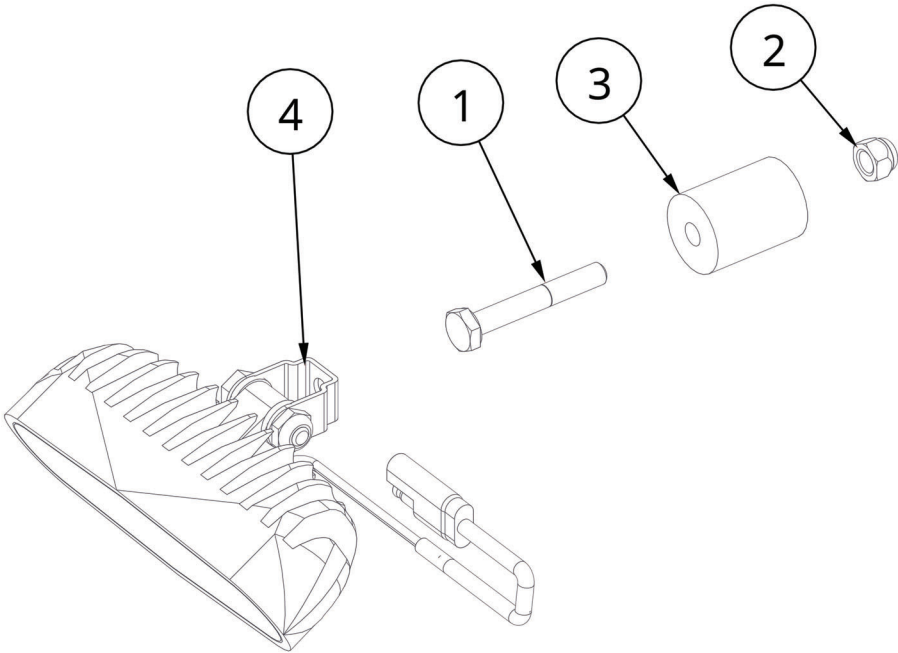

INSTALLATION

NOTE: INSTALL THE WIRELESS RECEIVER TO THE MAST FIRST. WITH THE 1/4" NYLOCK NUT REMOVED, INSTALL THE BOLT ATTACHED TO THE LIGHT INTO THE WIRELESS MAST (FIGURE 1.1). **FOR WIRELESS SYSTEMS SOLD PRIOR TO 2024,** PLACE THE SUPPLIED ADAPTER INTO THE 1" HOLE IN THE MAST BELOW WHERE THE WIRELESS RECEIVER MOUNTS (FIGURE 1.1A).

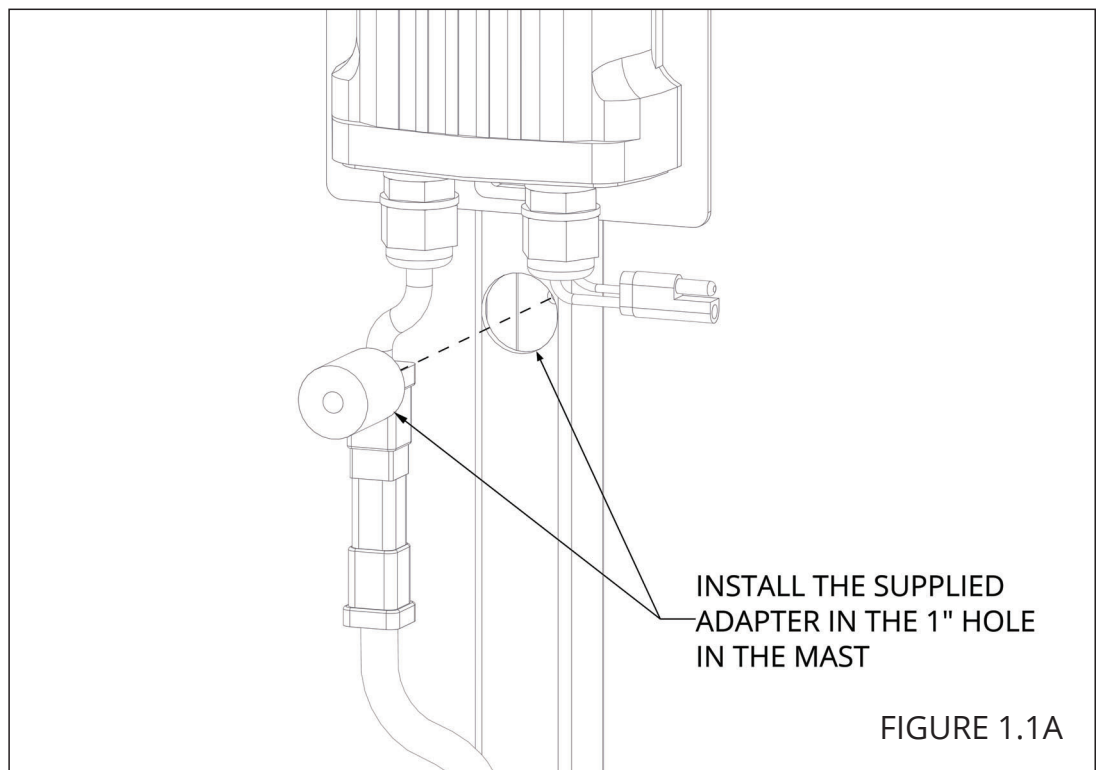
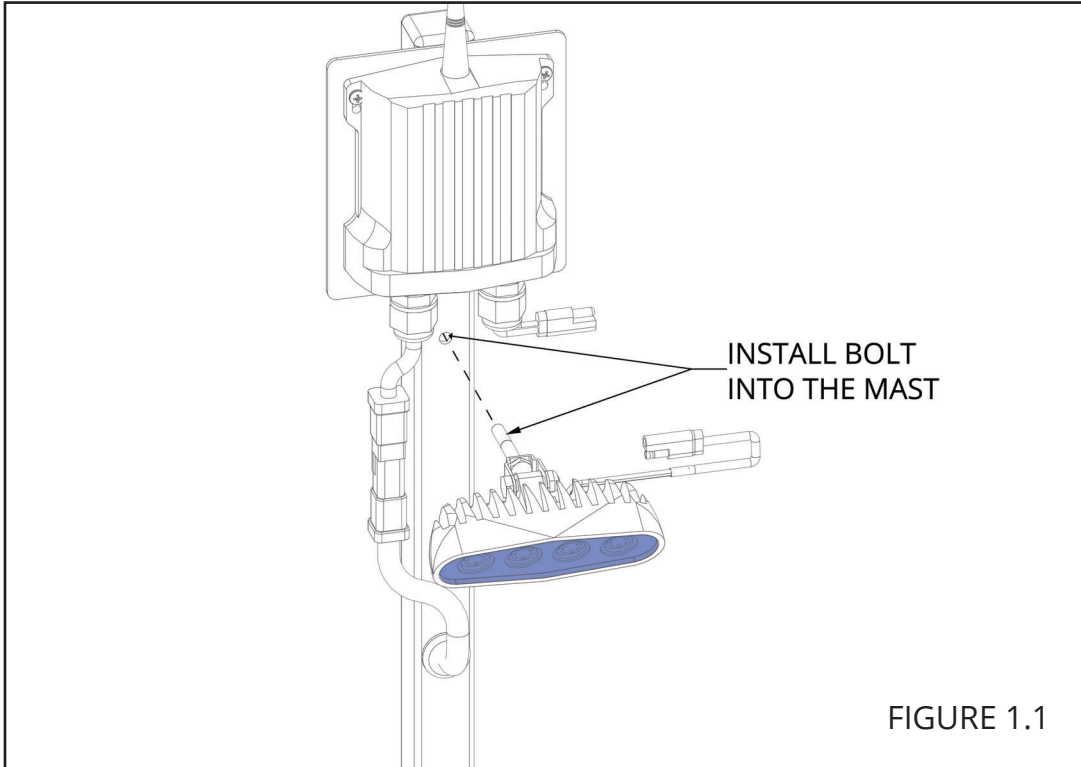

CONNECT THE PLUG ON THE LIGHT TO THE MATCHING PLUG ON THE WIRELESS RECEIVER. INSTALL THE 1/4" NYLOCK NUT ONTO THE BOLT (FIGURE 1.2) AND TIGHTEN TO SNUG TO REMOVE PLAY IN THE BOLT (FIGURE 1.3). **USE THE BUTTON ON THE REMOTE TO TURN LIGHT ON AND OFF. THE LIGHT REMAINS ON FOR 15 MINUTES BEFORE AUTOMATICALLY TURNING OFF.**

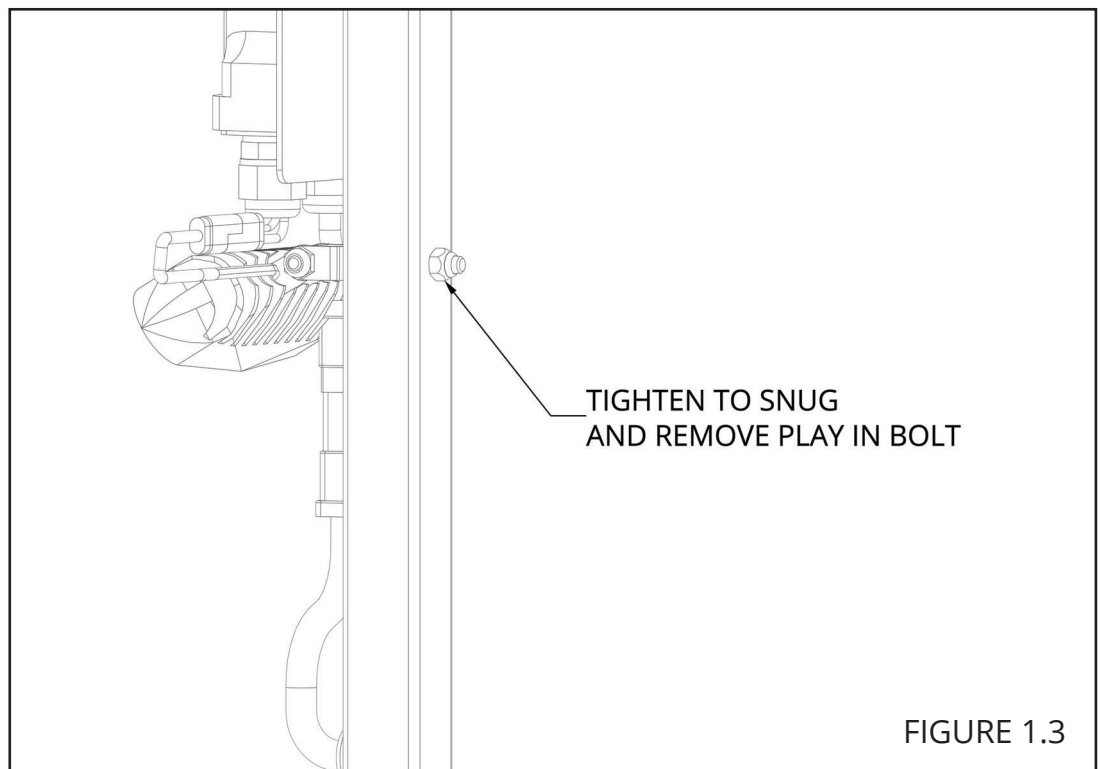
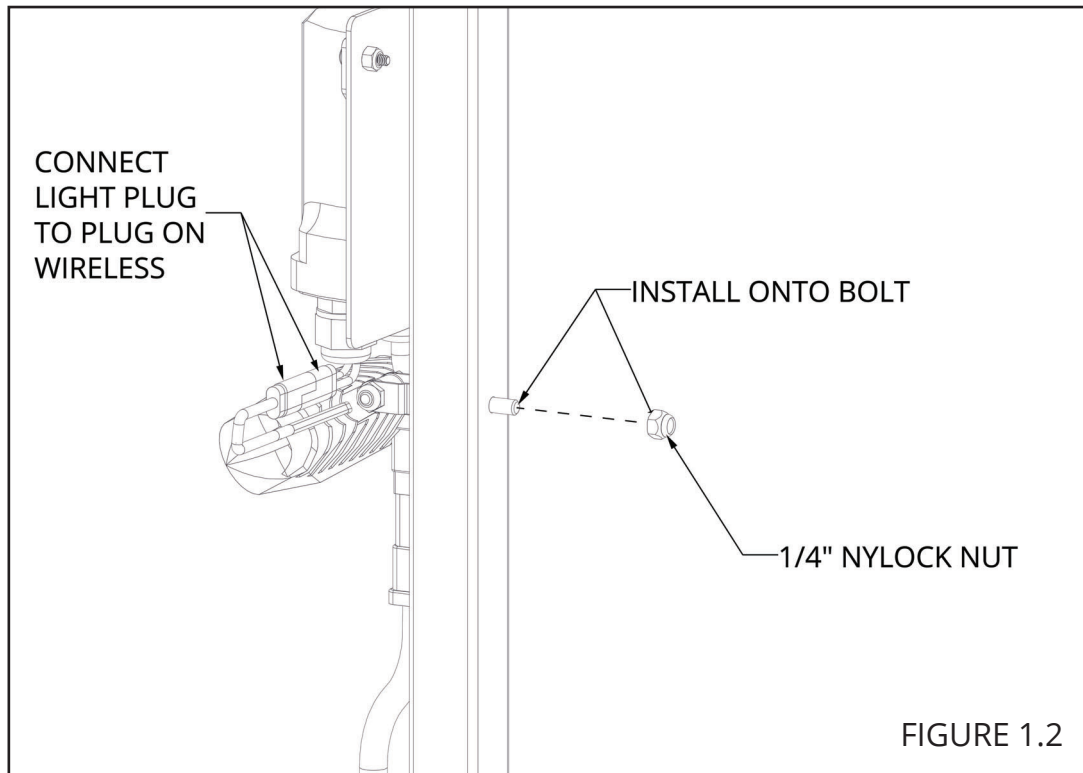

NOTES

NOTES

NOTES



FLOE INTERNATIONAL, INC.
48473 STATE HIGHWAY 65 • MCGREGOR, MN 55760
www.floeintl.com

*All material copyright © 2023 FLOE International, Inc.
Specifications subject to change without notice.*