

**FLOE QUICK ATTACH SECTIONAL  
DOCK FLAG POLE BRACKET KIT**  
ASSEMBLY INSTRUCTIONS  
KIT P/N 510-02573-00

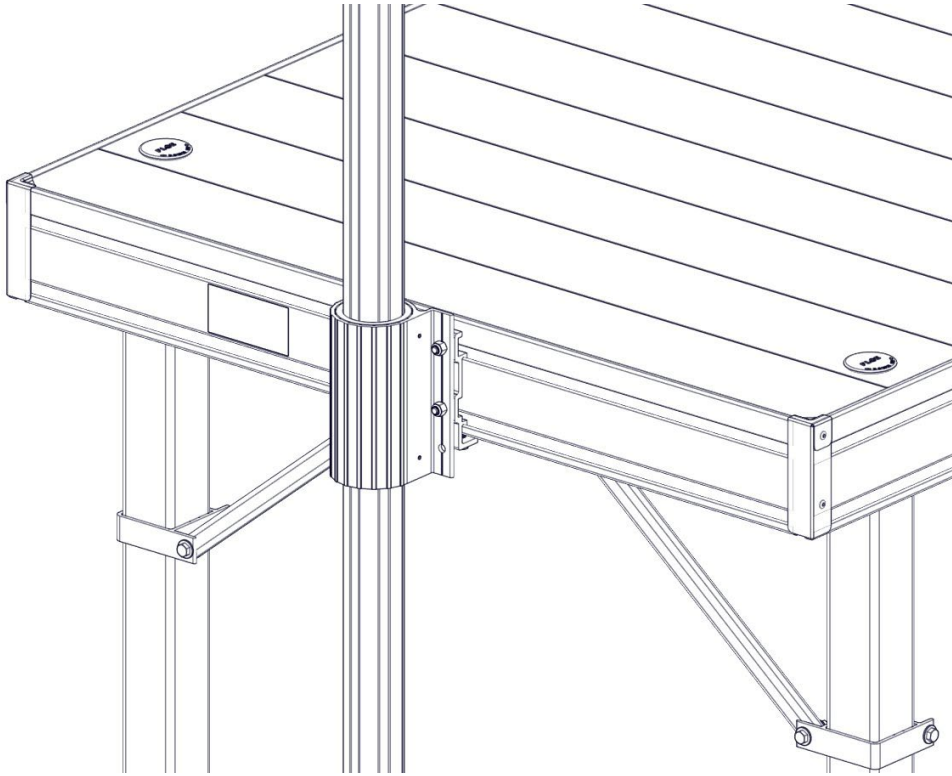

\* FLAG POLE, FLAG POLE POCKET, DOCK, AND LEGS NOT INCLUDED

NOTE: TWO 9/16" WRENCHES MAY BE  
REQUIRED, DEPENDING ON THE STYLE OF THE  
QUICK ATTACH ACCESSORY BRACKET

**TOOLS REQUIRED**

-(2) 9/16" SOCKETS/WRENCHES  
-TORQUE WRENCH

**BILL OF MATERIALS/EXPLODED VIEW**

P/N 510-02573-00	KIT, QA FLAG POLE		
NUMBER	PART NUMBER	DESCRIPTION	QTY
1	001-02573-01	FASTENERS, QUICK ATT. FLAG POLE	1
1A	001-70105-00	HHCS, 3/8-16 X 1" 18-8 SS	6
1B	001-76071-00	NUT, NYLOCK 3/8-16 ALUM.	4
2	002-00161-01	BRACKET, QA SCTN'L FLAG POLE – 6.312"	1

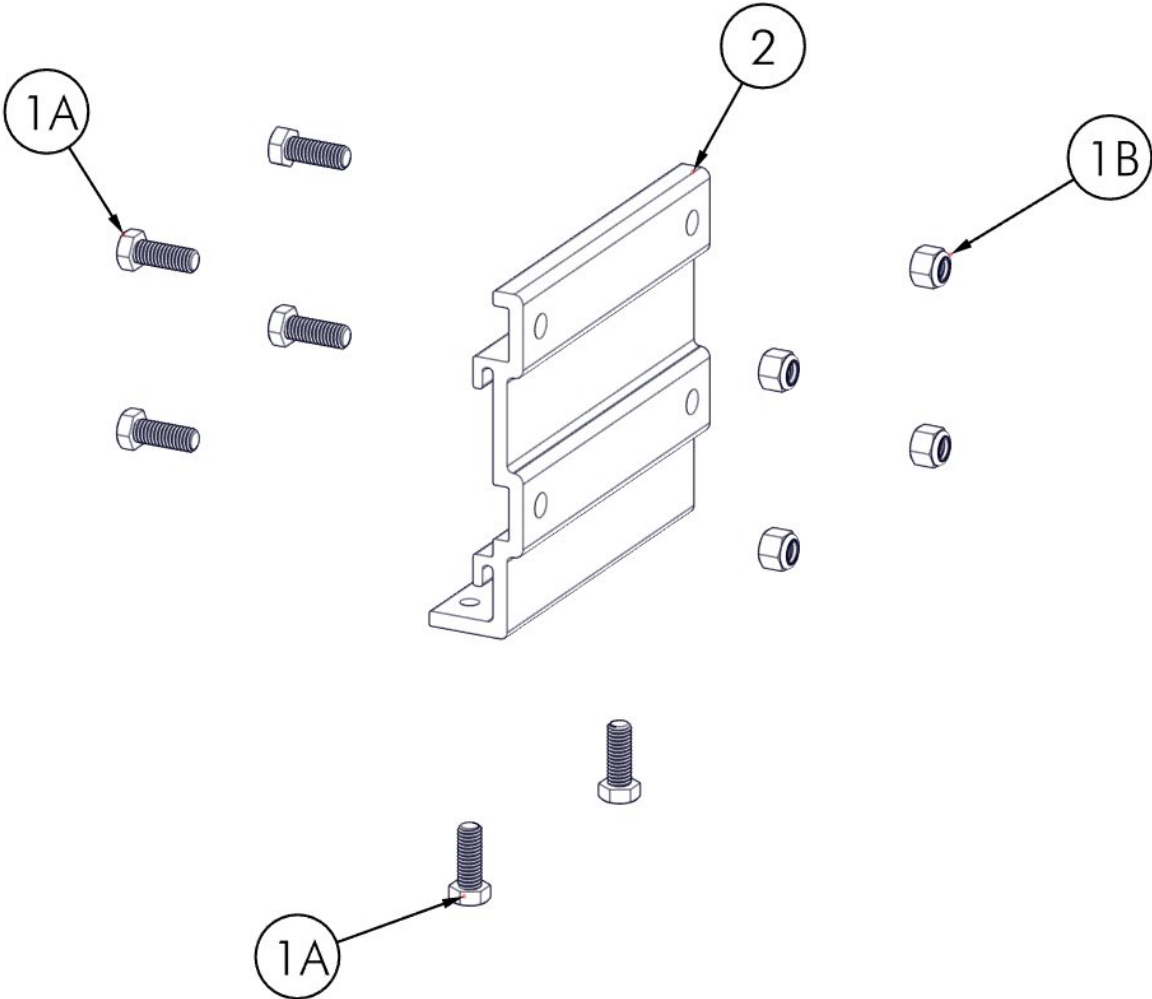

## ASSEMBLY

FIRST, DETERMINE WHERE THE FLAG POLE WILL BE INSTALLED ON THE DOCK SYSTEM. INSERT (2) 3/8" X 1" BOLTS INTO THE BRACKET AND INTO THE CORRESPONDING HOLES ON THE FLAG POLE POCKET (FIGURE 1.1). PLACE A 3/8" NYLOCK NUT ONTO EACH BOLT (FIGURE 1.2). TORQUE TO 35 FT-LB (FIGURE 1.3).

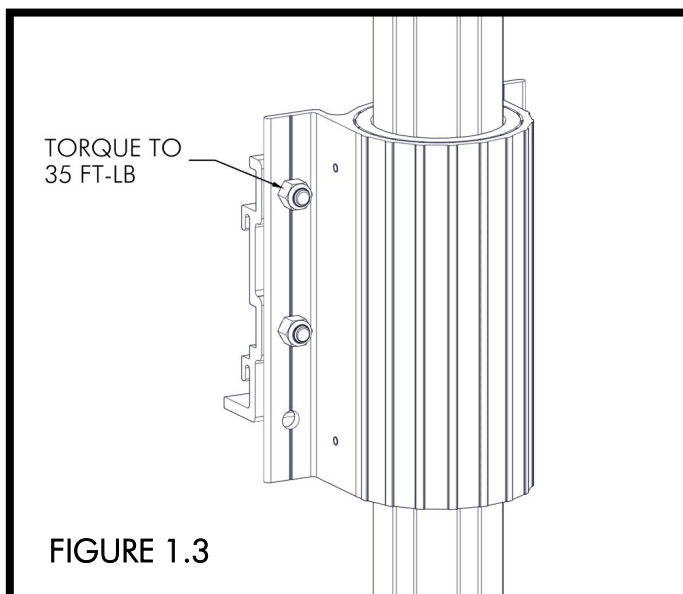
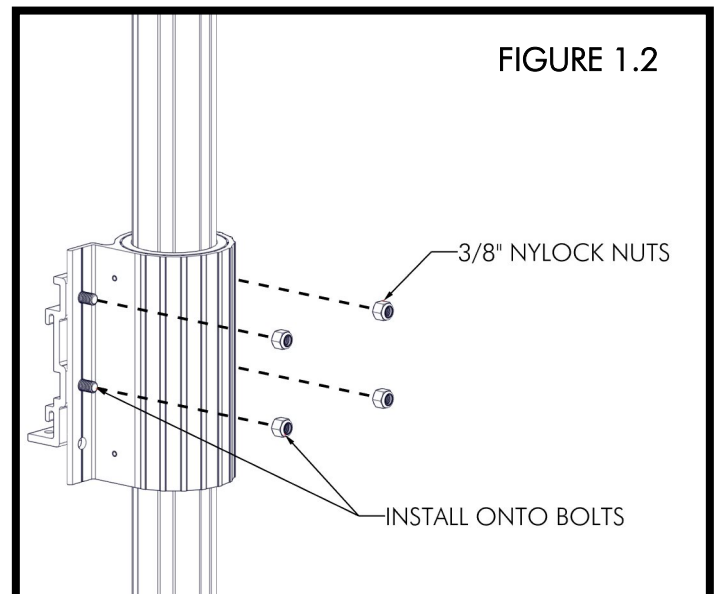
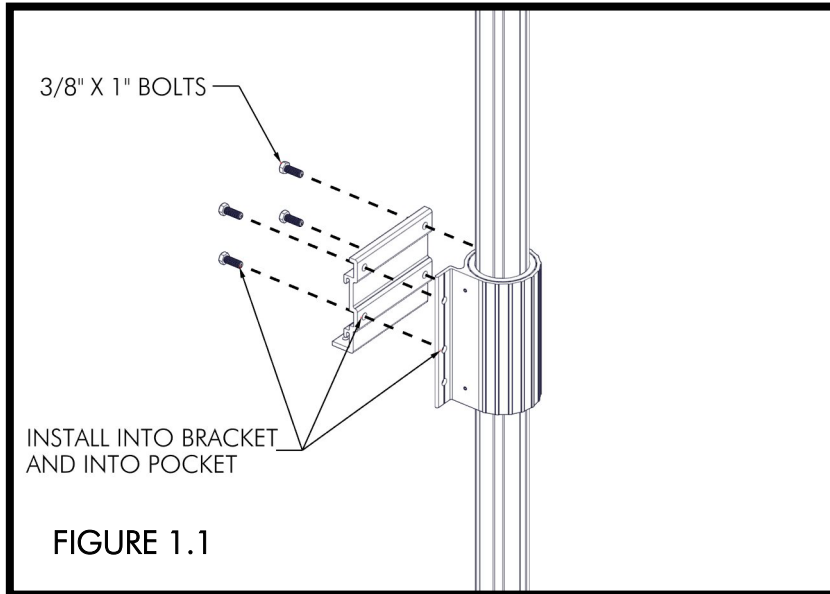

START A 3/8" X 1" BOLT INTO THE BOTTOM OF EACH BRACKET. DO NOT TIGHTEN (FIGURE 1.4). PLACE THE BRACKET INTO THE DOCK SIDE IN THE DESIRED LOCATION (FIGURE 1.5). TORQUE BOLTS TO **6 FT-LB MAXIMUM** (FIGURE 1.6). REFER TO THE FLAG POLE INSTRUCTIONS FOR FURTHER INFORMATION.

FIGURE 1.4

