



# SUPPORTS, CANOPY W/CABLE

ASSEMBLY INSTRUCTIONS KIT P/N 512-00010-00

## CANOPY SUPPORTS INSTALLATION AND ADJUSTMENT

### TOOLS REQUIRED:

- 1 - 7/8" OPEN END WRENCH
- 1 - 3/4" OPEN OR BOX END WRENCH  
(OR A RACHET AND 3/4" SOCKET)
- 2 - 9/16" COMBINATION END WRENCHES
- 1 - TORQUE WRENCH

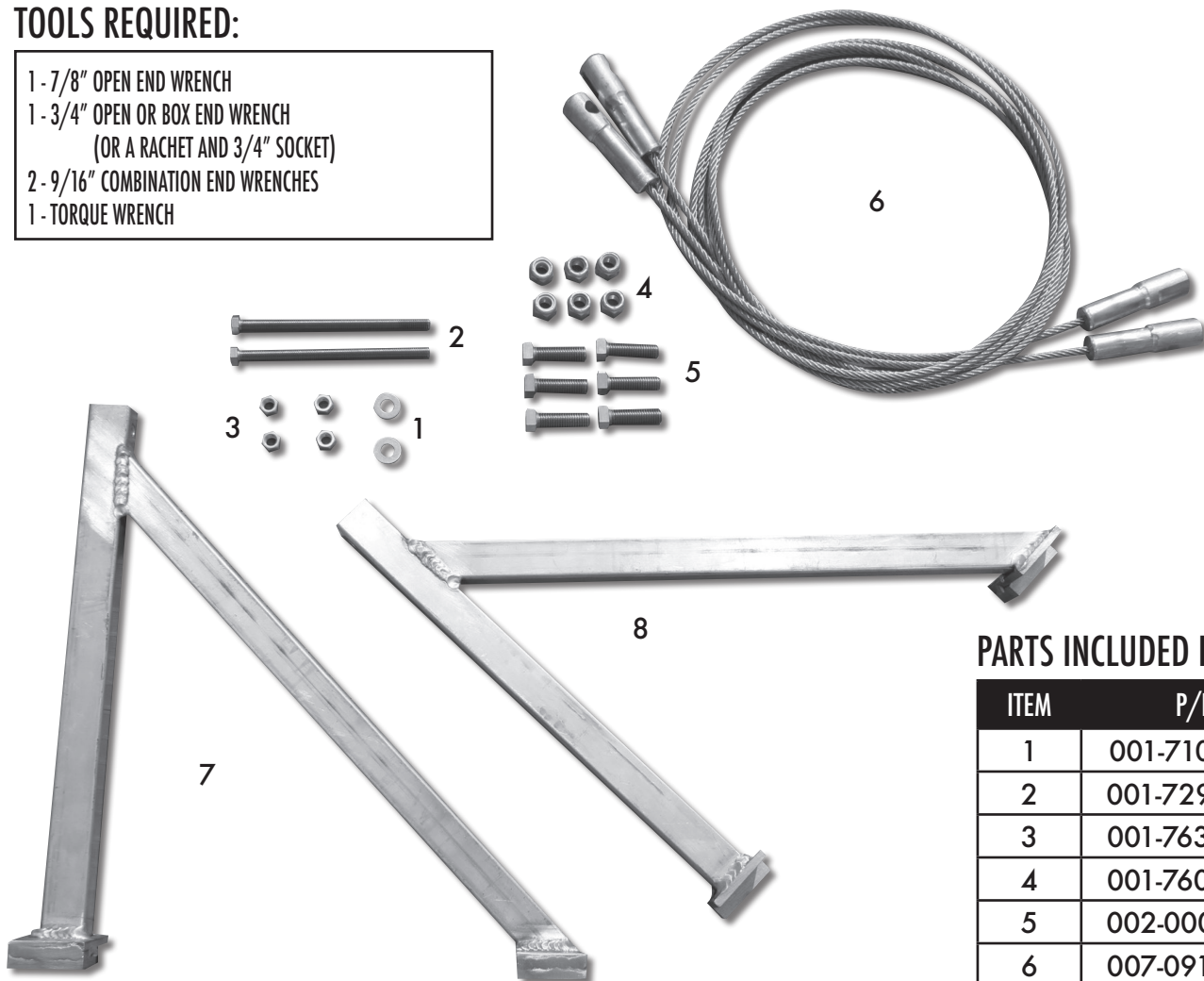

NOTE: READ THESE INSTRUCTIONS CAREFULLY AND COMPLETELY AND UNDERSTAND ALL ASSEMBLY AND ADJUSTMENT PROCEDURES PRIOR TO PERFORMING THE INSTALLATION AND MAKING ANY ADJUSTMENTS. WORK FROM A STABLE LADDER OR PLATFORM WHILE PERFORMING THESE STEPS. THESE INSTRUCTIONS REFER TO THE INSTALLATION OF THE "SIDE A" ADJUSTMENT BRACKET AND CABLE. THE OPPOSITE SIDE IS INSTALLED FOLLOWING THE SAME PROCEDURES.

NOTE: QUANTITIES ARE X2 FOR CANOPIES 30' AND LONGER

### PARTS INCLUDED IN KIT:

ITEM	P/N	DESCRIPTION	QTY
1	001-71017-00	FLAT WASHER, 3/8" SAE SS 18-8	2
2	001-72942-00	HHCS, 3/8-16 x 6" FULL THREAD	2
3	001-76349-00	NUT, 3/8-16 ALUM.	4
4	001-76072-00	NUT, NYLOCK, 1/2-13 ALUM.	6
5	002-00074-00	BOLT, CANOPY SUPPORT (FAB)	6
6	007-09175-00	CABLE, CANOPY SUPPORT 1/4"	2
7	111-00421-00	WELD'T, CANOPY SUPPORT "SIDE A"	1
8	111-00422-00	WELD'T, CANOPY SUPPORT "SIDE B"	1

INSTRUCTION P/N 612-00010-00  
ISSUED: 5/5/23

PLEASE RETAIN THIS INSTRUCTION MANUAL FOR FUTURE REFERENCE

# BRACKET INSTALLATION - PART 1

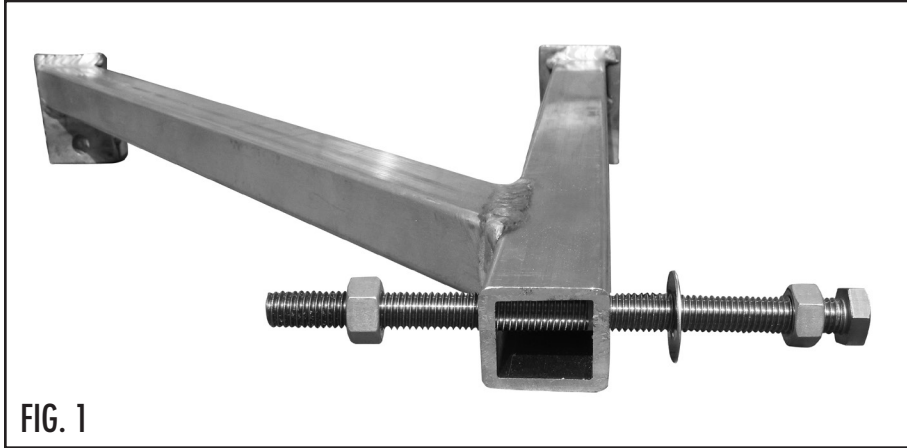

FIG. 1

1. INSTALL ONE 3/8" NUT (ITEM #3) WHICH WILL BE REFERRED TO AS THE ADJUSTMENT BOLT LOCK NUT, AND WASHER (ITEM #1) ONTO THE 6" ADJUSTMENT BOLT (ITEM #2) AND INSTALL THE BOLT THROUGH THE HOLE IN THE TOP OF THE VERTICAL TUBE. INSTALL A SECOND 3/8" NUT ONTO THE ADJUSTMENT BOLT AS SHOWN IN **FIGURE 1**.

2. INSERT TWO SPECIAL BOLTS (ITEM #5) FIGURE 2 INTO THE SLOT IN THE TOP OF THE CANOPY BEAM, ONE ON EACH SIDE OF CANOPY CROSS BOW NEAR THE VERTICAL CORNER POST - **FIGURE 3 & 4**.

3. ROTATE BOLT 90° CLOCKWISE IN CANOPY BEAM SLOT TO LOCK THE BOLT INTO POSITION.



FIG. 2



FIG. 3

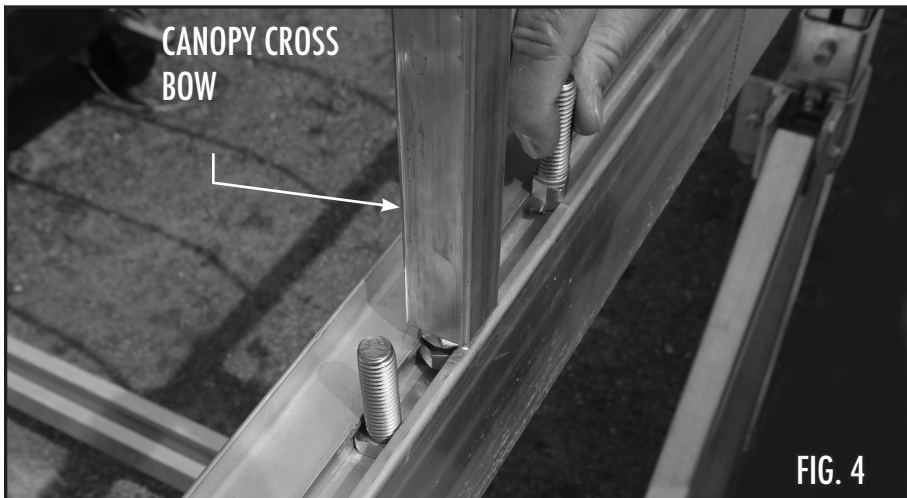
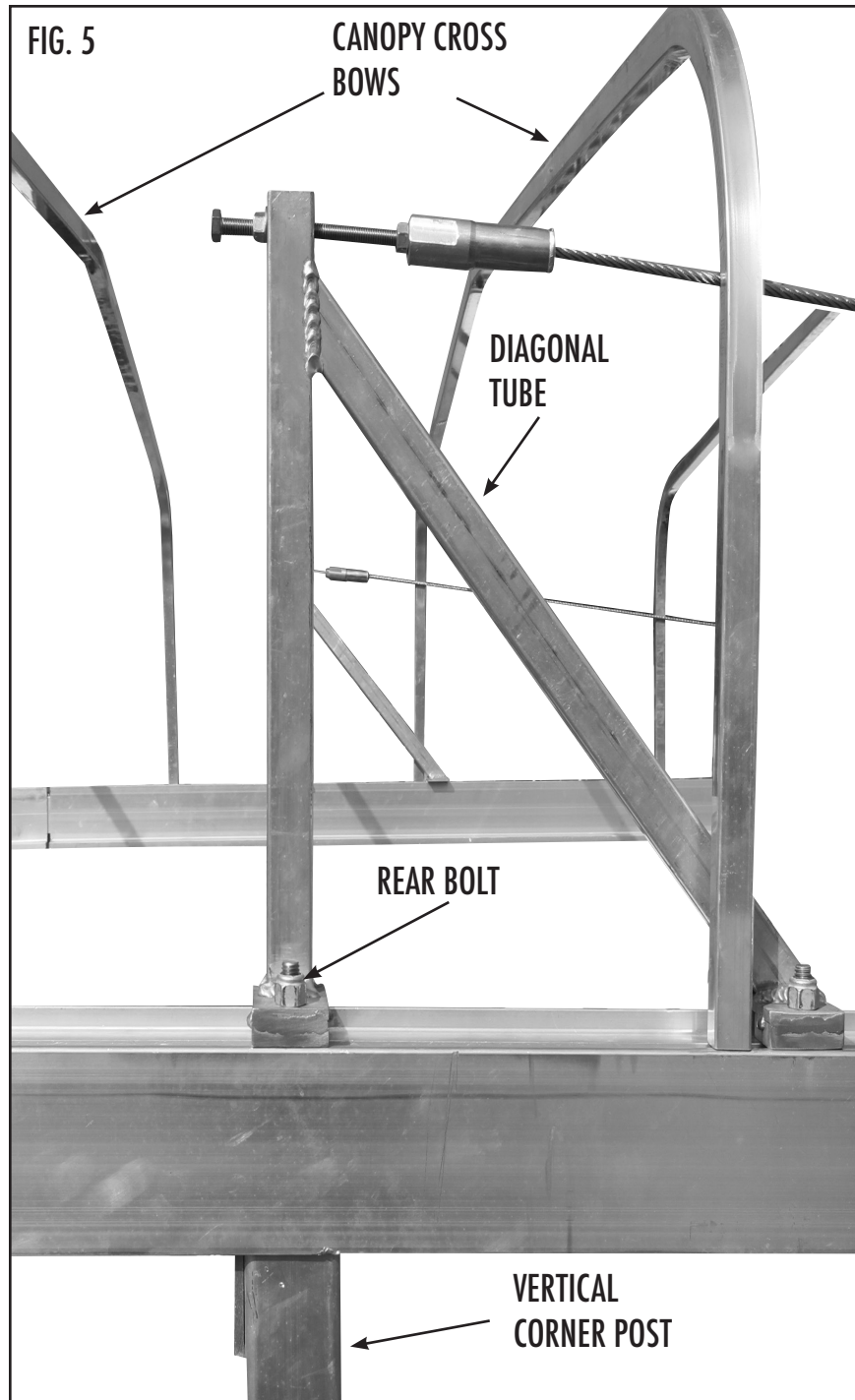

FIG. 4

# BRACKET INSTALLATION - PART 2



4. INSTALL THE RIGHT SIDE SUPPORT BRACKET ("SIDE A" ITEM# 7) OVER THE TWO SPECIAL BOLTS ENSURING THAT THE DIAGONAL PART OF THE BRACKET IS FACING FORWARD ON THE LIFT - **FIGURE 5**. ENSURE THAT THE REAR BOLT IS LOCATED ABOVE THE VERTICAL CORNER POST AS SHOWN - IT DOES NOT HAVE TO BE DIRECTLY ABOVE, ONLY NEAR. REFER TO STEP 17 FOR CANOPIES 30' AND LONGER

5. INSTALL A 1/2" NYLOCK HEX NUT (ITEM #4) LOOSELY ONTO THE SPECIAL BOLTS - **FIGURE 6**.

6. ENSURING THAT THE VERTICAL TUBE ON THE SUPPORT BRACKET IS STILL LOCATED ABOVE THE VERTICAL CORNER POST, TIGHTEN BOTH OF THE NYLOCK HEX NUTS - **FIGURE 7**. TORQUE TO 60 FT/LBS.

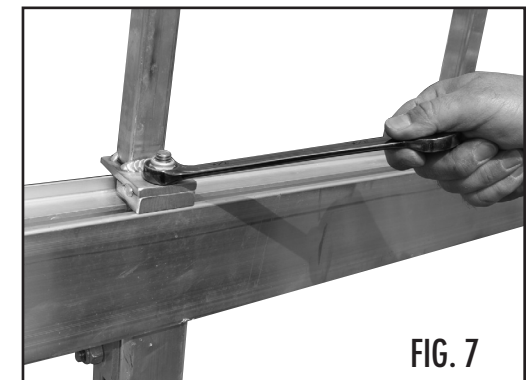
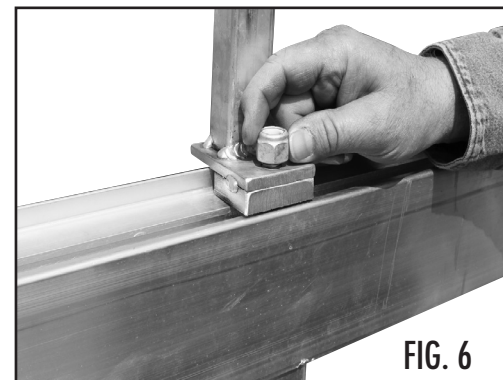

# CABLE INSTALLATION - PART 1

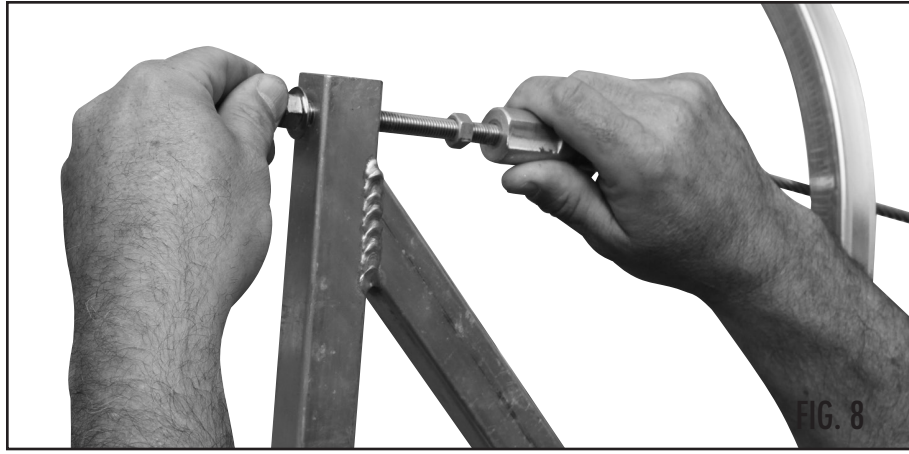

7. THREAD THE END OF THE ADJUSTMENT BOLT INTO THE THREADED CABLE END OF THE ADJUSTMENT CABLE (ITEM #6) UNTIL IT BOTTOMS OUT - **FIGURE 8.**

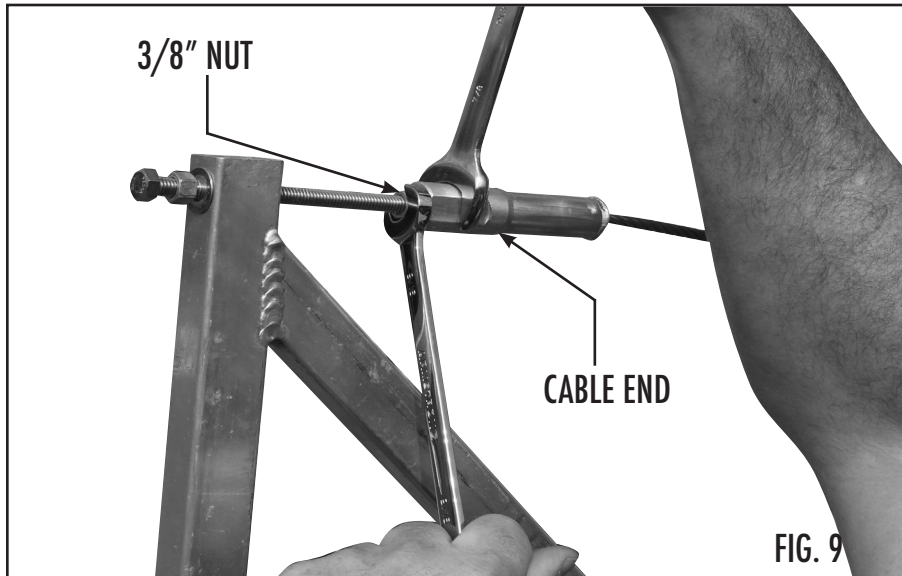

8. TIGHTEN THE 3/8" NUT AGAINST THE END OF THE CABLE END USING 9/16" & 7/8" WRENCHES TO HOLD THE CABLE WHILE TIGHTENING THE NUT - **FIGURE 9.**

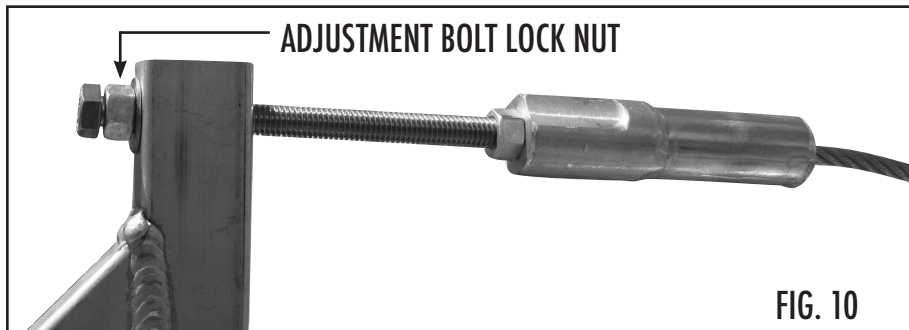

9. RUN THE 3/8" ADJUSTMENT BOLT LOCK NUT AS FAR BACK AS POSSIBLE TOWARDS THE HEAD OF THE ADJUSTMENT BOLT - **FIGURE 10.**



## CABLE INSTALLATION - PART 2

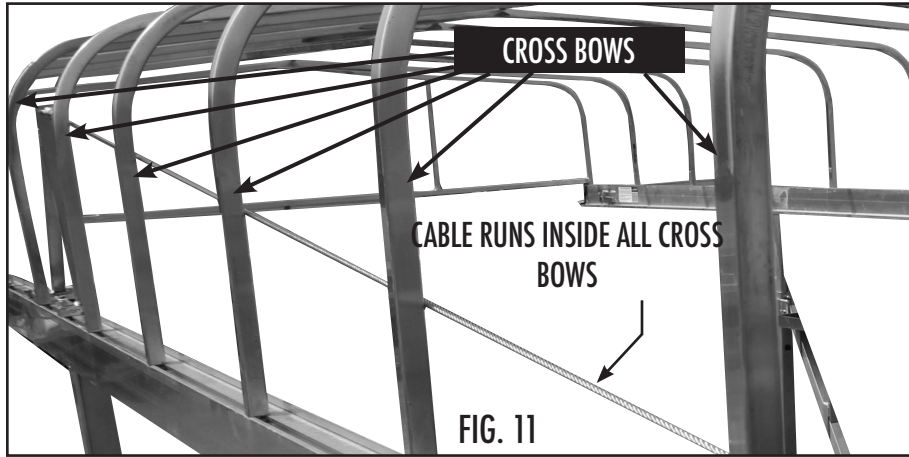

10. ROUTE THE ADJUSTMENT CABLE ON THE INSIDE OF THE CANOPY CROSS BOWS AS FAR FORWARD AS POSSIBLE - **FIGURE 11.**

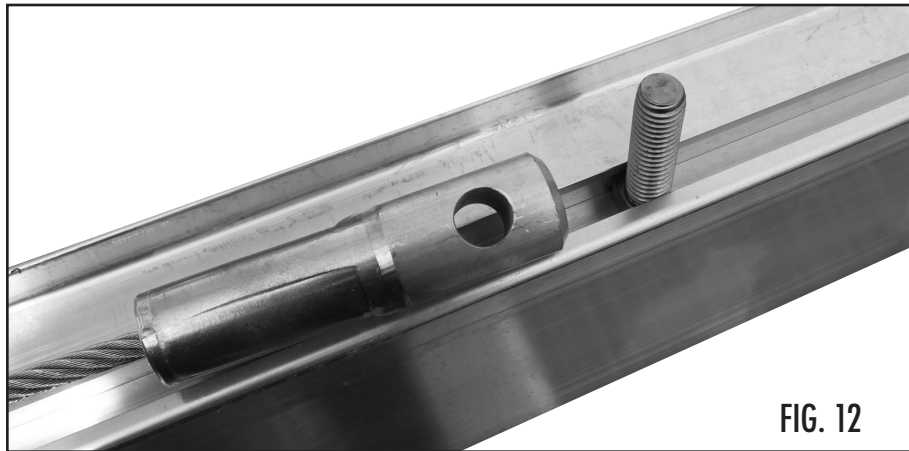

11. INSERT A SPECIAL BOLT INTO CANOPY CHANNEL NEAR THE END OF THE ADJUSTMENT CABLE AND ROTATE IT 90° TO LOCK IT INTO THE CANOPY CHANNEL - **FIGURE 12.**

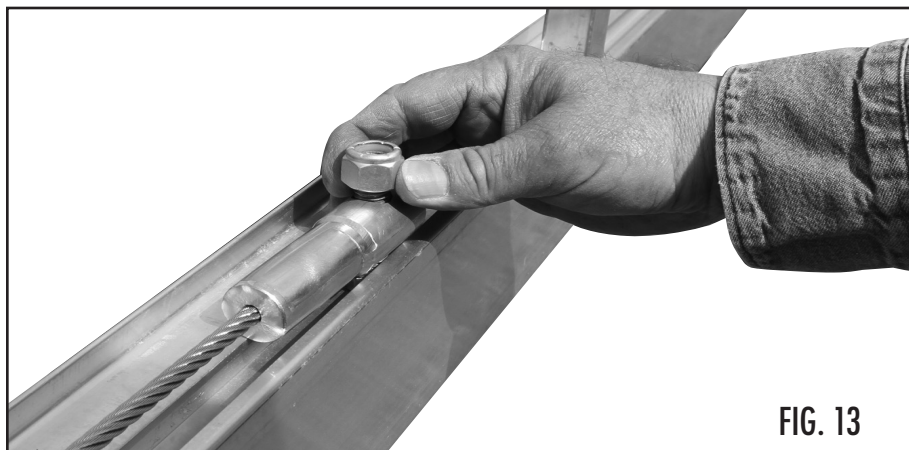

12. MAKING SURE THAT THERE ARE NO TWISTS IN THE ADJUSTMENT CABLE, INSTALL THE CABLE OVER THE SPECIAL BOLT AND INSTALL A 1/2" NYLOCK NUT ONTO THE BOLT - **FIGURE 13.**

## CABLE INSTALLATION - PART 3

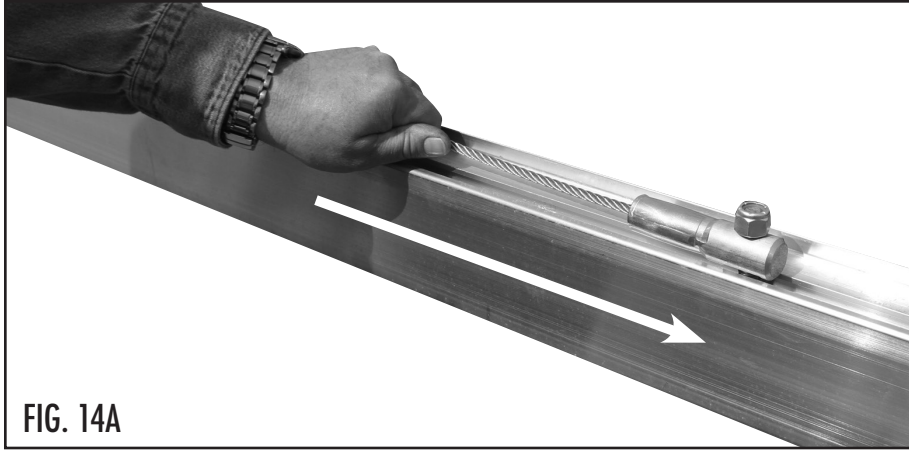

13. PULL THE ADJUSTMENT CABLE AS FAR FORWARD AS POSSIBLE AND TIGHTEN THE NYLOCK NUT ENSURING THE CABLE END IS PARALLEL WITH THE CANOPY CHANNEL - **FIGURE 14 A & B.** TORQUE TO 60 FT/LBS.



14. TIGHTEN THE CABLE BY HOLDING THE HEX END OF THE ADJUSTMENT BOLT WITH ONE 9/16 WRENCH WHILE TIGHTENING THE ADJUSTMENT BOLT LOCK NUT WITH A 9/16 OPEN END WRENCH - **FIGURE 15.**

# CABLE ADJUSTMENT



FIG. 16A

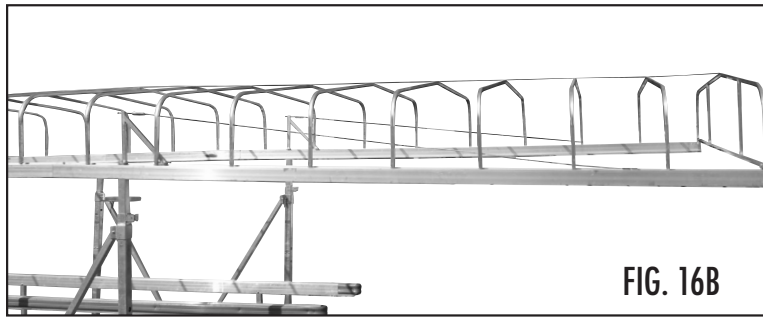

FIG. 16B

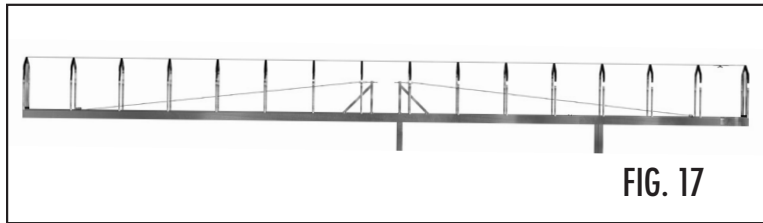

FIG. 17

15. TIGHTEN THE CABLE UNTIL THERE IS NO PERCEIVABLE DOWNWARD BOW IN THE CANOPY BEAM - **FIGURE 16 A & B.**

*NOTE: IF YOU RUN OUT OF ADJUSTMENT THREAD WHILE TIGHTENING THE CABLE, BACK OFF THE ADJUSTMENT SCREW ALL THE WAY (AS SHOWN IN FIGURE 11) AND MOVE THE FORWARD END OF THE CABLE FURTHER FORWARD. RETIGHTEN AND MAKE ADJUSTMENTS ACCORDING TO THE PREVIOUS STEPS.*

16. DO NOT OVER-TIGHTEN THE CABLE.

17. FOR CANOPIES 30' AND LONGER, POSITION THE SIDE SUPPORT BRACKETS IN THE CENTER OF THE CANOPY BEAM AND SO THAT THEY ARE CENTERED LENGTHWISE AS SHOWN.

REFER TO STEPS 1 THROUGH 16 ON INSTALLATION OF THE SIDE SUPPORT BRACKETS AND CABLES. ADJUSTMENTS TO THE POSITION OF THESE COMPONENTS MAY BE NECESSARY TO ACHIEVE PROPER FRAME ADJUSTMENT.

- REPEAT STEPS 1 THROUGH 16 TO INSTALL THE ADJUSTMENT BRACKET AND CABLE ON THE OPPOSITE SIDE OF THE CANOPY FRAME. (FOR CANOPIES 30' AND LONGER, REPEAT FOR THE REMAINING THREE ADJUSTMENT BRACKETS AND CABLES)
- AFTER INSTALLATION, CHECK THE CABLE PERIODICALLY TO ENSURE THAT IT IS STILL TIGHT AND THAT ALL HARDWARE IS SECURE.
- RE-ADJUST AND RE-TIGHTEN IF NECESSARY.



**Want the best? Go with the FLOE!**

FLOE INTERNATIONAL, INC.  
48473 STATE HIGHWAY 65 • MCGREGOR, MN 55760  
218-426-3563  
WWW.FLOEINTL.COM

*All material copyright © 2023 FLOE International, Inc. Unauthorized reproduction is strictly prohibited.  
Specifications subject to change without notice.*