

FLOE BOW FLEX INDICATOR

LIFT MOUNTED – STANDARD AND PONTOON LIFTS

ASSEMBLY INSTRUCTIONS

KIT P/N 511-02660-01, 511-02662-01

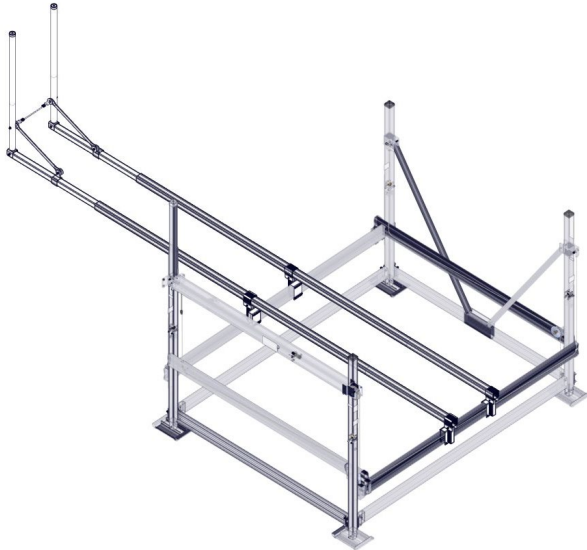

VSD3800-5000 PONTOON

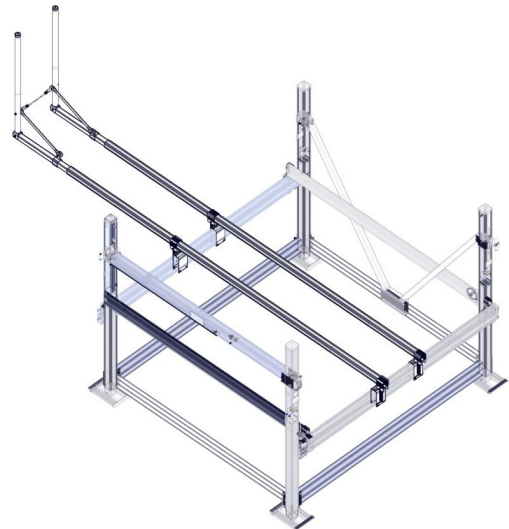

VSD6500-10,000 STANDARD

* LIFTS NOT INCLUDED

TOOLS REQUIRED

- (2) 9/16" SOCKETS/WRENCHES
- (2) 3/4" SOCKETS/WRENCHES
- TAPE MEASURE
- TORQUE WRENCH

IMPORTANT NOTE:

THE BOW FLEX INDICATOR IS **NOT** A BOW STOP. CAUTION MUST BE USED WHEN PARKING A BOAT WITH THIS KIT INSTALLED. BOATS SHOULD BE DRIFTED INTO FINAL POSITION ON BOAT LIFT. FAILURE TO DO SO WILL RESULT IN DAMAGE TO BOAT, BOAT LIFT, AND/OR LIFT ACCESSORIES.

BILL OF MATERIALS

511-02660-01 INDICATOR, LIFT MOUNTED BOW FLEX 3.8-5K

P/N 211-02660-01	KIT, TELESCOPING BOW FLEX TUBES (PAIR)		
<u>NO.</u>	<u>PART NUMBER</u>	<u>DESCRIPTION</u>	<u>QTY</u>
1	111-00511-01	ASS'Y, BOW FLEX TELESCOPING TUBES (SINGLE)	2

P/N 111-00511-01	ASS'Y, BOW FLEX TELESCOPING TUBES (SINGLE)		
<u>NO.</u>	<u>PART NUMBER</u>	<u>DESCRIPTION</u>	<u>QTY</u>
1A	001-70205-00	HHCS, 1/2-13 X 1" 18-8 SS	1
1B	002-00267-01	TUBE, LIFT BOW FLEX INNER	1
1C	111-01511-00	WELD'T, OUTER LIFT TUBE BOW FLEX	1

P/N 211-02661-01	KIT, CLAMPS BOW FLEX 3800-5K		
<u>NO.</u>	<u>PART NUMBER</u>	<u>DESCRIPTION</u>	<u>QTY</u>
2	002-00260-00	CLAMP, LOWER V-BRACE DEEP WATER 3.6-5K	4
3	010-00089-00	BUNGEE, 24" W/ MOLDED ENDS	2
4	111-00512-01	WELD'T, LIFT BOW FLEX LOWER BUNGEE MOUNT	2
5	111-00513-00	WELD'T, LIFT BOW FLEX TILT POST	2
6	111-00514-00	WELD'T, LIFT BOW FLEX MOUNT CLAMP 3.8-5K	4
7	511-92660-01	HARDWARE, LIFT BOW FLEX 3.6-5K	1

P/N 511-92660-01	HARDWARE, LIFT BOW FLEX 36-5K		
<u>NO.</u>	<u>PART NUMBER</u>	<u>DESCRIPTION</u>	<u>QTY</u>
7A	001-01562-00	EYE BOLT, 3/8-16 X 4" SHANK, 3/4" EYE	2
7B	001-70113-00	HHCS, 3/8-16 X 2-1/2" 18-8 SS	2
7C	001-70115-00	HHCS, 3/8-16 X 3" 18-8 SS	8
7D	001-70118-00	HHCS, 3/8-16 X 3-3/4" 18-8 SS	4
7E	001-70205-00	HHCS, 1/2-13 X 1" 18-8 SS	2
7F	001-70218-00	HHCS, 1/2-13 X 3-3/4" 18-8 SS	2
7G	001-71017-00	FLAT WASHER, 3/8" SAE SS 18-8	6
7H	001-76071-00	NUT, NYLOCK 3/8-16 ALUM.	8
7I	001-76072-00	NUT, NYLOCK 1/2-13 ALUM.	2
7J	001-76349-00	NUT, 3/8-16 ALUM.	8
7K	010-00092-00	WASHER, 2.5" OD, .406" ID	6
7L	010-00094-00	CAP, VINYL 2.375" ID X 1" SMALL HOLE	2
7M	010-00095-00	BUSHING, 1" OD, .5" ID - .875"	4
7N	111-00516-00	CABLE, LIFT BOW FLEX	1

P/N 211-02663-00	KIT, LIFT BOW FLEX PVC		
<u>NO.</u>	<u>PART NUMBER</u>	<u>DESCRIPTION</u>	<u>QTY</u>
8	011-01711-00	PIPE, 2" SCHED. 40 PVC - 74.875 W/ HOLE	2

EXPLODED VIEW

511-02660-01 INDICATOR, LIFT MOUNTED BOW FLEX 3.8-5K

NOTE:
ADDITIONAL VIEWS ARE
ON SHEET 4

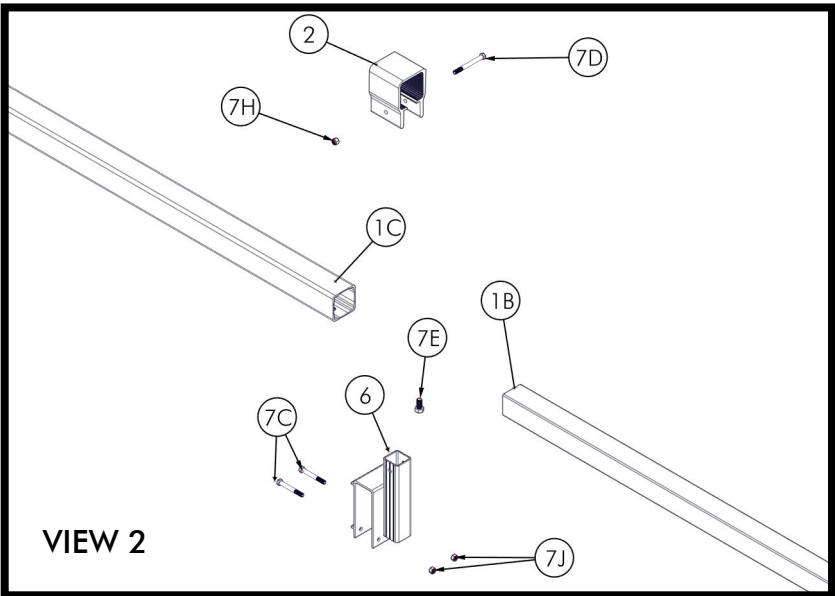
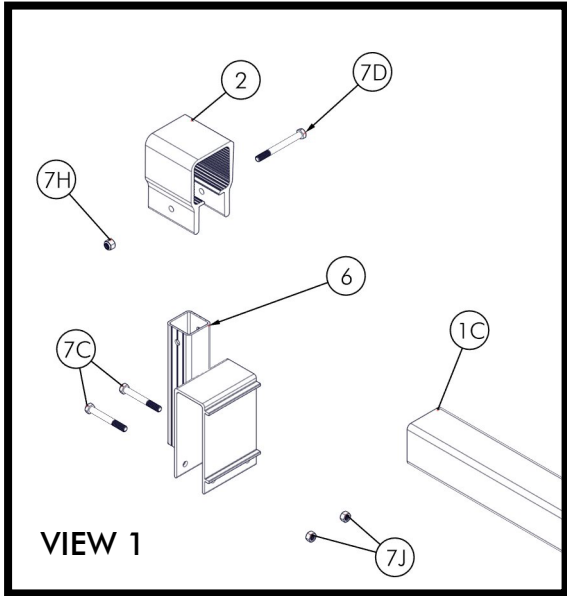
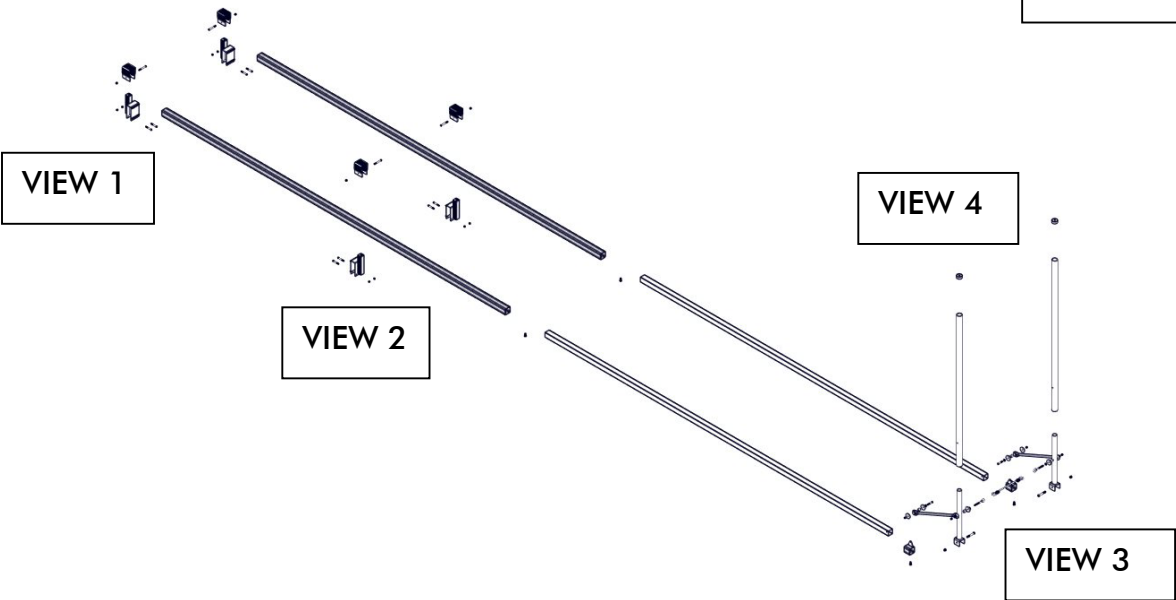

EXPLODED VIEW

511-02660-01 INDICATOR, LIFT MOUNTED BOW FLEX 3.8-5K

VIEW 3

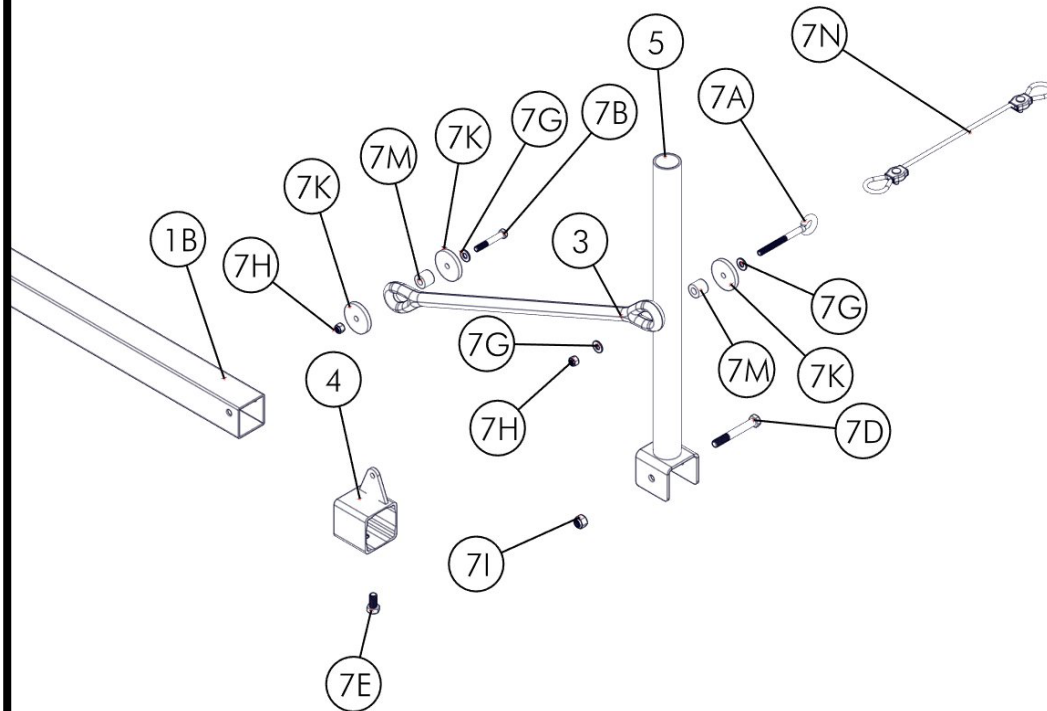

VIEW 4

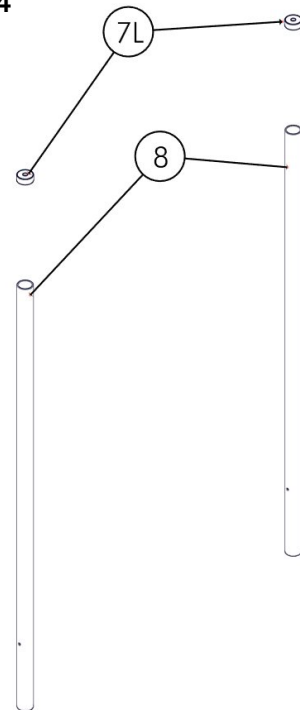

BILL OF MATERIALS

511-02662-01 INDICATOR, LIFT MOUNTED BOW FLEX 6-10K STD.

P/N 211-02660-01		KIT, TELESCOPING BOW FLEX TUBES (PAIR)	
<u>NO.</u>	<u>PART NUMBER</u>	<u>DESCRIPTION</u>	<u>QTY</u>
1	111-00511-01	ASS'Y, BOW FLEX TELESCOPING TUBES (SINGLE)	2

P/N 111-00511-01		ASS'Y, BOW FLEX TELESCOPING TUBES (SINGLE)	
<u>NO.</u>	<u>PART NUMBER</u>	<u>DESCRIPTION</u>	<u>QTY</u>
1A	001-70205-00	HHCS, 1/2-13 X 1" 18-8 SS	1
1B	002-00267-01	TUBE, LIFT BOW FLEX INNER	1
1C	111-01511-00	WELD'T, OUTER LIFT TUBE BOW FLEX	1

P/N 211-02662-01		KIT, CLAMPS BOW FLEX 6-10K STD.	
<u>NO.</u>	<u>PART NUMBER</u>	<u>DESCRIPTION</u>	<u>QTY</u>
2	002-00260-00	CLAMP, LOWER V-BRACE DEEP WATER 3.6-5K	4
3	002-04285-00	CLAMP, BUNK CRADLE (MALE)	4
4	010-00089-00	BUNGEE, 24" W/ MOLDED ENDS	2
5	111-00512-01	WELD'T, LIFT BOW FLEX LOWER BUNGEE MOUNT	2
6	111-00513-00	WELD'T, LIFT BOW FLEX TILT POST	2
7	111-00515-00	WELD'T, LIFT BOW FLEX MOUNT CLAMP 6-8K	4
8	511-92662-01	HARDWARE, LIFT BOW FLEX 6-8K	1

P/N 511-92662-01		HARDWARE, LIFT BOW FLEX 6-10K STD.	
<u>NO.</u>	<u>PART NUMBER</u>	<u>DESCRIPTION</u>	<u>QTY</u>
7A	001-01562-00	EYE BOLT, 3/8-16 X 4" SHANK, 3/4" EYE	2
7B	001-70113-00	HHCS, 3/8-16 X 2-1/2" 18-8 SS	2
7C	001-70118-00	HHCS, 3/8-16 X 3-3/4" 18-8 SS	4
7D	001-70119-00	HHCS, 3/8-16 X 4" 18-8 SS	8
7E	001-70205-00	HHCS, 1/2-13 X 1" 18-8 SS	2
7F	001-70218-00	HHCS, 1/2-13 X 3-3/4" 18-8 SS	2
7G	001-71017-00	FLAT WASHER, 3/8" SAE SS 18-8	6
7H	001-76071-00	NUT, NYLOCK 3/8-16 ALUM.	8
7I	001-76072-00	NUT, NYLOCK 1/2-13 ALUM.	2
7J	001-76349-00	NUT, 3/8-16 ALUM.	8
7K	010-00092-00	WASHER, 2.5" OD, .406" ID	6
7L	010-00094-00	CAP, VINYL 2.375" ID X 1" SMALL HOLE	2
7M	010-00095-00	BUSHING, 1" OD, .5" ID - .875"	4
7N	111-00516-00	CABLE, LIFT BOW FLEX	1

P/N 211-02663-00		KIT, LIFT BOW FLEX PVC	
<u>NO.</u>	<u>PART NUMBER</u>	<u>DESCRIPTION</u>	<u>QTY</u>
8	011-01711-00	PIPE, 2" SCHED. 40 PVC - 74.875 W/ HOLE	2

EXPLODED VIEW

511-02662-01 INDICATOR, LIFT MOUNTED BOW FLEX 6-10K STD.

NOTE:
ADDITIONAL VIEWS
ARE ON SHEET 7

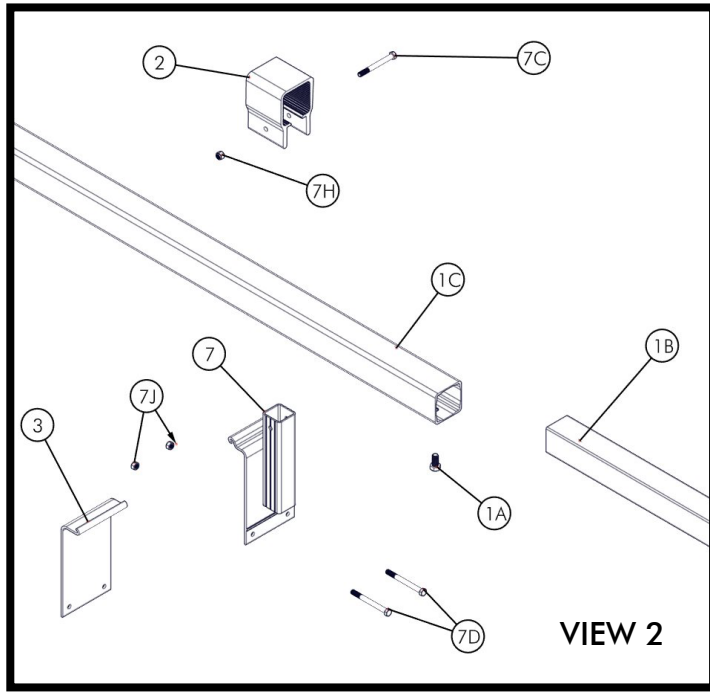
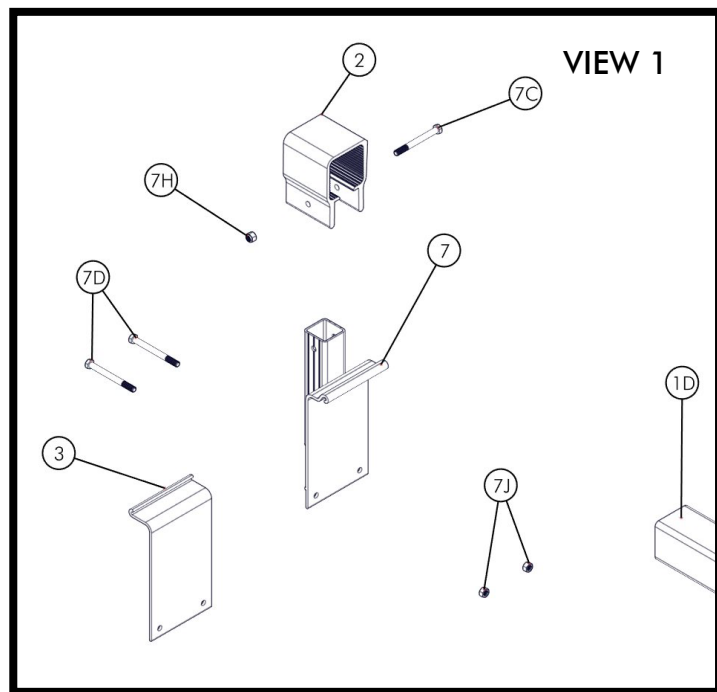
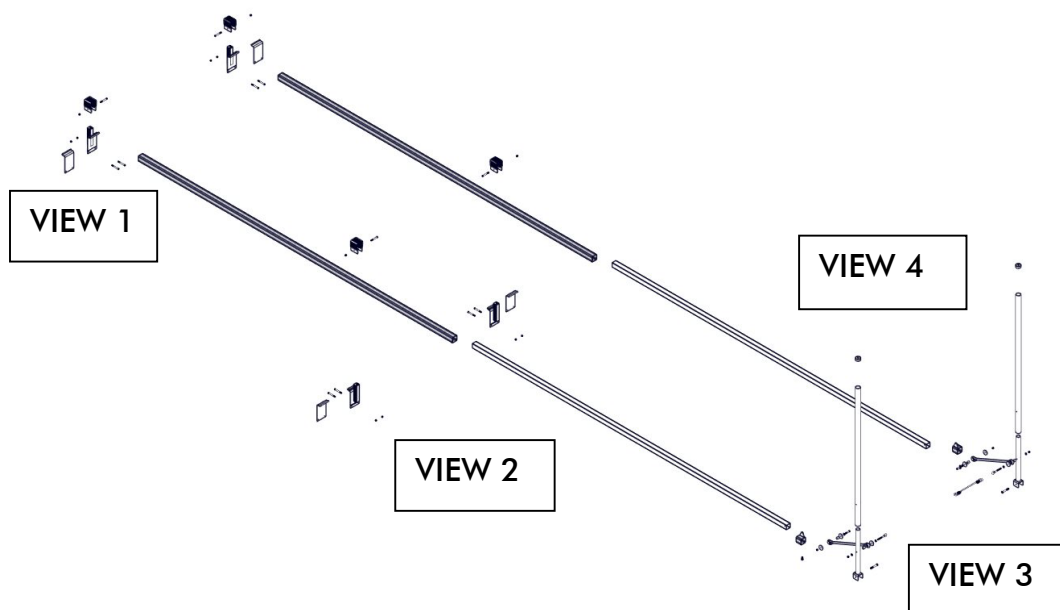

EXPLODED VIEW

511-02662-01 INDICATOR, LIFT MOUNTED BOW FLEX 6-10K STD.

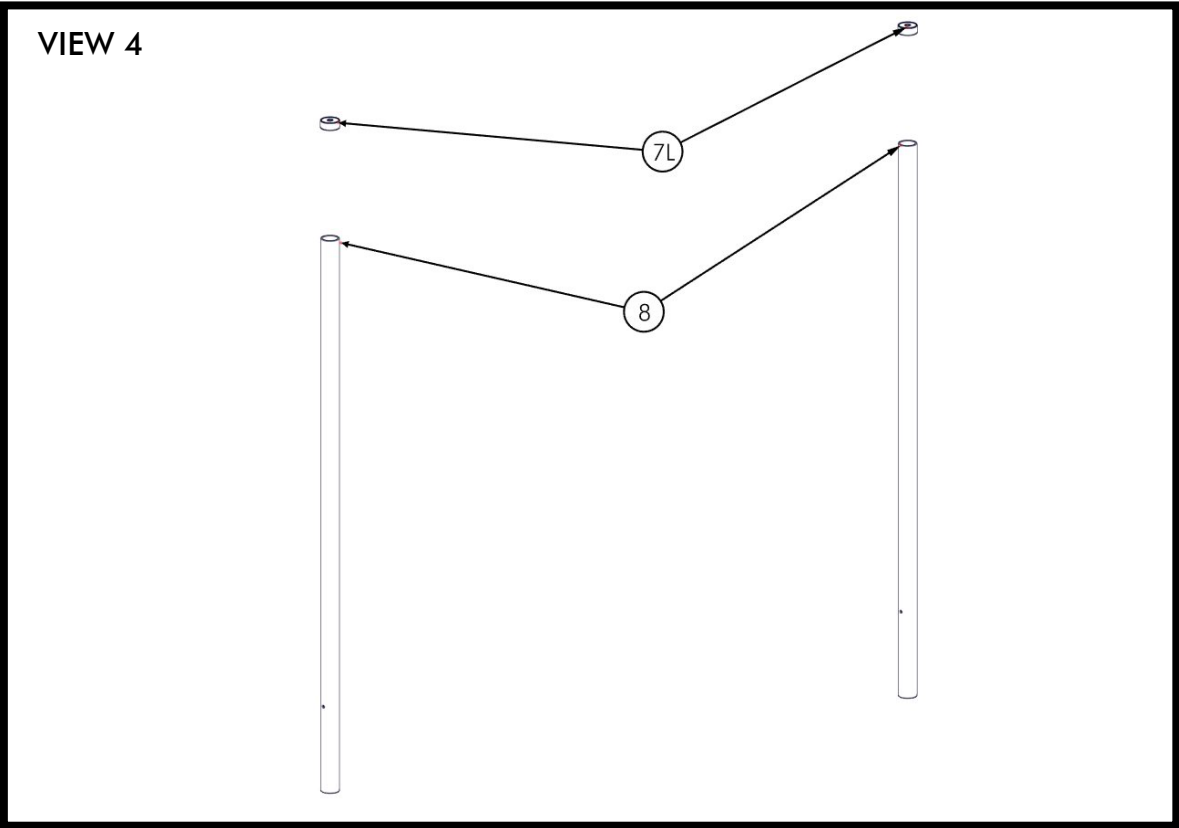
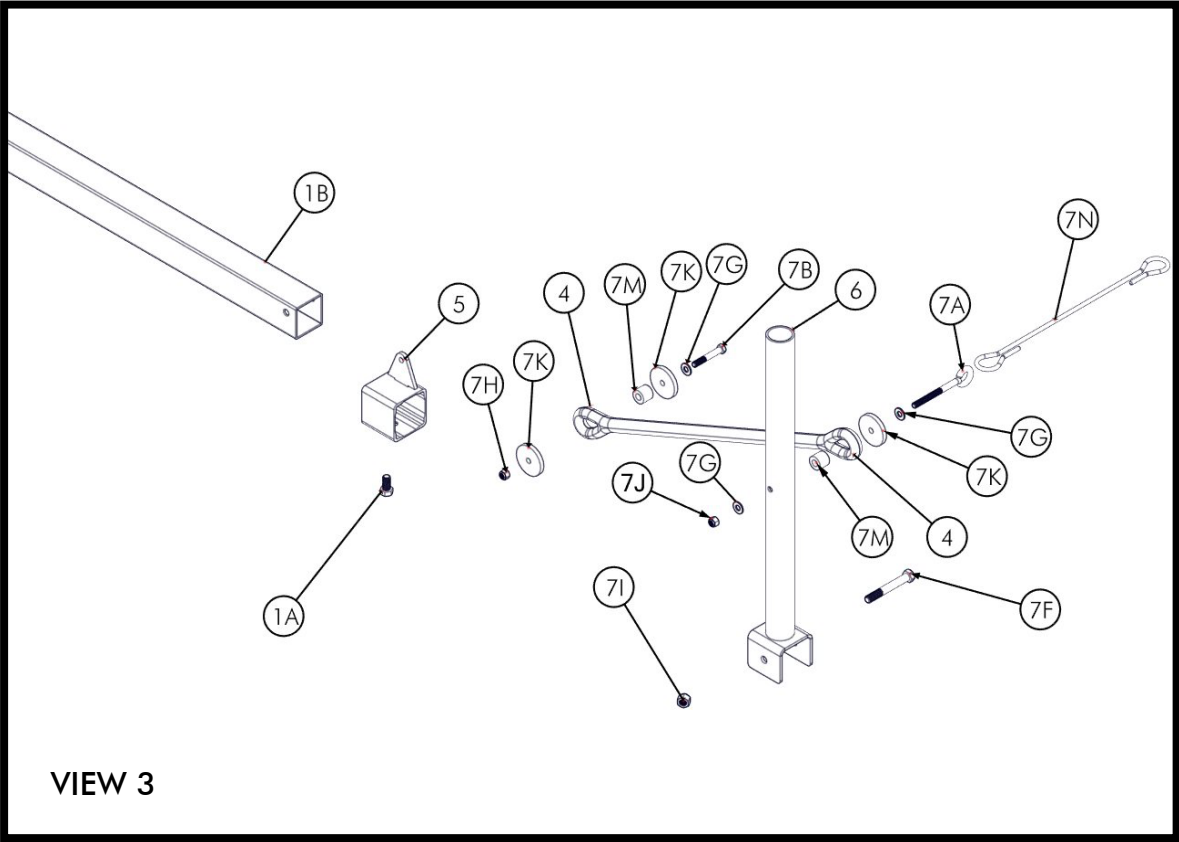

PRE-INSTALLATION

-UPRIGHT POSITIONING

THE BOW FLEX UPRIGHTS SHOULD BE POSITIONED TO FULLY ENGAGE THE BOW WHEN THE BOAT IS POSITIONED CORRECTLY ON THE LIFT. THE PVC UPRIGHTS WILL BE VERTICAL AND AT THE FRONT OF THE BOW WHEN THE BOAT IS PARKED.

THE PVC UPRIGHTS SHOULD NOT BE BENT FORWARD OR TOWARDS THE SIDES OF THE HULL.

EXAMPLES OF DIFFERENT HULL DESIGNS ARE SHOWN BELOW WITH RECOMMENDED UPRIGHT PLACEMENTS.

SEE FOLLOWING PAGES ON HOW TO MEASURE FOR PLACEMENT.

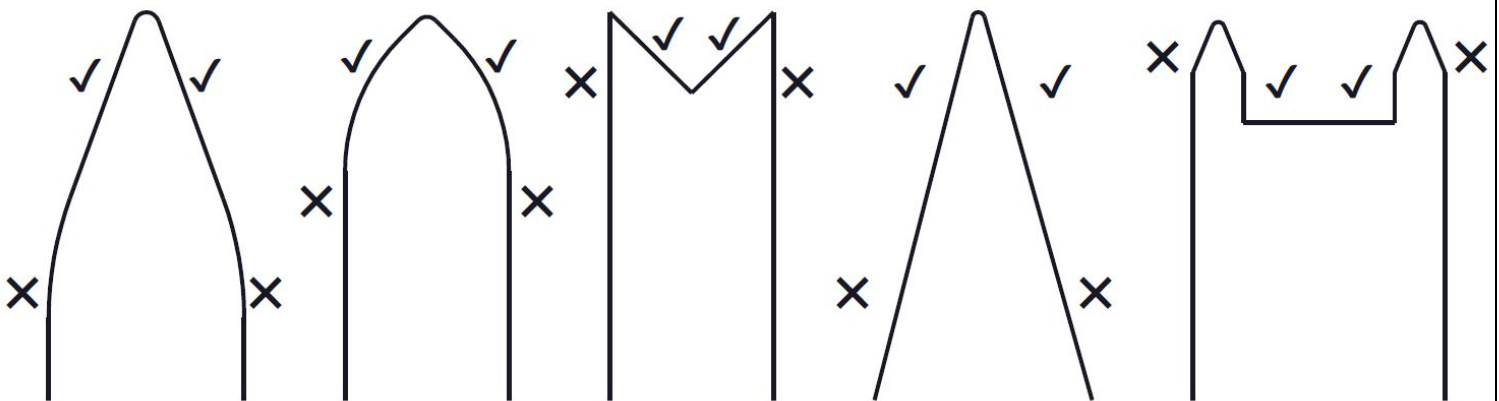

KEY

✓ CORRECT
X WRONG

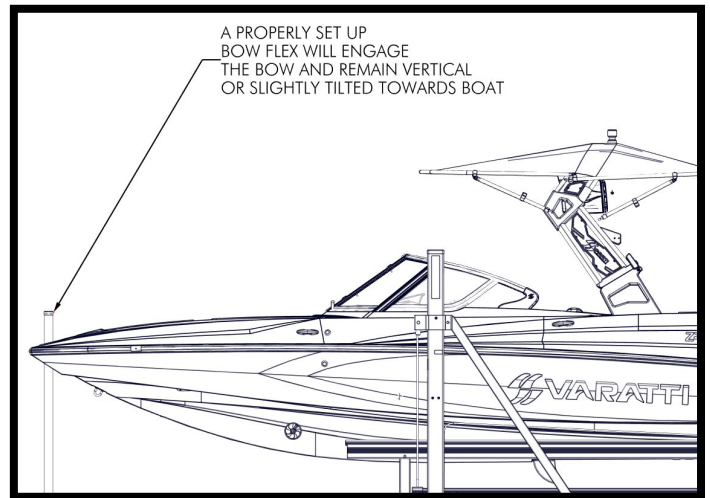
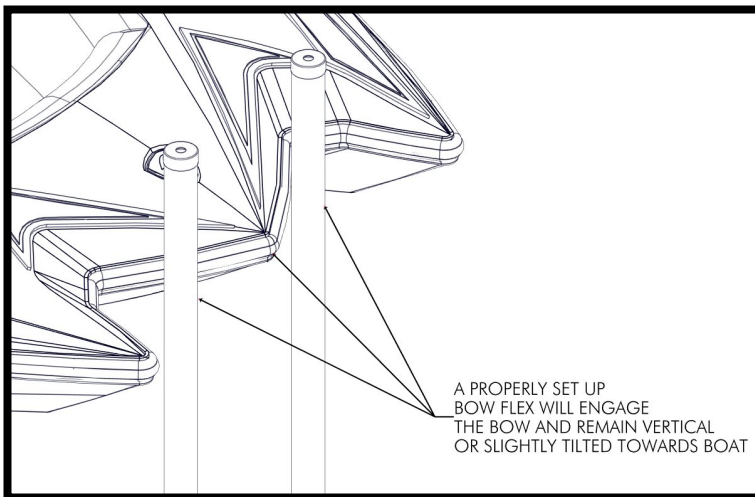

PRE-INSTALLATION

-DETERMINE LOCATION RELATIVE TO BOAT LIFT

BEFORE INSTALLING THE BOW FLEX POSITION INDICATOR, PARK THE BOAT ON THE BOAT LIFT. THEN, TAKE A MEASUREMENT FROM THE CORNER POST TO THE LOCATION ON THE BOW WHERE THE BOW FLEX UPRIGHTS SHOULD BE LOCATED. THE RECORDED MEASUREMENT WILL BE THE DISTANCE FROM THE FRONT CORNER POST OF THE LIFT TO THE LOCATION OF THE VERTICAL UPRIGHT.

THE PVC UPRIGHTS SHOULD NOT BE BENT FORWARD OR TOWARDS THE SIDES OF THE HULL.

MEASUREMENT SHOULD BE MADE FROM DOCK OR SIDE OF LIFT

DO NOT STAND UNDER BOAT/BOAT LIFT WHEN A BOAT IS ON THE LIFT

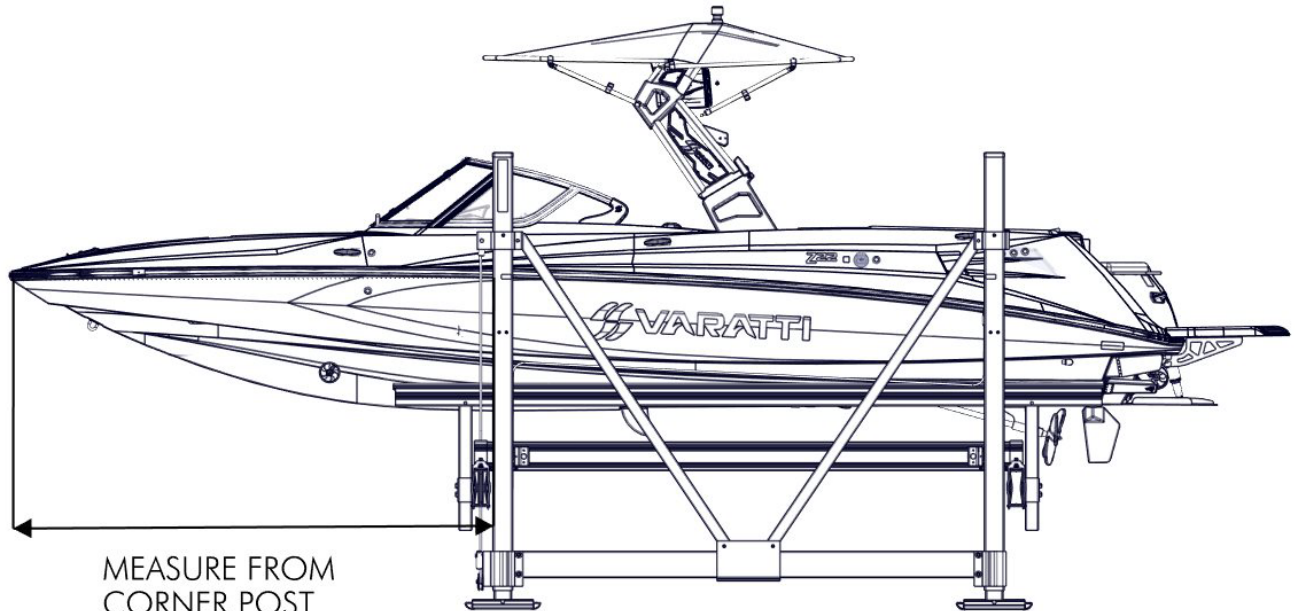

MEASURE FROM
CORNER POST
TO PROPER UPRIGHT
POSITION ON BOW
(SEE EXAMPLES)

PARK BOAT ON LIFT TO DETERMINE
WHERE BOW FLEX POSITIONING
SYSTEM SHOULD BE PLACED

PRE-INSTALLATION

-DETERMINE LOCATION OF UPRIGHTS

TAKE A MEASUREMENT BETWEEN THE TWO APPROXIMATE LOCATIONS SHOWN IN THE EXAMPLE BELOW. POSITION WILL VARY, BUT THE PVC UPRIGHTS SHOULD NOT BE BENT FORWARD OR TOWARDS THE SIDES OF THE HULL. THEY MUST REMAIN UPRIGHT.

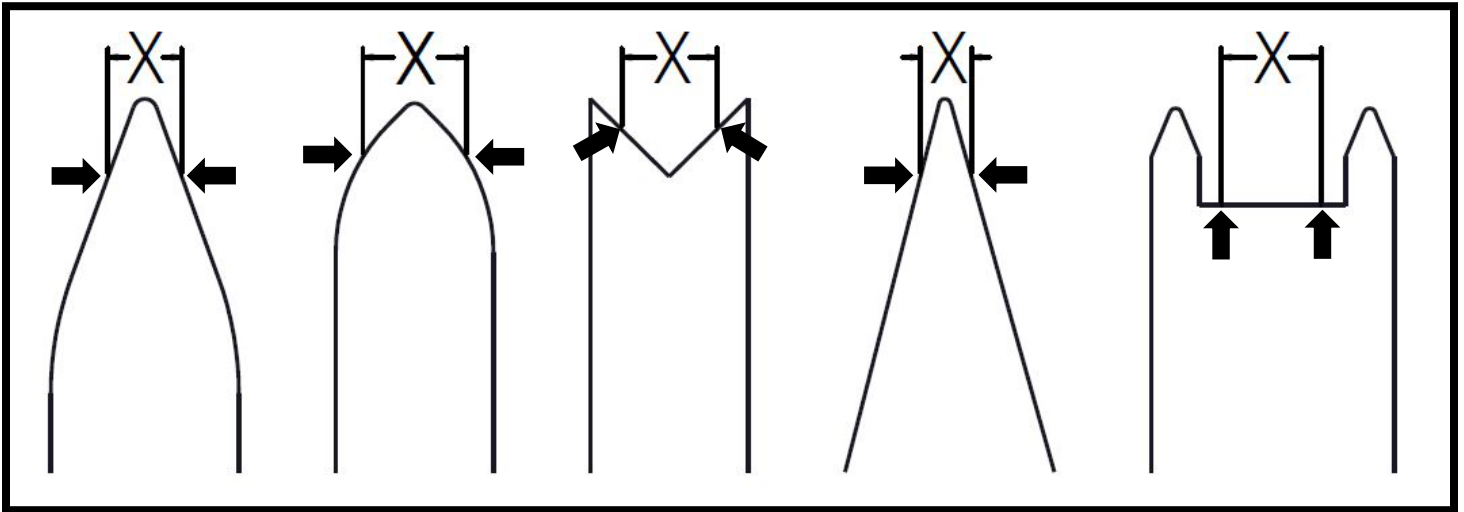

ASSEMBLY

SLIDE UPRIGHT CLAMPS ONTO CRADLE BEAM (FIGURE 1.1). FOR LARGE LIFTS, SLIDE CLAMPS TOGETHER, AND ONTO CRADLE BEAM (FIGURES 1.2 & 1.3).

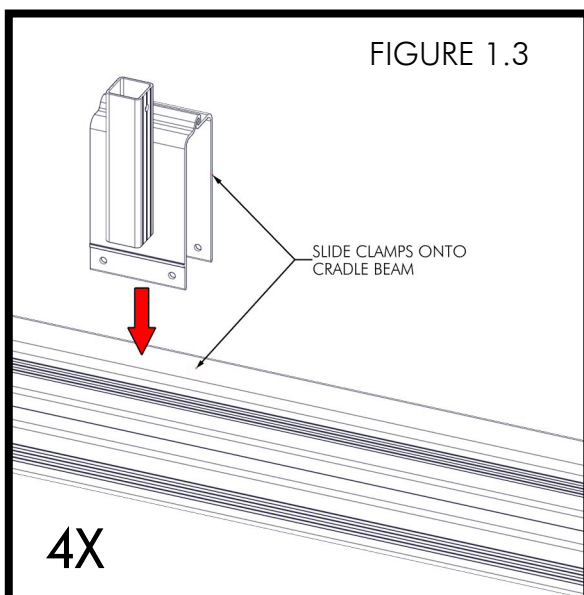
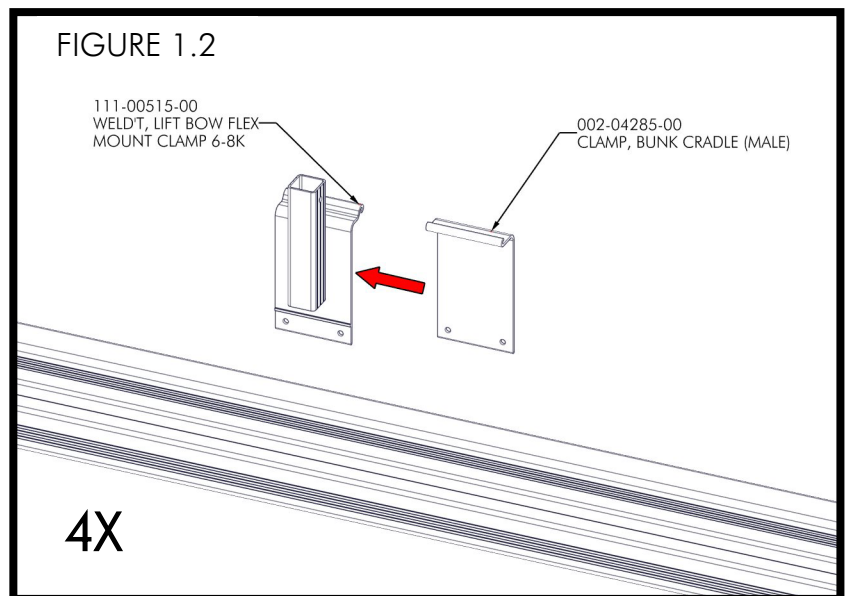
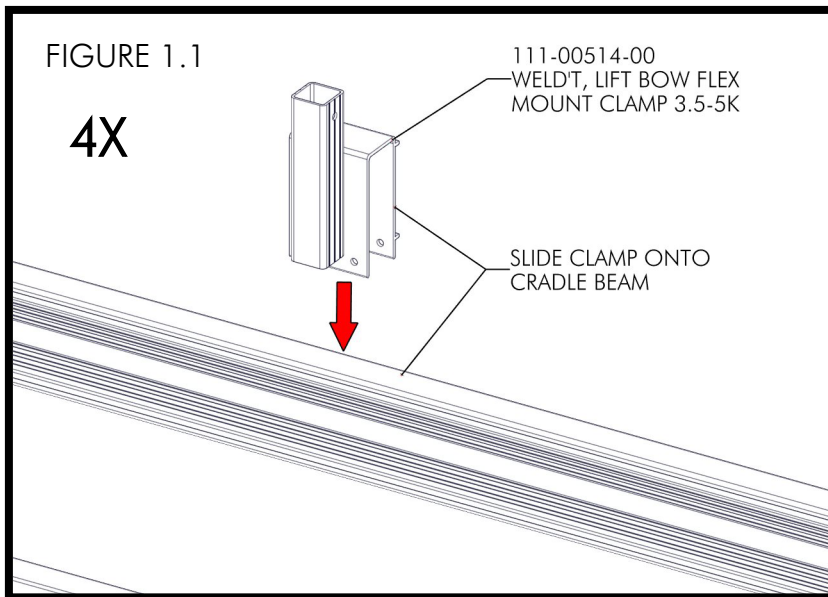

ATTACH CLAMPS TO CRADLE BEAM. FOR SMALL LIFTS, USE (2) 3/8" X 3" BOLTS AND (2) 3/8" NUTS (FIGURE 1.4). FOR LARGE LIFTS, USE (2) 3/8" X 4" BOLTS AND (2) 3/8" NUTS (FIGURE 1.4A). DO NOT TORQUE.

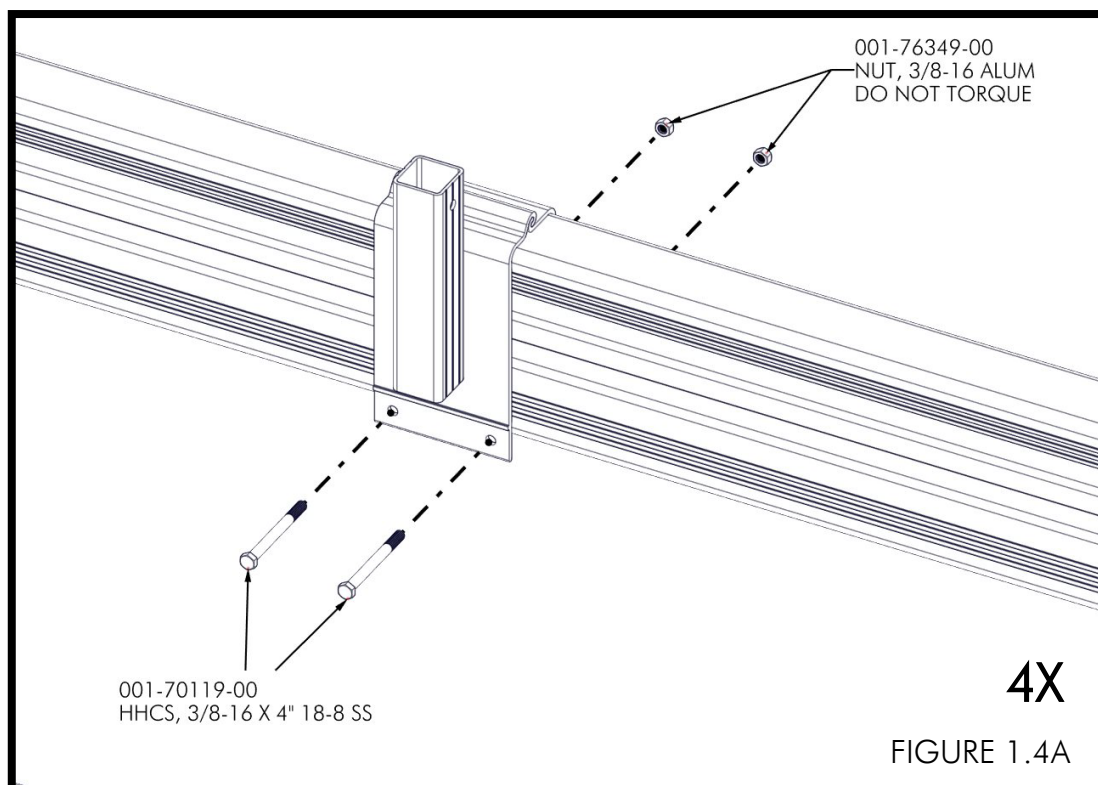
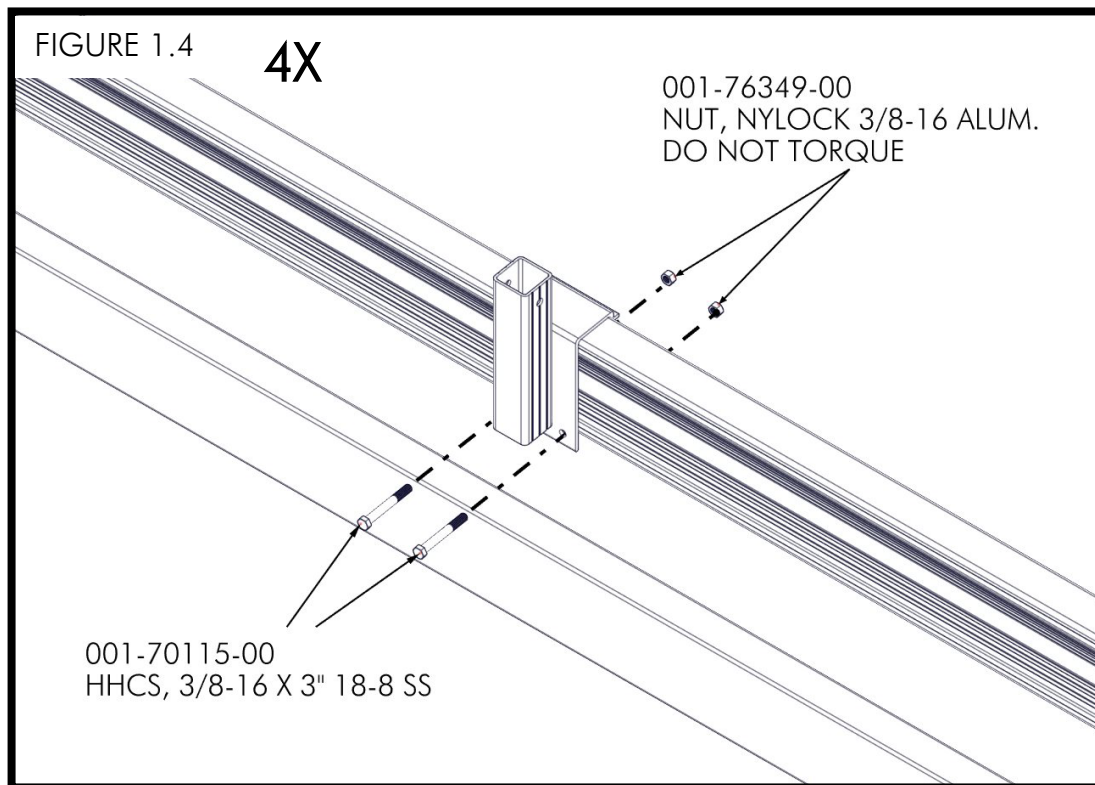

FOR PLACEMENT, FIRST FIND THE CENTER OF THE CRADLE BEAMS. THEN, USE THE UPRIGHT LOCATION MEASUREMENT FROM THE PRE-INSTALLATION INSTRUCTIONS. THIS DIMENSION IS USED FOR THE CENTER TO CENTER DISTANCE BETWEEN THE UPRIGHT TUBES. SPACE THE UPRIGHT CLAMPS EVENLY ON THE CRADLE BEAM BETWEEN THE CORNER POSTS. TORQUE NUTS TO 35 FT-LBS (FIGURE 1.5).

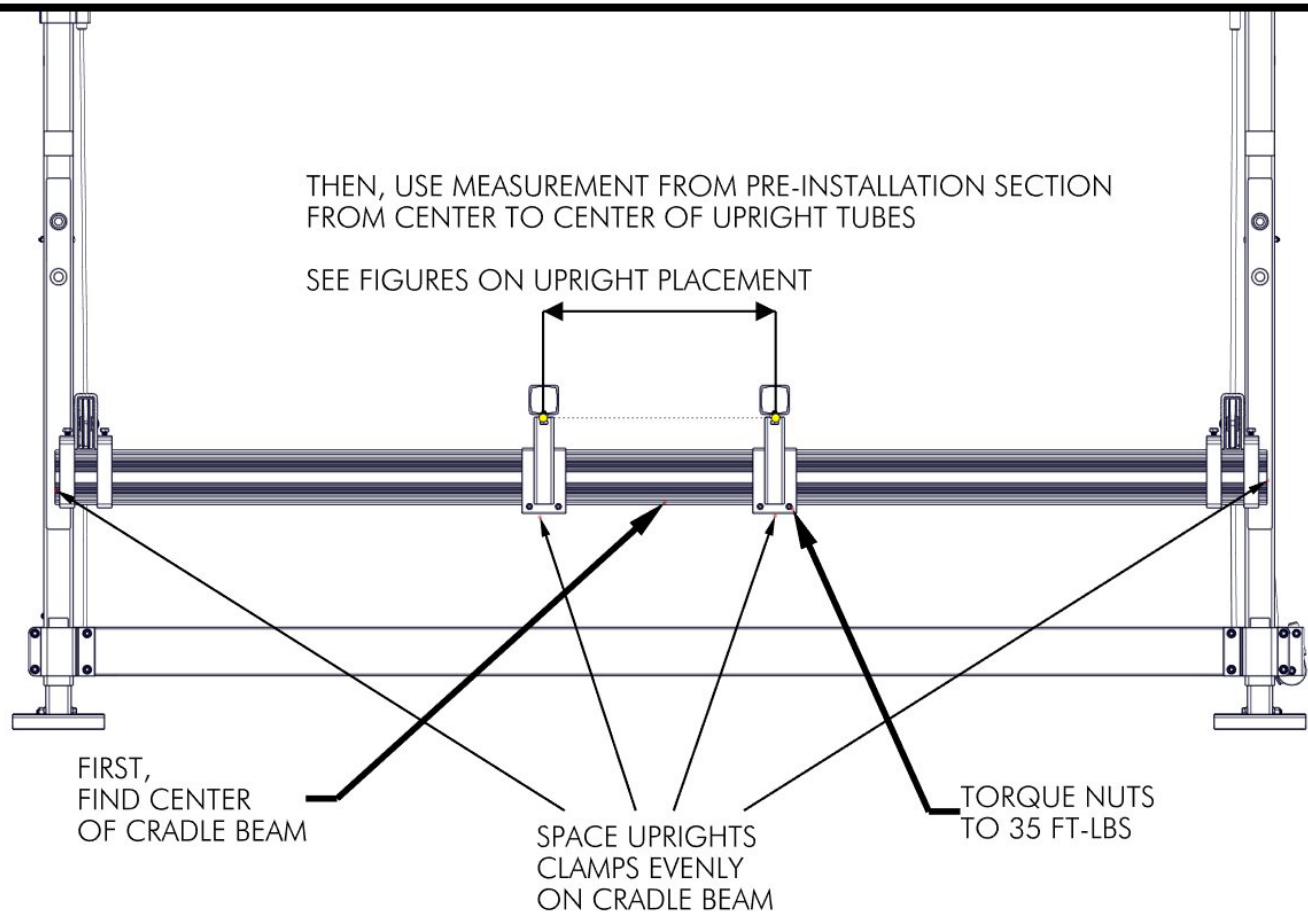
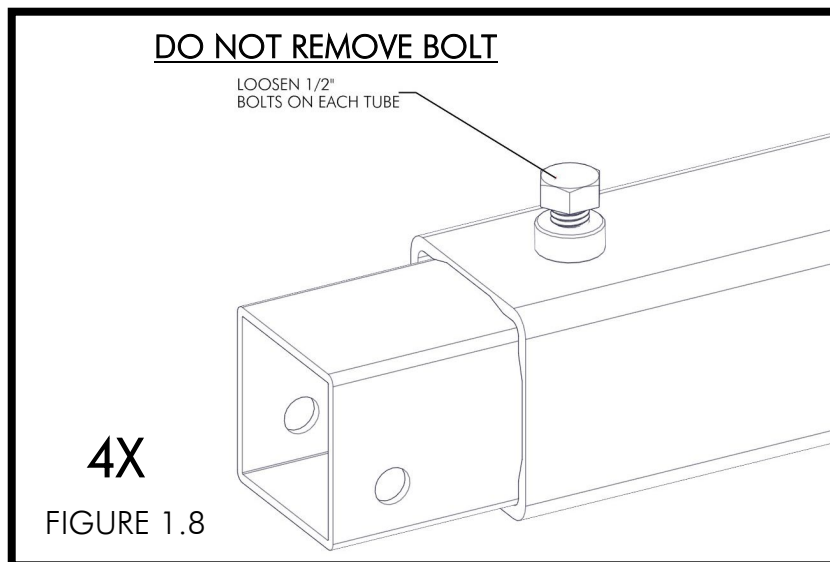
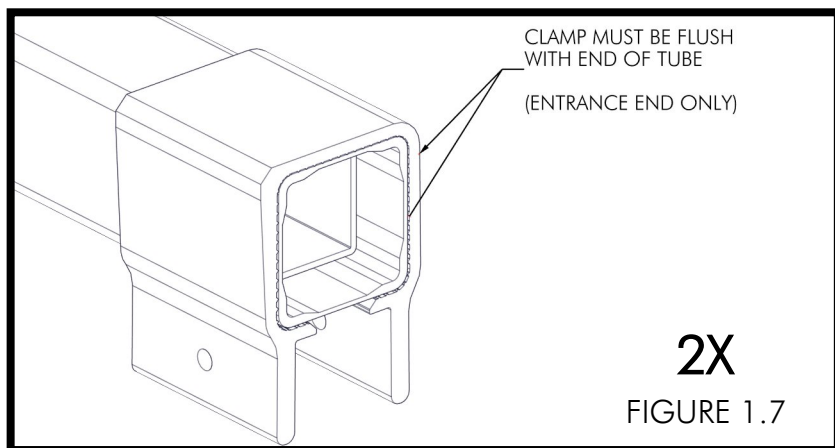
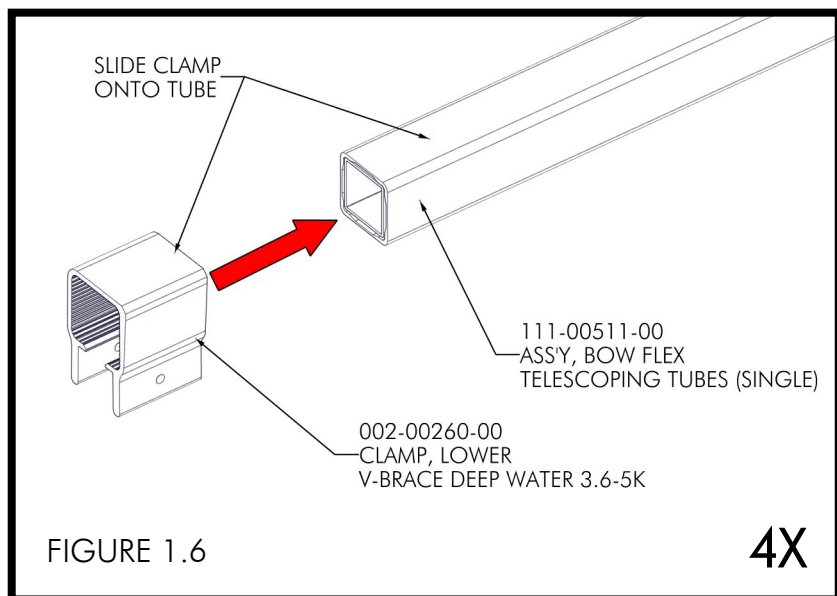

FIGURE 1.5

SLIDE CLAMPS FOR MOUNTING ONTO THE TELESCOPING TUBES (FIGURE 1.6). FOR THE ENTRANCE END, THE CLAMP MUST BE FLUSH WITH THE END OF THE TELESCOPING TUBES (END WITHOUT FASTENERS ATTACHING TUBES TOGETHER) (FIGURE 1.7). FLIP THE TUBES OVER AND LOOSEN THE 1/2" BOLTS ON THE TUBES, BUT DO NOT REMOVE (FIGURE 1.8).



SLIDE THE INNER TUBES OUT OF THE OUTER TUBES (FIGURE 1.9). START (1) 1/2" X 1" BOLT PER MOUNT INTO THE WELDED ON NUTS ON THE LOWER BUNGEE MOUNT (FIGURE 1.10). SLIDE BUNGEE MOUNT WITH BOLT ONTO INNER TUBE (FIGURE 1.11).

FIGURE 1.9

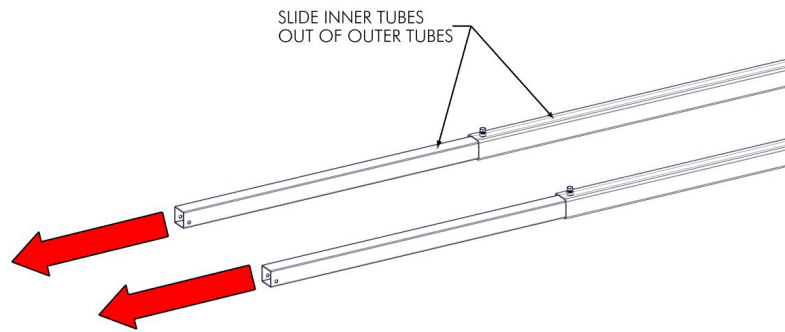

2X

001-70205-00
HHCS, 1/2-13 X 1" 18-8 SS

111-00512-00
WELD'T, LIFT BOW FLEX
LOWER BUNGEE MOUNT

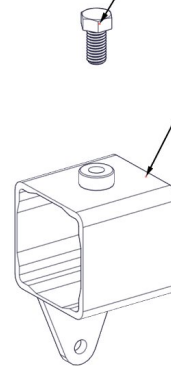
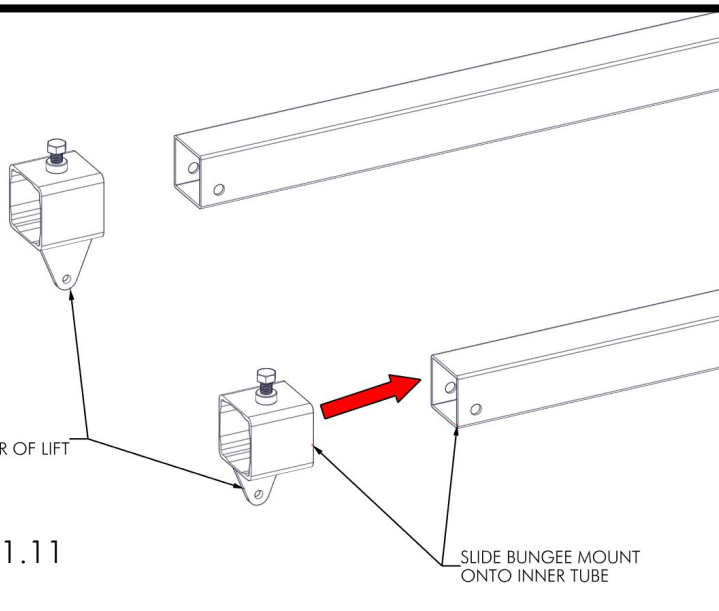

FIGURE 1.10

TAB IS BIASED
TOWARDS CENTER OF LIFT

FIGURE 1.11

SLIDE BUNGEE MOUNT
ONTO INNER TUBE



ATTACH MOUNT POCKET ONTO UPRIGHT ON CRADLE BEAM USING (1) 3/8" X 3-3/4" BOLT AND (1) 3/8" NYLOCK NUT (FIGURE 1.12). TORQUE TO 35 FT-LBS (FIGURE 1.13).

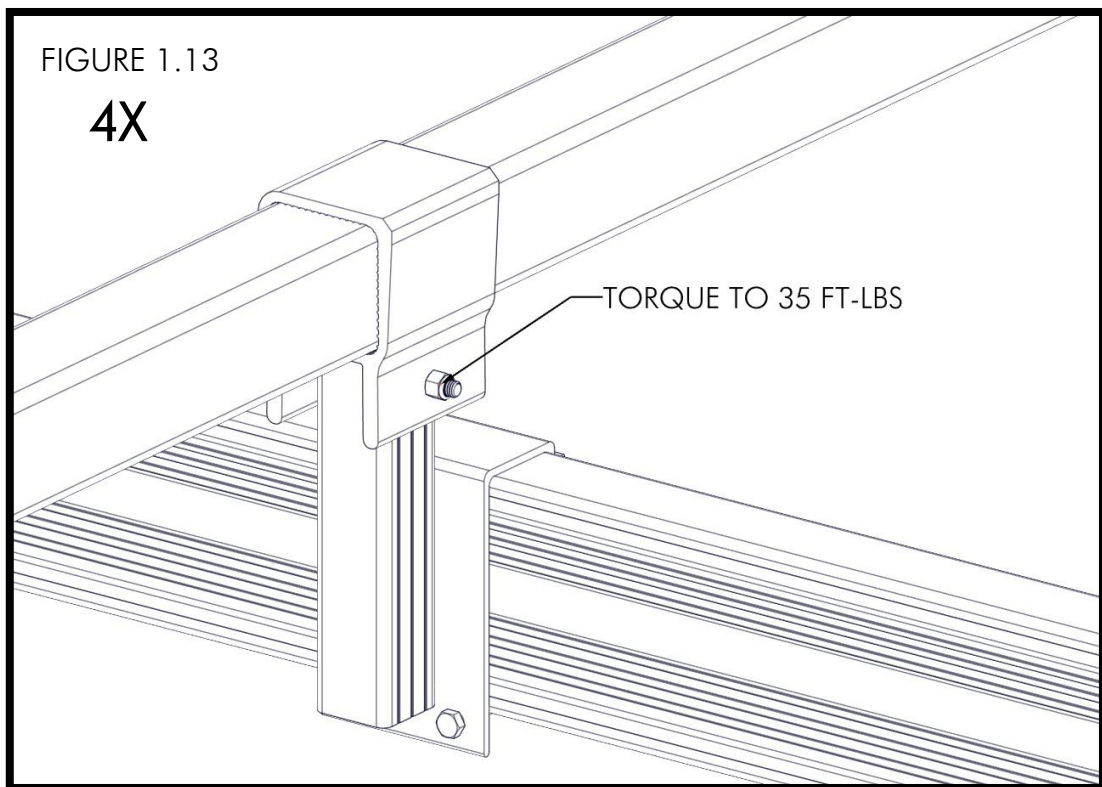
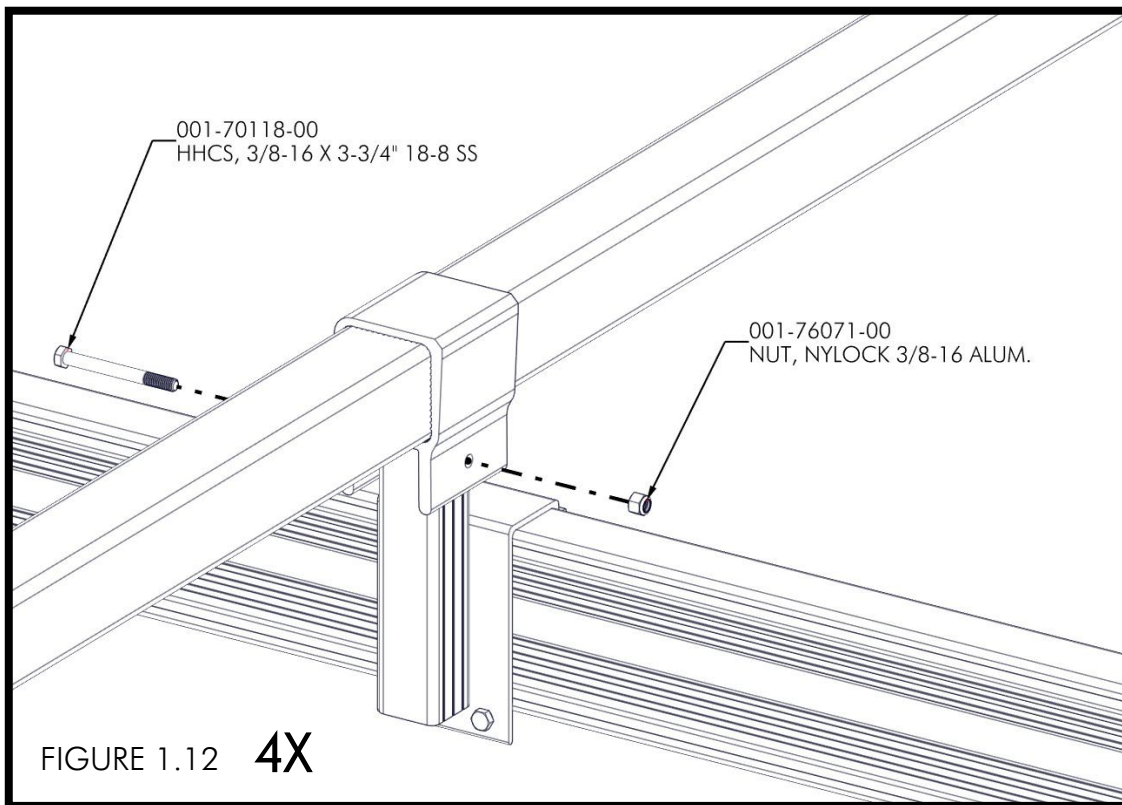

PLACE TILT POST UPRIGHT ONTO END OF INNER TUBE (FIGURE 1.14) AND ATTACH USING (1) 1/2" X 3-3/4" BOLT AND (1) 1/2" NYLOCK NUT (FIGURE 1.15). NOTE THAT BLOCK ON UPRIGHT FACES TOWARDS LIFT (FIGURE 1.15A). TIGHTEN TO REMOVE PLAY IN BOLT AND ENGAGE NYLOCK. UPRIGHT MUST BE ABLE TO MOVE FREELY (FIGURE 1.16).

FIGURE 1.14

2X

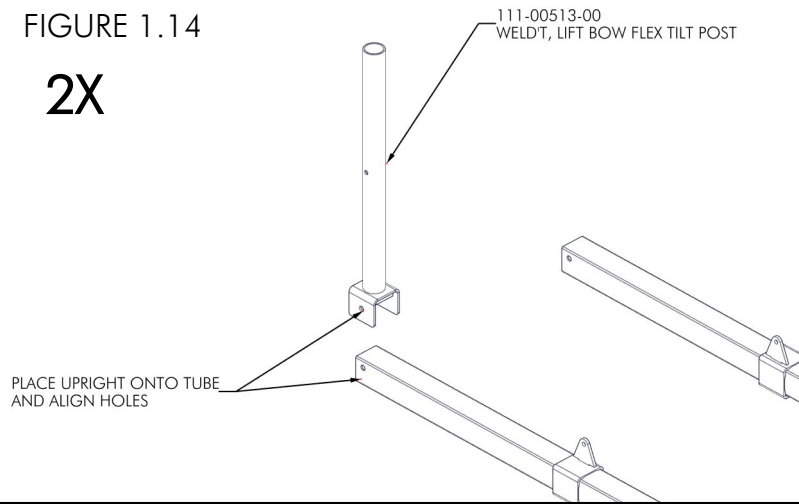

FIGURE 1.15

2X

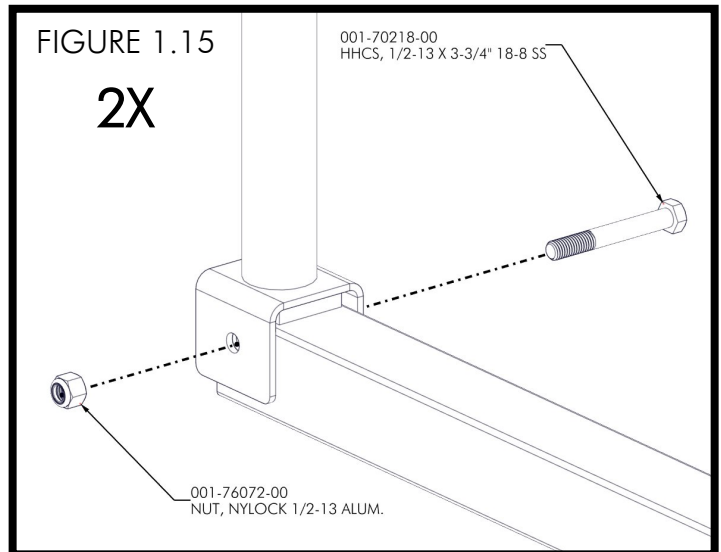

FIGURE 1.15A

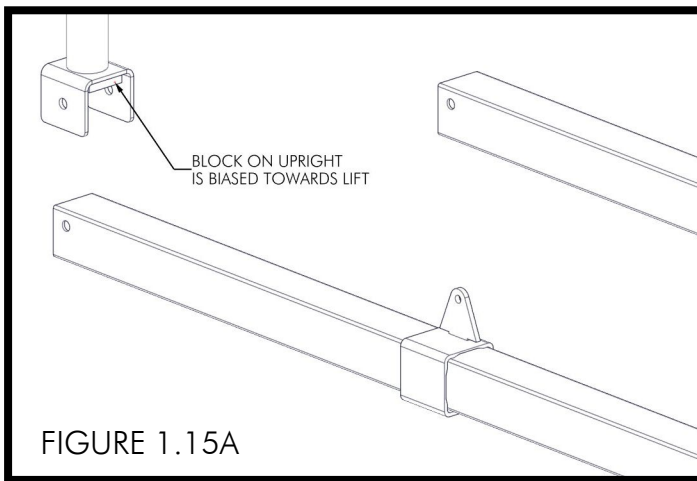
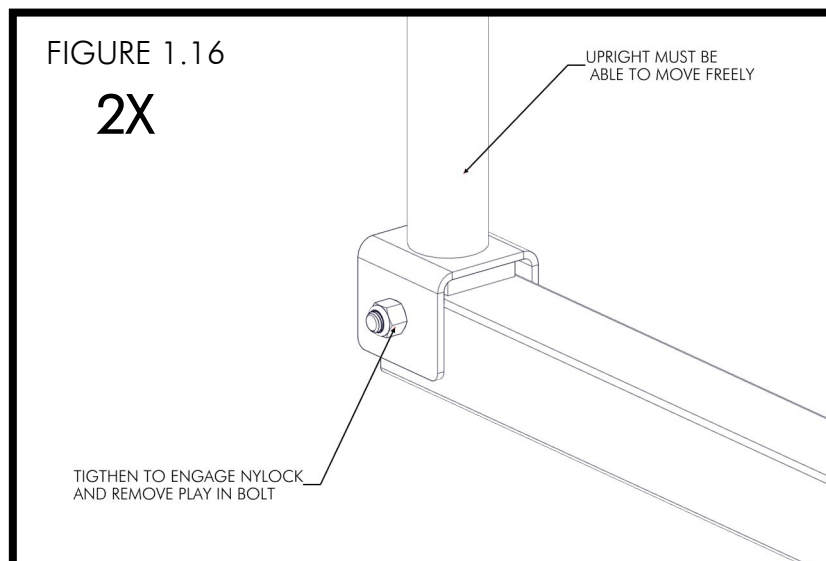
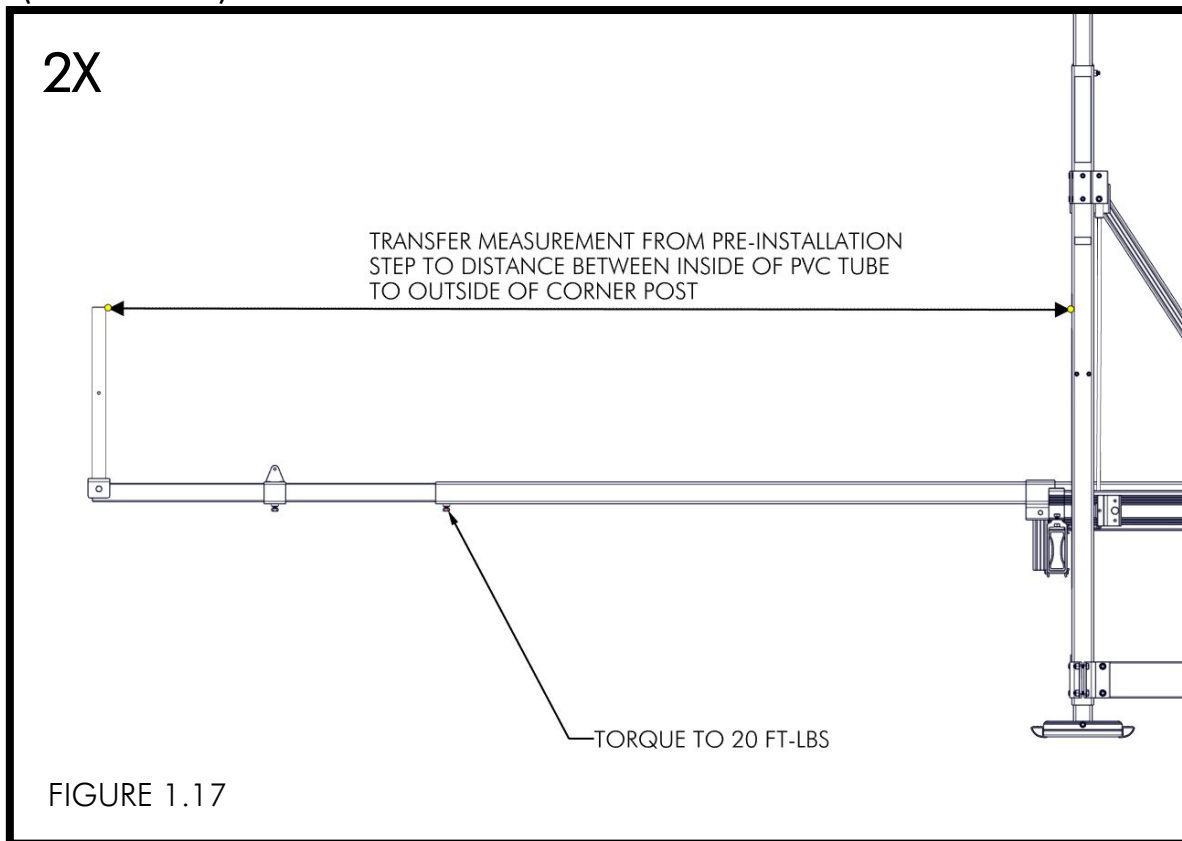

FIGURE 1.16

2X



USE THE MEASUREMENT TAKEN FROM THE PRE-INSTALLATION STEP TO SET THE DISTANCE BETWEEN THE INSIDE OF THE UPRIGHT AND OUTSIDE OF THE CORNER POST. TORQUE 1/2" BOLTS TO 20 FT-LBS (FIGURE 1.17). PLACE VINYL CAP ONTO PVC TUBE, THEN TUBE ONTO UPRIGHT (FIGURE 1.18).



NOTE:

PVC TUBES MAY HAVE TO BE CUT TO LENGTH TO PREVENT INTERFERENCE WITH TILTED MAXIS CANOPIES. CUT MUST BE MADE FROM END OF TUBES WITHOUT PRE-DRILLED HOLES.

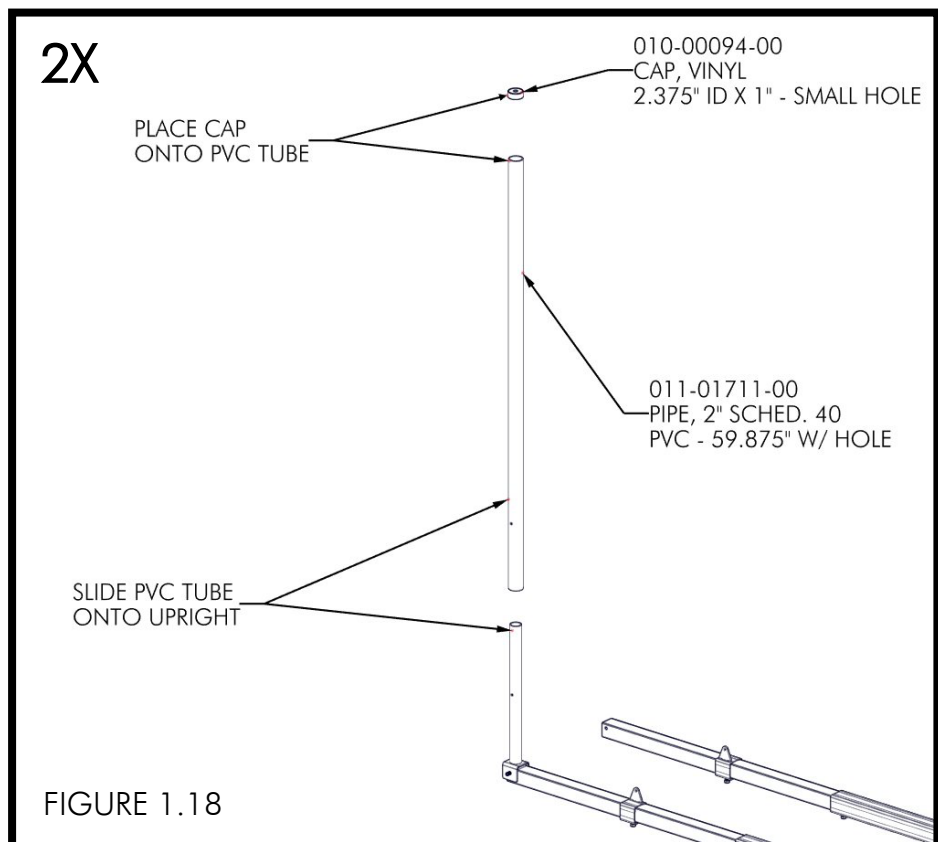

NOTE: FOR BOW FLEX INSTALLATIONS ON PONTOON LIFTS, THIS CABLE IS NOT NECESSARY. ATTACH CABLE TO EYE BOLTS BY LOOSENING NUTS ON CABLE CLAMPS, INSERT CABLE INTO EYE, AND RE-TIGHTEN CLAMPS TO COMPRESS CABLE. DO NOT OVER TIGHTEN (FIGURE 1.19).

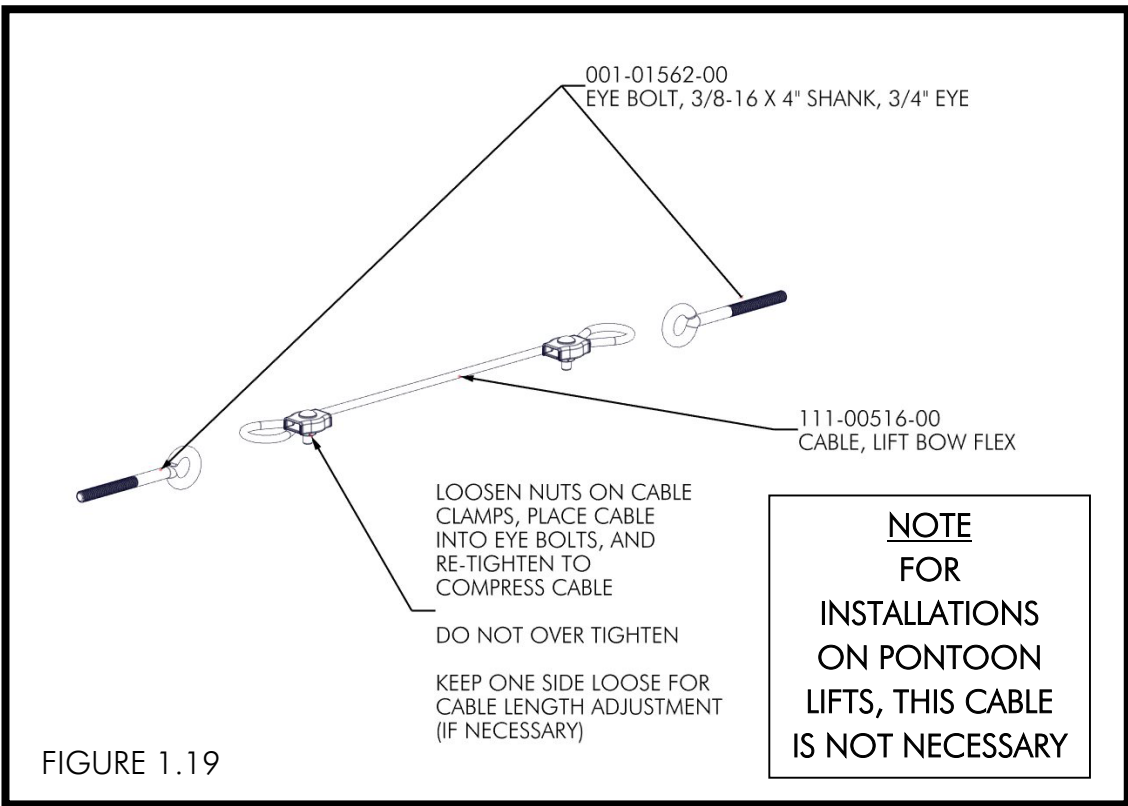

ATTACH ONE END OF BUNGEE TO PVC TUBE & UPRIGHT USING (1) 3/8" X 4" EYE BOLT (WITH CABLE ATTACHED), (2) 3/8" WASHERS, (1) 2.5" PLASTIC WASHER, (1) 1" BUSHING (PLACE INSIDE BUNGEE OPENING), AND (1) 3/8" NYLOCK NUT (FIGURE 1.20).

FIGURE 1.20

2X

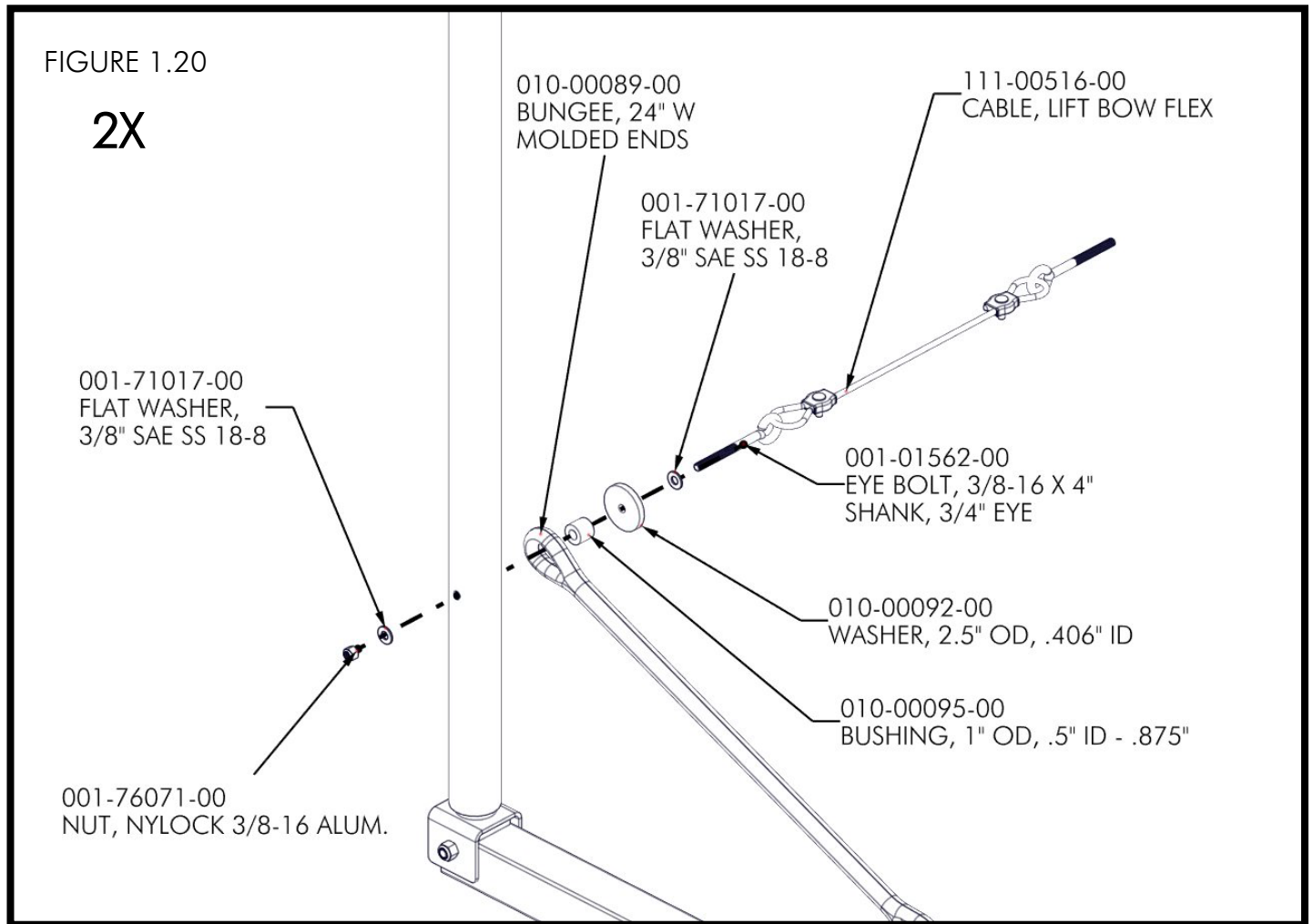

IF NECESSARY, ADJUST CABLE LENGTH AS NEEDED. RE-TIGHTEN NUT TO COMPRESS CABLE. DO NOT OVERTIGHTEN (FIGURE 1.21). TORQUE NUTS TO 15 FT-LBS (FIGURE 1.22).

FIGURE 1.21

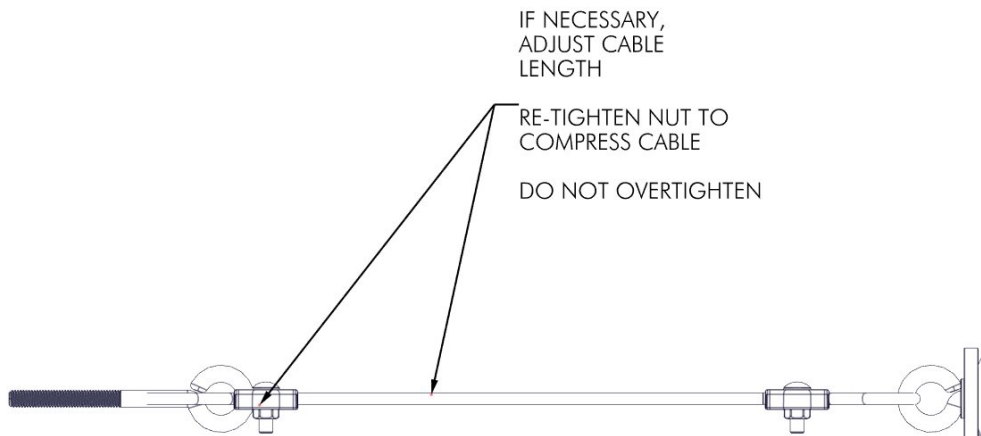
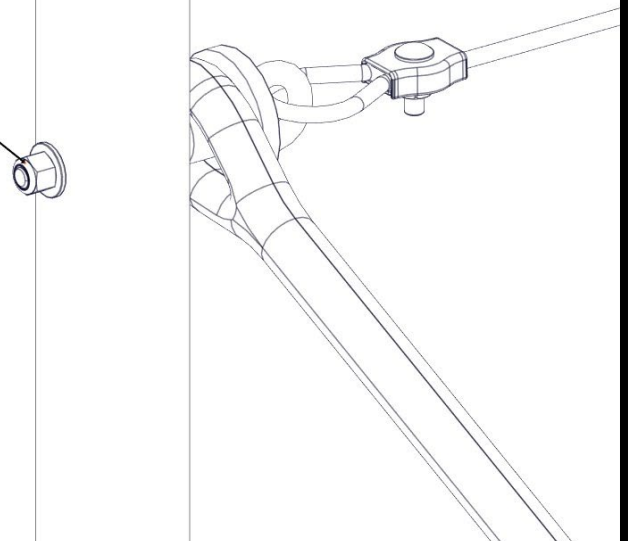

FIGURE 1.22

2X

TORQUE TO 15 FT-LBS



SLIDE BUSHING INTO BUNGEE (FIGURE 1.23), THEN ATTACH BUNGEE TO MOUNT USING (1) 3/8" X 2-1/2" BOLT, (1) 3/8" WASHER, (2) 2.5" PLASTIC WASHERS (ON BOTH SIDES OF BUNGEE), AND (1) 3/8" NYLOCK NUT (FIGURE 1.24). TORQUE TO 15 FT-LBS (FIGURE 1.25).

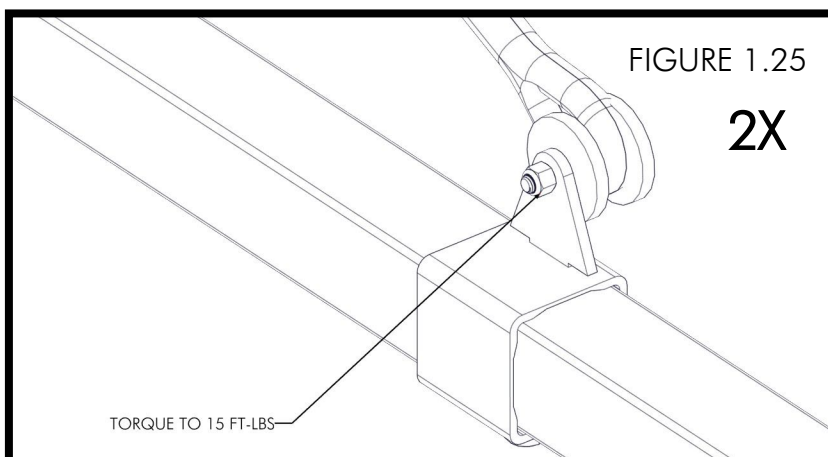
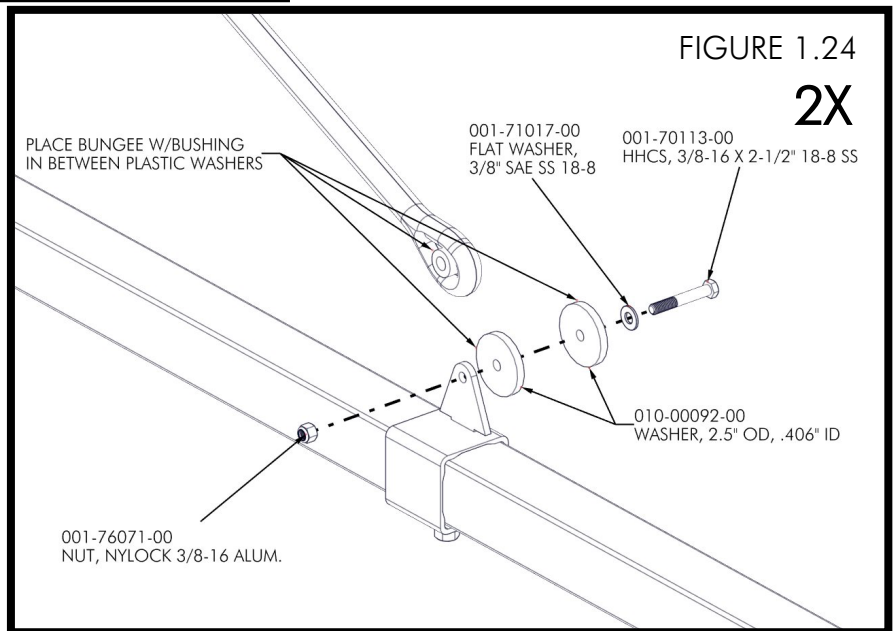
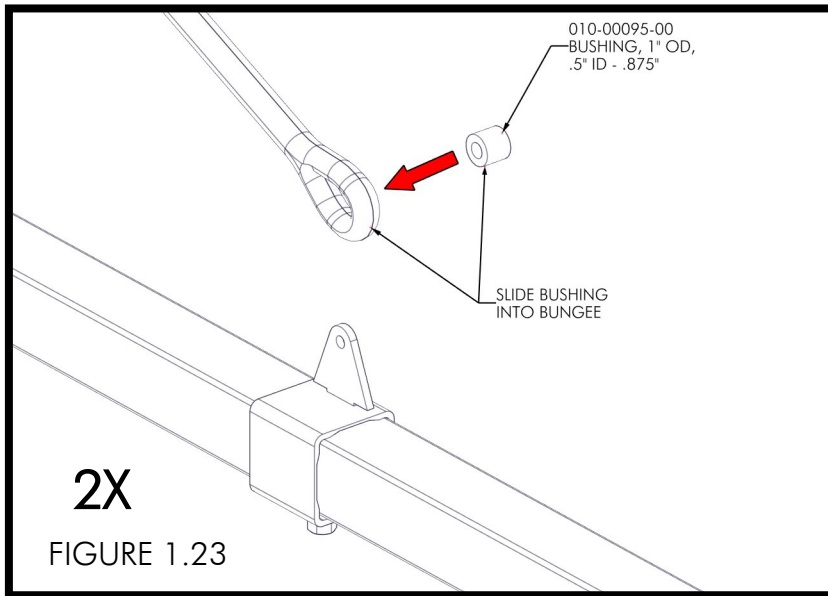

SLIDE BUNGEE MOUNT APPROXIMATELY *22" FROM END OF MOUNT TO END OF INNER TUBE.
TORQUE 1/2" BOLTS TO 20 FT-LBS (FIGURE 1.26).

FIGURE 1.26

2X

MOVE BUNGEE
MOUNT UNTIL THERE
IS TENSION IN BUNGEE

*22"

UPRIGHTS WILL BE
VERTICAL OR
SLIGHTLY TILTED
INWARDS

TORQUE TO
20 FT-LBS

***APPROXIMATELY**

