



ASSEMBLY INSTRUCTIONS

WATER ACCESSORY RACK BRACKETS

QUICK ATTACH ROLL-IN DOCKS

P/N 510-02634-00

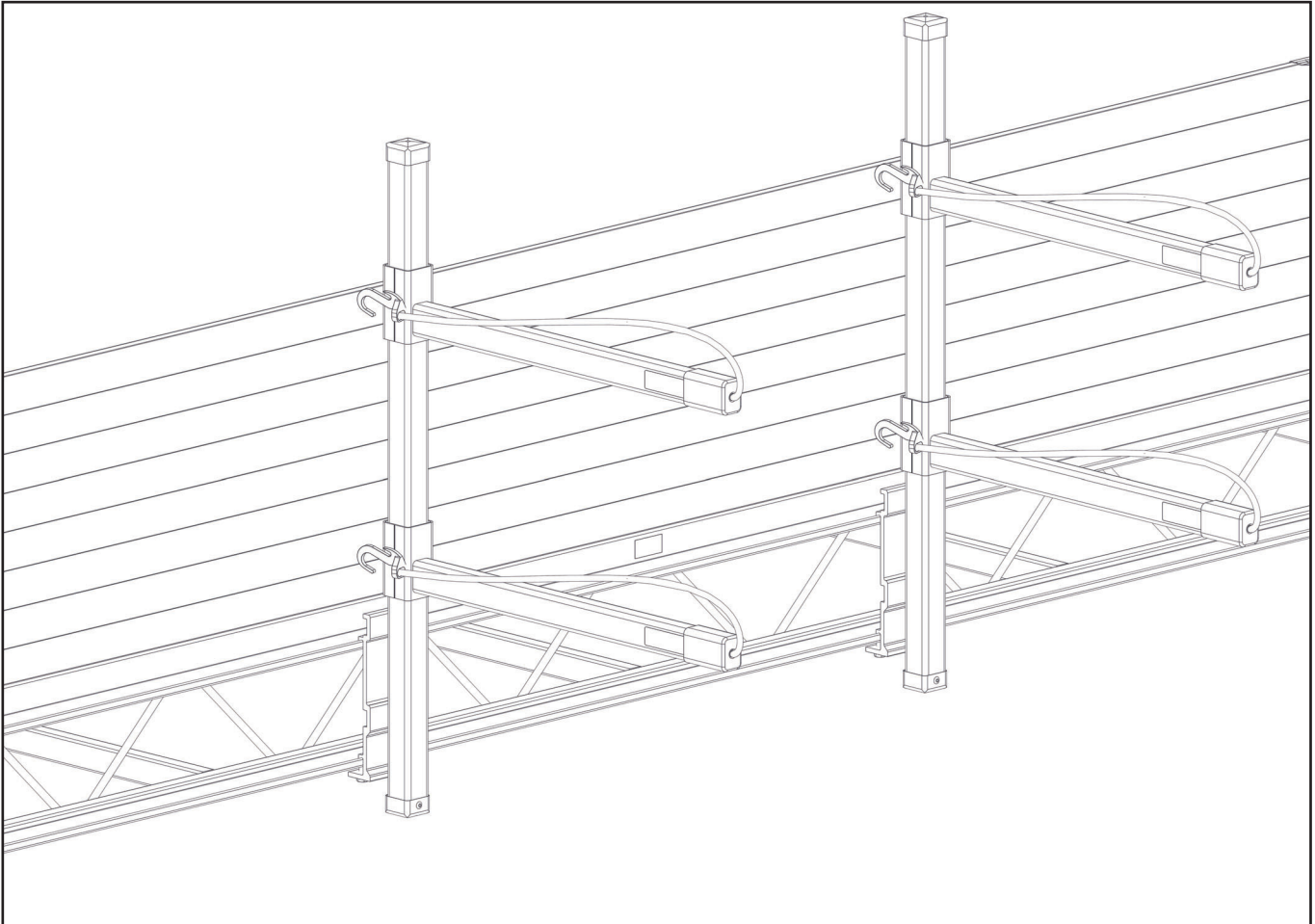

For more information, go to the owner support tab on the FLOE website

*DOCK, LEGS, AND ACCESSORY RACKS NOT INCLUDED

TOOLS REQUIRED

- *(2) 9/16" SOCKETS/WRENCHES

(*NOTE: ONE OR TWO 9/16" WRENCHES/sockets MAY BE REQUIRED, DEPENDING ON THE STYLE OF THE QUICK ATTACH ACCESSORY BRACKET)

- TORQUE WRENCH
- TAPE MEASURE

BILL OF MATERIALS/EXPLODED VIEW

P/N 510-02634-00	KIT, QA ROLL-IN WATER ACCESSORY RACK MTG.		
NUMBER	PART NUMBER	QTY.	DESCRIPTION
1	001-02634-00	1	FASTENERS, QA SCTN'L/QA ROLL-IN WATER ACC. RACK MTG.
1A	001-70103-00	4	HHCS, 3/8-16 X 3/4" 18-8 SS
1B	001-70105-00	4	HHCS, 3/8-16 X 1" 18-8 SS
1C	001-71017-00	4	FLAT WASHER, 3/8" SAE SS 18-8
1D	001-76349-00	4	NUT, 3/8-16 ALUM.
2	002-00278-01	2	BRACKET, QUICK ATT. ROLL-IN BUMPER - 4"

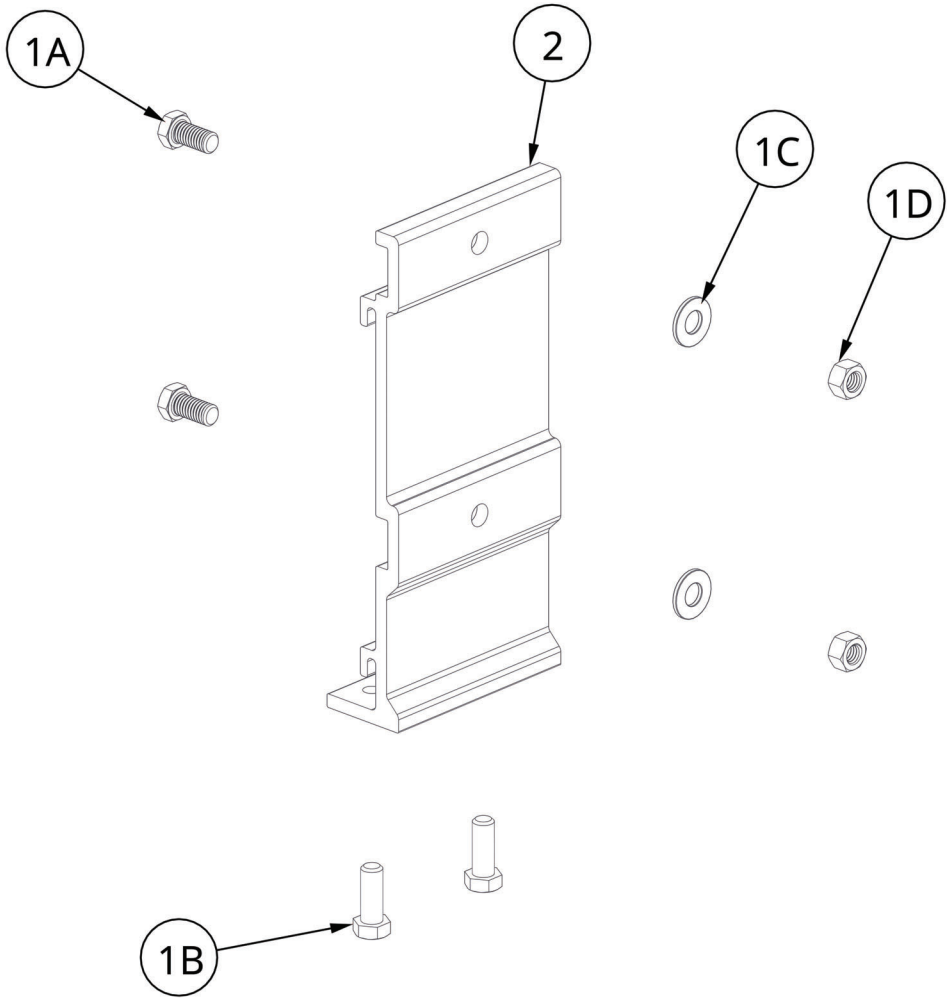

ASSEMBLY

INSTALL (2) 3/8" X 3/4" BOLTS INTO EACH BRACKET (FIGURE 1.1). REMOVE THE VINYL CAP INSTALLED ON THE WATER ACCESSORY RACK UPRIGHT (WITHOUT SCREW ATTACHING IT TO THE UPRIGHT), INSTALL (2) 3/8" WASHERS AND (2) 3/8" NUTS INTO THE TRACK, AND RE-INSTALL THE CAP AND SECURE USING THE SUPPLIED TAPE WITH THE ACCESSORY RACK (FIGURE 1.2).

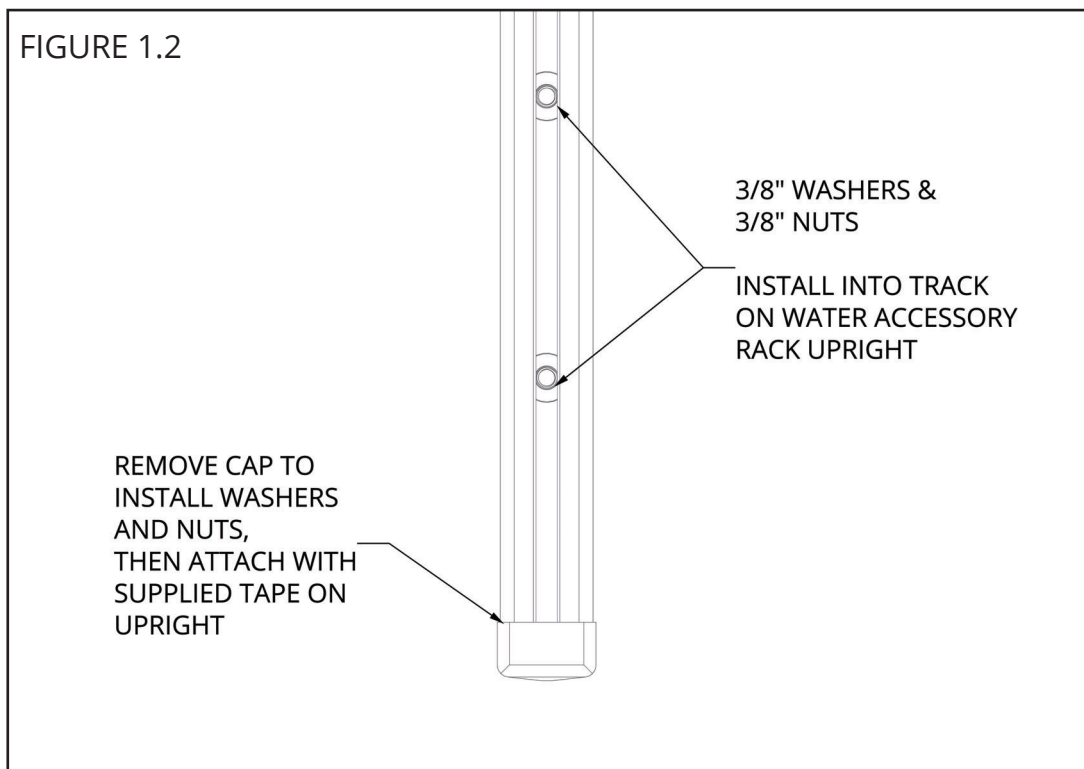
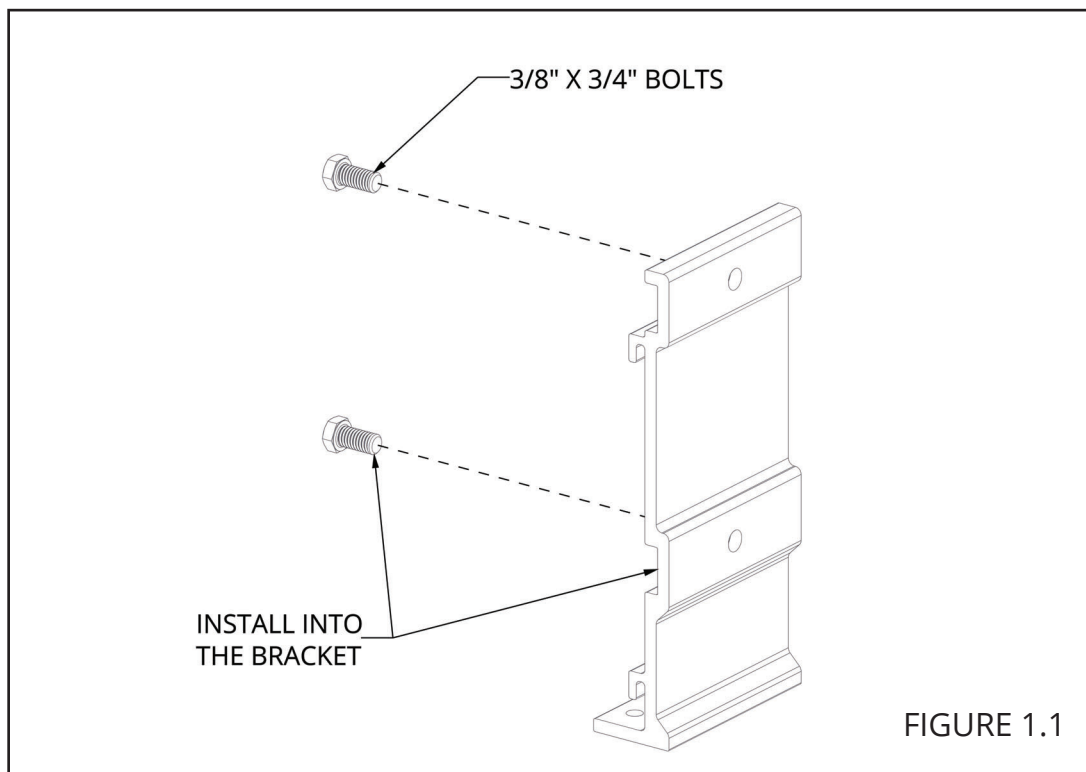

ATTACH THE ACCESSORY RACK UPRIGHT TO THE BRACKET BY ALIGNING THE BOLTS IN THE BRACKET WITH THE WASHERS AND NUTS IN THE UPRIGHT (FIGURE 1.3). POSITION THE BRACKET TO ACHIEVE THE DESIRED HEIGHT AND TORQUE BOLTS TO 35 FT-LB (FIGURE 1.4).

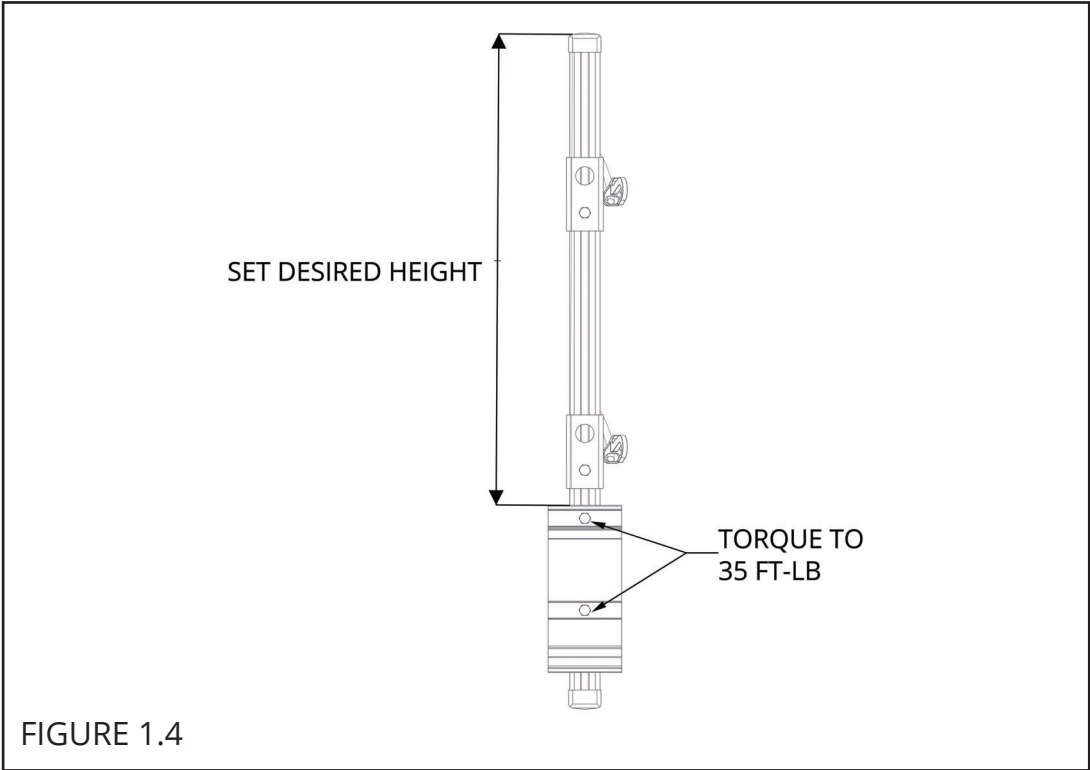
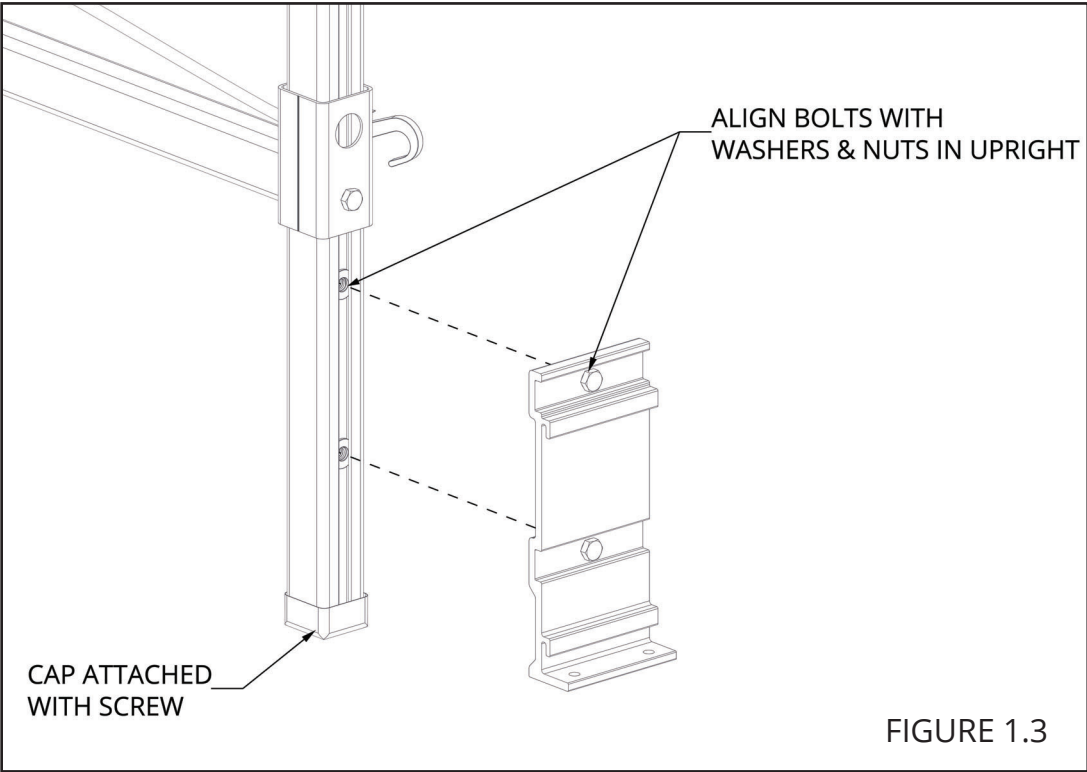

PLACE THE BRACKETS ONTO THE DOCK SIDE IN THE DESIRED LOCATION AND SPACING (FIGURE 1.5). INSTALL (2) 3/8" X 1" BOLTS INTO THE BOTTOM OF THE BRACKET (FIGURE 1.6).

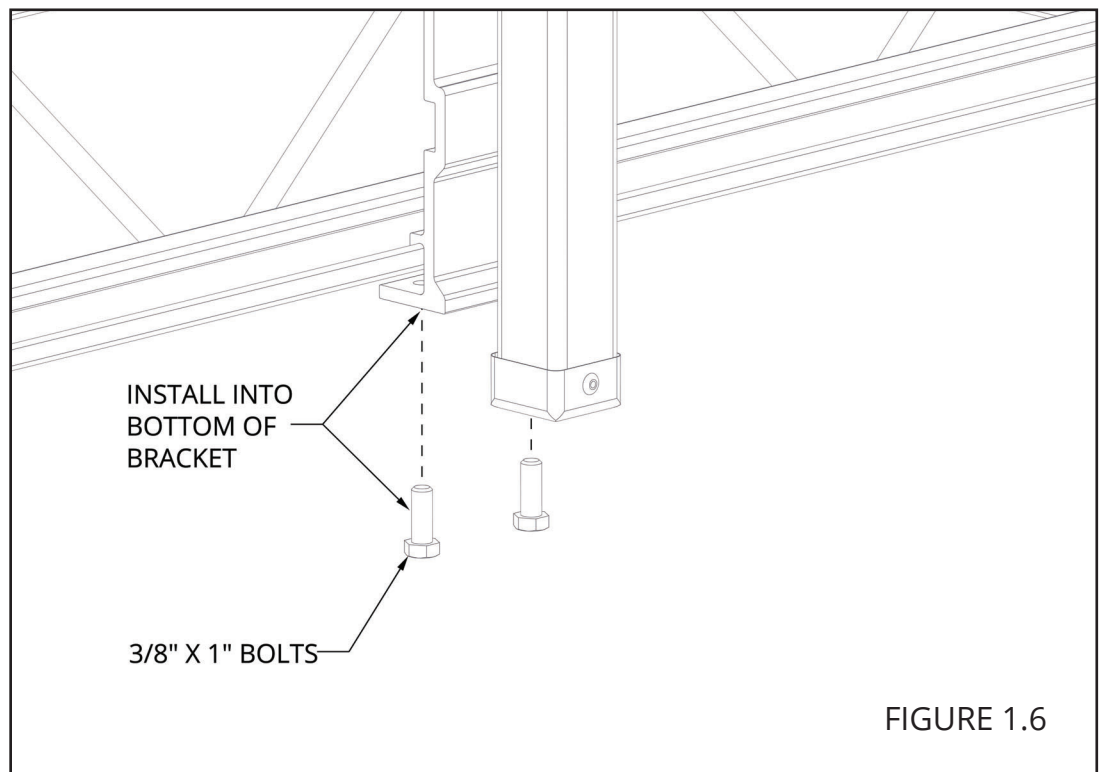
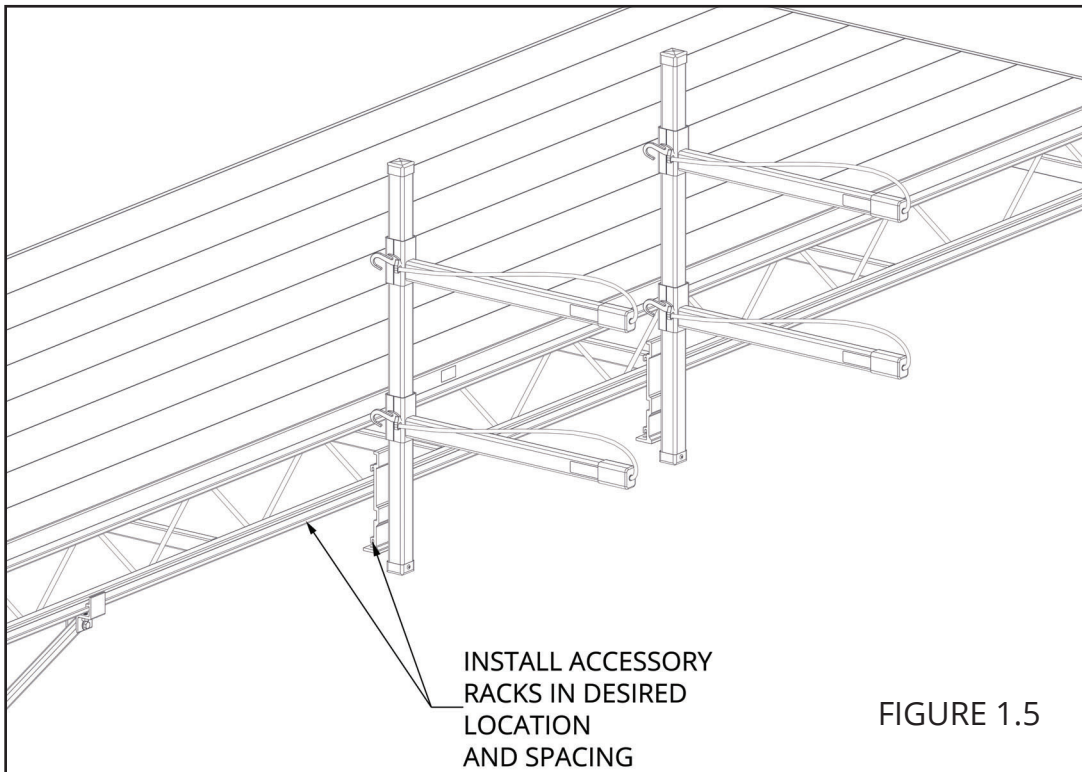

TORQUE BOLTS TO 6 FT-LB MAXIMUM (FIGURE 1.7). REFER TO WATER ACCESSORY RACK INSTRUCTIONS TO COMPLETE INSTALLATION.

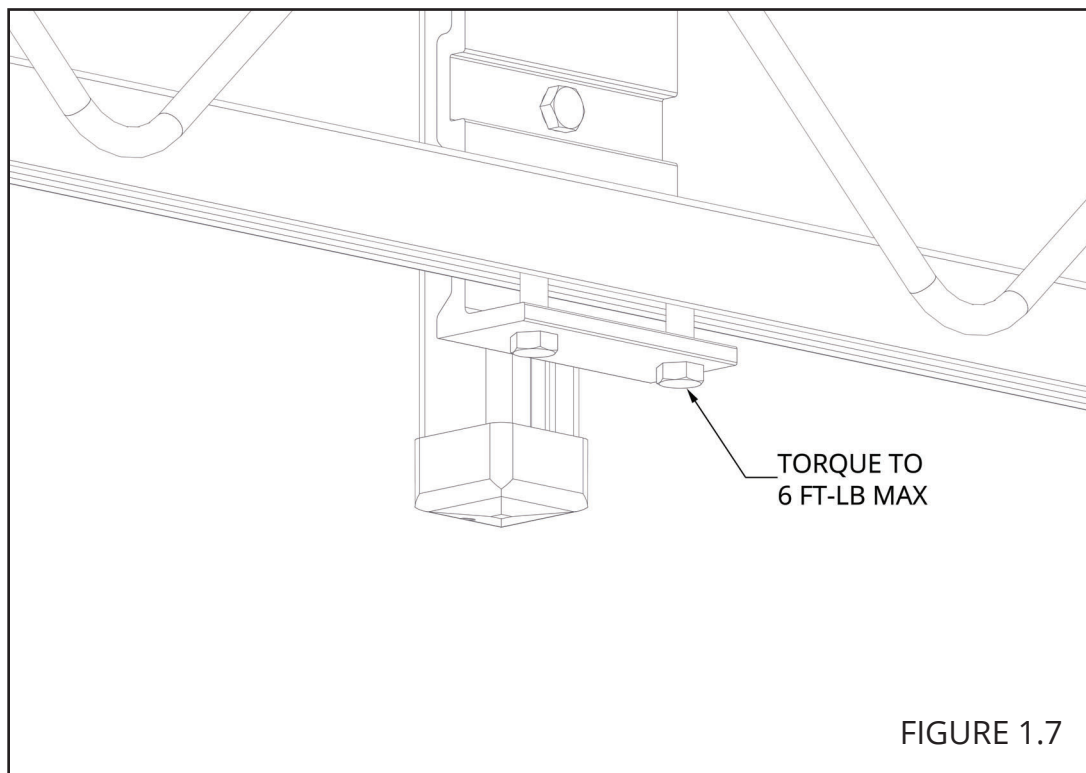

NOTES



FLOE INTERNATIONAL, INC.
48473 STATE HIGHWAY 65 • MCGREGOR, MN 55760
www.floeintl.com

*All material copyright © 2022 FLOE International, Inc.
Specifications subject to change without notice.*