

FLOE STANDARD SECTIONAL DOCK VERTICAL BUMPER ATTACHMENT KIT ASSEMBLY INSTRUCTIONS

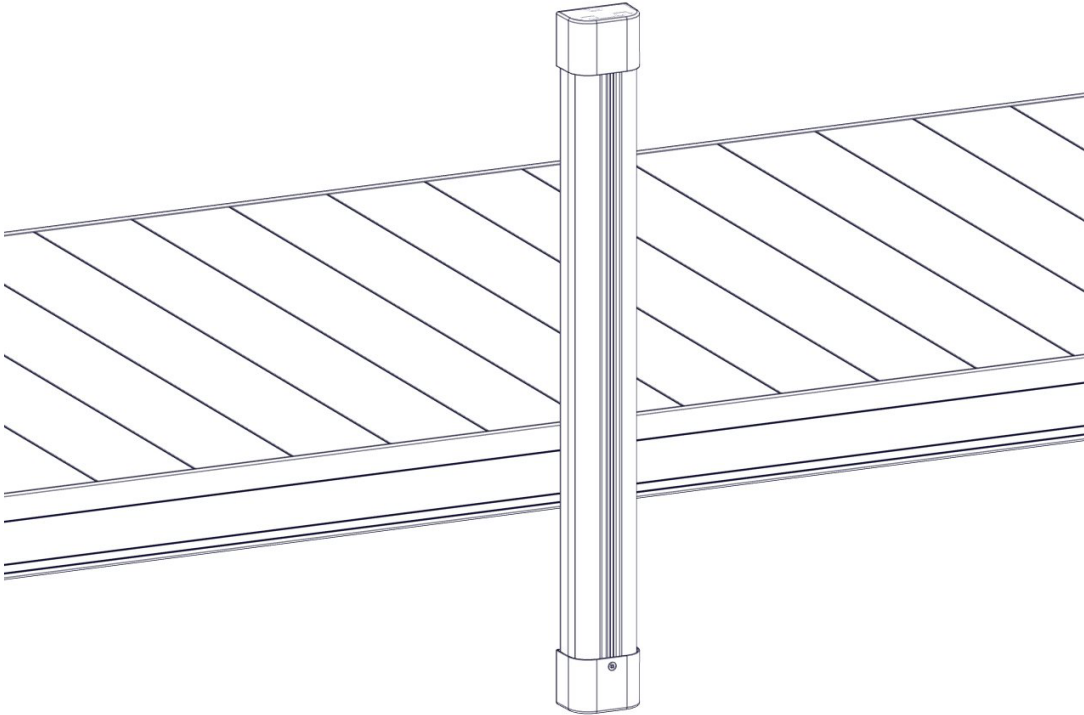

KIT P/N 510-02338-00



*DOCK SECTION & LEGS NOT INCLUDED

NOTE:

VERTICAL BUMPER IS SOLD SEPARATELY.
REFER TO THE INSTRUCTIONS INCLUDED
WITH THE KIT.

TOOLS REQUIRED

- 9/16" SOCKET/WRENCH
- TAPE MEASURE
- TORQUE WRENCH
- FRAMING SQUARE
- MARKER
- CORDLESS DRILL
- 13/32" DRILL BIT
- HAMMER
- CENTER PUNCH

INSTRUCTION P/N: 610-02338-00
RELEASED 1/5/22

SHEET 1 OF 8

© Manufactured by:
Floe International Inc.
48473 State Hwy. 65
McGregor, MN 55760
www.floeintl.com

BILL OF MATERIALS

P/N 510-02338-00	KIT, VERT. BUMPER MTG. HRDW. STD. SCTN'L		
NUMBER	PART NUMBER	DESCRIPTION	QTY
1A	001-70112-00	HHCS, 3/8-16 X 2-1/4" 18-8 SS	2
1B	001-71017-00	FLAT WASHER, 3/8" SAE SS 18-8	2
1C	001-76071-00	NUT, NYLOCK 3/8-16 ALUM.	2

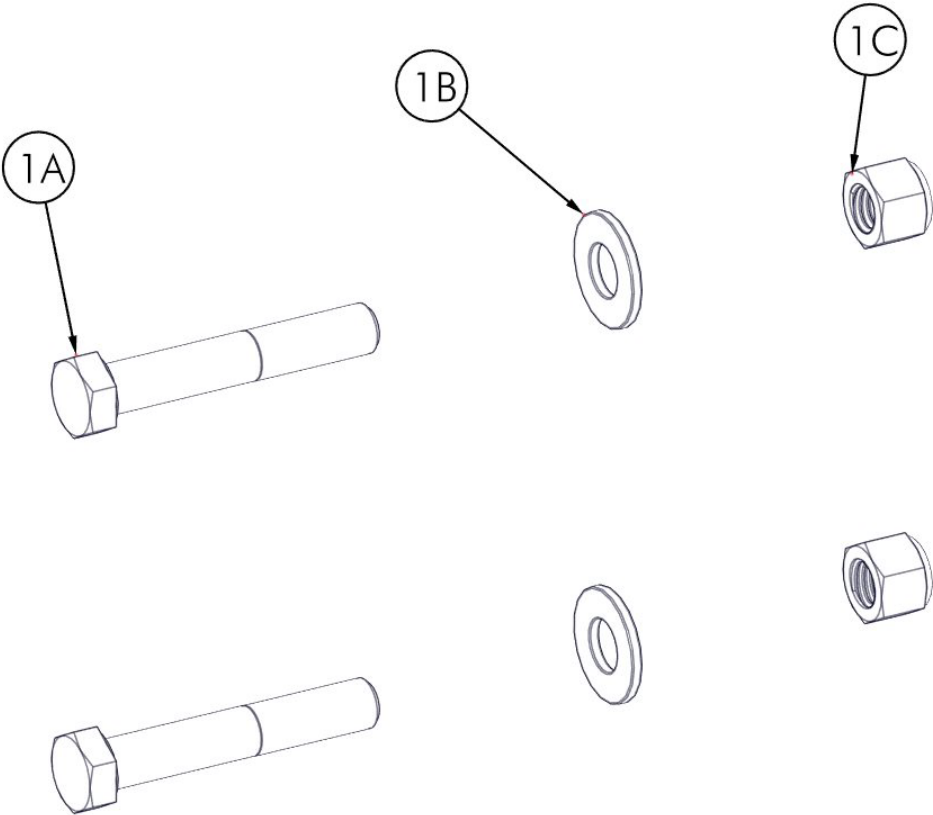

ASSEMBLY

FIRST, DETERMINE WHERE THE BUMPER WILL BE INSTALLED ON THE DOCK SYSTEM. USING A FRAMING SQUARE, MARK A VERTICAL LINE ACROSS THE TOP AND BOTTOM SERRATIONS (THESE SERRATIONS ARE 3" APART AND ARE INTENDED TO ACT AS A HOLE SPACING REFERENCE USE A HAMMER AND CENTER PUNCH TO MAKE A DIMPLE FOR THE DRILL BIT. THIS HELPS PREVENT THE DRILL FROM WANDERING. KEEP THE DRILL BIT PERPENDICULAR TO THE DOCK FRAME WHILE DRILLING (FIGURE 1.1). WITH THE TOP CAP REMOVED (CAP WITHOUT RIVET) SLIDE (4) 3/8" X 2-1/4" BOLTS INTO THE BUMPER (FIGURE 1.2).

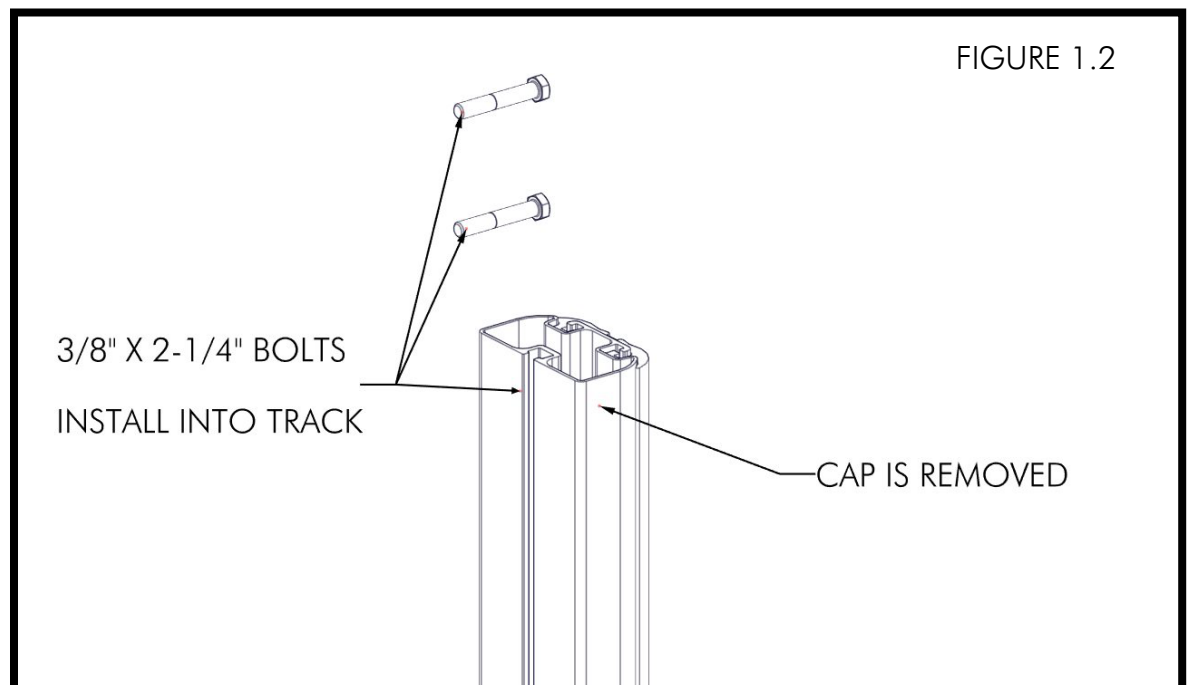
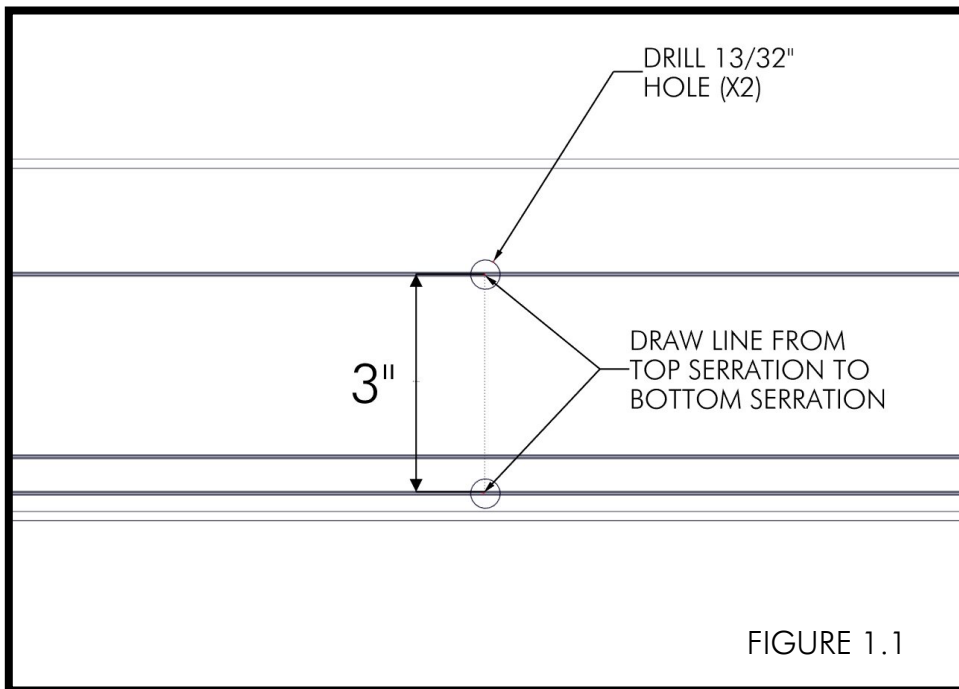

PEEL THE BACKING OFF THE TAPE ON THE SIDES OF THE BUMPER AND ATTACH THE CAP TO THE BUMPER. WITH THE DESIRED HEIGHT OF THE BUMPER SET, INSERT THE BOLTS INTO THE DOCK SIDE (FIGURE 1.3 & 1.3A).

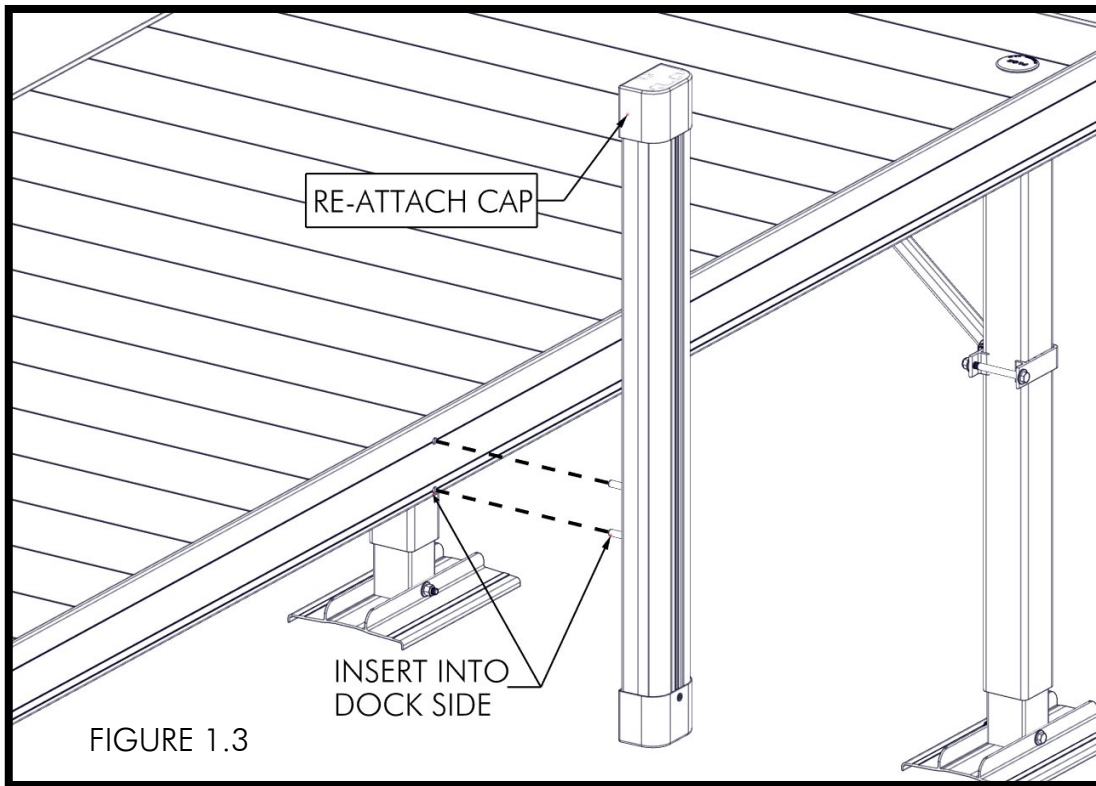
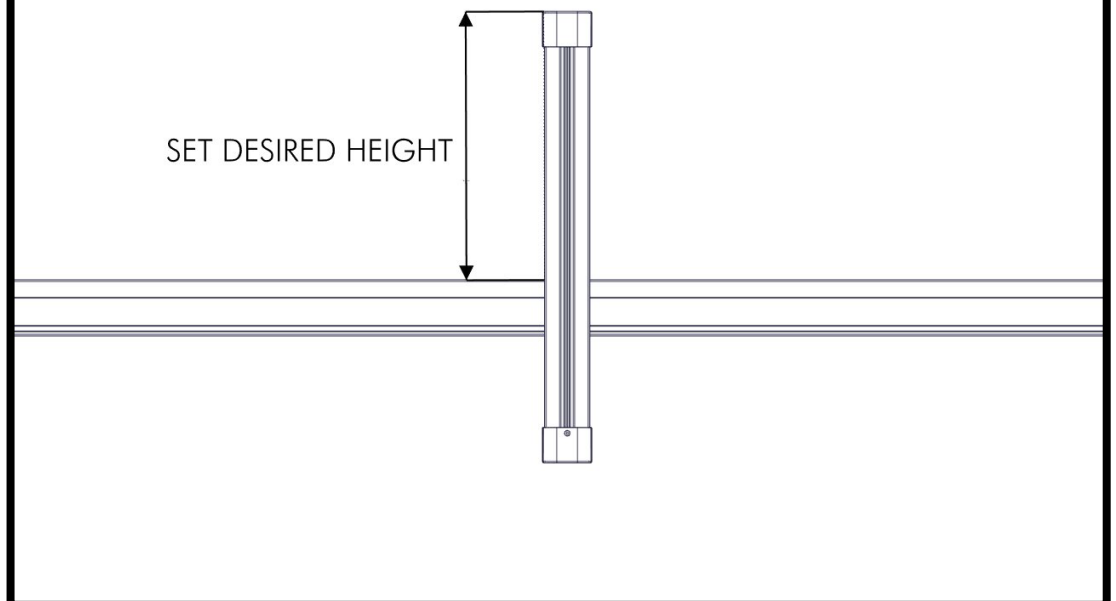
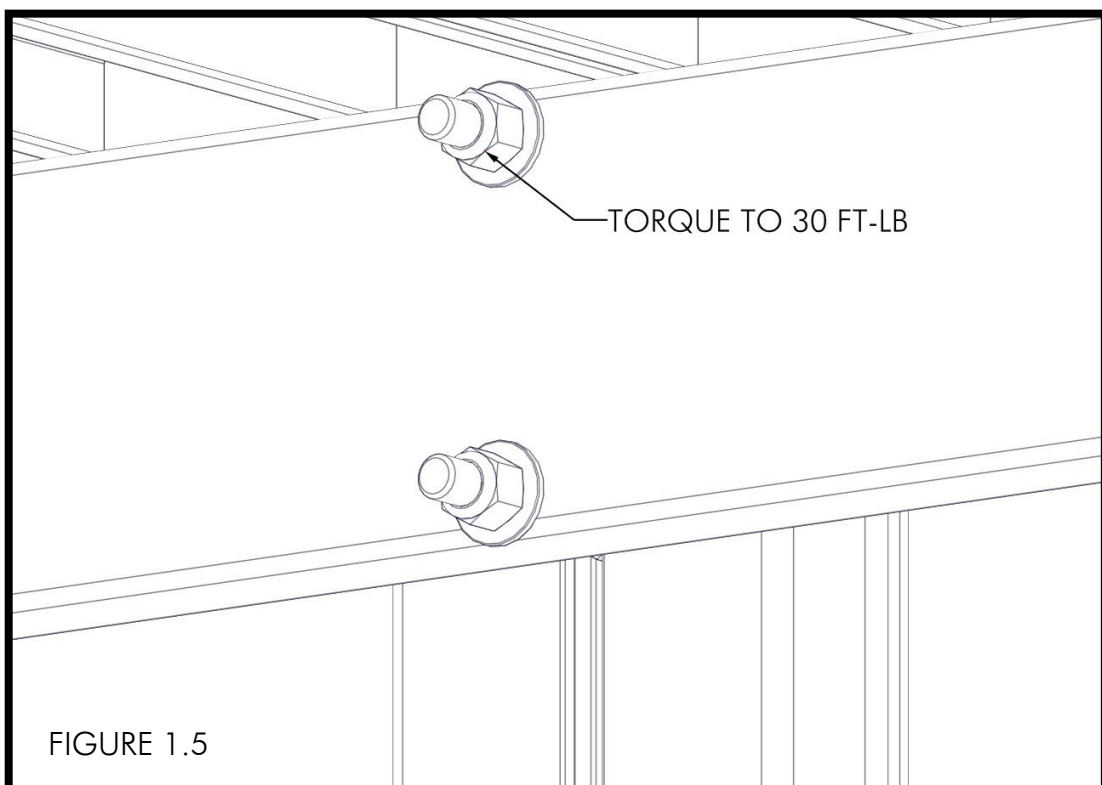
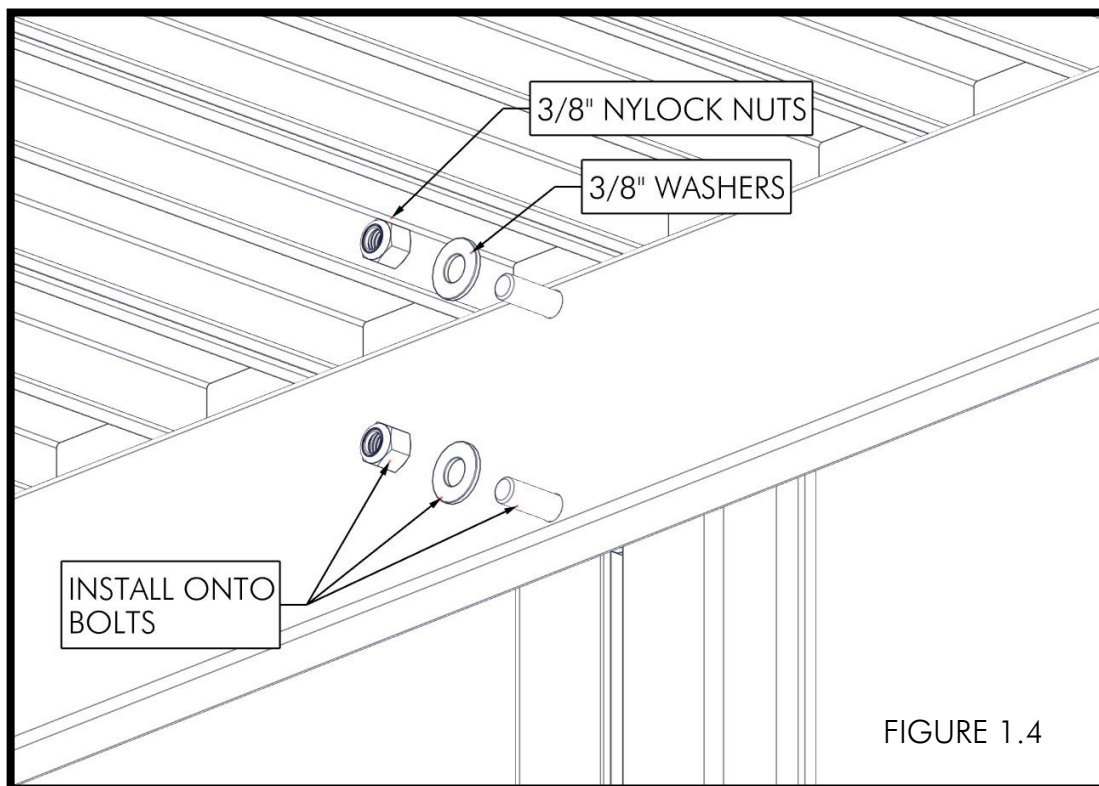

FIGURE 1.3A



INSTALL A 3/8" WASHER AND 3/8" NUT ONTO EACH BOLT (FIGURE 1.4). TORQUE NUTS TO 30 FT-LB AND ENSURE BUMPER IS SQUARE TO THE TOP OF THE DOCK (FIGURE 1.5).



NOTES

NOTES

