

FLOE FLAG POLE

ASSEMBLY INSTRUCTIONS

KIT P/N 510-00200-01

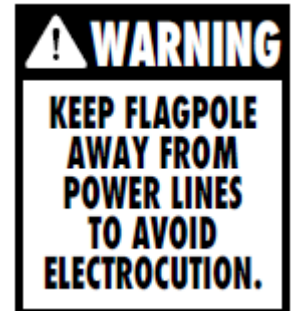

FOR INFORMATION ON USA FLAG ETIQUETTE, REFER TO:
<https://www.usa.gov/flag>

FOR INFORMATION ON CANADA FLAG ETIQUETTE, REFER TO:
<https://www.canada.ca/en/canadian-heritage/services/flag-canada-etiquette/flying-rules.html>

TOOLS REQUIRED
-3/32" ALLEN WRENCH

*DOCK SECTION, LEGS, AND FLAG NOT INCLUDED

ACCESSORY ATTACHMENT KITS

THESE ARE REQUIRED IN ADDITION TO THE FLAG POLE KIT, SPECIFIC TO EACH DOCK STYLE

- 510-02334-00 (STANDARD ROLL-IN DOCKS)
- 510-02335-00 (STANDARD SECTIONAL DOCKS)
- 510-02336-00 (FLOATING DOCKS)
- 510-02603-00 (QUICK ATTACH ROLL-IN DOCKS (BRACKETS AND HARDWARE))
- 510-02573-00 (QUICK ATTACH SECTIONAL DOCKS (BRACKETS & HARDWARE))

MINIMUM WATER DEPTH: 48"
MAXIMUM WATER DEPTH: 60"
(WITH THE AUGER DRIVEN 12" INTO THE LAKE BOTTOM
AND THE DECK HEIGHT 16" ABOVE THE WATER)

INSTRUCTION P/N: 610-00200-02

RELEASED 1/9/23

SHEET 1 OF 12

© Manufactured by:
Floe International Inc.
48473 State Hwy. 65
McGregor, MN 55760
www.floeintl.com

BILL OF MATERIALS

P/N 510-00200-01	FLAG POLE		
NUMBER	PART NUMBER	DESCRIPTION	QTY
1	210-00200-01	FLAG POLES – TELESCOPIC	1
2	210-00201-03	KIT, FLAG POLE W/ SOLAR DISC LIGHT	1

P/N 210-00200-01	FLAG POLES - TELESCOPIC		
NUMBER	PART NUMBER	DESCRIPTION	QTY
1A	002-12509-01	FLAG POLE, UPPER TELESCOPIC 12'	1
1B	110-12507-00	ASS'Y, FLAG POLE LOWER	1

P/N 210-00201-03	KIT, FLAG POLE W/ SOLAR DISC LIGHT		
NUMBER	PART NUMBER	DESCRIPTION	QTY
2A	001-00200-02	ASS'Y HARDWARE, FLAG POLE TELESCOPIC	1
2B	001-70000-00	SOFT GRIP KNOB, 1/2-13 X 1-1/4"	1
2C	002-02523-00	AUGER, 13.5" SCREW	1
2D	002-12514-01	TOPPER, FLAG POLE (TURNED)	1
2E	003-50000-00	LIGHT, SOLAR FLAG POLE (DISC)	1
2F	006-22601-00	ROD, CRANK – GUIDE POST	1
2G	010-00021-00	GLOBE, FLAG POLE 3" W/ 1/2-13 STEM (SILVER BALL)	1
2H	110-12501-00	ASS'Y, FLAG POLE BRACKET	1
2I	110-12502-01	WELD'T, FLAG WEIGHT – 8"	1

P/N 001-00200-02	ASS'Y HARDWARE, FLAG POLE TELESCOPIC		
NUMBER	PART NUMBER	DESCRIPTION	QTY
2AA	001-03521-00	CLIP, SPRING 3/16" SS	2
2AB	001-43489-00	EYE BOLT, 3/16" X 3" SS	1
2AC	001-70116-00	HHCS, 3/8-16 X 3-1/4" 18-8 SS	1
2AD	001-70907-00	NUT, WING 10-24 SS	1
2AE	001-70912-00	NUT, WING 3/8-16 SS	1
2AF	001-71067-00	LOCK WASHER, 3/8" S/W SS 18-8	1
2AG	001-73247-00	SSS CP 10-32 X 3/8" SS	2

EXPLODED VIEW

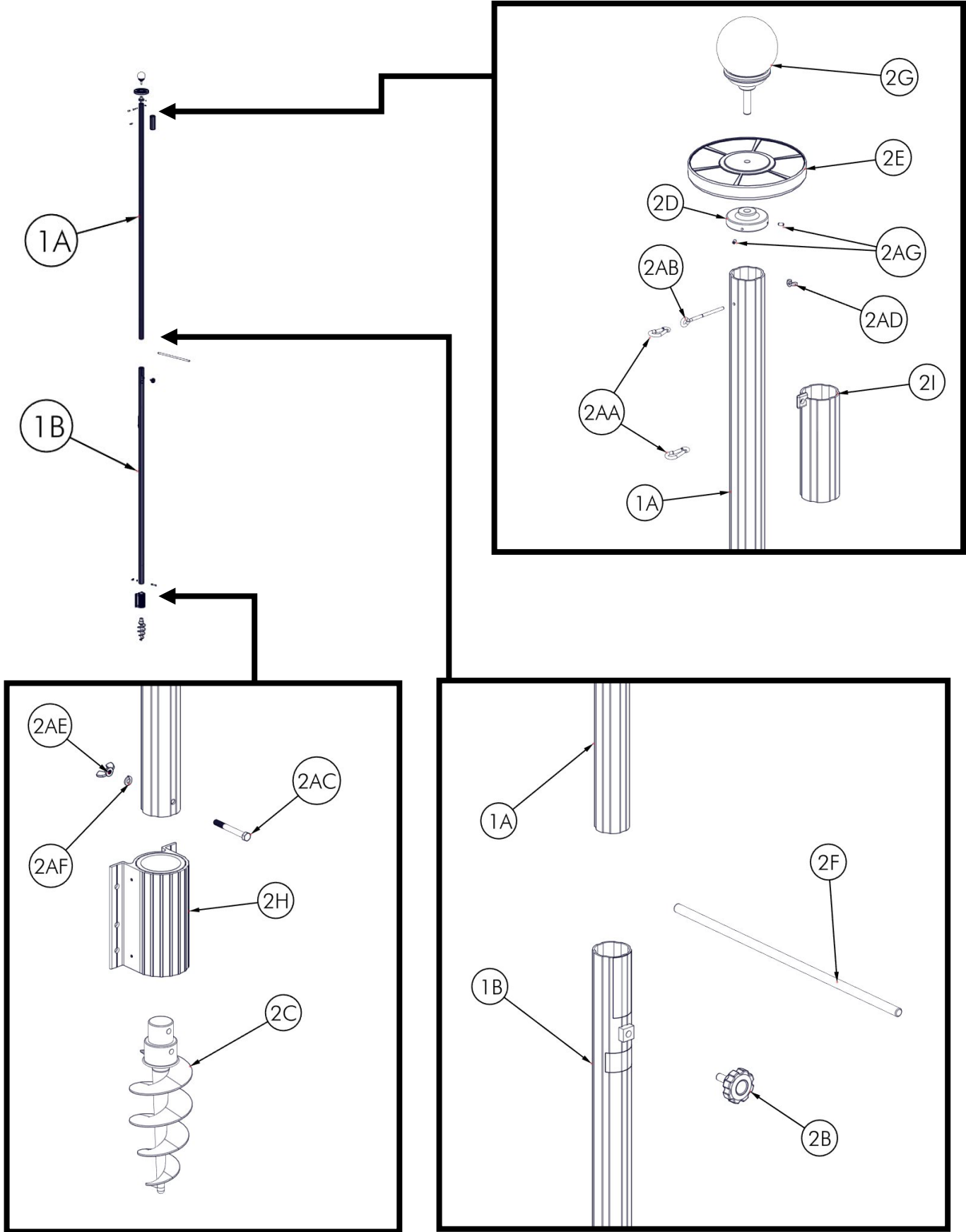

ASSEMBLY

STEP 1

INSTALL THE EYE BOLT IN THE TOP HOLE OF THE UPPER POLE AND SECURE WITH A 10-24 WING NUT. FOR HALF-STAFF, USE THE HOLE 52" DOWN FROM THE TOP (FIGURE 1.1). PLACE THE FLAG POLE TOPPER ONTO THE TOP POLE (FIGURE 1.2).

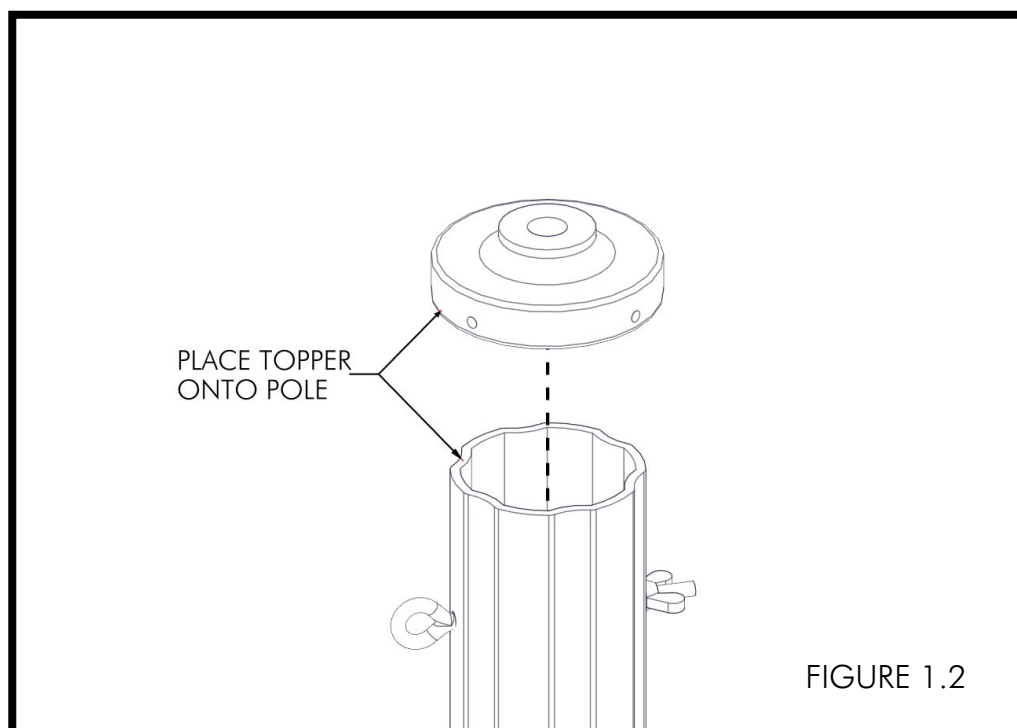
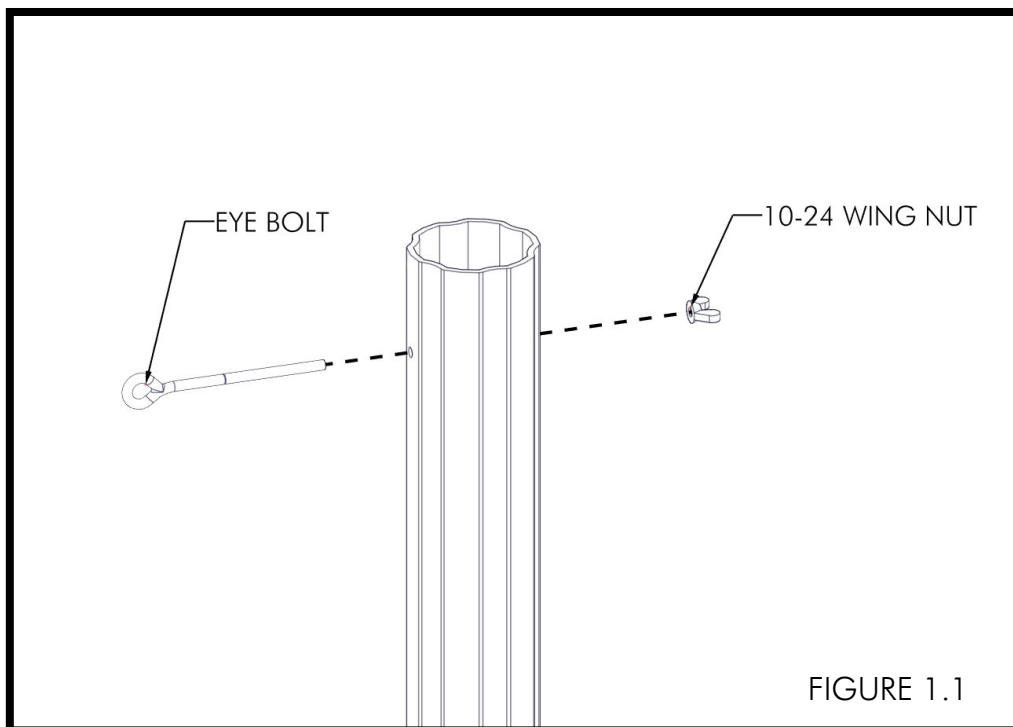

SECURE THE TOPPER TO THE POLE WITH (2) 10-32 X 3/8" SET SCREWS (FIGURE 1.3). PLACE THE SOLAR LIGHT ONTO THE TOPPER (FIGURE 1.4). SCREW THE GLOBE INTO THE TOPPER, BUT DO NOT OVERTIGHTEN (FIGURE 1.5).

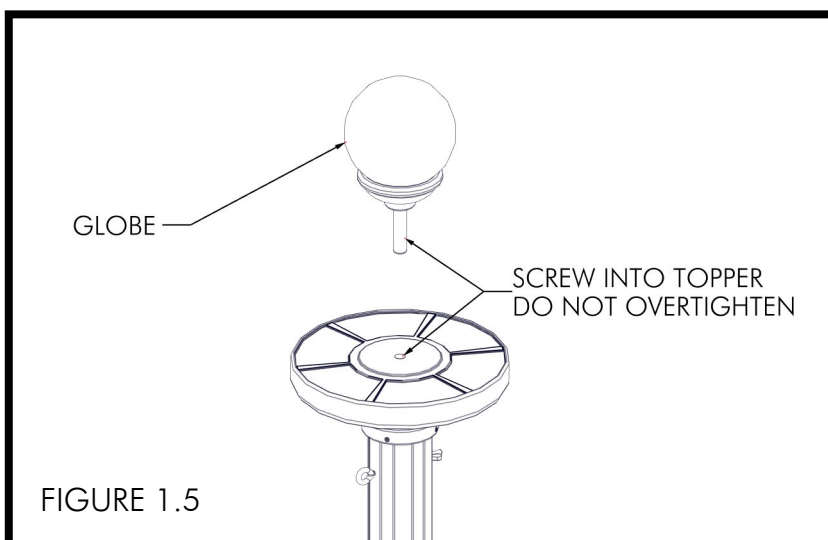
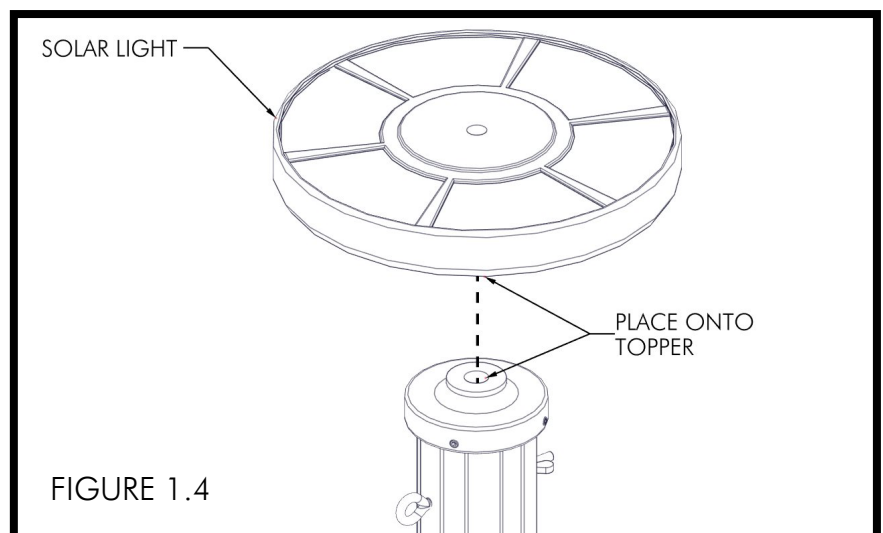
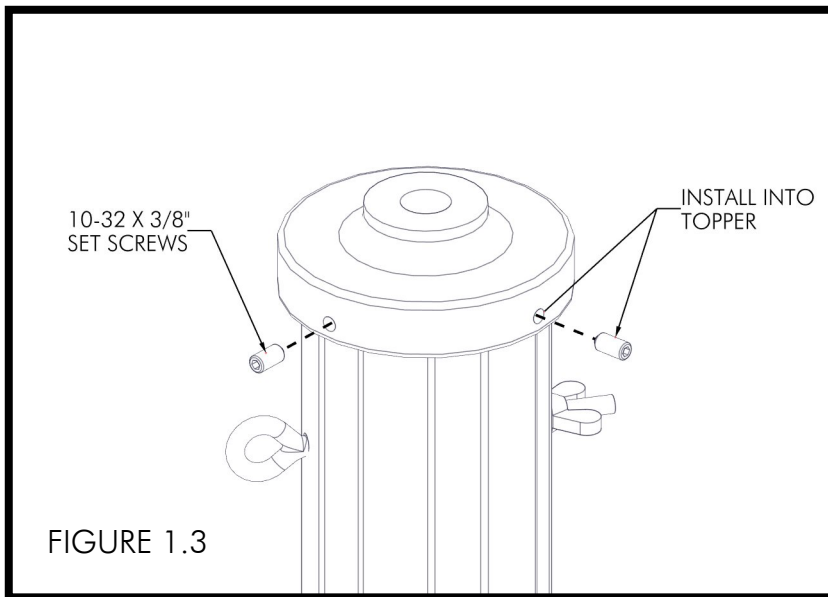

STEP 2

ALIGN THE MOUNTING TAB ON THE FLAG WEIGHT TUBE IN LINE WITH THE EYE BOLT ON THE UPPER POLE AND SLIDE ONTO THE UPPER POLE FROM THE BOTTOM (FIGURE 2.1). INSERT THE UPPER POLE ONTO THE LOWER POLE WHILE ALIGNING THE INDEX HOLE IN THE UPPER POLE WITH THE ARROW ON THE WARNING DECAL ON THE LOWER POLE (FIGURE 2.2).

FIGURE 2.1

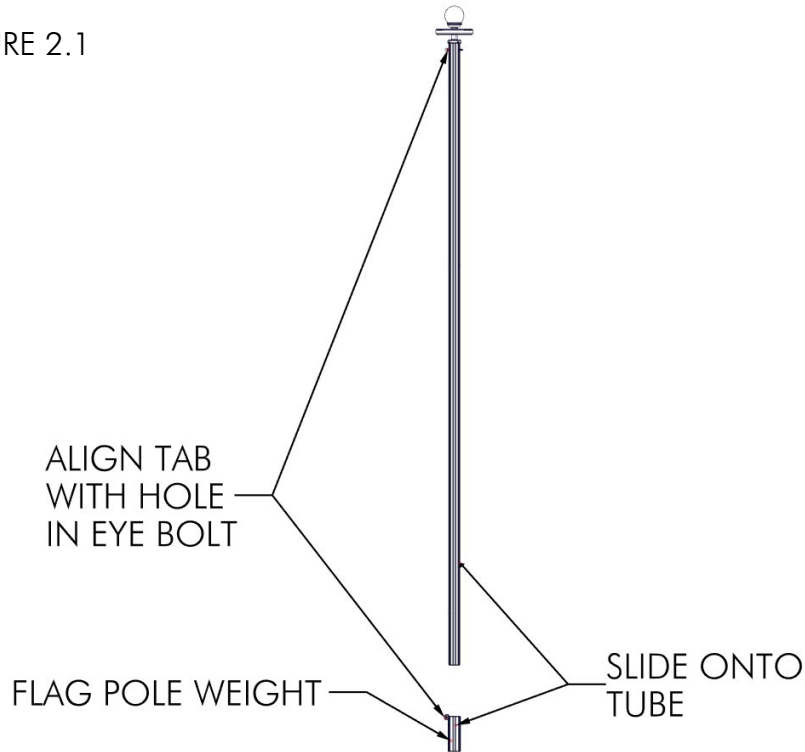

ALIGN INDEX
HOLE WITH ARROW
ON DECAL

SLIDE UPPER POLE
INTO LOWER POLE

FIGURE 2.2

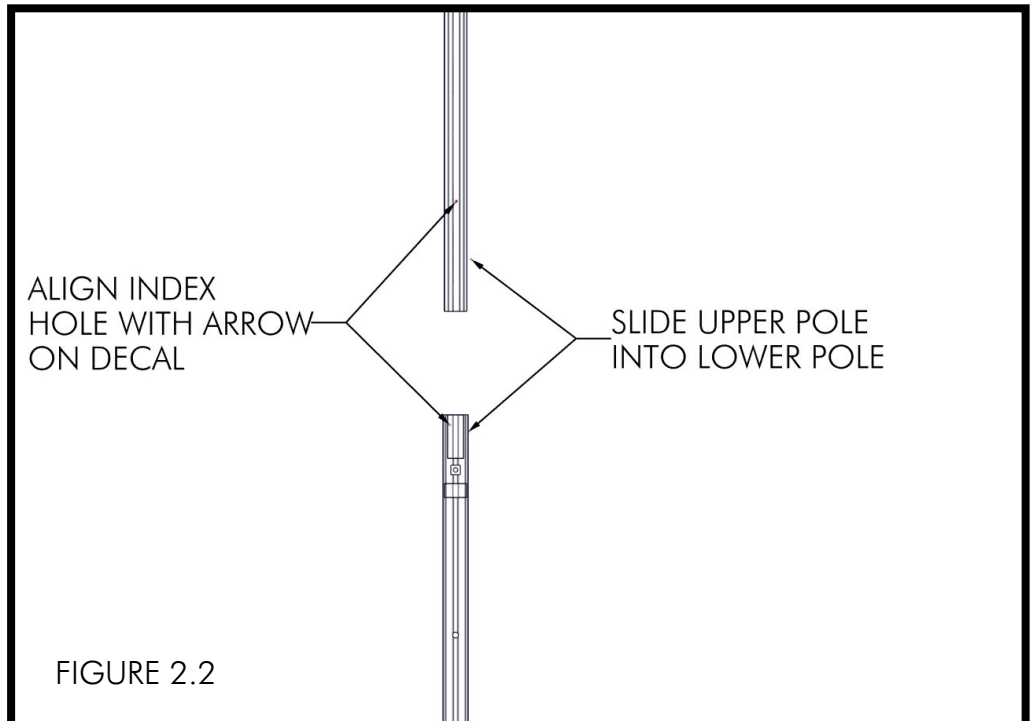

WITH THE ASSEMBLY IN THE RETRACTED POSITION, INSERT THE KNOB BOLT AND TIGHTEN TO SNUG (FIGURE 2.3). SLIDE THE FLAG POLE POCKET ONTO THE LOWER POLE (FIGURE 2.4).

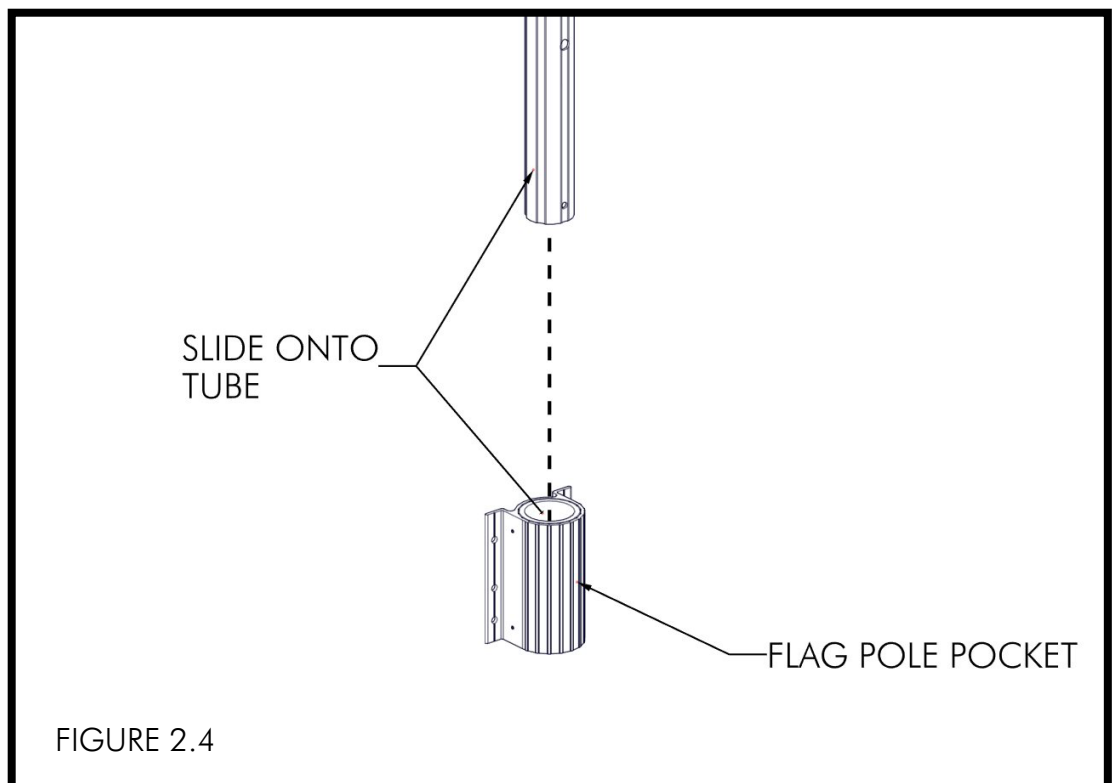
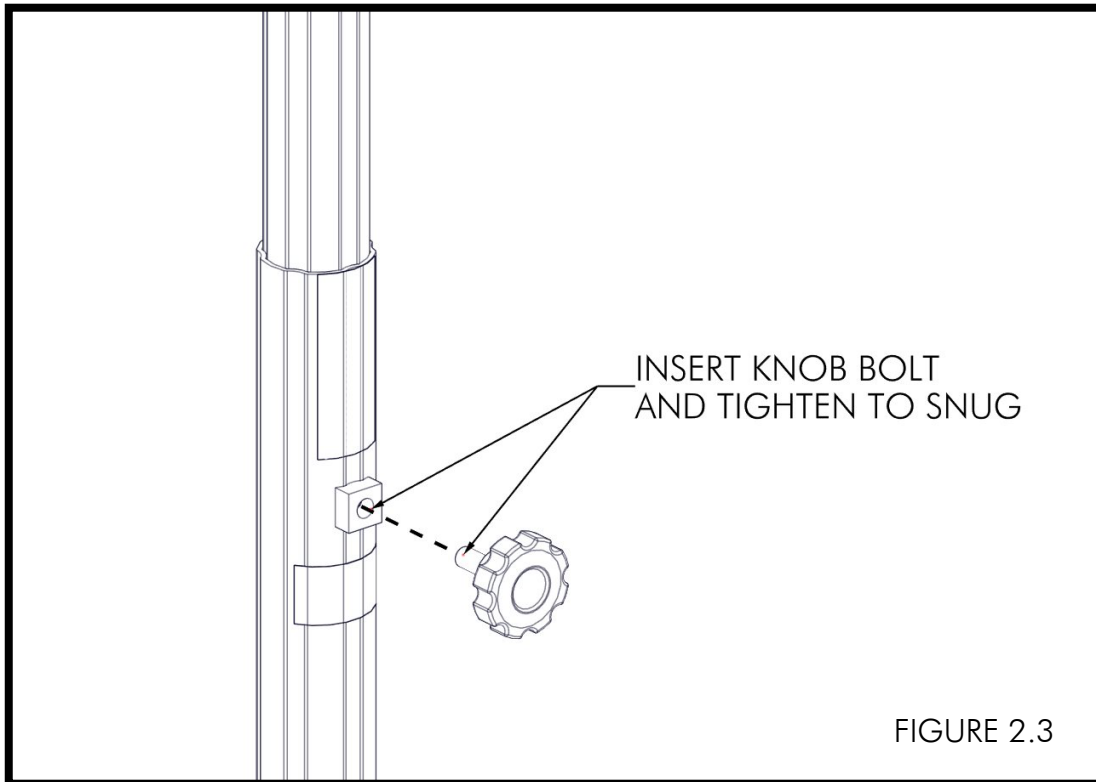

ATTACH THE AUGER USING A 3/8" X 3-1/4" BOLT, 3/8" LOCK WASHER, AND 3/8" WING NUT (FIGURE 2.5).

AT THIS TIME, ATTACH THE FLAG POLE POCKET TO THE DOCK SIDE BY REFERRING TO THE INSTRUCTIONS INCLUDED WITH THE ATTACHMENT KIT FOR YOUR DOCK. TWO PEOPLE MAY BE REQUIRED.

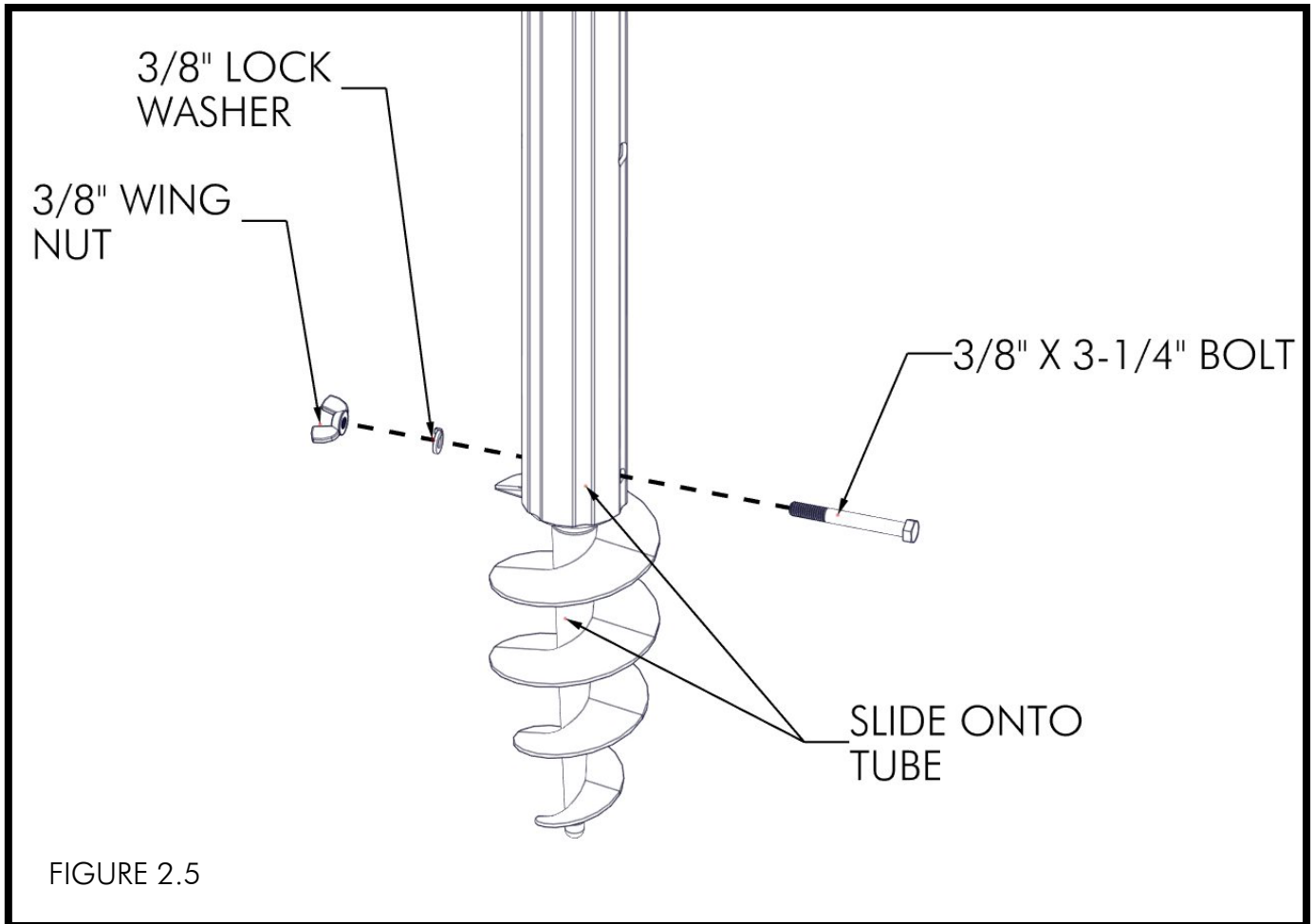

STEP 3

PLACE THE CRANK ROD IN THE UPPER LARGE HOLE AND TURN CLOCKWISE AND DRIVE THE AUGER 12" INTO THE LAKE BOTTOM (FIGURE 3.1). ATTACH THE FLAG OF CHOICE TO THE TWO SPRING CLIPS (FIGURE 3.2).

FIGURE 3.1

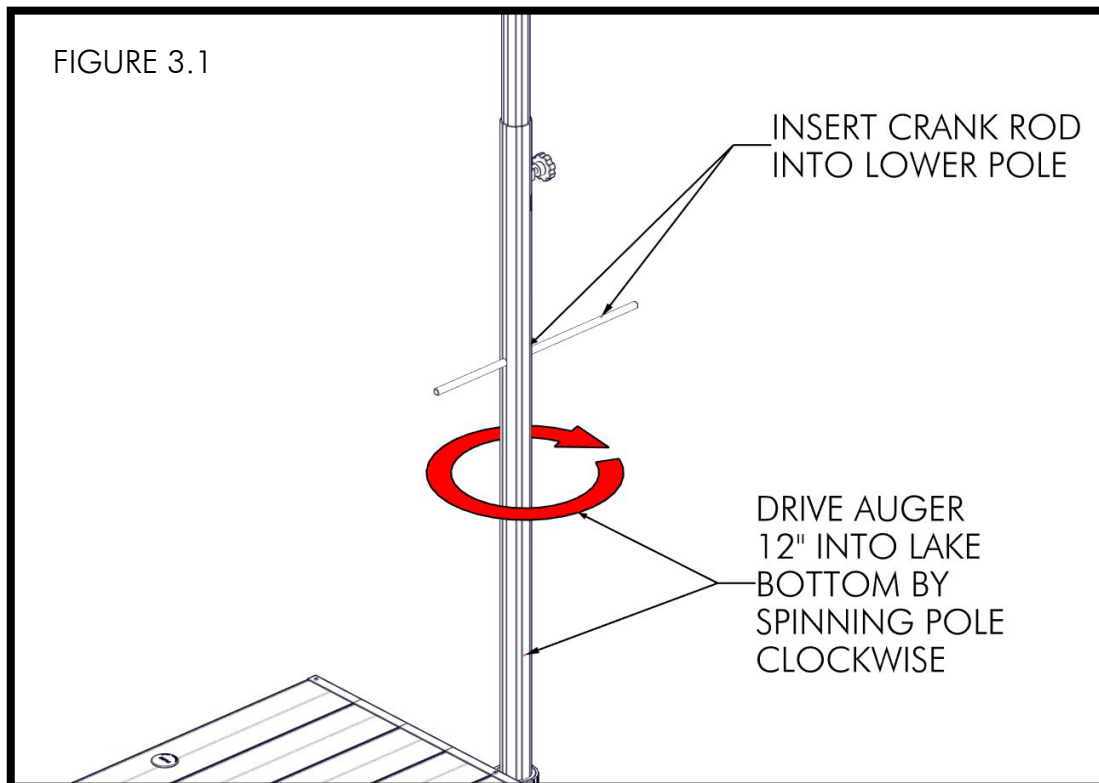

ATTACH SPRING CLIPS
TO EYE BOLT
AND FLAG WEIGHT

ATTACH FLAG
TO SPRING CLIPS

FIGURE 3.2

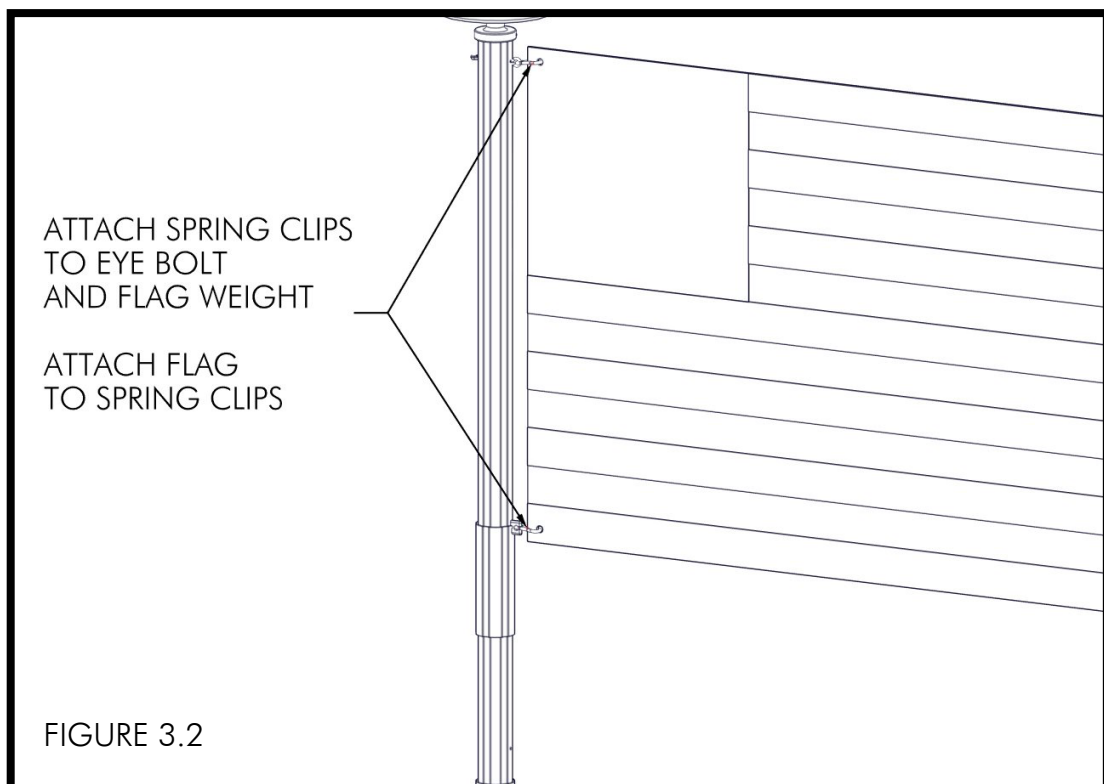

CAREFULLY IN A HAND OVER HAND MOTION, RAISE THE INNER POLE UP UNTIL THE INDEX HOLE IS VISIBLE, THEN TIGHTEN THE KNOB BOLT (FIGURE 3.3).

WARNING: DO NOT OVER EXTEND. OVER EXTENDING WILL CAUSE THE POLES TO SEPARATE!

TO LOWER THE FLAG POLE, LOOSEN THE KNOB BOLT WHILE FIRMLY GRASPING THE UPPER POLE. ONCE THE KNOB BOLT IS LOOSE, CAREFULLY ALLOW THE INNER POLE TO SLIDE DOWN.

WARNING: BE VERY CAREFUL OF PINCH POINTS!

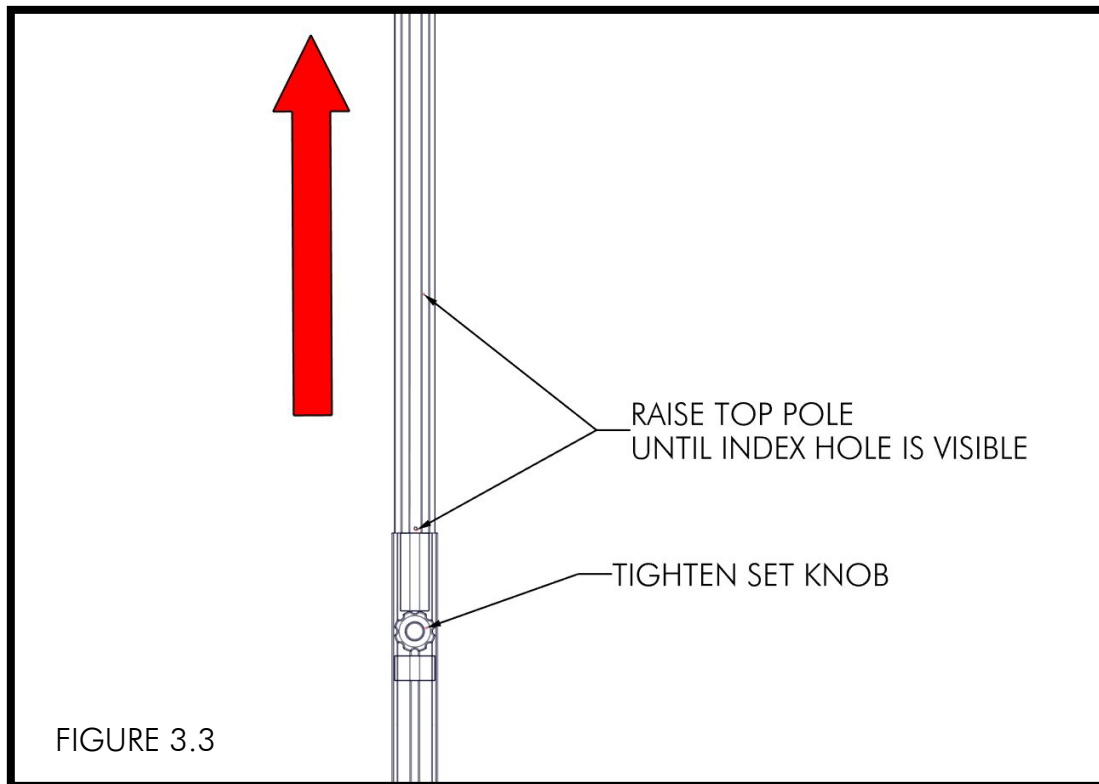

MINIMUM WATER DEPTH: 48"
MAXIMUM WATER DEPTH: 60"
(WITH THE AUGER DRIVEN 12" INTO THE LAKE BOTTOM AND
THE DECK HEIGHT 16" ABOVE THE WATER)

NOTES

