

FLOE DOCK ANCHOR DRIVER TOOL

ASSEMBLY INSTRUCTIONS

KIT P/N 510-00015-00



*DOCK, LEGS, AND ANCHORS NOT INCLUDED
STANDARD SETUP SHOWN

NOTE

TWO PEOPLE ARE REQUIRED.

IMPORTANT

DO NOT USE AN IMPACT OR CORDLESS
DRILL TO INSTALL DOCK ANCHORS.

TOOLS REQUIRED

-(2) 1-1/8" WRENCHES OR
RATCHET WITH 1-1/8"
SOCKET

BILL OF MATERIALS/EXPLODED VIEW

P/N 510-00015-00		TOOL, DOCK ANCHOR DRIVER	
NUMBER	PART NUMBER	DESCRIPTION	QTY.
1	001-99015-00	HARDWARE, SAND PAD ANCHOR DRIVER	1
1A	001-00900-00	CLEVIS PIN, WIRE LOCK 1/4 X 1-1/8" SS	2
1B	001-03521-00	CLIP, SPRING 3/16" SS	2
1C	001-69999-00	SOFT GRIP KNOB, 3/8-16 X 1.5"	1
1D	002-00198-00	SET COLLAR, ANCHORING SYSTEM	1
1E	110-00407-00	ASS'Y, ANCHOR RETENTION CABLE	1
1F	110-00408-00	ASS'Y, ANCHOR RETENTION CABLE EXTENSION	1
2	110-00405-00	ASS'Y, ANCHOR DRIVER (WITH SOCKET ATTACHED)	1
3	110-00406-00	ASS'Y, ANCHOR DRIVER EXTENSION – 7'	1

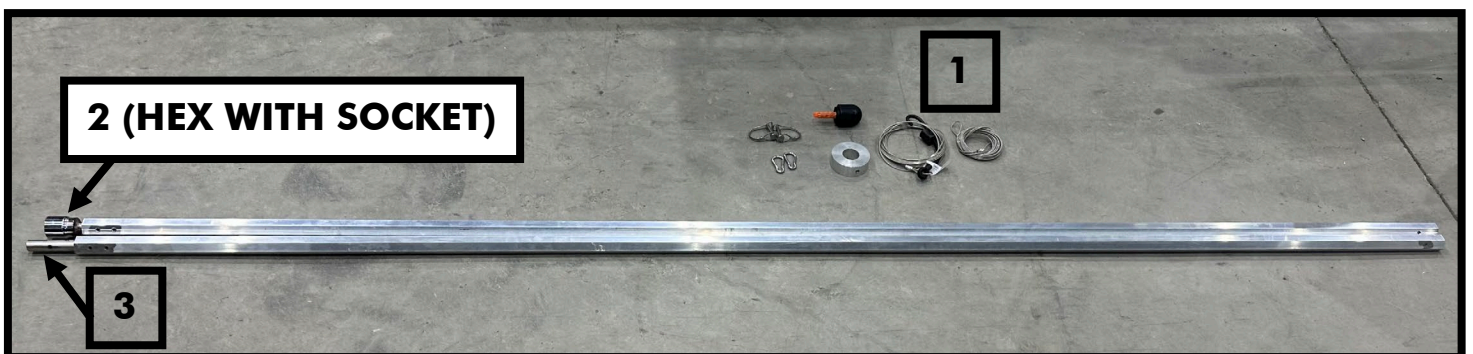
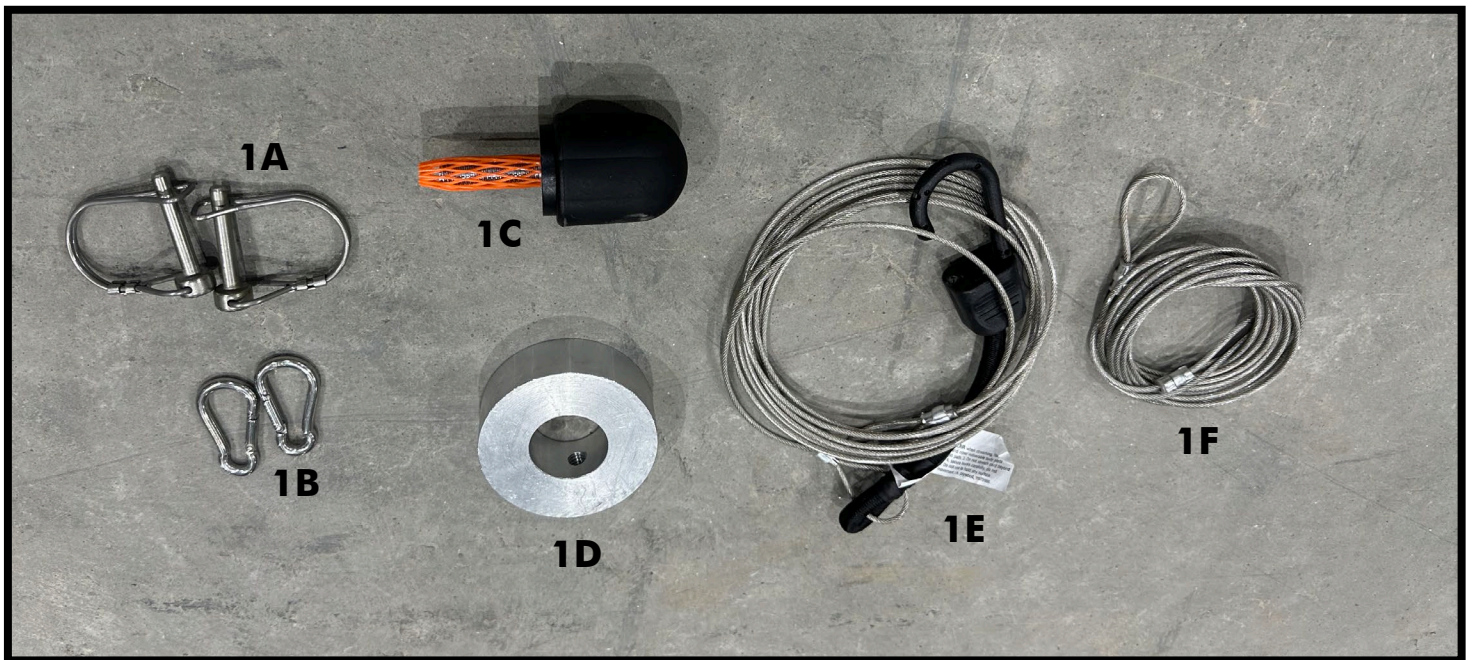

ASSEMBLY

REFER TO THE INSTRUCTIONS INCLUDED WITH THE DOCK ANCHOR KITS FOR ASSEMBLY (INSTRUCTION P/N: 610-02555-00) UNTIL THE STEP WHERE THE ANCHORS ARE BEING DRIVEN INTO THE LAKE BOTTOM.

NOTE THAT THE ATTACHMENT OF THE ANCHOR DRIVER TO THE DOCK ANCHOR WILL PRIMARILY BE DONE ON TOP OF THE DOCK OR IN THE WATER, AS THE ANCHORS WILL BE INSTALLED ONTO THE DOCK LEGS WHEN THE DRIVER TOOL IS BEING ATTACHED TO THE ANCHOR.

SET COLLAR INSTALLATION (IF USING WRENCHES)

WITH THE SOFT GRIP KNOB STARTED INTO THE SET COLLAR (DO NOT TIGHTEN AT THIS TIME), SLIDE THE COLLAR ONTO THE **ANCHOR DRIVER (HEX SHAFT WITH SOCKET ATTACHED, IF NOT USING THE EXTENSION)** OR ONTO THE **ANCHOR DRIVER EXTENSION HEX SHAFT** (FIGURE 1.1). SLIDE THE COLLAR DOWN AND SECURE IT TEMPORARILY BY TIGHTENING UNTIL SNUG. THE PLACEMENT CAN BE ADJUSTED WHEN INSTALLING THE ANCHORS IN THE LAKE BOTTOM (FIGURE 1.2).

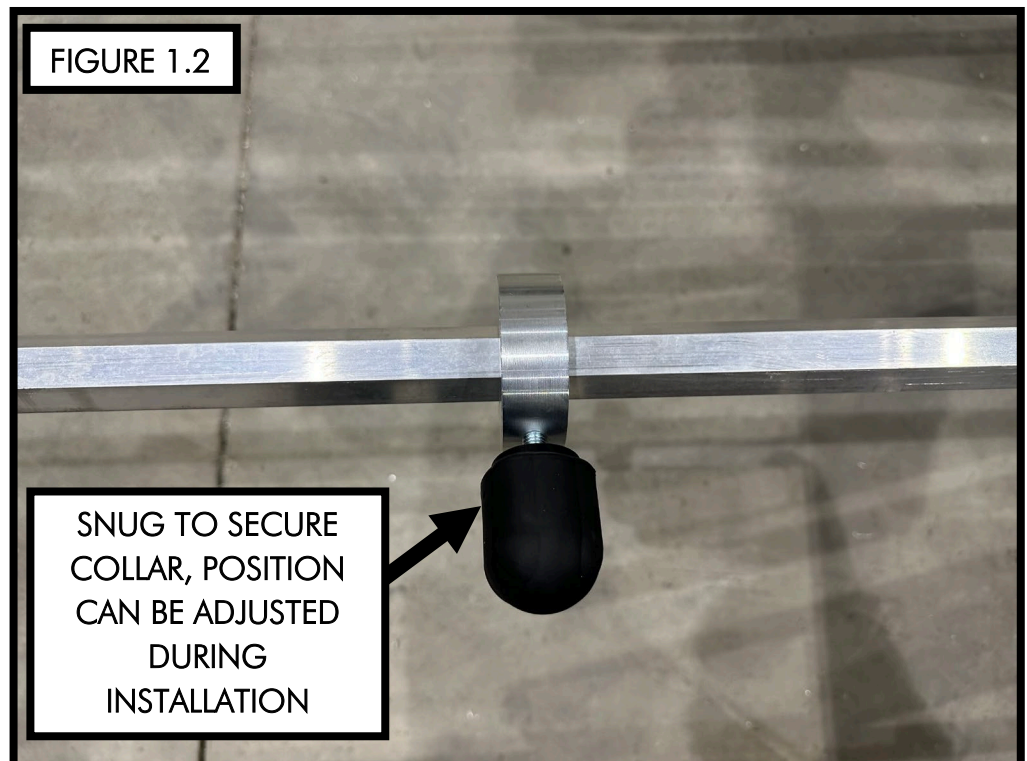
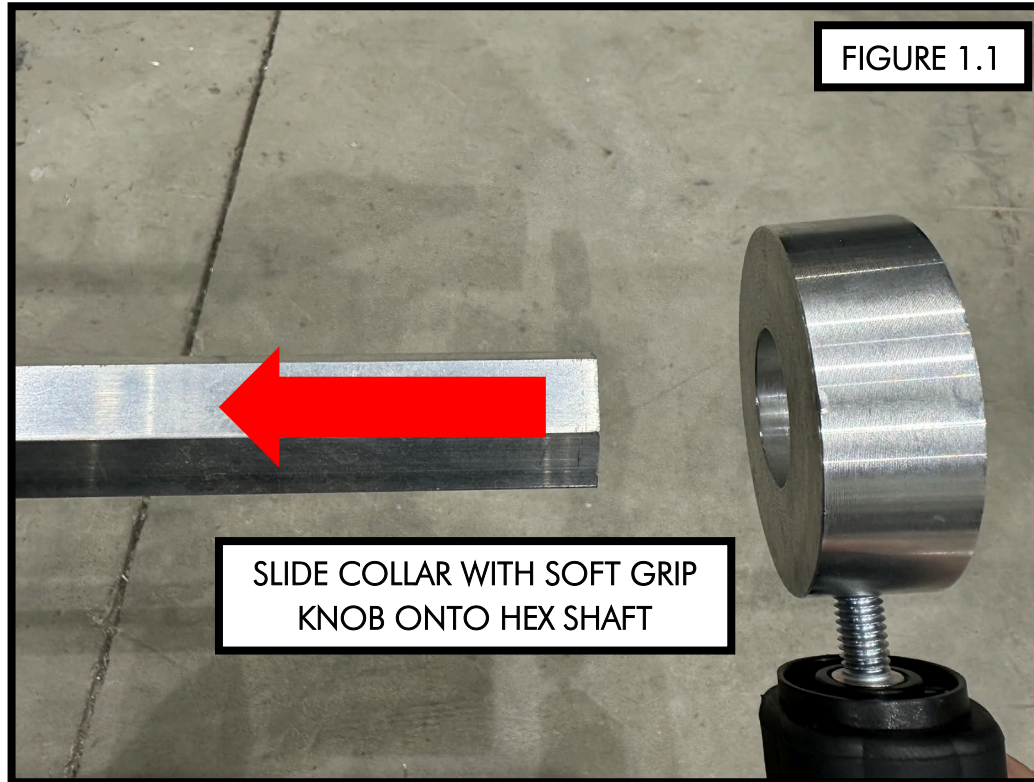

NOTE: THESE STEPS CAN BE DONE WHEN THE ANCHOR IS BEING DRIVEN INTO THE LAKE BOTTOM. SLIDE (2) 1-1/8" WRENCHES ONTO THE SHAFT (FIGURE 1.3) SO THEY ARE POSITIONED THAT THEY ARE OPPOSING EACH OTHER AS SHOWN (FIGURE 1.4).

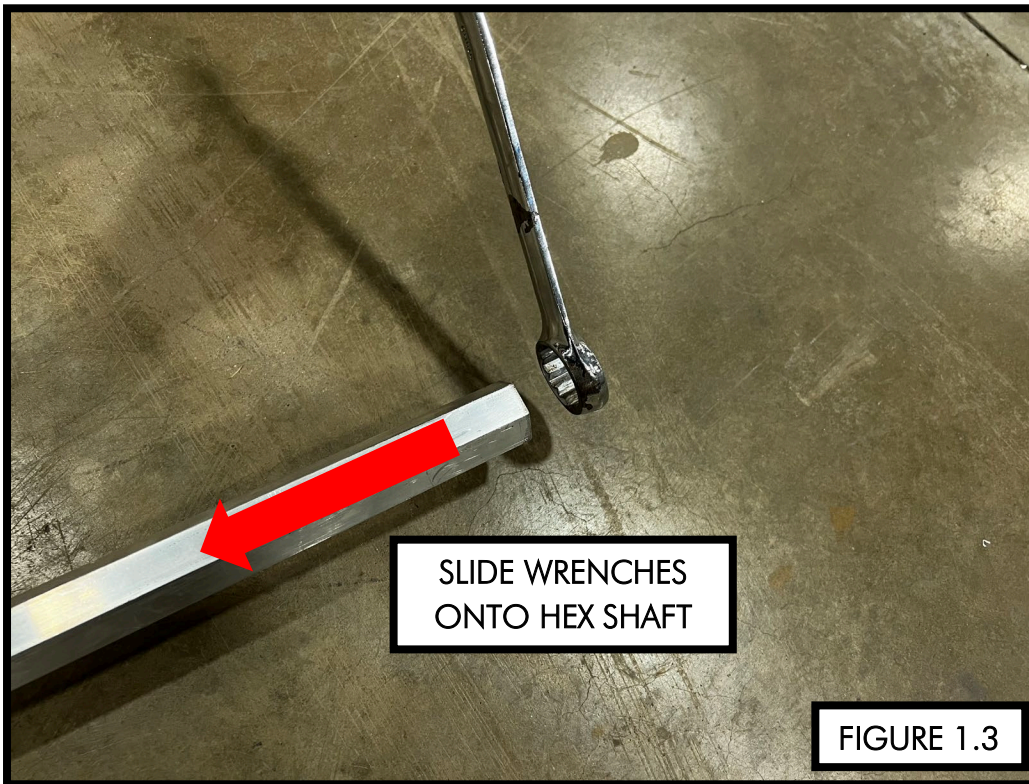

DRIVER EXTENSION ASSEMBLY

(SKIP STEP IF NOT INSTALLING EXTENSION)

INSERT THE DRIVER EXTENSION INTO THE TOP OF THE **ANCHOR DRIVER (HEX SHAFT WITH SOCKET ATTACHED TO IT)** AND LINE UP THE HOLES SHOWN (FIGURE 2.1). SECURE THE EXTENSION TO THE DRIVER WITH A CLEVIS PIN (FIGURE 2.2).

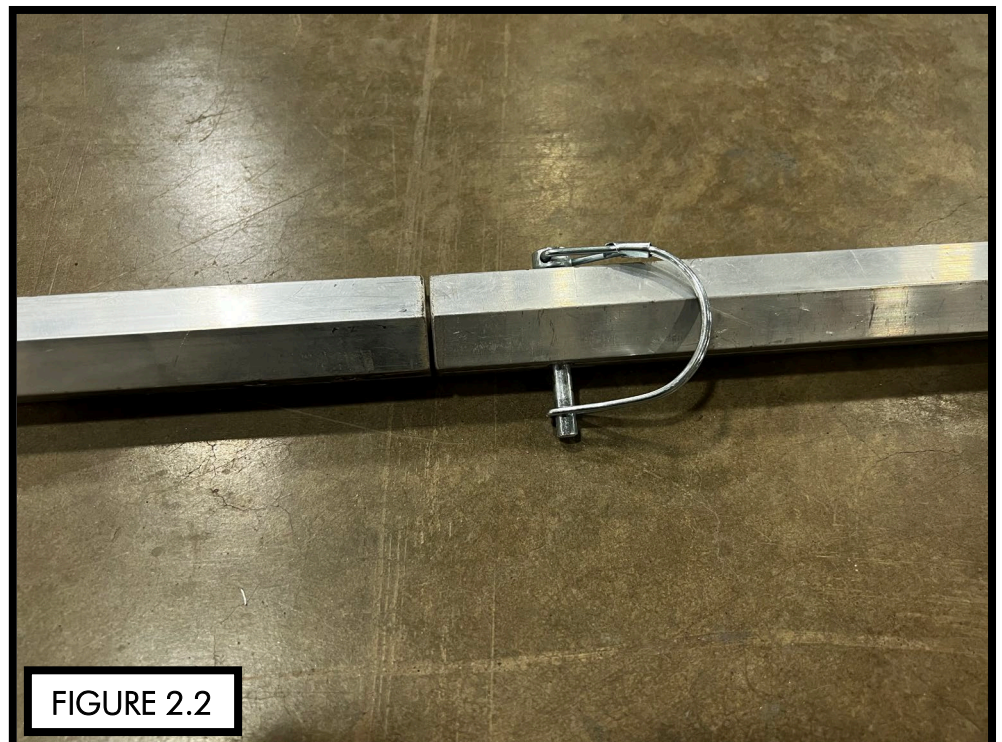
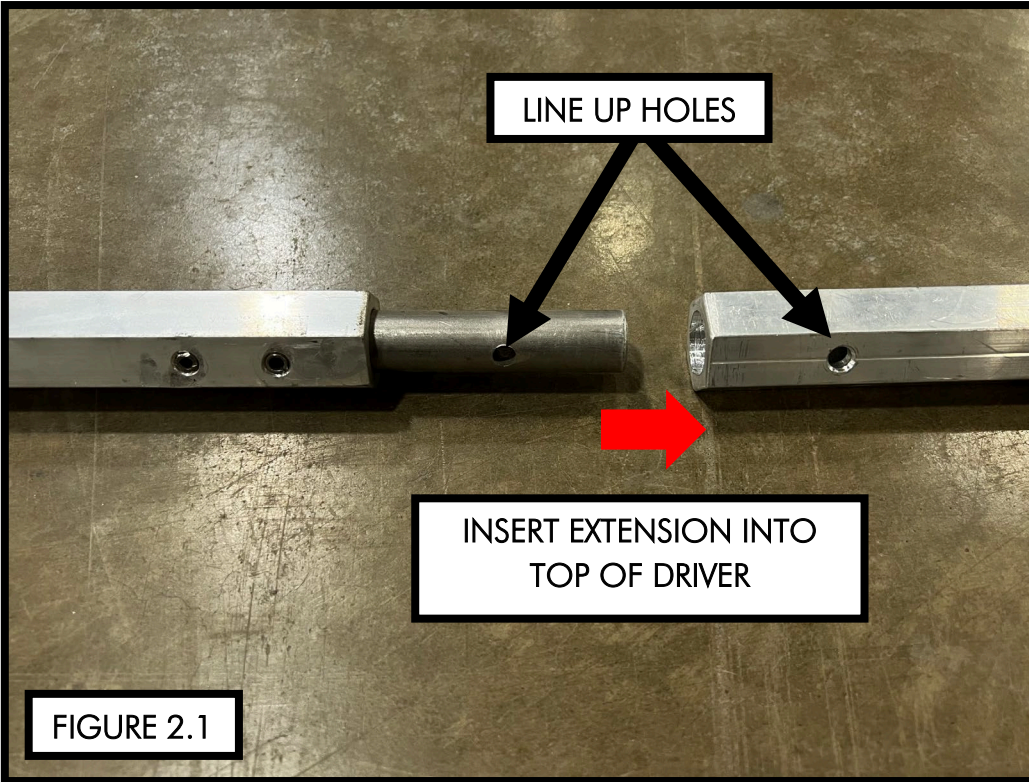

WITH THE ANCHOR INSERTED INTO THE ANCHOR DRIVER SOCKET, FEED THE **EXTENSION CABLE (CABLE WITHOUT SHOCK CORD ATTACHED)** INTO THE TAB ON THE ANCHOR COLLAR AS SHOWN (FIGURE 2.3). WITH A CLEVIS PIN INSTALLED INTO THE HOLE NEAR THE TOP OF THE EXTENSION SHAFT, ATTACH THE SHOCK CORD HOOK TO THE CLEVIS PIN. ATTACH A CARABINER TO THE LOOP ON THE SHOCK CORD (FIGURE 2.4).

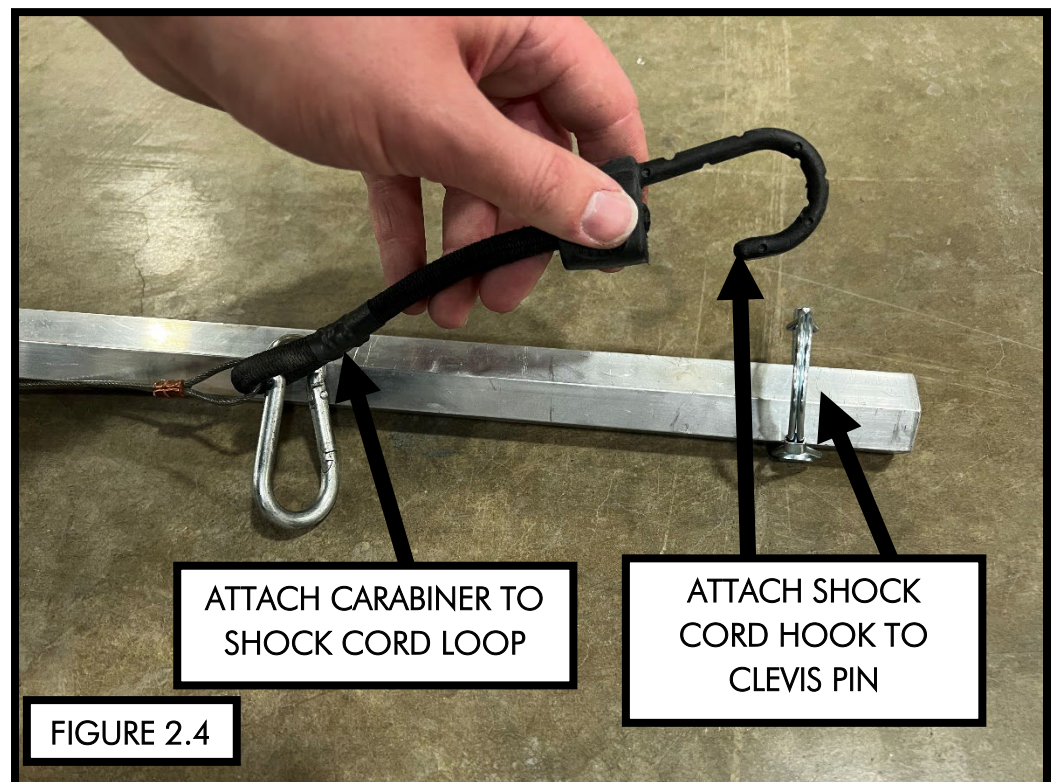
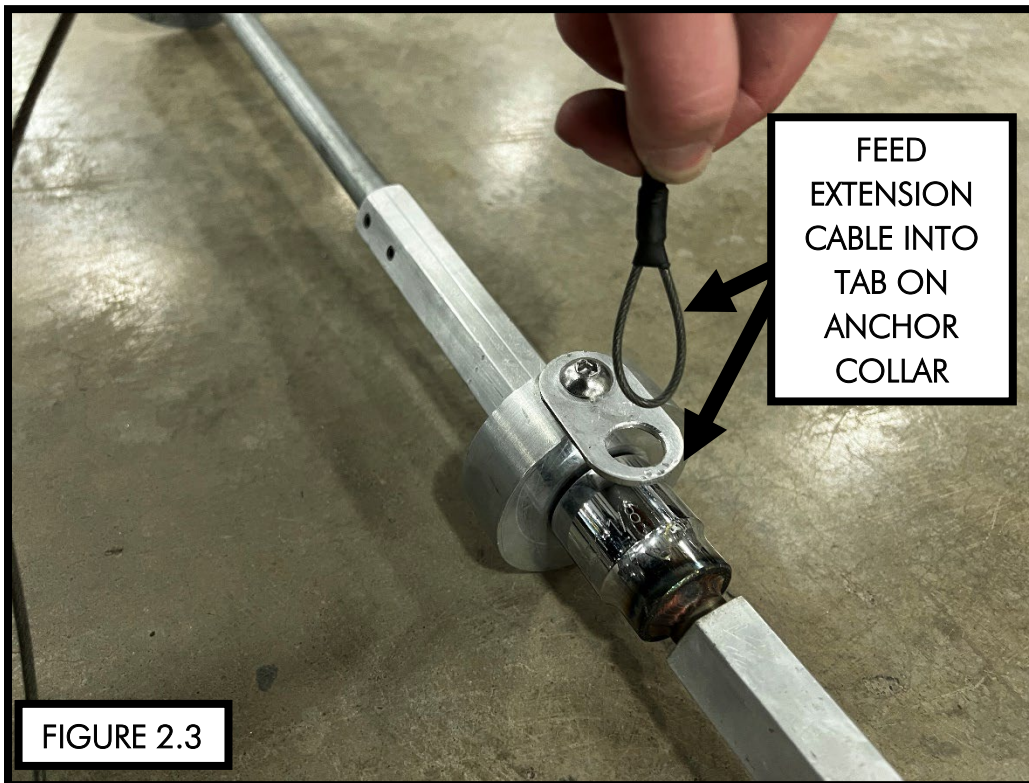

PULL THE **EXTENSION CABLE** TOWARDS THE TOP OF THE ANCHOR DRIVER (FIGURE 2.5). PULL THE CABLE TO THE CARABINER ON THE SHOCK CORD (FIGURE 2.6).

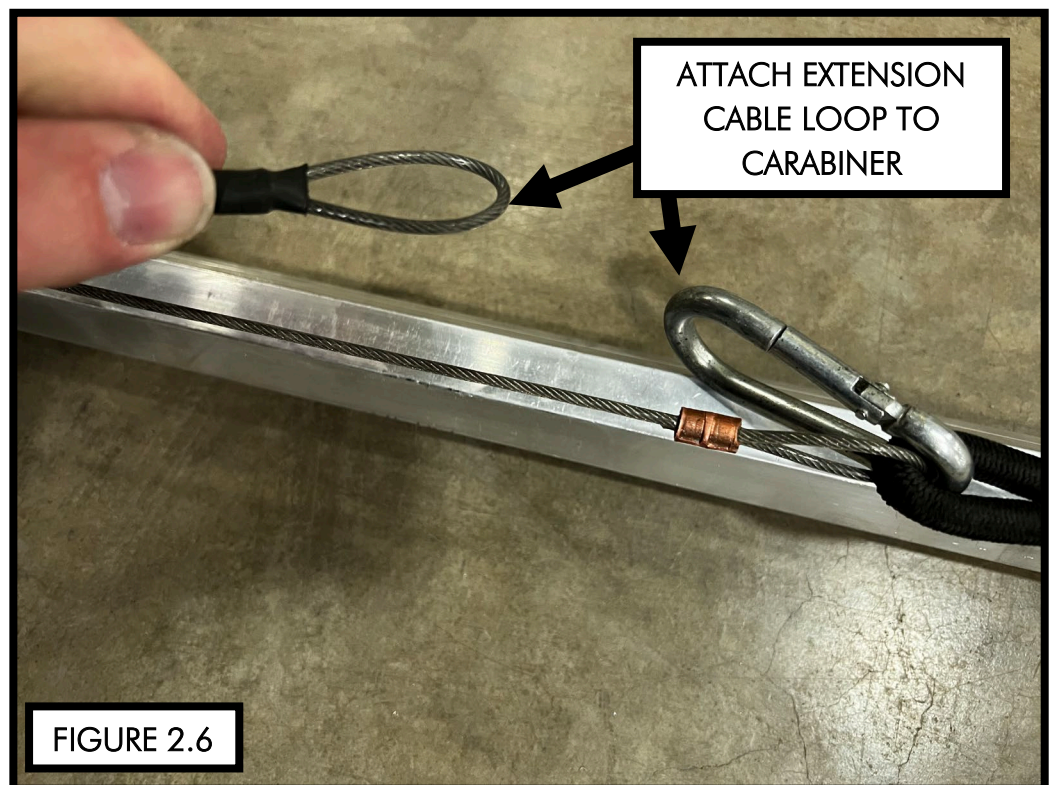
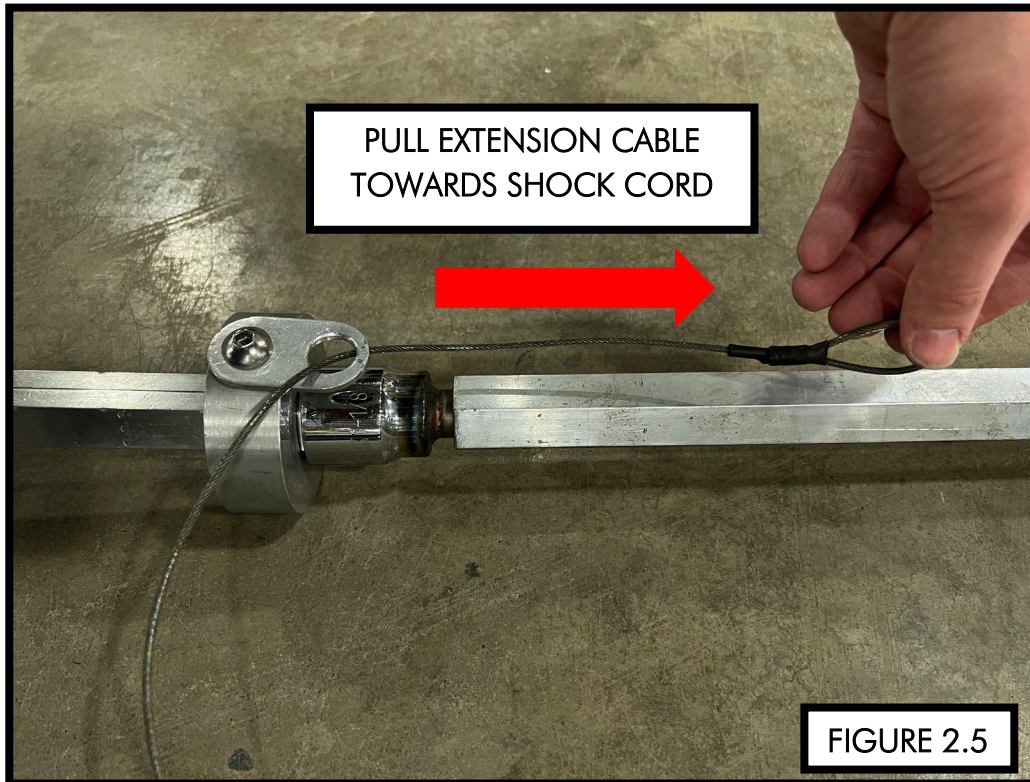

ATTACH THE CABLE LOOP TO THE CARABINER (FIGURE 2.7). ATTACH THE LOOP END OF THE **EXTENSION CABLE** TO THE LOOP END OF THE **RETENTION CABLE (CABLE WITH SHOCK CORD ATTACHED)** WITH A CARABINER (FIGURE 2.8).

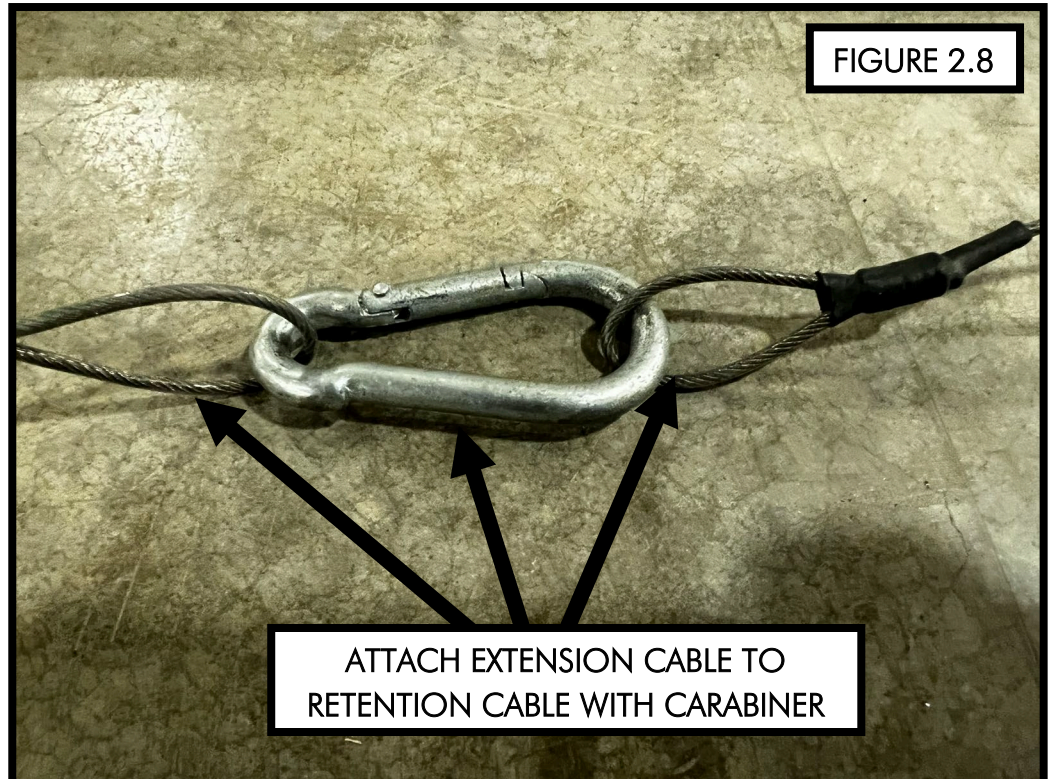
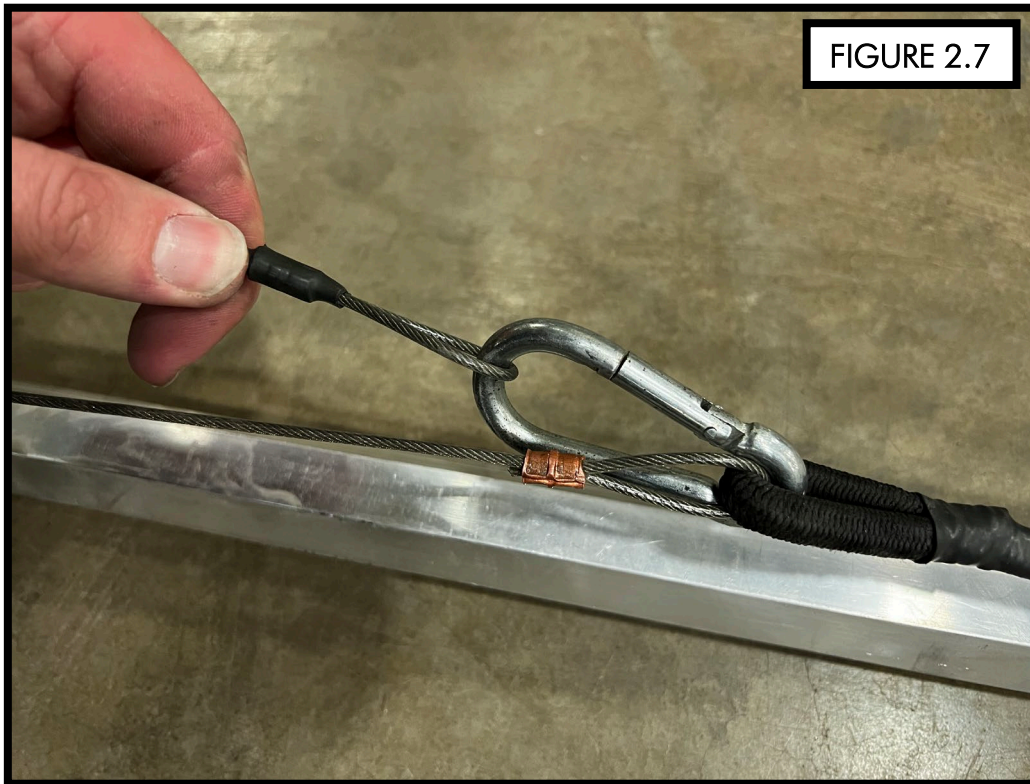

STANDARD ASSEMBLY

WITH THE ANCHOR INSERTED INTO THE ANCHOR DRIVER SOCKET, FEED THE **RETENTION CABLE (CABLE WITH THE SHOCK CORD ATTACHED)** INTO THE TAB ON THE ANCHOR COLLAR AS SHOWN (FIGURE 3.1). WITH A CLEVIS PIN INSTALLED INTO THE HOLE NEAR THE TOP OF THE **ANCHOR DRIVER (HEX SHAFT WITH SOCKET ATTACHED TO IT)**, ATTACH THE SHOCK CORD HOOK ONTO THE LOOP OF THE PIN. ATTACH A CARABINER TO THE LOOP ON THE SHOCK CORD (FIGURE 3.2).

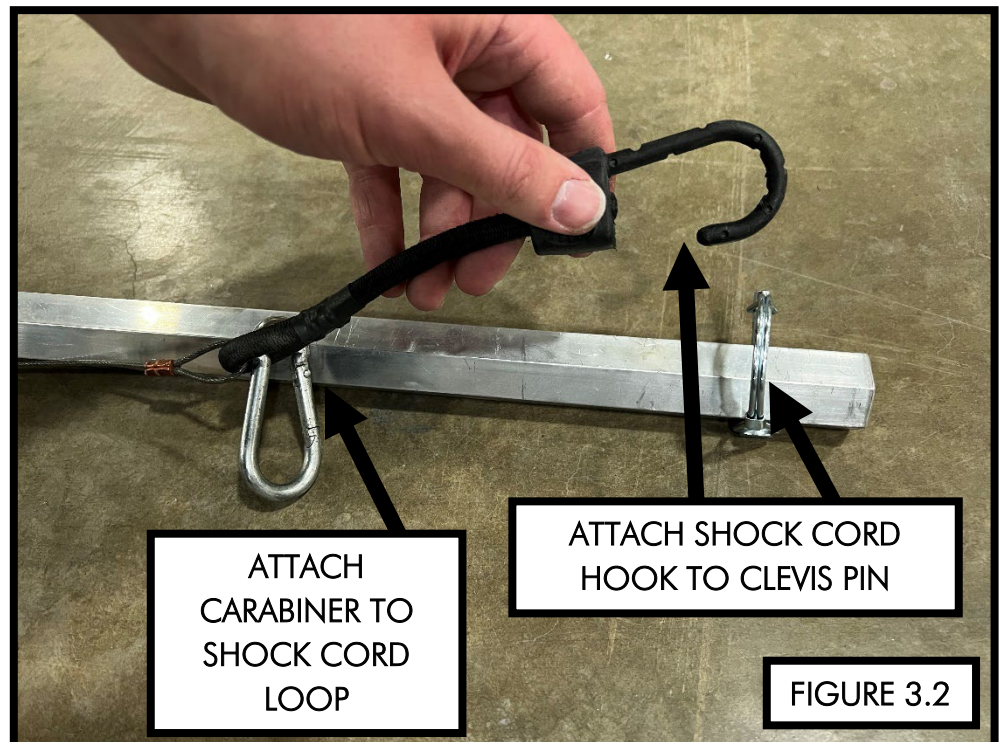
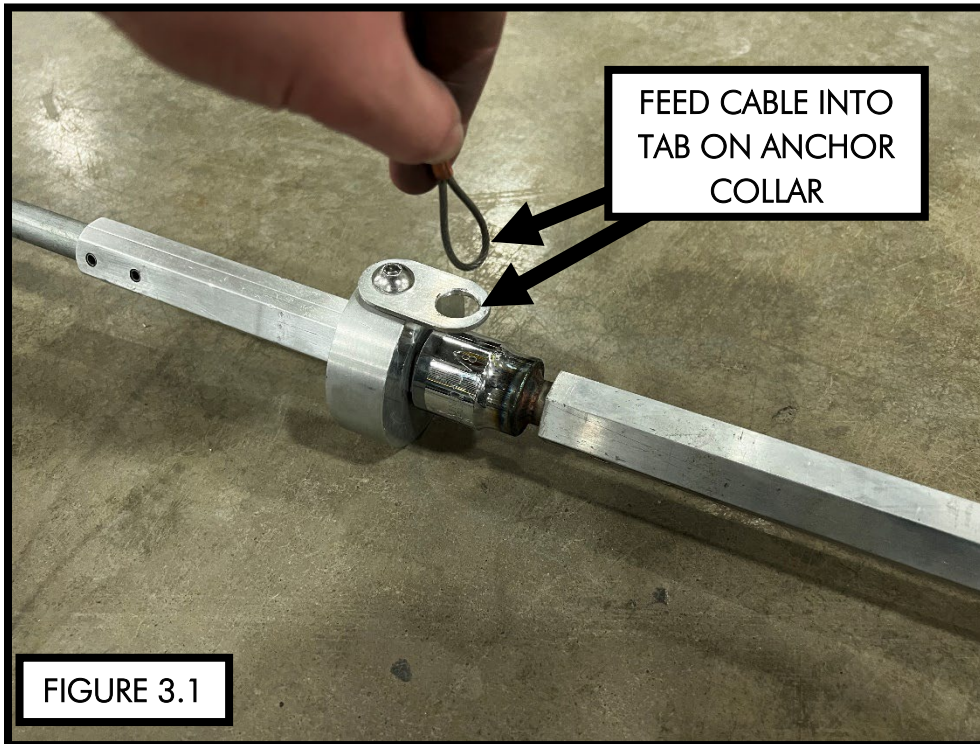

PULL THE **RETENTION CABLE** TOWARDS THE SHOCK CORD AT THE TOP OF THE HEX SHAFT (FIGURE 3.3). WITH THE CARABINER ATTACHED TO THE LOOP ON THE SHOCK CORD, PULL THE CABLE TO IT (FIGURE 3.4) AND ATTACH THE CABLE LOOP TO THE CARABINER (FIGURE 3.5).

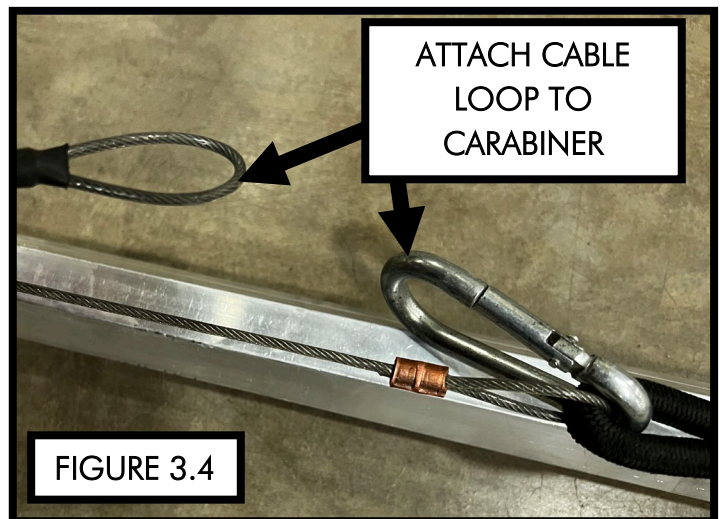
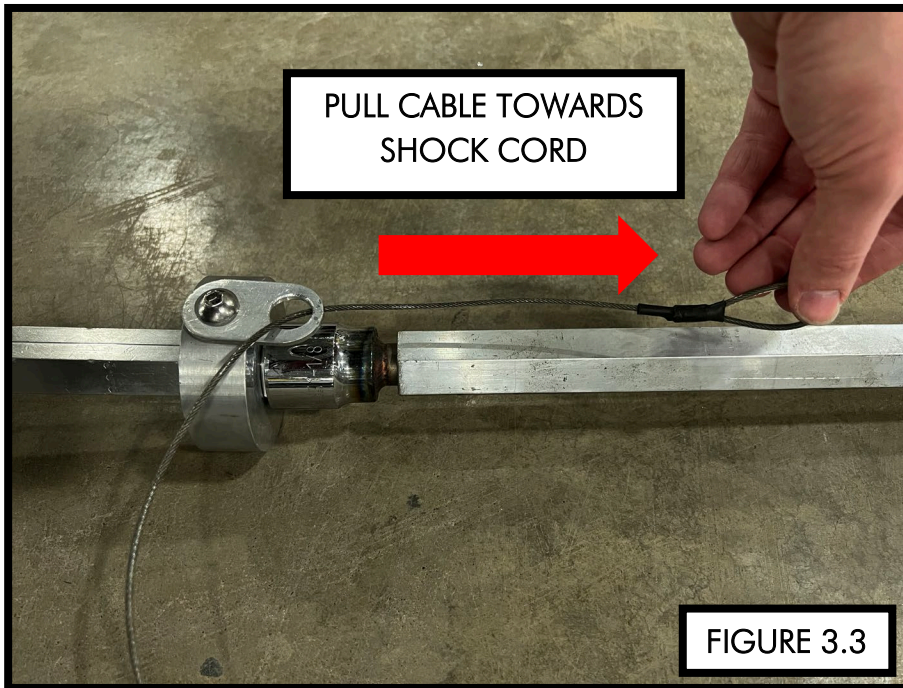

ANCHOR INSTALLATION (W/O EXTENSION SHOWN)

ORIENT THE DRIVER AND ANCHOR VERTICALLY AND LOWER UNTIL THE ANCHOR TOUCHES THE LAKE BOTTOM (FIGURE 4.1). DRIVE ANCHOR INTO THE LAKE BOTTOM USING (2) 1-1/8" WRENCHES WITH THE INCLUDED COLLAR OR USE A 1-1/8" **6 POINT** SOCKET & 1/2" DRIVE RATCHET UNTIL THE COLLAR ON THE DOCK ANCHOR TOUCHES THE LAKE BOTTOM (FIGURE 4.2).

FIGURE 4.1

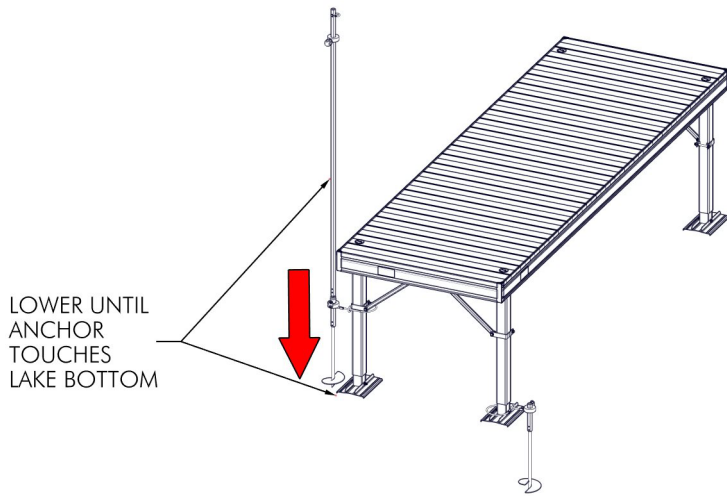

IMPORTANT NOTE:

ONLY USE A 6 POINT SOCKET.
12 POINT SOCKETS MAY CAUSE
DAMAGE TO HEX SHAFT.

IMPORTANT

DO NOT USE AN
IMPACT OR
CORDLESS DRILL TO
INSTALL ANCHORS.



6 POINT SOCKET



12 POINT SOCKET
DO NOT USE

FIGURE 4.2

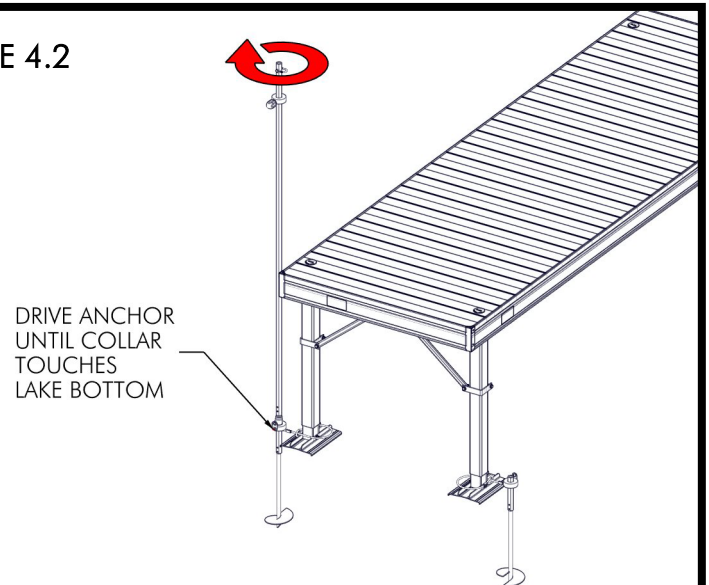

WHEN REMOVING THE CABLE FROM THE DOCK ANCHOR, DETACH ONE CABLE LOOP FROM THE CARABINER (FIGURE 4.3) AND PULL IT THROUGH THE TAB ON THE DOCK ANCHOR (FIGURE 4.4).

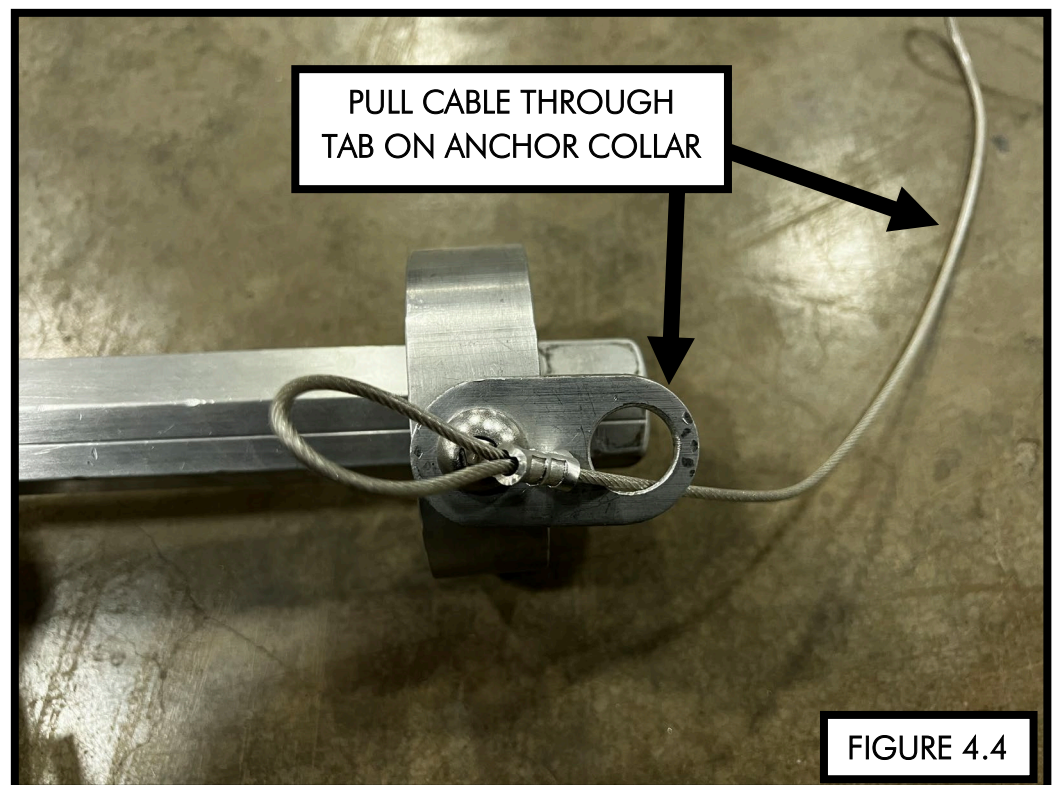
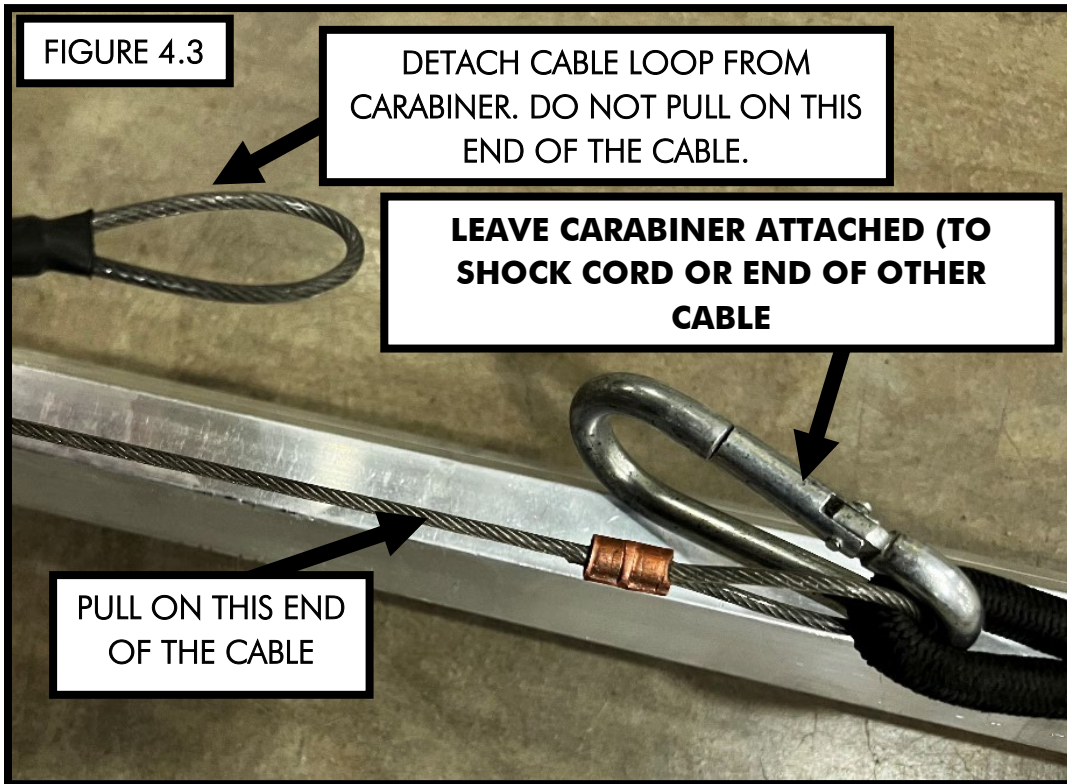

IMPORTANT: CARABINER WILL NOT PASS THROUGH THE TAB ON THE DOCK ANCHOR (FIGURE 4.5).

FIGURE 4.5

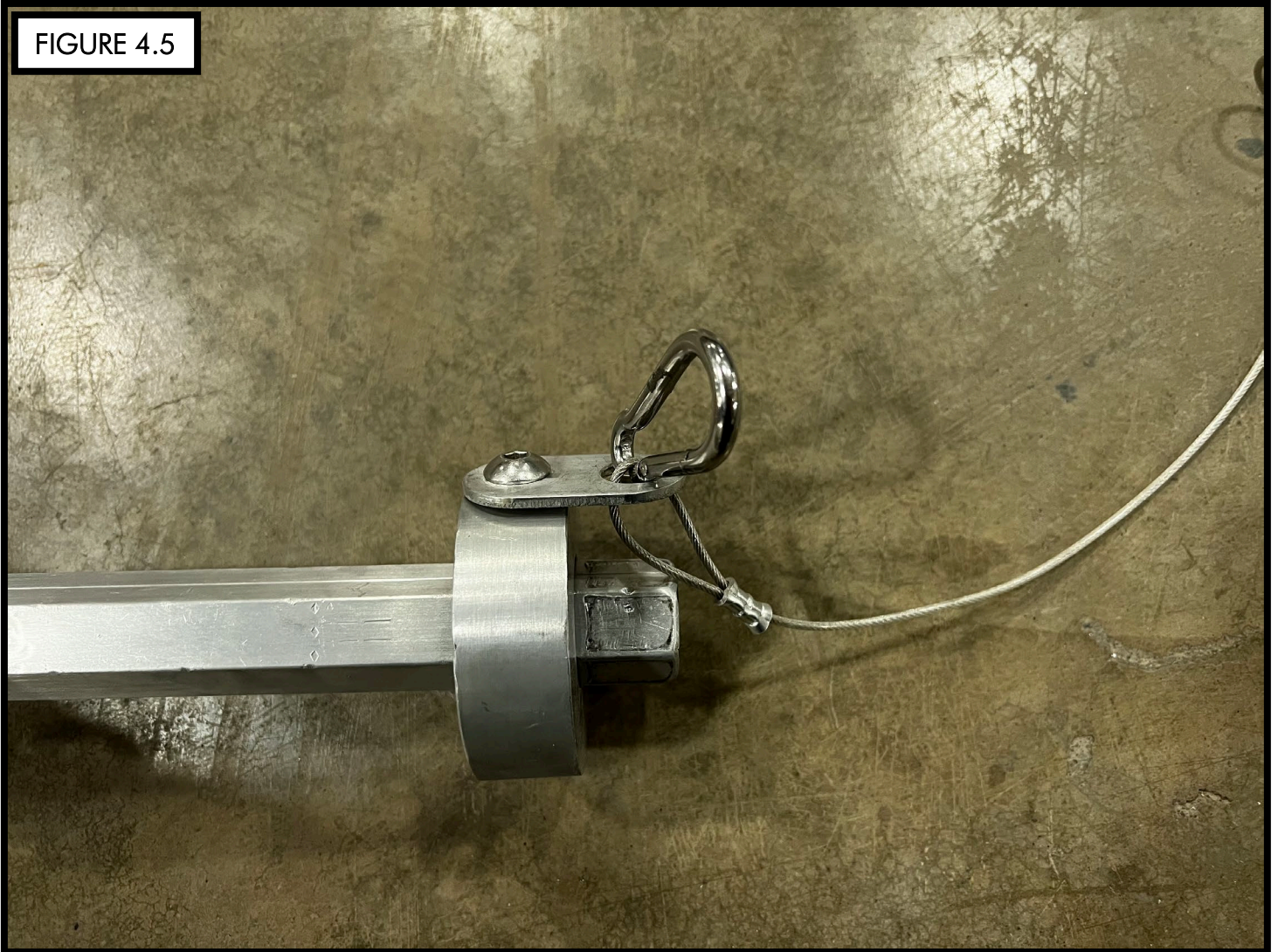

NOTES

