

FLOE DOCK STEPS

ASSEMBLY INSTRUCTIONS

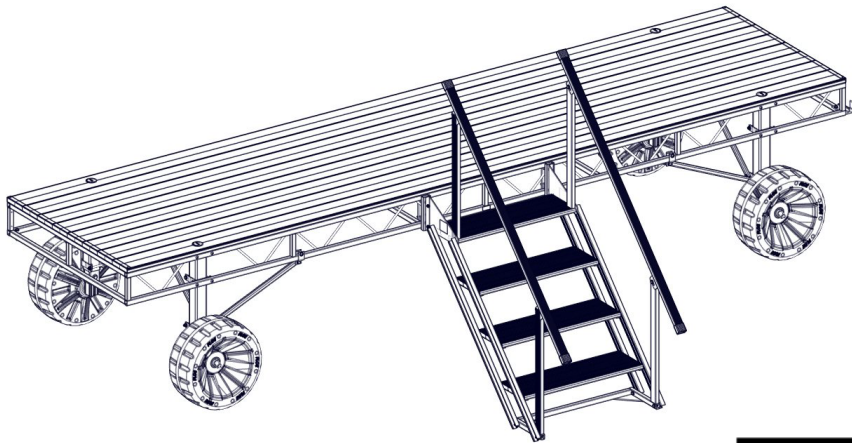

KIT P/N 510-42000-01 4 STEP (WATER DEPTHS UP TO 32")
510-42010-01 6 STEP (WATER DEPTHS 21" TO 53")
510-42015-01 8 STEP (WATER DEPTHS 41" TO 74")



! WARNING

**MULTIPLE
PINCH POINTS
KEEP HANDS &
FEET CLEAR OF
ALL MOVING
PARTS DURING
ASSEMBLY &
INSTALLATION.**

NOTE

If you live in a cold climate that requires removal of your steps in the fall, special attention needs to be taken to make sure that the drain holes are unobstructed to provide proper drainage.

*DOCK SECTION NOT INCLUDED

ACCESSORY ATTACHMENT KITS

THESE ARE REQUIRED IN ADDITION TO THE STAIRS, SPECIFIC TO EACH DOCK STYLE

- 510-02327-00 (STANDARD ROLL-IN DOCKS)
- 510-02328-00 (STANDARD SECTIONAL DOCKS)
- 510-02605-00 (QUICK ATTACH ROLL-IN DOCKS (BRACKETS AND HARDWARE))
- 510-02575-00 (QUICK ATTACH SECTIONAL DOCKS (BRACKETS & HARDWARE))

TOOLS REQUIRED

- (2) 9/16" SOCKETS/WRENCHES
- TORQUE WRENCH

BILL OF MATERIALS

510-42000-01 4 STEP DOCK STAIRS

DOCK DECK IS 16" ABOVE WATER

P/N 510-42001-03	STAIRS, DOCK 4 STEP		
NUMBER	PART NUMBER	DESCRIPTION	QTY
1	001-42000-03	FASTENER KIT, DOCK STEPS (4)	1
2	002-00114-00	PLANK, DOCK STEP - 31.688"	3
3	002-02010-00	CAP, STEP ANGLE - 9.75"	6
4	002-42010-00	TUBE, MOUNTING 1 x 2 x 8"	2
5	110-42002-01	WELDMENT, BOTTOM	1
6	110-42022-00	ASS'Y, TOP STEP W/ RAIL SUPPORT	1
6A	001-74444-00	CB, 3/8-16 x 3/4" SS 18-8	4
6B	001-76071-00	NUT, NYLOCK 3/8-16 ALUM.	4
6C	110-42021-00	WELD'T, TOP STEP W/RAIL SUPPORT	1

P/N 001-42000-03	FASTENER KIT, DOCK STEPS (4)		
NUMBER	PART NUMBER	DESCRIPTION	QTY
1A	001-37026-00	NUT, 3/8-16 JAM NYLOCK-ZINC	4
1B	001-70110-00	HHCS, 3/8-16 X 1-3/4" 18-8 SS	4
1C	001-70111-00	HHCS, 3/8-16 x 2" 18-8 SS	4
1D	001-71017-00	FLAT WASHER, 3/8" SAE SS 18-8	32
1E	001-75288-00	HHCS, 3/8-16 x 1-1/4 W/NYL	16
1F	001-76071-00	NUT, NYLOCK 3/8-16 ALUM.	4

P/N 510-42002-01	STAIRS, DOCK 4 STEP (RAILS)		
NUMBER	PART NUMBER	DESCRIPTION	QTY
7	002-42009-00	U-CHANNEL, STRINGER – 49.811"	4
8	110-42010-00	ASS'Y, HANDRAIL STAIRS – 70"	2

EXPLODED VIEW

510-42000-01 4 STEP DOCK STAIRS

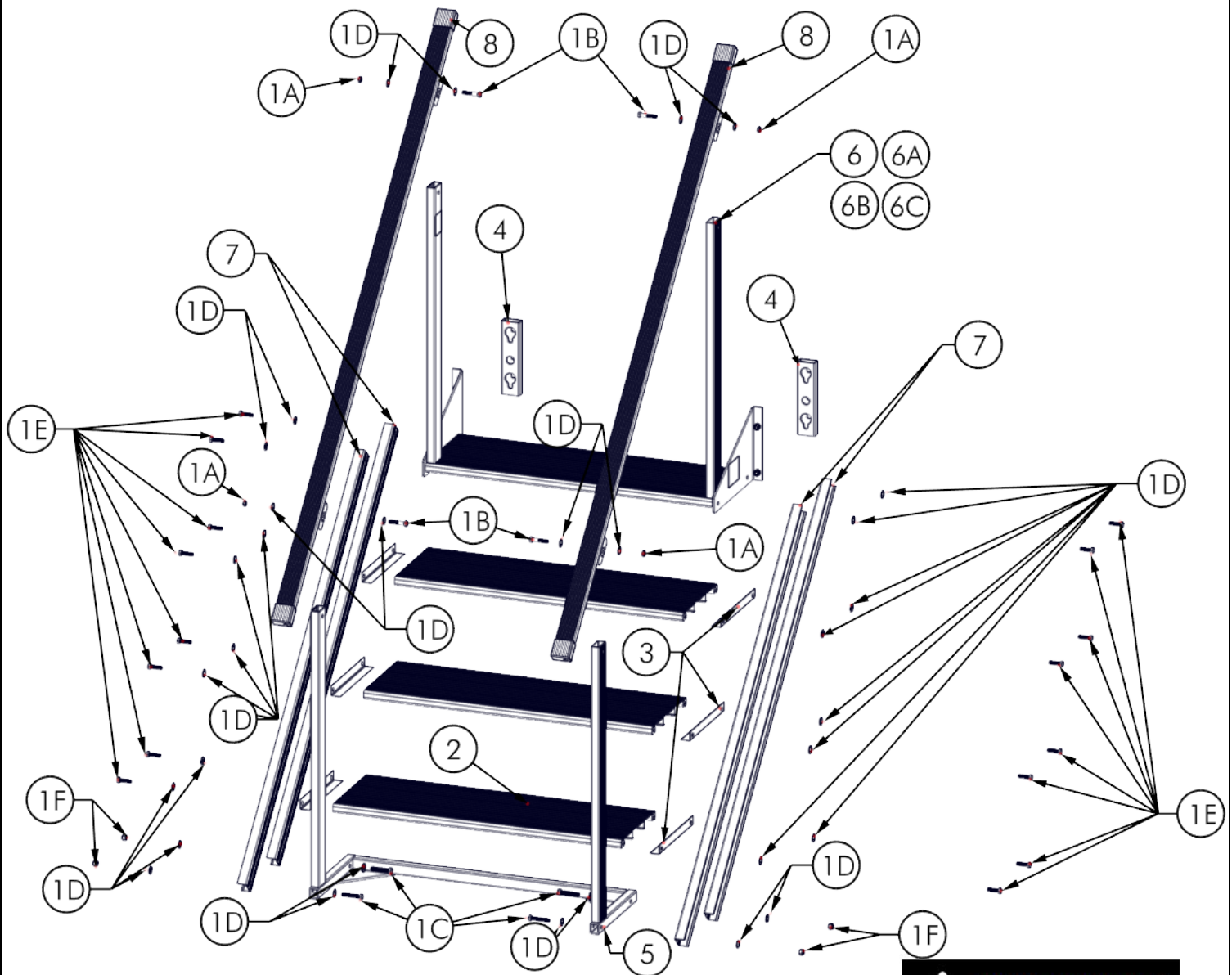

! WARNING

**MULTIPLE
PINCH POINTS
KEEP HANDS &
FEET CLEAR OF
ALL MOVING
PARTS DURING
ASSEMBLY &
INSTALLATION.**

BILL OF MATERIALS

510-42010-01 6 STEP DOCK STAIRS

DOCK DECK IS 16" ABOVE WATER

P/N 510-42011-03	STAIRS, DOCK 6 STEP		
NUMBER	PART NUMBER	DESCRIPTION	QTY
1	001-42010-03	FASTENER KIT, DOCK STEPS (6)	1
2	002-00114-00	PLANK, DOCK STEP – 31.688"	5
3	002-02010-00	CAP, STEP ANGLE – 9.75"	10
4	002-42010-00	TUBE, MOUNTING 1 X 2 X 8"	2
5	110-42002-01	WELDMENT, BOTTOM	1
6	110-42022-00	ASS'Y, TOP STEP W/ RAIL SUPPORT	1
6A	001-74444-00	CB, 3/8-16 X 3/4" SS 18-8	4
6B	001-76071-00	NUT, NYLOCK 3/8-16 ALUM.	4
6C	110-42021-00	WELD'T, TOP STEP W/ RAIL SUPPORT	1

P/N 001-42010-03	FASTENER KIT, DOCK STEPS (6)		
NUMBER	PART NUMBER	DESCRIPTION	QTY
1A	001-37026-00	NUT, 3/8-16 JAM NYLOCK-ZINC	4
1B	001-70110-00	HHCS, 3/8-16 X 1-3/4" 18-8 SS	4
1C	001-70111-00	HHCS, 3/8-16 x 2" 18-8 SS	4
1D	001-71017-00	FLAT WASHER, 3/8" SAE SS 18-8	40
1E	001-75288-00	HHCS, 3/8-16 x 1-1/4 W/NYL	24
1F	001-76071-00	NUT, NYLOCK 3/8-16 ALUM.	4

P/N 510-42012-00	STAIRS, DOCK 6 STEP (RAILS)		
NUMBER	PART NUMBER	DESCRIPTION	QTY
7	002-42011-00	U-CHANNEL, STRINGER – 75.811"	4
8	110-42016-00	ASS'Y, 96" HANDRAIL	2

EXPLODED VIEW

510-42010-01 6 STEP DOCK STAIRS

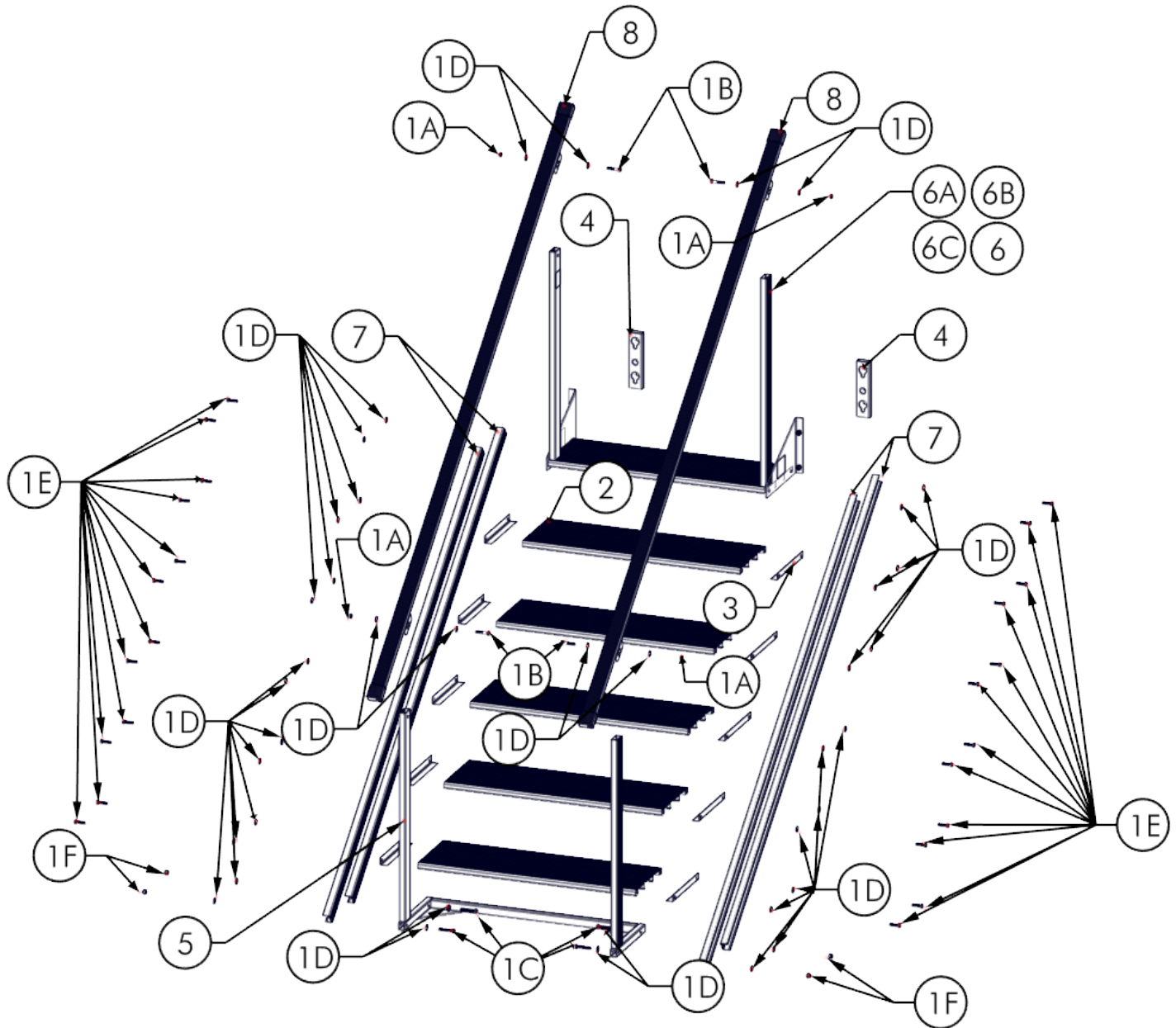

! WARNING

**MULTIPLE
PINCH POINTS
KEEP HANDS &
FEET CLEAR OF
ALL MOVING
PARTS DURING
ASSEMBLY &
INSTALLATION.**

BILL OF MATERIALS

510-42015-01 8 STEP DOCK STAIRS

DOCK DECK IS 16" ABOVE WATER

P/N 510-42016-03	STAIRS, DOCK 8 STEP		
NUMBER	PART NUMBER	DESCRIPTION	QTY
1	001-42015-03	FASTENER KIT, DOCK STEPS (8)	1
2	002-00114-00	PLANK, DOCK STEP – 31.688"	6
3	002-02010-00	CAP, STEP ANGLE – 9.75"	14
4	002-42010-00	TUBE, MOUNTING 1 x 2 x 8"	2
5	110-42002-01	WELDMENT, BOTTOM	1
6	110-42022-00	ASS'Y, TOP STEP W/ RAIL SUPPORT	1
6A	001-74444-00	CB, 3/8-16 x 3/4" S 18-8	4
6B	007-76071-00	NUT, NYLOCK 3/8-16 ALUM.	4
6C	110-42021-00	WELD'T, TOP STEP W/ RAIL SUPPORT	1
7	110-42024-00	ASS'Y, MID STEP W/ RAIL SUPPORT	1

P/N 001-42015-03	FASTENER KIT, DOCK STEPS (8)		
NUMBER	PART NUMBER	DESCRIPTION	QTY
1A	001-37026-00	NUT, 3/8-16 JAM NYLOCK-ZINC	6
1B	001-70110-00	HHCS, 3/8-16 X 1-3/4" 18-8 SS	6
1C	001-70111-00	HHCS, 3/8-16 x 2" 18-8 SS	4
1D	001-71017-00	FLAT WASHER, 3/8" SAE SS 18-8	52
1E	001-75288-00	HHCS, 3/8-16 x 1-1/4 W/NYL	32
1F	001-76071-00	NUT, NYLOCK 3/8-16 ALUM.	8

P/N 510-42017-00	STAIRS, DOCK 8 STEP (RAILS)		
NUMBER	PART NUMBER	DESCRIPTION	QTY
8	002-42012-00	U-CHANNEL, STRINGER – 101.811"	4
9	110-42018-00	ASS'Y, 122" HANDRAIL	2

EXPLODED VIEW

510-42015-01 8 STEP DOCK STAIRS

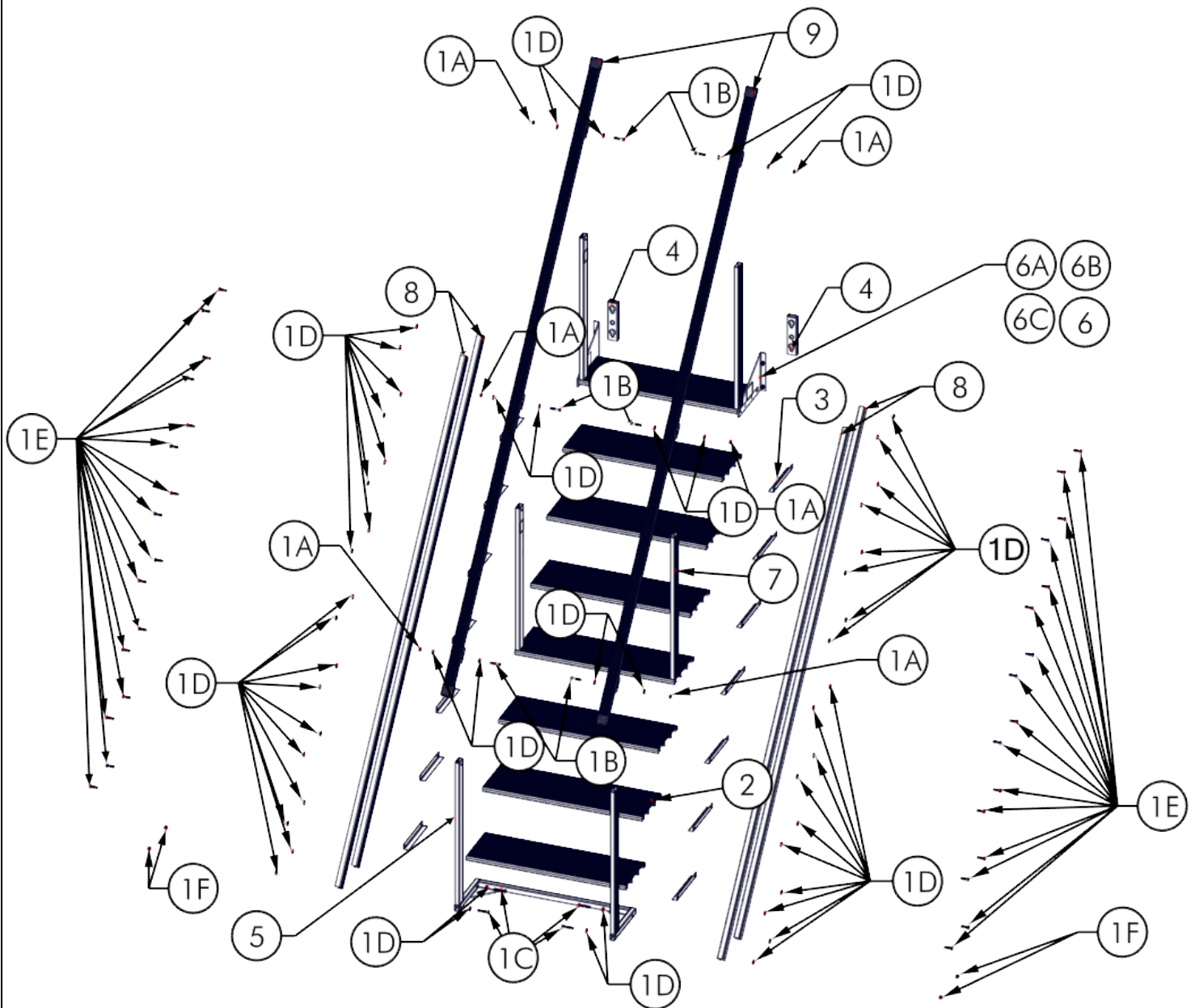

! WARNING

**MULTIPLE
PINCH POINTS
KEEP HANDS &
FEET CLEAR OF
ALL MOVING
PARTS DURING
ASSEMBLY &
INSTALLATION.**

ASSEMBLY

STEP 1

PLACE STRINGERS WITH HOLES SPACED $9\text{--}9/16"$ APART ONTO BOTTOM HANDRAIL ASSEMBLY (FIGURE 1.1). ATTACH THE (4) STRINGERS TO THE BOTTOM HANDRAIL ASSEMBLY USING (4) $3/8"$ X $2"$ BOLTS, (8) $3/8"$ WASHERS, AND (4) $3/8"$ NYLOCK NUTS (FIGURE 1.2). PLACE END CAPS ON EACH STEP, 4 STEP IS SHOWN (FIGURE 1.3).

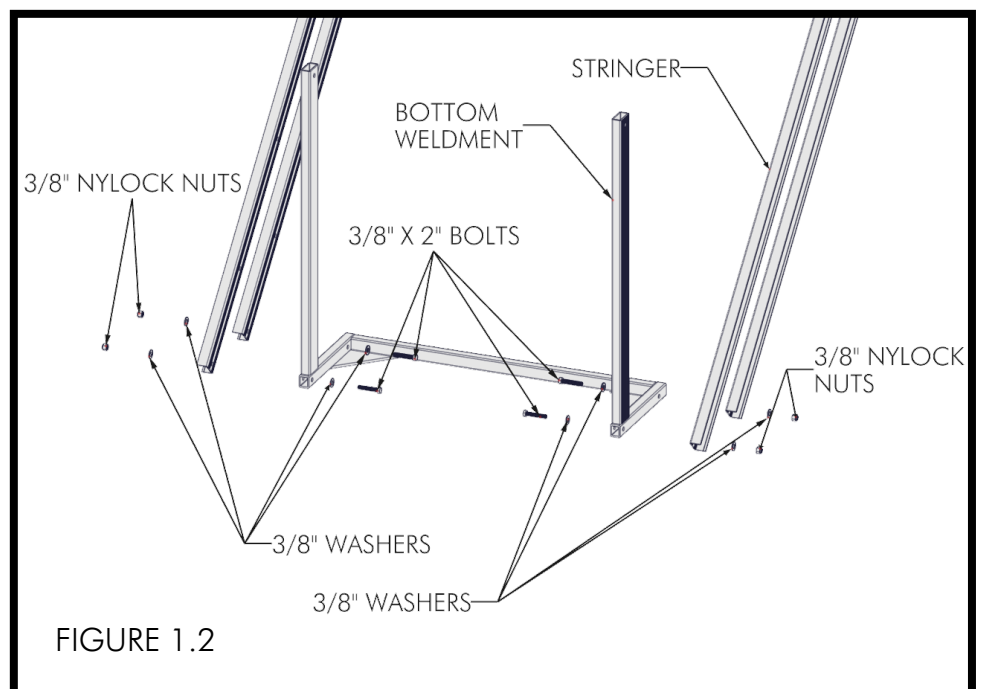
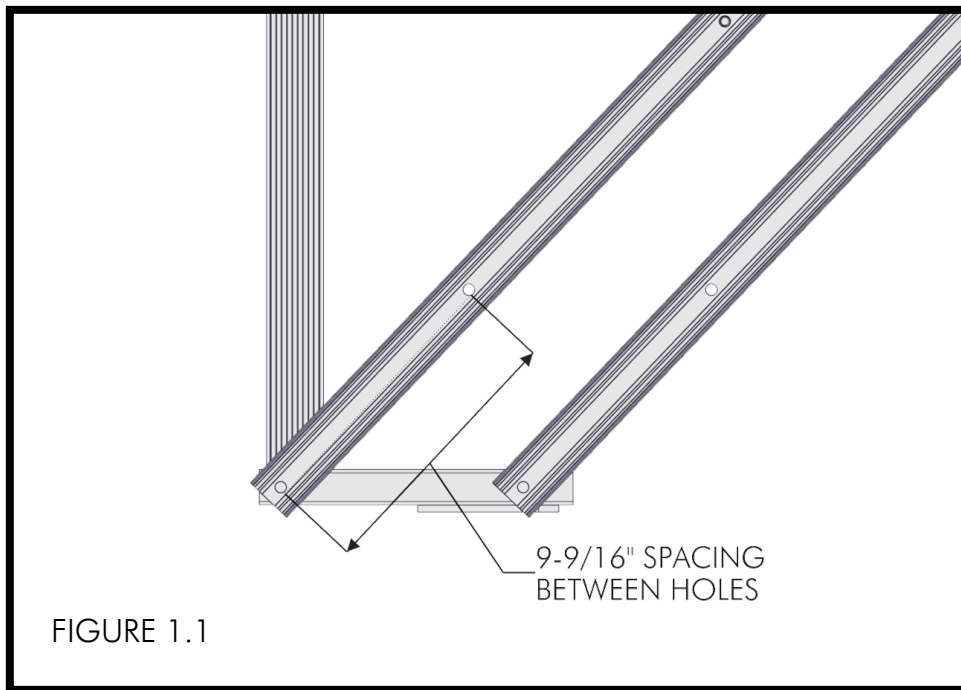

PLACE END CAPS ON EACH STEP, 4 STEP IS SHOWN (FIGURE 1.3). PLACE DOCK STEPS WITH END CAPS AND TOP STEP HANDRAIL SUPPORT ASSEMBLY BETWEEN STRINGERS AND ATTACH USING 3/8" X 1-1/4" BOLTS AND 3/8" WASHERS (FOR 4 STEPS, 16 BOLTS AND WASHERS. FOR 6 STEPS, 24 BOLTS AND WASHERS. FOR 8 STEPS, 32 BOLTS AND WASHERS) (FIGURE 1.4).

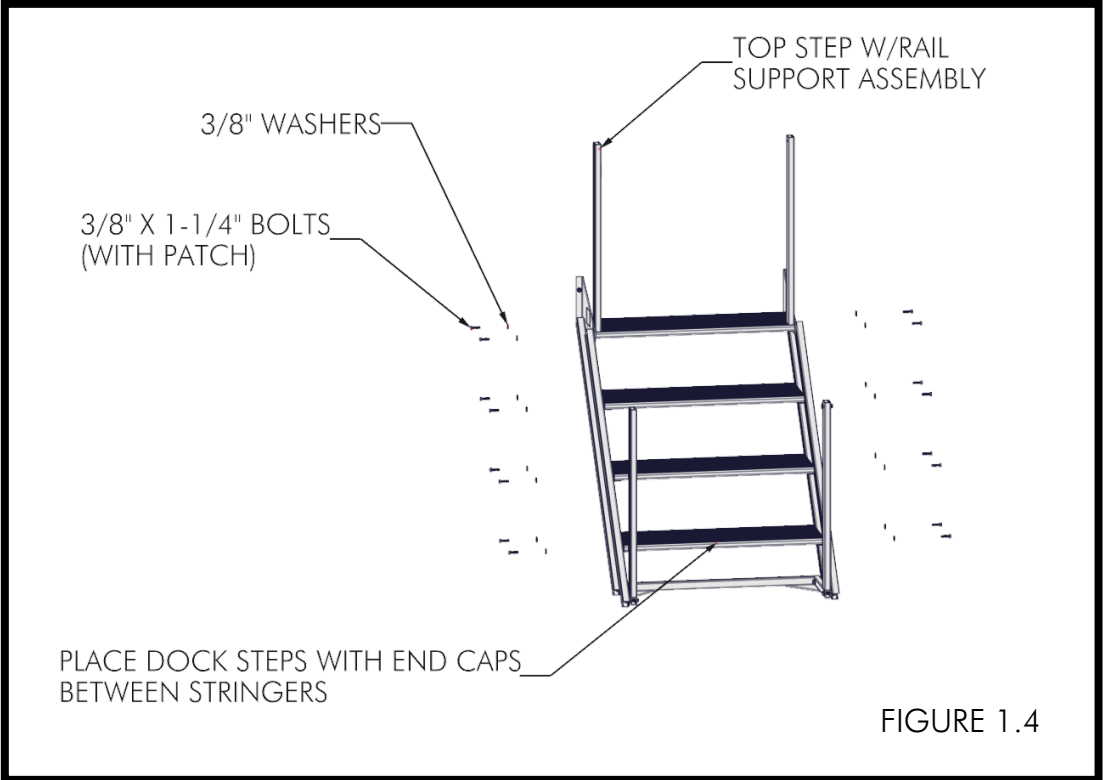
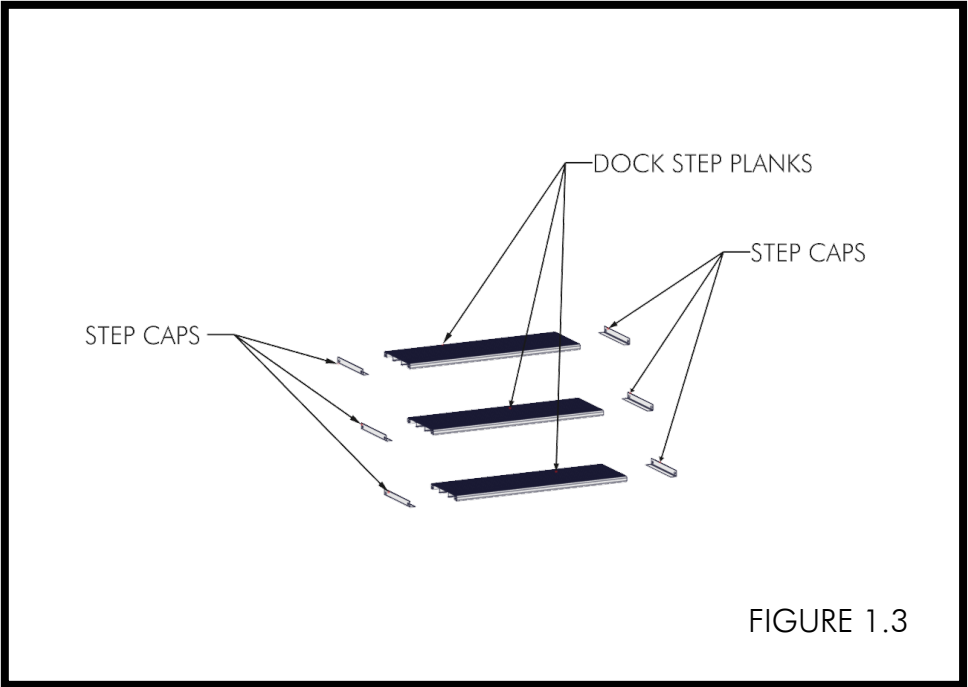

FOR 8 STEP STAIRS, A MID STEP HANDRAIL SUPPORT ASSEMBLY IS PLACED ON THE FIFTH SET OF HOLES FROM THE BOTTOM OF THE STAIRS (FIGURE 1.4A). SNUG DOWN ALL FASTENERS, BUT DO NOT OVERTIGHTEN. OVERTIGHTENING WILL PREVENT STEPS FROM LEVELING THEMSELVES (FIGURE 1.5).

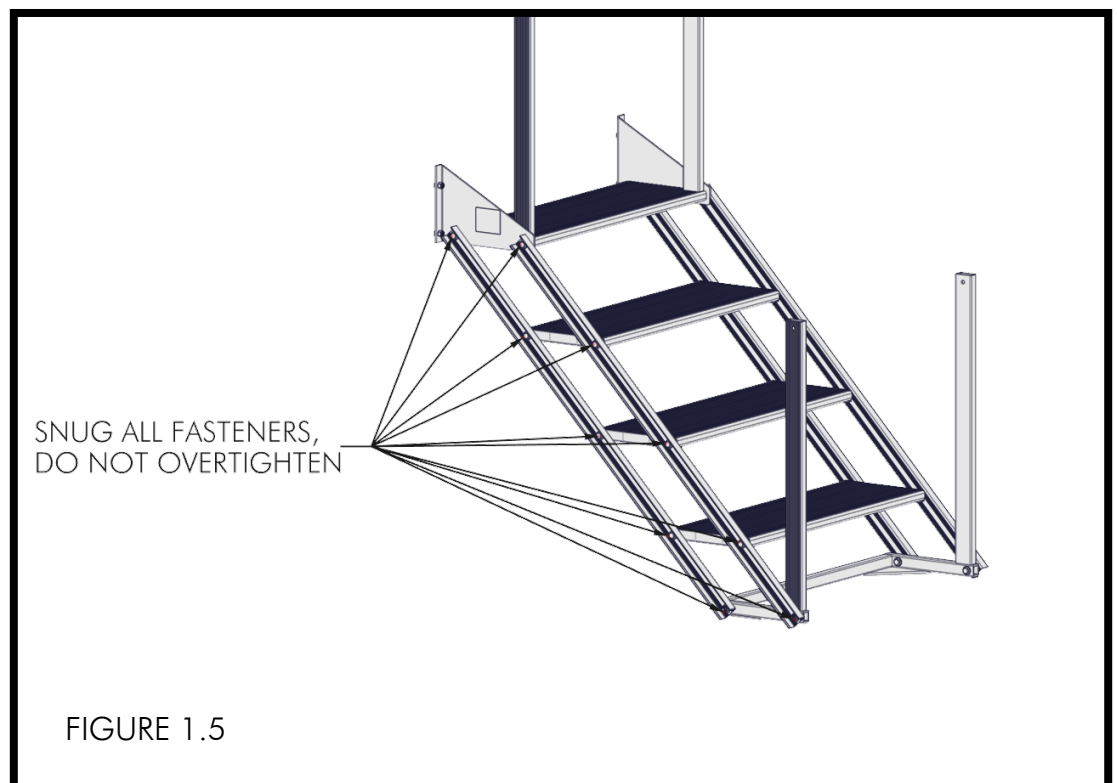
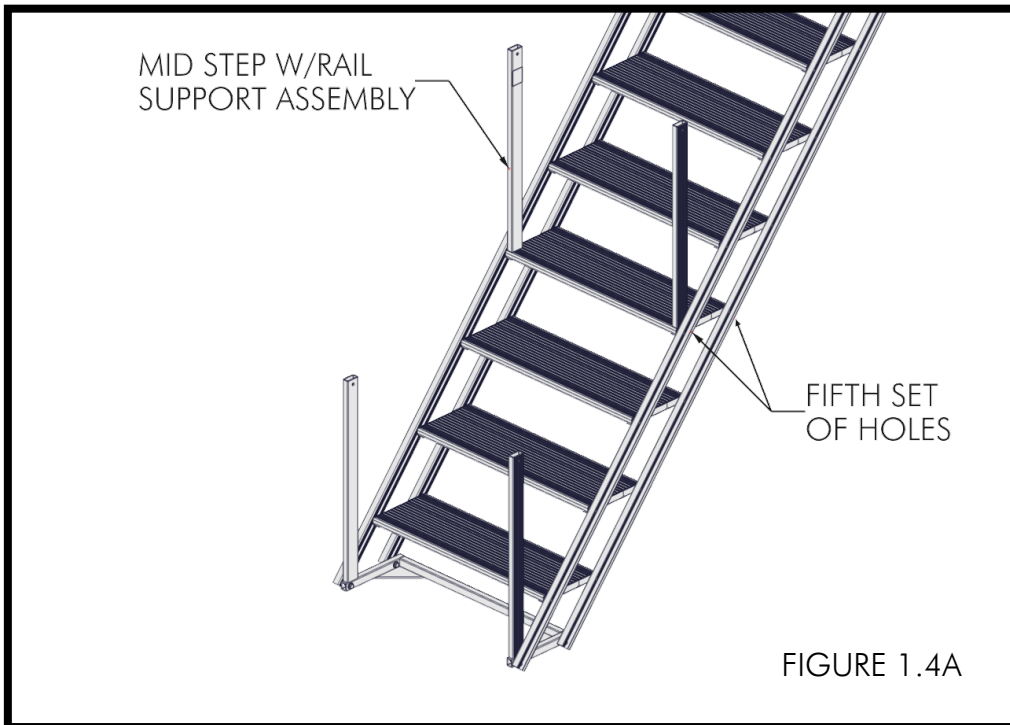

STEP 2

ATTACH HANDRAILS TO SUPPORTS USING 3/8" X 1-3/4" BOLTS, 3/8" WASHERS, AND 3/8" JAM NYLOCK NUTS (FIGURE 2.1). FOR 4 STEPS, 4 BOLTS, 8 WASHERS, AND 4 NUTS. FOR 6 STEPS, 4 BOLTS, 8 WASHERS, AND 4 NUTS. FOR 8 STEPS, 6 BOLTS, 12 WASHERS, AND 6 NUTS (ADDITIONAL 2 BOLTS, 4 WASHERS, AND 2 NUTS ARE FOR ATTACHING TO MID STEP SUPPORT). **SNUG ONLY, DO NOT OVERTIGHTEN** (FIGURE 2.2). REFER TO THE INSTRUCTIONS INCLUDED WITH THE ACCESSORY ATTACHMENT KITS FOR FURTHER INFORMATION ON INSTALLING THEM ONTO THE DOCK.

