



# ASSEMBLY INSTRUCTIONS

## SHORE END RAMP HOOK LOOP

### STANDARD ROLL-IN DOCKS

P/N 510-43410-00

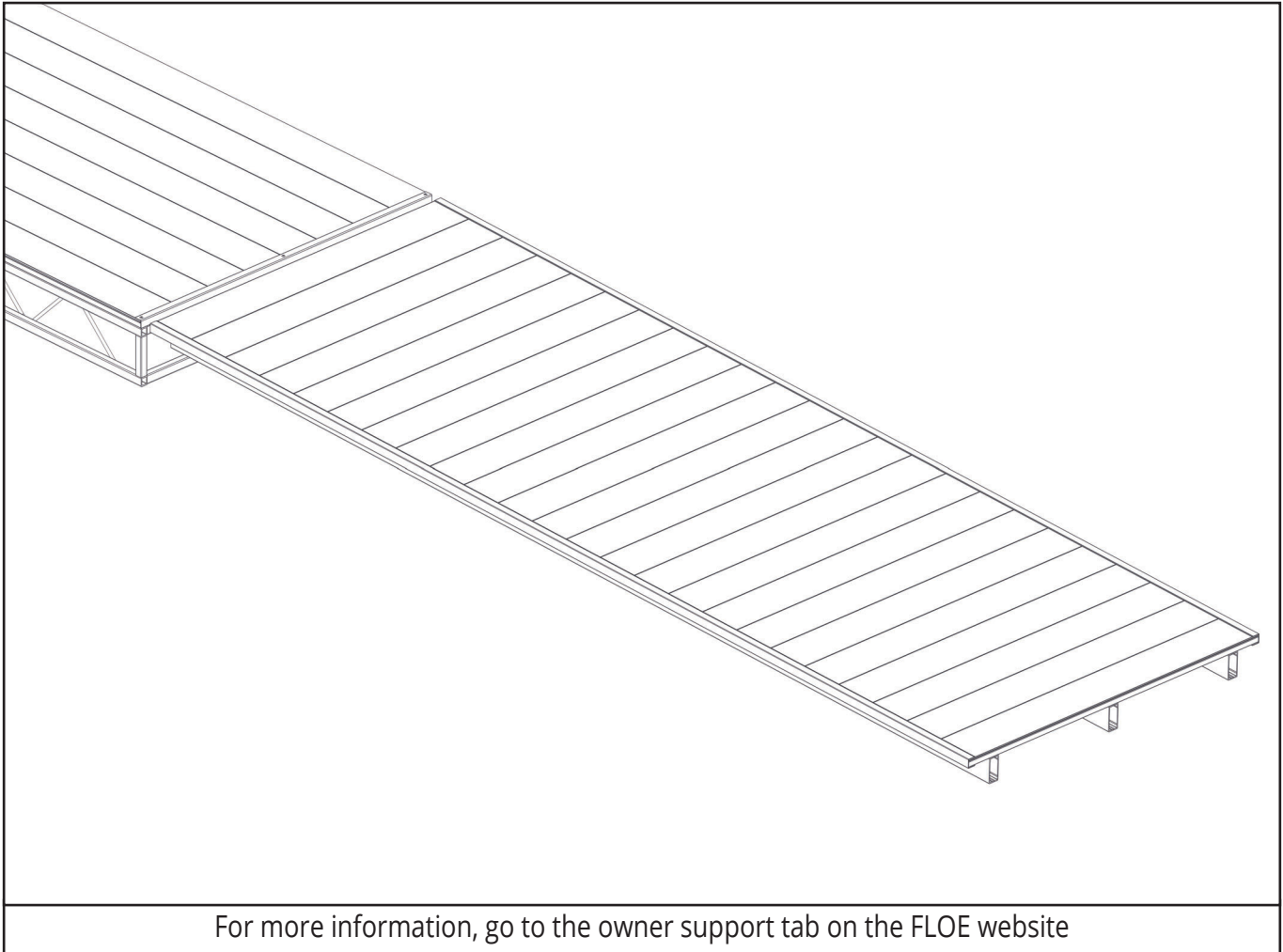

**\*DOCK NOT INCLUDED, (1) LOOP PER KIT**

### TOOLS REQUIRED

- 9/16" SOCKET/WRENCH
- TORQUE WRENCH
- TAPE MEASURE
- CORDLESS DRILL
- 13/32" DRILL BIT
- MARKER

**BILL OF MATERIALS/EXPLODED VIEW**

P/N 510-43410-00	KIT, SER LOOP & HRDW		
NUMBER	PART NUMBER	QTY.	DESCRIPTION
1	001-03902-01	1	KIT, HARDWARE - SER (SINGLE)
1A	001-70105-00	1	HHCS, 3/8-16 X 1" 18-8 SS
1B	001-71017-00	1	FLAT WASHER, 3/8" SAE SS 18-8
1C	001-74439-00	1	CB, 3/8-16 X 2" SS 18-8
1D	001-76349-00	1	NUT, 3/8-16 ALUM.
2	110-00032-00	1	WELDMNT, DOCK RAMP HOOK CATCH

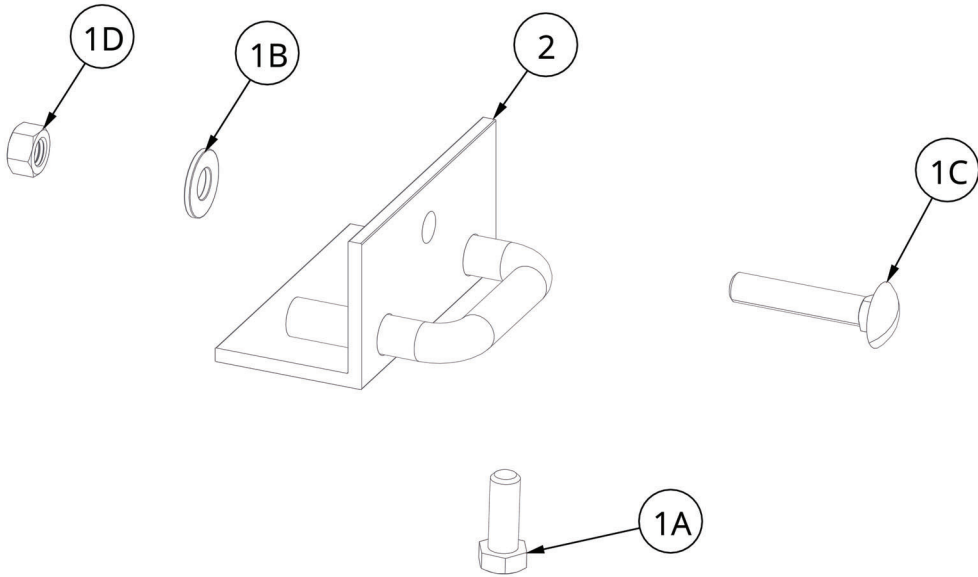

# ASSEMBLY

REFER TO THE FIGURES BELOW ON THE PLACEMENT OF THE LOOP BRACKETS ON THE END OF THE DOCK (FIGURE 1.1: 4' WIDE RAMPS (2 PER RAMP), FIGURE 1.1A: 6' WIDE RAMPS (3 PER RAMP)). BE SURE TO DRILL THE HOLE PERPENDICULAR TO THE TUBE TO ENSURE PROPER FIT BETWEEN THE BRACKET AND DOCK TUBE.

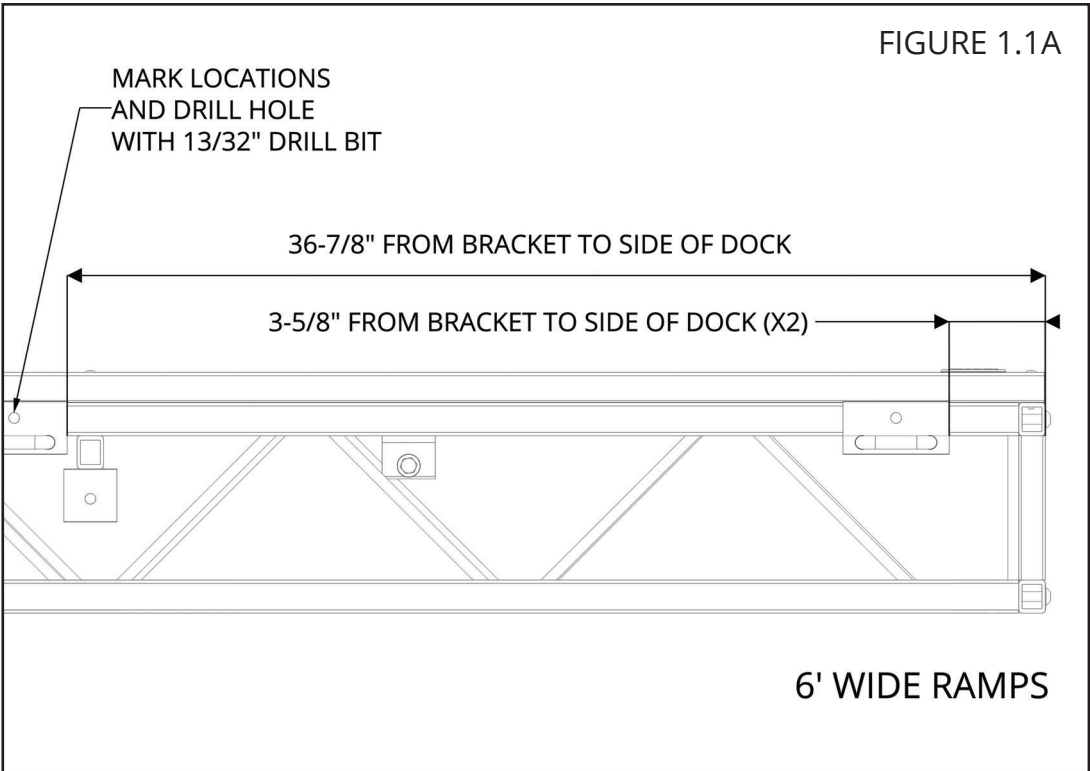
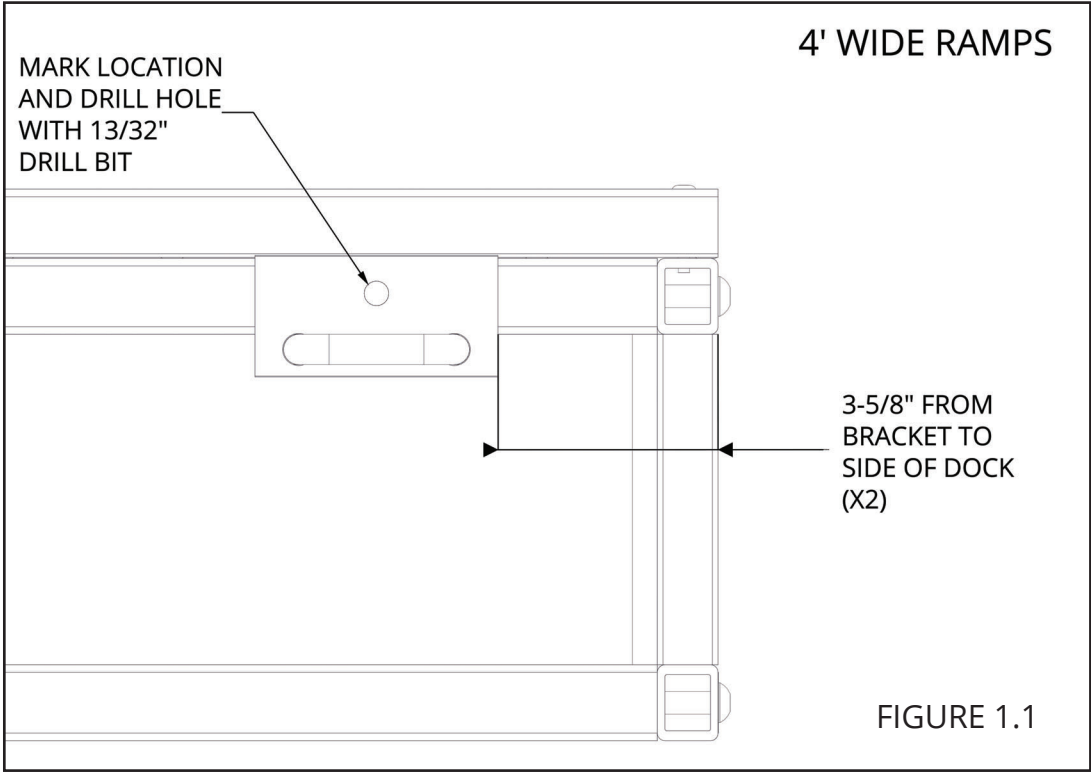

ATTACH THE LOOP BRACKETS TO THE DOCK USING A 3/8" X 2" CARRIAGE BOLT FOR EACH BRACKET (FIGURE 1.2), 3/8" WASHER, AND 3/8" NUT (FIGURE 1.3).

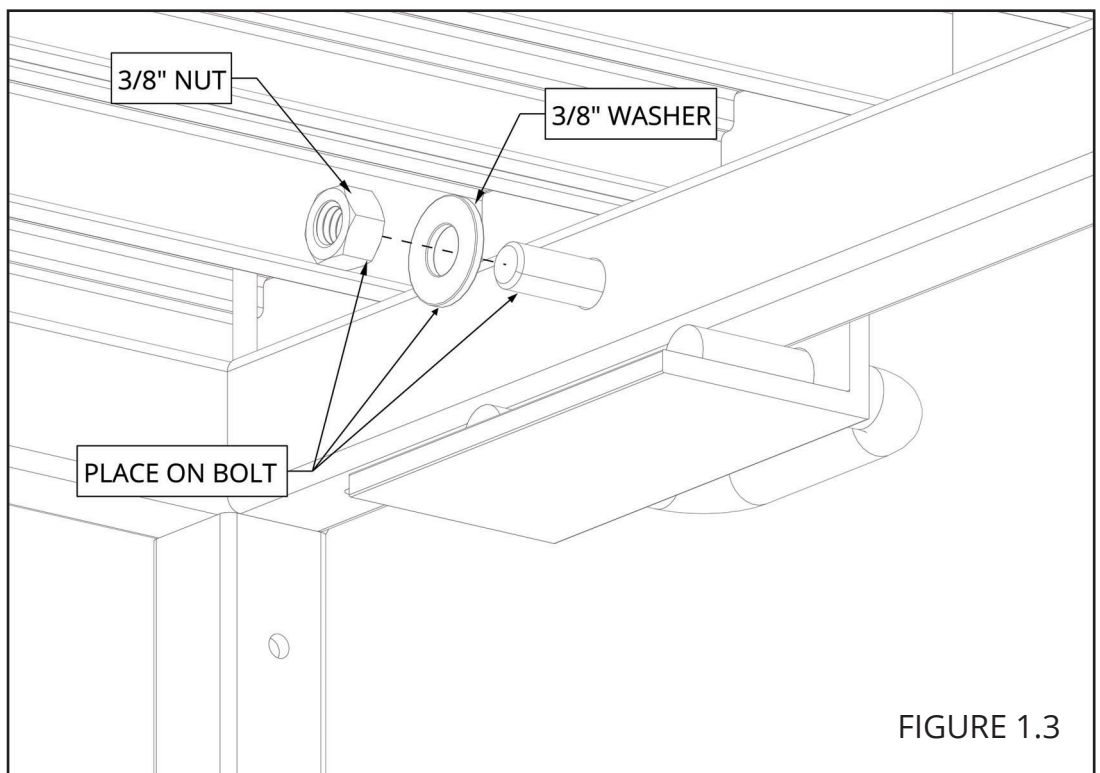
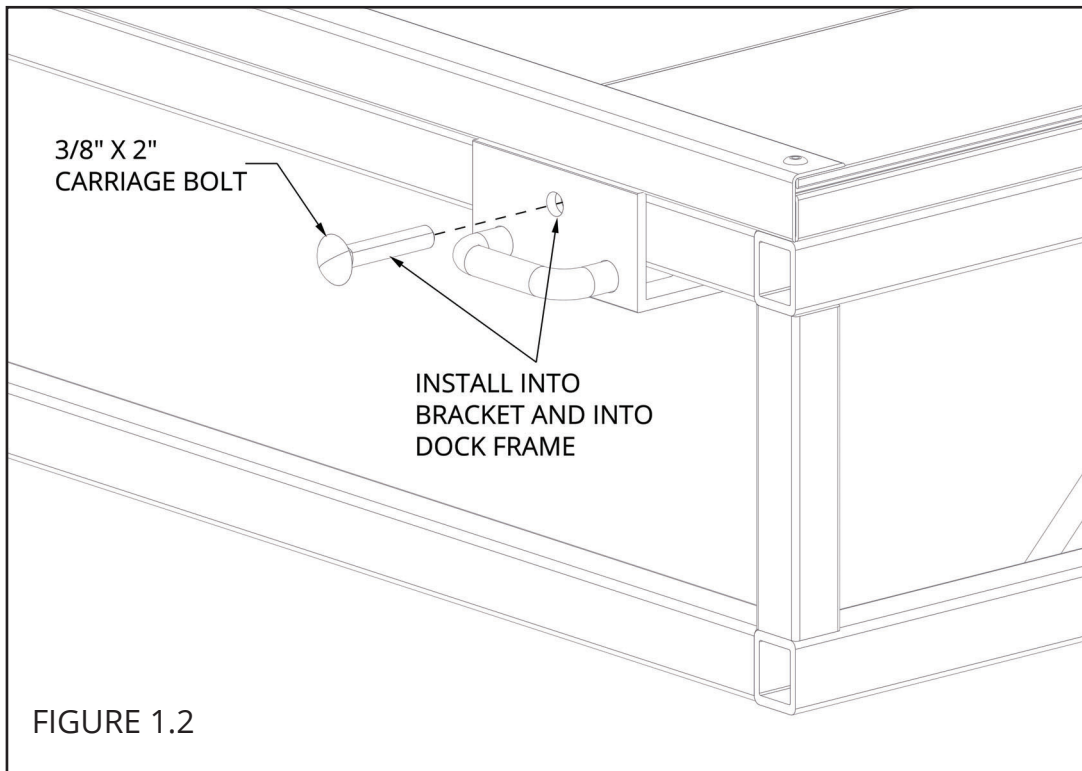

TORQUE ALL NUTS TO 25 FT-LB (FIGURE 1.4). PLACE THE HOOKS OF THE RAMP ONTO THE LOOPS (FIGURE 1.5: 4' WIDE RAMPS).

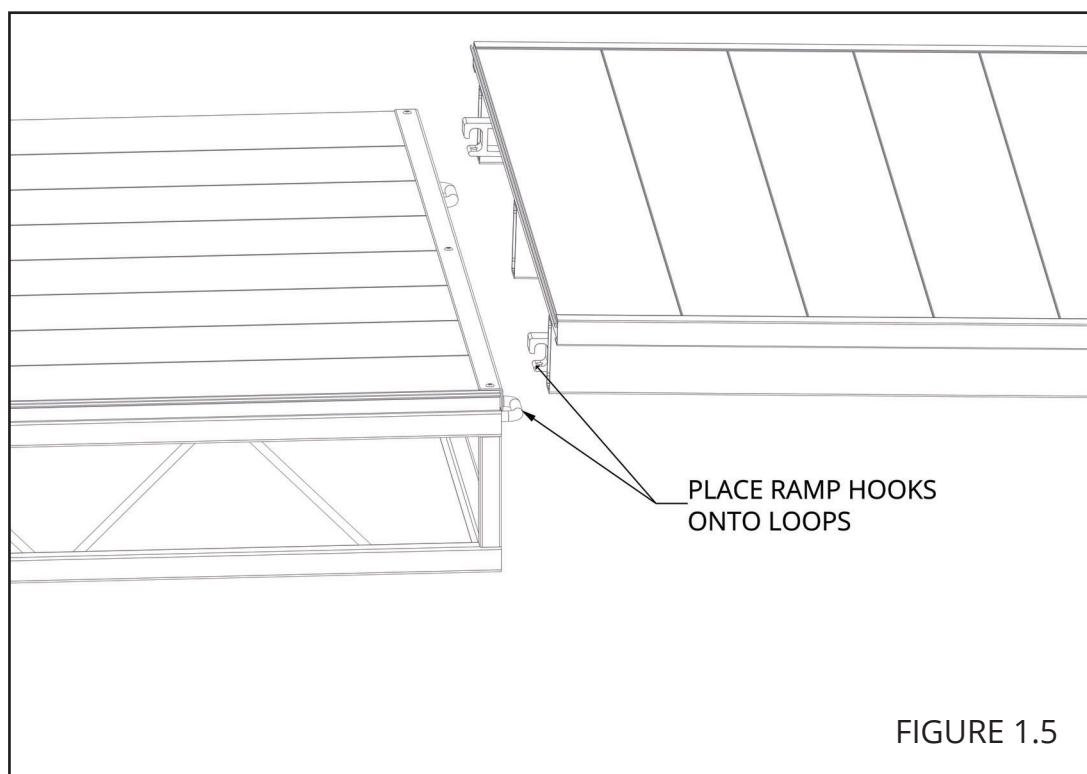
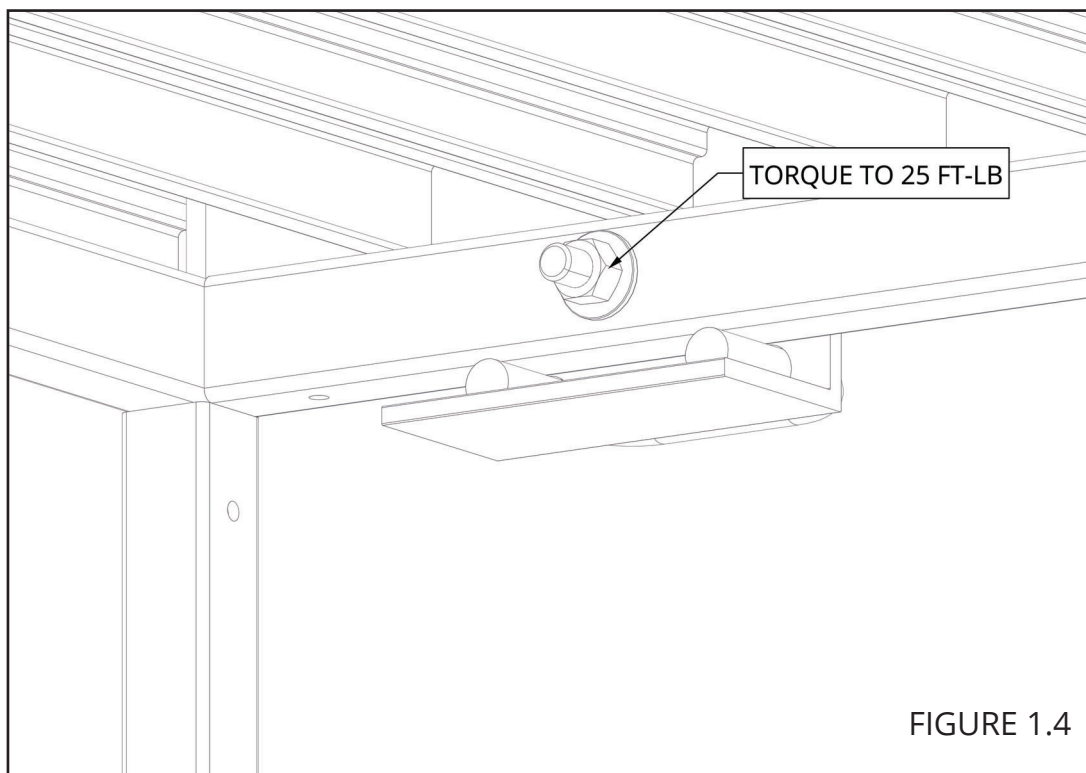

PLACE THE HOOKS OF THE RAMP ONTO THE LOOPS (FIGURE 1.5A: 6' WIDE RAMPS). INSTALL A 3/8" X 1" BOLT INTO THE BOTTOM OF EACH HOOK ON THE RAMP (FIGURE 1.6).

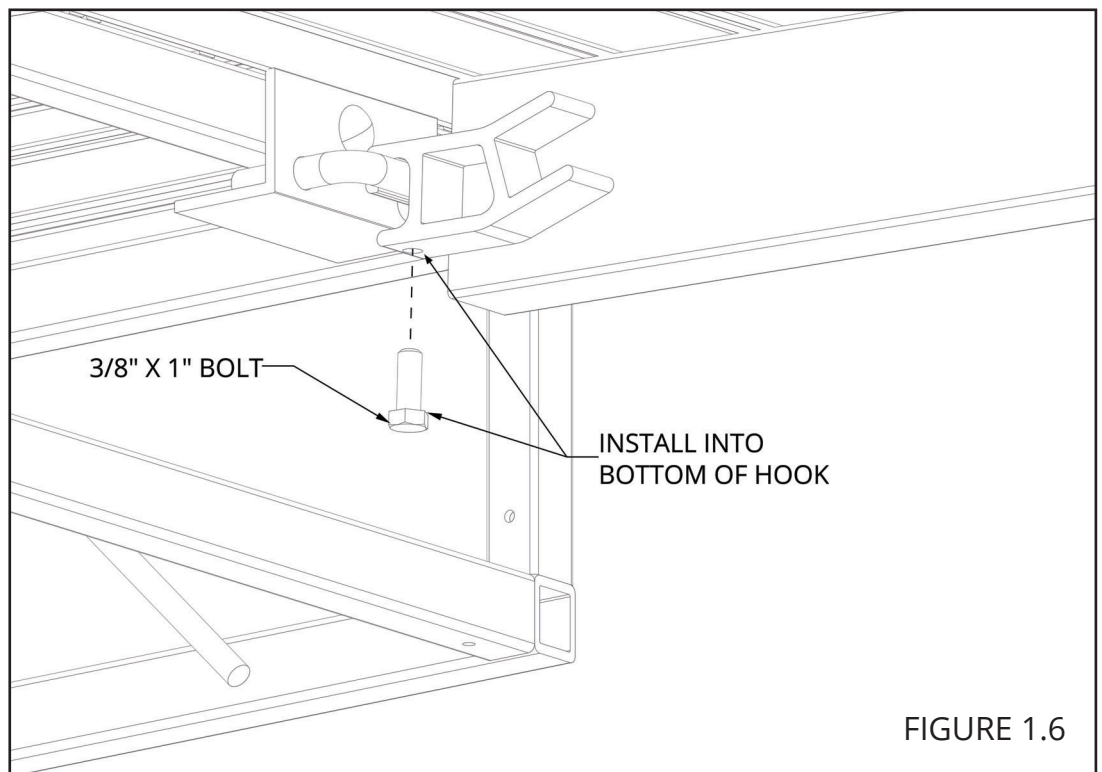
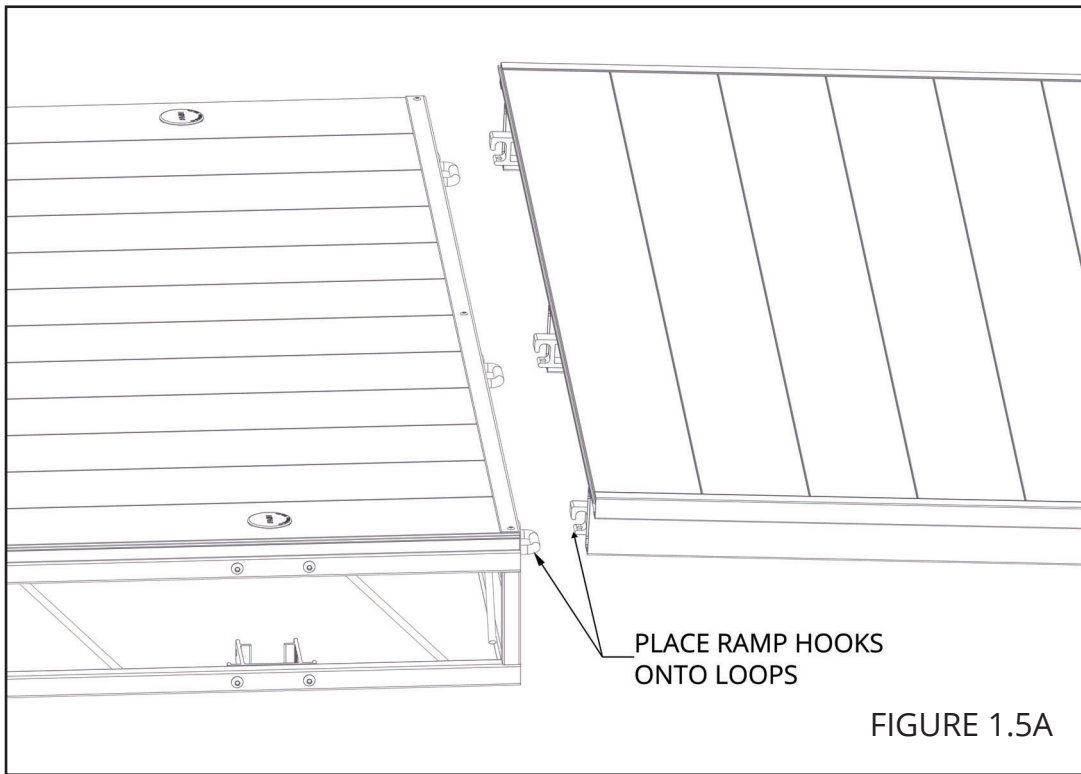

TORQUE ALL BOLTS TO 5 FT-LB (FIGURE 1.7),

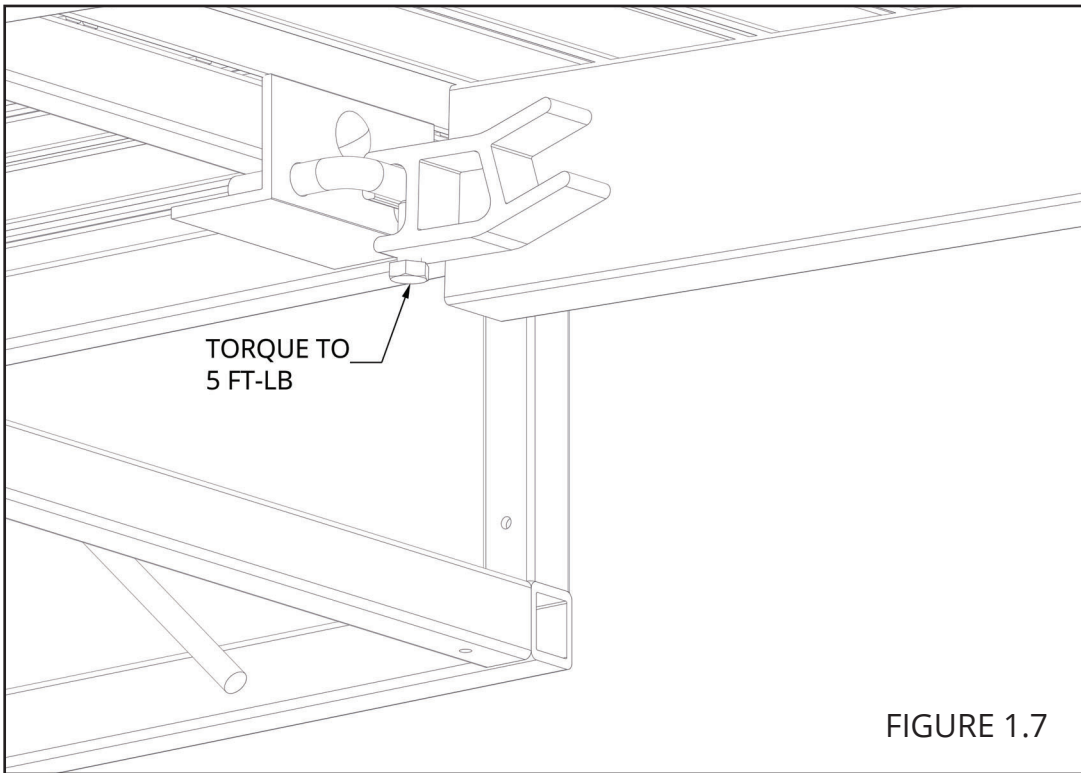



FLOE INTERNATIONAL, INC.  
48473 STATE HIGHWAY 65 • MCGREGOR, MN 55760  
[www.floeintl.com](http://www.floeintl.com)

*All material copyright © 2022 FLOE International, Inc.  
Specifications subject to change without notice.*