

# FLOE QUICK ATTACH ROLL-IN DOCK MOUNTED ADJUSTABLE BOW STOP ATTACHMENT KIT

## ASSEMBLY INSTRUCTIONS

KIT P/N 510-02610-00

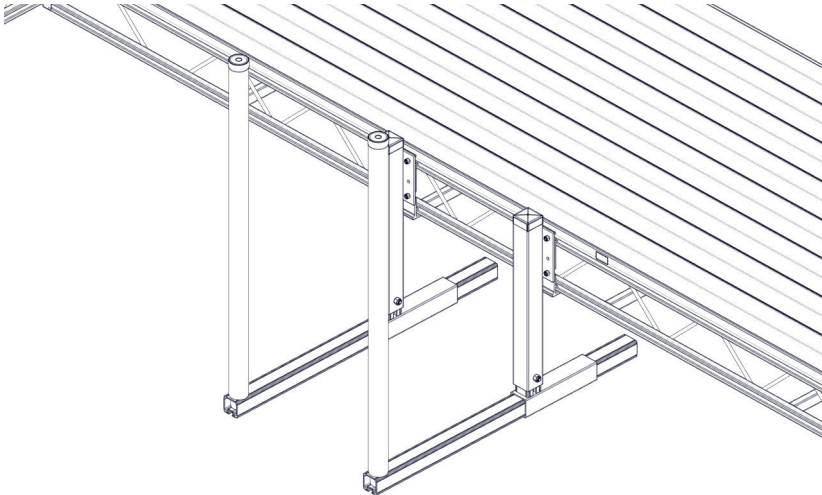

### TOOLS REQUIRED

- 9/16" SOCKET/WRENCH
- 3/4" SOCKET/WRENCH
- TAPE MEASURE
- TORQUE WRENCH
- MARKER

\* DOCK NOT INCLUDED

### **IMPORTANT NOTE:**

CAUTION MUST BE USED WHEN PARKING A BOAT WITH THIS KIT INSTALLED. BOATS SHOULD BE DRIFTED INTO FINAL POSITION ON BOAT LIFT. FAILURE TO DO SO WILL RESULT IN DAMAGE TO BOAT, BOAT LIFT, AND/OR LIFT ACCESSORIES.

### **NOTE:**

ADJUSTABLE BOW STOP IS SOLD SEPARATELY (KIT P/N 511-00008-01). REFER TO INSTRUCTIONS INCLUDED WITH THE KIT FOR ASSEMBLY.

**BILL OF MATERIALS/EXPLODED VIEW**

P/N 510-02610-00		KIT, QA ROLL-IN ADJ. BOW STOP BRACKETS	
NO.	PART NUMBER	DESCRIPTION	QTY
1	001-70105-00	HHCS, 3/8-16 X 1" 18-8 SS	12
2	001-76071-00	NUT, NYLOCK 3/8-16 ALUM.	8
3	002-00277-00	BRACKET, QUICK ATT. ROLL-IN – 5.25"	2

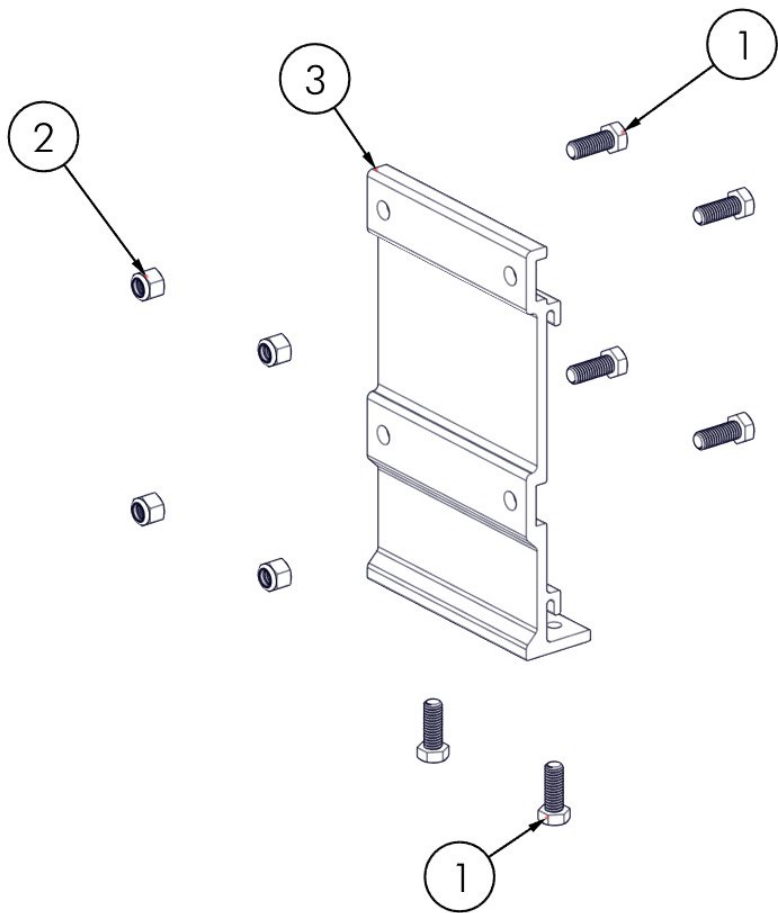

## ASSEMBLY

PLACE (4) 3/8" X 1" BOLTS INTO THE BRACKET (FIGURE 1.1) AND START (2) 3/8" X 1" BOLTS INTO THE BOTTOM OF THE BRACKET (FIGURE 1.2).

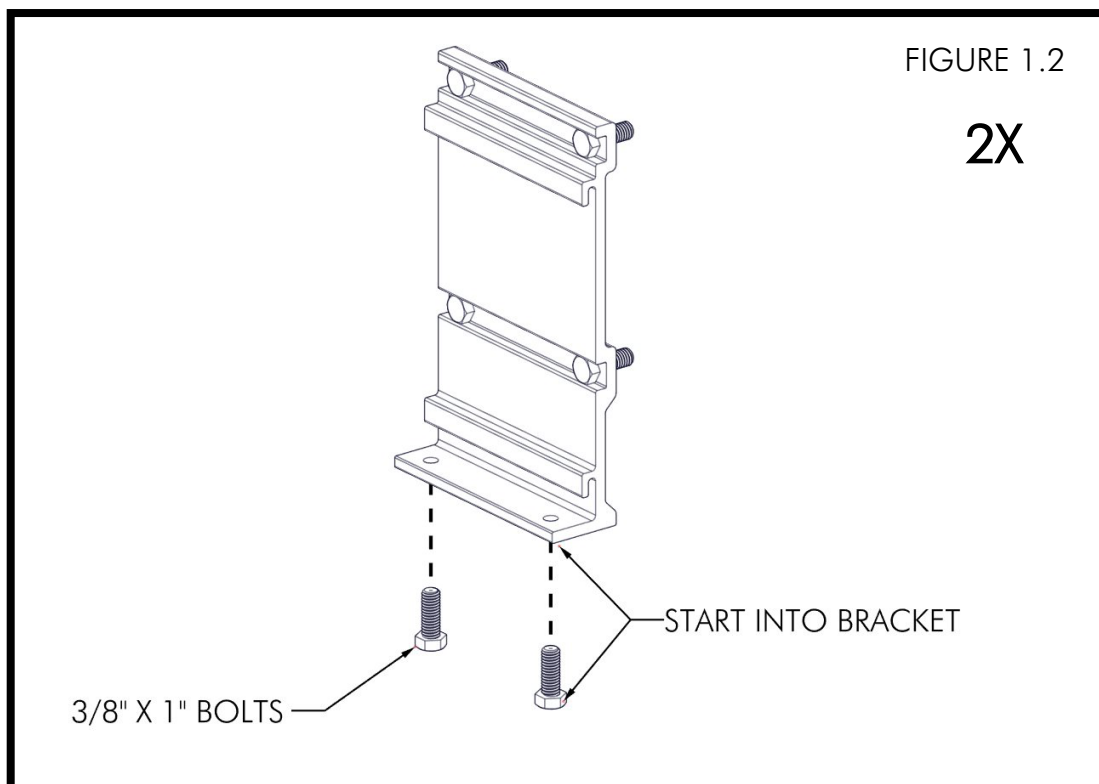
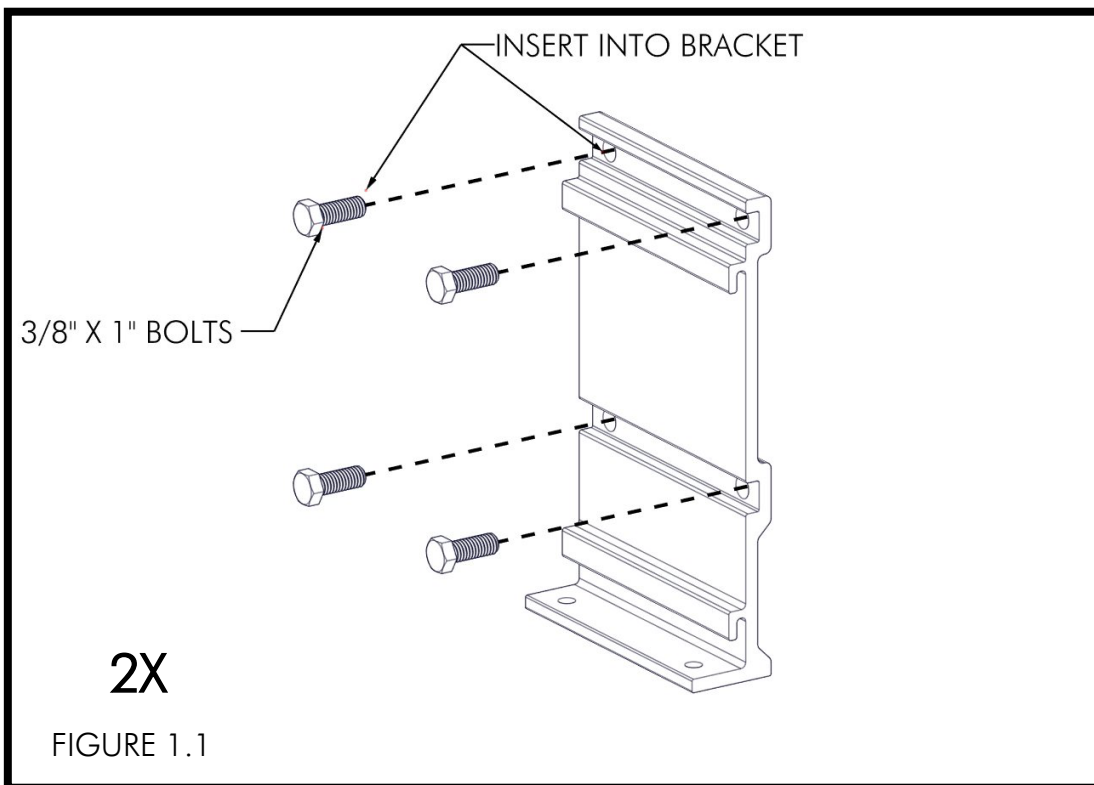

USING THE MEASUREMENT FROM THE PRE-INSTALLATION STEP OF THE BOW STEP ASSEMBLY INSTRUCTIONS (WITH 511-00008-00), SET THE WIDTH OF THE BRACKETS. **NOTE: THE PVC UPRIGHTS SHOULD NOT BE BENT FORWARD OR TOWARDS THE SIDES OF THE HULL** (FIGURE 1.3). PLACE BRACKET INTO DOCK SIDE (FIGURE 1.4).

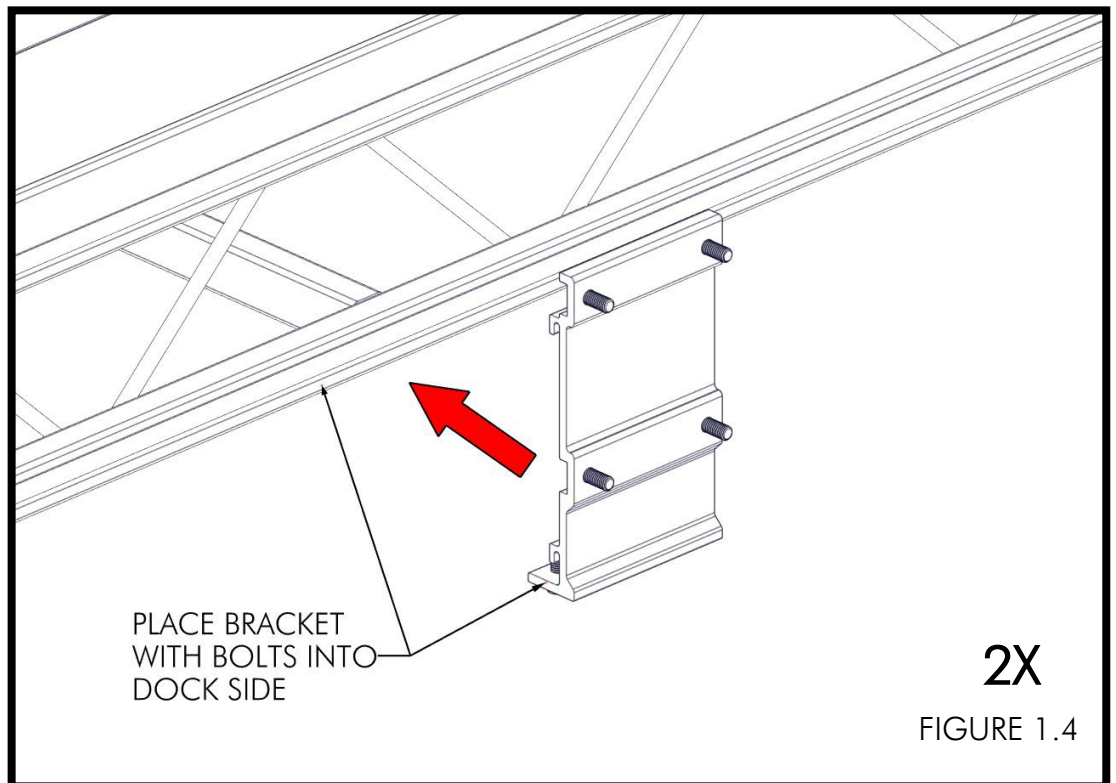
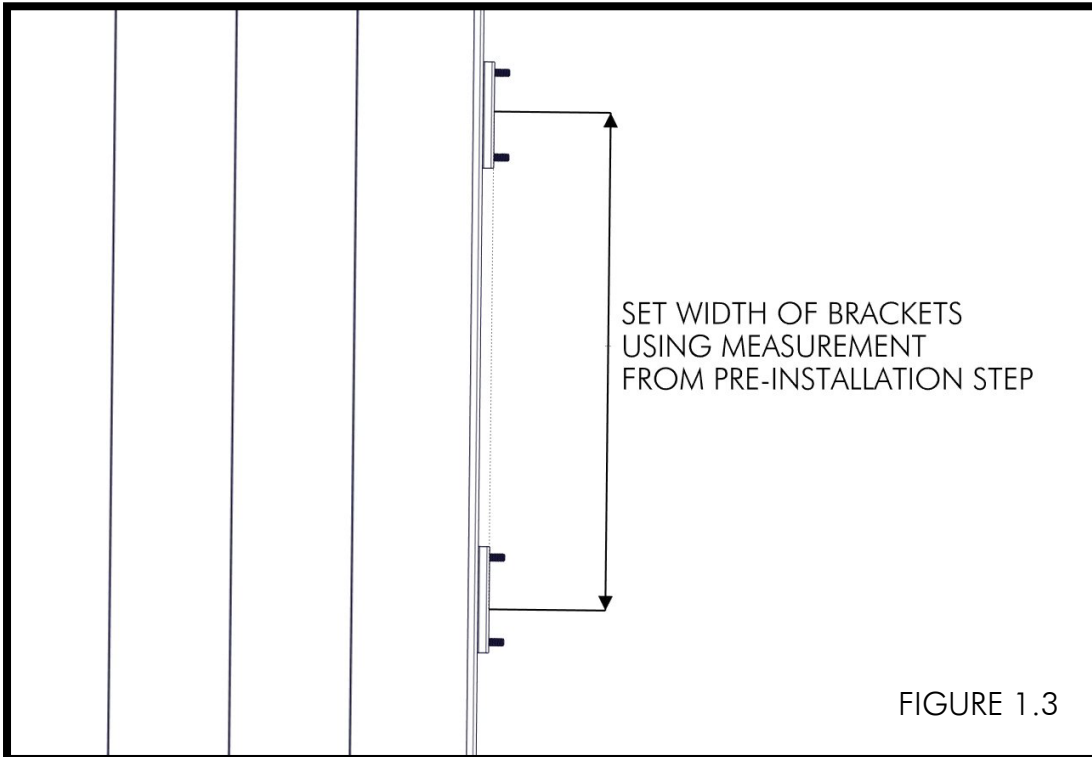

PLACE UPPER MOUNT (INCLUDED WITH ADJUSTABLE BOW STOP KIT) ONTO BOLTS (FIGURE 1.5) AND ATTACH USING (4) 3/8" NYLOCK NUTS (FIGURE 1.6).

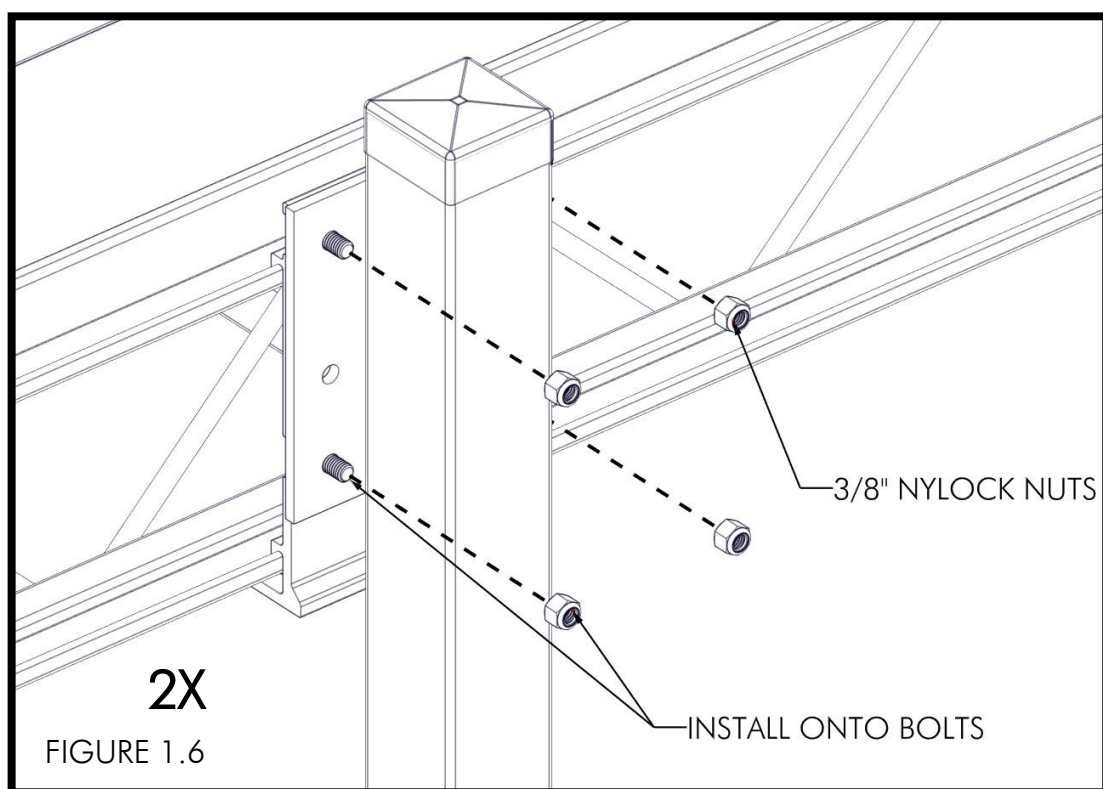
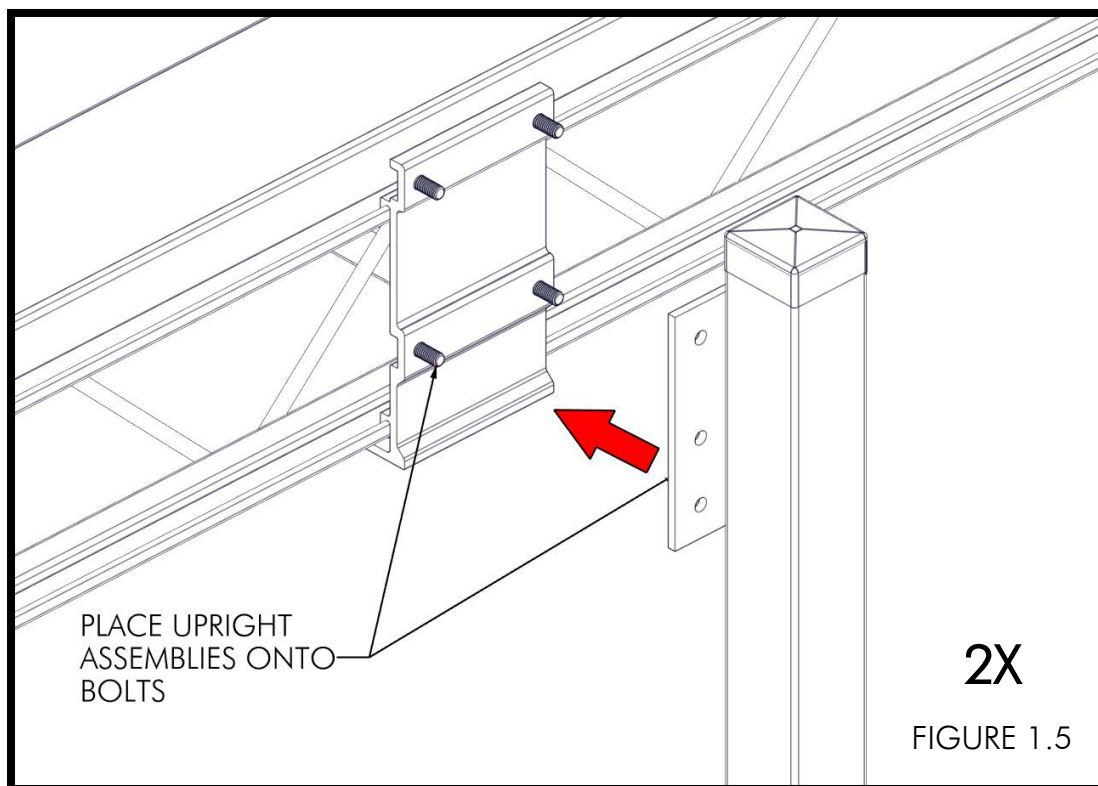

TORQUE ALL NUTS TO 20 FT-LBS (FIGURE 1.7).

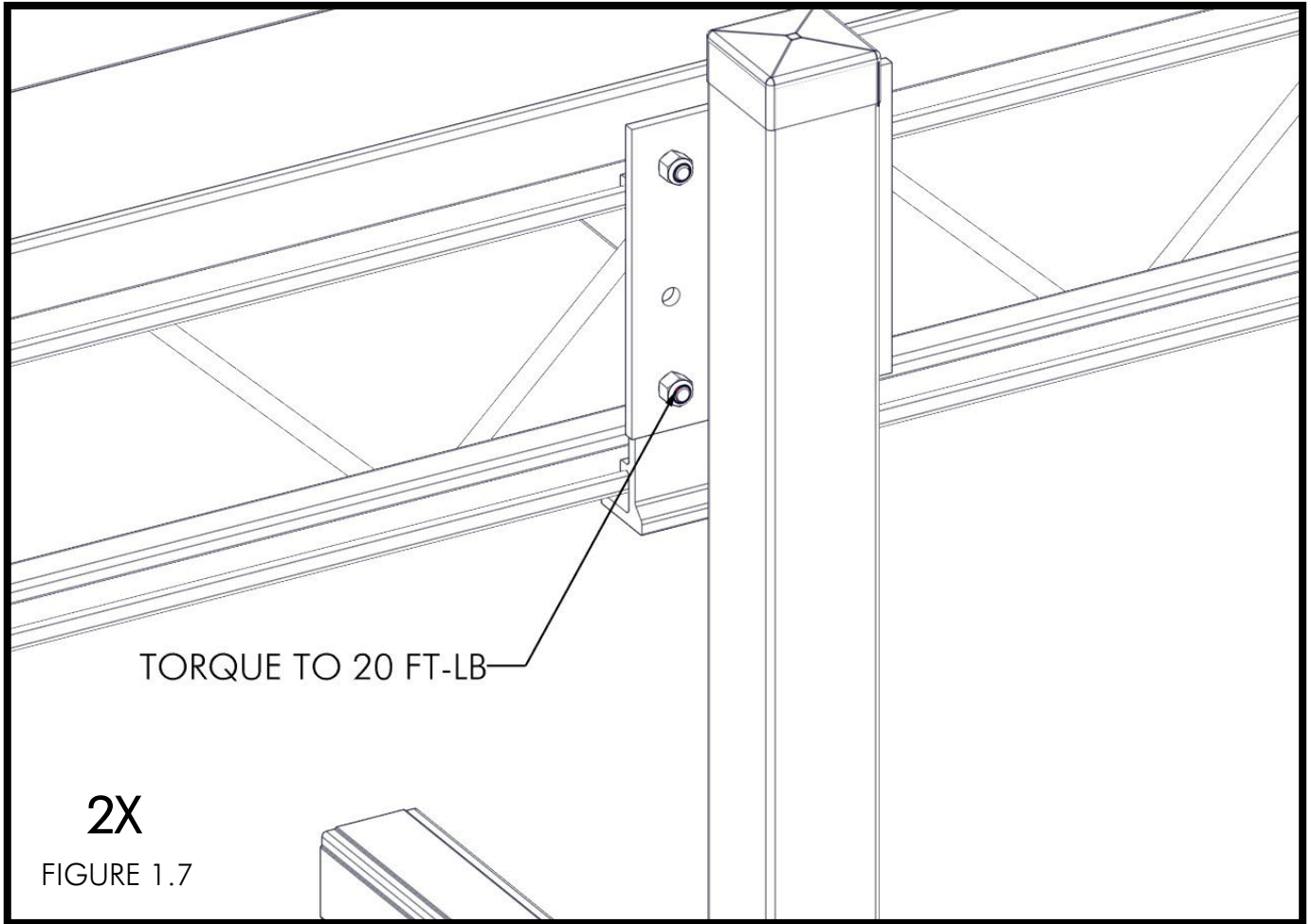

TORQUE BOLTS TO 6 FT-LBS MAXIMUM (FIGURE 1.8).

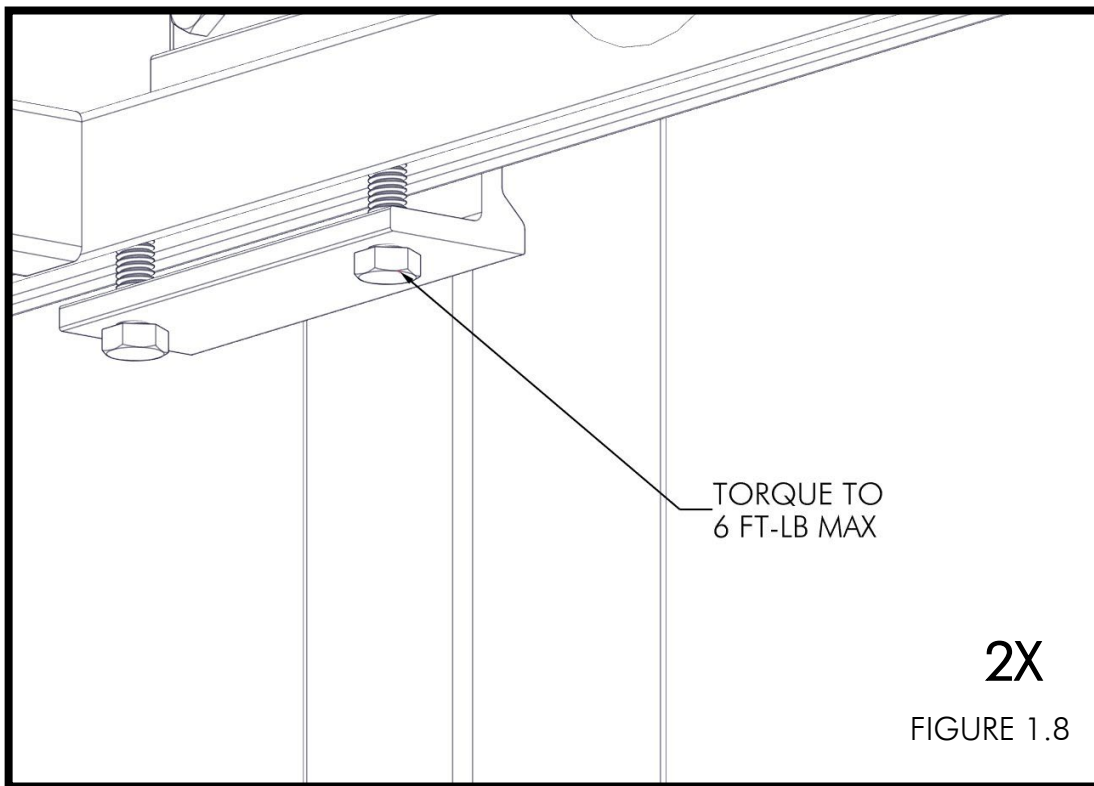



PARK BOAT ON LIFT AND SET THE POSITION OF BOW STOP UPRIGHTS BY SLIDING THE UPRIGHTS UNTIL THEY CONTACT THE BOAT. THE PVC UPRIGHTS SHOULD NOT BE BENT FORWARD OR TOWARDS THE SIDES OF THE HULL AND THE TOP OF THE TUBE SHOULD BE 6-8 INCHES ABOVE THE RUB RAIL WHEN THE BOAT IS FLOATING INSIDE OF THE LIFT. TORQUE 1/2" NYLOCK NUTS TO 20 FT-LB (FIGURES 1.9 & 1.10).

