

**FLOE QUICK ATTACH ROLL IN  
VERTICAL BUMPER BRACKET**  
ASSEMBLY INSTRUCTIONS  
KIT P/N 510-02602-00

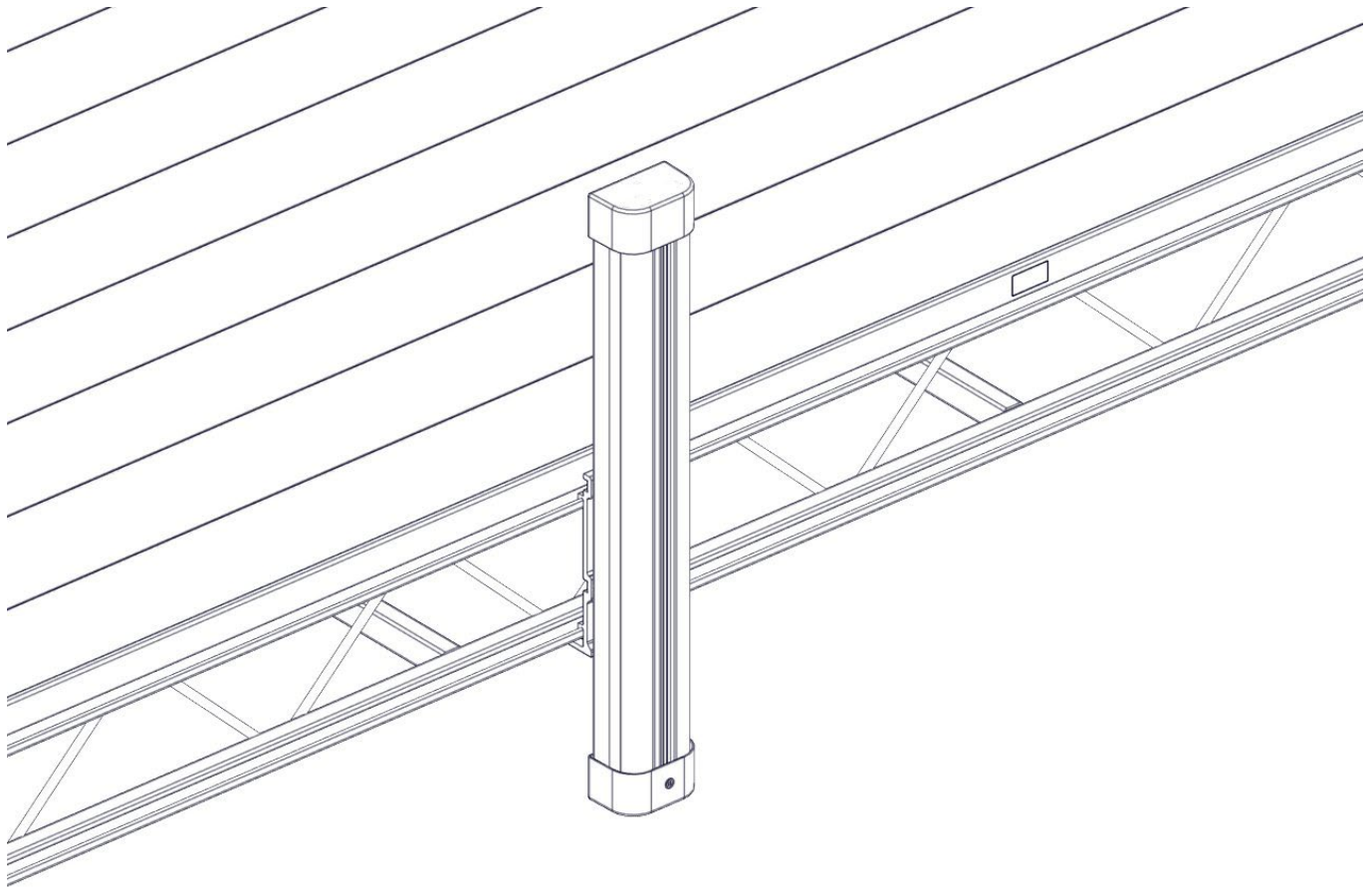

\*DOCK, LEGS, AND BUMPER NOT INCLUDED

TOOLS REQUIRED  
-9/16" SOCKET/WRENCH  
-TAPE MEASURE  
-TORQUE WRENCH

INSTRUCTION P/N: 610-02602-00  
RELEASED 9/6/22

SHEET 1 OF 8

© Manufactured by:  
Floe International Inc.  
48473 State Hwy. 65  
McGregor, MN 55760  
[www.floeintl.com](http://www.floeintl.com)

**BILL OF MATERIALS/EXPLODED VIEW**

P/N 510-02602-00	KIT, QA ROLL-IN VERTICAL BUMPER MTG.		
<u>NUMBER</u>	<u>PART NUMBER</u>	<u>QTY.</u>	<u>DESCRIPTION</u>
1	001-70103-00	2	HHCS, 3/8-16 X 3/4" 18-8 SS
2	001-70105-00	2	HHCS, 3/8-16 X 1" 18-8 SS
3	001-76349-00	2	NUT, 3/8-16 ALUM.
4	002-00278-00	1	BRACKET, QUICK ATT. ROLL IN BUMPER – 4"

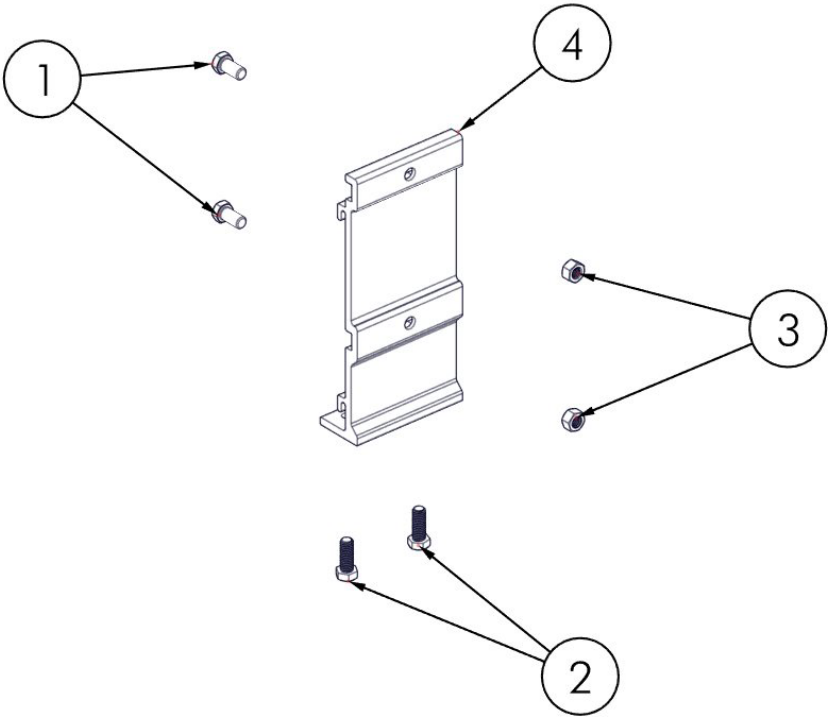

## INSTALLATION

INSTALL (2) 3/8" X 3/4" BOLTS INTO THE BRACKET (FIGURE 1.1). REMOVE THE VINYL CAP INSTALLED ON THE BUMPER (WITHOUT RIVET HOLDING IT), INSTALL (2) 3/8" NUTS INTO THE TRACK, AND RE-INSTALL THE CAP AND SECURE USING THE SUPPLIED TAPE WITH THE BUMPER (FIGURE 1.2).

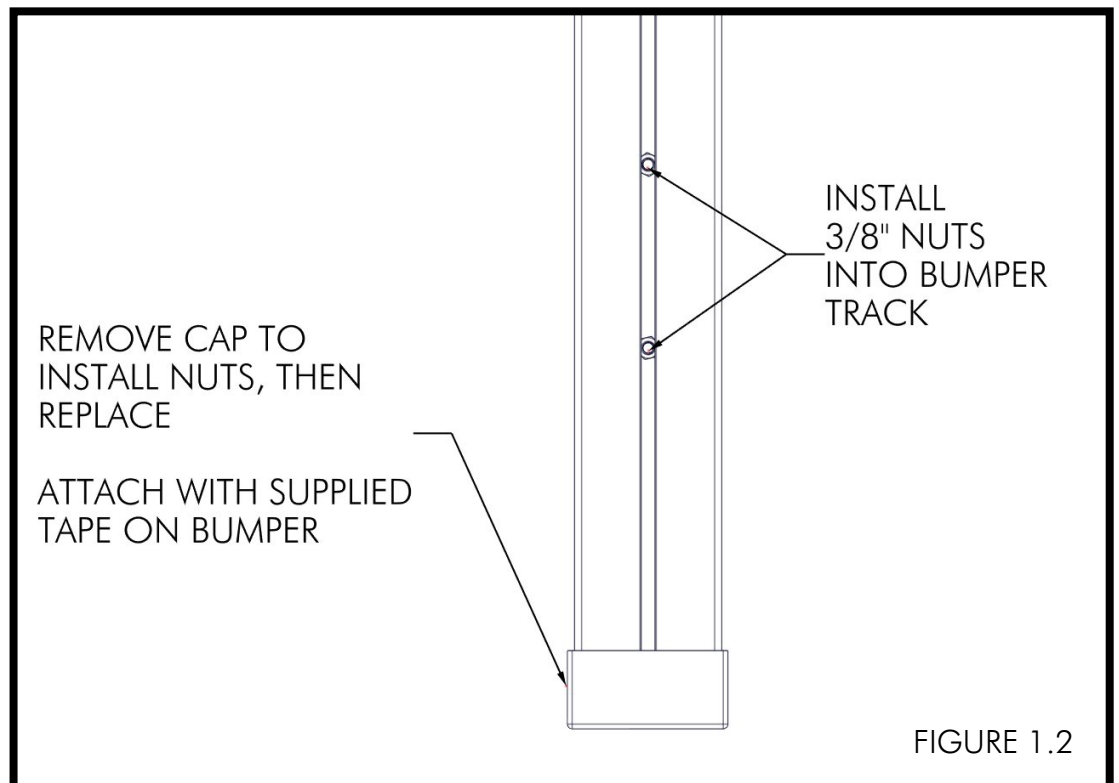
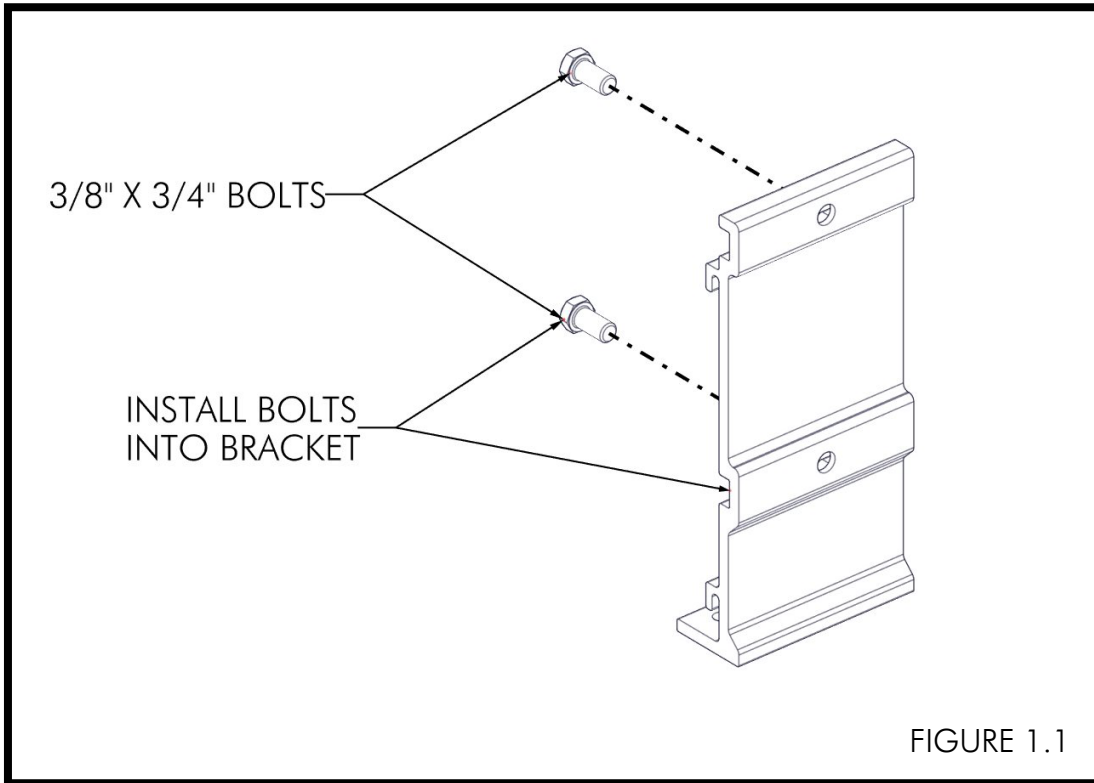

ALIGN THE BRACKET WITH THE NUTS IN THE BUMPER AND ATTACH USING (2) 3/8" X 3/4" BOLTS (FIGURE 1.3). POSITION THE BRACKET TO ACHIEVE THE DESIRED BUMPER HEIGHT AND TORQUE BOLTS TO 35 FT-LB (FIGURE 1.4).

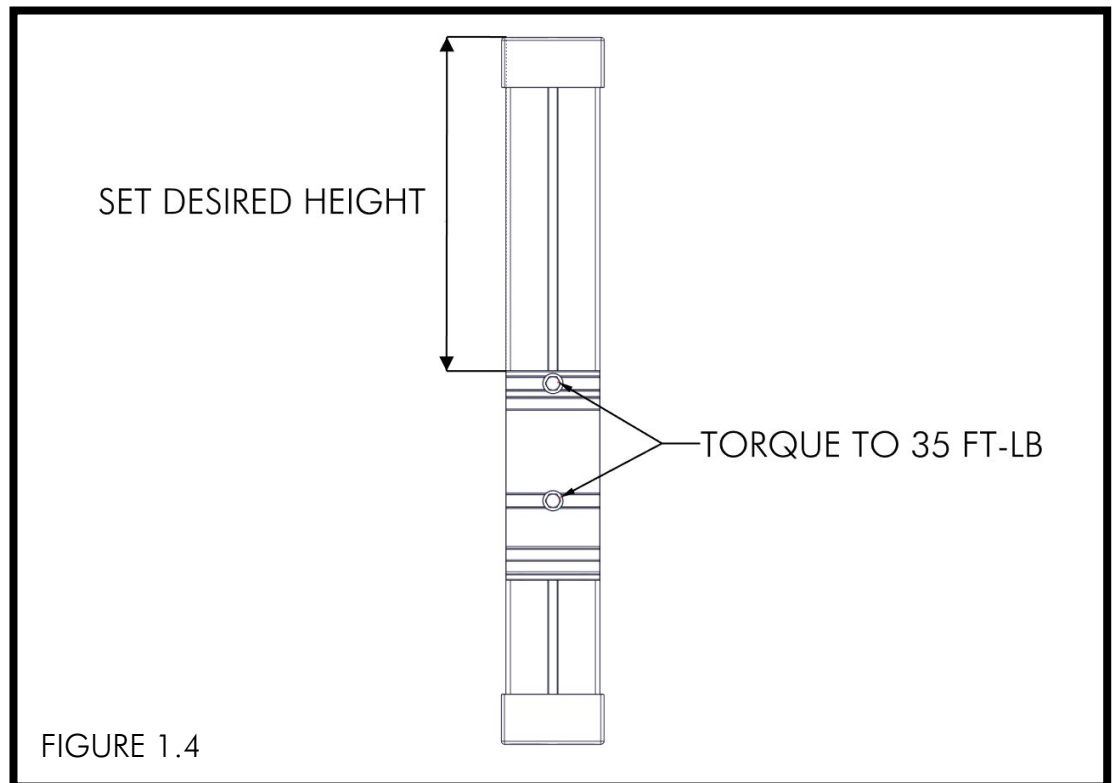
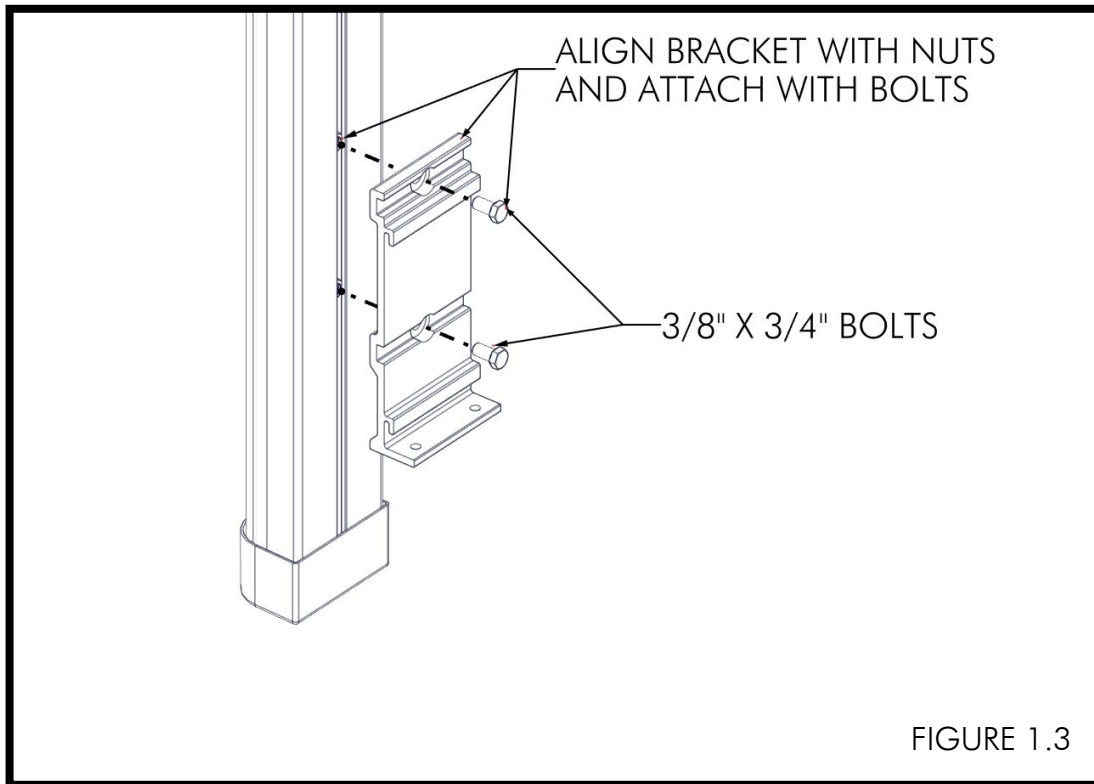

PLACE THE BRACKET INTO THE DOCK SIDE IN THE DESIRED LOCATION (FIGURE 1.5). INSTALL (2) 3/8" X 1" BOLTS INTO THE BOTTOM OF THE BRACKET (FIGURE 1.6) AND TORQUE TO **6 FT-LB MAXIMUM** (FIGURE 1.7).

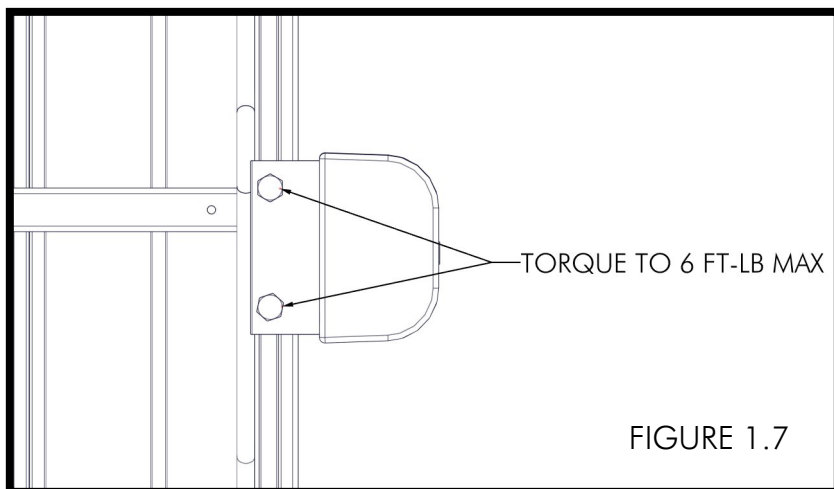
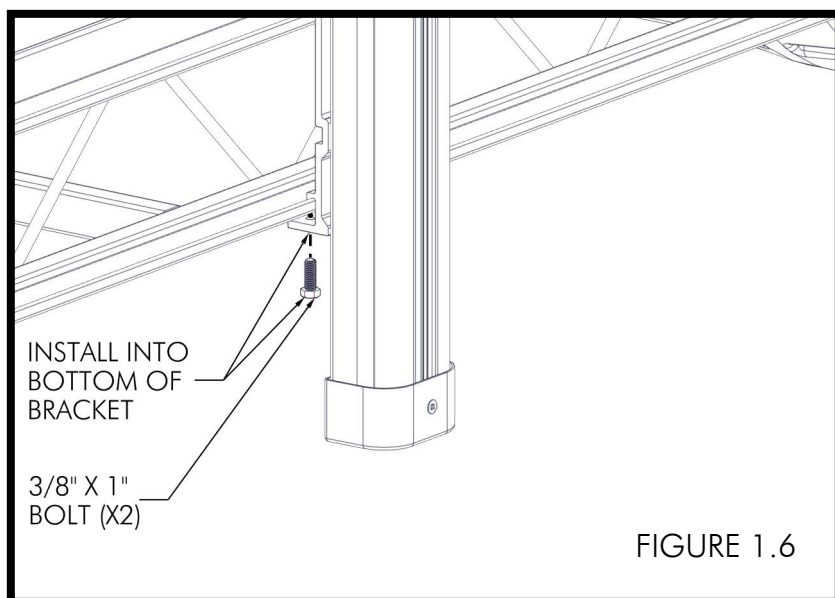
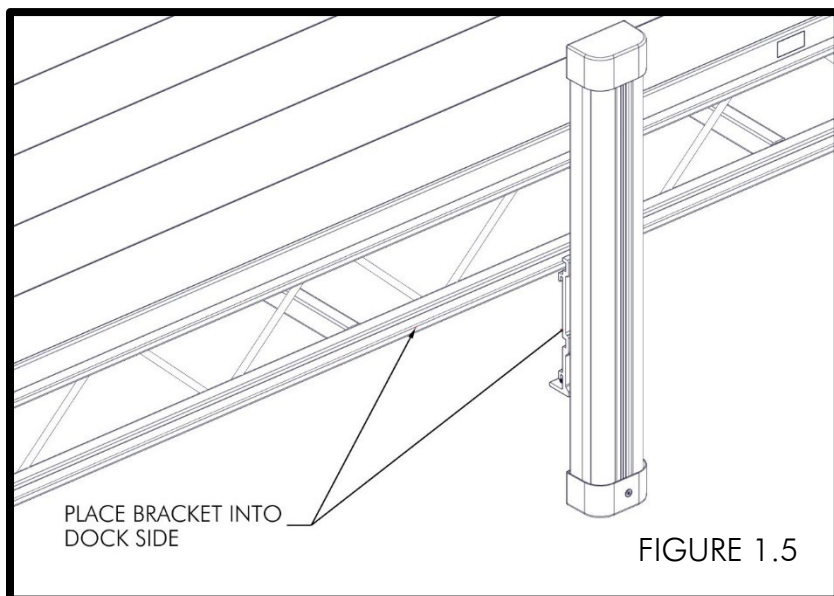

**NOTES**

**NOTES**

