

FLOE QUICK ATTACH ROLL IN DOCK FURNITURE

ASSEMBLY INSTRUCTIONS

KIT P/N 510-02601-00

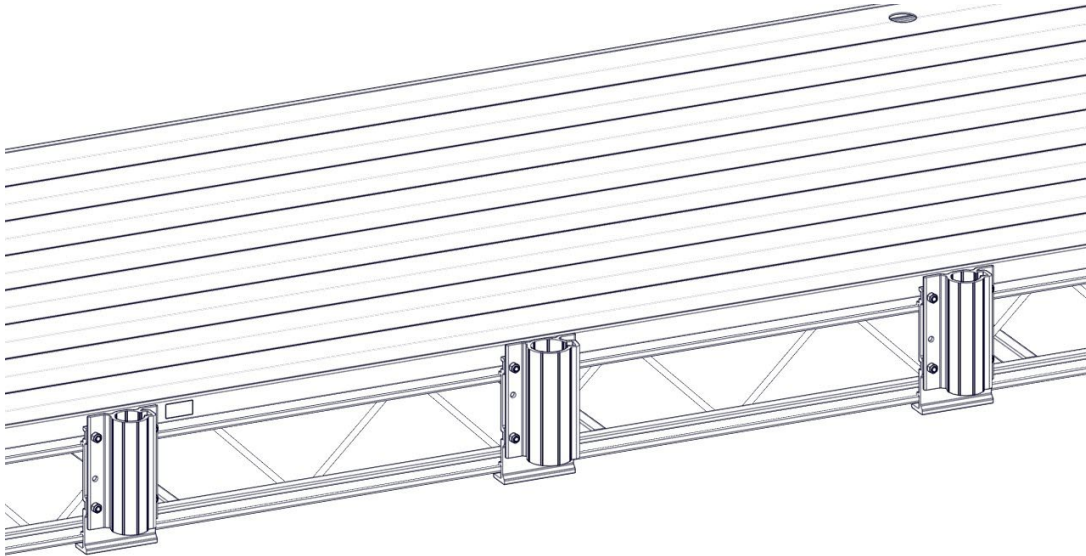

*DOCKS, LEGS, AND FURNITURE BRACKETS NOT INCLUDED

TOOLS REQUIRED

- 9/16" SOCKET/WRENCH
- TAPE MEASURE
- TORQUE WRENCH

NOTE:

REFER TO FURNITURE INSTRUCTIONS TO COMPLETE INSTALLATION

INSTRUCTION P/N: 610-02601-00
RELEASED 6/30/22

© Manufactured by:
Floe International Inc.
48473 State Hwy. 65
McGregor, MN 55760
www.floeintl.com

BILL OF MATERIALS/EXPLODED VIEW

| | | | |
|------------------|--------------------------------|-------------|---|
| P/N 510-02601-00 | KIT, QA ROLL-IN DOCK FURNITURE | | |
| <u>NUMBER</u> | <u>PART NUMBER</u> | <u>QTY.</u> | <u>DESCRIPTION</u> |
| 1 | 001-70105-00 | 18 | HHCS, 3/8-16 X 1" 18-8 SS |
| 2 | 001-76071-00 | 12 | NUT, NYLOCK 3/8-16 ALUM. |
| 3 | 002-00277-00 | 3 | BRACKET, QUICK ATT. ROLL IN FURNITURE – 5.25" |

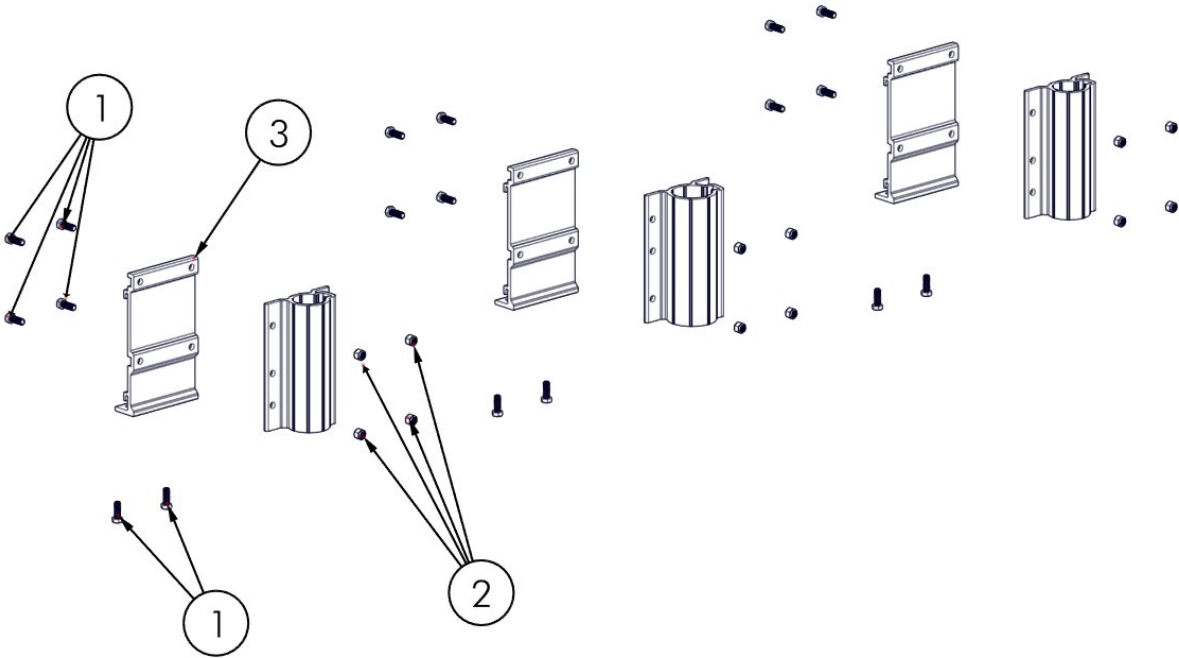

ASSEMBLY

INSERT (4) 3/8" X 1" BOLTS INTO EACH BRACKET (FIGURE 1.1). POSITION THE BRACKETS IN THE DESIRED LOCATION ON THE DOCK SIDE, 31" APART CENTER TO CENTER (FIGURE 1.2). INSERT (2) 3/8" X 1" BOLTS INTO THE BOTTOM OF EACH BRACKET (FIGURE 1.3).

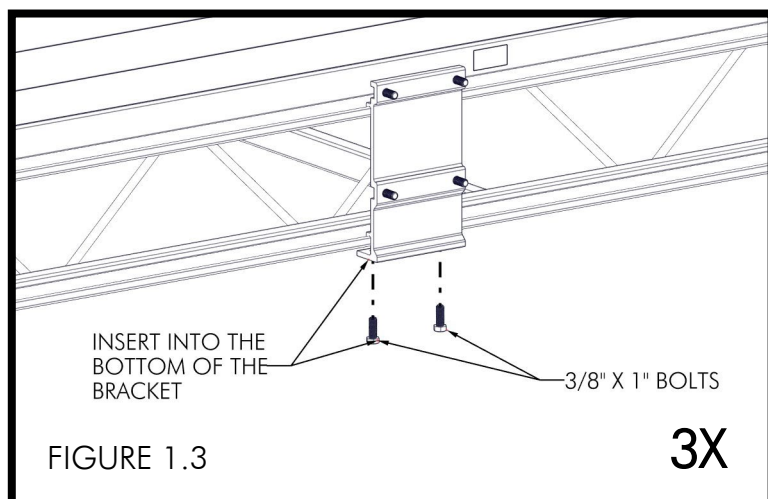
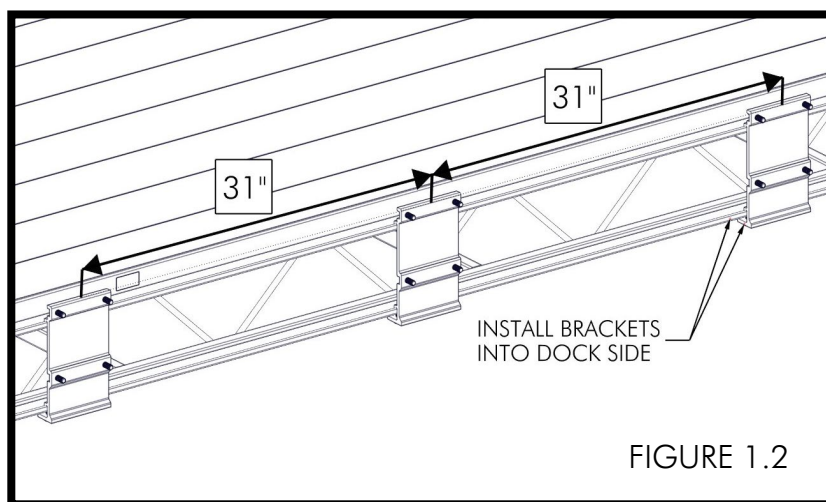
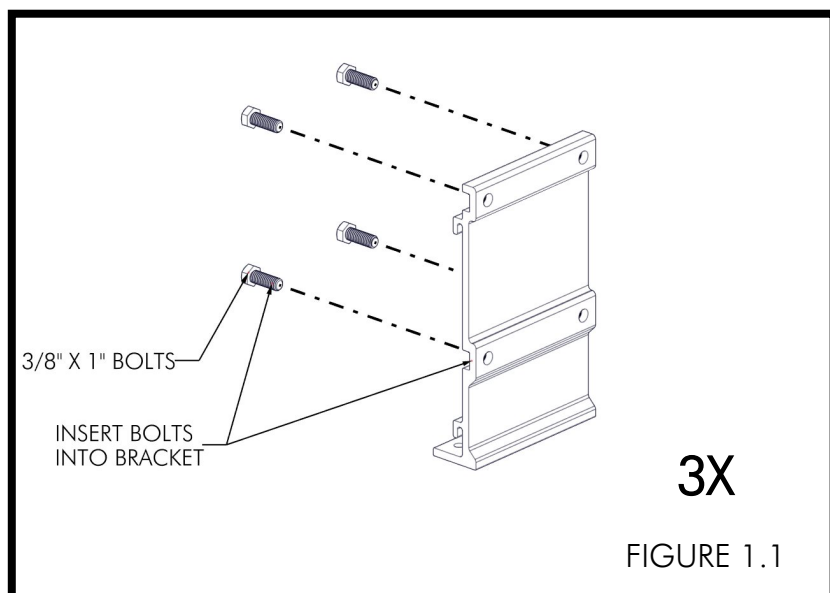

TORQUE BOLTS TO **6 FT-LB MAXIMUM** (FIGURE 1.4). PLACE THE FURNITURE POCKETS (**SOLD SEPARATELY**) ONTO THE BRACKETS AND ATTACH THEM WITH (4) 3/8" NYLOCK NUTS PER BRACKET (FIGURE 1.5). TORQUE NUTS TO 35 FT-LB (FIGURE 1.6).

