

**FLOE QUICK ATTACH SECTIONAL  
DOCK END BENCH BRACKET KIT**  
ASSEMBLY INSTRUCTIONS  
KIT P/N 510-02580-00

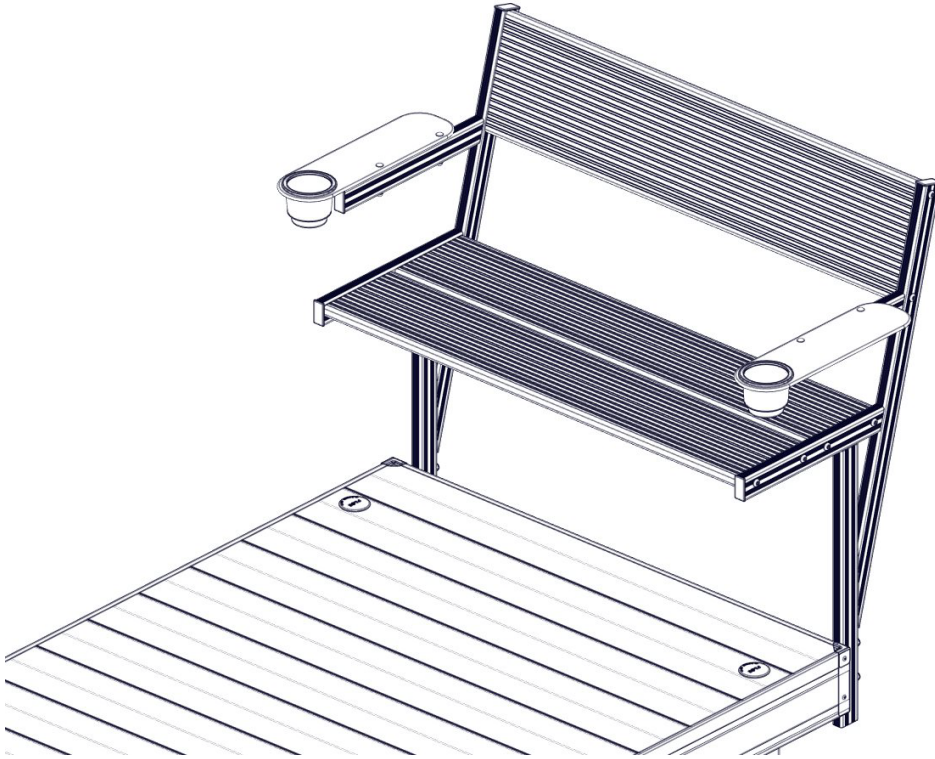

\*DOCK, LEGS, AND BENCH NOT INCLUDED

NOTE: TWO 9/16" WRENCHES MAY BE  
REQUIRED, DEPENDING ON THE STYLE OF THE  
QUICK ATTACH ACCESSORY BRACKET

TOOLS REQUIRED  
-(2) 9/16" SOCKETS/WRENCHES  
-TORQUE WRENCH

**BILL OF MATERIALS/EXPLODED VIEW**

P/N 510-02580-00	KIT, QA SECTIONAL BENCH DOCK END BRACKETS		
NUMBER	PART NUMBER	DESCRIPTION	QTY
1	001-02570-01	FASTENERS, QUICK ATT. LADDER/BENCH	1
1A	001-70105-00	HHCS, 3/8-16 X 1" 18-8 SS	2
1B	001-70114-00	HHCS, 3/8-16 X 2-3/4" 18-8 SS	4
1C	001-76071-00	NUT, NYLOCK 3/8-16 ALUM.	4
2	002-00232-01	BRACKET, QA SCTN'L DOCK END BENCH "A" SIDE	1
3	002-00233-01	BRACKET, QA SCTN'L DOCK END BENCH "B" SIDE	1

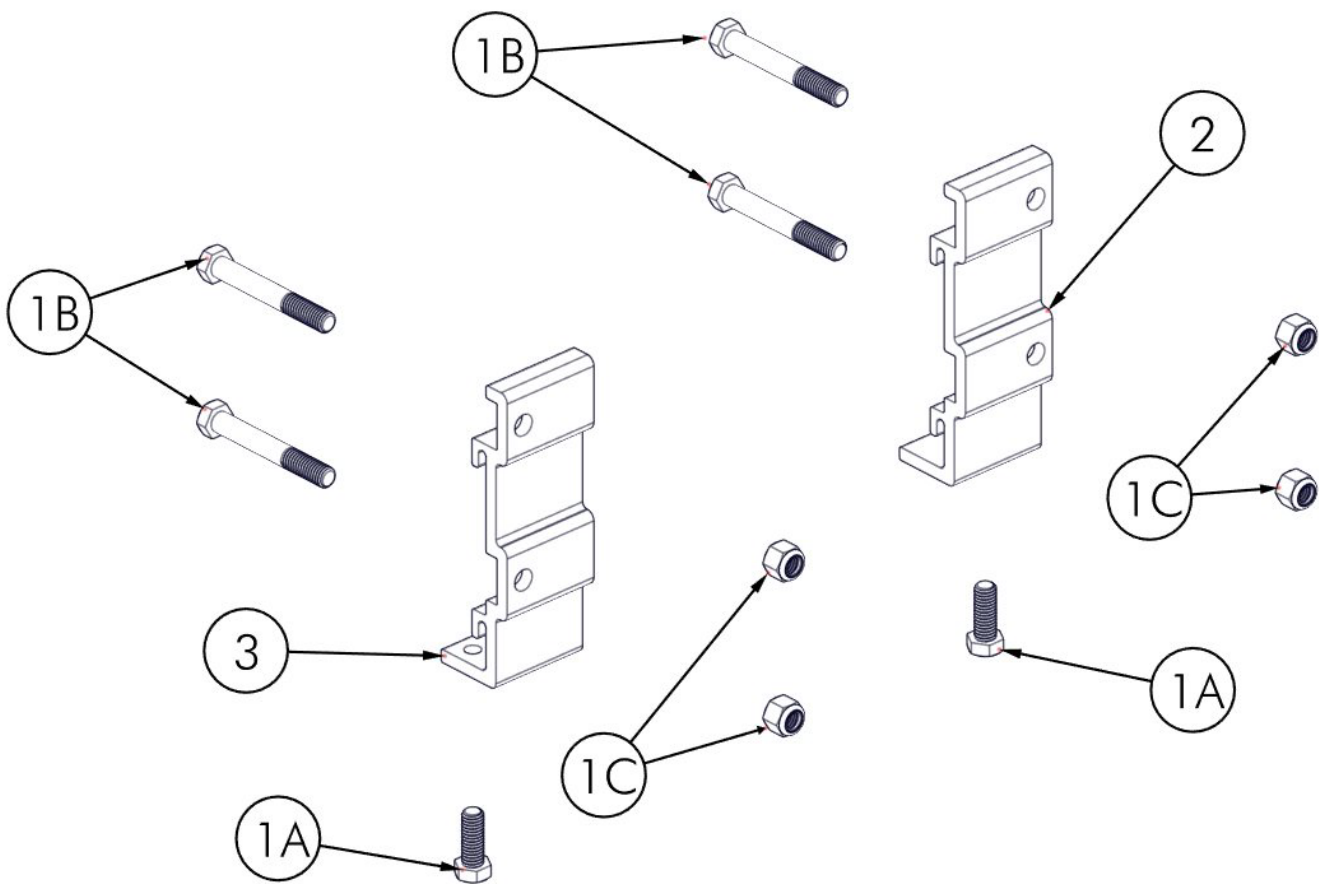

## INSTALLATION

FIRST, DETERMINE WHERE THE BENCH WILL BE INSTALLED ON THE DOCK SYSTEM. INSERT (2) 3/8" X 2-3/4" BOLTS INTO EACH BRACKET AND INTO THE CORRESPONDING HOLES ON THE BENCH (FIGURE 1.1). PLACE A 3/8" NYLOCK NUT ONTO EACH BOLT (FIGURE 1.2). TORQUE TO 25 FT-LB (FIGURE 1.3).

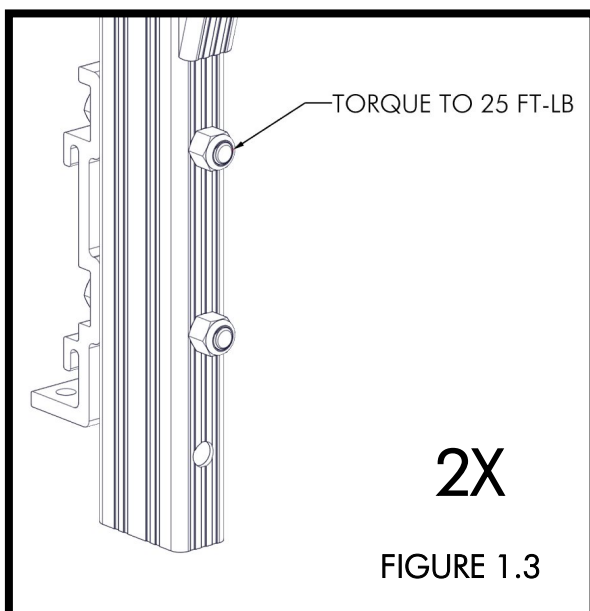
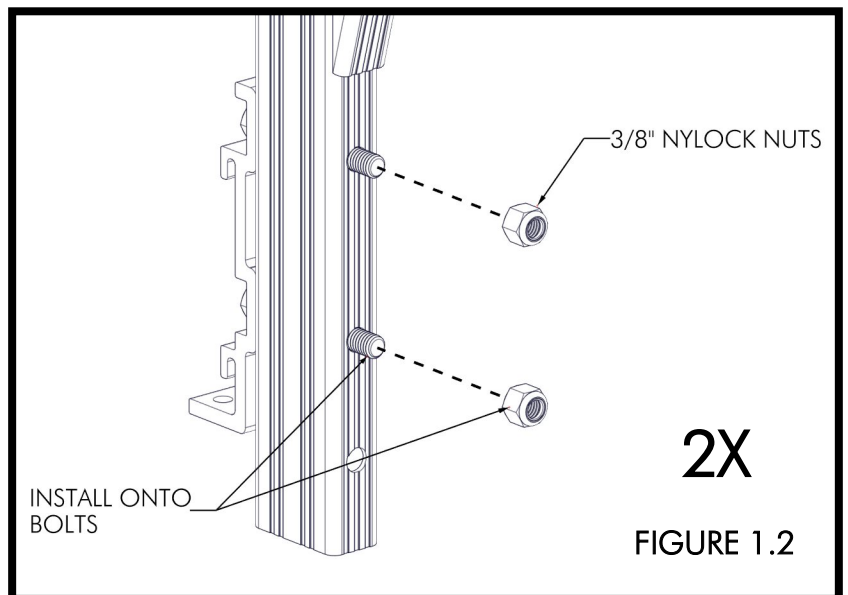
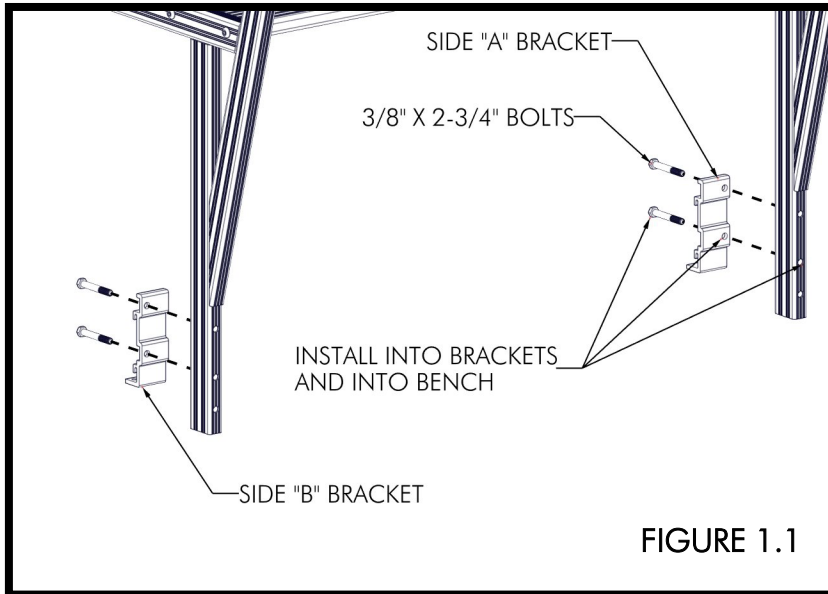

START A 3/8" X 1" BOLT INTO THE BOTTOM OF EACH BRACKET. DO NOT TIGHTEN (FIGURE 1.4). PLACE THE BRACKETS INTO THE DOCK SIDE IN THE DESIRED LOCATION (FIGURE 1.5). TORQUE BOLTS TO **6 FT-LB MAXIMUM** (FIGURE 1.6).

