

**FLOE QUICK ATTACH SECTIONAL  
DOCK STAIRS BRACKET KIT**  
ASSEMBLY INSTRUCTIONS  
KIT P/N 510-02575-00

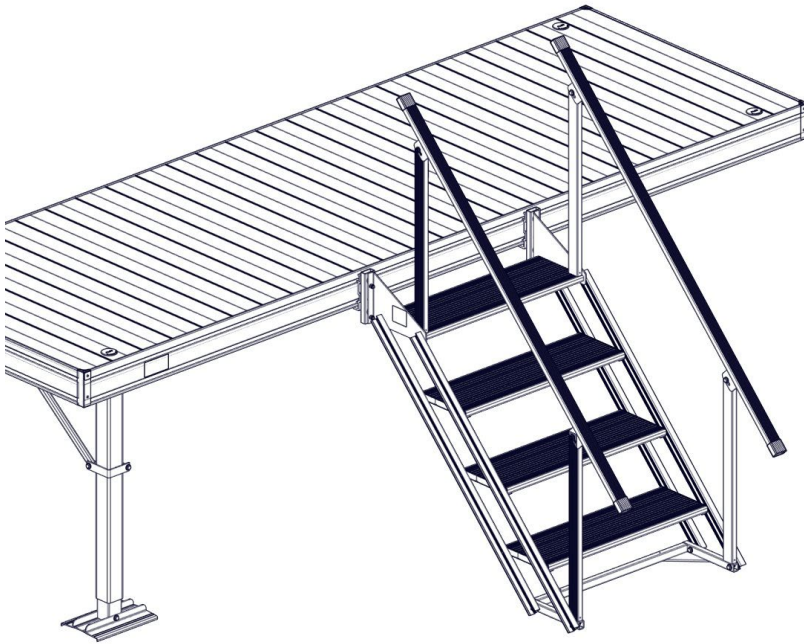

TOOLS REQUIRED  
-(2) 9/16" SOCKETS/WRENCHES  
-TORQUE WRENCH  
-TAPE MEASURE

\*DOCK, LEGS, AND STEPS NOT INCLUDED

NOTE: TWO 9/16" WRENCHES MAY BE  
REQUIRED, DEPENDING ON THE STYLE OF THE  
QUICK ATTACH ACCESSORY BRACKET

**BILL OF MATERIALS/EXPLODED VIEW**

P/N 510-02575-00	KIT, QA SECTIONAL DOCK STEPS		
NUMBER	PART NUMBER	DESCRIPTION	QTY
1	001-02575-01	FASTENERS, QUICK ATT. DOCK STEPS	1
1A	001-37026-00	NUT, 3/8-16 JAM NYLOCK – ZINC	4
1B	001-70103-00	HHCS, 3/8-16 X 3/4" 18-8 SS	4
1C	001-70105-00	HHCS, 3/8-16 X 1" 18-8 SS	2
2	002-00150-01	BRACKET, QA SCTN'L ACCY. – 2"	2

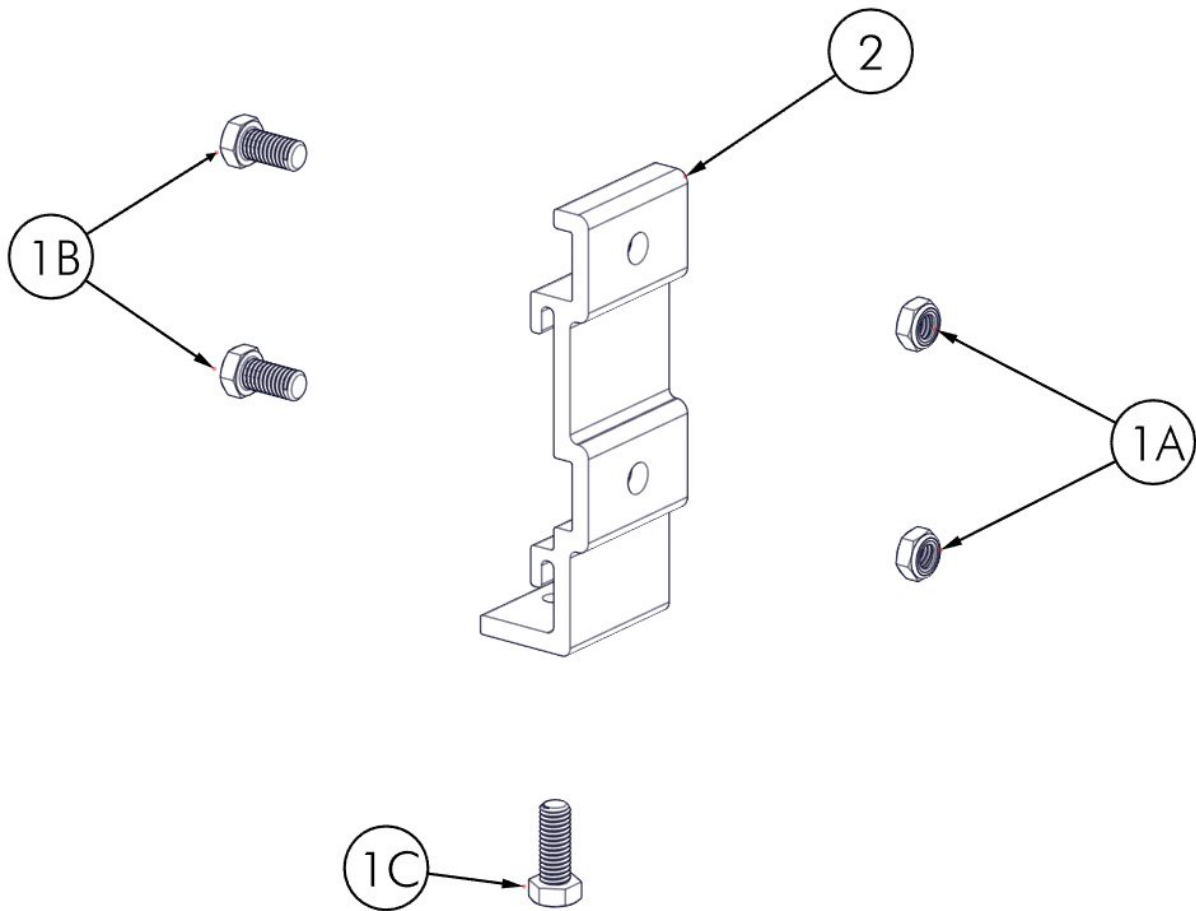

## INSTALLATION

FIRST, DETERMINE WHERE THE STEPS WILL BE INSTALLED ON THE DOCK SYSTEM. INSERT (2) 3/8" X 3/4" BOLTS INTO EACH BRACKET AND INTO THE CORRESPONDING HOLES ON THE QUICK ATTACH ACCESSORY BRACKET AND DOCK STEPS MOUNTING BRACKET (INCLUDED WITH DOCK STEPS). PLACE A 3/8" JAM NYLOCK NUT ONTO EACH BOLT (FIGURE 1.1). TORQUE NUTS TO 35 FT-LB (FIGURE 1.2). START A 3/8" X 1" BOLT INTO THE BOTTOM OF EACH BRACKET. DO NOT TIGHTEN (FIGURE 1.3).

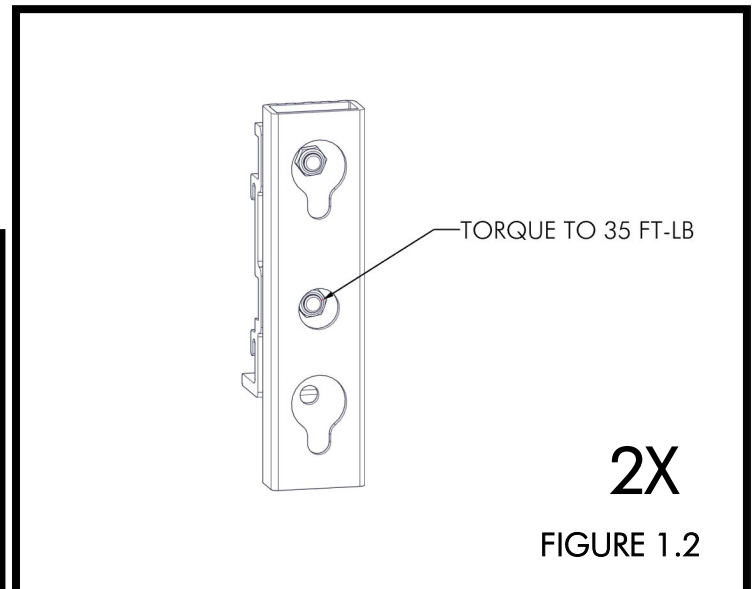
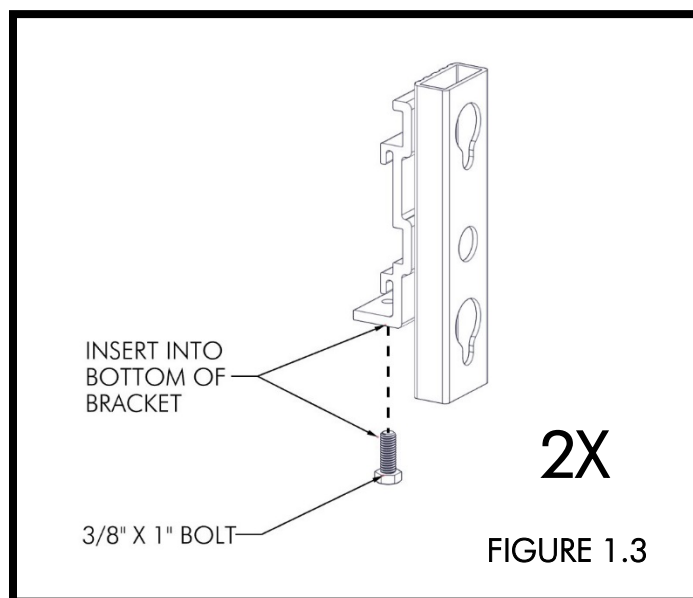
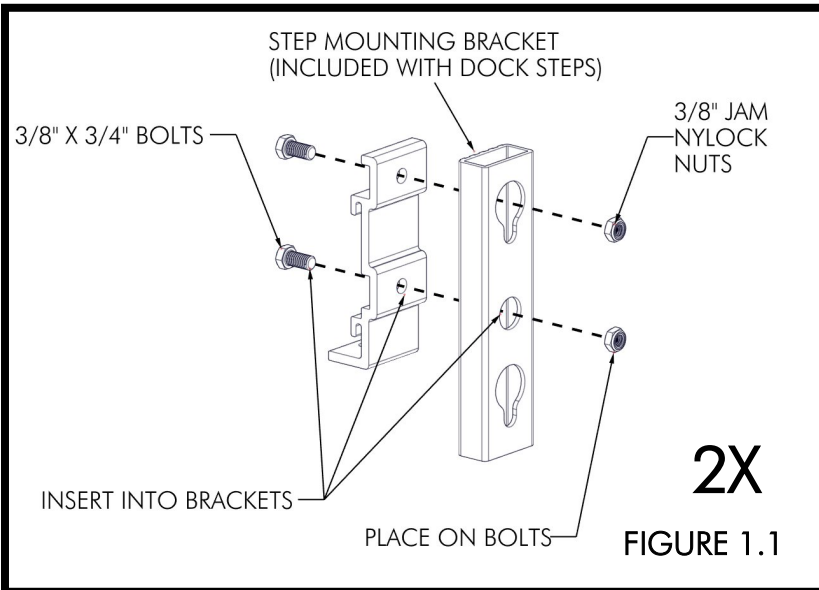

PLACE THE BRACKETS INTO THE DOCK SIDE IN THE DESIRED LOCATION (FIGURE 1.4) AND SPACE THEM 33" APART, CENTER TO CENTER OF THE BRACKETS (FIGURE 1.5). TORQUE BOLTS TO **6 FT-LB MAXIMUM** (FIGURE 1.6).

