

**FLOE QUICK ATTACH SECTIONAL
VERTICAL BUMPER BRACKET KIT**
ASSEMBLY INSTRUCTIONS
KIT P/N 510-02572-00

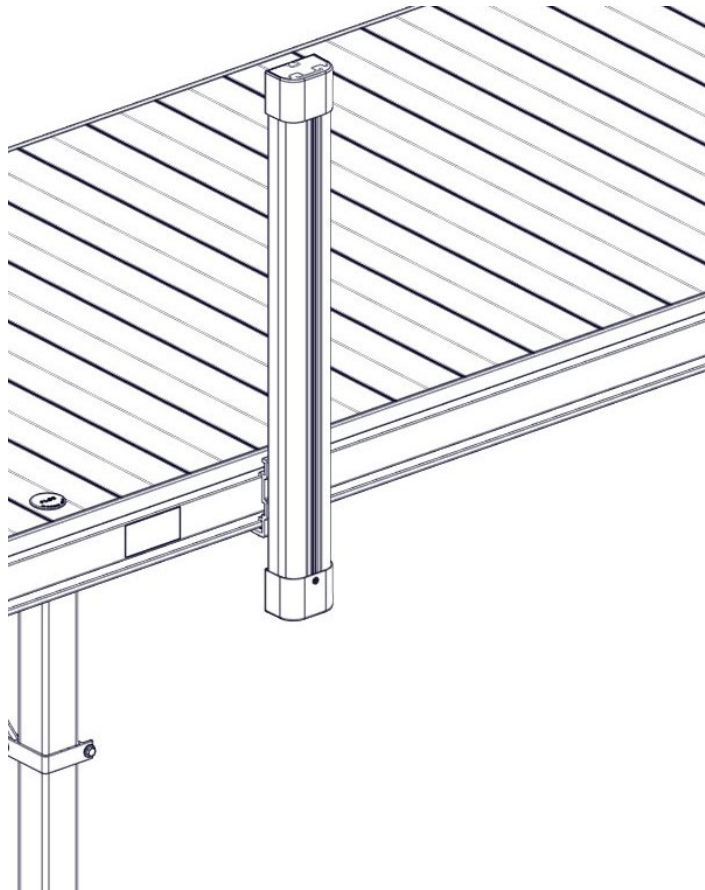

*DOCK, LEGS, AND BUMPER NOT INCLUDED

NOTE: TWO 9/16" WRENCHES MAY BE
REQUIRED, DEPENDING ON THE STYLE OF THE
QUICK ATTACH ACCESSORY BRACKET

TOOLS REQUIRED

-(2) 9/16" SOCKETS/WRENCHES
-TORQUE WRENCH

BILL OF MATERIALS/EXPLODED VIEW

P/N 510-02572-00	KIT, QA SECTIONAL BRKT. VERT. BUMPER		
NUMBER	PART NUMBER	DESCRIPTION	QTY
1	001-02572-03	FASTENERS, QUICK ATT. VERTICAL BUMPER	1
1A	001-70103-00	HHCS, 3/8-16 X 3/4" 18-8 SS	2
1B	001-70105-00	HHCS, 3/8-16 X 1" 18-8 SS	2
1C	001-76349-00	NUT, 3/8-16 ALUM.	2
2	002-00180-00	BRACKET, QA SCTN'L BUMPER – 4"	1

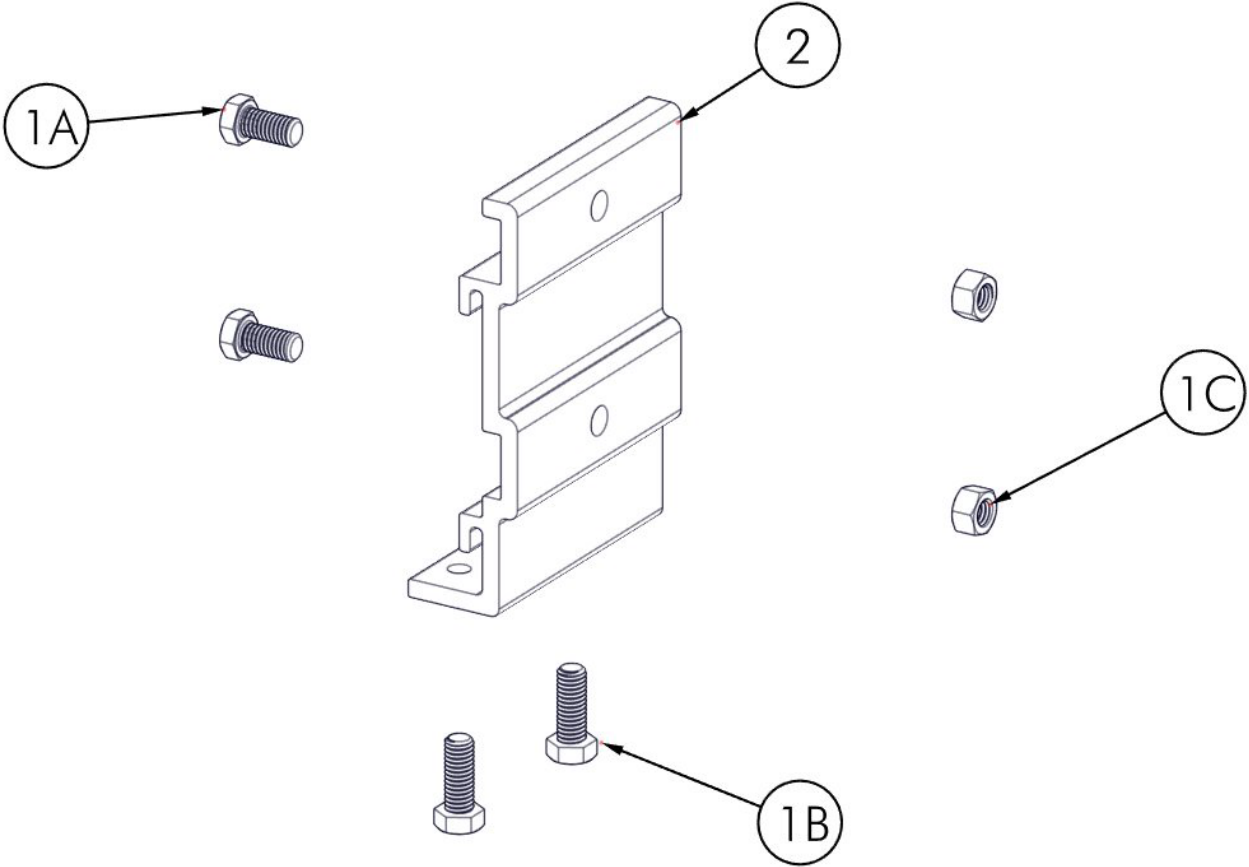

INSTALLATION

FIRST, DETERMINE WHERE THE BUMPER WILL BE INSTALLED ON THE DOCK SYSTEM. WITH THE TOP CAP ON THE BUMPER REMOVED, INSERT (2) 3/8" NUTS INTO THE TRACK (FIGURE 1.1). PLACE (2) 3/8" X 3/4" BOLTS INTO THE BRACKET AND ALIGN THE BOLTS WITH THE NUTS IN THE BUMPER TRACK (FIGURE 1.2).

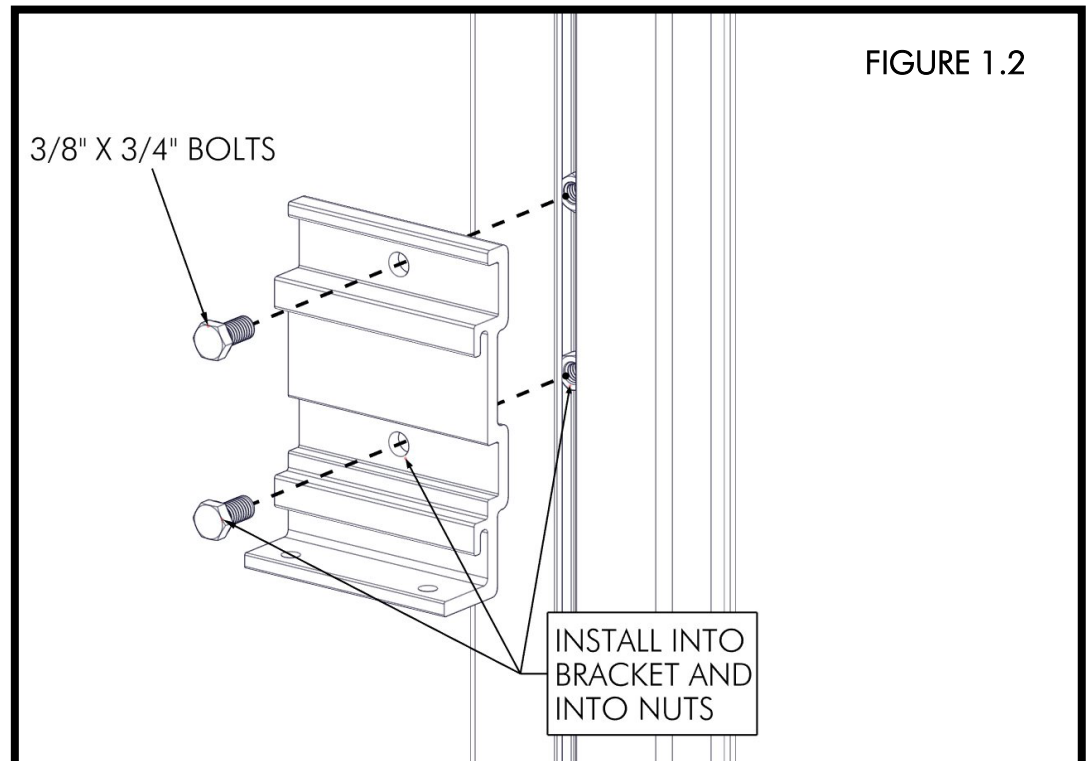
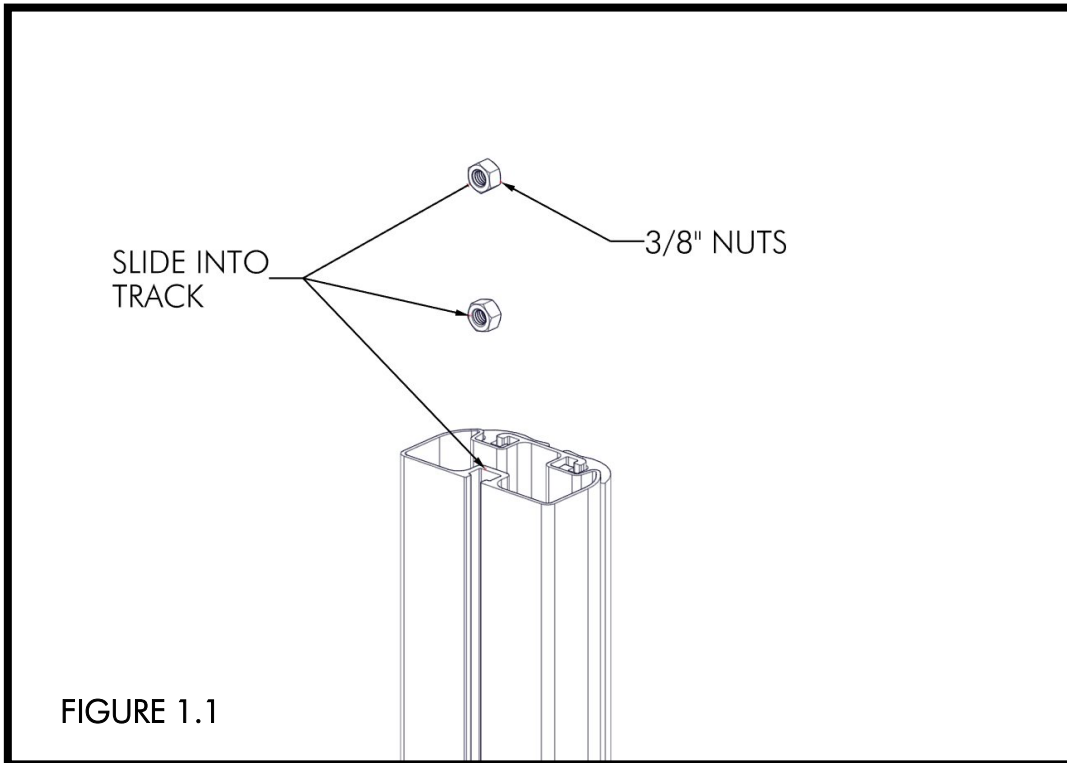

PEEL THE BACKING OFF THE TAPE ON THE SIDES OF THE BUMPER AND ATTACH THE CAP TO THE BUMPER. TO AID IN PLACEMENT, POSITION THE BUMPER AGAINST THE DOCK SIDE. IT IS RECOMMENDED THAT THE BOTTOM OF THE BUMPER IS 3-4" BELOW THE BOTTOM OF THE DOCK FRAME AS SHOWN. THE BUMPER CAN BE ADJUSTED VERTICALLY TO ACCOMMODATE THE RUB RAIL HEIGHT ON YOUR BOAT (FIGURE 1.3). TORQUE BOLTS TO 35 FT-LB (FIGURE 1.4).

FIGURE 1.3

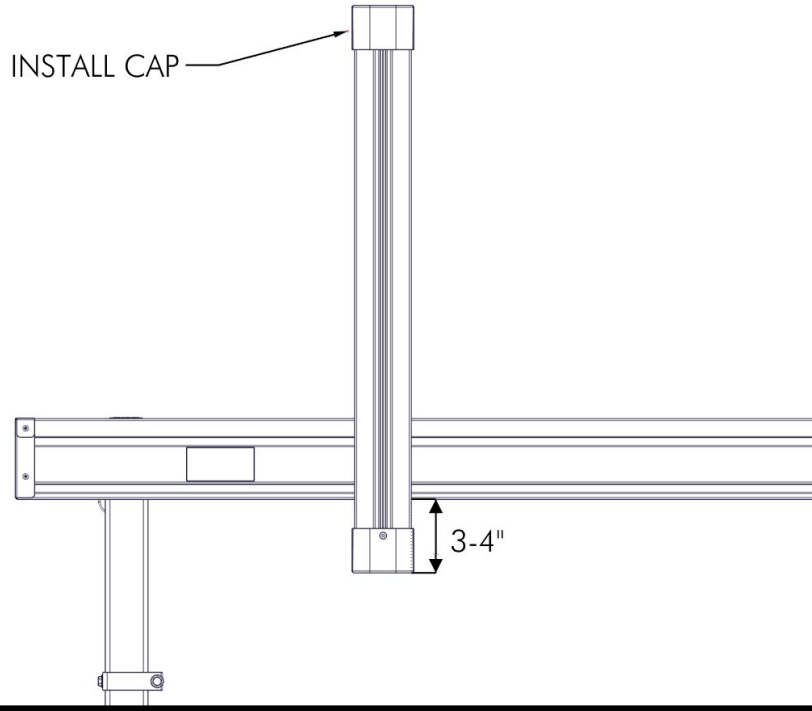

TORQUE TO 35 FT-LB

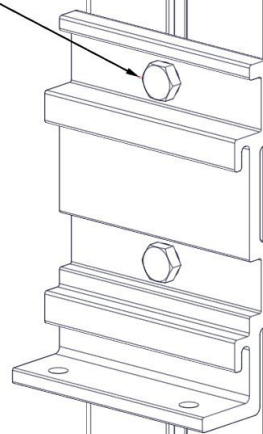
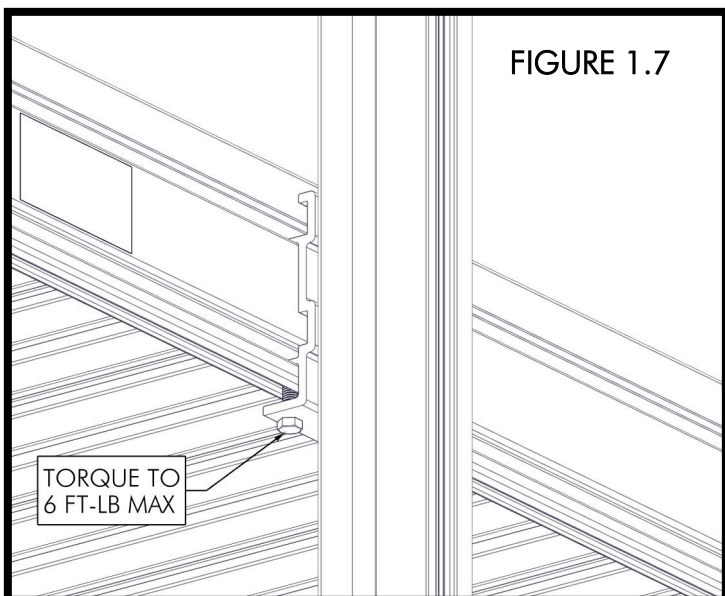
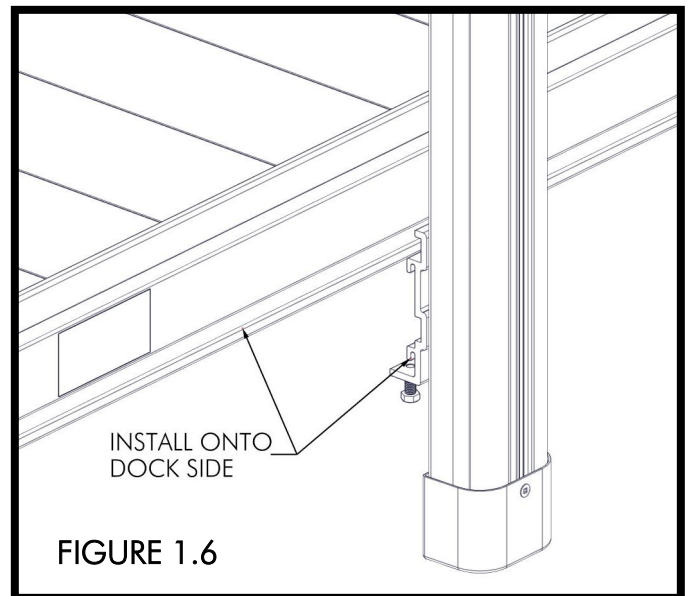
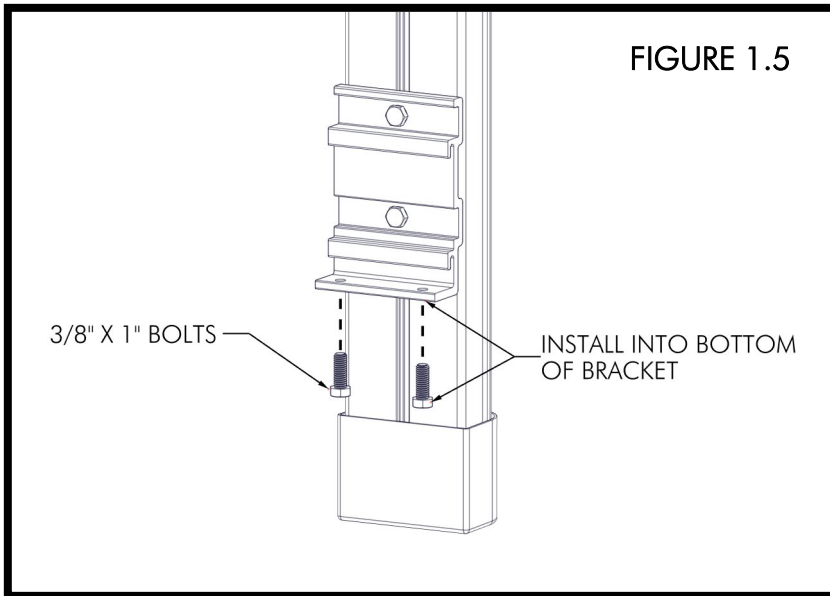

FIGURE 1.4

START (2) 3/8" X 1" BOLTS INTO THE BOTTOM OF EACH BRACKET. DO NOT TIGHTEN (FIGURE 1.5). PLACE THE BRACKETS INTO THE DOCK SIDE IN THE DESIRED LOCATION (FIGURE 1.6). TORQUE BOLTS TO **6 FT-LB MAXIMUM** (FIGURE 1.7).



NOTES

NOTES

