

FLOE FLOATING DOCK MOUNTED ADJUSTABLE BOW STOP ATTACHMENT KIT

ASSEMBLY INSTRUCTIONS

KIT P/N 510-02365-00

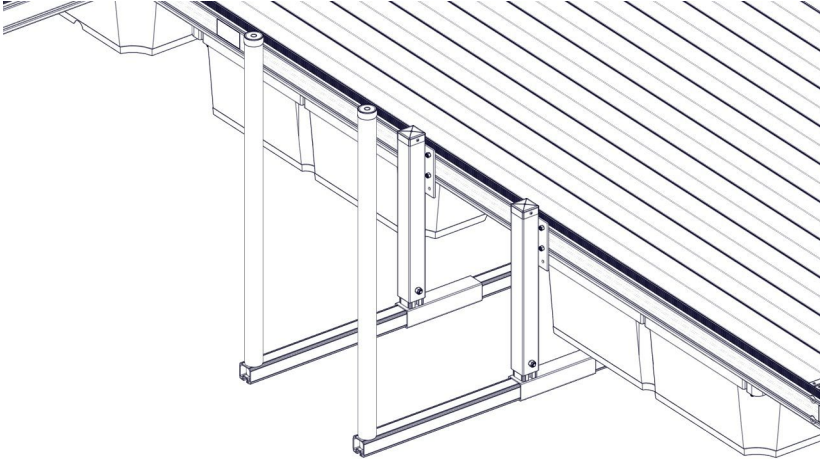

* DOCK NOT INCLUDED

TOOLS REQUIRED

- 9/16" SOCKET/WRENCH
- 3/4" SOCKET/WRENCH
- TAPE MEASURE
- TORQUE WRENCH
- MARKER

IMPORTANT NOTE:

CAUTION MUST BE USED WHEN PARKING A BOAT WITH THIS KIT INSTALLED. BOATS SHOULD BE DRIFTED INTO FINAL POSITION ON BOAT LIFT. FAILURE TO DO SO WILL RESULT IN DAMAGE TO BOAT, BOAT LIFT, AND/OR LIFT ACCESSORIES.

NOTE:

ADJUSTABLE BOW STOP IS SOLD SEPARATELY (KIT P/N 511-00008-01). REFER TO INSTRUCTIONS INCLUDED WITH THE KIT FOR ASSEMBLY.

INSTRUCTION P/N: 610-02365-00
RELEASED 5/24/22

© Manufactured by:
Floe International Inc.
48473 State Hwy. 65
McGregor, MN 55760
www.floeintl.com

BILL OF MATERIALS

P/N 510-02365-00	KIT, DOCK MTD. BOW STOP HRDW. FLOATING		
<u>NO.</u>	<u>PART NUMBER</u>	<u>DESCRIPTION</u>	<u>QTY</u>
1	001-70105-00	HHCS, 3/8-16 X 1" 18-8 SS	8
2	001-71017-00	FLAT WASHER, 3/8" SAE SS 18-8	8
3	001-76071-00	NUT, NYLOCK 3/8-16 ALUM.	8

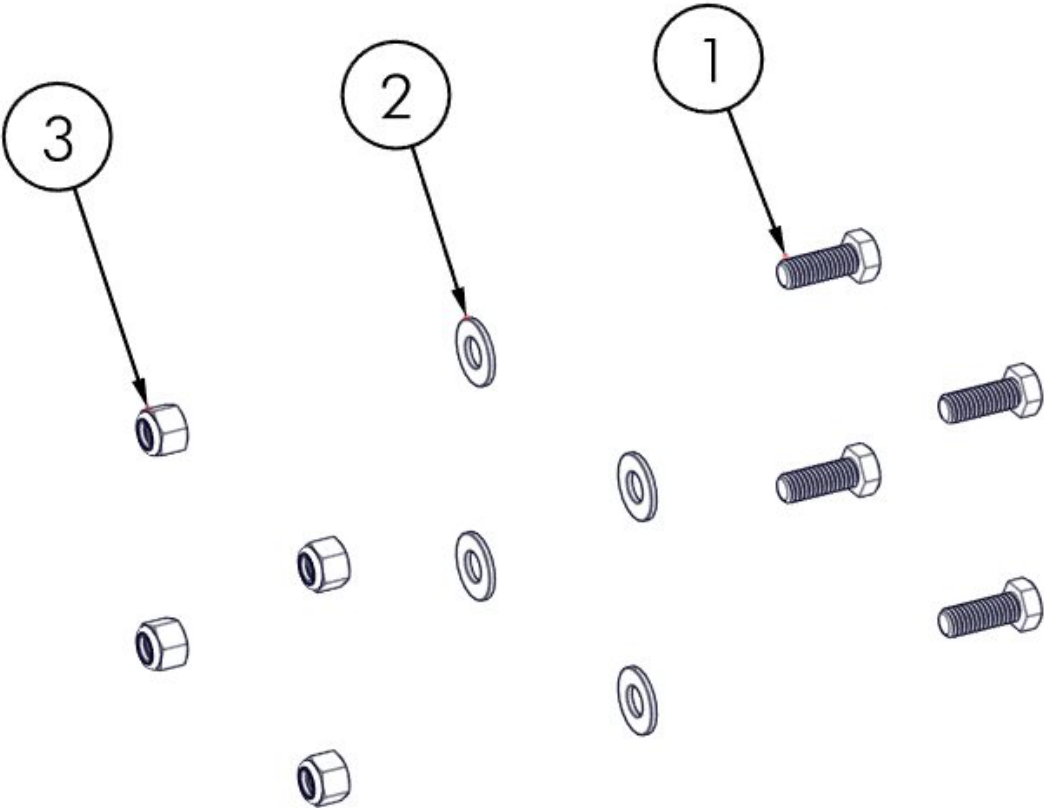

ASSEMBLY

SLIDE (4) 3/8" X BOLTS WITH (4) 3/8" WASHERS INTO THE TRACK TO THE APPROXIMATE FINAL LOCATION (FIGURE 1.1). PLACE UPRIGHT ASSEMBLY ONTO THE BOLTS WITH WASHERS (FIGURE 1.2).

FIGURE 1.1

2X

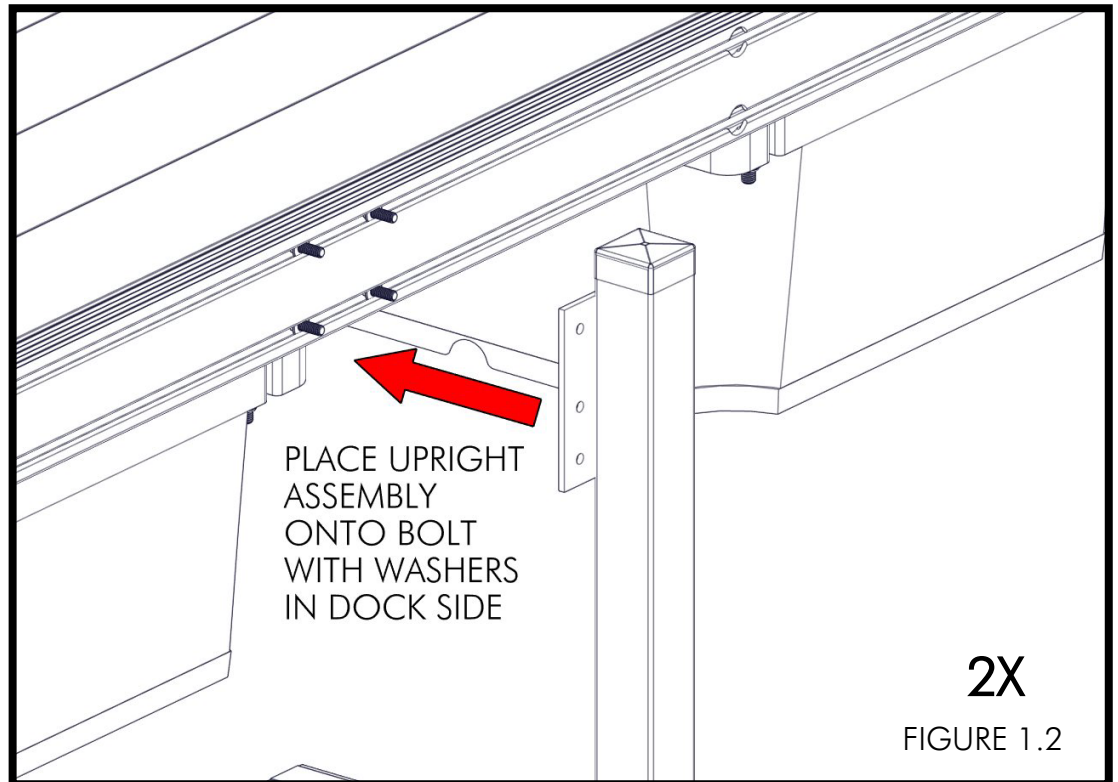
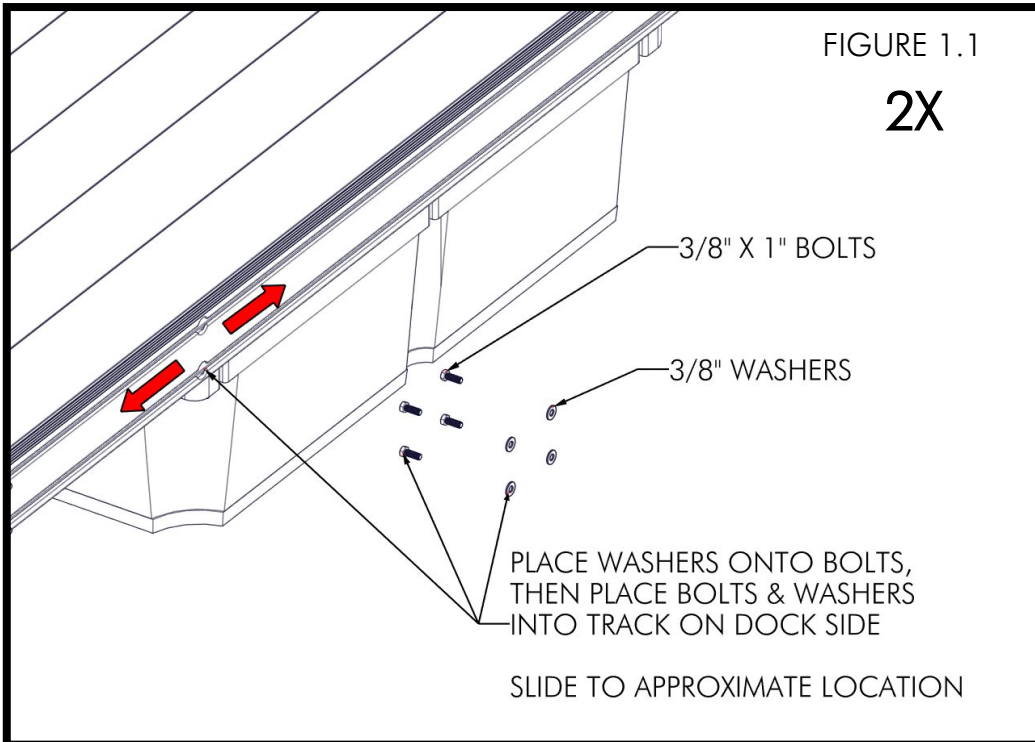

ATTACH USING (4) 3/8" NYLOCK NUTS. DO NOT TORQUE (FIGURE 1.3). SET THE WIDTH OF THE UPRIGHTS ON DOCK USING THE TAKEN MEASUREMENT FROM THE PRE-INSTALLATION STEP. THE PVC UPRIGHTS SHOULD NOT BE BENT FORWARD OR TOWARDS THE SIDES OF THE HULL (FIGURE 1.4).

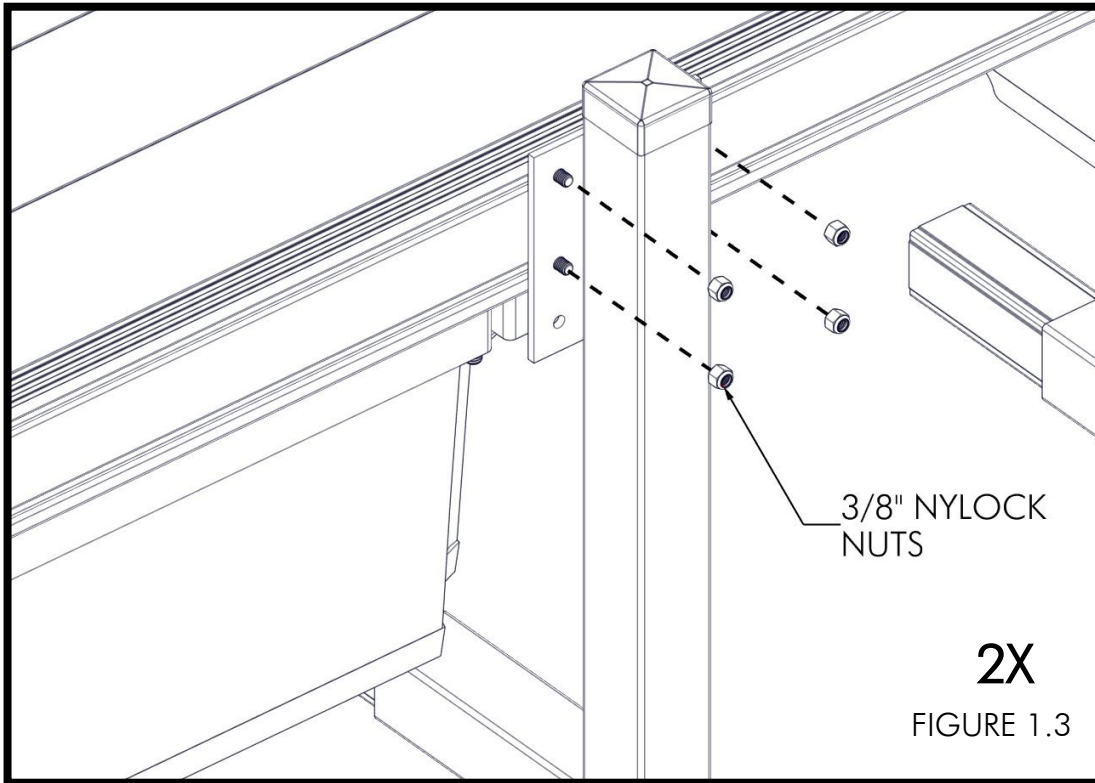
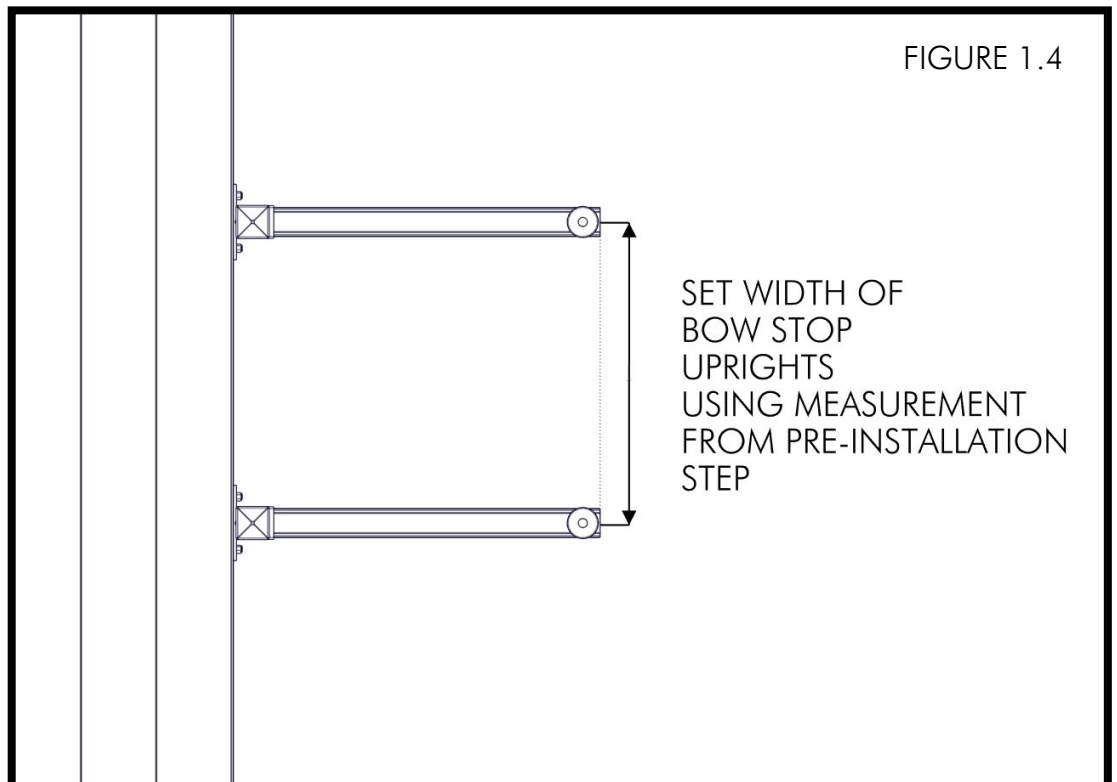
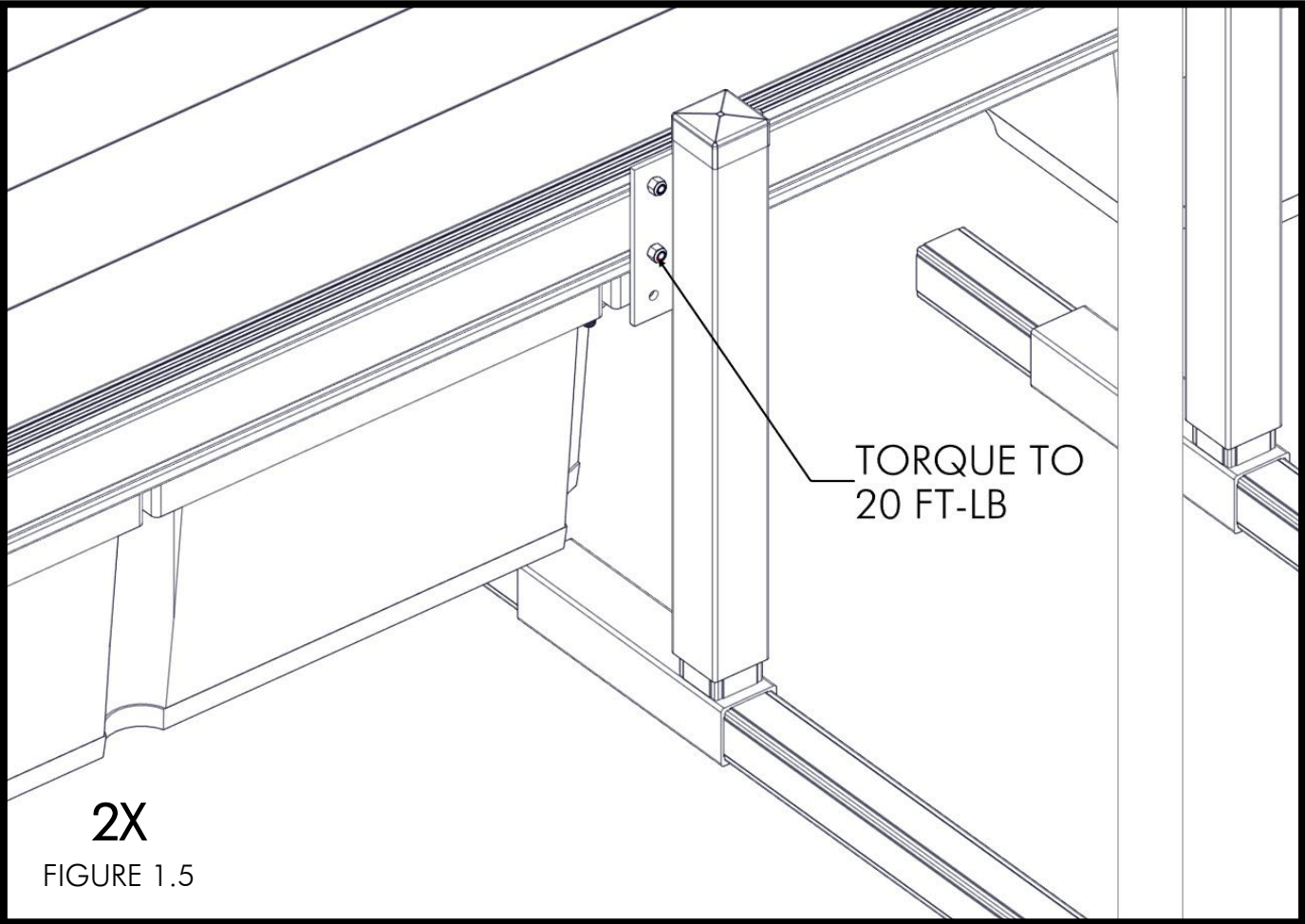

FIGURE 1.4



TORQUE NUTS TO 20 FT-LBS (FIGURE 1.5).



PARK BOAT ON LIFT AND SET THE POSITION OF BOW STOP UPRIGHTS BY SLIDING THE UPRIGHTS UNTIL THEY CONTACT THE BOAT. THE PVC UPRIGHTS SHOULD NOT BE BENT FORWARD OR TOWARDS THE SIDES OF THE HULL AND THE TOP OF THE TUBE SHOULD BE 6-8 INCHES ABOVE THE RUB RAIL WHEN THE BOAT IS FLOATING INSIDE OF THE LIFT. TORQUE 1/2" NYLOCK NUTS TO 20 FT-LB (FIGURES 1.6 & 1.7).

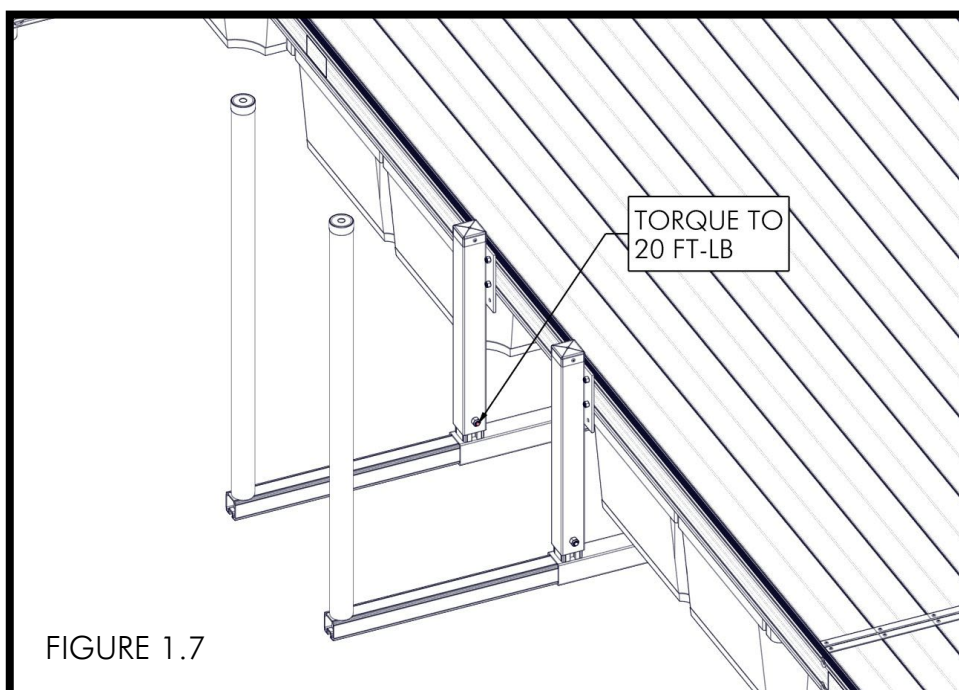
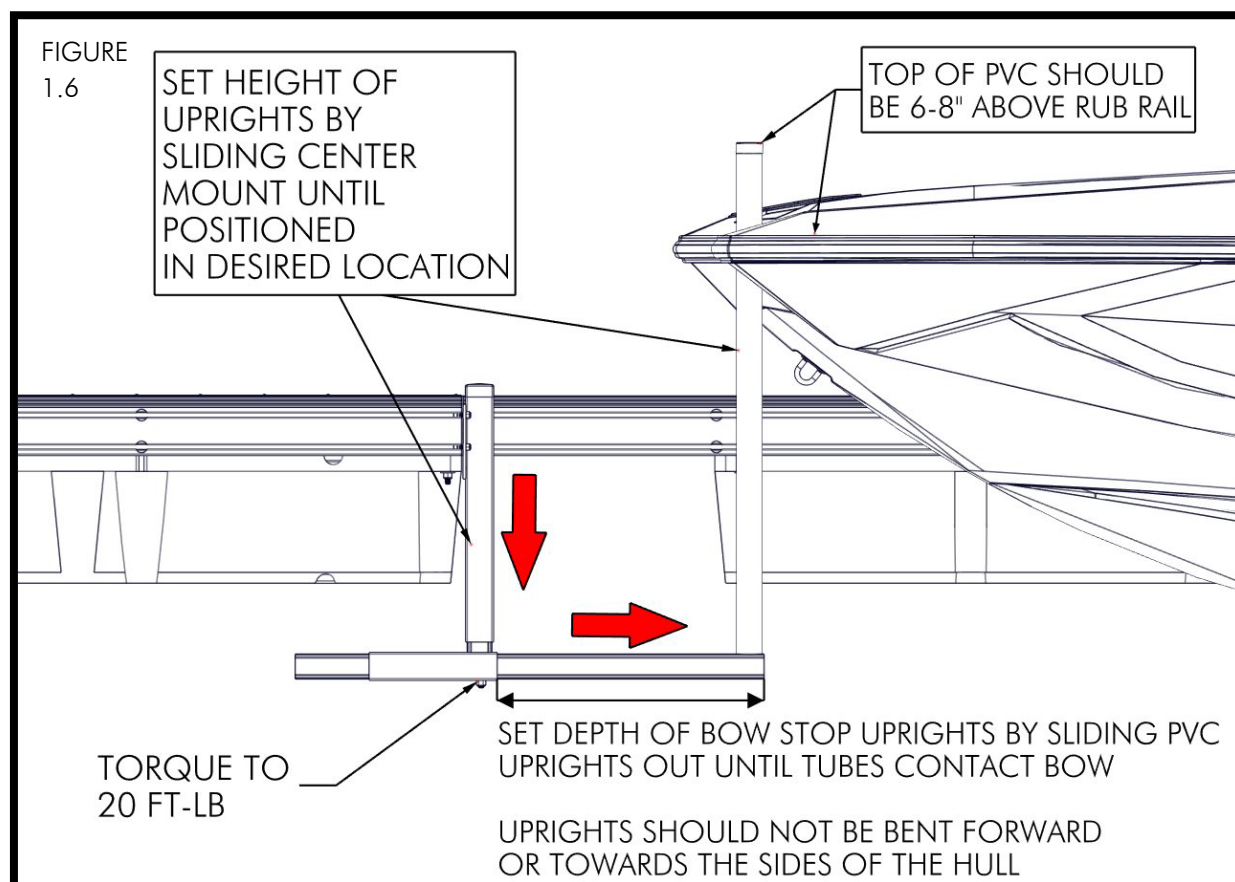

NOTES

