

FLOE STANDARD ROLL-IN DOCK MOUNTED ADJUSTABLE BOW STOP ATTACHMENT KIT

ASSEMBLY INSTRUCTIONS

KIT P/N 510-02364-00

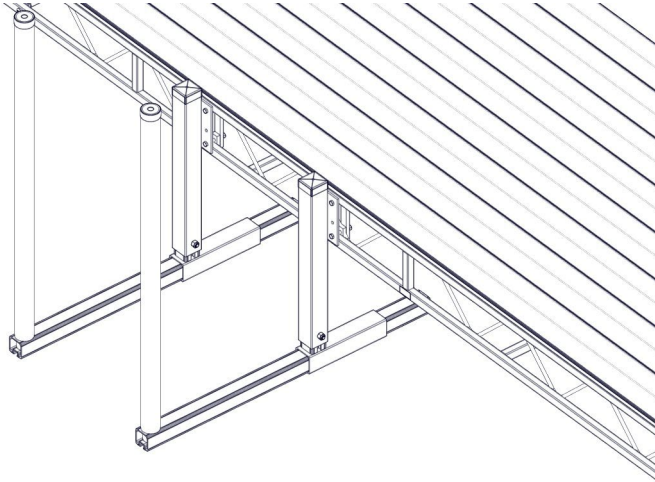

* DOCK NOT INCLUDED

TOOLS REQUIRED

- (2) 9/16" SOCKETS/WRENCHES
- 3/4" SOCKET/WRENCH
- TAPE MEASURE
- TORQUE WRENCH
- MARKER

IMPORTANT NOTE:

CAUTION MUST BE USED WHEN PARKING A BOAT WITH THIS KIT INSTALLED. BOATS SHOULD BE DRIFTED INTO FINAL POSITION ON BOAT LIFT. FAILURE TO DO SO WILL RESULT IN DAMAGE TO BOAT, BOAT LIFT, AND/OR LIFT ACCESSORIES.

NOTE:

ADJUSTABLE BOW STOP IS SOLD SEPARATELY (KIT P/N 511-00008-01). REFER TO INSTRUCTIONS INCLUDED WITH THE KIT FOR ASSEMBLY.

INSTRUCTION P/N: 610-02364-00
RELEASED 5/24/22

© Manufactured by:
Floe International Inc.
48473 State Hwy. 65
McGregor, MN 55760
www.floeintl.com

BILL OF MATERIALS

P/N 511-02364-00	KIT, DOCK MTD. BOW STOP HRDW. STD. ROLL-IN		
<u>NO.</u>	<u>PART NUMBER</u>	<u>DESCRIPTION</u>	<u>QTY</u>
1	001-70114-00	HHCS, 3/8-16 X 2-3/4" 18-8 SS	8
2	001-71067-00	LOCK WASHER, 3/8" S/W SS 18-8	8
3	001-76349-00	NUT, 3/8-16 ALUM.	8
4	002-02203-00	PLATE, DOCK ACCESSORY	4
5	002-02204-00	SPACER, DOCK ACCESSORY	8

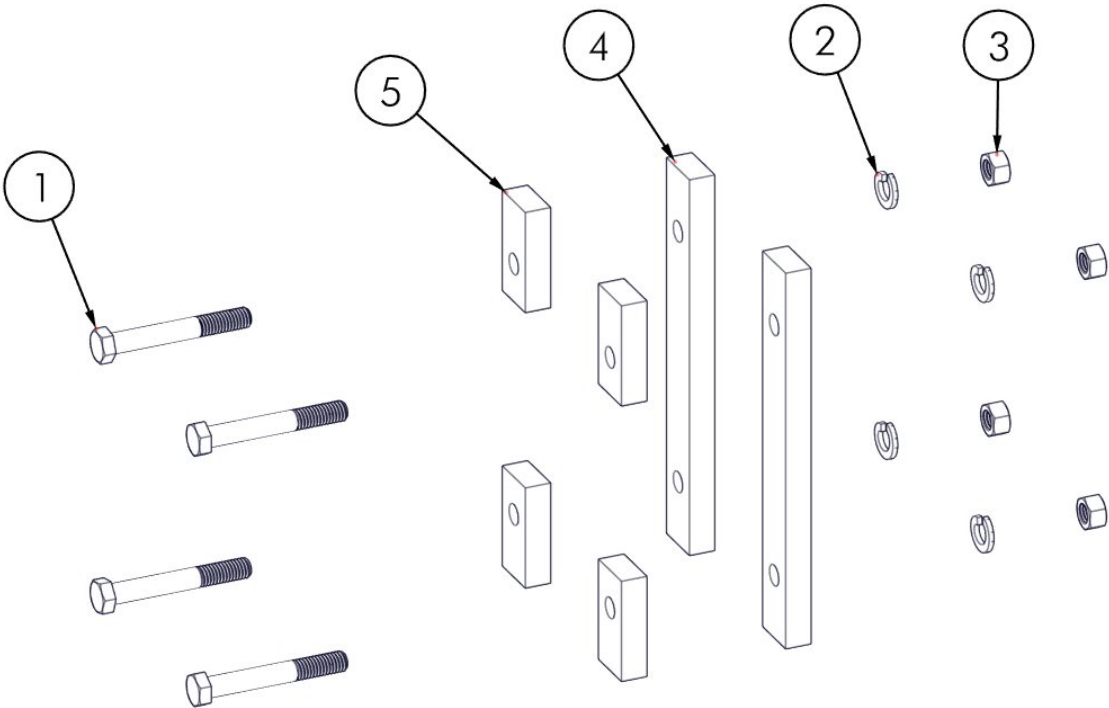

ASSEMBLY

MARK THE WIDTH OF THE BOW STOP UPRIGHTS ONTO DOCK USING THE TAKEN MEASUREMENT FROM THE PRE-INSTALLATION STEP OF THE BOW STEP ASSEMBLY INSTRUCTIONS (WITH 511-00008-00). THE PVC UPRIGHTS SHOULD NOT BE BENT FORWARD OR TOWARDS THE SIDES OF THE HULL (FIGURE 1.1). SLIDE (4) 3/8" X 2-3/4" BOLTS INTO EACH UPPER MOUNT ASSEMBLY (FIGURE 1.2).

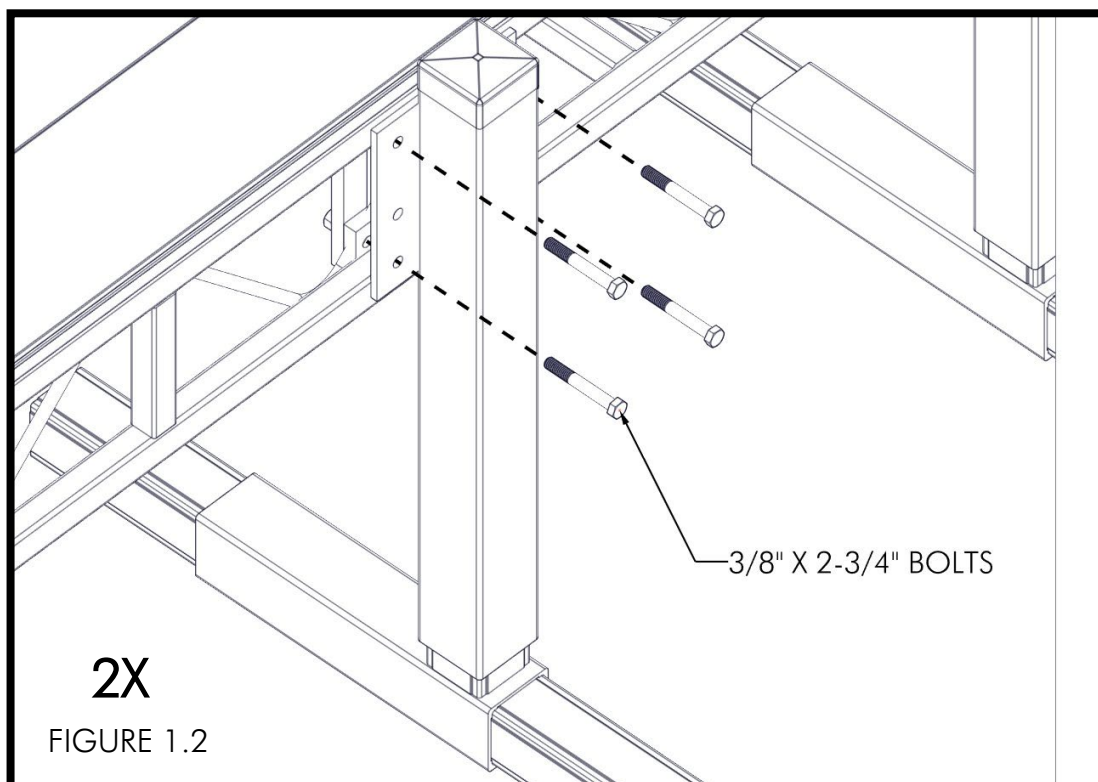
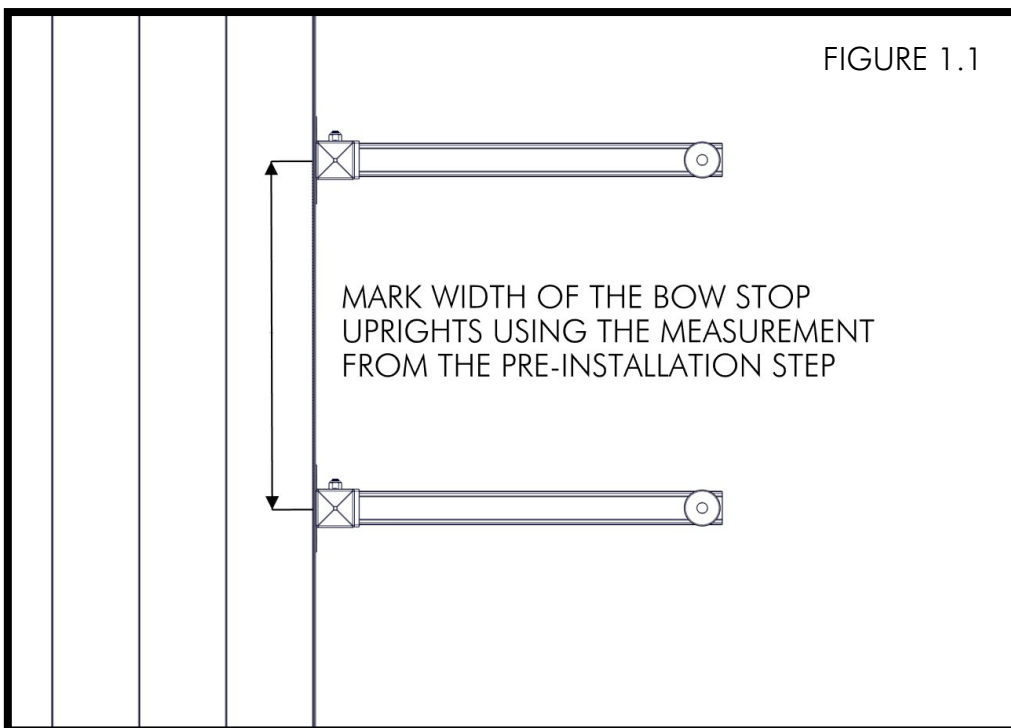

ATTACH MOUNT TO DOCK WITH, DOCK PLATES, SPACERS, (4) 3/8" LOCK WASHERS, AND (4) 3/8" NUTS. FOR PLACEMENTS NEAR WEBBING, SPACERS MAY NOT BE USED (FIGURE 1.3). TORQUE TO 20 FT-LBS (FIGURE 1.4).

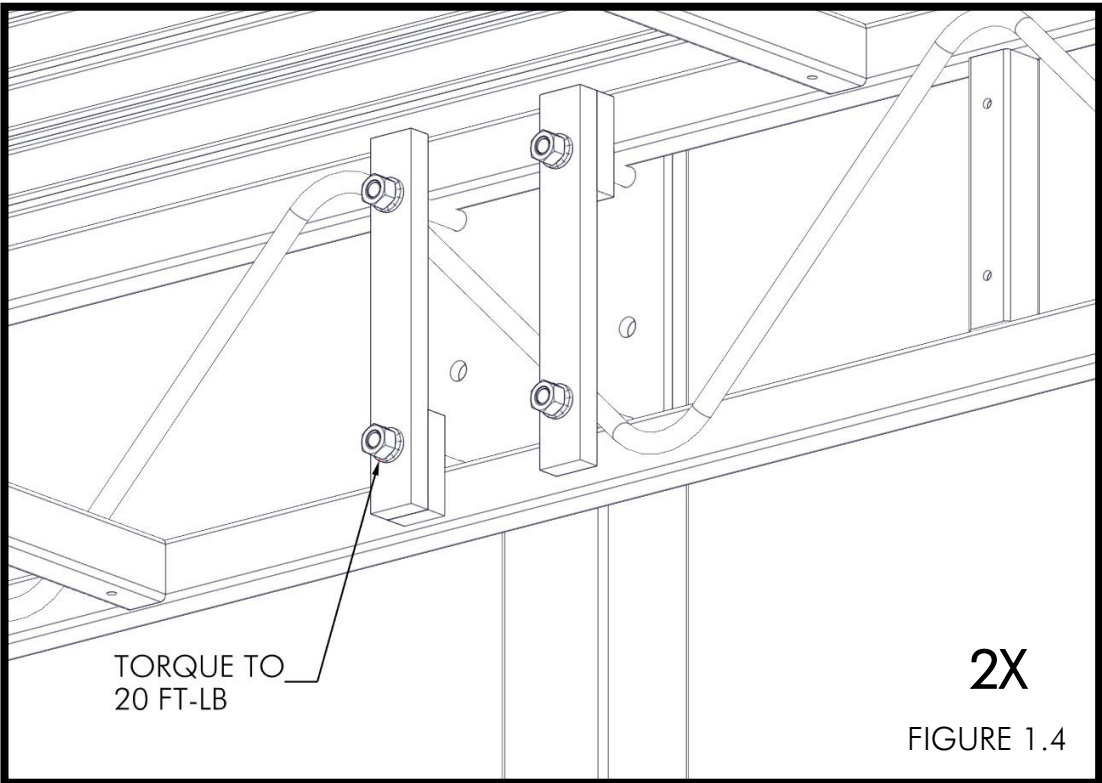
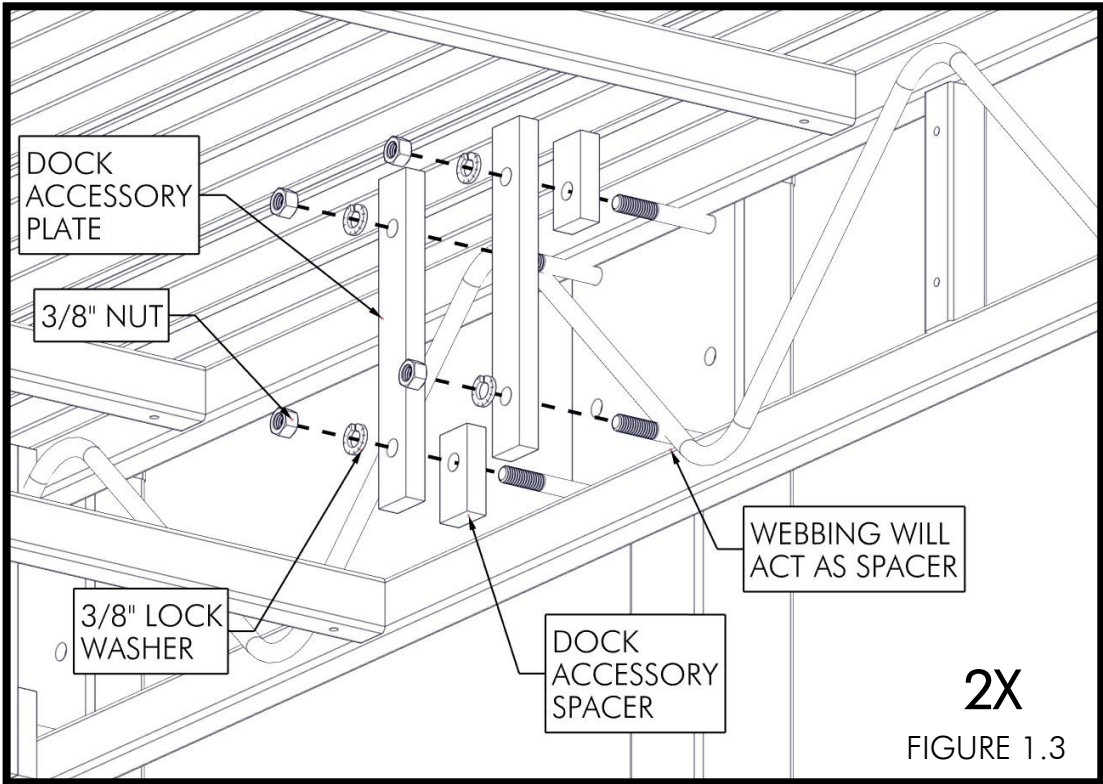

PARK BOAT ON LIFT AND SET THE POSITION OF BOW STOP UPRIGHTS BY SLIDING THE UPRIGHTS UNTIL THEY CONTACT THE BOAT. THE PVC UPRIGHTS SHOULD NOT BE BENT FORWARD OR TOWARDS THE SIDES OF THE HULL AND THE TOP OF THE TUBE SHOULD BE 6-8 INCHES ABOVE THE RUB RAIL WHEN THE BOAT IS FLOATING INSIDE OF THE LIFT. TORQUE 1/2" NYLOCK NUTS TO 20 FT-LBS (FIGURES 1.5 & 1.6).

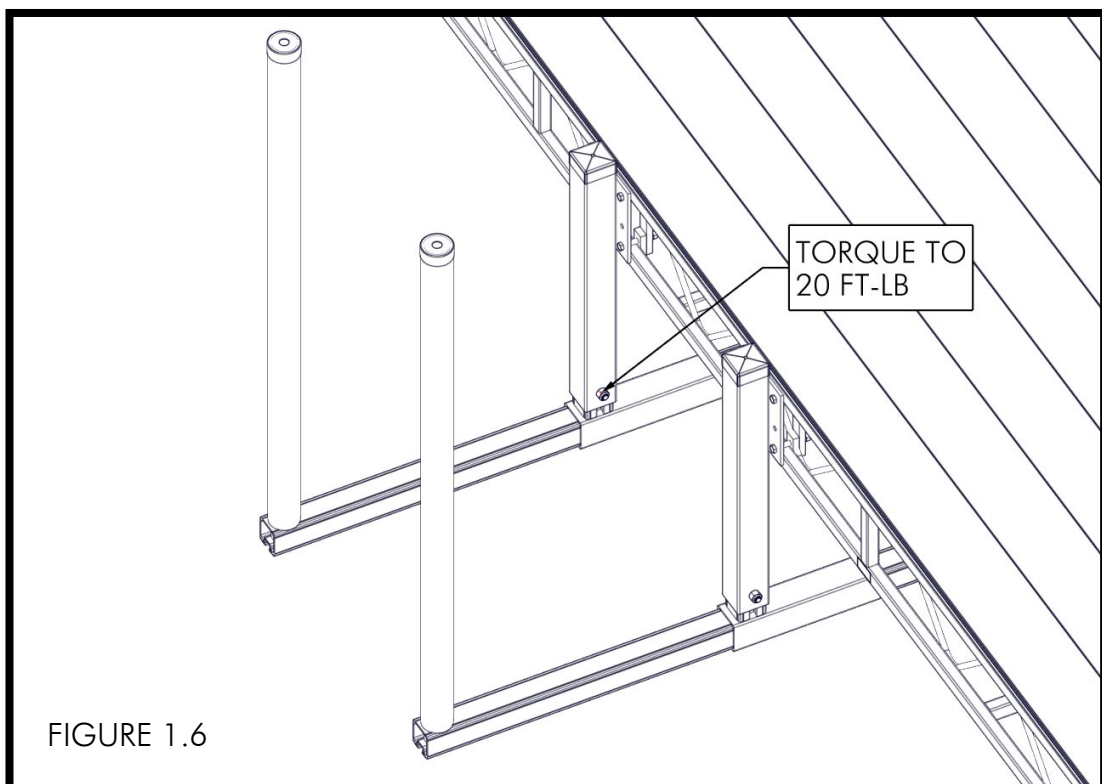
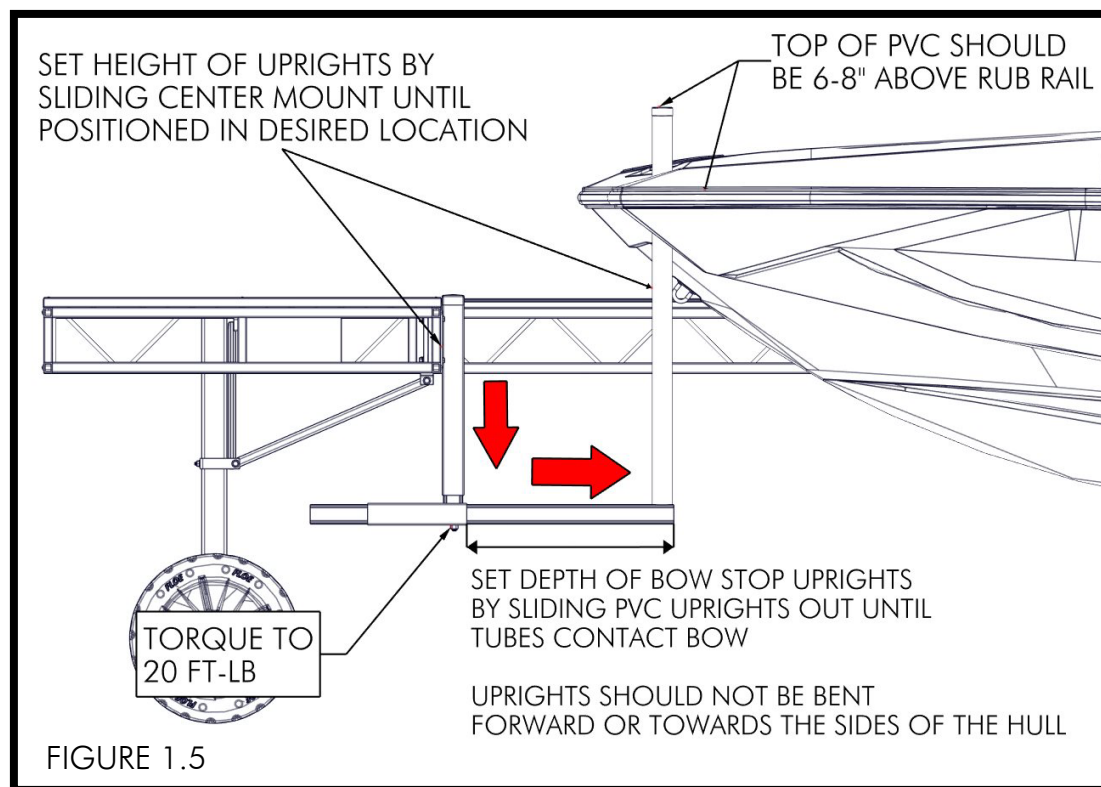

NOTES

NOTES

