

# FLOE FLOATING DOCK FURNITURE ATTACHMENT KIT

## ASSEMBLY INSTRUCTIONS

KIT P/N 510-00463-00 CHAIR MOUNTING

P/N 510-00464-00 TABLE MOUNTING

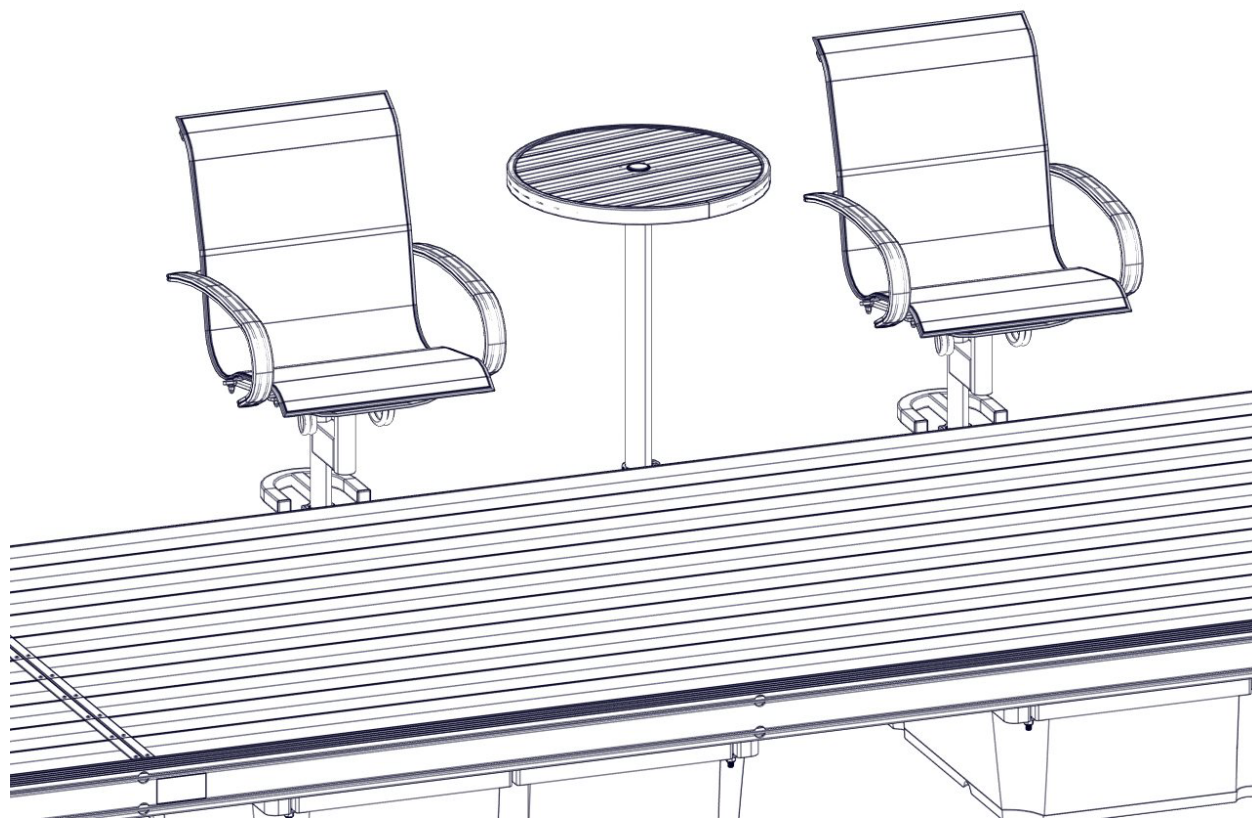

\*DOCK SECTION NOT INCLUDED

### **NOTE:**

REFER TO THE FURNITURE INSTRUCTIONS  
FOR INSTALLATION OF CHAIRS & TABLE.

### TOOLS REQUIRED

- 9/16" SOCKET/WRENCH
- 3/4" SOCKET WRENCH
- TAPE MEASURE
- TORQUE WRENCH

INSTRUCTION P/N: 610-02350-00  
RELEASED 7/28/22

SHEET 1 OF 8

© Manufactured by:  
Floe International Inc.  
48473 State Hwy. 65  
McGregor, MN 55760  
[www.floeintl.com](http://www.floeintl.com)

## BILL OF MATERIALS/EXPLODED VIEW

P/N 510-00463-00	CHAIRS, FLOATING DOCK (2 CHAIRS)		
NUMBER	PART NUMBER	DESCRIPTION	QTY
	210-07019-00	POCKETS, CHAIR (2) (INCLUDES ITEM #1)	1
1	002-07019-00	POCKET, CHAIR MOUNT	2
2	310-00425-00	KIT, DOCK CHAIRS (PAIR)	1
3	510-02370-00	HDWR, FLOATING DOCK CHAIR MTG.	1
3A	001-70105-00	HHCS, 3/8-16 X 1" 18-8 SS	8
3B	001-70205-00	HHCS, 1/2-13 X 1" SS 18-8	2
3C	001-71017-00	FLAT WASHER, 3/8" SAE SS 18-8	8
3D	001-76071-00	NUT, NYLOCK 3/8-16 ALUM.	8
3E	001-76350-00	NUT, 1/2-13 ALUM.	2

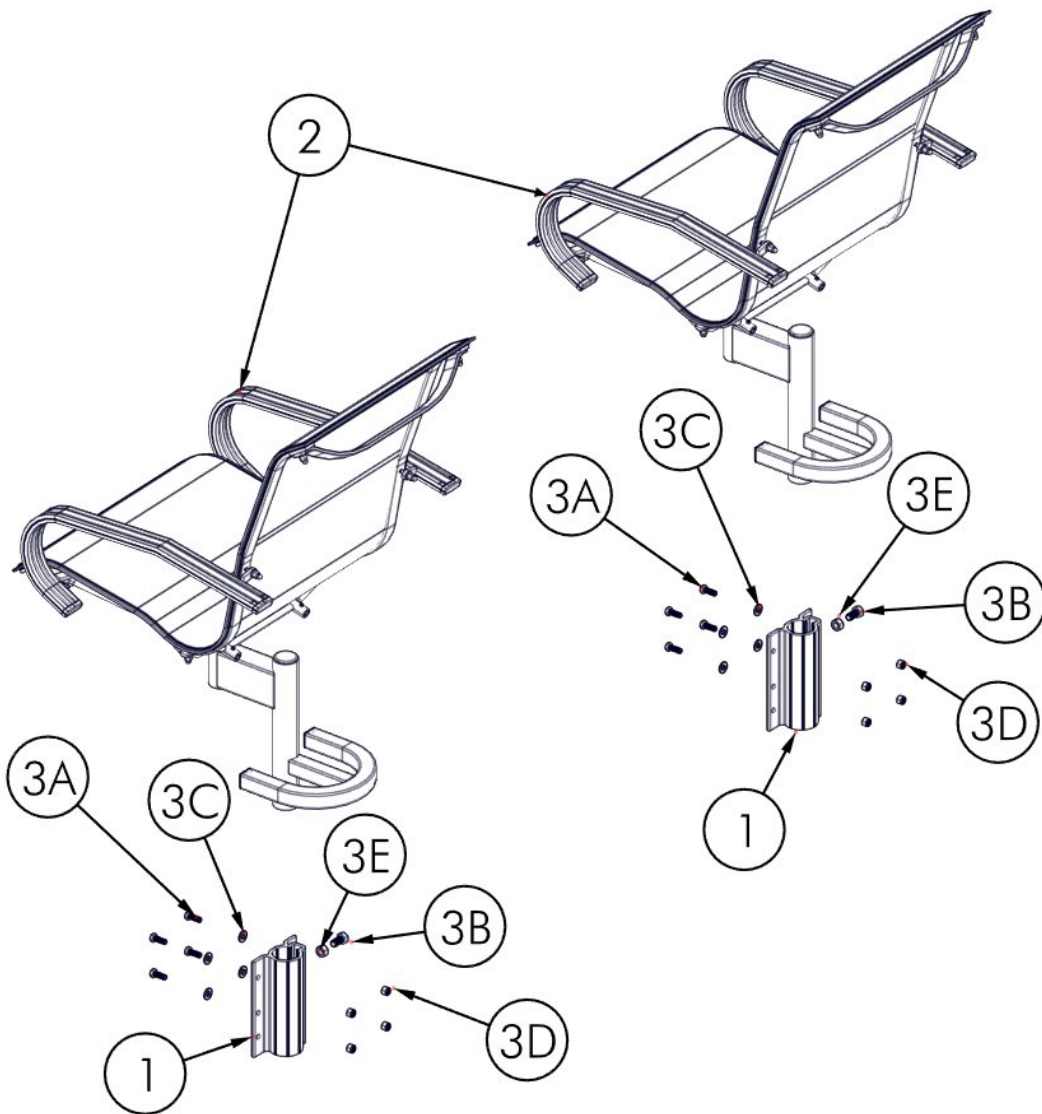

**BILL OF MATERIALS/EXPLODED VIEW**

P/N 510-00464-00	TABLE, FLOATING DOCK		
NUMBER	PART NUMBER	DESCRIPTION	QTY
	210-07020-00	POCKET, TABLE (INCLUDES ITEM #1)	1
1	002-07020-00	POCKET, TABLE MOUNT	1
2	310-00430-00	KIT, DOCK TABLE	1
3	510-02371-00	HDWR, FLOATING DOCK TABLE MTG.	1
3A	001-70105-00	HHCS, 3/8-16 X 1" 18-8 SS	4
3B	001-70110-00	HHCS, 3/8-16 X 1-3/4" 18-8 SS	2
3C	001-71017-00	FLAT WASHER, 3/8" SAE SS 18-8	4
3D	001-76071-00	NUT, NYLOCK 3/8-16 ALUM.	4

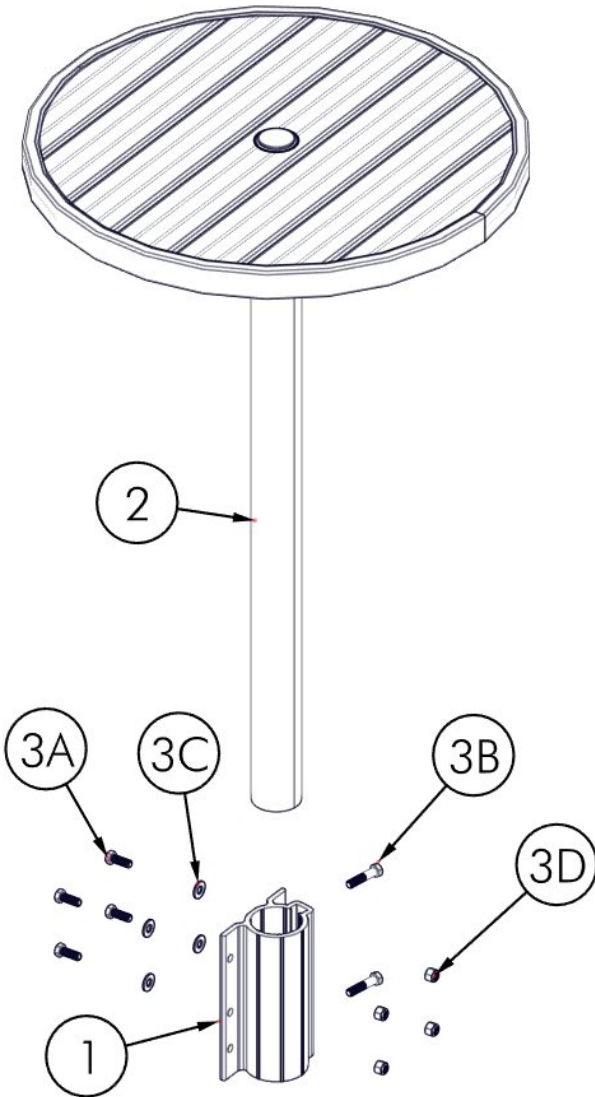

## RECOMMENDED INSTALLATION LAYOUTS

REFER TO THE IMAGES BELOW FOR THE TYPE OF DOCK YOU ARE INSTALLING THE FURNITURE ON TO DETERMINE WHICH LAYOUT IS BEST FOR YOUR CONFIGURATION. **NOTE: THERE ARE SEVERAL CONFIGURATIONS THAT ARE NOT RECOMMENDED.**

**WARNING: ENSURE THAT SAFETY QUICK CONNECTS ARE USED ON ROLL-IN AND SECTIONAL DOCKS SO THE DOCK SECTIONS DO NOT**

### RECOMMENDED SAMPLE FLOATING AND ROLL-IN LAYOUTS

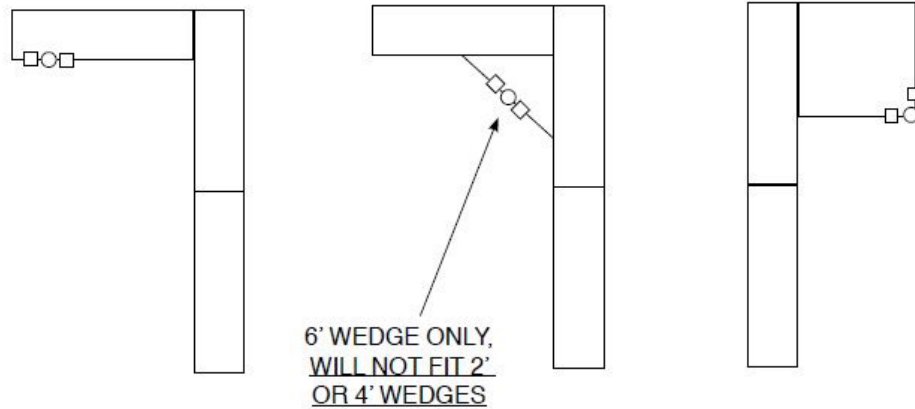

### NOT RECOMMENDED LAYOUT FOR FLOATING, ROLL-IN OR SECTIONALS

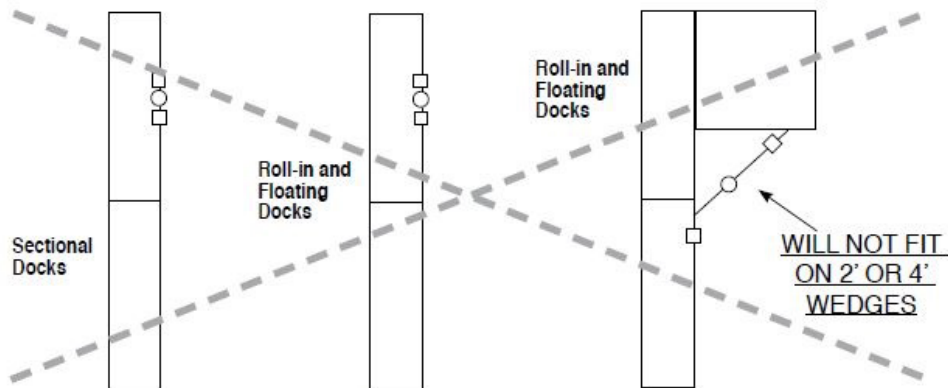

## ASSEMBLY

FIRST, DETERMINE WHERE THE FURNITURE WILL BE INSTALLED ON THE DOCK SYSTEM. PLACE A 3/8" WASHER ONTO EACH OF THE (12) 3/8" X 1" BOLTS (FIGURE 1.1), THEN INSERT THE HEX HEAD AND WASHER INTO THE TRACK ON THE DOCK SIDE (6 SETS ON THE TOP TRACK, 6 SETS ON THE BOTTOM TRACK) (FIGURE 1.2).

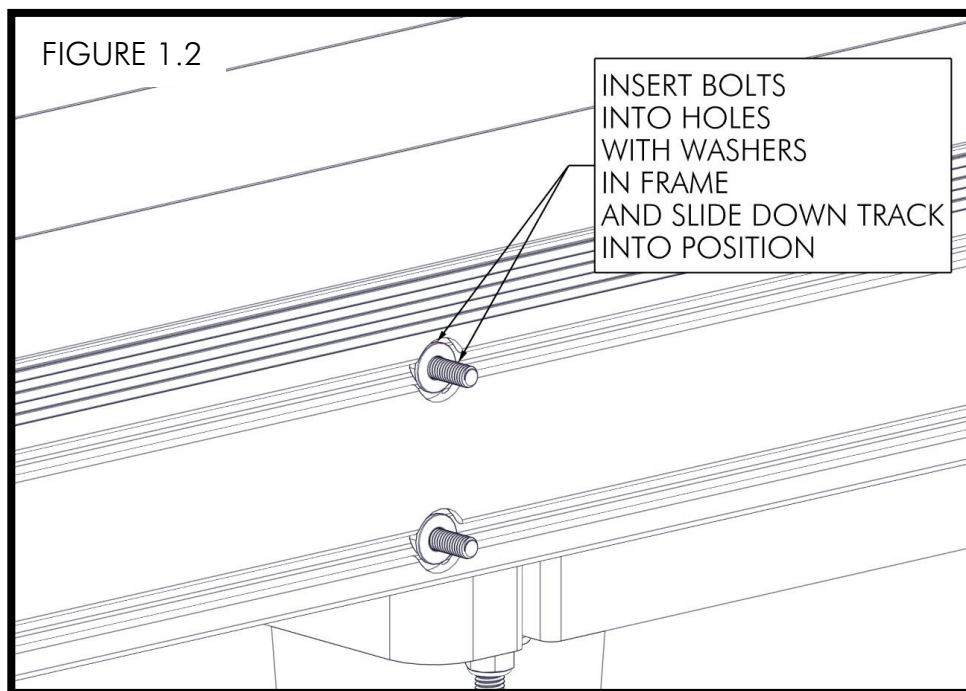
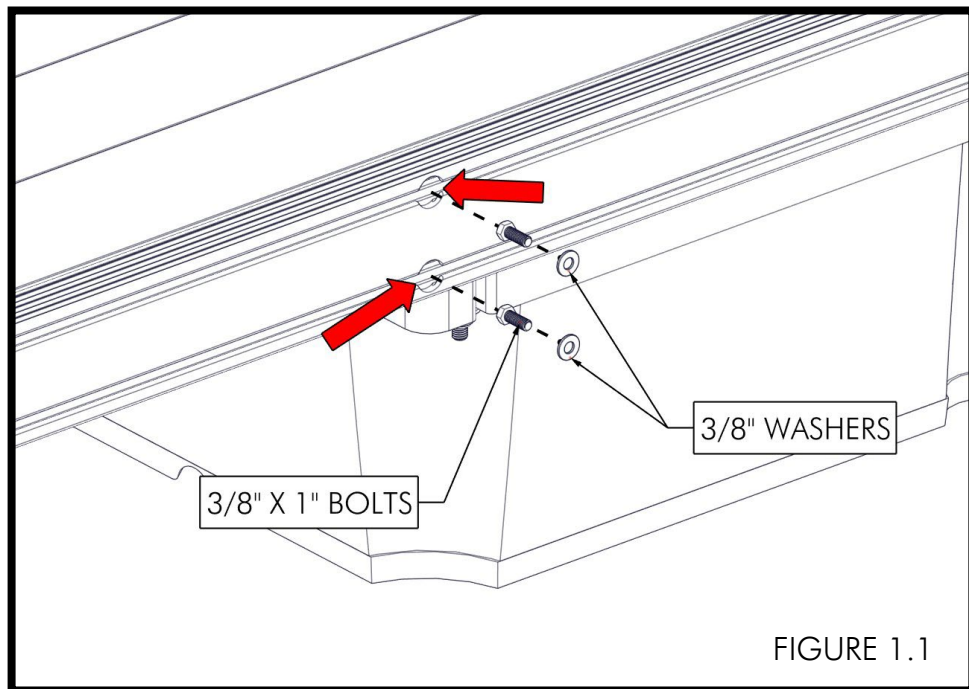



WHILE ALIGNING THE POCKETS WITH THE BOLTS, POSITION THE POCKETS ON THE DOCK SIDE (FIGURE 1.3) WITH EACH POCKET 31" FROM CENTER TO CENTER APART (FIGURE 1.3A). THIS IS TO PREVENT THE CHAIR'S ARM RESTS FROM HITTING THE TABLE AND POSSIBLY DAMAGING EITHER THE TABLE OR CHAIRS.

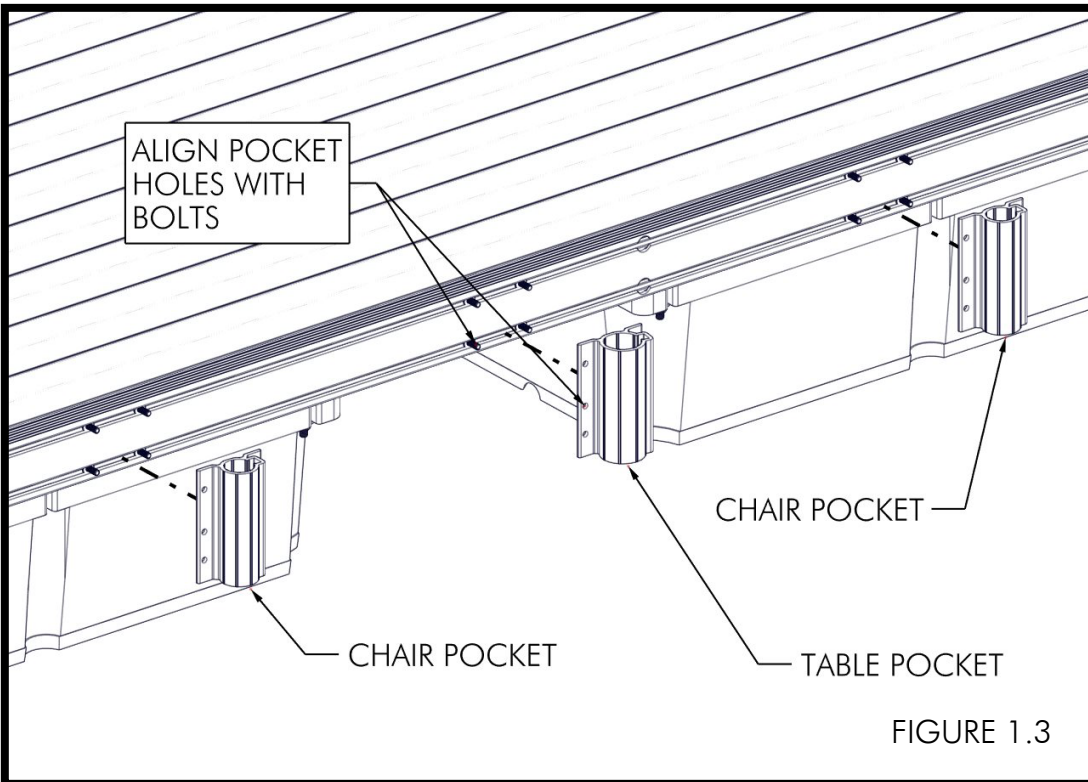

NOTE:  
IF THE TABLE WILL  
NOT BE  
INSTALLED, THE  
CHAIR POCKETS  
MUST BE  
INSTALLED A  
MINIMUM OF 30"  
APART

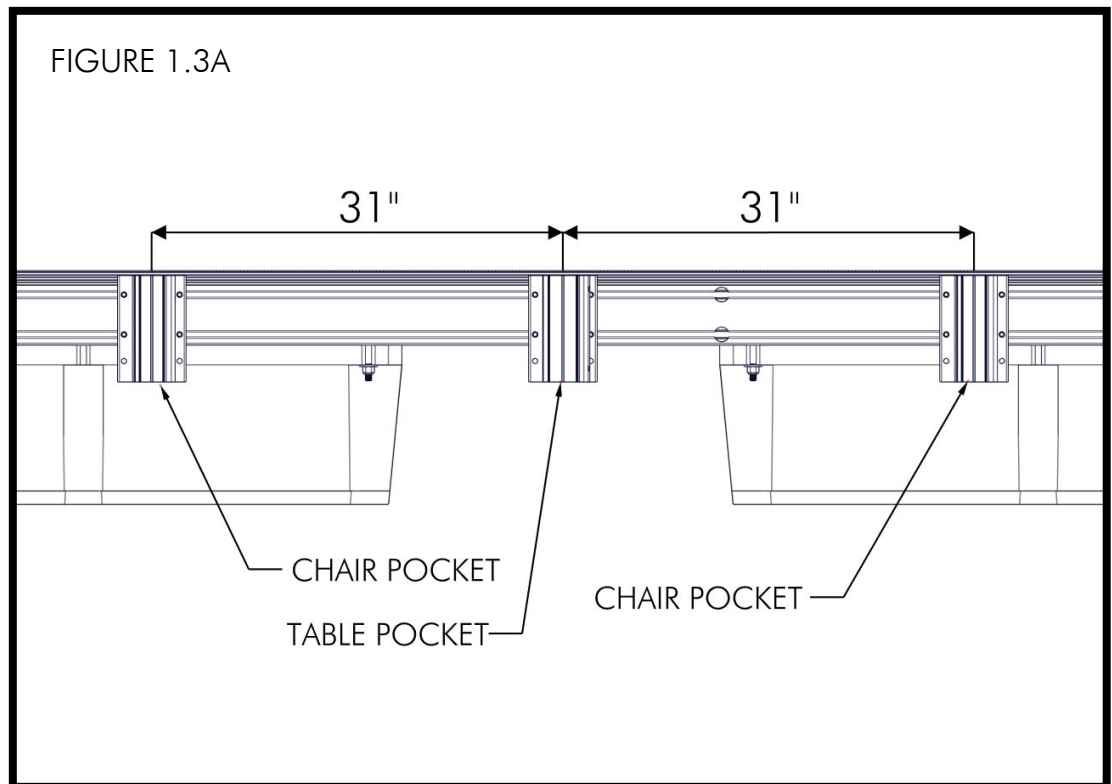

PLACE A 3/8" NYLOCK NUT ONTO EACH BOLT (FIGURE 1.4). WHILE ENSURING THAT THE POCKETS ARE PERPENDICULAR TO THE DOCK SURFACE, TORQUE THE NUTS TO 20 FT-LB (FIGURE 1.5). REFER TO THE FURNITURE INSTRUCTIONS ON INSTALLING THE CHAIRS AND TABLE.

