

# FLOE STANDARD ROLL-IN DOCK FURNITURE ATTACHMENT KIT



## ASSEMBLY INSTRUCTIONS

KIT P/N 510-00453-00 CHAIR MOUNTING

P/N 510-00454-00 TABLE MOUNTING

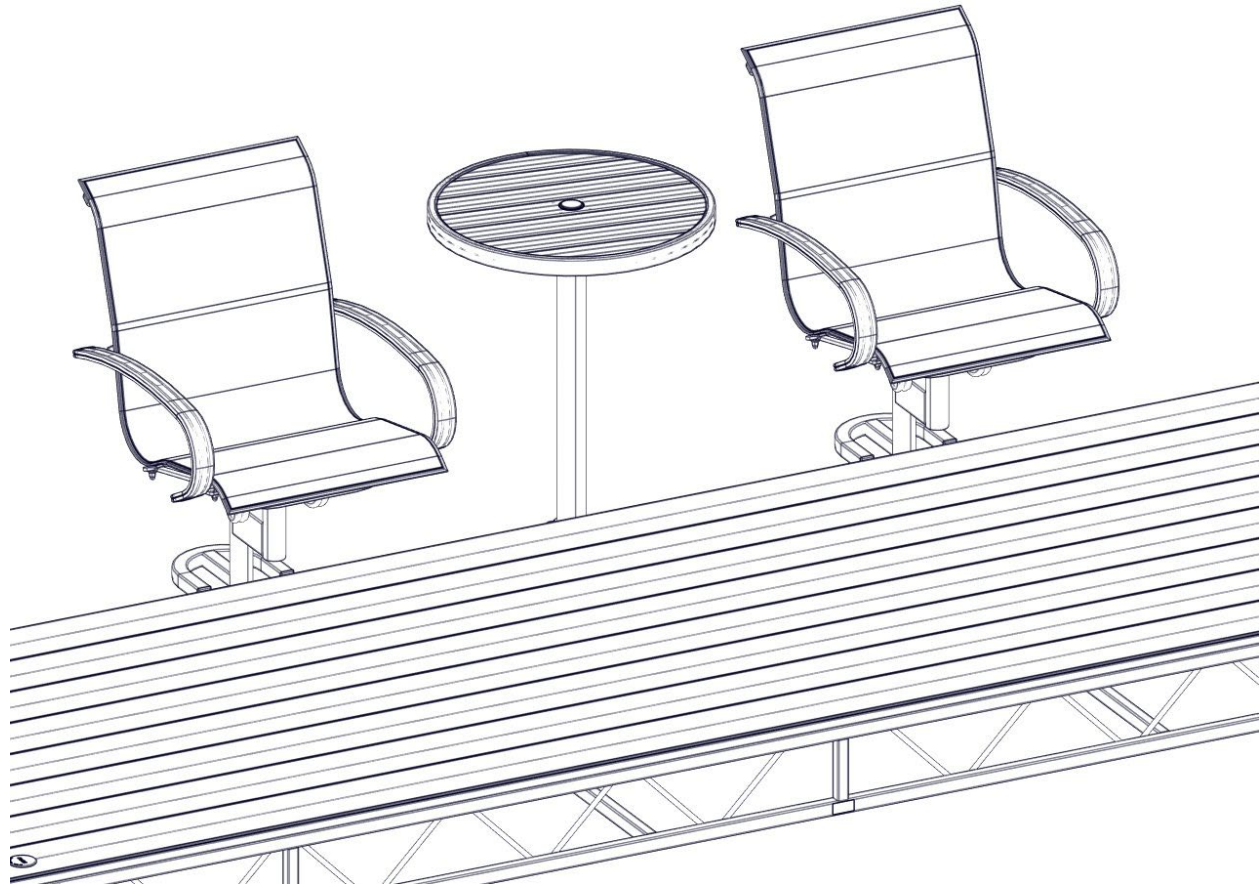

\*DOCK SECTION NOT INCLUDED

### **NOTE:**

REFER TO THE FURNITURE INSTRUCTIONS  
FOR INSTALLATION OF CHAIRS & TABLE.

### TOOLS REQUIRED

- (2) 9/16" SOCKETS/WRENCHES
- 3/4" SOCKET WRENCH
- TAPE MEASURE
- TORQUE WRENCH

## BILL OF MATERIALS/EXPLODED VIEW

P/N 510-00453-00	CHAIRS, STANDARD ROLL-IN DOCK (2 CHAIRS)		
NUMBER	PART NUMBER	DESCRIPTION	QTY
	210-07019-00	POCKETS, CHAIR (2) (INCLUDES ITEM #1)	1
1	002-07019-00	POCKET, CHAIR MOUNT	2
2	310-00425-00	KIT, DOCK CHAIRS (PAIR)	1
3	510-02366-00	HDWR, STD. ROLL-IN CHAIR MTG.	1
2A	001-70114-00	HHCS, 3/8-16 X 2-3/4" 18-8 SS	8
2B	001-70205-00	HHCS, 1/2-13 X 1" SS 18-8	2
2C	001-71067-00	LOCK WASHER, 3/8" S/W SS 18-8	8
2D	001-76349-00	NUT, 3/8-16 ALUM.	8
2E	001-76350-00	NUT, 1/2-13 ALUM.	2
2F	002-02203-00	PLATE, DOCK ACCESSORY	4
2G	002-02204-00	SPACER, DOCK ACCESSORY	8

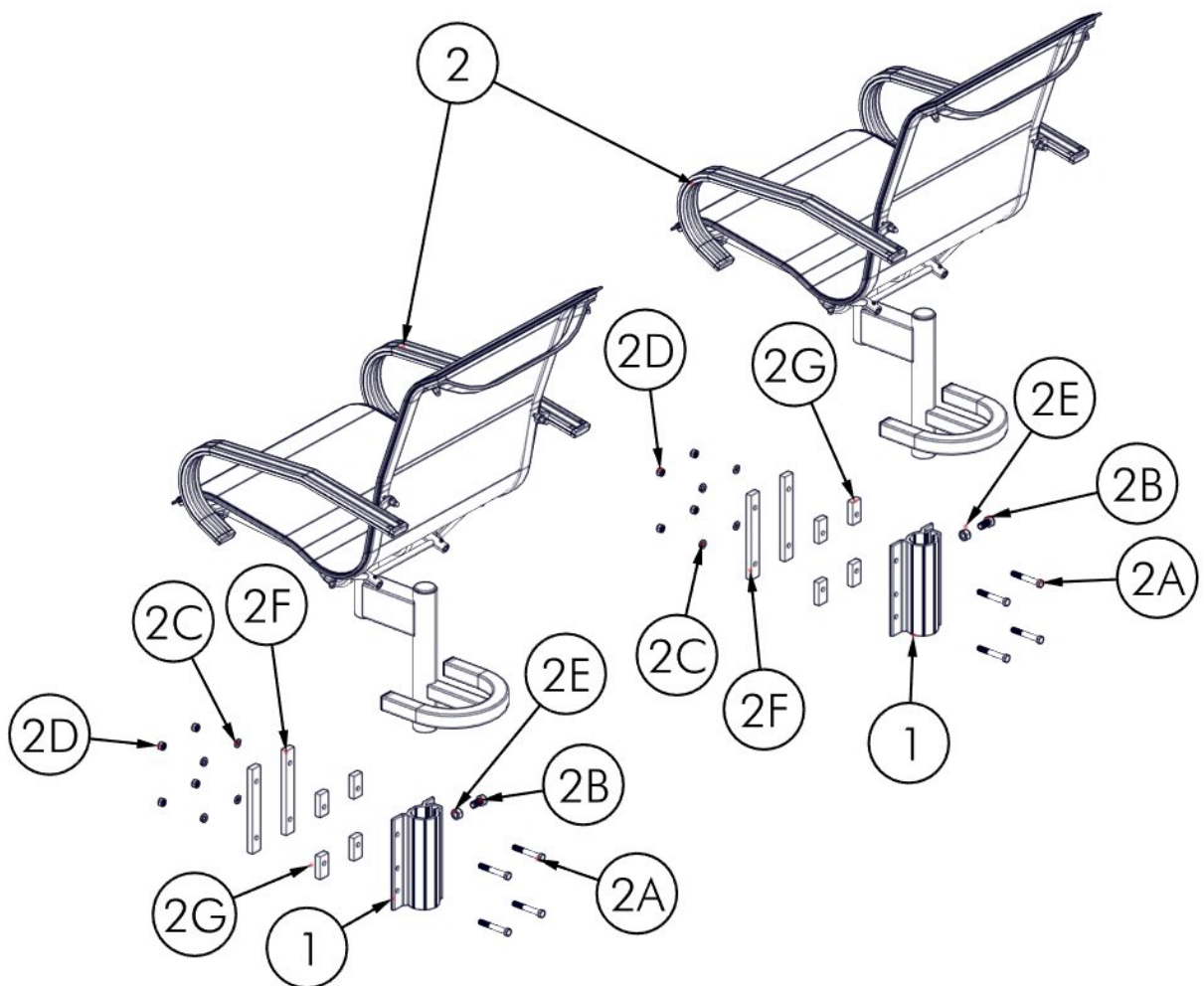

## BILL OF MATERIALS/EXPLODED VIEW

P/N 510-00454-00	TABLE, STANDARD ROLL-IN DOCK (2 CHAIRS)		
NUMBER	PART NUMBER	DESCRIPTION	QTY
	210-07020-00	POCKET, TABLE (1) (INCLUDES ITEM #1)	1
1	002-07020-00	POCKET, TABLE MOUNT	1
2	310-00430-00	KIT, DOCK TABLE	1
3	510-02367-00	HDWR, STD. ROLL-IN CHAIR MTG.	1
2A	001-70110-00	HHCS, 3/8-16 X 1-3/4" 18-8 SS	2
2B	001-70114-00	HHCS, 3/8-16 X 2-3/4" 18-8 SS	4
2C	001-71067-00	LOCK WASHER, 3/8" S/W SS 18-8	4
2D	001-76349-00	NUT, 3/8-16 ALUM.	4
2E	002-02203-00	PLATE, DOCK ACCESSORY	2
2F	002-02204-00	SPACER, DOCK ACCESSORY	4

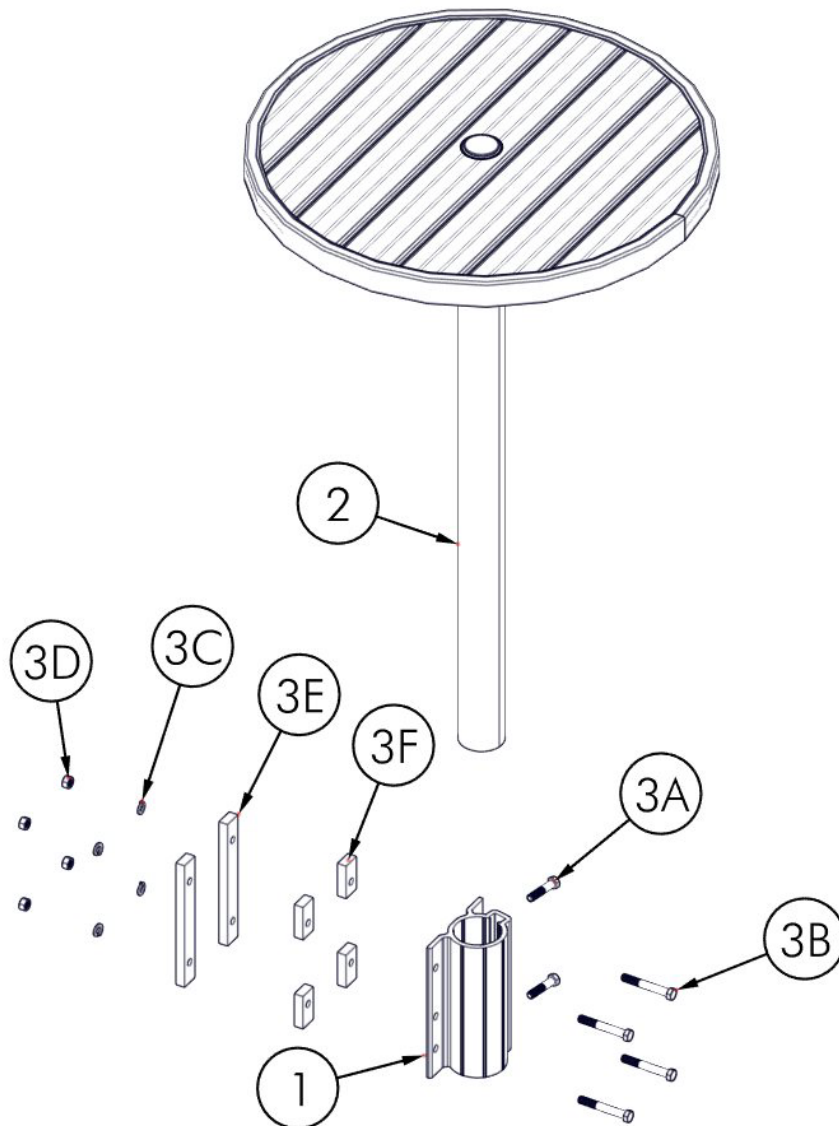

## RECOMMENDED INSTALLATION LAYOUTS

REFER TO THE IMAGES BELOW FOR THE TYPE OF DOCK YOU ARE INSTALLING THE FURNITURE ON TO DETERMINE WHICH LAYOUT IS BEST FOR YOUR CONFIGURATION. **NOTE: THERE ARE SEVERAL CONFIGURATIONS THAT ARE NOT RECOMMENDED.**

**WARNING: ENSURE THAT SAFETY QUICK CONNECTS ARE USED ON ROLL-IN AND SECTIONAL DOCKS SO THE DOCK SECTIONS DO NOT SEPARATE**

### RECOMMENDED SAMPLE FLOATING AND ROLL-IN LAYOUTS

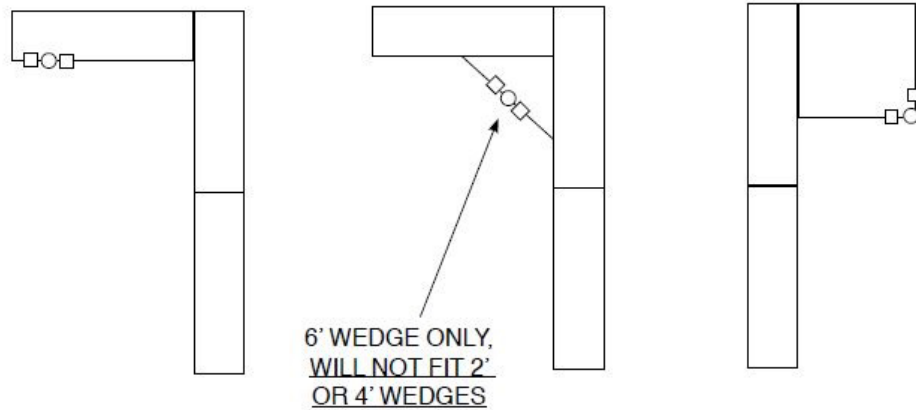

### NOT RECOMMENDED LAYOUT FOR FLOATING, ROLL-IN OR SECTIONALS

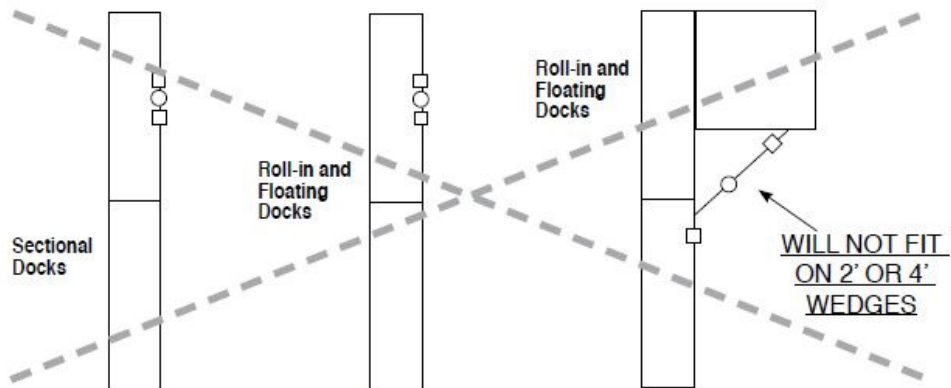

## ASSEMBLY

FIRST, DETERMINE WHERE THE FURNITURE WILL BE INSTALLED ON THE DOCK SYSTEM. INSTALL (4)  $\frac{3}{8}$ " X  $2\frac{3}{4}$ " BOLTS INTO EACH POCKET (FIGURE 1.1). POSITION THE POCKETS ON THE DOCK SIDE WITH EACH POCKET 31" FROM CENTER TO CENTER APART. THIS IS TO PREVENT THE CHAIR'S ARM RESTS FROM HITTING THE TABLE AND POSSIBLY DAMAGING EITHER THE TABLE OR CHAIRS (FIGURE 1.2).

FIGURE 1.1

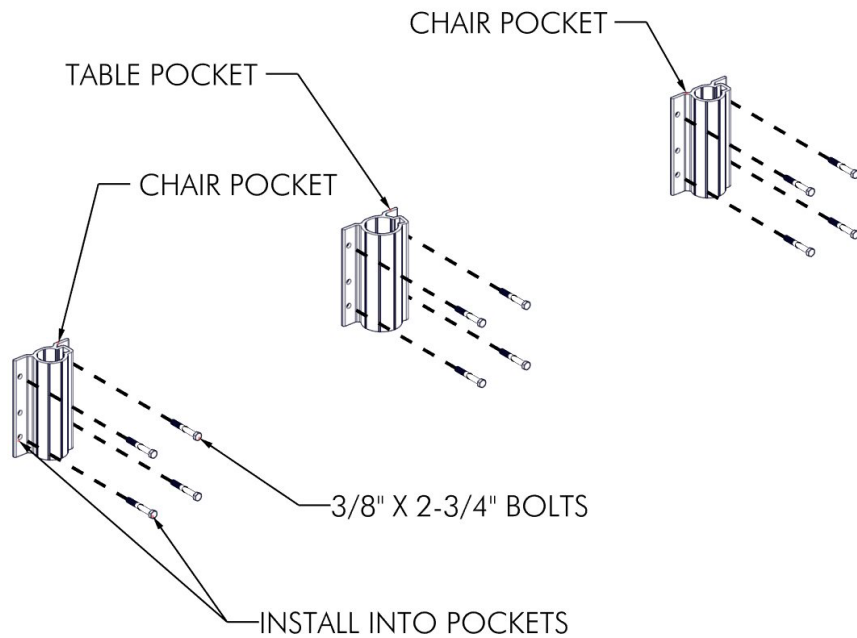

**NOTE:**  
IF THE TABLE WILL  
NOT BE INSTALLED,  
THE CHAIR POCKETS  
MUST BE INSTALLED A  
MINIMUM OF 30"  
APART

FIGURE 1.2

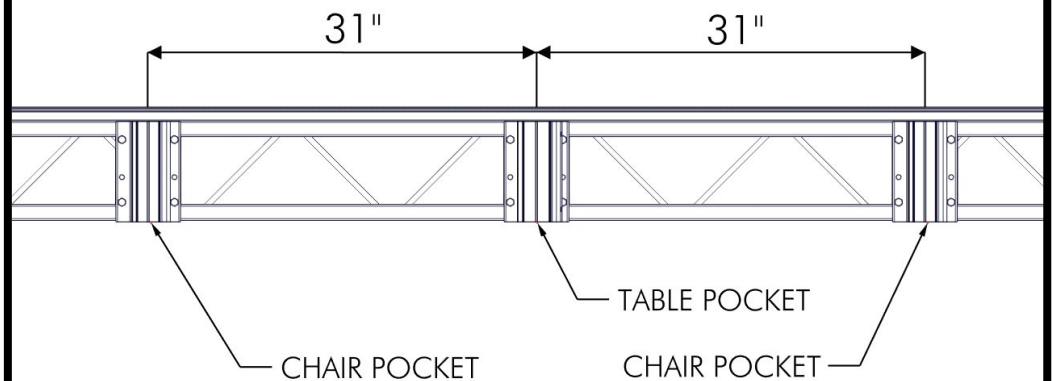



INSTALL THE SPACERS AND DOCK PLATES ON THE BOLTS ON THE INSIDE OF THE DOCK FRAME (IF NECESSARY, WEBBING MAY BE USED AS A SPACER) (FIGURE 1.3). INSTALL A 3/8" LOCK WASHER AND 3/8" NUT ONTO EACH BOLT (FIGURE 1.4).

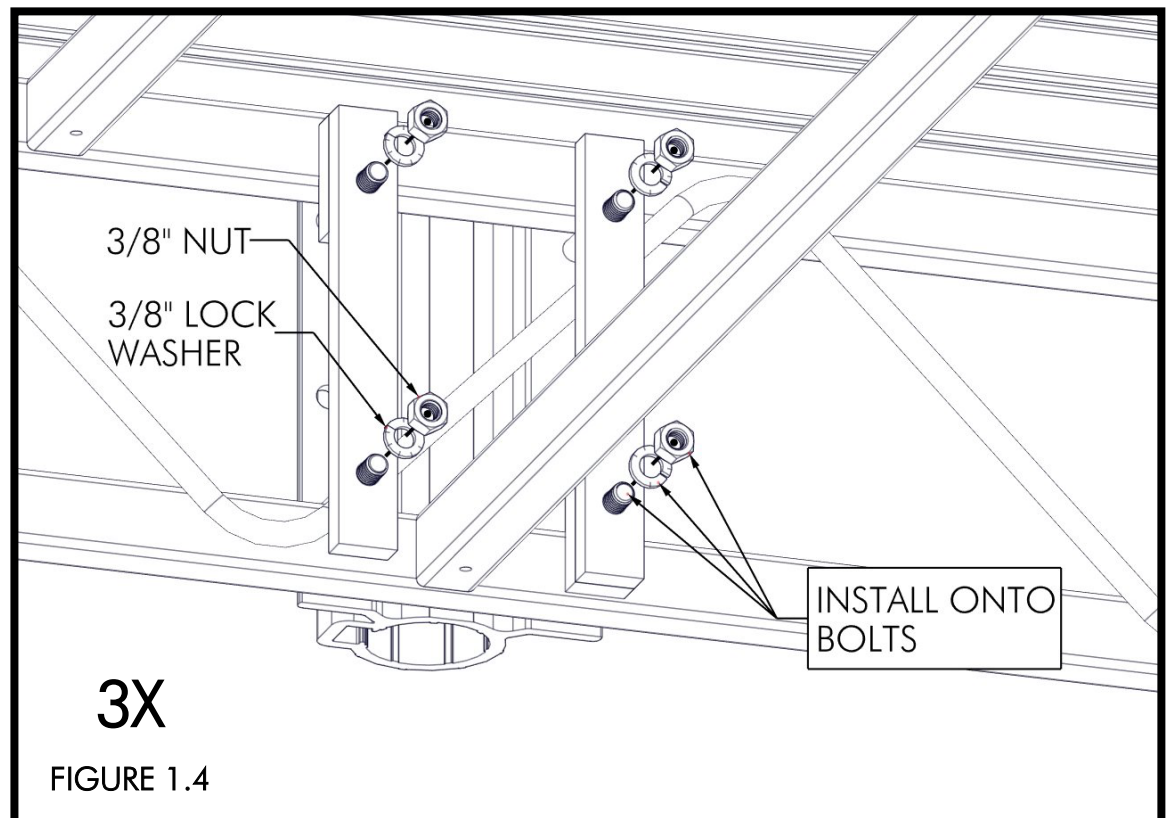
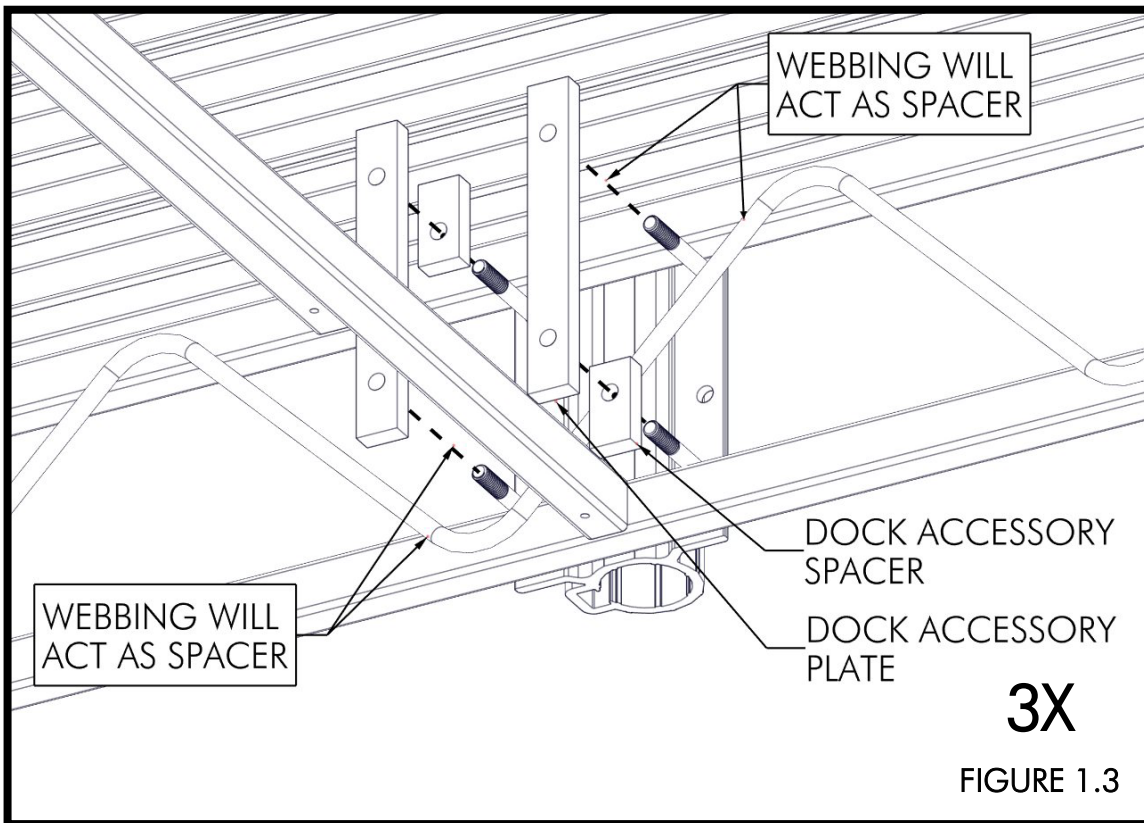

TORQUE ALL NUTS TO 20 FT-LB (FIGURE 1.5). REFER TO THE FURNITURE INSTRUCTIONS ON INSTALLING THE CHAIRS AND TABLE.

