

# FLOE STANDARD SECTIONAL SHORE END TRANSITION MOUNT ASSEMBLY INSTRUCTIONS

KIT P/N 510-02344-00

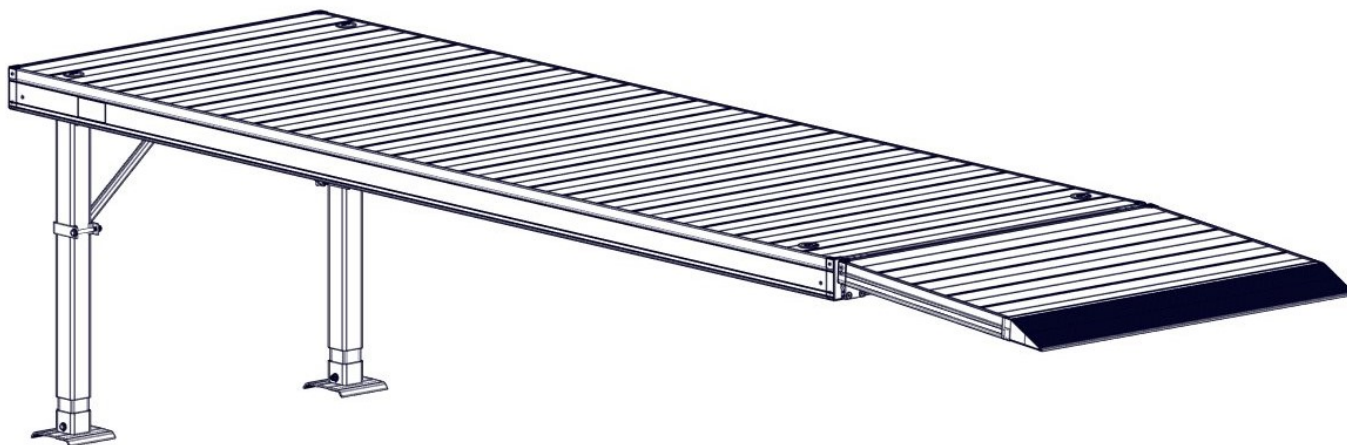

## TOOLS REQUIRED

- 7/32" HEX BIT
- (2) 9/16" SOCKETS/WRENCHES
- TORQUE WRENCH
- DEBURRING TOOL (FILE OR EQUIVALENT)
- 13/32" DRILL BIT
- CORDLESS DRILL

\*DOCK, LEGS, AND SHORE END TRANSITION NOT INCLUDED

INSTRUCTION P/N: 610-02344-00  
RELEASED 3/24/21

SHEET 1 OF 8

© Manufactured by:  
Floe International Inc.  
48473 State Hwy. 65  
McGregor, MN 55760  
[www.floeintl.com](http://www.floeintl.com)

**BILL OF MATERIALS/EXPLODED VIEW**

P/N 510-02344-00	KIT, SE TRANSITION STD SECTIONAL MNT		
NUMBER	PART NUMBER	QTY.	DESCRIPTION
1	001-70111-00	2	HHCS, 3/8-16 X 2" 18-8 SS
2	001-71017-00	2	FLAT WASHER, 3/8" SAE SS 18-8
3	001-71067-00	6	LOCK WASHER, 3/8" S/W SS 18-8
4	001-73935-00	4	FHCS, 3/8-16 X 2" 18-8 SS
5	001-76349-00	6	NUT, 3/8-16 ALUM.
6	110-00316-00	2	WELD'T, STD SECT'L SE TRANSITION PIVOT BRACKET

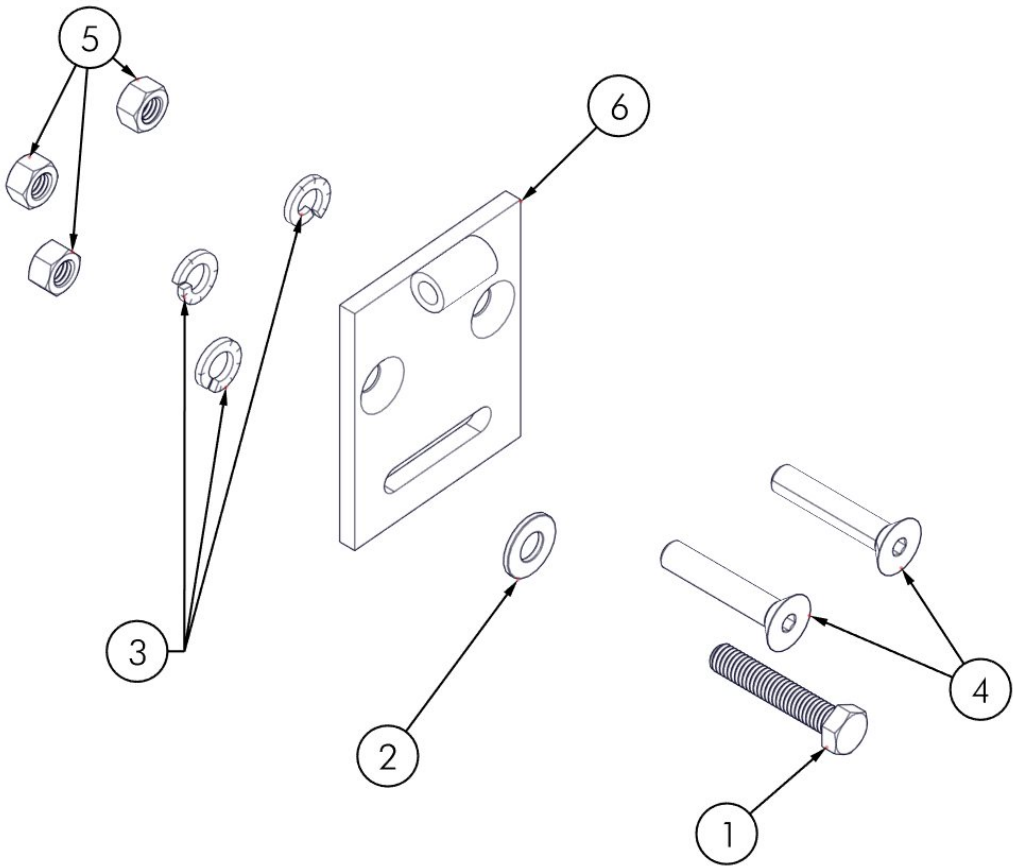

## ASSEMBLY

REMOVE THE PINS OUT OF THE HINGES ON THE TRANSITION (FIGURE 1.1). ALIGN THE HINGES ON THE TRANSITION WITH HINGE ON THE TRANSITION MOUNT (FIGURE 1.2).

FIGURE 1.1

2X

PULL PIN  
OUT OF  
TRANSITION  
PLATE HINGE

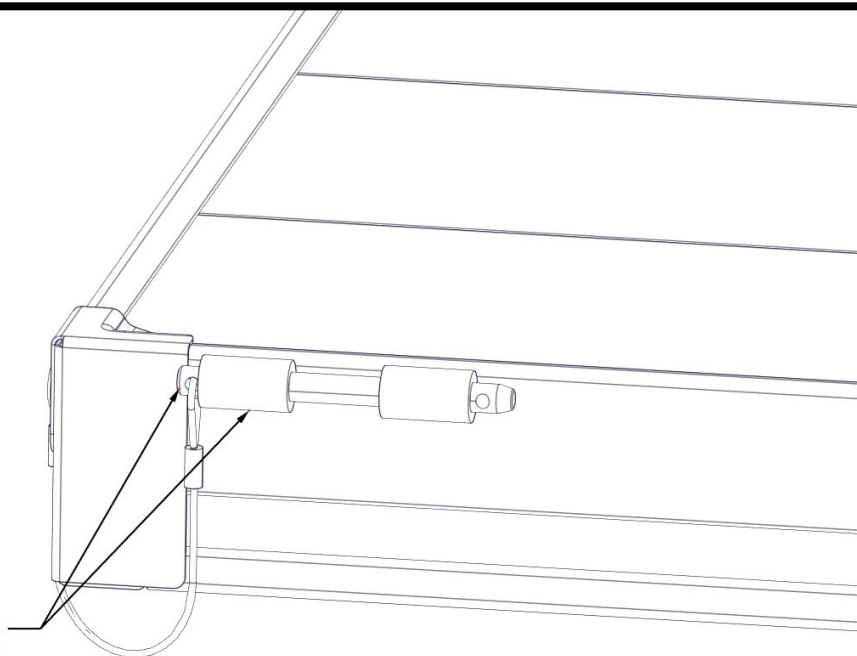

ALIGN HINGES  
ON TRANSITION  
WITH HINGE  
ON TRANSITION MOUNT

2X

FIGURE 1.2

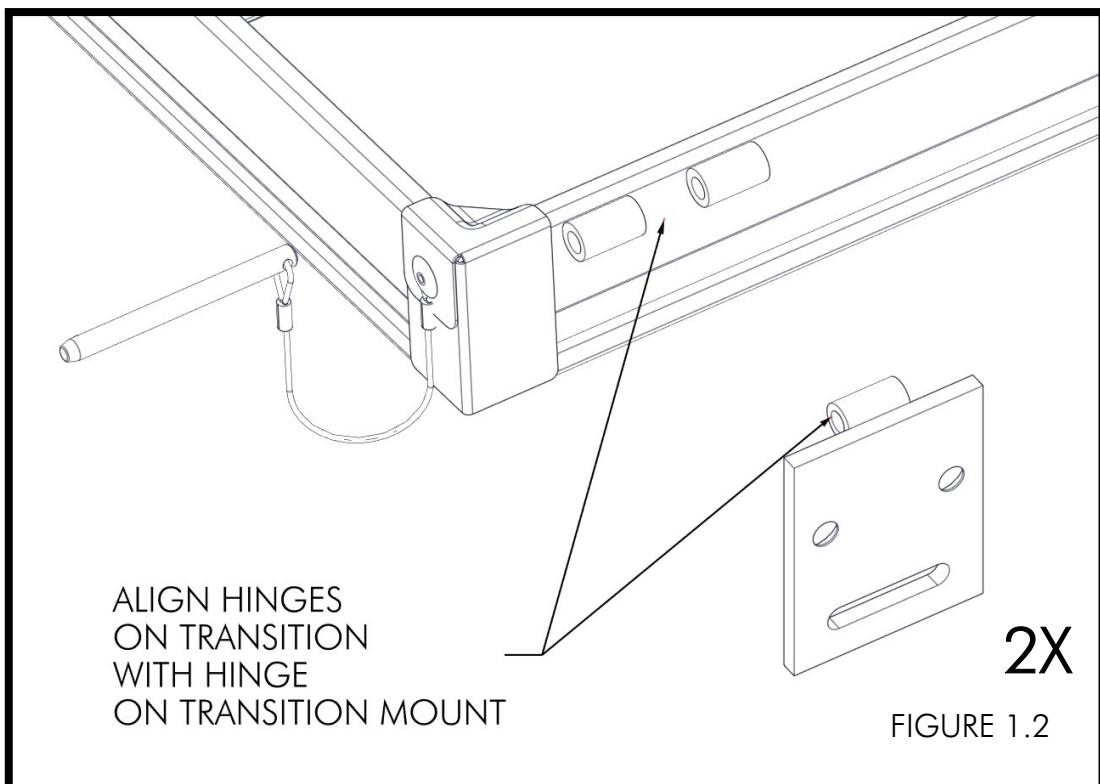

RE-INSERT THE PINS ON THE TRANSITION INTO THE HINGES ON THE TRANSITION AND HINGES ON THE MOUNT (FIGURE 1.3). POSITION THE TRANSITION WITH MOUNTS ONTO THE END OF THE DOCK WHILE ENSURING THAT THE SIDE OF THE TRANSITION IS FLUSH WITH THE SIDE OF THE DOCK (FIGURE 1.4). FLIP TRANSITION UP AND SUPPORT IT (FIGURE 1.5).

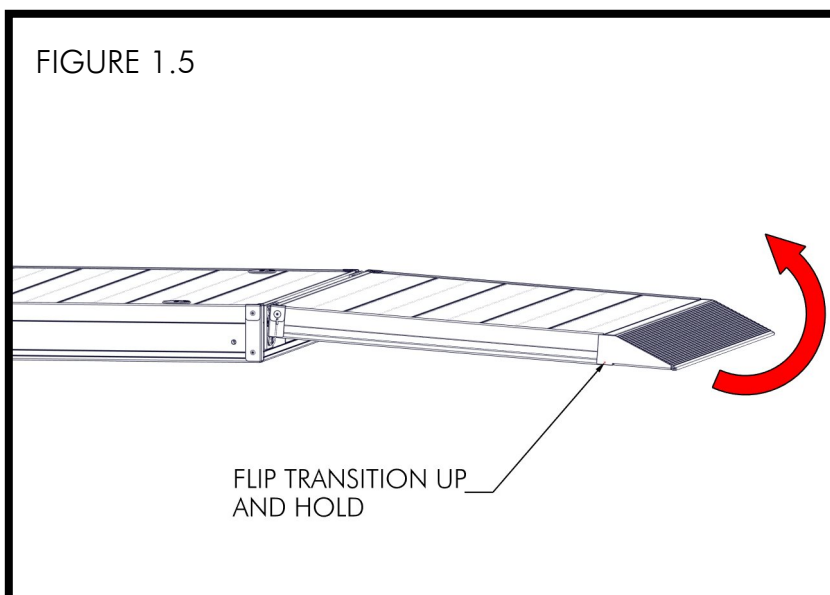
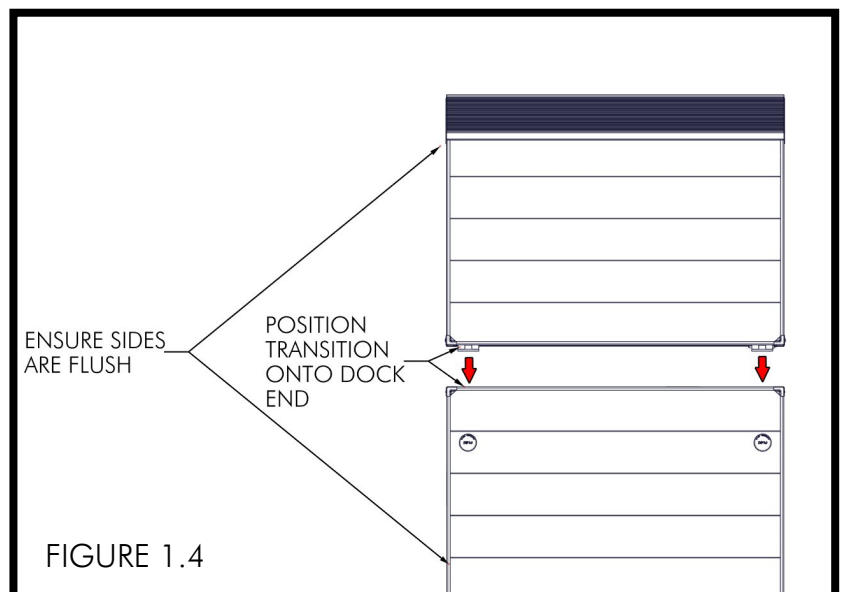
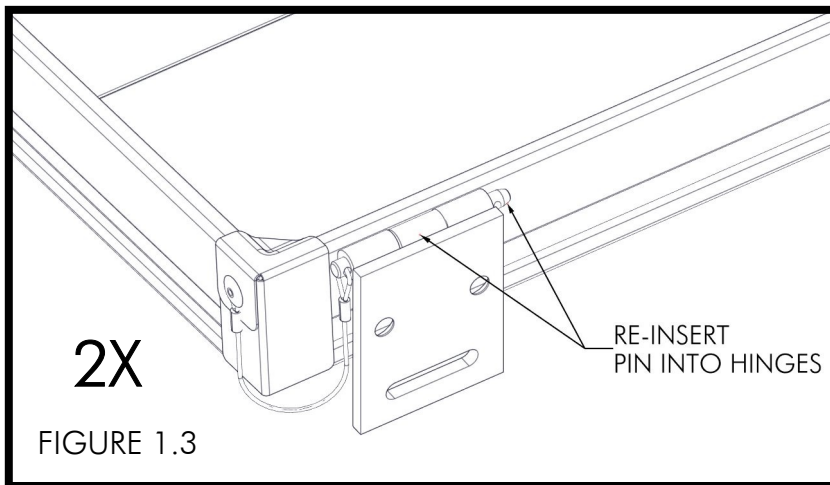

ATTACH THE TRANSITION WITH MOUNTS TO THE END OF THE DOCK WITH EXISTING HOLES USING (1) 3/8" X 2" BOLT, (1) 3/8" WASHER (FIGURE 1.6), (1) 3/8" LOCK WASHER, AND (1) 3/8" NUT PER MOUNT (FIGURE 1.7).

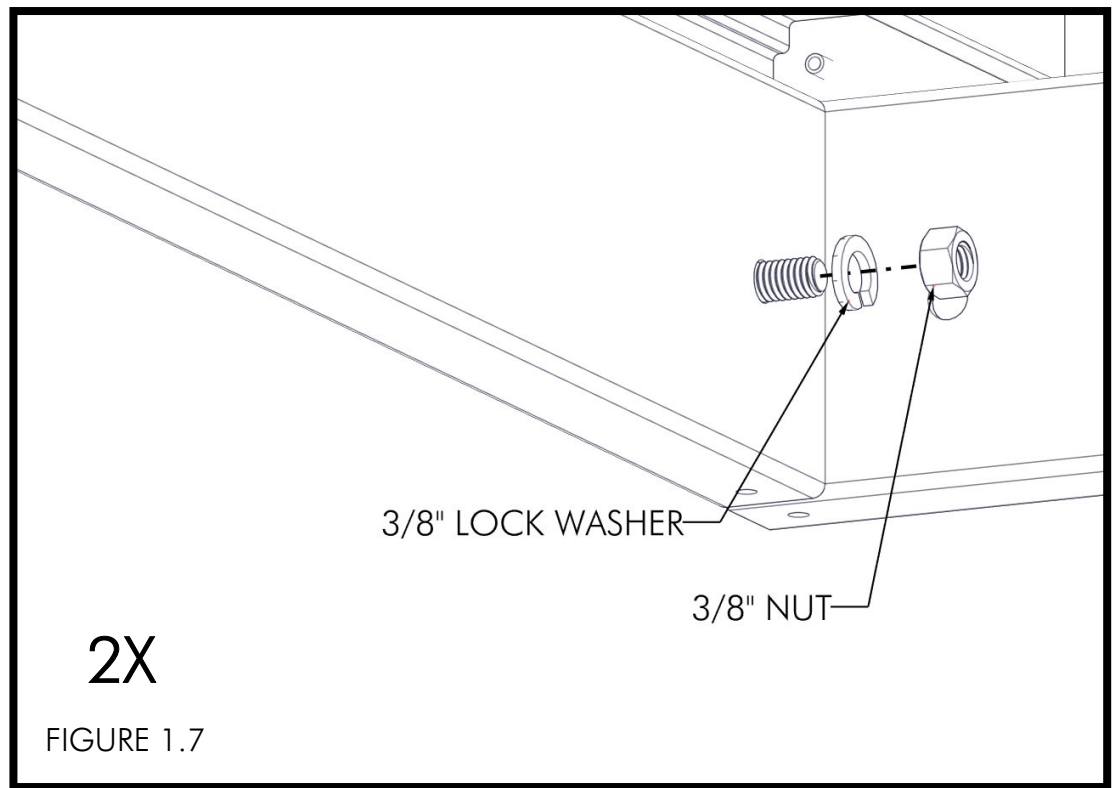
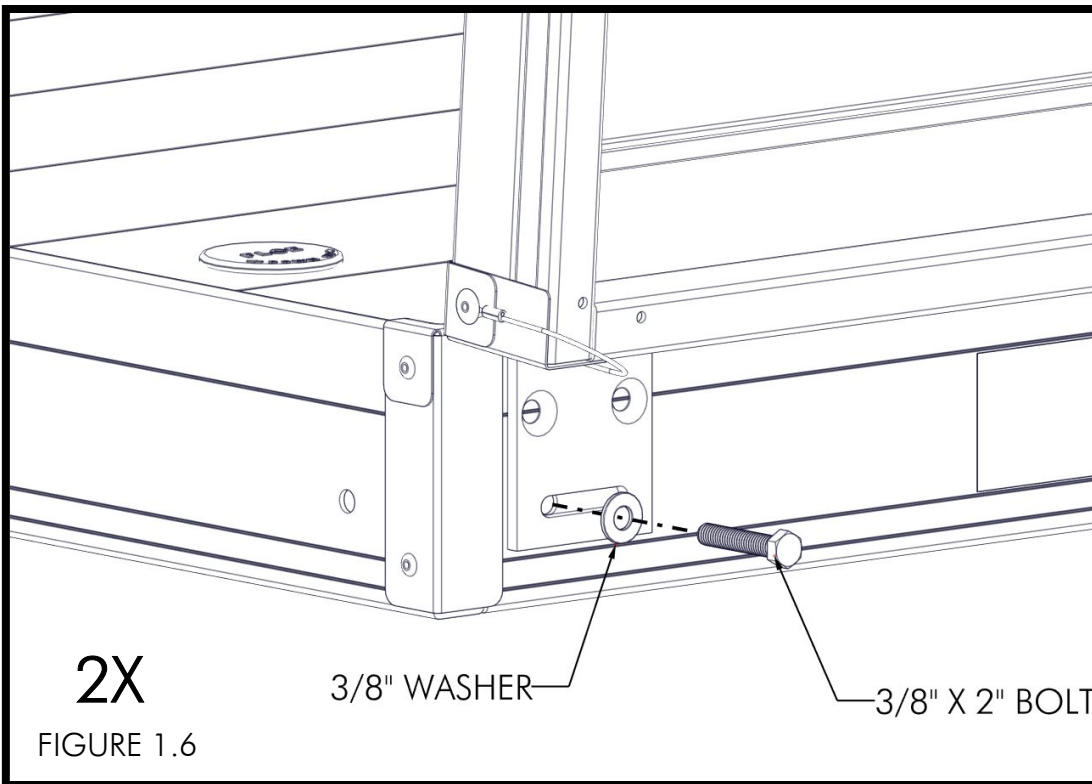

CENTER THE TRANSITION ON THE DOCK END BY MOVING IT LEFT OR RIGHT TO ENSURE THE SIDES OF THE TRANSITION AND DOCK ARE FLUSH (FIGURE 1.8). TORQUE NUT TO 25 FT-LB (FIGURE 1.9).

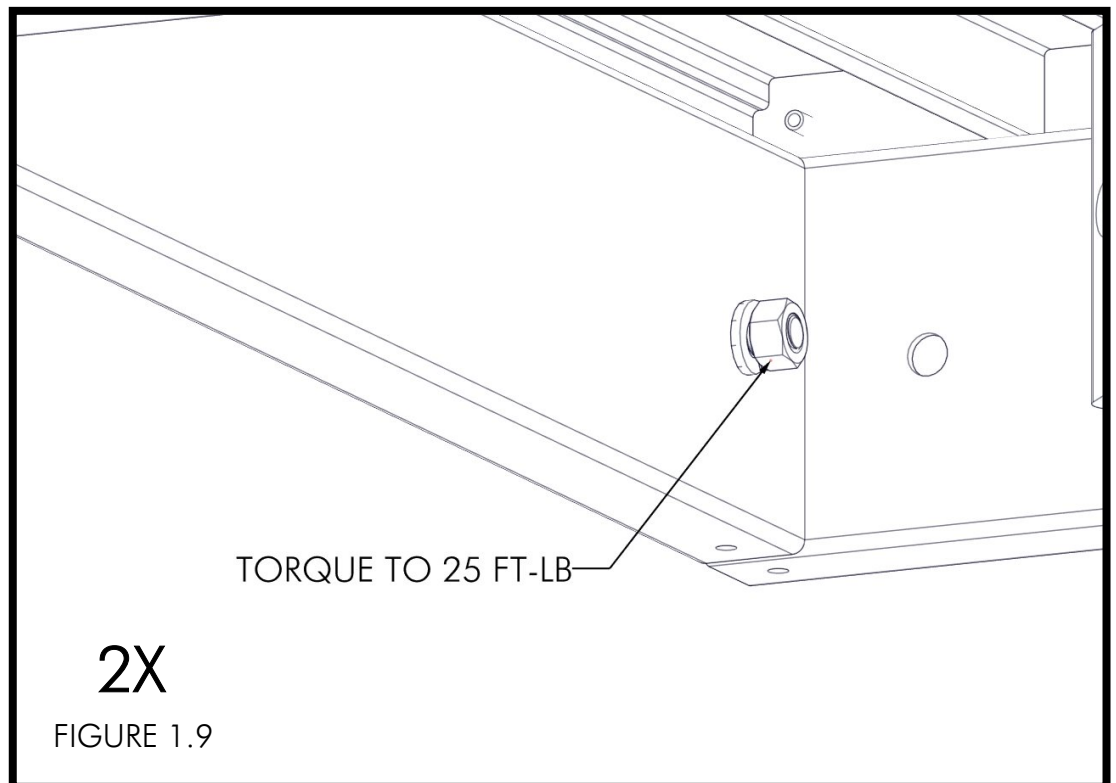
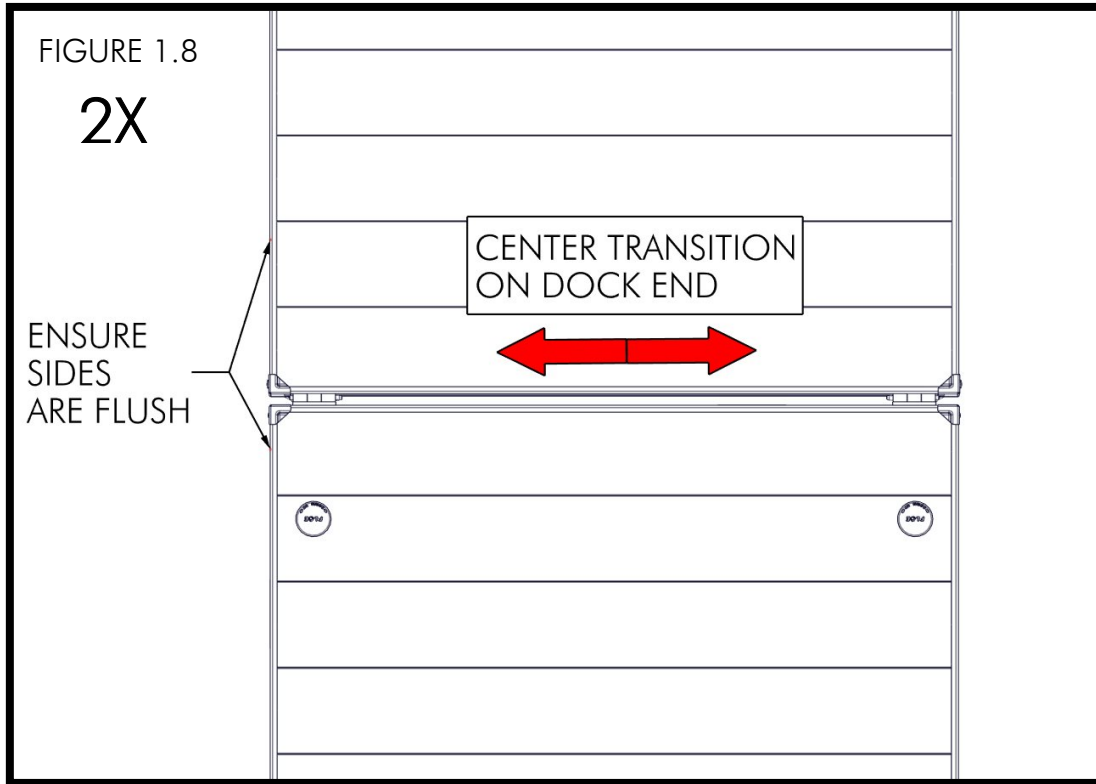

USING A 13/32" DRILL BIT, DRILL (2) HOLES PER TRANSITION MOUNT (FIGURE 1.10). INSERT (2) 3/8" X 2" FLAT HEAD BOLTS INTO EACH TRANSITION MOUNT (FIGURE 1.11).

FIGURE 1.10

2X

USING THE MOUNT  
AS A GUIDE, DRILL  
(2) HOLES WITH  
A 13/32" DRILL BIT

ENSURE MOUNT  
IS PARALLEL WITH  
BOTTOM OF DOCK

FIGURE 1.11

2X

3/8" X 2" FLAT HEAD  
BOLTS

PLACE (1) 3/8" LOCK WASHER AND (1) 3/8" NUT ONTO EACH BOLT (FIGURE 1.12) AND TORQUE TO 25 FT-LB (FIGURE 1.13).

