

# FLOE FLOATING DOCK FLAG POLE ATTACHMENT KIT ASSEMBLY INSTRUCTIONS

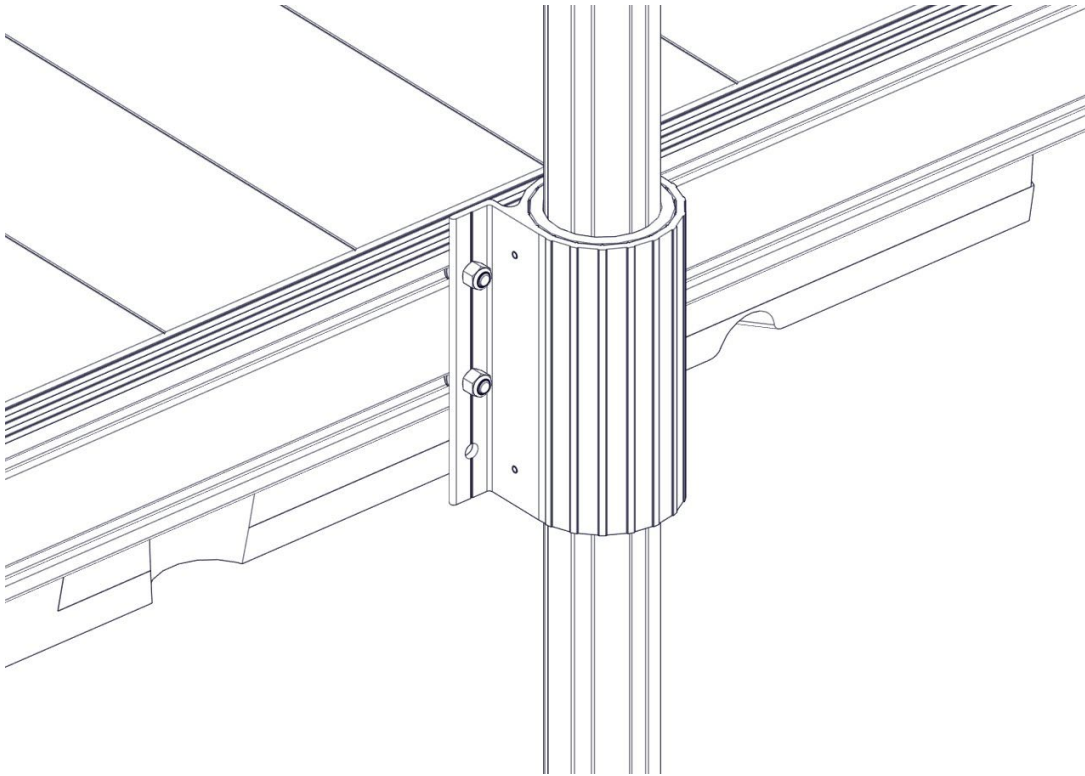

KIT P/N 510-02336-00



**\*DOCK SECTION NOT INCLUDED**

**NOTE:**

FLAG POLE IS SOLD SEPARATELY.  
REFER TO THE INSTRUCTIONS INCLUDED  
WITH THE KIT.

**TOOLS REQUIRED**

- 9/16" SOCKET/WRENCH
- TORQUE WRENCH

**BILL OF MATERIALS**

P/N 510-02336-00	KIT, FLAG POLE MTG. HRDW. FLOATING		
NUMBER	PART NUMBER	DESCRIPTION	QTY
1	001-70105-00	HHCS, 3/8-16 X 1" 18-8 SS	4
2	001-71017-00	FLAT WASHER, 3/8" SAE SS 18-8	4
3	001-76071-00	NUT, NYLOCK 3/8-16 ALUM.	4

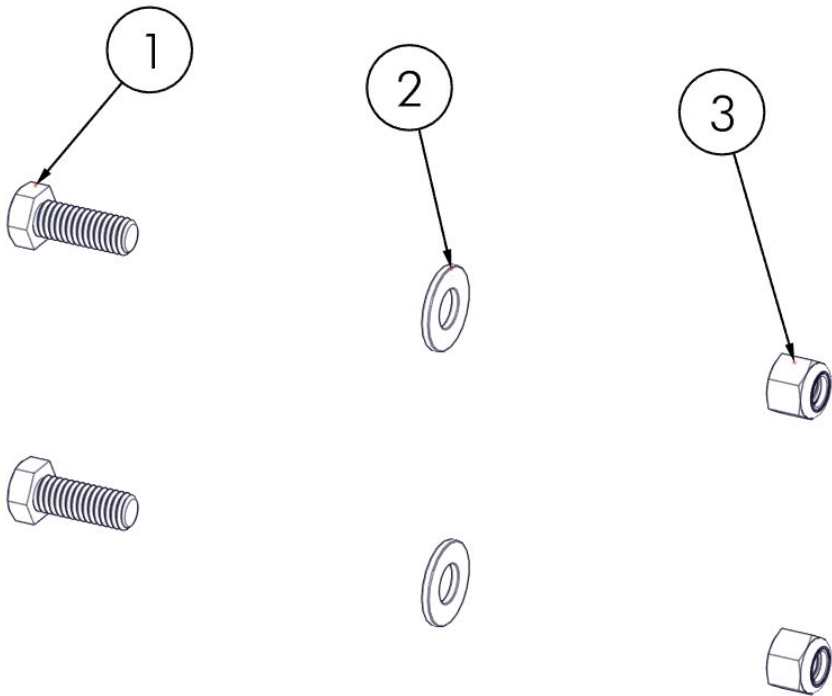

## ASSEMBLY

FIRST, DETERMINE WHERE THE FLAG POLE WILL BE INSTALLED ON THE DOCK SYSTEM. PLACE A 3/8" WASHER ONTO EACH OF THE (4) 3/8" X 1" BOLTS (FIGURE 1.1), THEN INSERT THE HEX HEAD AND WASHER INTO THE TRACK ON THE DOCK SIDE (FIGURE 1.2).

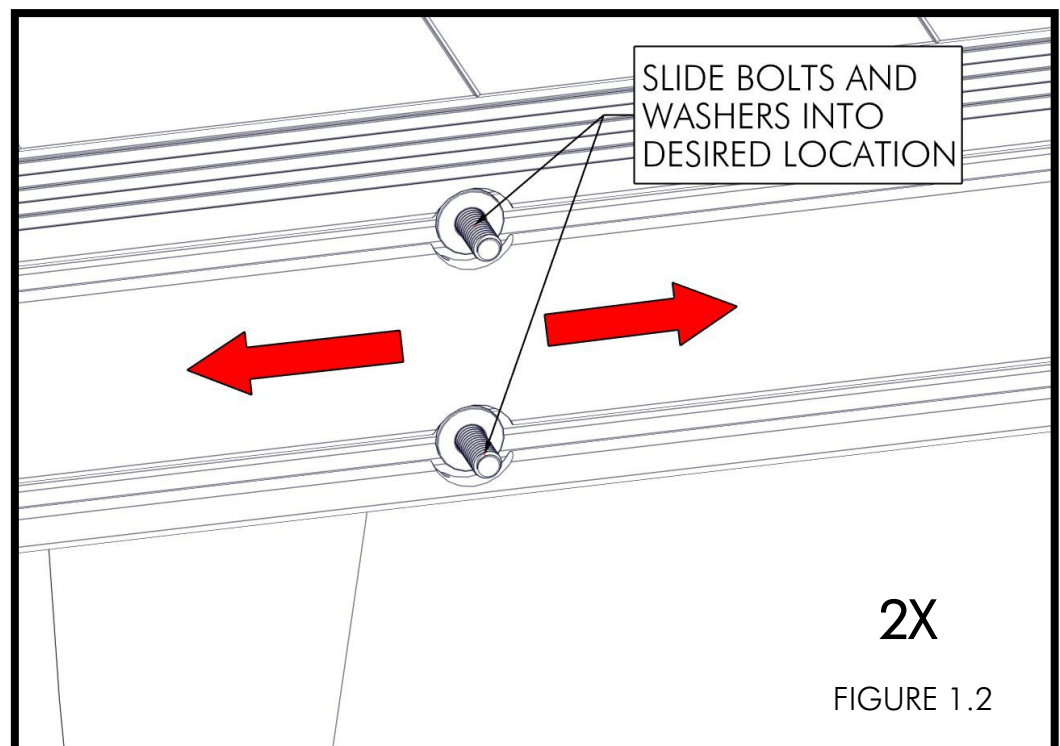
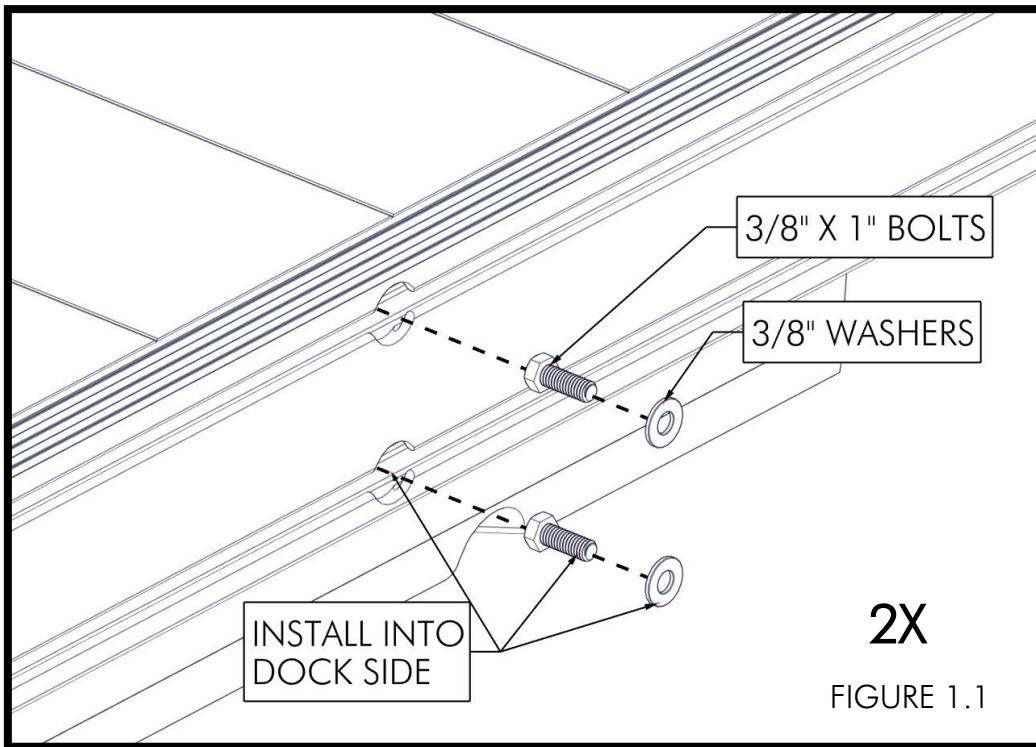

PLACE A 3/8" NYLOCK NUT ONTO EACH BOLT (FIGURE 1.4). WHILE ENSURING THAT THE POCKETS ARE PERPENDICULAR TO THE DOCK SURFACE, TORQUE THE NUTS TO 20 FT-LB (FIGURE 1.5). REFER TO THE FLAG POLE INSTRUCTIONS FOR FURTHER INFORMATION.

