

FLOE STANDARD SECTIONAL DOCK FLAG POLE ATTACHMENT KIT ASSEMBLY INSTRUCTIONS

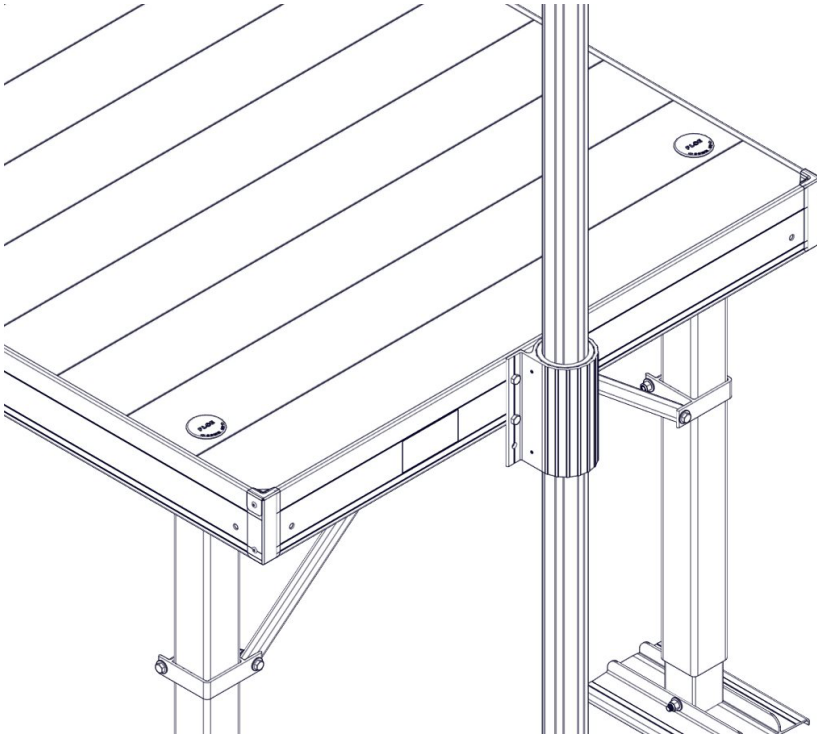

KIT P/N 510-02335-00



*FLAG POLE, POCKET, DOCK SECTION &
LEGS NOT INCLUDED

NOTE:

FLAG POLE KIT IS SOLD SEPARATELY.
REFER TO THE INSTRUCTIONS INCLUDED
WITH THE KIT.

TOOLS REQUIRED

- (2) 9/16" SOCKETS/WRENCHES
- TAPE MEASURE
- TORQUE WRENCH
- FRAMING SQUARE
- MARKER
- CORDLESS DRILL
- 13/32" DRILL BIT
- HAMMER
- CENTER PUNCH

BILL OF MATERIALS

P/N 510-02335-00	KIT, FLAG POLE MTG. HRDW. STD. SCTN'L		
NUMBER	PART NUMBER	DESCRIPTION	QTY
1A	001-70111-00	HHCS, 3/8-16 X 2" 18-8 SS	4
1B	001-71017-00	FLAT WASHER, 3/8" SAE SS 18-8	4
1C	001-76071-00	NUT, NYLOCK 3/8-16 ALUM.	4

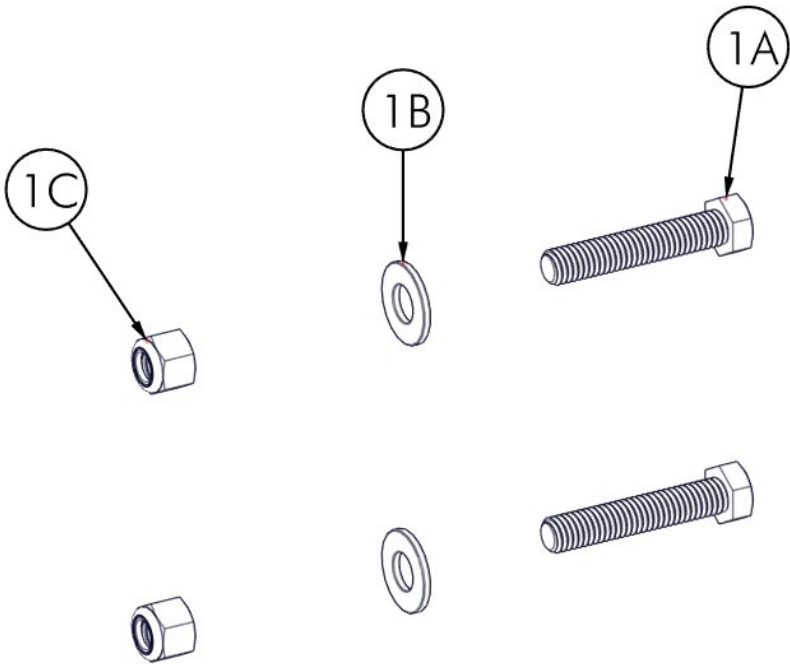

ASSEMBLY

FIRST, DETERMINE WHERE THE FLAG POLE WILL BE INSTALLED ON THE DOCK SYSTEM. USING A FRAMING SQUARE, MARK A VERTICAL LINE ACROSS THE TOP AND BOTTOM SERRATIONS (THESE SERRATIONS ARE 3" APART AND ARE INTENDED TO ACT AS A HOLE SPACING REFERENCE). MARK A SECOND LINE 5-1/8" FROM THE FIRST LINE. USE A HAMMER AND CENTER PUNCH TO MAKE A DIMPLE FOR THE DRILL BIT. THIS HELPS PREVENT THE DRILL FROM WANDERING. KEEP THE DRILL BIT PERPENDICULAR TO THE DOCK FRAME WHILE DRILLING (FIGURE 1.1). INSERT (4) 3/8" X 2" BOLTS INTO THE POCKET (INCLUDED WITH FLAG POLE KIT) AND INTO THE DOCK SIDE (FIGURE 1.2).

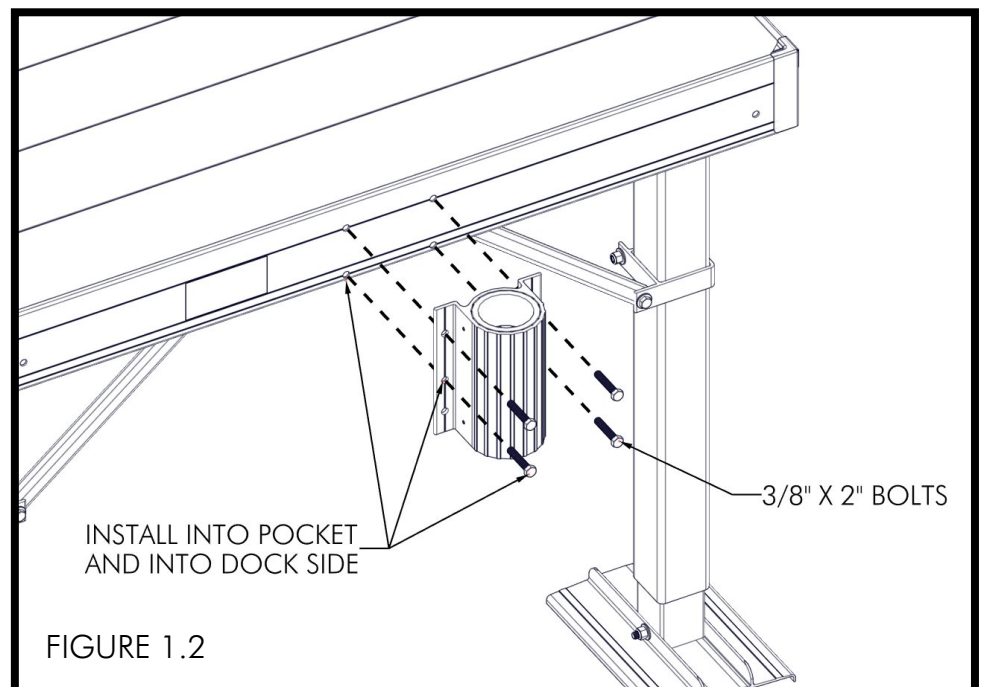
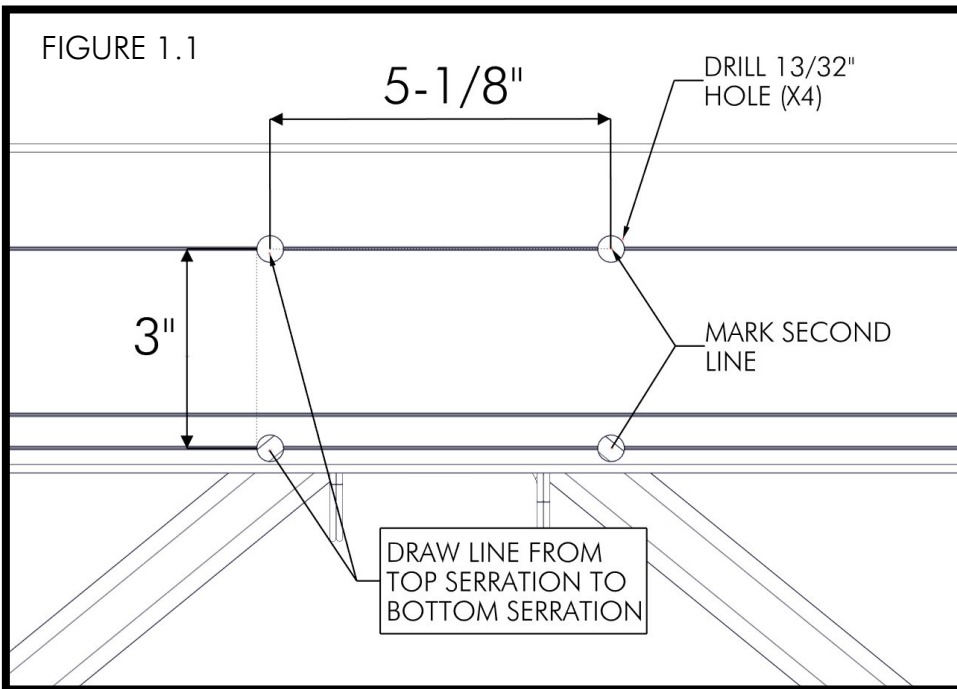

PLACE A 3/8" WASHER AND 3/8" NYLOCK NUT ONTO EACH BOLT (FIGURE 1.3). WHILE ENSURING THAT THE POCKET IS SQUARE TO THE TOP OF THE DOCK, TORQUE ALL NUTS TO 20 FT-LB (FIGURE 1.4). REFER TO THE FLAG POLE INSTRUCTIONS FOR FURTHER INFORMATION.

