

FLOE STANDARD ROLL-IN FLAG POLE ATTACHMENT KIT ASSEMBLY INSTRUCTIONS

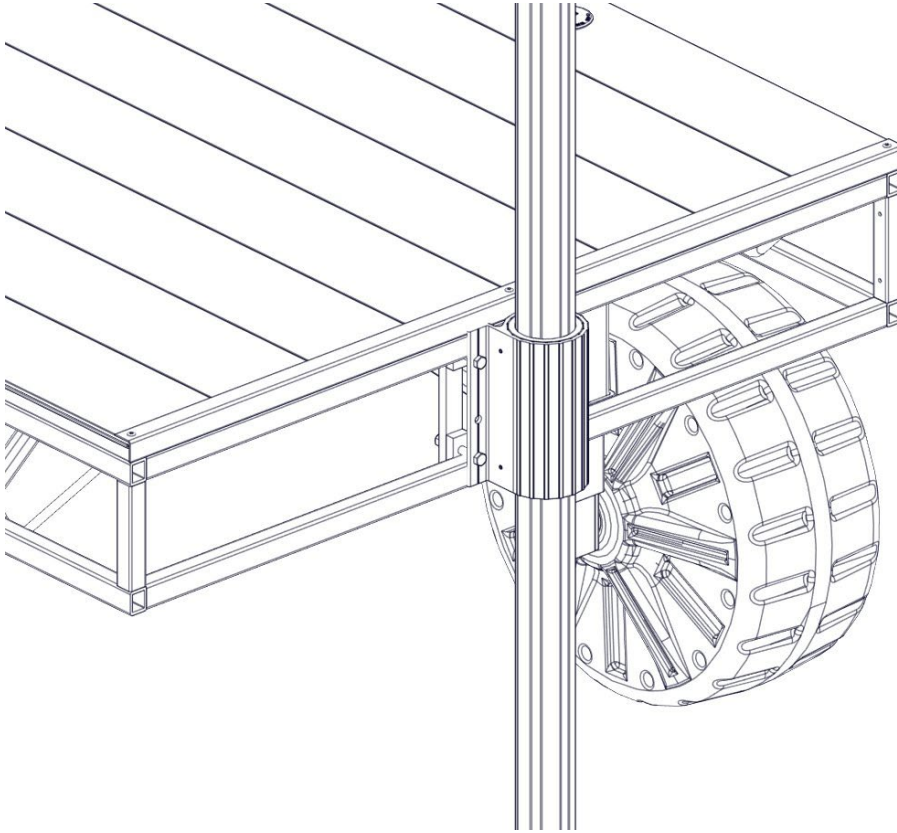

KIT P/N 510-02334-00



*FLAG POLE, POCKET, DOCK SECTION &
LEGS NOT INCLUDED

NOTE:

FLAG POLE KIT IS SOLD SEPARATELY.
REFER TO THE INSTRUCTIONS INCLUDED
WITH THE KIT.

TOOLS REQUIRED

- (2) 9/16" SOCKETS/WRENCHES
- TORQUE WRENCH

BILL OF MATERIALS

P/N 510-02334-00	KIT, FLAG POLE MTG. HRDW. STD. ROLL-IN		
NUMBER	PART NUMBER	DESCRIPTION	QTY
1A	001-70114-00	HHCS, 3/8-16 X 2-3/4" 18-8 SS	4
1B	001-71067-00	LOCK WASHER, 3/8" S/W SS 18-8	4
1C	001-76349-00	NUT, 3/8-16 ALUM.	4
1D	002-02203-00	PLATE, DOCK ACCESSORY	2
1E	002-02204-00	SPACER, DOCK ACCESSORY	4

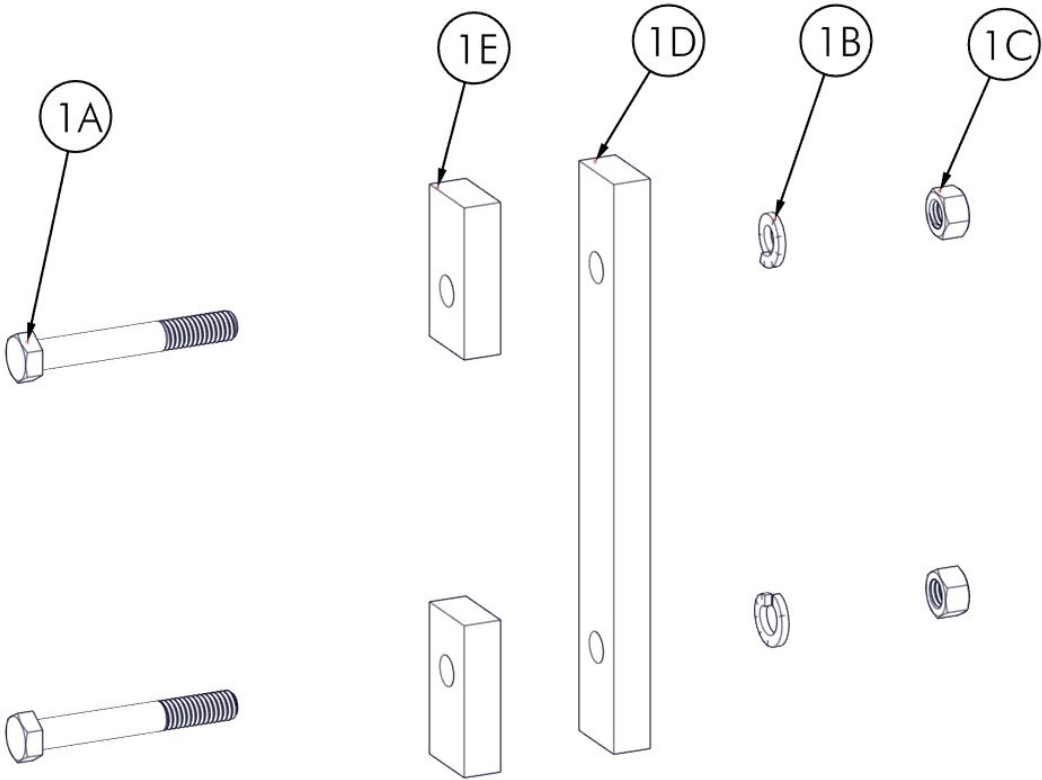

ASSEMBLY

FIRST, DETERMINE WHERE THE FLAG POLE WILL BE INSTALLED ON THE DOCK SYSTEM. INSERT (4) 3/8" X 2-3/4" BOLTS INTO THE POCKET (INCLUDED WITH FLAG POLE KIT) AND ONTO THE DOCK SIDE (FIGURE 1.1). INSTALL THE SPACERS AND DOCK PLATES ON THE BOLTS ON THE INSIDE OF THE DOCK FRAME (IF NECESSARY, WEBBING MAY BE USED AS A SPACER) (FIGURE 1.2).

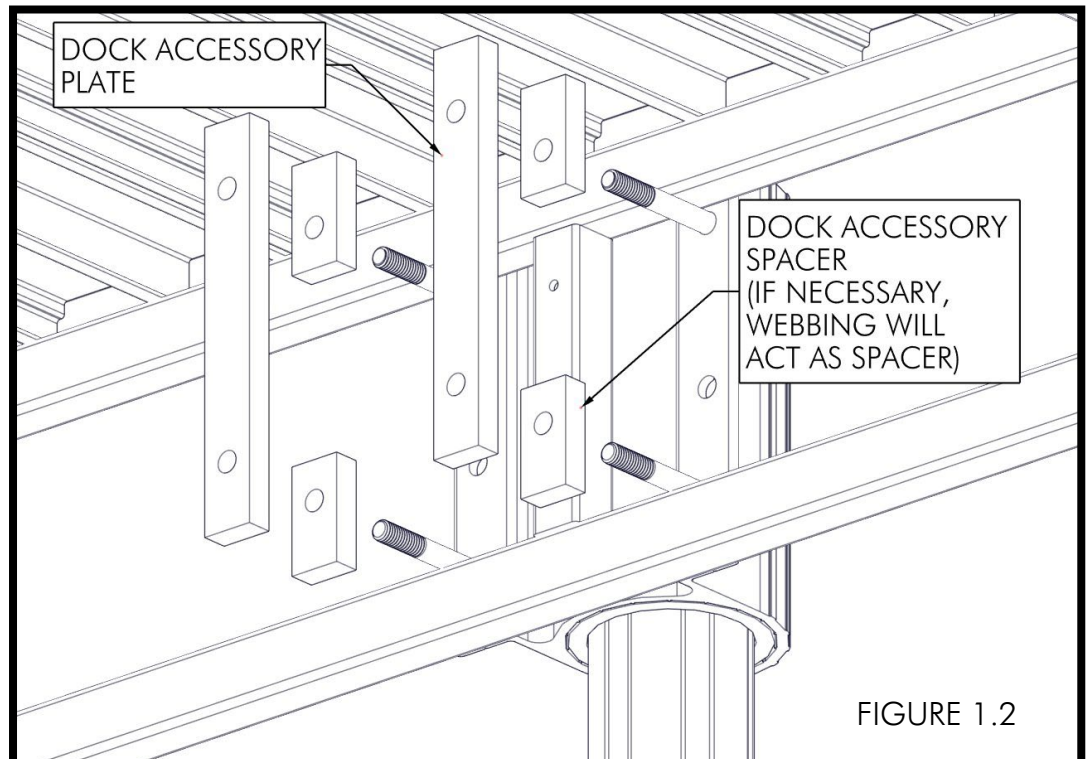
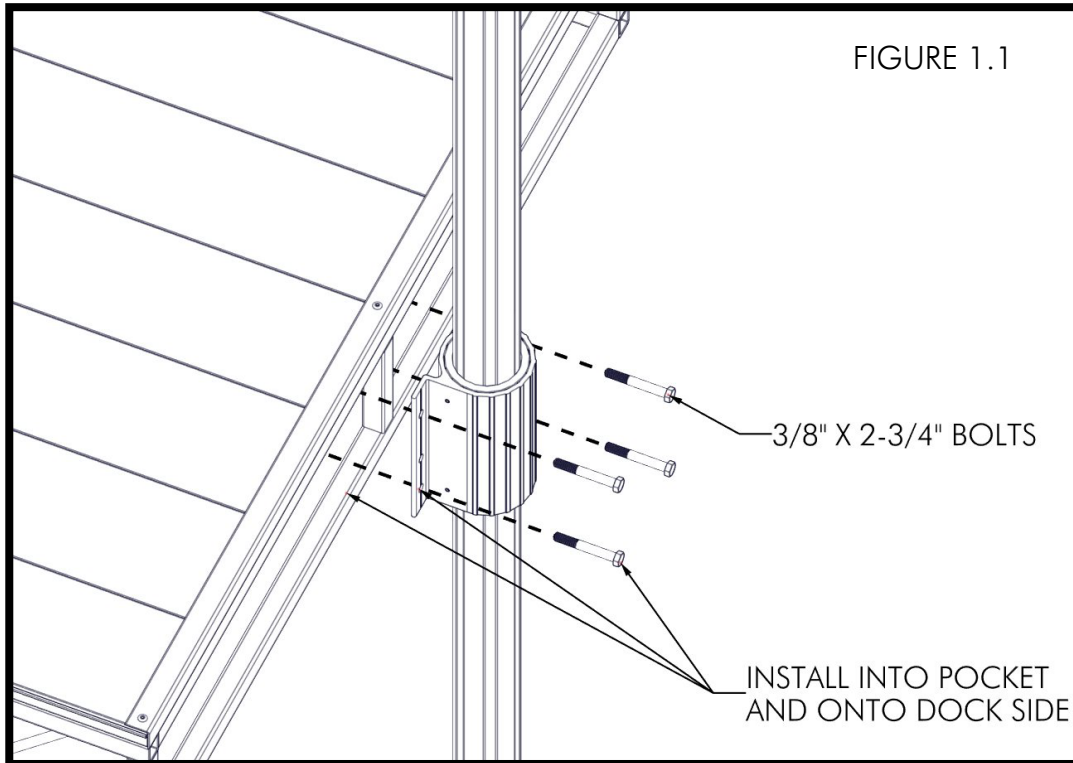

INSTALL A 3/8" LOCK WASHER AND 3/8" NUT ONTO EACH BOLT (FIGURE 1.3). WHILE ENSURING THAT THE POCKET IS SQUARE TO THE TOP OF THE DOCK, TORQUE ALL NUTS TO 20 FT-LB (FIGURE 1.4). REFER TO THE FLAG POLE INSTRUCTIONS FOR FURTHER INFORMATION.

