

FLOE STANDARD SECTIONAL WATER ACC. RACK ATTACHMENT KIT ASSEMBLY INSTRUCTIONS

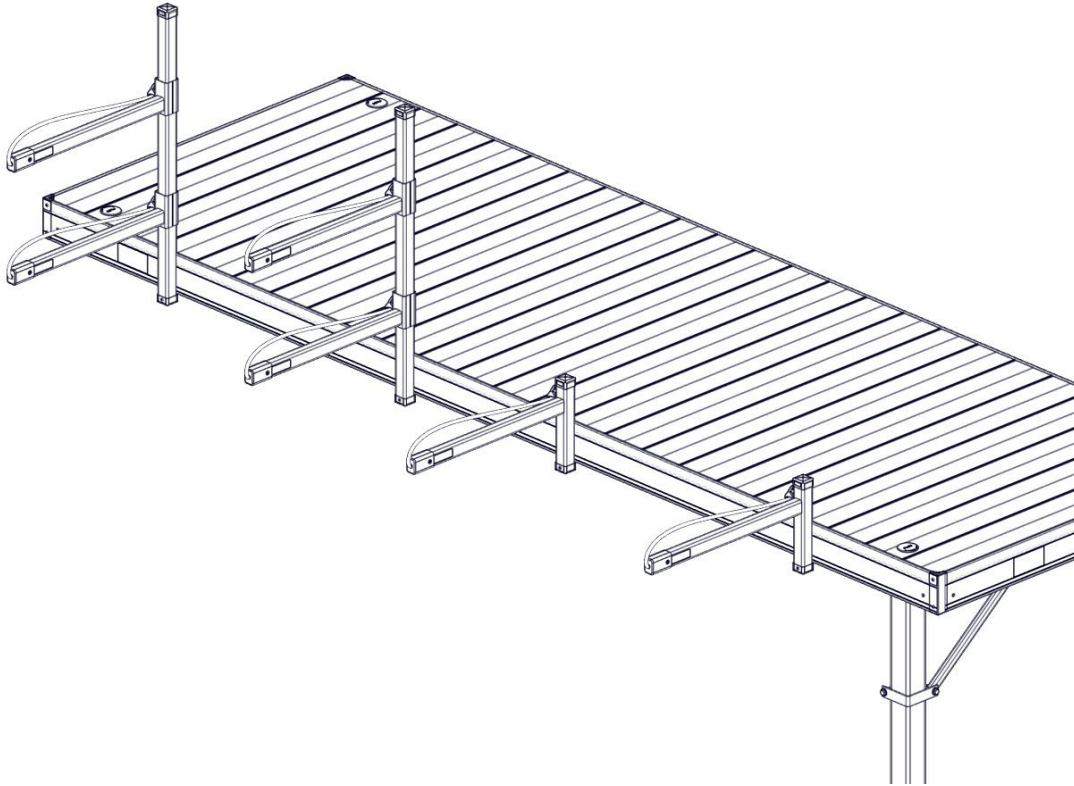

KIT P/N 510-02333-00



*DOCK SECTION & LEGS NOT INCLUDED

NOTE:

WATER ACCESSORY RACKS ARE SOLD SEPARATELY.
REFER TO THE INSTRUCTIONS INCLUDED WITH THE KIT.

TOOLS REQUIRED

- 9/16" SOCKET/WRENCH
- TAPE MEASURE
- TORQUE WRENCH
- FRAMING SQUARE
- MARKER
- CORDLESS DRILL
- 13/32" DRILL BIT
- HAMMER
- CENTER PUNCH

BILL OF MATERIALS

P/N 510-02333-00	KIT, WATER ACC. RACK MTG. HRDW. STD. SCTN'L		
NUMBER	PART NUMBER	DESCRIPTION	QTY
1A	001-70111-00	HHCS, 3/8-16 X 2" 18-8 SS	4
1B	001-71017-00	FLAT WASHER, 3/8" SAE SS 18-8	4
1C	001-71067-00	LOCK WASHER, 3/8" S/W SS 18-8	4
1D	001-76349-00	NUT, 3/8-16 ALUM.	4

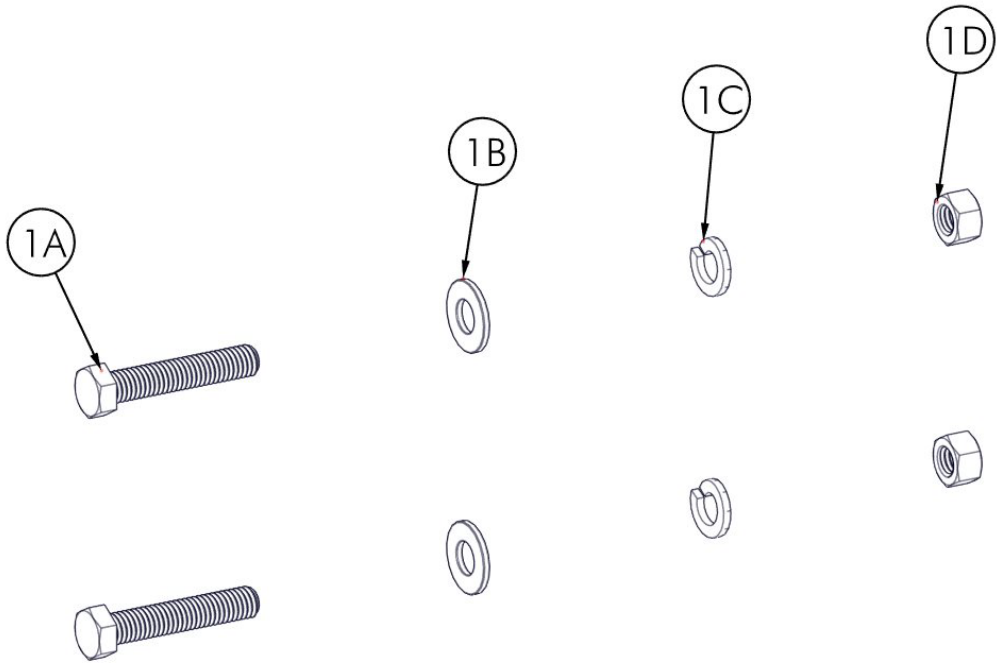

ASSEMBLY

FIRST, DETERMINE WHERE THE ACCESSORY RACK (SINGE OR DOUBLE TIER) WILL BE INSTALLED ON THE DOCK SYSTEM. USING A FRAMING SQUARE, MARK A VERTICAL LINE ACROSS THE TOP AND BOTTOM SERRATIONS (THESE SERRATIONS ARE 3" APART AND ARE INTENDED TO ACT AS A HOLE SPACING REFERENCE). THE LOCATION FOR THE SECOND SET OF HOLES IS DEPENDANT ON THE DESIRED SPACING OF THE ACCESSORY RACKS. ONCE THAT DISTANCE IS DETERMINED, MARK THE HOLE LOCATIONS. USE A HAMMER AND CENTER PUNCH TO MAKE A DIMPLE FOR THE DRILL BIT. THIS HELPS PREVENT THE DRILL FROM WANDERING. KEEP THE DRILL BIT PERPENDICULAR TO THE DOCK FRAME WHILE DRILLING (FIGURE 1.1).

FIGURE 1.1

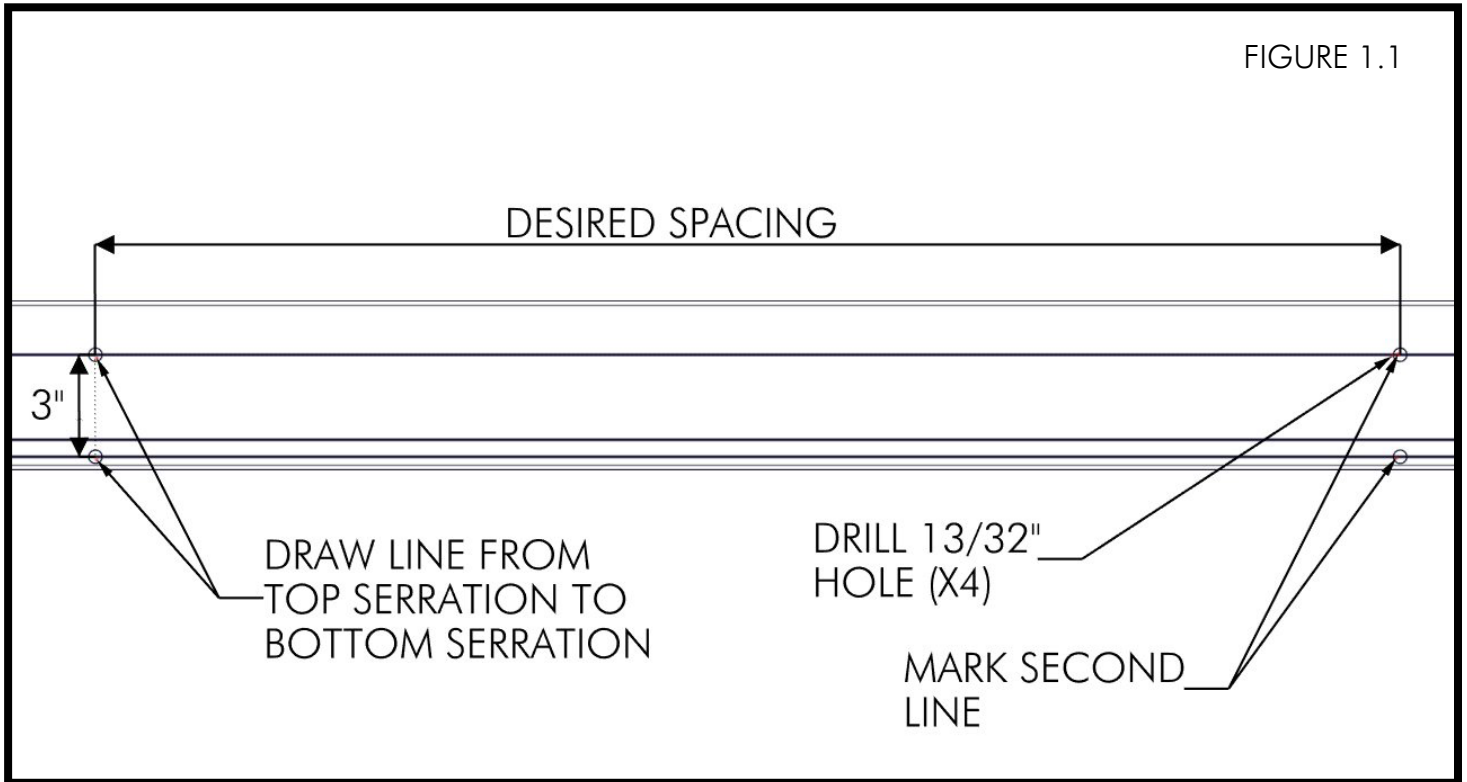

WITH THE CAP REMOVED, INSERT (2) 3/8" X 2" BOLTS WITH (2) 3/8" WASHERS INTO THE TRACK ON THE UPRIGHT. PEEL THE BACKING OFF THE TAPE ON THE INSIDE OF THE CAP AND ATTACH TO THE UPRIGHT. NOTE: TAPE MUST BE ON THE OPPOSITE SIDE OF THE TRACK (FIGURE 1.2 & 1.3).

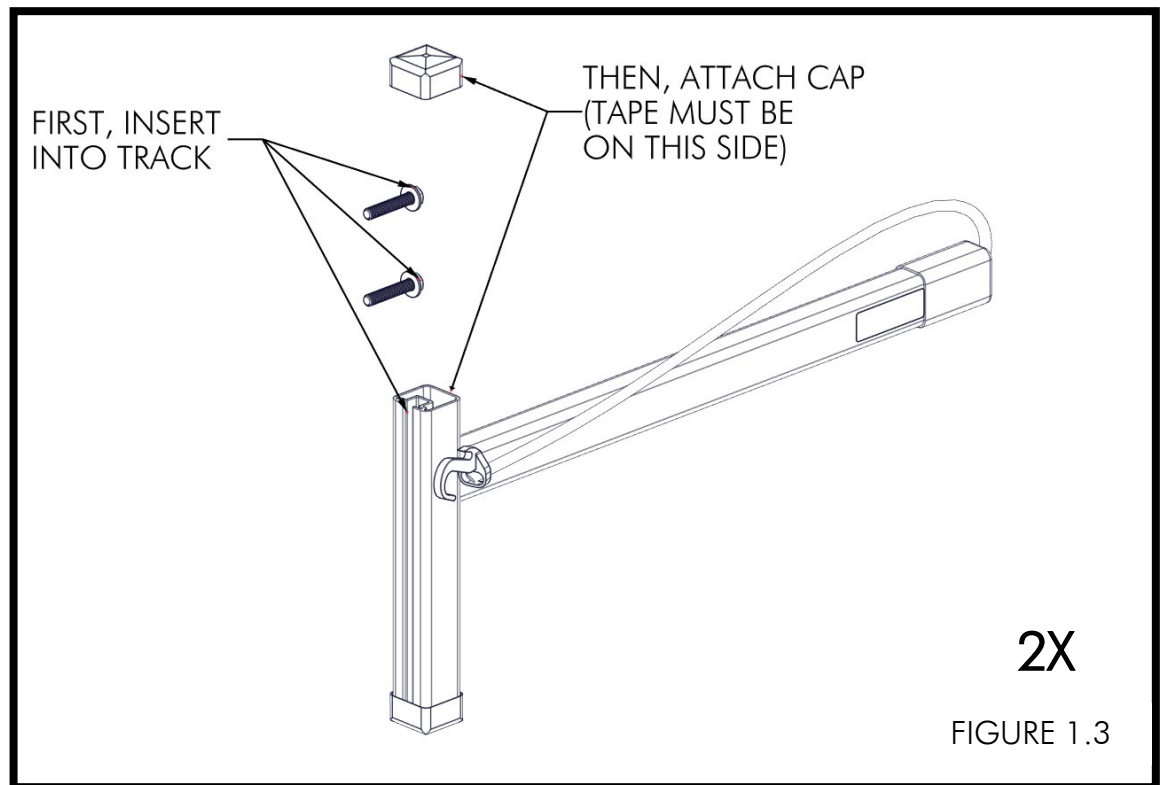
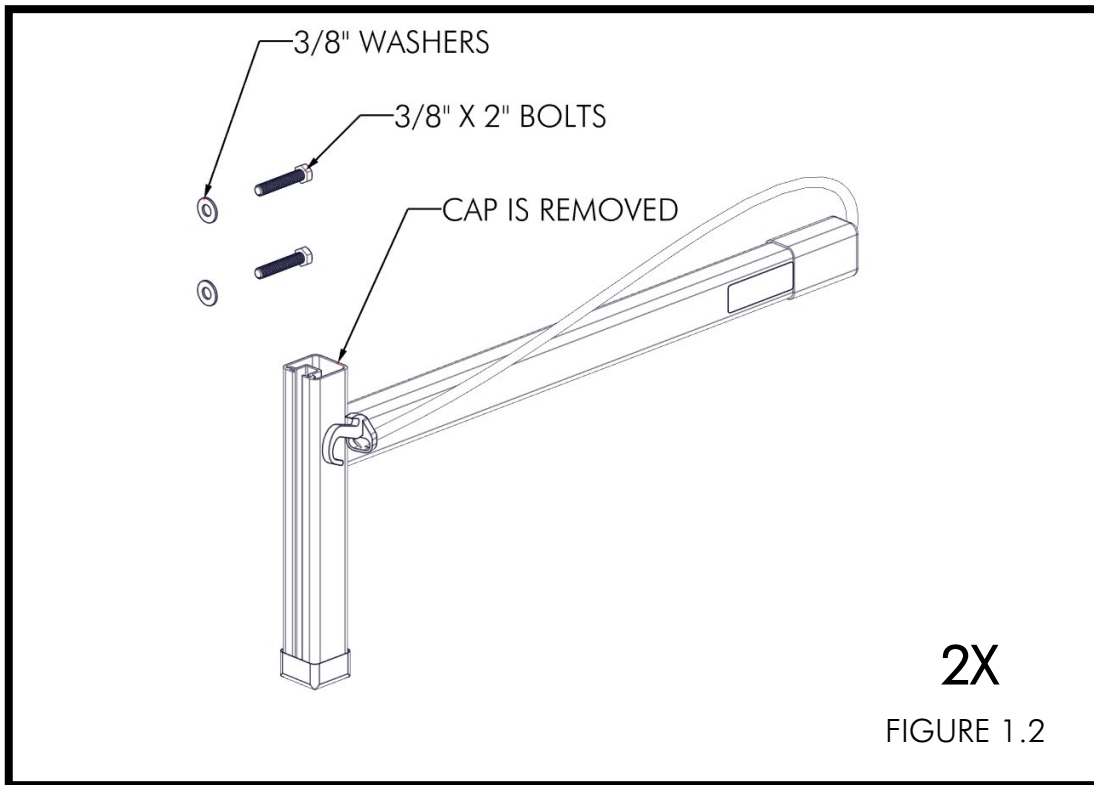

WITH THE BOLTS MOVED IN POSITION TO SET THE DESIRED HEIGHT OF THE UPRIGHTS, INSTALL THE ACCESSORY RACKS ONTO THE DOCK SIDE (FIGURE 1.4). INSTALL A 3/8" LOCK WASHER AND 3/8" NUT ONTO EACH BOLT (FIGURE 1.5).

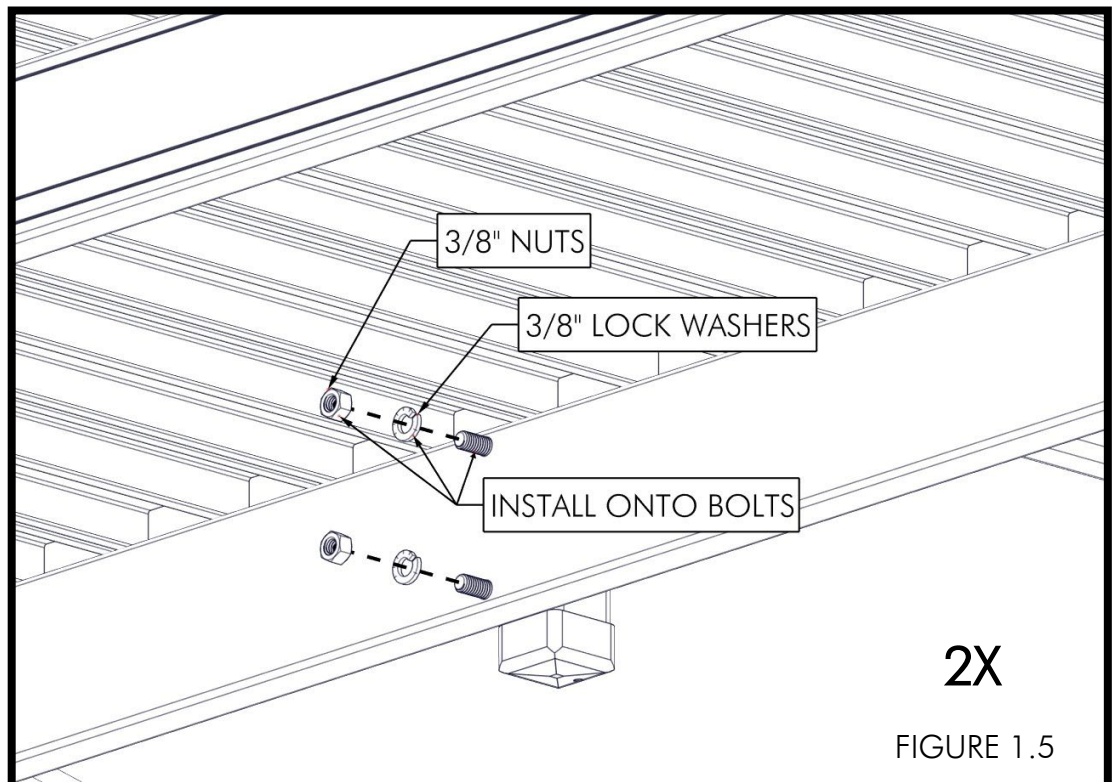
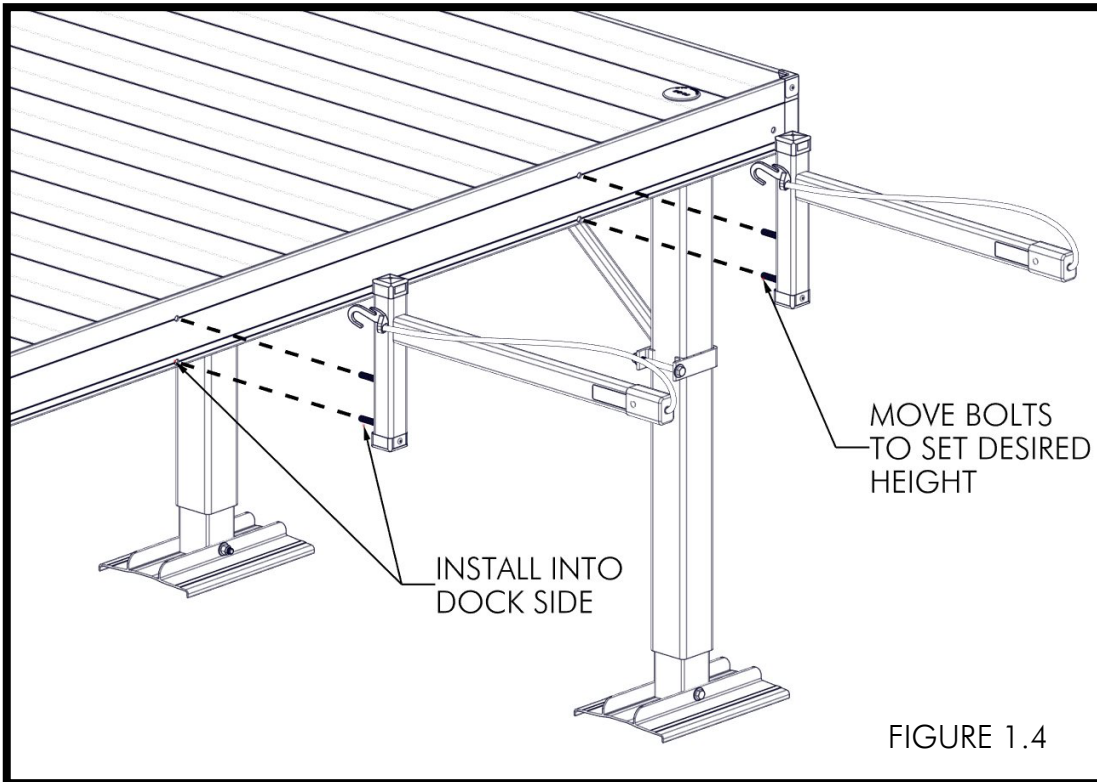

WHILE ENSURING THE UPRIGHTS ARE SQUARE TO THE TOP OF THE DOCK, TORQUE NUTS TO 20 FT-LB (FIGURE 1.6).

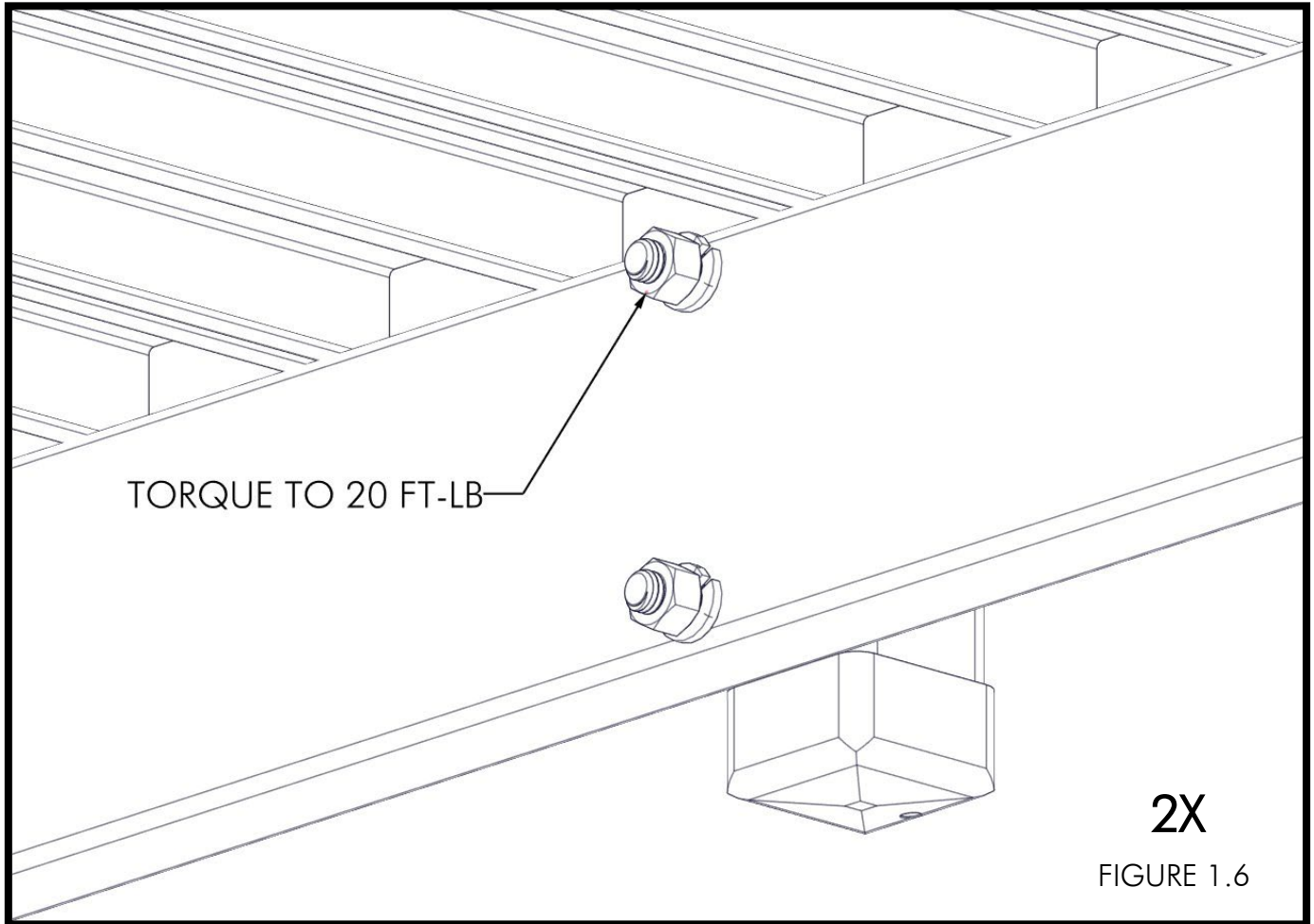

NOTES

