

FLOE STANDARD ROLL-IN DOCK WATER ACC. RACK ATTACHMENT KIT ASSEMBLY INSTRUCTIONS

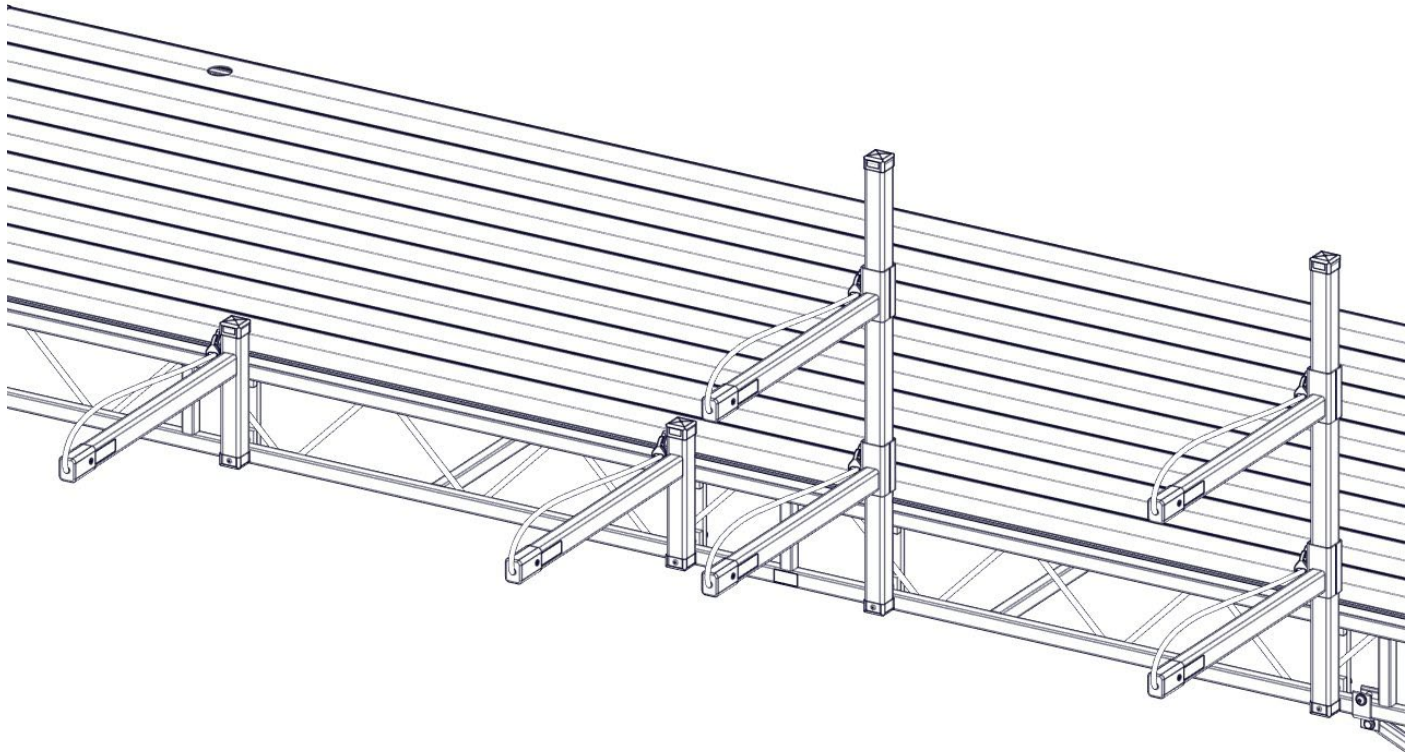

KIT P/N 510-02332-00



TOOLS REQUIRED

- 9/16" SOCKET/WRENCH
- TAPE MEASURE
- TORQUE WRENCH

*DOCK SECTION & LEGS NOT INCLUDED

NOTE:

WATER ACCESSORY RACKS ARE SOLD SEPARATELY.
REFER TO THE INSTRUCTIONS INCLUDED WITH THE KIT.

BILL OF MATERIALS

P/N 510-02332-00	KIT, WATER ACC. RACK MTG. HRDW. STD. ROLL-IN		
NUMBER	PART NUMBER	DESCRIPTION	QTY
1A	001-70114-00	HHCS, 3/8-16 X 2-3/4" 18-8 SS	4
1B	001-71017-00	FLAT WASHER, 3/8" SAE SS 18-8	4
1C	001-71067-00	LOCK WASHER, 3/8" S/W SS 18-8	4
1D	001-76349-00	NUT, 3/8-16 ALUM.	4
1E	002-02203-00	PLATE, DOCK ACCESSORY	2
1F	002-02204-00	SPACER, DOCK ACCESSORY	4

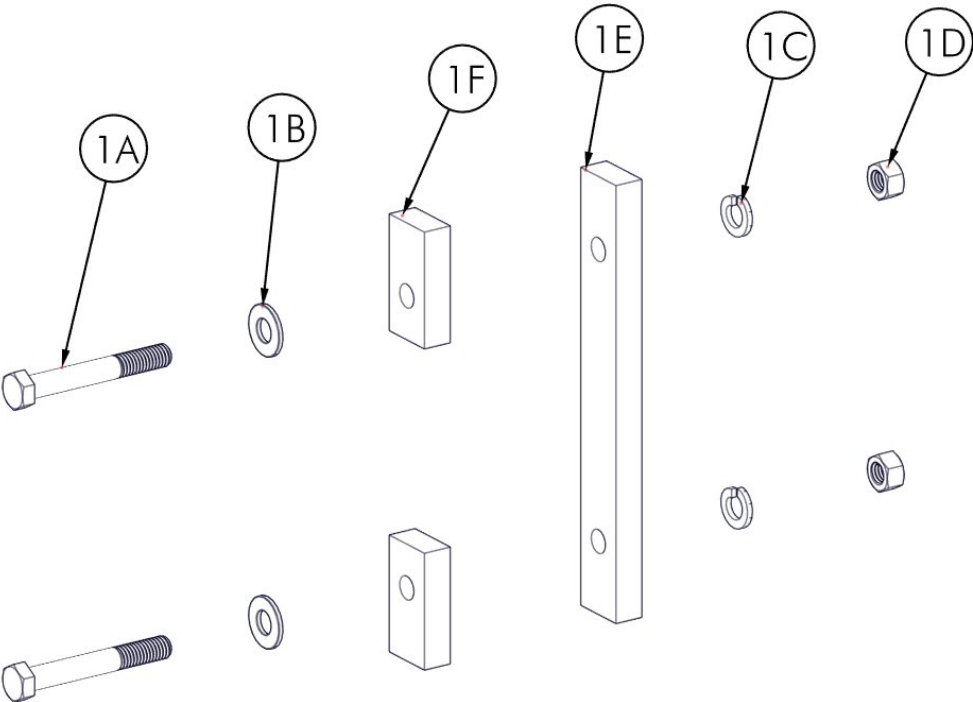

ASSEMBLY

FIRST, DETERMINE WHERE THE ACCESSORY RACK (SINGE OR DOUBLE TIER) WILL BE INSTALLED ON THE DOCK SYSTEM. WITH THE CAP REMOVED, INSERT (2) 3/8" X 2-3/4" BOLTS WITH (2) 3/8" WASHERS INTO THE TRACK ON THE UPRIGHT. PEEL THE BACKING OFF THE TAPE ON THE INSIDE OF THE CAP AND ATTACH TO THE UPRIGHT. NOTE: TAPE MUST BE ON THE OPPOSITE SIDE OF THE TRACK (FIGURE 1.1 & 1.2).

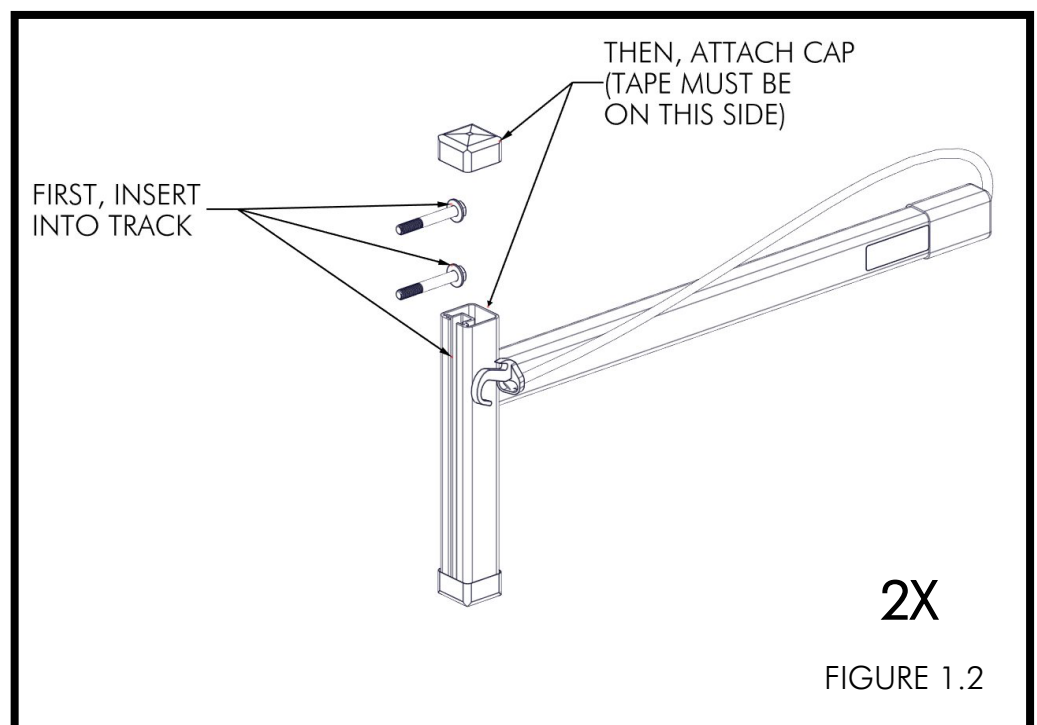
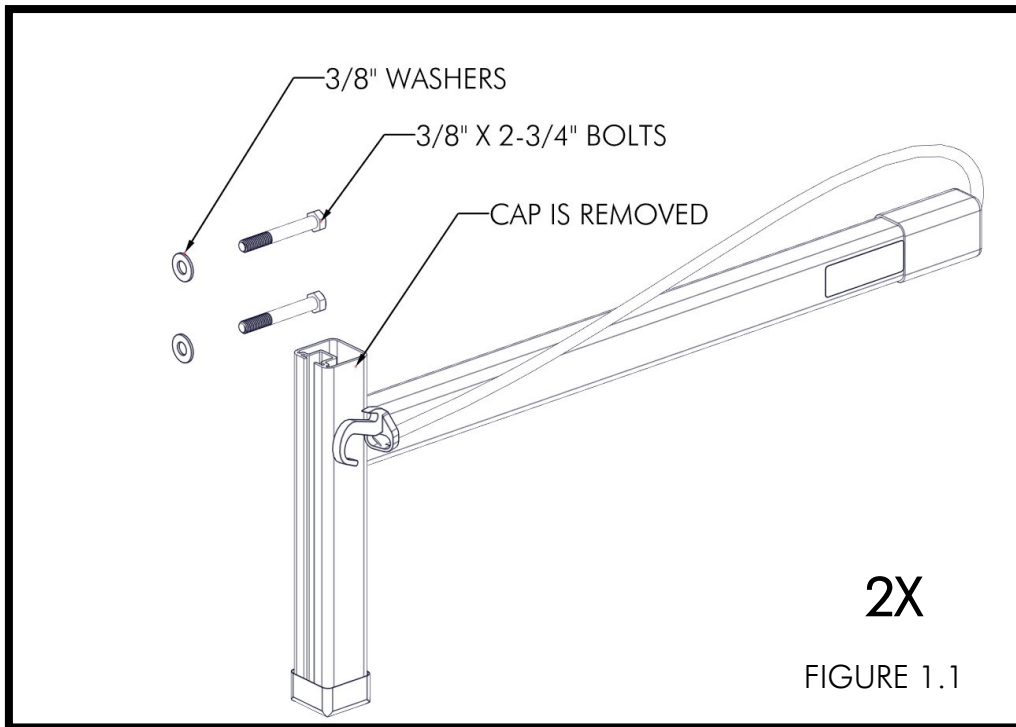

WITH THE BOLTS MOVED IN POSITION TO SET THE DESIRED HEIGHT OF THE UPRIGHTS, INSTALL THE ACCESSORY RACKS ONTO THE DOCK SIDE AT THE DESIRED WIDTH (FIGURE 1.3 & 1.4).

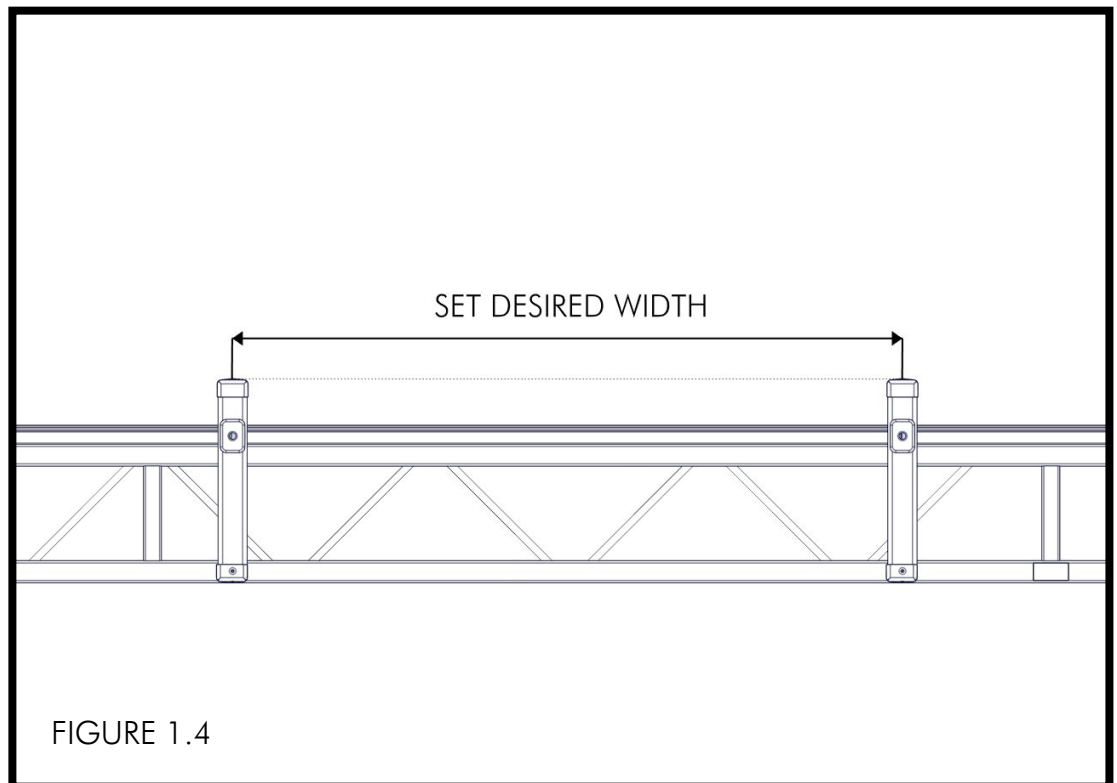
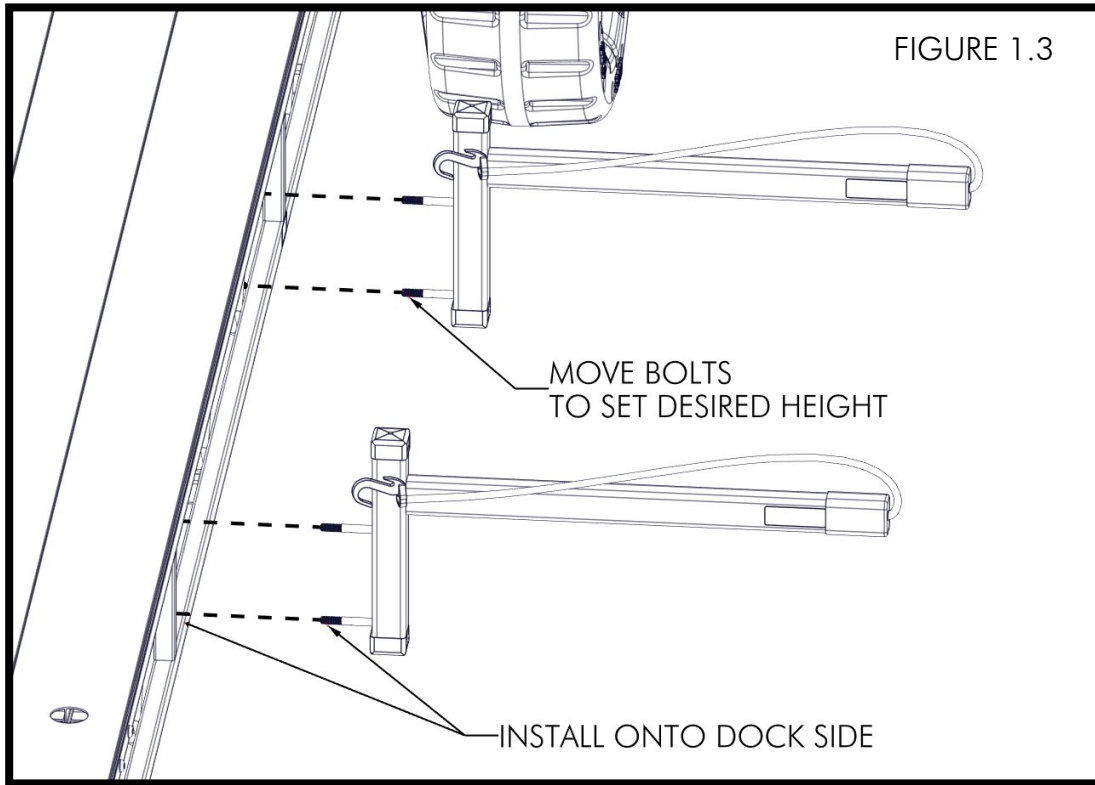

INSTALL THE SPACERS AND DOCK PLATES ON THE BOLTS ON THE INSIDE OF THE DOCK FRAME (IF NECESSARY, WEBBING MAY BE USED AS A SPACER (FIGURE 1.5). INSTALL A 3/8" LOCK WASHER AND 3/8" NUT ONTO EACH BOLT (FIGURE 1.6).

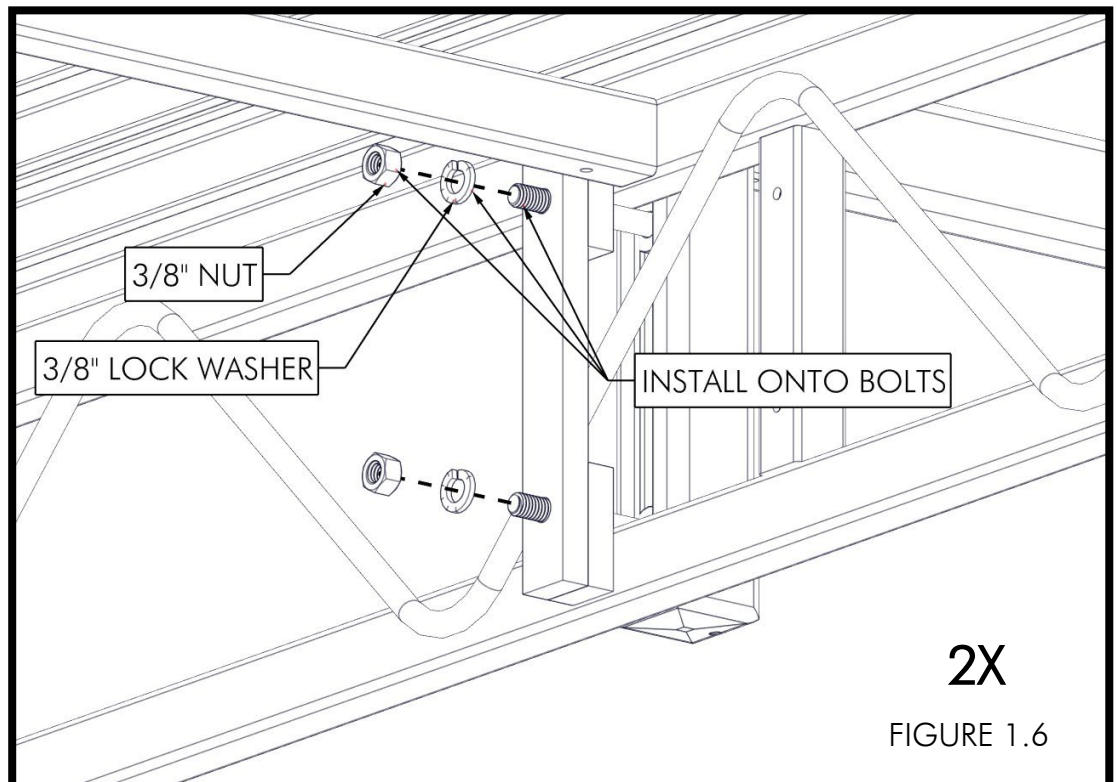
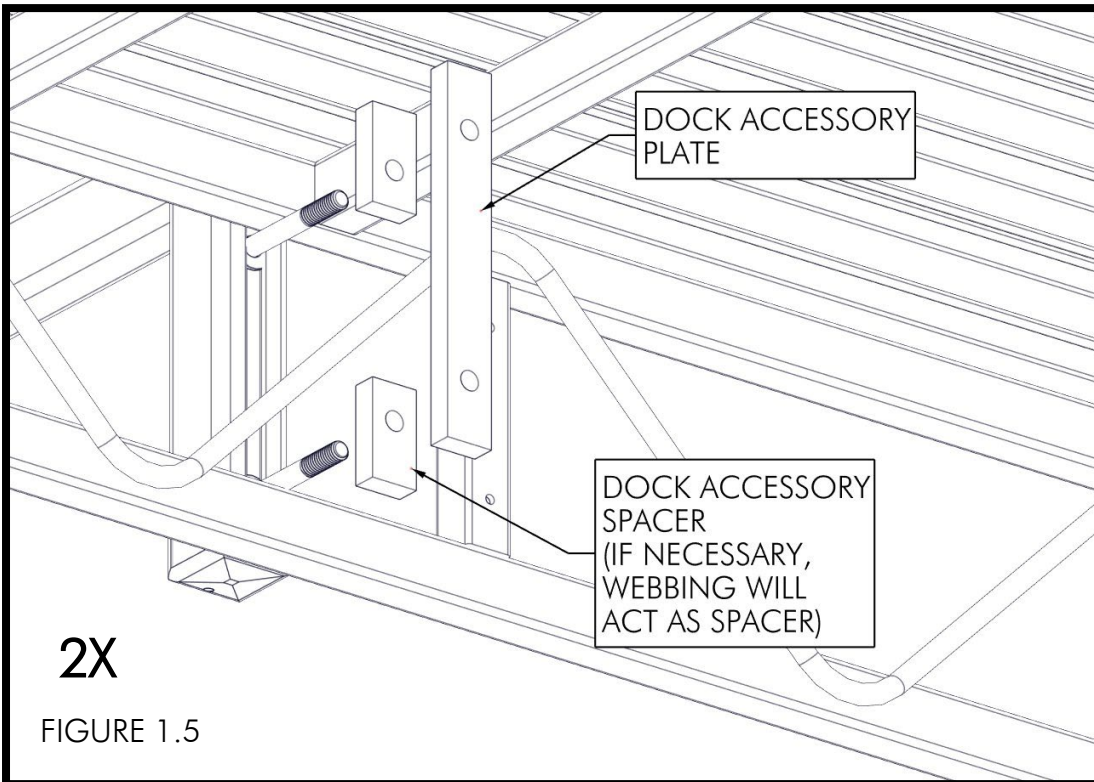

WHILE ENSURING THE UPRIGHTS ARE SQUARE TO THE TOP OF THE DOCK, TORQUE NUTS TO 20 FT-LB (FIGURE 1.7).

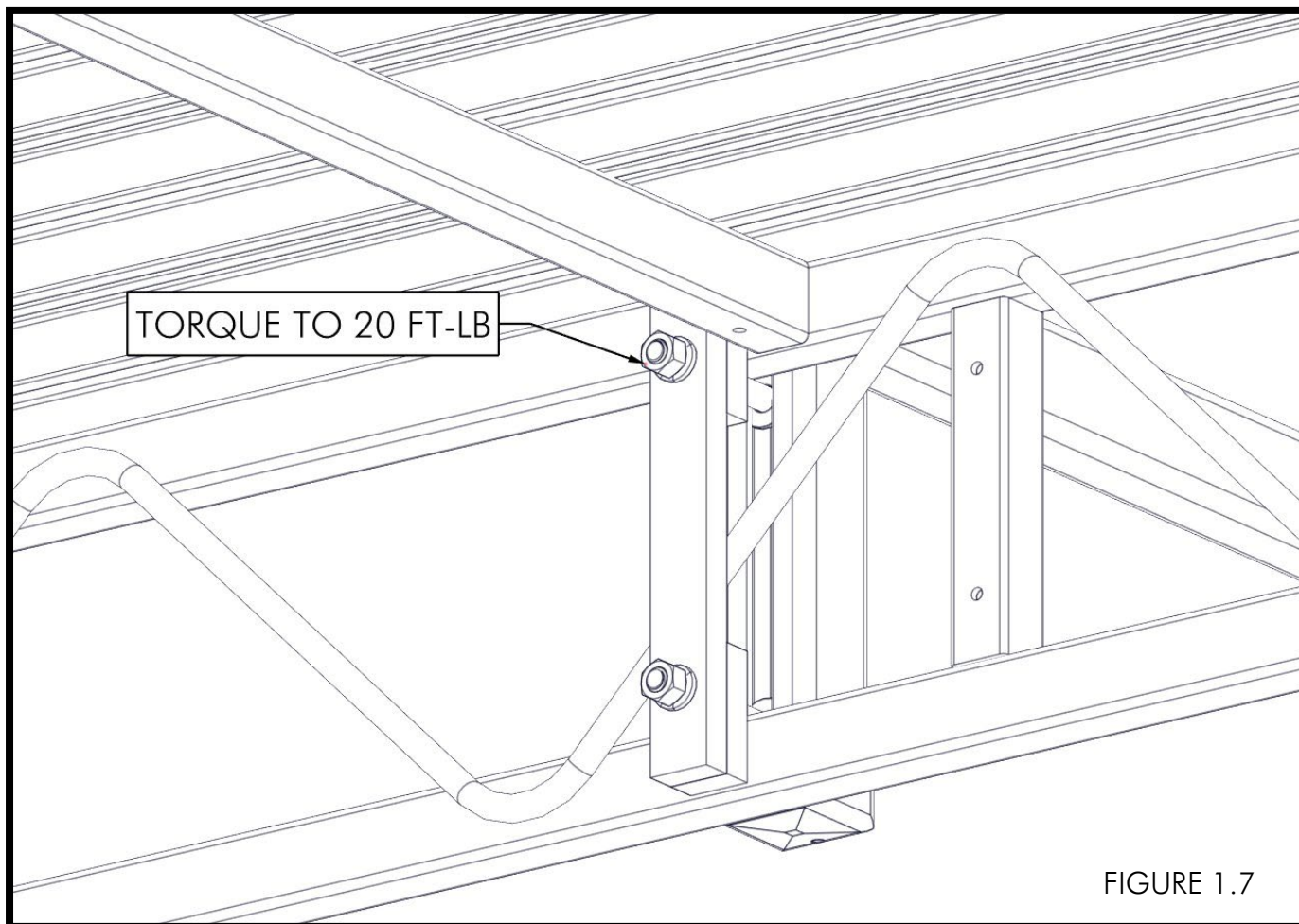

FIGURE 1.7

NOTES

