

FLOE FLOATING DOCK LADDER & BENCH ATTACHMENT KIT

ASSEMBLY INSTRUCTIONS

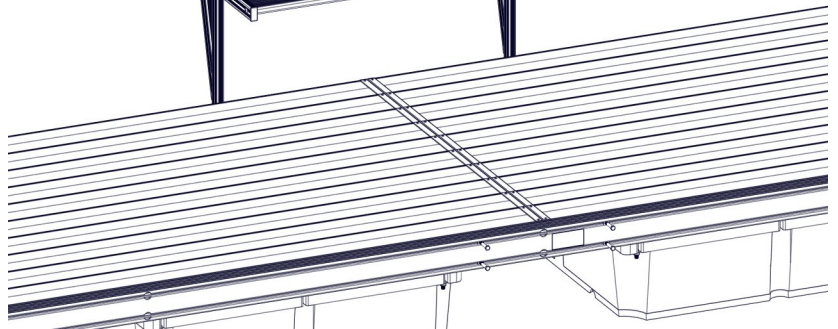

KIT P/N 510-02331-00

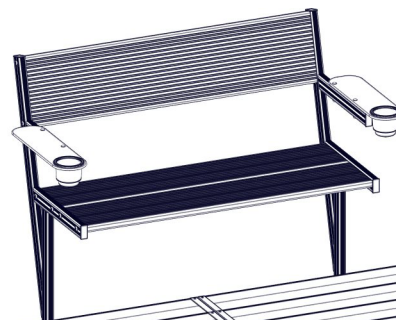
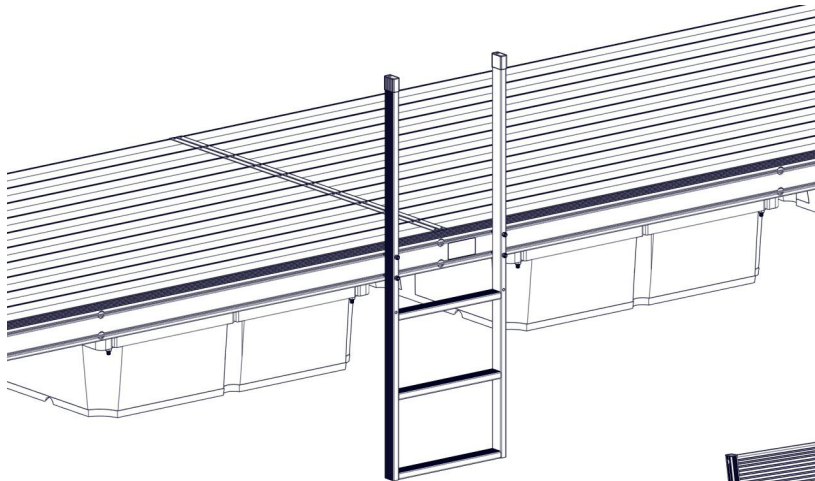

***DOCK SECTION NOT INCLUDED**

NOTE:
LADDER/BENCH IS SOLD SEPARATELY.

TOOLS REQUIRED

-9/16" SOCKET/WRENCH
-TORQUE WRENCH

BILL OF MATERIALS

P/N 510-02331-00	KIT, LADDER/BENCH MTG. HRDW. FLOATING		
NUMBER	PART NUMBER	DESCRIPTION	QTY
1A	001-70114-00	HHCS, 3/8-16 X 2-3/4" 18-8 SS	4
1B	001-71017-00	FLAT WASHER, 3/8" SAE SS 18-8	4
1C	001-76071-00	NUT, NYLOCK 3/8-16 ALUM.	4
*2	510-41400-01 510-41405-01	58" ALUMINUM LADDER (INCLUDES 2A & 2B) 70" ALUMINUM LADDER (INCLUDES 2A & 2C)	1
*2A	006-13700-00	CAP, VINYL 1" X 2" X 2" LONG	2
*2B	110-00033-00	WELDMENT, DOCK LADDER – 58"	1
*2C	110-00065-00	WELDMENT, DOCK LADDER – 70"	1

***NOT INCLUDED**

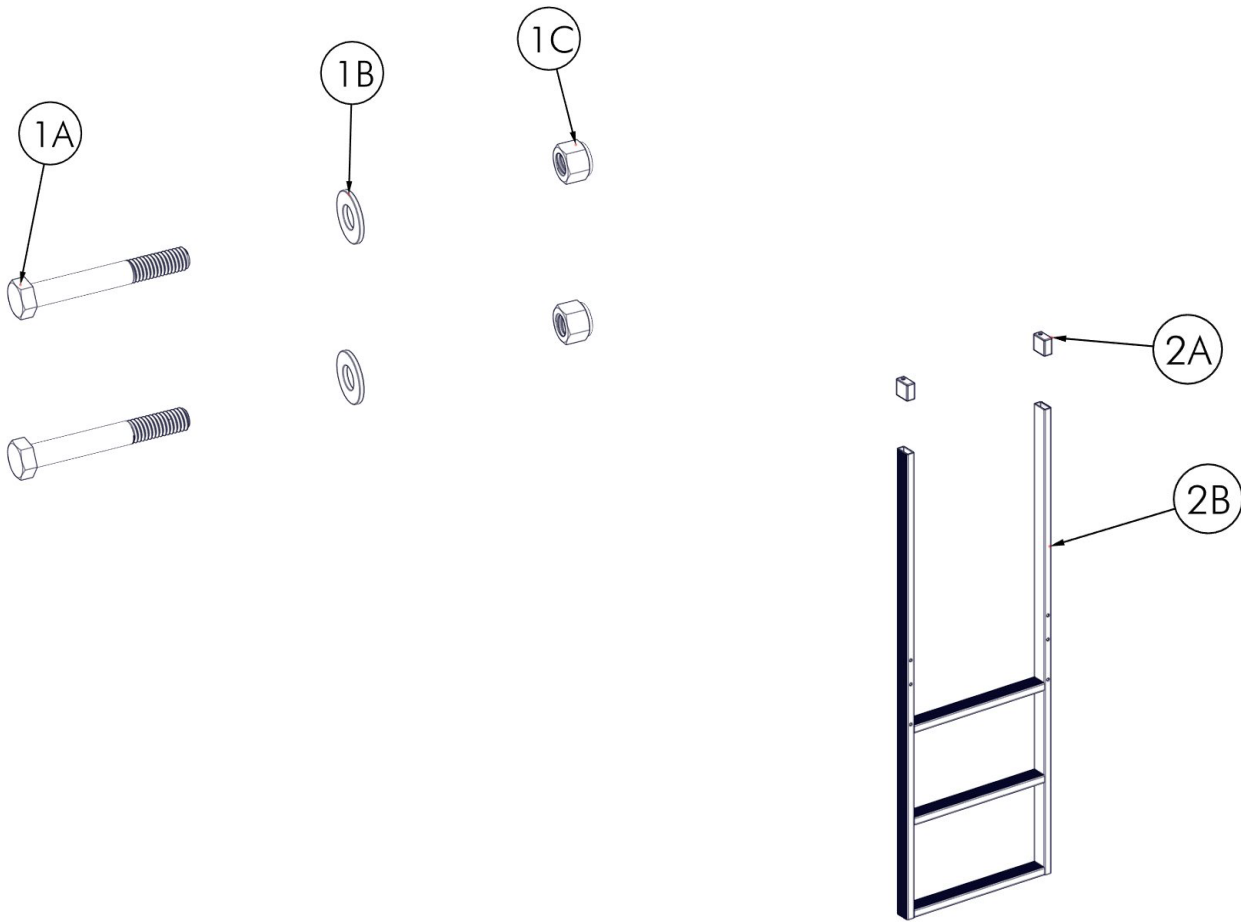

LADDER ATTACHMENT

FIRST, DETERMINE WHERE THE LADDER WILL BE INSTALLED ON THE DOCK SYSTEM. INSERT (2) 3/8" NYLOCK NUTS AND (2) 3/8" WASHERS INTO THE HOLES ON EACH TRACK IN THE SIDE OF THE DOCK (FIGURE 1.1) AND SLIDE TO THE DESIRED LOCATION (FIGURE 1.2).

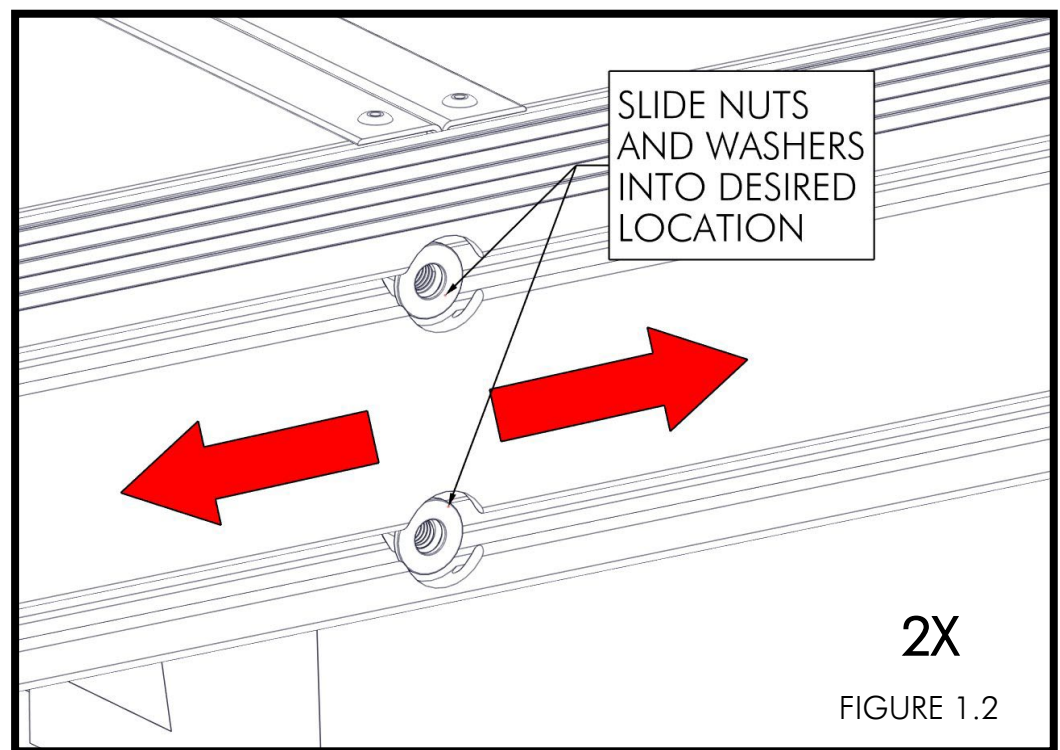
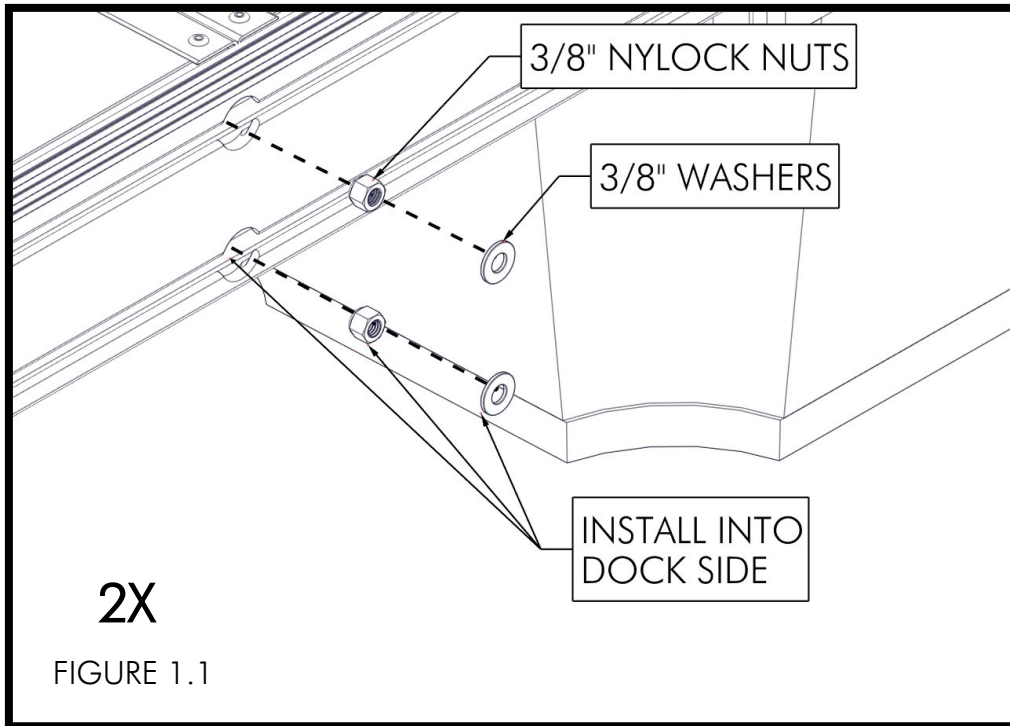

INSERT (2) 3/8" X 2-3/4" BOLTS INTO THE LADDER AND INTO THE CORRESPONDING NUTS AND WASHERS AS SHOWN (FIGURE 1.3). TORQUE TO 30 FT-LB (FIGURE 1.4).

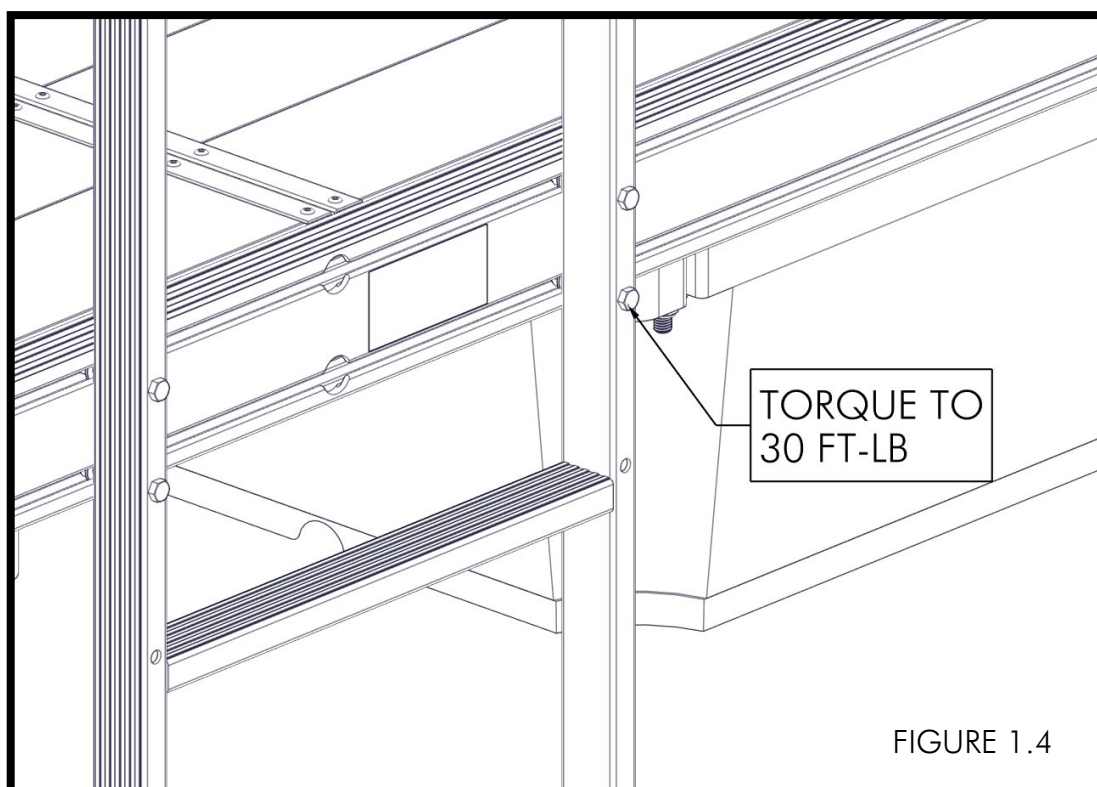
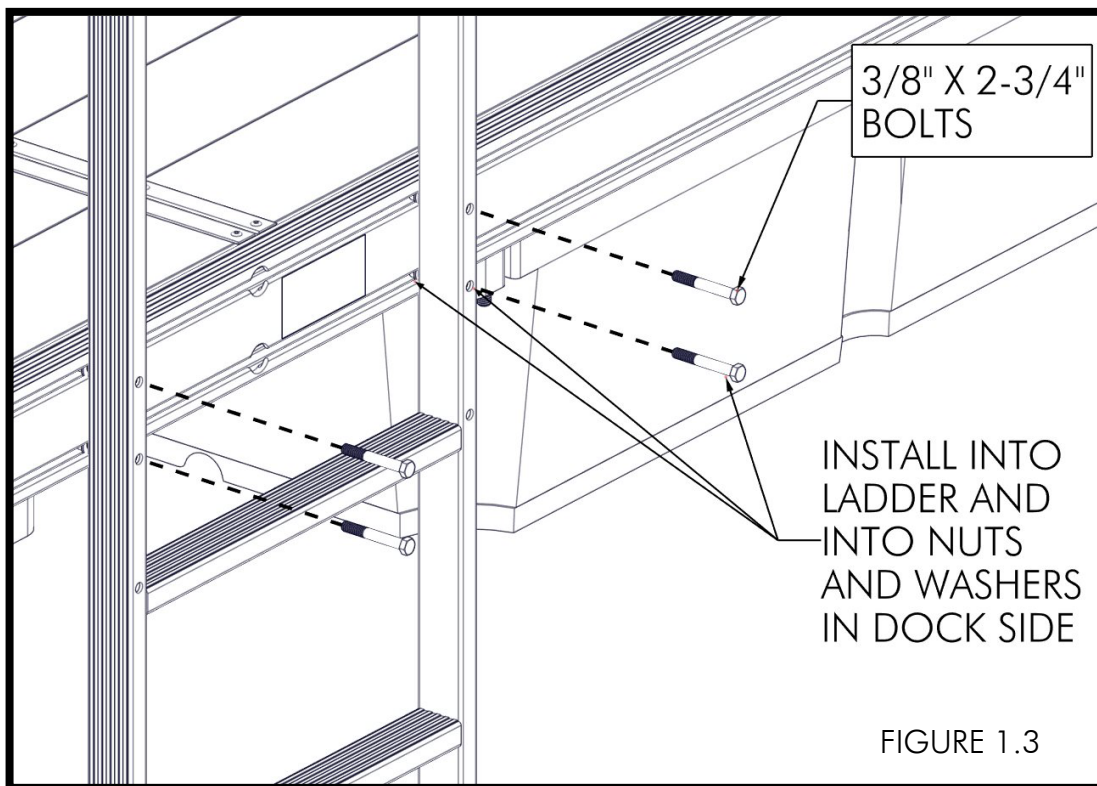

BENCH ATTACHMENT

FIRST, DETERMINE WHERE THE BENCH WILL BE INSTALLED ON THE DOCK SYSTEM. INSERT (2) 3/8" NYLOCK NUTS AND (2) 3/8" WASHERS INTO THE HOLES ON EACH TRACK IN THE SIDE OF THE DOCK (FIGURE 1.1) AND SLIDE TO THE DESIRED LOCATION (FIGURE 1.2).

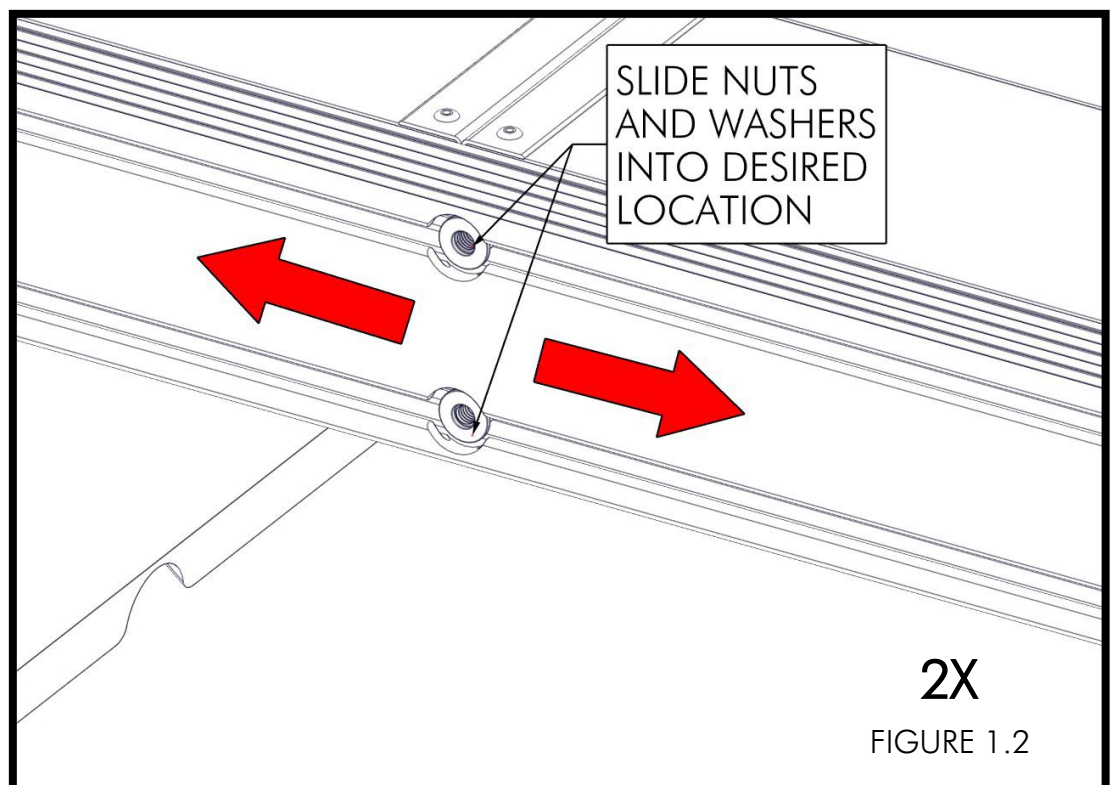
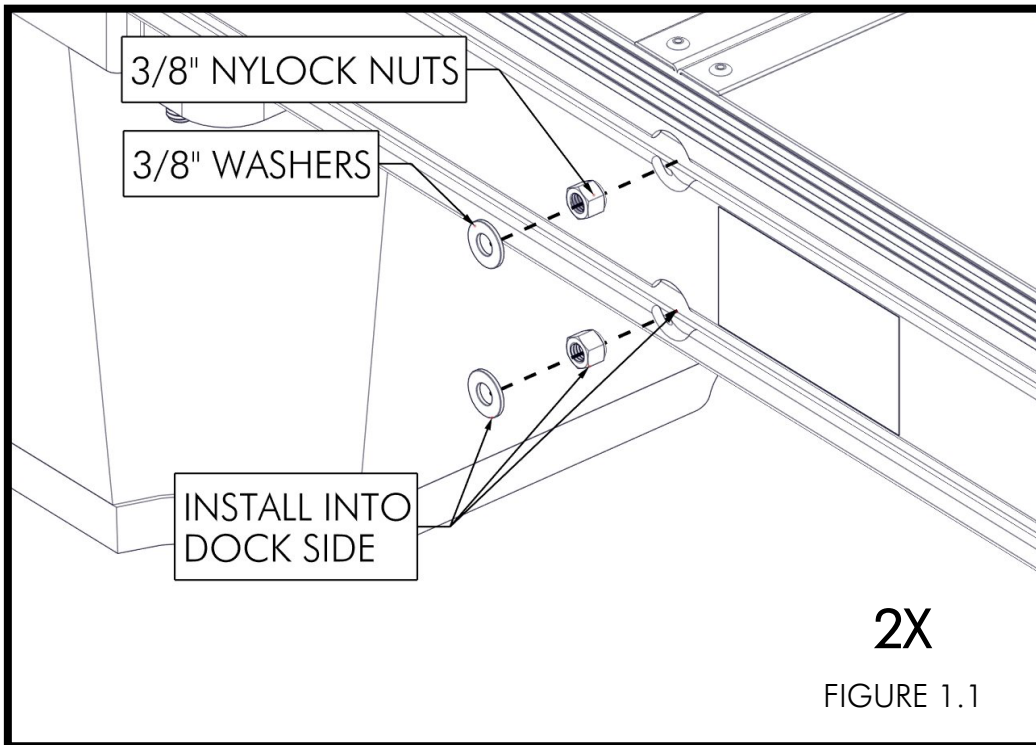

INSERT (2) 3/8" X 2-3/4" BOLTS INTO THE BENCH AND INTO THE CORRESPONDING NUTS AND WASHERS AS SHOWN (FIGURE 1.3). TORQUE TO 30 FT-LB (FIGURE 1.4).

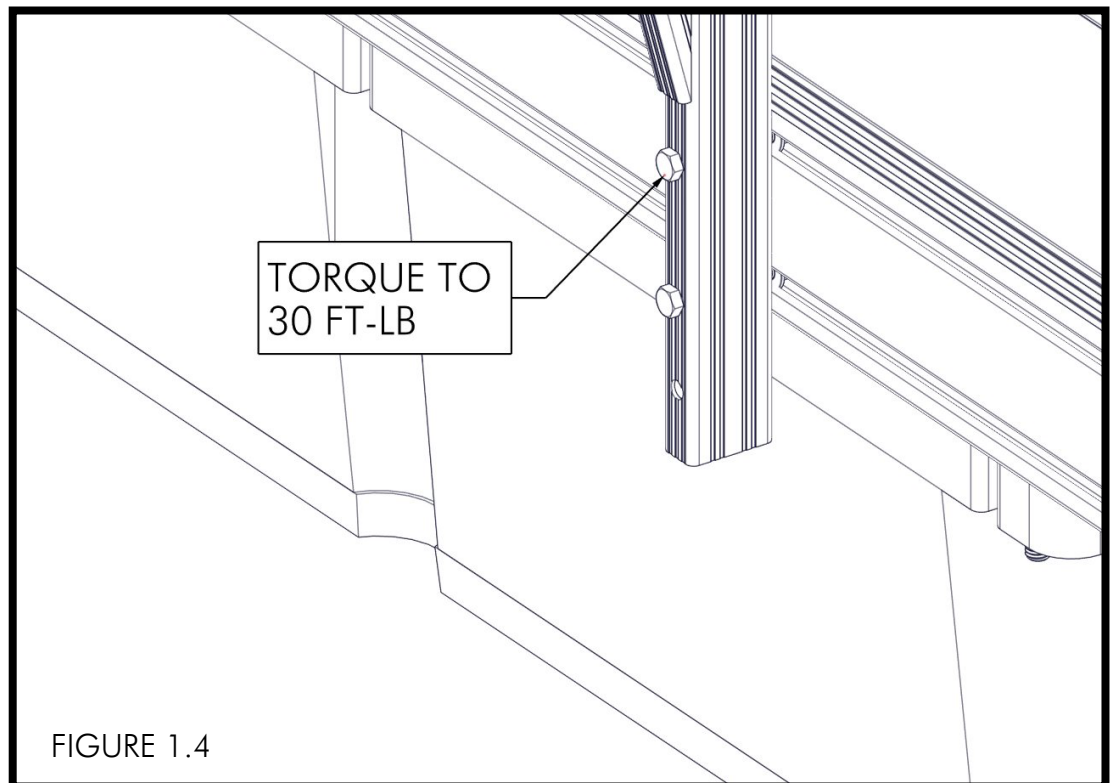
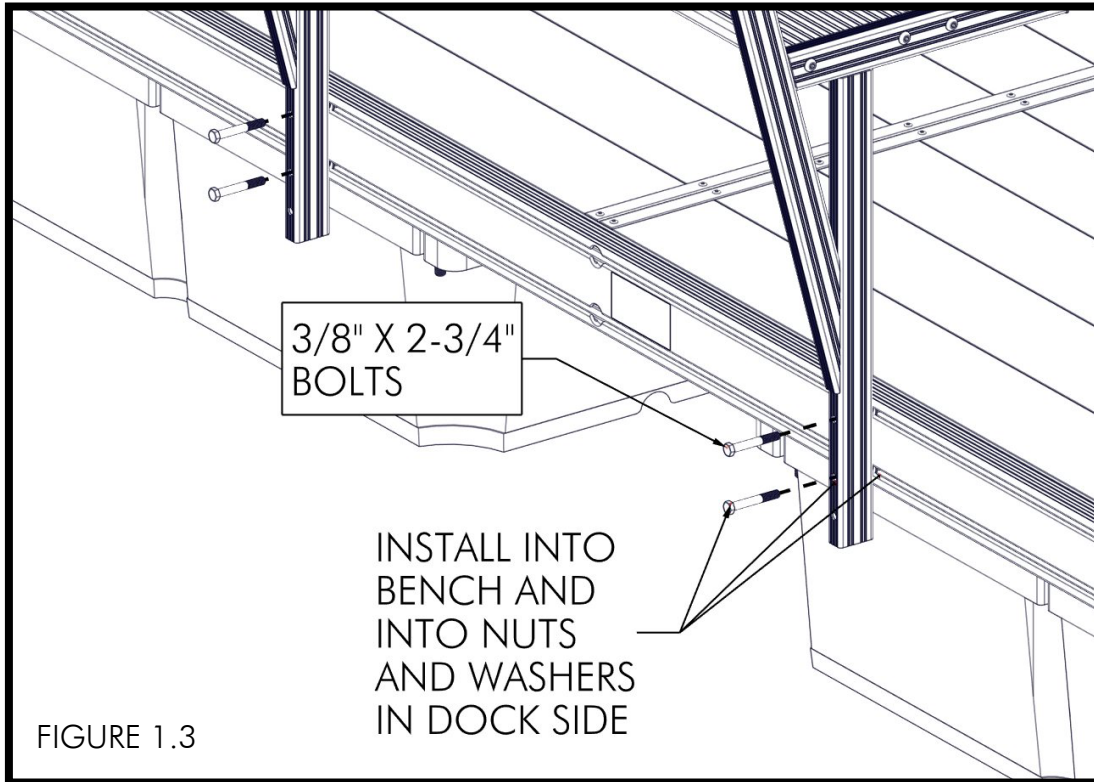

NOTES

