

FLOE STANDARD SECTIONAL DOCK STEP ATTACHMENT KIT ASSEMBLY INSTRUCTIONS

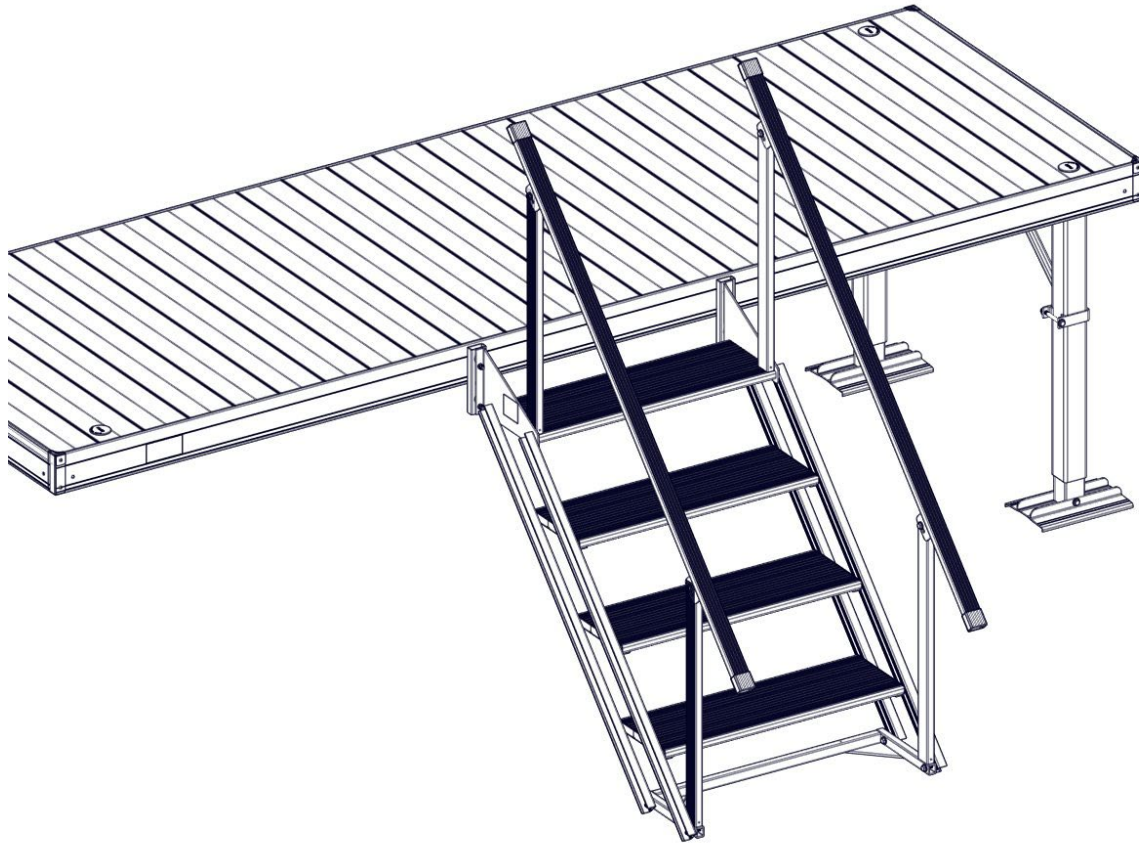

KIT P/N 510-02328-00



*DOCK SECTION & LEGS NOT INCLUDED

NOTE:

DOCK STEPS ARE SOLD SEPARATELY.
REFER TO THE INSTRUCTIONS INCLUDED
WITH THE KIT.

TOOLS REQUIRED

- (2) 9/16" SOCKETS/WRENCHES
- TAPE MEASURE
- TORQUE WRENCH
- FRAMING SQUARE
- MARKER
- CORDLESS DRILL
- 13/32" DRILL BIT
- HAMMER
- CENTER PUNCH

BILL OF MATERIALS/EXPLODED VIEW

P/N 510-02328-00	KIT, STEP MOUNTING HARDWARE STD. SECTIONAL		
NUMBER	PART NUMBER	DESCRIPTION	QTY
1A	001-70111-00	HHCS, 3/8-16 X 2" 18-8 SS	4
1B	001-71017-00	FLAT WASHER, 3/8" SAE SS 18-8	4
1C	001-76071-00	NUT, NYLOCK 3/8-16 ALUM.	4

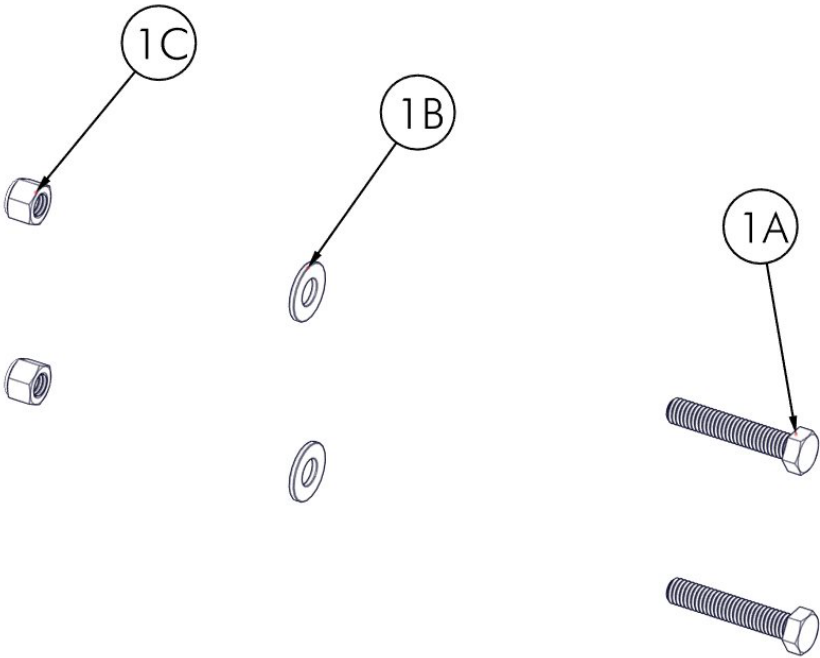

ASSEMBLY

FIRST, DETERMINE WHERE THE DOCK STEPS WILL BE INSTALLED ON THE DOCK SYSTEM. USING A FRAMING SQUARE, MARK A VERTICAL LINE ACROSS THE TOP AND BOTTOM SERRATIONS (THESE SERRATIONS ARE 3" APART AND ARE INTENDED TO ACT AS A HOLE SPACING REFERENCE). MARK A SECOND LINE 33" FROM THE FIRST LINE. USE A HAMMER AND CENTER PUNCH TO MAKE A DIMPLE FOR THE DRILL BIT. THIS HELPS PREVENT THE DRILL FROM WANDERING. KEEP THE DRILL BIT PERPENDICULAR TO THE DOCK FRAME WHILE DRILLING (FIGURE 1.1). INSERT (4) 3/8" X 2" BOLTS INTO THE MOUNTING BRACKET (INCLUDED WITH DOCK STEPS) AND INTO THE DOCK SIDE (FIGURE 1.2).

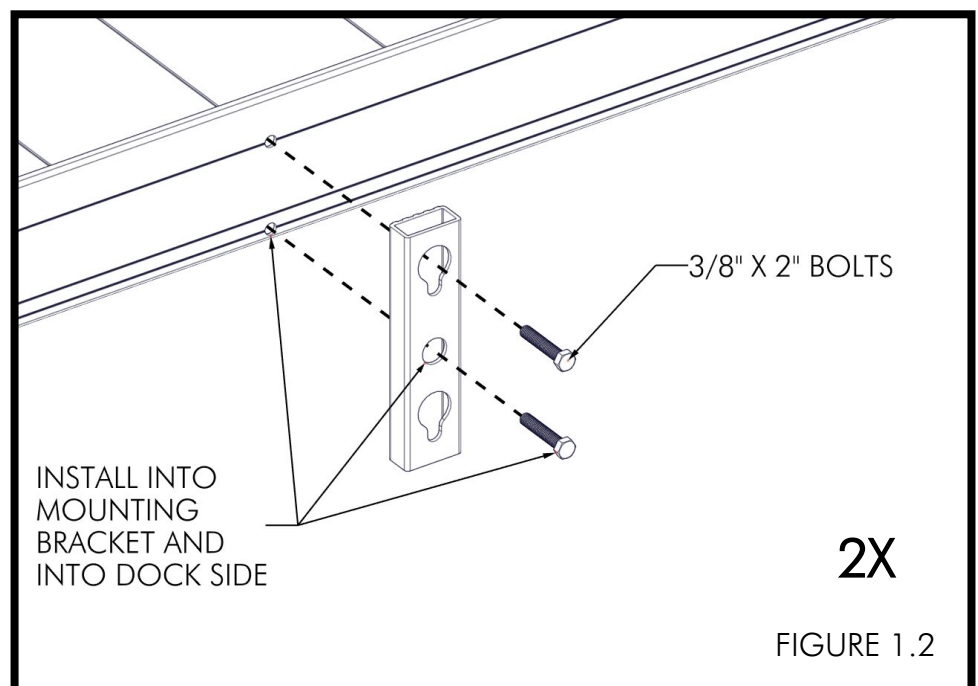
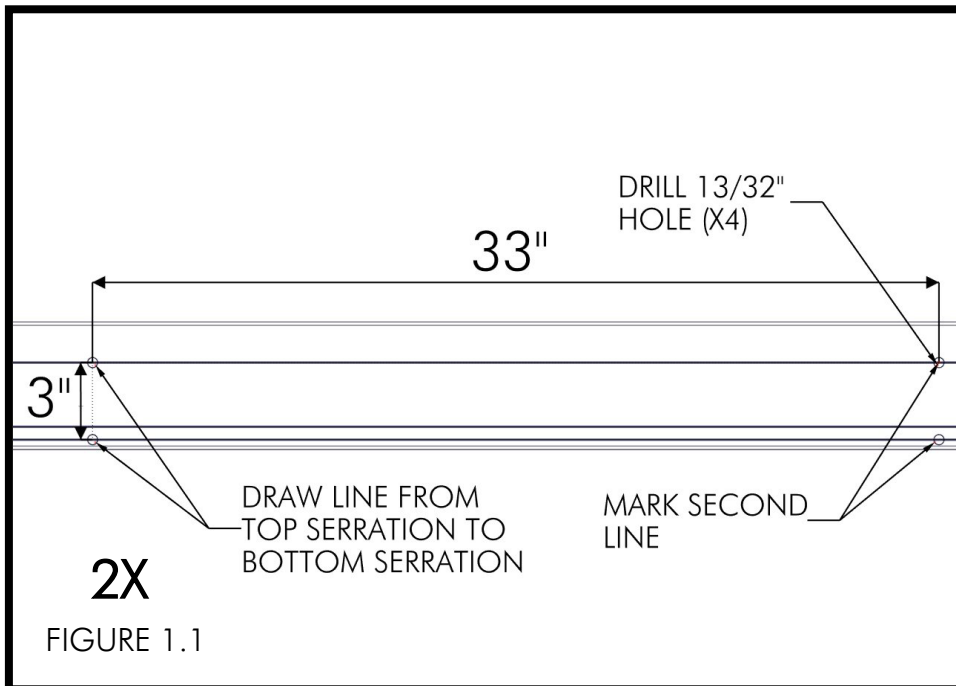

PLACE A 3/8" WASHER AND 3/8" NYLOCK NUT ONTO EACH BOLT (FIGURE 1.3). TORQUE ALL NUTS TO 25 FT-LB (FIGURE 1.4).

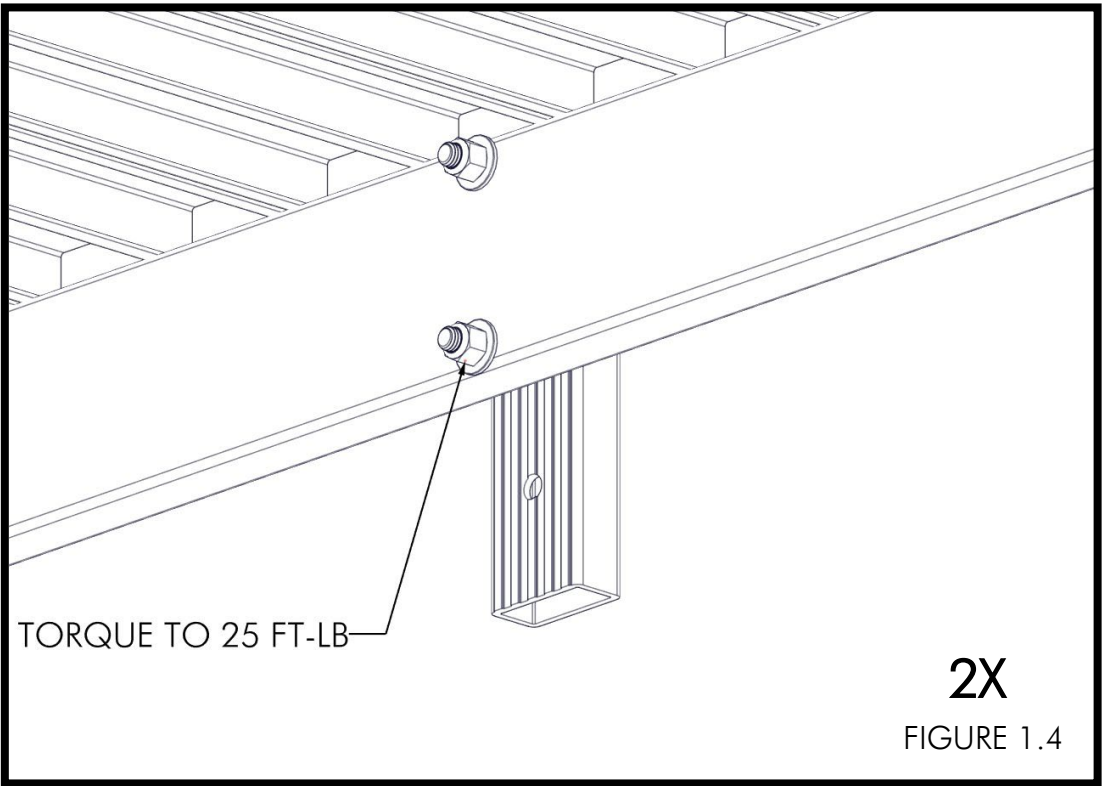
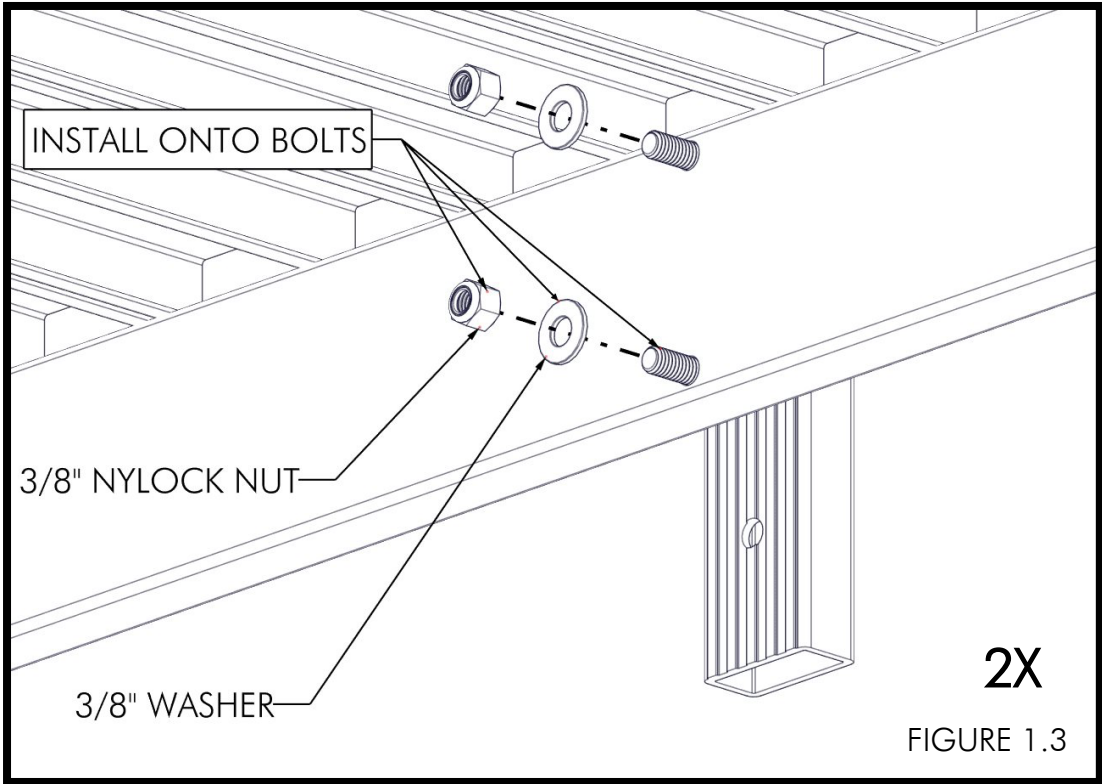

INSERT THE HEADS OF THE CARRIAGE BOLTS PRE-INSTALLED ON THE DOCK STEPS INTO THE MOUNTING BRACKETS (FIGURE 1.5). PUSH DOWN ON THE STEPS TO ENSURE THAT THE CARRIAGE BOLTS ARE ENGAGED INTO THE SLOTS IN THE MOUNTING BRACKET (FIGURE 1.6).

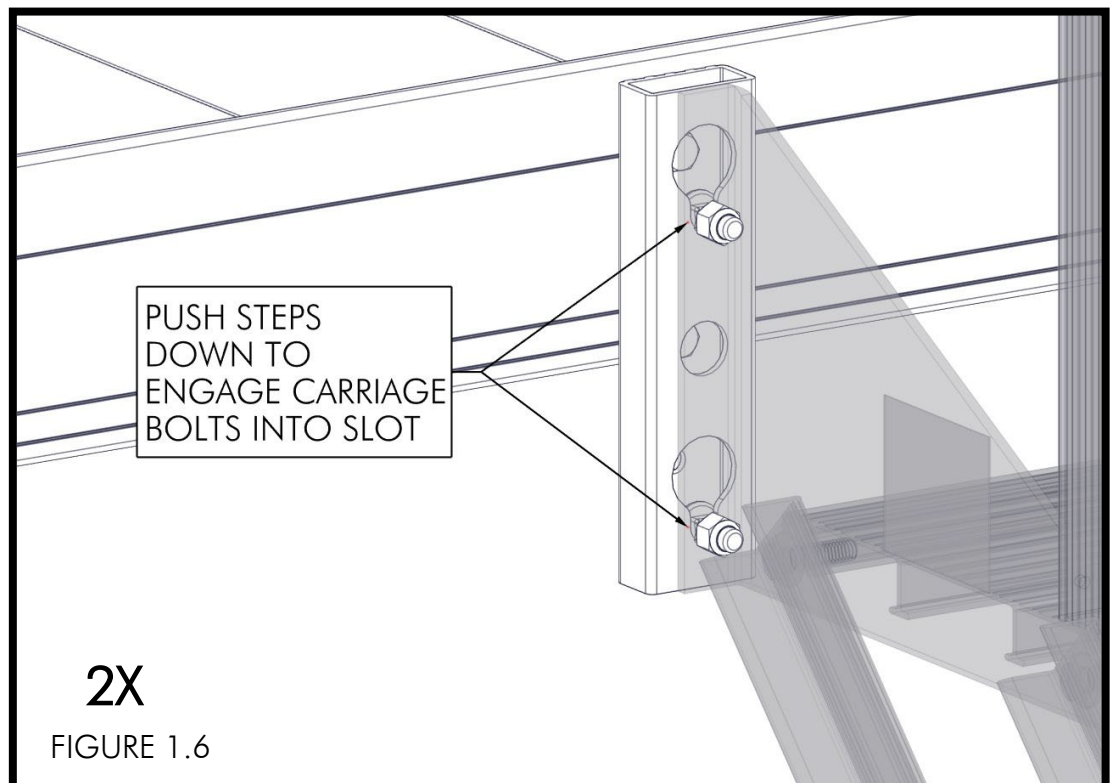
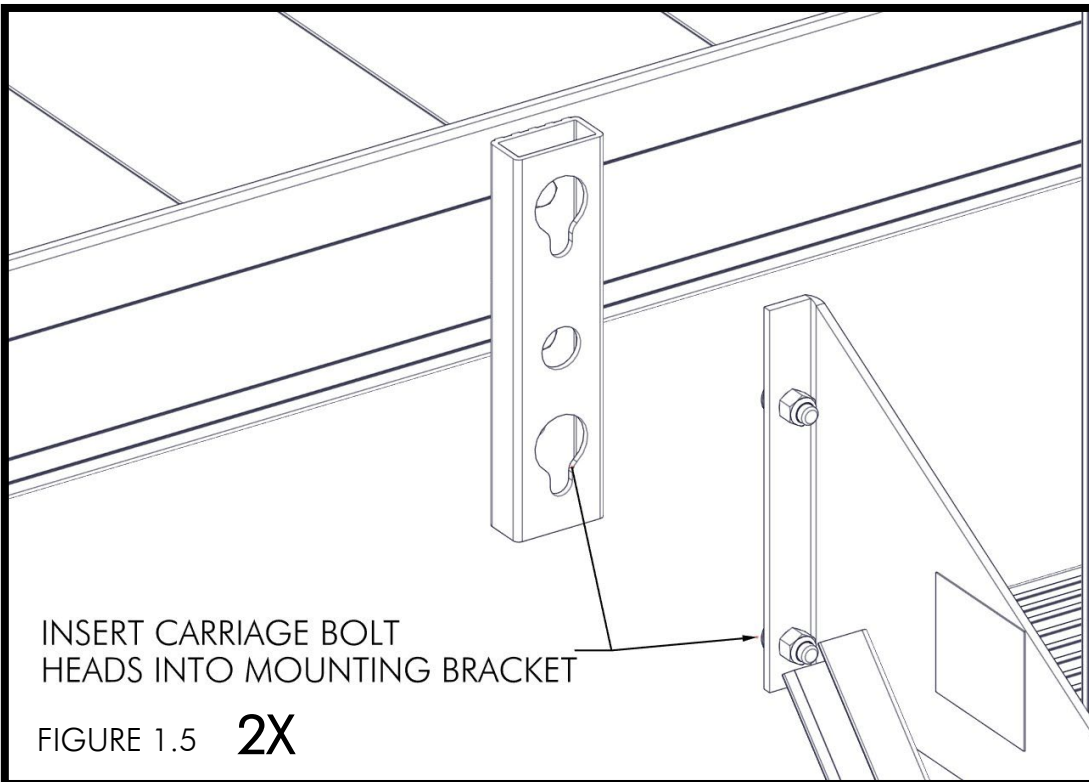

NOTES

NOTES

