

7-18-01
Proof

FLOE INTERNATIONAL, INC.



FLOE BOAT LIFT SYSTEMS
OWNER'S MANUAL/PARTS LISTS



Dear Friend:

Congratulations on the purchase of your new FLOE Boat Lift! Like you, I enjoy many kinds of waterfront activities, and I know that to have fun I need to keep my boat secure, protected and accessible. Through my years of experience, I've learned how boat lifts should not only protect your watercraft investment, but also be convenient and easy to use. And I have developed them accordingly.

The fact that you purchased a FLOE boat lift tells me that you research a product thoroughly. You will find a FLOE boat lift has many innovative features that will ensure that you enjoy years of dependable service, satisfaction, and enjoyment.

Your FLOE boat lift is engineered to lift and support a tremendous amount of weight so it is critical that you operate it safely. Carefully read this entire owners manual before operating your lift to make sure you are able to operate it properly and enjoy all of its features to the fullest. See you on the water!

Wayne Floe

CEO, FLOE International

CONTENTS

Page 2.....	P-800 PWC Lift/Parts List
Page 3.....	P-1000 Boat Lift/Parts List
Page 4.....	P-2000 Boat Lift/Parts List
Page 5-6.....	V-2000/V-3000 Boat Lifts/Parts Lists
Page 6.....	Winch Care & Maintenance
Page 7-8.....	V-4000/V-5000 Boat Lifts/Parts Lists
Page 9-10.....	H-4000/H-5000 Boat Lifts/Parts Lists
Page 10.....	Hydraulics Care & and Maintenance
Page 11.....	V-2002 Boat Lift/Parts List
Page 12.....	VP-3000 Boat Lift/Parts List
Page 13-14....	Optional Boat Lift Accessories
Page 15.....	Using Your FLOE Boat Lift System
Page 15.....	Canopy Care & Maintenance
Page 16.....	Installation/Removal of Your FLOE Boat Lift
Page 17-18.....	Warranties

FLOE P-800 PWC Lift

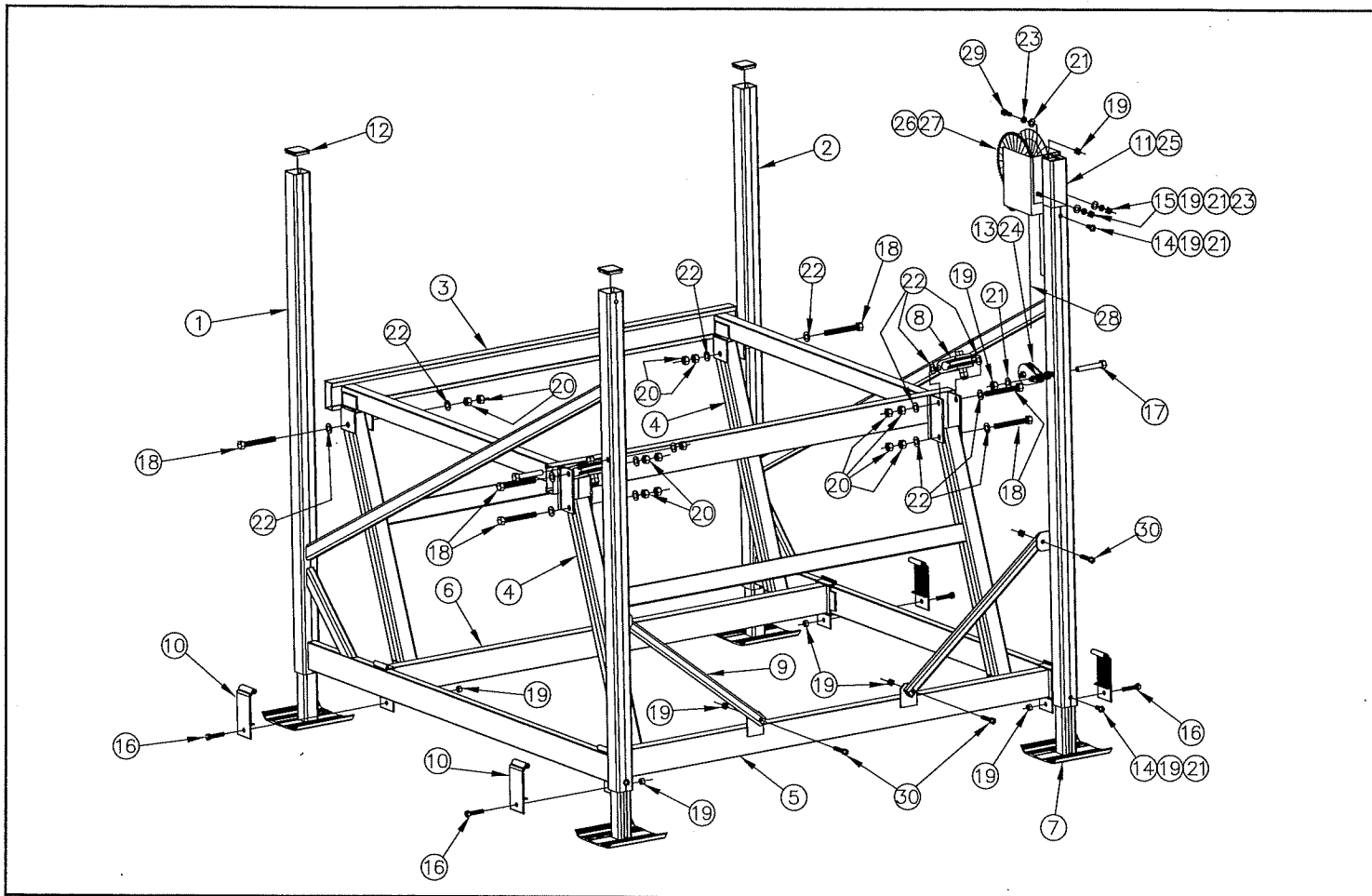

Parts List for FLOE P-800 PWC Lift

NO.	PART NO.	QTY.	DESCRIPTION
1	111-00025-00	1	Side Frame Weldment (Right)
2	111-00026-00	1	Side Frame Weldment (Left)
3	111-00027-00	1	Cradle Weldment
4	111-00028-00	2	Pivot Arm Weldment
5	111-00029-00	2	Front Frame Beam Weldment
6	111-00030-00	1	Rear Frame Beam Weldment
7	111-00031-00	2	Adj. Leg - 30" Weldment
8	111-00042-00	2	3" Pulley Assembly
9	002-03305-00	2	Front Brace 17.75
10	002-03310-00	4	Frame Beam Clamp (Female) 6.75
11	002-03313-00	1	Winch Mount
12	006-15210-00	3	2" Square Vinyl Cap
13	007-06000-00	1	2" Pulley Assembly
14	001-70103-00	1	HHCS, 3/8-16 x 3/4" ss
15	001-70105-00	5	HHCS, 3/8-16 x 1" ss

NO.	PART NO.	QTY.	DESCRIPTION
16	001-70110-00	4	HHCS, 3/8-16 x 1-3/4" ss
17	001-70115-00	2	HHCS, 3/8-16 x 3" ss
18	001-70219-00	10	HHCS, 1/2-13 x 4" ss
19	001-76349-00	18	Nut, 3/8-16 Alum.
20	001-76350-00	20	Nut, 1/2-13 Alum.
21	001-71017-00	10	Flat Washer, 3/8" SAE ss
22	001-71021-00	24	Flat Washer, 1/2" SAE ss
23	001-71067-00	3	Lock washer, 3/8 Split ss
24	007-08800-00	3	3/16" Lift Chain
25	911-01202-00	1	Winch Post - 15"
26	007-00000-00	1	Manual Winch DLB800
27	007-00300-00	1	12" Winch Handle DLB
28	111-00043-00	1	P-800 Cable Assembly
29	001-70107-00	1	HHCS, 3/8-16 x 1-1/4" ss
30	001-70109-00	4	HHCS, 3/8-16 x 1-1/2" ss

FLOE P-1000 Boat Lift

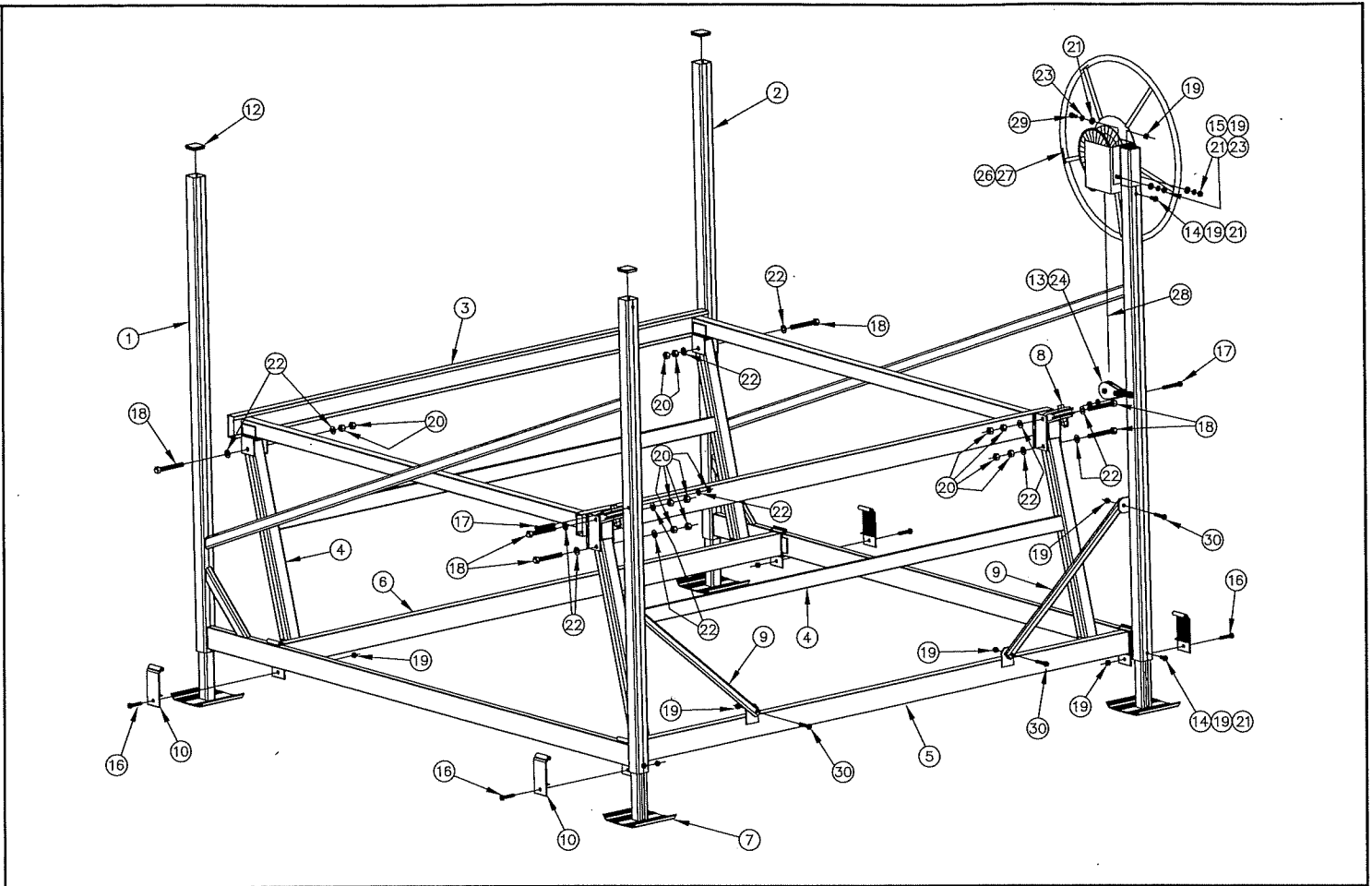

Parts List for FLOE Model P-1000 Boat Lift

NO.	PART NO.	QTY.	DESCRIPTION	NO.	PART NO.	QTY.	DESCRIPTION
1	111-00033-00	1	Side Frame Weldment (Right)	16	001-70110-00	4	HHCS, 3/8-16 x 1-3/4" ss
2	111-00034-00	1	Side Frame Weldment (Left)	17	001-70215-00	2	HHCS, 1/2-13 x 3" ss
3	111-00035-00	1	Cradle Weldment	18	001-70219-00	10	HHCS, 1/2-13 x 4" ss
4	111-00036-00	2	Pivot Arm Weldment	19	001-76349-00	18	Nut, 3/8-16 Alum.
5	111-00037-00	2	Front Frame Beam Weldment	20	001-76350-00	20	Nut, 1/2-13 Alum.
6	111-00038-00	1	Rear Frame Beam Weldment	21	001-71017-00	10	Flat Washer, 3/8" SAE ss
7	111-00031-00	2	Adj. Leg - 30" Weldment	22	001-71021-00	24	Flat Washer, 1/2" SAE ss
8	111-00042-00	2	3" Pulley Assembly	23	001-71067-00	3	Lock washer, 3/8 Split ss
9	002-03318-00	2	Front Brace	24	007-08800-00	3	3/16" Lift Chain
10	002-03310-00	4	Frame Beam Clamp (Female)	25	911-01202-00	1	Winch Post - 15"
11	002-03313-00	1	Winch Mount	26	007-00100-00	1	Manual Winch DLB1200
12	006-12400-00	3	2" Square Cap Plug	27	007-00200-00	1	2" Winch Wheel DLB
13	007-06000-00	1	2" Pulley Assembly	28	111-00044-00	1	P-1300 Cable Assembly
14	001-70103-00	1	HHCS, 3/8-16 x 3/4" ss	29	001-70107-00	1	HHCS, 3/8-16 x 1-1/4" ss
15	001-70105-00	5	HHCS, 3/8-16 x 1" ss	30	001-70109-00	4	HHCS, 3/8-16 x 1-1/2" ss

FLOE P-2000 Boat Lift

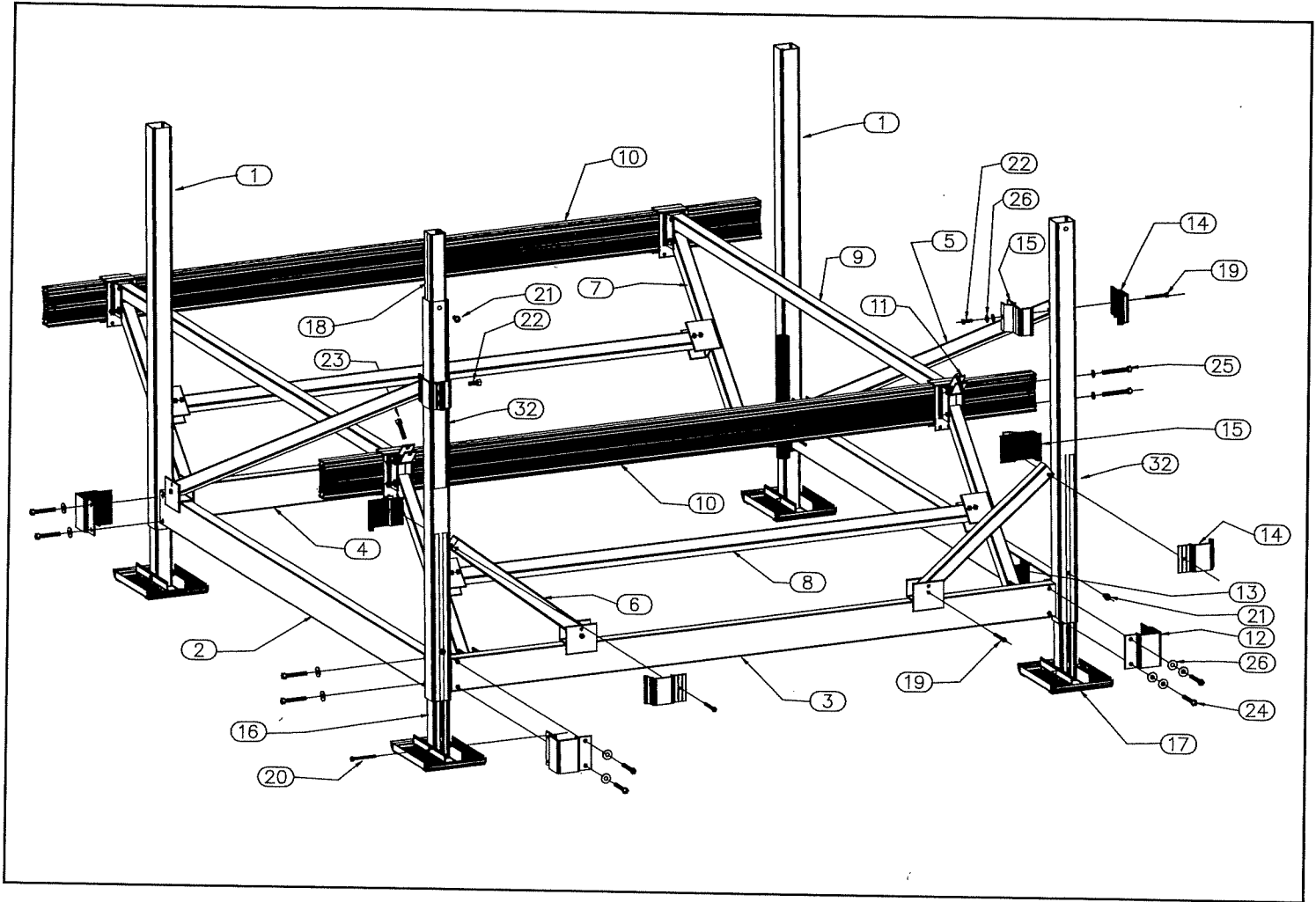

Parts List for FLOE Model P-2000 Boat Lift

NO.	PART NO.	QTY.	DESCRIPTION
1	002-04003-00	4	Cornerpost 74" (.090)
2	111-00051-00	2	Side Frame Beam 96" (.100)
3	111-00007-00	1	Front Frame Beam 96" (.125)
4	111-00008-00	1	Rear Frame Beam 96" (.125)
5	002-03110-00	2	Side Brace 99.5"
6	002-03111-00	2	Front Brace 26"
7	111-00005-00	4	Pivot Arm Weldment
8	002-03124-00	2	Pivot Cross Brace
9	111-00052-00	2	Side Cradle
10	911-04702-00	2	F/R Cradle Beam 101" (.090)
11	002-03130-00	2	Pulley Block
12	002-04082-00	4	Frame Beam Clamp (Outer)
13	002-04083-00	4	Frame Beam Clamp (Inner)
14	002-04034-00	4	Upper Clamp 1
15	002-04038-00	4	Upper Clamp 2
16	002-04067-00	5	Adjustable Leg 54" 0.100

NO.	PART NO.	QTY.	DESCRIPTION
17	011-00000-00	4	Sand Pad
18	911-04201-00	1	Adjustable Leg 38" (.125)
19	001-70115-00	24	HHCS, 3/8-16 X 3" ss 18-8
20	001-70217-00	4	HHCS, 1/2-13 X 3-1/2 ss 18-8
21	001-70203-00	5	HHCS, 1/2-13 X 3/4 ss 18-8
22	001-70207-00	2	HHCS, 1/2-13 X 1-1/4 ss 18-8
23	001-70213-00	2	HHCS, 1/2-13 X 2-1/2 ss 18-8
24	001-70216-00	16	HHCS, 1/2-13 X 3-1/4 ss 18-8
25	001-70219-00	10	HHCS, 1/2-13 X4 ss 18-8
26	001-71022-00	65	1/2" Flat Washer USS ss 18-8
27	001-76349-00	28	Nut, 3/8-16 Alum.
28	001-76350-00	45	Nut, 1/2-13 Alum.
29	111-00092-00	1	3" Pulley Assembly
30	111-00104-00	2	3" Pulley w/Bushing
31	007-08800-00	4	Lift Chain
32	002-04005-00	2	Corner Post 74" (.125)

FLOE V-2000/V-3000 Boat Lift

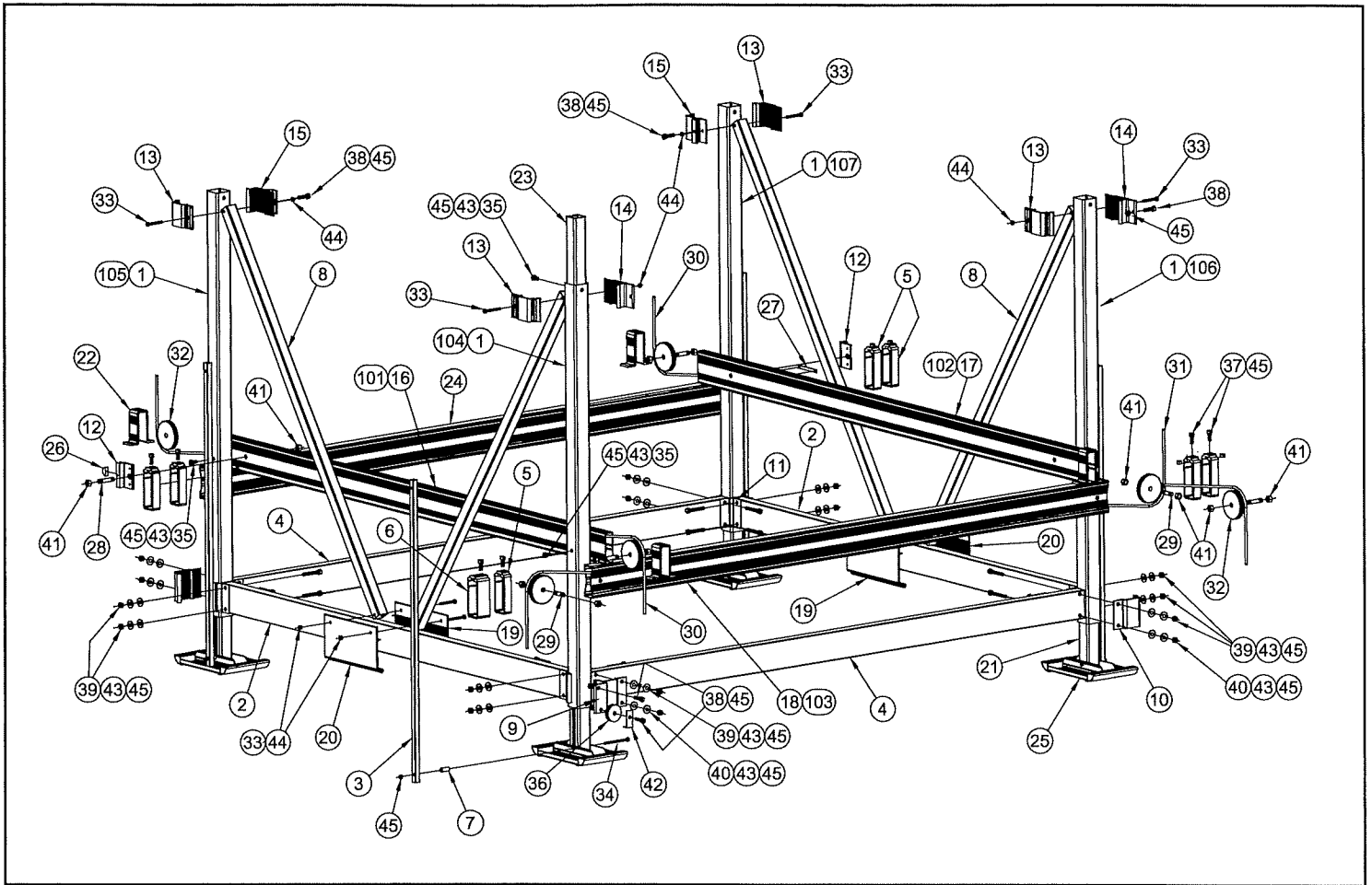

FLOE V-2000 Boat Lift Parts List

NO.	PART NO.	QTY.	DESCRIPTION
1	002-04003-00	4	Corner Post 74" 0.090
2	002-04012-00	2	Side Frame Beam 96" (.100)
3	002-04013-00	4	Lifting Handle (Sand Pad)
4	002-04014-00	2	F/R Frame Beam 108"(.100)
5	002-04015-00	7	Cradle Clamp 1.5"
6	002-04017-00	1	Cradle Lift Clamp 2.5"
7	002-04019-00	4	Lifting Handle Stand Off
8	002-04022-00	4	V-brace 77"
9	002-04085-00	1	Frame Beam Winch Clamp
10	002-04082-00	3	Frame Beam Clamp (Outer)
11	002-04083-00	4	Frame Beam Clamp (Inner)
12	002-04031-00	4	Cradle Guide
13	002-04034-00	4	Upper Clamp 1
14	002-04036-00	2	Upper Clamp 3
15	002-04038-00	2	Upper Clamp 2
16	002-04040-00	1	Side Cradle (Right) 109"
17	002-04042-00	1	Side Cradle (Left) 109"
18	002-04046-00	1	Front Cradle Beam 113" (.090)
19	002-04064-00	2	V-brace Clamp female
20	002-04066-00	2	V- Brace Clamp male
21	002-04067-00	4	Adjustable Leg 54" .100
22	911-00301-00	4	Cradle U-Clamp 2.125"
23	911-04201-00	1	Adjustable Leg 38" (.125)

NO.	PART NO.	QTY.	DESCRIPTION
24	911-07301-00	1	Rear Cradle Beam 113" (.090)
25	111-00000-00	4	Sand Pad
26	006-10202-00	4	Cradle Guide Puck
27	006-11001-00	4	Lexan - 3/16"x1/2"x5" LG
28	007-05600-00	4	5/8 Side Cradle Sheave Pin - 3.20"
29	007-05800-00	2	5/8 End Cradle Sheave Pin - 2.25"
30	007-09000-00	2	Side Leveling Cable - 166.875"
31	007-09500-00	1	Front Leveling Cable - 183"
32	111-00106-00	6	5" Sheave w/Bushing
33	001-70115-00	8	HHCS, 3/8-16x3"SS 18-8
34	001-70224-00	4	HHCS, 1/2-13x3/4" SS 18-8
35	001-70203-00	5	HHCS, 1/2-13x1" SS 18-8
36	007-06201-00	1	3" Clamp Sheave
37	001-70207-00	8	HHCS, 1/2-13 x 1-1/4 ss
38	001-70210-00	5	HHCS, 1/2-13 x 1-3/4 ss
39	001-70216-00	14	HHCS, 1/2-13 x 3-1/4 ss
40	001-70219-00	2	HHCS, 12-13 x 4" ss 18-8
41	001-70816-00	12	Nut, JAM 5/8-11 ss 18-8
42	002-04140-00	1	Cable Holder
43	001-71022-00	37	1/2" Flat Washer USS ss 18-8
44	001-76349-00	8	Nut, 3/8-16 Alum.
45	001-76350-00	37	Nut, 1/2-13 Alum.

FLOE V-3000 Boat Lift Parts List

NO.	PART NO.	QTY.	DESCRIPTION
1	002-04005-00	4	Corner Post 74" 0.090
2	002-04012-00	2	Side Frame Beam 96" (.100)
3	002-04013-00	4	Lifting Handle (Sand Pad)
4	002-04018-00	2	F/R Frame Beam 108" (.125)
5	002-04015-00	7	Cradle Clamp 1.5"
6	002-04017-00	1	Cradle Lift Clamp 2.5"
7	002-04019-00	4	Lifting Handle Stand Off
8	002-04022-00	4	V-brace 77"
9	002-04085-00	1	Frame Beam Winch Clamp
10	002-04082-00	3	Frame Beam Clamp (Outer)
11	002-04083-00	4	Frame Beam Clamp (Inner)
12	002-04031-00	4	Cradle Guide
13	002-04034-00	4	Upper Clamp 1
14	002-04036-00	2	Upper Clamp 3
15	002-04038-00	2	Upper Clamp 2
16	002-04040-00	1	Side Cradle (Right) 109"
17	002-04042-00	1	Side Cradle (Left) 109"
18	002-04046-00	1	Front Cradle Beam 113" (.125)
19	002-04064-00	2	V-brace Clamp female
20	002-04066-00	2	V- Brace Clamp male
21	002-04067-00	4	Adjustable Leg 54" .100
22	911-00301-00	4	Cradle U-Clamp 2.125"
23	911-04201-00	1	Adjustable Leg 38" (.125)

NO.	PART NO.	QTY.	DESCRIPTION
24	911-07401-00	1	Rear Cradle Beam 113" (.125)
25	111-00000-00	4	Sand Pad
26	006-10202-00	4	Cradle Guide Wear Pad
27	006-11001-00	4	Lexan - 3/16"x1/2"x5" LG
28	007-05600-00	4	5/8 Side Cradle Sheave Pin - 3.20"
29	007-05800-00	2	5/8 End Cradle Sheave Pin - 2.25"
30	007-09000-00	2	Side Leveling Cable - 166.875"
31	007-09500-00	1	Front Leveling Cable - 192.5"
32	111-00106-00	6	5" Sheave w/Bushing
33	001-70115-00	8	HHCS, 3/8-16x3"ss 18-8
34	001-70224-00	4	HHCS, 1/2-13x5-1/2" SS 18-8
35	001-70203-00	5	HHCS, 1/2-13x3/4" SS 18-8
36	001-06201-00	1	3" Clamp Sheave
37	001-70207-00	8	HHCS, 1/2-13 x 1-1/4 ss
38	001-70210-00	5	HHCS, 1/2-13 x 1-3/4 ss
39	001-70216-00	14	HHCS 1/2-13 x 3-1/4 ss
40	001-70219-00	2	HHCS 12-13 x 4" SS 18-8
41	001-70816-00	12	Nut, Jam 5/8-11 ss 18-8
42	002-04140-00	1	Cable Holder
43	001-71022-00	37	1/2 Flat Washer USS ss 18-8
44	001-76349-00	8	Nut, 3/8-16 Alum.
45	001-76350-00	37	Nut, 1/2-13 Alum.

WINCH CARE & MAINTENANCE

FLOE lifts come standard with a manual winch, or you can add a DC electric winch. If you have a DC electric winch, make sure the plug is securely turned on to raise or lower the lift cradle. If plug is not turned on, the switch mechanism.



DC Winch



WARNING

If winch wheel starts turning on its own, don't attempt to stop with hands or any object because it can cause serious injury. Simply let the platform spin down into the water.



CAUTION

Always turn lift wheel clockwise when raising the platform so the brake mechanism will hold the platform up and provide a controlled lowering procedure. Always make sure the self-braking mechanism is working. Note: the platform will raise if the wheel is turned counter-clockwise, but it will not lock in position, resulting in an uncontrolled spin-down that can cause serious injury and damage.

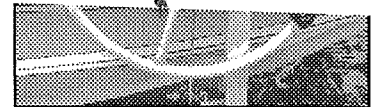

Manual Winch

FLOE V-4000/V-5000 Boat Lift

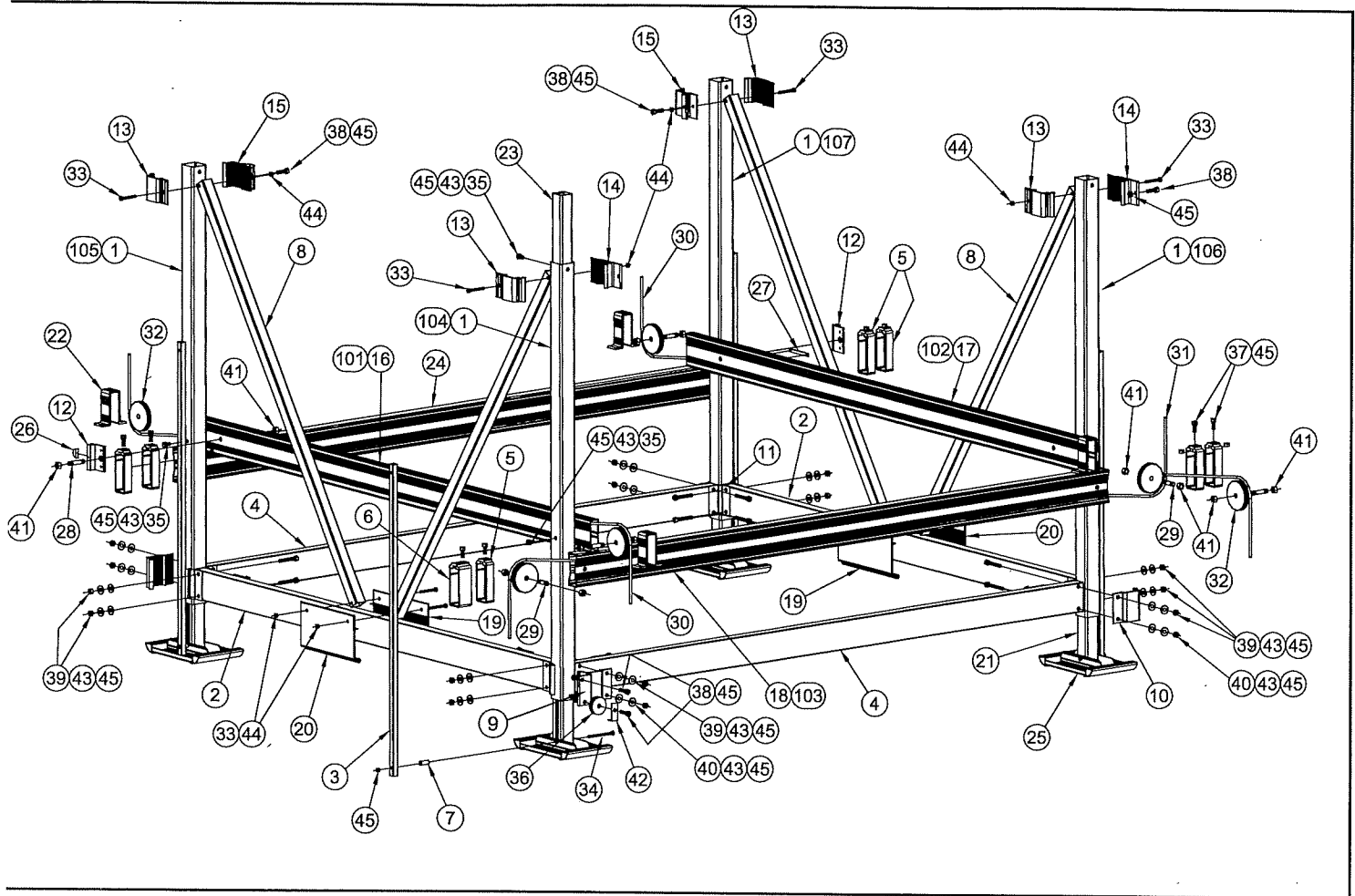

FLOE V-4000 Boat Lift Parts List

NO.	PART NO.	QTY.	DESCRIPTION
1	002-04007-00	4	Corner Post 74" (.187)
2	002-04016-00	2	Side Frame Beam 96" (.125)
3	002-04013-00	4	Lifting Handle (Sand Pad)
4	002-04020-00	2	F/R Frame Beam 116" (.125)
5	002-04015-00	7	Cradle Clamp 1.5"
6	002-04017-00	1	Cradle Lift Clamp 2.5"
7	002-04019-00	4	Lifting Handle Stand Off
- 8	002-04022-00	4	V-brace 77"
9	002-04085-00	1	Frame Beam Winch Clamp
10	002-04082-00	3	Frame Beam Clamp (Outer)
11	002-04083-00	4	Frame Beam Clamp (Inner)
12	002-04031-00	4	Cradle Guide
13	002-04034-00	4	Upper Clamp 1
14	002-04036-00	2	Upper Clamp 3
15	002-04038-00	2	Upper Clamp 2
16	002-04040-00	1	Side Cradle (Right) 109"
17	002-04042-00	1	Side Cradle (Left) 109"
18	002-04050-00	1	Front Cradle Beam 121" (.188)
19	002-04064-00	2	V-brace Clamp female
20	002-04066-00	2	V-Brace Clamp male
21	002-04069-00	4	Adjustable Leg 58" .125
22	911-00301-00	4	Cradle U-Clamp 2.125"
23	911-04201-00	1	Adjustable Leg 38" (.125)

NO.	PART NO.	QTY.	DESCRIPTION
24	911-07501-00	1	Rear Cradle Beam 121" (.188)
25	111-00000-00	4	Sand Pad
26	006-10202-00	4	Cradle Guide Wear Pad
27	006-11001-00	4	Lexan - 3/16"x1/2"x5" LG
28	007-05600-00	4	5/8 Side Cradle Sheave Pin - 3.20"
29	007-05800-00	2	5/8 End Cradle Sheave Pin - 2.25
30	007-09000-00	2	Side Leveling Cable - 166.875"
31	007-09300-00	1	Front Leveling Cable - 200.5"
32	111-00107-00	6	5" Sheave w/Bushing
33	001-70115-00	8	HHCS, 3/8-16x3"SS 18-8
34	001-70224-00	4	HHCS, 1/2-13x5-1/2" ss 18-8
35	001-70205-00	5	HHCS, 1/2-13x1" ss 18-8
36	001-06201-00	1	3" Clamp Sheave
37	001-70207-00	8	HHCS, 1/2-13 x 1-1/4 ss
38	001-70210-00	5	HHCS, 1/2-13 x 1-3/4 ss
39	001-70216-00	14	HHCS 1/2-13 x 3-1/4 ss
40	001-70219-00	2	HHCS 12-13 x 4" ss 18-8
41	001-70816-00	12	Nut, JAM 5/8-11 ss18-8
42	002-04140-00	1	Cable Holder
43	001-71022-00	42	1/2" Flat Washer USS ss 18-8
44	001-76349-00	8	Nut, 3/8-16 Alum.
45	001-76350-00	37	Nut, 1/2-13 Alum.

FLOE V-5000 Boat Lift Parts List

<u>NO.</u>	<u>PART NO.</u>	<u>QTY.</u>	<u>DESCRIPTION</u>	<u>NO.</u>	<u>PART NO.</u>	<u>QTY.</u>	<u>DESCRIPTION</u>
1	002-04009-00	4	Corner Post 74" (.219)	24	911-07501-00	1	Rear Cradle Beam 121" (.188)
2	002-04016-00	2	Side Frame Beam 96" (.125)	25	111-00000-00	4	Sand Pad
3	002-04013-00	4	Lifting Handle (Sand Pad)	26	006-10202-00	4	Cradle Guide Wear Pad
4	002-04021-00	2	F/R Frame Beam 116"(.125)	27	006-11001-00	4	Lexan - 3/16"x1/2"x5" LG
5	002-04015-00	7	Cradle Clamp 1.5"	28	007-05600-00	4	5/8 Side Cradle Sheave Pin - 3.20"
6	002-04017-00	1	Cradle Lift Clamp 2.5"	29	007-05800-00	2	5/8 End Cradle Sheave Pin - 2.25
7	002-04019-00	4	Lifting Handle Stand Off	30	007-09000-00	2	Side Leveling Cable - 166.875"
8	002-04022-00	4	V-brace 77"	31	007-09300-00	1	Front Leveling Cable - 200.5"
9	002-04085-00	1	Frame Beam Winch Clamp	32	111-00107-00	6	5" Sheave w/Bushing
10	002-04082-00	3	Frame Beam Clamp (Outer)	33	001-70115-00	8	HHCS, 3/8-16x3" ss 18-8
11	002-04083-00	4	Frame Beam Clamp (Inner)	34	001-70224-00	4	HHCS, 1/2-13x5-1/2" ss 18-8
12	002-04031-00	4	Cradle Guide	35	001-70205-00	5	HHCS, 1/2-13x1" ss 18-8
13	002-04034-00	4	Upper Clamp 1	36	007-06201-00	1	3" Clamp Sheave
14	002-04036-00	2	Upper Clamp 3	37	001-70207-00	8	HHCS, 1/2-13 x 1-1/4 ss
15	002-04038-00	2	Upper Clamp 2	38	001-70210-00	5	HHCS, 1/2-13 x 1-3/4 ss
16	002-04040-00	1	Side Cradle (Right) 109"	39	001-70216-00	14	HHCS 1/2-13 x 3-1/4 ss
17	002-04042-00	1	Side Cradle (Left) 109"	40	001-70219-00	2	HHCS 12-13 x 4" ss 18-8
18	002-04050-00	1	Front Cradle Beam 121" (.188)	41	001-70816-00	12	Nut, JAM 5/8-11 ss 18-8
19	002-04064-00	2	V-brace Clamp female	42	002-04140-00	1	Cable Holder
20	002-04066-00	2	V- Brace Clamp male	43	001-71022-00	42	1/2" Flat Washer USS ss 18-8
21	002-04069-00	4	Adjustable Leg 58" (.125)	44	001-76349-00	8	Nut, 3/8-16 Alum.
22	911-00301-00	4	Cradle U-Clamp (.125)	45	001-76350-00	37	Nut, 1/2-13 Alum.
23	911-04201-00	1	Adjustable Leg 38" (.125)				

FLOE H-4000/H-5000 Boat Lifts

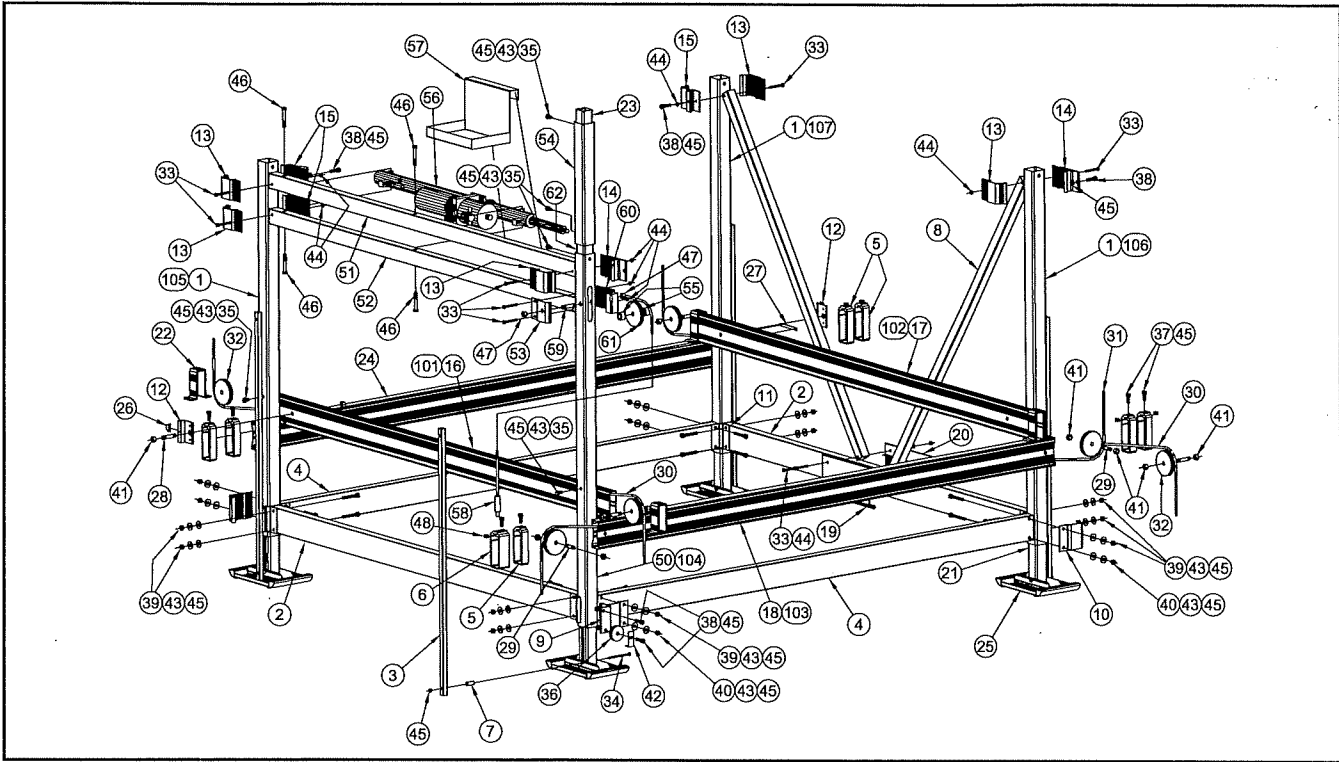

Parts List for FLOE H-4000 Boat Lift

NO.	PART NO.	QTY.	DESCRIPTION	NO.	PART NO.	QTY.	DESCRIPTION
1	002-04007-00	3	Corner Post 74" (.187)	32	111-00106-00	6	5" Sheave w/Bushing
2	002-04016-00	2	Side Frame Beam 96" (.125)	33	001-70115-00	9	HHCS, 3/8-16 x 3" ss 18-8
3	002-04013-00	4	Lifting Handle (Sand Pad)	34	001-70224-00	4	HHCS, 1/2-13x5-1/2" ss 18-8
4	002-04020-00	2	F/R Frame Beam 116" (.125)	35	001-70205-00	7	HHCS, 1/2-13x1" ss 18-8
5	002-04015-00	7	Cradle Clamp 1.5"	36	001-06201-00	1	3" Clamp Sheave
6	002-04017-00	1	Cradle Lift Clamp 2.5"	37	001-70207-00	8	HCS 1/2-13 x 1-1/4" ss 18-8
7	002-04019-00	4	Lifting Handle Stand Off	38	001-70210-00	5	HCS 1/2-13 x 1-3/4" ss 18-8
8	002-04022-00	2	V-Brace 77"	39	001-70216-00	14	HCS 1/2-13 x 3-1/4" ss 18-8
9	002-04085-00	1	Frame Beam Winch Clamp	40	001-70219-00	2	HCS 1/2-13 x 4" ss 18-8
10	002-04082-00	3	Frame Beam Clamp (Outer)	41	001-70816-00	12	Nut, Jam 5/8-11 ss 18-8
11	002-04083-00	4	Frame Beam Clamp (Inner)	42	002-04140-00	1	Cable Holder
12	002-04031-00	4	Cradle Guide	43	001-71022-00	46	1/2" Flat Washer USS ss 18-8
13	002-04034-00	5	Upper Clamp 1	44	001-76349-00	9	Nut, 3/8-16 Alum.
14	002-04036-00	2	Upper Clamp 3	45	001-76350-00	40	Nut, 1/2-13 Alum.
15	002-04038-00	3	Upper Clamp 2	46	001-70317-00	4	HCS 5/8-11 x 3-1/2 ss
16	002-04040-00	1	Side Cradle (Right) 109"	47	001-70717-00	2	Nut, 3/4-10 FHN ss 18-8
17	002-04042-00	1	Side Cradle (Left) 109"	48	001-70734-00	1	Nut, 1/2-20 ss 18-8
18	002-04050-00	1	Front Cradle Beam 121" (.188)	49	001-70837-00	1	Nut, 3/4-16 ss 18-8
19	002-04064-00	1	V-Brace Clamp (female)	50	002-04011-00	1	Corner Post 74" (.187)
20	002-04066-00	1	V-Brace Clamp (male)	51	002-04024-00	1	Hydraulic Support (upper)
21	002-04069-00	4	Adjustable Leg 58" (.125)	52	002-04025-00	1	Hydraulic Support (lower)
22	911-00301-00	4	Cradle U-Clamp 2.125"	53	002-04037-00	1	6" Pulley Clamp
23	911-04206-00	1	Adjustable Leg 38" (.125)	54	002-04075-00	1	Hydraulic Canopy Splice
24	911-07501-00	1	Rear Cradle Beam 121" (.188)	55	006-10205-00	2	Hydraulic Sheave Spacer
25	111-00000-00	4	Sand Pad	56	007-04000-00	1	Hydraulic Pump/Cylinder Kit
26	006-10202-00	4	Cradle Guide Wear Pad	57	007-04144-00	1	Battery Tray
27	006-11001-00	4	Lexan - 3/16"x1/2"x5" LG	58	007-04146-00	1	Hydraulic Lifting Cable
28	007-05600-00	4	5/8 Side Cradle Sheave Pin-3.20"	59	007-04154-00	1	3/4" Sheave Pin
29	007-05800-00	2	5/8 End Cradle Sheave Pin-2.25"	60	111-00011-00	1	6" Pulley Clamp Weldment
30	007-09000-00	2	Side Leveling Cable - 166.875"	61	111-00108-00	1	6" Hydraulic Sheave Assbly.
31	007-09300-00	1	Front Leveling Cable - 200.5"	62	911-04207-00	1	Adjustable Leg - 7" (.125)

Parts List for FLOE H-5000 Boat Lift

NO.	PART NO.	QTY.	DESCRIPTION
1	002-04009-00	3	Corner Post 74" (.219)
2	002-04016-00	2	Side Frame Beam 96" (.125)
3	002-04013-00	4	Lifting Handle (Sand Pad)
4	002-04021-00	2	F/R Frame Beam 116" (.125)
5	002-04015-00	7	Cradle Clamp 1.5"
6	002-04017-00	1	Cradle Lift Clamp 2.5"
7	002-04019-00	4	Lifting Handle Stand Off
8	002-04022-00	2	V-Brace 77"
9	002-04085-00	1	Frame Beam Winch Clamp
10	002-04082-00	3	Frame Clamp (Outer)
11	002-04083-00	4	Frame Clamp (Inner)
12	002-04031-00	4	Cradle Guide
13	002-04034-00	5	Upper Clamp 1
14	002-04036-00	2	Upper Clamp 3
15	002-04038-00	3	Upper Clamp 2
16	002-04040-00	1	Side Cradle (Right) 109"
17	002-04042-00	1	Side Cradle (Left) 109"
18	002-04050-00	1	Front Cradle Beam 121" (.188)
19	002-04064-00	1	V-Brace Clamp (female)
20	002-04066-00	1	V-Brace Clamp (male)
21	002-04069-00	4	Adjustable Leg 58" (.125)
22	911-00301-00	4	Cradle U-Clamp 2.125"
23	911-04206-00	1	Adjustable Leg 19" (.125)
24	911-07501-00	1	Rear Cradle Beam 121" (.188)
25	111-00000-00	4	Sand Pad
26	006-10202-00	4	Cradle Guide Wear Pad
27	006-11001-00	4	Lexan - 3/16"x1/2"x5" LG
28	007-05600-00	4	5/8 Side Cradle Sheave Pin - 3.20"
29	007-05800-00	2	5/8 Side Cradle Sheave Pin - 2.25"
30	007-09000-00	2	Side Leveling Cable - 166.875
31	007-09300-00	1	Front Leveling Cable - 200.5"

NO.	PART NO.	QTY.	DESCRIPTION
32	111-00106-00	6	5" Sheave w/Bushing
33	001-70115-00	9	HHCS 3/8-16 x 3" ss 18-8
34	001-70224-00	4	HHCS 1/2-13x5-1/2" ss 18-
35	001-70205-00	7	HHCS, 1/2-13x1"ss 18-8
36	007-06201-00	1	3" Clamp Sheave
37	001-70207-00	8	HHCS 1/2-13 x 1-1/4" ss 18-
38	001-70210-00	3	HHCS 1/2-13 x 1-3/4" ss 18-
39	001-70216-00	14	HHCS 1/2-13 x 3-1/4" ss 18-
40	001-70219-00	2	HHCS 1/2-13 x 4" ss 18-8
41	001-70816-00	12	Nut, Jam 5/8-11 ss 18-8
42	002-04140-00	1	Cable Holder
43	001-71022-00	46	1/2" Flat Washer USS ss 18-8
44	001-76349-00	9	Nut, 3/8-16 Alum.
45	001-76350-00	40	Nut, 1/2-13 Alum.
46	001-70317-00	4	HHCS 5/8-11 x 3-1/2" ss
47	001-70717-00	2	Nut, 3/4-10 FHN ss 18-8
48	001-70734-00	1	Nut, 1/2-20 ss 18-8
49	001-70837-00	1	Nut, 3/4-16 ss 18-8
50	002-04011-00	1	Corner Post 74" (.187)
51	002-04024-00	1	Hydraulic Support (upper)
52	002-04025-00	1	Hydraulic Support (lower)
53	002-04037-00	1	6" Pulley Clamp
54	002-04075-00	1	Hydraulic Canopy Splice
55	006-10205-00	2	Hydraulic Sheave Spacer
56	007-04000-00	1	Hydraulic Pump/Cylinder Kit
57	007-04144-00	1	Battery Tray
58	007-04146-00	1	Hydraulic Lifting Cable
59	007-04154-00	1	3/4" Sheave Pin
60	111-00011-00	6"	6" Pulley Weldment
61	111-00108-00	1	6" Hydraulic Sheave Assbly.
62	911-04207-00	1	Adjustable Leg - 7" (.125)

HYDRAULICS CARE & MAINTENANCE

FLOE hydraulic lifts have gone through years of research and development to provide quiet, smoother, faster lifting, and remote operation. To ensure your hydraulic lift will always operate at peak performance, remember:

1. When installing lift into water you will always want the hydraulic unit on the opposite side of the dock. This allows you to enter and exit the boat through the side V-braces.
2. If you are using an externally mounted battery, be sure to strap the box to the tray. Tighten all battery connections thoroughly. A deep cycle marine battery with over 800 amps is required to operate lift.
3. Your FLOE hydraulic lift has a relief down valve that should be used only in emergencies.
4. Periodically check: 1) vent cap on reservoir for possible blockage, 2) the canister of hydraulic oil - it needs to be half full.
5. When storing lift in the off-season, the hydraulic ram must be retracted to prevent rust and the lift cradle raised to its highest position. Battery should be removed and properly stored.



WARNING

WARNING: Inspect all battery connections. Loose wire may cause damage or fire.

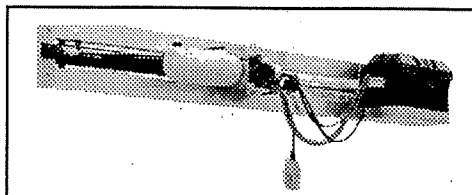

FLOE V-2002 Boat Lift

FLOE VP-3000 Boat Lift

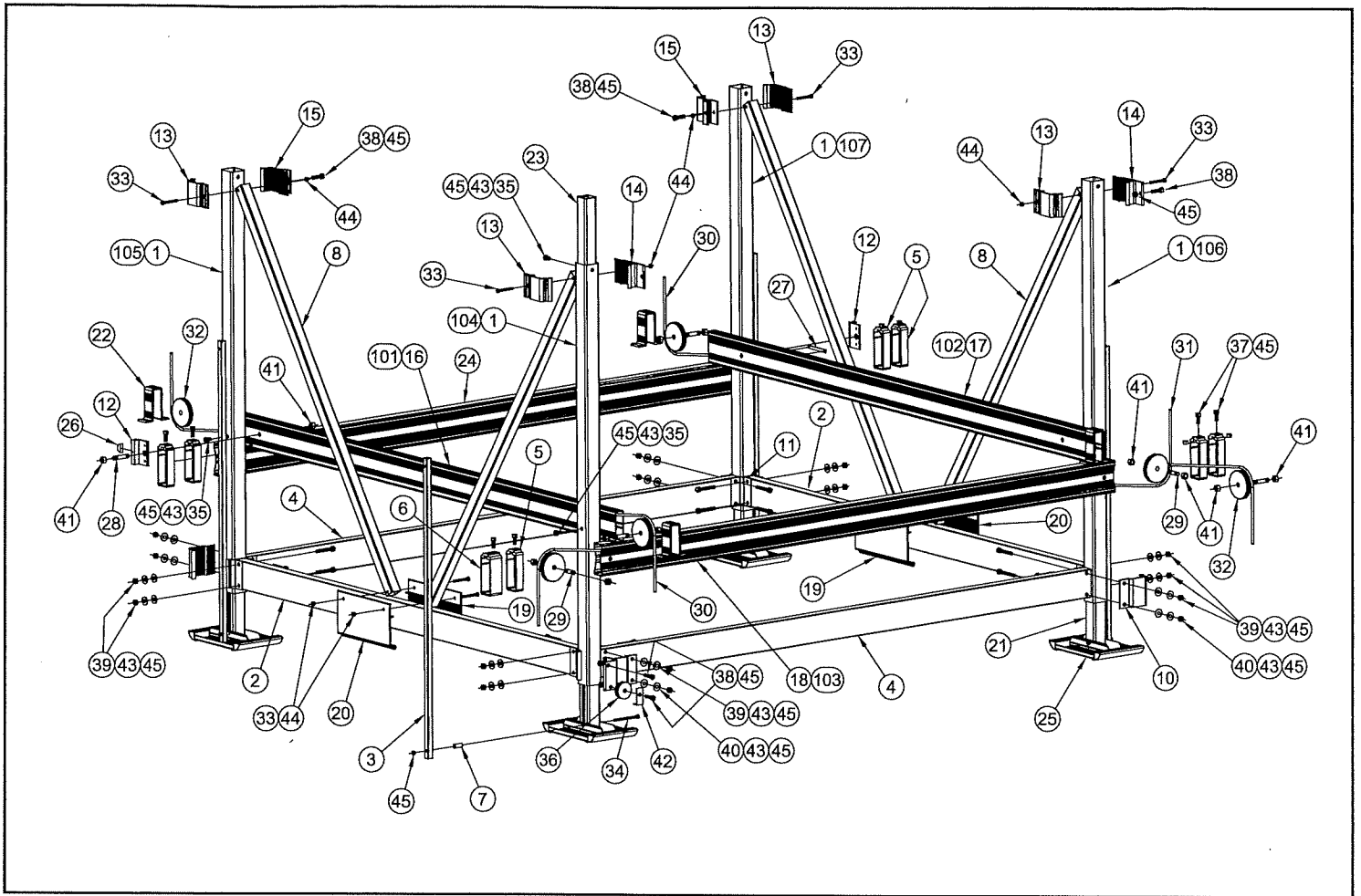

FLOE VP-3000 Boat Lift Parts List

NO.	PART NO.	QTY.	DESCRIPTION
1	002-04005-00	4	Corner Post 74" (.125)
2	002-04012-00	2	Side Frame Beam 96" (.100)
3	002-04013-00	4	Lifting Handle (Sand Pad)
4	002-04074-00	2	F/R Frame Beam 116"(.100)
5	002-04015-00	7	Cradle Clamp 1.5"
6	002-04017-00	1	Cradle Lift Clamp 2.5"
7	002-04019-00	4	Lifting Handle Stand Off
8	002-04022-00	4	V-brace 77"
9	002-04085-00	1	Frame Beam Winch Clamp
10	002-04082-00	3	Frame Beam Clamp (Outer)
11	002-04083-00	4	Frame Beam Clamp (Inner)
12	002-04031-00	4	Cradle Guide
13	002-04034-00	4	Upper Clamp 1
14	002-04036-00	2	Upper Clamp 3
15	002-04038-00	2	Upper Clamp 2
16	002-04040-00	1	Side Cradle (Right) 109"
17	002-04042-00	1	Side Cradle (Left) 109"
18	002-04043-00	1	Front Cradle Beam 121" (.125)
19	002-04064-00	2	V-brace Clamp female
20	002-04066-00	2	V- Brace Clamp male
21	002-04067-00	4	Adjustable Leg 54" (.100)
22	911-00301-00	4	Cradle U-Clamp 2.125"
23	911-04201-00	1	Adjustable Leg 38" (.125)

NO.	PART NO.	QTY.	DESCRIPTION
24	911-07303-00	1	Rear Cradle Beam 121" (.090)
25	111-00000-00	4	Sand Pad
26	006-10202-00	4	Cradle Guide Wear Pad
27	006-11001-00	4	Lexan - 3/16"x1/2"x5" LG
28	007-05600-00	4	5/8 Side Cradle Sheave Pin - 3.20"
29	007-05800-00	2	5/8 End Cradle Sheave Pin - 2.25
30	007-09000-00	2	Side Leveling Cable - 166.875
31	007-09300-00	1	Front Leveling Cable - 200.5"
32	111-00106-00	6	5" Sheave w/Bushing
33	001-70115-00	8	HHCS, 3/8-16x3"SS 18-8
34	001-70224-00	4	HHCS, 1/2-13x5-1/2" ss 18-8
35	001-70203-00	5	HHCS, 1/2-13x3/4" ss 18-8
36	001-06201-00	1	3" Clamp Sheave
37	001-70207-00	8	HHCS, 1/2-13 x 1-1/4 ss
38	001-70210-00	5	HHCS, 1/2-13 x 1-3/4 ss
39	001-70216-00	14	HHCS 1/2-13 x 3-1/4 ss
40	001-70219-00	2	HHCS 12-13 x 4" ss 18-8
41	001-70816-00	12	Nut, JAM 5/8-11 ss18-8
42	002-04140-00	1	Cable Holder
43	001-71022-00	42	1/2" Flat Washer USS ss 18-8
44	001-76349-00	8	Nut, 3/8-16 Alum.
45	001-76350-00	37	Nut, 1/2-13 Alum.

OPTIONAL BOAT LIFT ACCESSORIES

Boat Lift Wheel Kits

Wheel Kits attach to the main side frame of lift so you can easily roll the lift into the water and position right where you want it.

Note: You can leave Wheel Kits on the dock after it is installed if the leveling legs on the lift extend far enough to raise wheels off the lake bottom. If the wheels touch the bottom after the legs are fully extended, you must remove the Wheel Kits before using the lift.

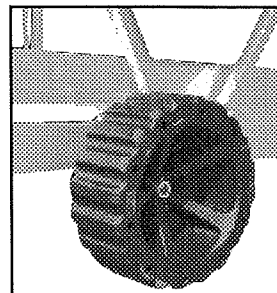

Float & Roll System

Float-n-Roll System lets you easily move your lift into and out of the water. Once afloat, you can maneuver the lift into the right position, or you can even tow it to another location.

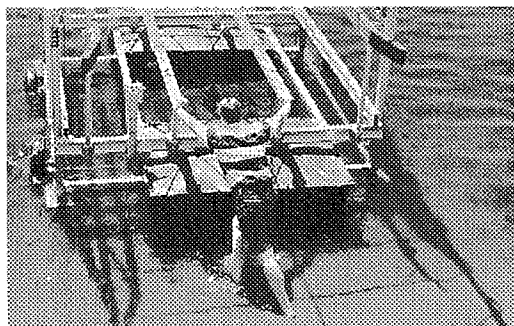

1. Roll your lift into the water until it floats

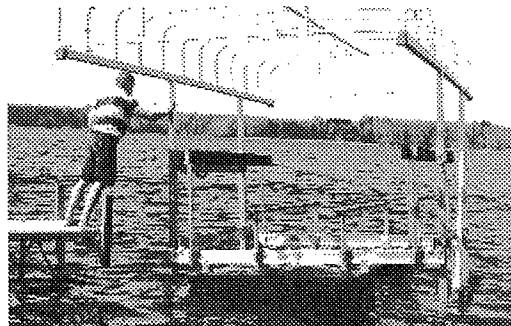

2. Float your lift into the right position

Detailed Float & Roll Operating Instruction

STEP ONE

Position the floating transponder at the entrance of your FLOE Lift system. Face transporter so that the attached tow cable is in the direction in which the lift will be pulled.

Note: If your lift is on a trailer and being installed for the first time, have the lift positioned so you can back your trailer into the water and roll the lift off until it floats.

STEP TWO

Raise the lift bed to its maximum height and position the transporter within the lift. Typically, the side of your lift that has either a winch or a hydraulic system is heavier. To Compensate: If you have a lift with a winch, simply slide the Float & Roll transporter off center towards the heavy side approximately six inches. If you have a hydraulic lift, position the transporter tight to the heavy side. Doing this will keep the the lift as level as possible while you float it into position.

Note: If you have a hydraulic lift and need additional bed height to fit the floating transporter bet between the top and bottom beams, either manually lift the bed u p higher or use th transporters winch system as in figure 2. To raise it higher, you may also need to do this when removing the transport system once the lift is installed.

STEP THREE

Lower the lifting bed down onto the aluminum framework of the transporter unit.

Important!

- If you have a winch model lift, release all but one wrap of the cable from the lift winch drum before proceeding to step 4.
- If you have a hydraulic power lift, extend the hydraulic cylinder to its maximum length before proceeding to step 4.

STEP 4

A. Install the transporter winch system as in Figure 4. Do so by positioning the winch in the center of the lift beam that is opposite the beam that has the main lifting cable attached. Install bolt and nut finger tight. When installed properly, the winch drum will face into the center of the lift.

B. Crank winch counter-clockwise while pulling on the cable. Let out enough cable so the hook located on the bottom of the hook handle reaches underneath the lower frame beam. When properly attached, the curved handle will point toward the center of the lift.

C. Crank the winch clockwise until the upper lift beam is pulled down to sandwich the transporter aluminum frame rail between the lift system upper and lower beams. Doing this cause the lift to be raised onto the wheels of the transporter as long as the leveling legs are in the retracted position.

STEP 5

Your lift system should now be ready to roll into the water, or if you are moving your system, it should be floating, provided the water is deep enough.

STEP 6

A. Once you've moved your lift to its proper location, crank the transporter winch counter-clockwise to lower your lift onto its leveling pads.

B. Check the lift system to make sure its level and within two-inches corner to corner. If out of level, float the lift back up by cranking the transporter winch system clockwise. Adjust leveling pads accordingly.

STEP 7

A. Once you are done leveling your lift, completely disconnect and remove the transporter winch system.

B. Using the boat lift winch or hydraulic system, raise the lifting platform high enough to float the transporter out of the lift.

Note: If your lift is a hydraulic model and you need additional height to remove the transporter.

LIFT REMOVAL

To remove the lift, repeat the previous steps. While the lift is floating, retract the leveling legs

Note: For ease of leveling the following year, you should mark the height of each leveling leg prior to raising them up for transporting purposes.

WARNING

You must ensure the hook is properly positioned tight to the beam before tightening the winch cable.

WARNING

Never attempt to raise the lift platform while the transporter winch is installed. Doing so may cause serious damage to the lift, personal injury, or death.

CAUTION

When adjusting leveling pads, do not loosen the adjustment bolt more than two turns or it may become disengaged from the non-accessible internal nut.

WARNING

Extending the hydraulic cylinder may cause the lifting cable (located at the end of the hydraulic cylinder) to slip out of the upper pulley. It is important that this lifting cable is positioned within the pulley before raising the platform again.

Using Your FLOE Boat Lift System

1. Do not overload the recommended weight capacity of the lift. Doing so may cause body or property damage and will void any warranty. When figuring total boat weight, be sure to include fuel, batteries, anchors, and all other boating accessories.
2. Be sure the boat is positioned so the weight is equally dispersed on the entire cradle assembly. You may have to drive the boat further onto the lift to achieve a good balance.
3. Lower the boat into the water prior to boarding to avoid overloading the lift.
4. Exit the boat prior to raising it out of the water.
5. Make sure your boat is positioned on the lift so the weight is evenly distributed.
6. As a general rule, you should not use more than 80 percent of the total capacity of your boat lift (ie. total weight of the boat, motor, and accessories for a 4,000 lb. boat lift should not exceed 3,200 lbs.) If your lift has a 4,000 lb. rating, that means the front beam can lift 2,000 lbs. and the back beam can lift 2,000 lbs. Most boats have more than half their weight in the back portion, and the rear weight would exceed 2,000 lbs.
7. Note all decal warnings on your lift system and follow their directions carefully.
8. Inspect cables and bolts. Make sure all are intact and tight, and cables are not frayed.



WARNING

Never operate this lift with anyone in or around the lift (outside the operator). Never allow anyone in, around, under or near lift when in its upright position.



CAUTION

Pull your drain plug when not using the boat. Additional water may cause over weight and collapse the lift. This will void any warranty.

CANOPY MAINTENANCE & CARE

FLOE extra-deep canopy systems are designed to keep major rain accumulation out and damaging sun rays off your valuable watercraft. To assure your canopy functions properly, remember to:

1. Adjust your canopy so it provides complete coverage for your boat. FLOE canopies can be easily fitted to most boats because they adjust infinitely both vertically and horizontally.
2. Put your boat on the lift and get inside when you install the canopy to help you reach and attach the Velcro® ties to the framework.
3. Store your canopy in the bag provided for winter storage. Make sure the canopy is dry and brushed clean before putting it away. Put the bagged canopy in a safe place where it won't be damaged by other objects or rodents.
4. Heavy snow and ice build up can collapse the framework assembly. Failure to remove the canopy will void the warranty.



CAUTION

When pulling under canopy and raising boat, remove running lights, antennas and other objects that may hit the canopy.

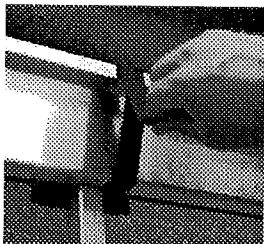

5. Some precipitation and condensation can seep through the canopy fabric. To minimize, apply a standard tent seam sealer on appropriate spots.

Note: When installing the canopy fabric, secure the lower Velcro® ties around the main frame rails, not the canopy hoops.

Installation and Removal of Your FLOE Boat Lift System

1. Prior to installing your lift into the water (whether for the first time or just for the season) Double check to make sure all bolts and nuts are tight. Also check the cables to make sure that they are on the pulleys and there is no visible wear.
 3. The boat lift should be approximately 6" from the dock. This will allow the cradle guides to travel past the dock without any interference.
 4. Prior to leveling the lift you must first decide what depth your lift should be. Rule of thumb is, set the cradle in the middle of its travel (approximately 24" up from the bottom and 24" from the "Stop here" sticker). Now raise the entire lift until the cradle is just above where the water will be at its highest for the entire season. This will allow your boat to be raised up high enough to be covered by the canopy and lowered enough when water levels reside. Now you may proceed with the leveling instructions called out in step #5.
 5. Leveling the lift: Raise the cradle to just above the water and use the cradle as a level reference. Now adjust the leveling legs until the cradle is equal distance to the water in all 4 corners. Note: The leveling legs are adjusted by loosening and tightening the adjustment bolts located on the outside of each corner post. You will need a 3/4" wrench or socket.
 6. If you are using adjustable cradle pads, bolt the cradle pads onto the lift according to the instructions included with the pads. Leaving the pads loose float the boat onto the cradle. Slide the bow pads up to the hull. Adjust for the correct angle and height. (Be sure to keep the pads centered so the boat will always stay in the middle of the lift.) To adjust the stern (rear) cradle pads, position each pad approximately half way between the middle and outside of the boat. Adjust pad height so that once the lift cradle is raised out of the water the majority of weight will rest on the pads. Note: The rear pads can be mounted perpendicular or parallel to the boat.
 8. Check the fluid level in the reservoir tank. It should be approximately 1/2 full.
 9. Without the boat, cycle the cradle up and down to make sure there is no resistance or obstructions.
- Note: The lift must be level prior before lifting boat. Use a level as you make final adjustments. A lift not level can damage the boat and the lift, and will void the warranty.



WARNING

Never make adjustments with boat on lift.

**FLOE INTERNATIONAL, INC.
CARPETED DOCK SECTIONS
10 YEAR LIMITED WARRANTY**

FLOE INTERNATIONAL warrants, to the original purchaser, FLOE carpeted dock systems to be free from original defects in materials and workmanship under the conditions and loads for which designed and from date of purchase as follows:

Aluminum Structure: See 15 Year Limited Warranty for Aluminum Structure.

Carpeted Deck: Floe will repair or replace, at their option, any portion of the carpeted deck which fails as a result of a defect in materials or workmanship during the first year after purchase at no charge to the customer. Thereafter, FLOE International, Inc. will repair or replace any portion of the carpeted deck which fails as a result of a defect in materials or workmanship at a cost to the purchaser of a portion of the existing manufacturer's carpet re-decking retail price as follows:

YEAR AFTER PURCHASE	% TO YOU OF CURRENT RETAIL PRICE
2	20%
3	30%
4	40%
5	50%
6	60%
7	70%
8	80%
9	90%
10	100%

This warranty covers only the cost for replacement of materials due to defects in materials or workmanship, and represents the only warranty authorized by us. In order to receive performance under this warranty, all warranty repairs must be authorized in advance by FLOE International, Inc.

FLOE International, Inc. will not be responsible for any costs incurred for unauthorized repairs. Unauthorized repairs may void the warranty on items repaired. Warranty repairs are subject to a \$20.00 customer (consumer) co-payment. This warranty does not cover any possible damages due to overloading of dock, nor damage resulting from misuse, storm or ice damage, being struck by any type of watercraft, or negligence. This warranty covers personal use and does not apply to commercial or rental use. The manufacturer is not responsible for damage where repairs have been made or attempted by others. FLOE International, Inc. reserves the right to inspect and perform repairs at its main facility (F.O.B.) McGregor, Minnesota. This warranty does not cover freight charges. Specifications may change without notice or obligation. To receive performance under this warranty, contact your authorized FLOE dealer.

There are no other expressed or implied warranties.

Our obligations under this warranty are limited to repair or replacement at our discretion, and we shall not be liable for incidental or consequential damages of any kind.

This warranty gives you specific legal rights and you may have other rights which vary from state to state.

FLOE INTERNATIONAL, INC.

15 YEAR LIMITED WARRANTY

FLOE INTERNATIONAL, INC. warrants, to the original purchaser, the FLOE dock or boat lift system to be free from original defects in materials and workmanship under conditions and loads for which designed, and from date of purchase as follows:

ALUMINUM STRUCTURE

FLOE INTERNATIONAL, INC. will repair or replace, at their option, any portion of the aluminum structure which fails as a result of a defect in material or workmanship during the first year after purchase.

Thereafter, **FLOE INTERNATIONAL, INC.** will repair or replace any portion of the aluminum structure which fails as a result of a defect on materials or workmanship at a cost to the purchaser of a proportion of the existing manufacturer's suggested retail price as follows:

YEAR AFTER PURCHASE	% TO YOU OF CURRENT RETAIL PRICE
2	30%
3	35%
4	40%
5	45%
6	50%
7	55%
8	60%
9	65%
10	70%
11	75%
12	75%
13	75%
14	80%
15	85%

Note: ALL DECKING, CARPETING, TIRES, CABLE, CANOPY FABRIC,
MANUAL WINCHES & ELECTRIC WINCHES CARRY A ONE YEAR WARRANTY

This warranty covers only the cost for replacement of materials due to defects in materials or workmanship, and represents the only warranty authorized by us. In order to receive performance under this warranty, all warranty repairs must be authorized in advance by **FLOE INTERNATIONAL, INC.**

FLOE INTERNATIONAL, INC. will not be responsible for any costs incurred for unauthorized repairs. Unauthorized repairs may void the warranty on items repaired. Warranty repairs are subject to a \$20.00 customer (consumer) co-payment. This warranty does not cover deck replacement labor, nor any possible damages due to overloading of dock or boat lift, nor damage resulting from misuse, storm or ice damage, being struck by any type watercraft, or negligence. This warranty covers personal use and does not apply to commercial or rental use. The manufacturer is not responsible for damage where repairs have been made or attempted by others. Items purchased by **FLOE INTERNATIONAL, INC.** are warranted by the original manufacturer and warranty is extended to the original purchaser. **FLOE INTERNATIONAL, INC.** reserves the right to inspect and perform repairs at its main facility (F.O.B.) McGregor, Minnesota. Specifications may change without notice or obligation. To receive performance under this warranty, contact your authorized **FLOE** dealer.

THERE ARE NO OTHER EXPRESSED OR IMPLIED WARRANTIES.

Our obligations under this warranty are limited to repair or replacement at our discretion, and **WE SHALL NOT BE LIABLE FOR INCIDENTAL OR CONSEQUENTIAL DAMAGES OF ANY KIND.**

This warranty gives you specific legal rights and you may have other rights which vary from state to state.

FLOE ALSO MAKES QUALITY ALUMINUM DOCK SYSTEMS AND RECREATIONAL/UTILITY TRAILERS

FLOE TRAILERS

From hauling firewood and leaves to trailering your ATV and snowmobile, FLOE offers a high-quality aluminum trailers that will fit your needs perfectly. FLOE enclosed trailers protect your valuable snowmobiles, cycles, and ATVs and keep them free from road grime. Versa-Max ramp and tilt trailers are the ultimate in easy loading and unloading tracked and wheeled recreation vehicles. FLOE's Versa-Tility Pro is the first true multi-use trailer that works equally well for hauling cargo and recreation vehicles.

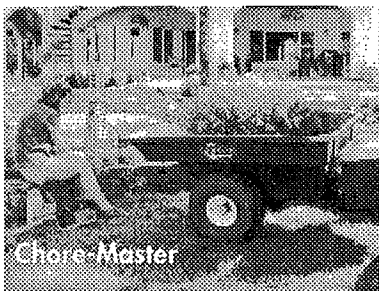

Chore-Master

The Chore-Master is the perfect work trailer and the All-Terrain Pro is designed for hauling single ATVs and snowmobiles. Whatever your needs, FLOE makes a trailer and a complete line of accessories to make your trailering easy and trouble-free.

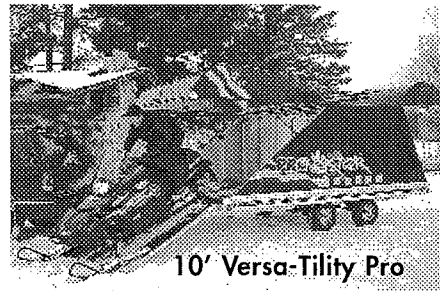

10' Versa-Tility Pro



10' Versa-Tility Pro

FLOE MODULAR DOCK SYSTEMS

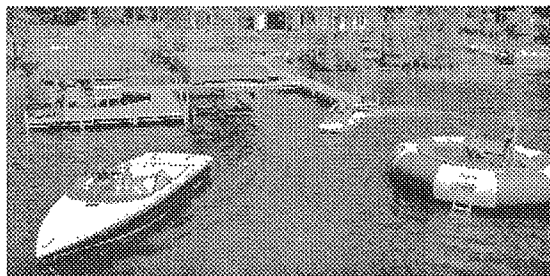

A FLOE roll-in or floating modular dock system will beautify and add value to your shorefront property. Learn how a FLOE dock system is easier to install, easier

to level, and more satisfying to use than other conventional docks. All FLOE docks are constructed with high-grade aluminum and stainless steel fasteners.

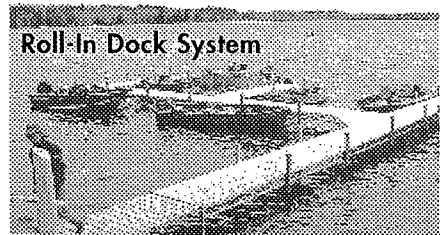

Roll-In Dock System

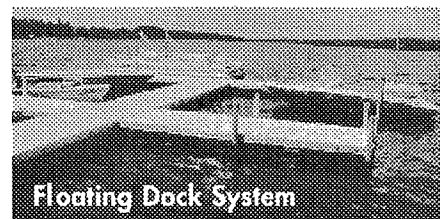

Floating Dock System



FLOE INTERNATIONAL, INC.
48473 State Highway 65
McGregor, Minnesota 55760
(218) 426-3563 • 1-800-336-6337
www.floeintl.com

**When It Comes To Your Valuable Recreation Time,
Don't Settle For Second Best ... GO WITH THE FLOE!**

©2001 FLOE International, Inc.
All Rights Reserved