

# FLOE MAXIS EXTENSION KIT 6-10K

## ASSEMBLY INSTRUCTIONS

KIT P/N 512-65030-00

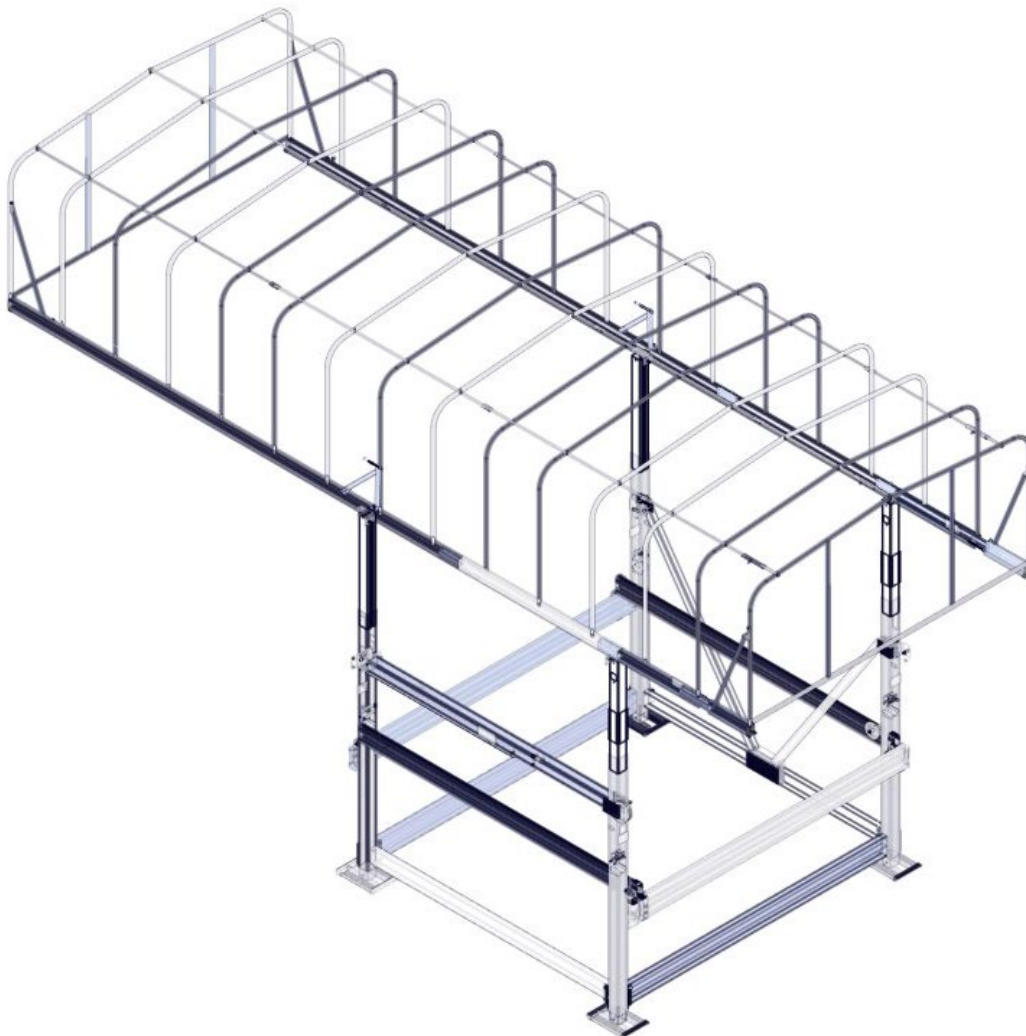

### TOOLS REQUIRED

- 9/16" SOCKET/WRENCH
- 3/4" SOCKET/WRENCH
- TORQUE WRENCH
- TAPE MEASURE

\*LIFT AND CANOPY NOT INCLUDED

INSTRUCTION P/N: 612-65030-00  
RELEASED 8/4/22

© Manufactured by:  
Floe International Inc.  
48473 State Hwy. 65  
McGregor, MN 55362  
[www.floeintl.com](http://www.floeintl.com)

**BILL OF MATERIALS/EXPLODED VIEW**

P/N 512-65030-00	KIT, MAXIS EXTENSION 6-10K		
NUMBER	PART NUMBER	QTY.	DESCRIPTION
1	001-70207-00	2	HHCS, 1/2-13 x 1 1/4" 18-8 ss
2	001-71021-00	2	FLAT WASHER, 1/2" 18-8 SS
3	001-76072-00	2	NUT, NYLOCK 1/2-13 ALUM.
4	002-00257-00	2	TUBE, MAXIS LEG EXTENSION 6-10K – 12"
5	002-00258-00	2	INSERT, CANOPY 6-10K W/ PIVOT HOLE – 44"
6	112-01075-00	2	ASS'Y, CANOPY INSERT W/ GUIDE HOLES – 44"

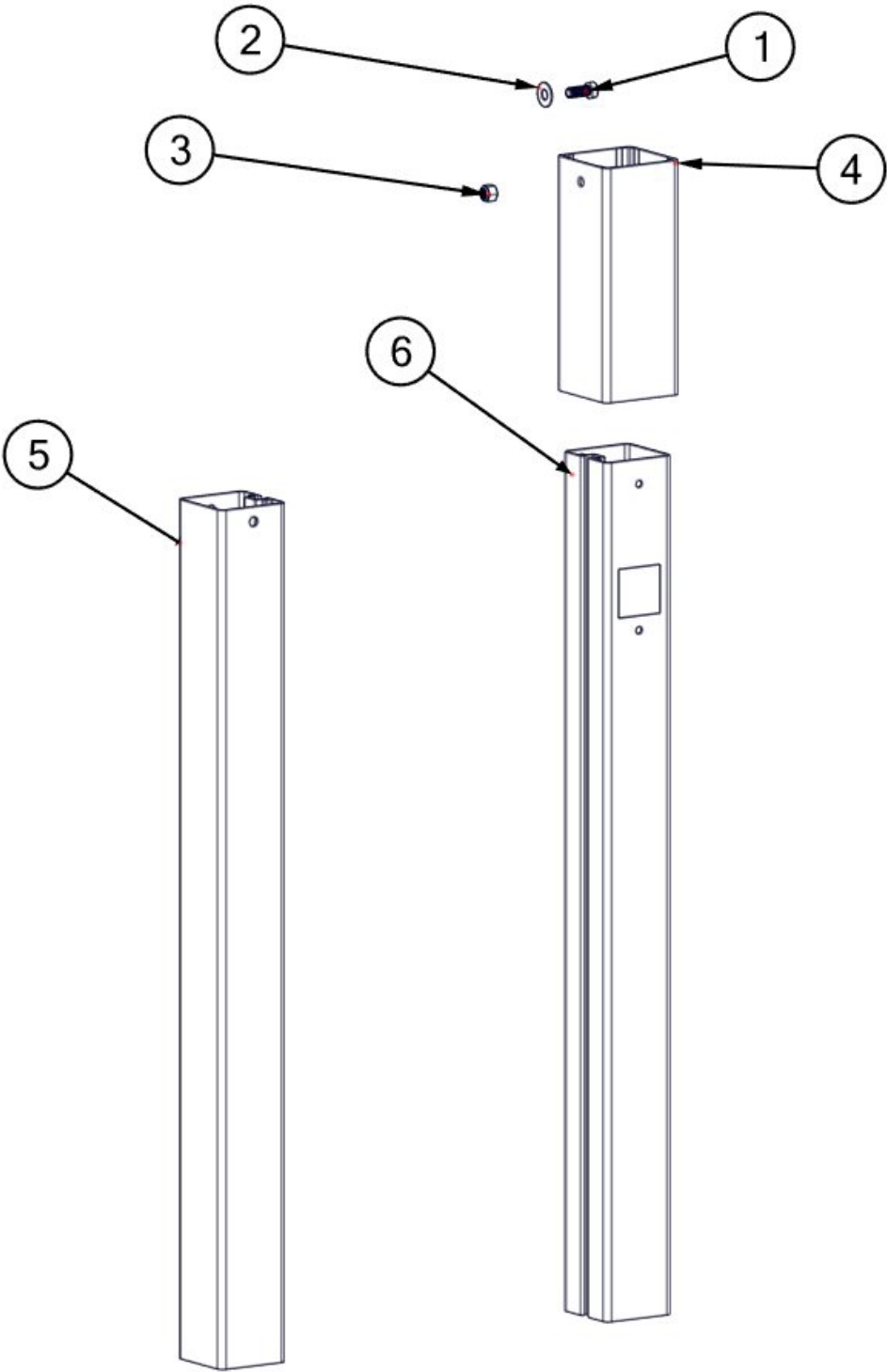

## STEP 1

IF INSTALLED, REMOVE VINYL CAP FROM TOP OF EACH CORNER POST. USE A  $\frac{1}{2}$ " X 1-1/4" BOLT AND  $\frac{1}{2}$ " WASHER FROM CANOPY HOOP HARDWARE (FIGURE 1.1). PLACE THE BOLT AND WASHER INTO THE CORNER POST (FIGURE 1.2). SLIDE AN INSERT INTO EACH OF THE CORNER POSTS, THEN START A  $\frac{1}{2}$ " NYLOCK NUT (INCLUDED WITH CANOPY HOOP HARDWARE) ON THE BOLT, BUT DO NOT TORQUE. CORNER POSTS ON THE TILTING SIDE USE INSERT P/N 002-00258-00 (ONE THROUGH HOLE) (FIGURE 1.3). CORNER POSTS ON THE NON-TILTING SIDE USE THE INSERT P/N 112-01075-00 (TWO THROUGH HOLES) (FIGURE 1.4).

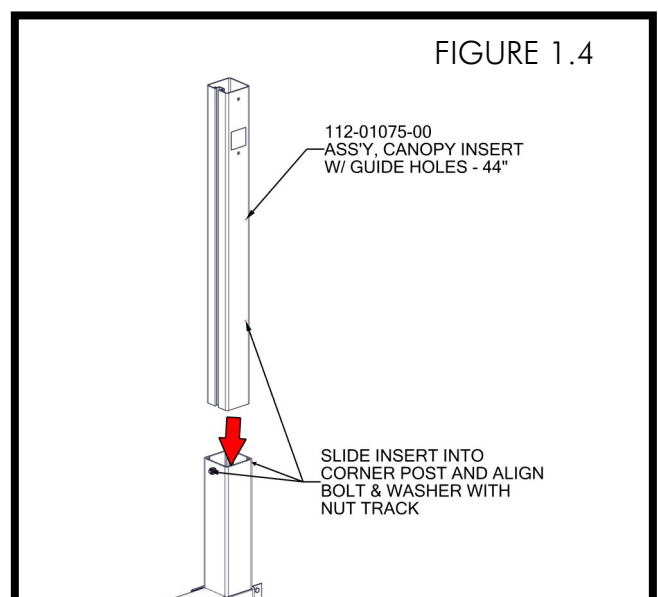
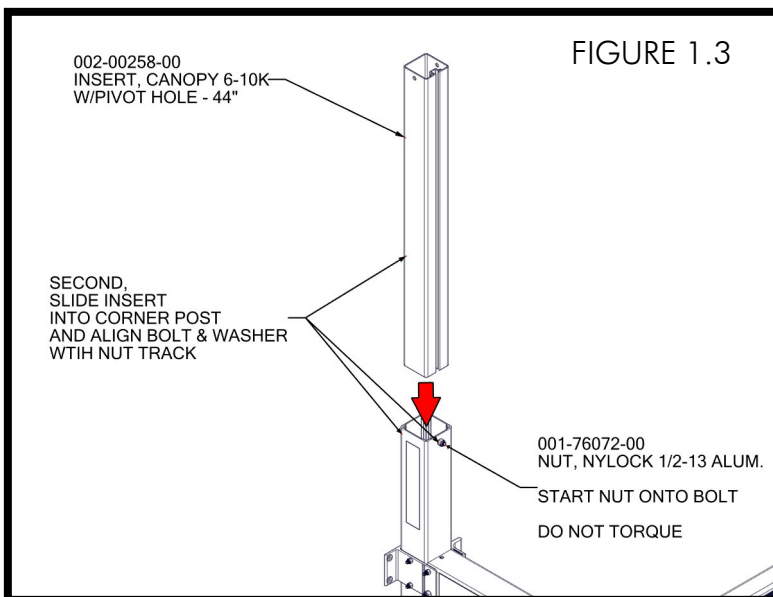
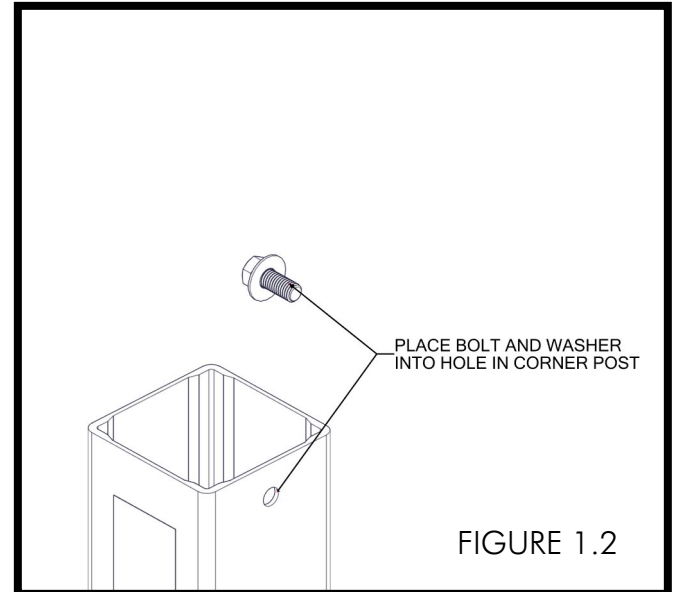
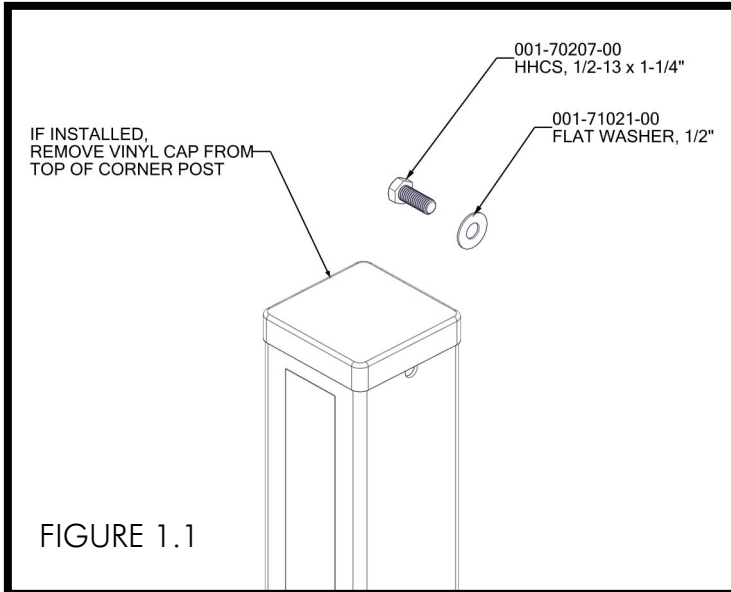

THE MAXIMUM HEIGHT OF THE INSERTS IS 38" (6" OF ENGAGEMENT IN THE CORNER POSTS). THE MINIMUM HEIGHT OF THE INSERTS IS 26" (18" OF ENGAGEMENT IN THE CORNER POSTS) (FIGURE 1.5). TORQUE ½" NUT TO 60 FT-LBS (FIGURE 1.6). PROCEED TO INSTALL MAXIS CANOPY BY REFERRING TO MAXIS CANOPY FRAME INSTRUCTIONS.

FIGURE 1.5

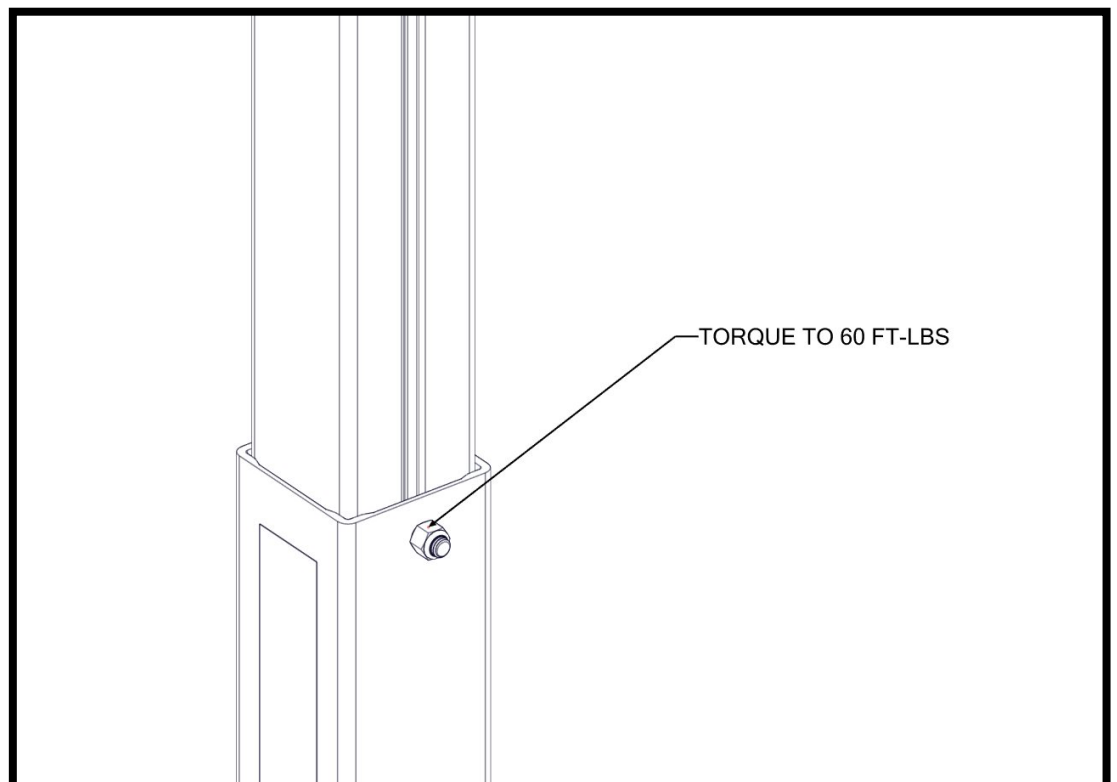
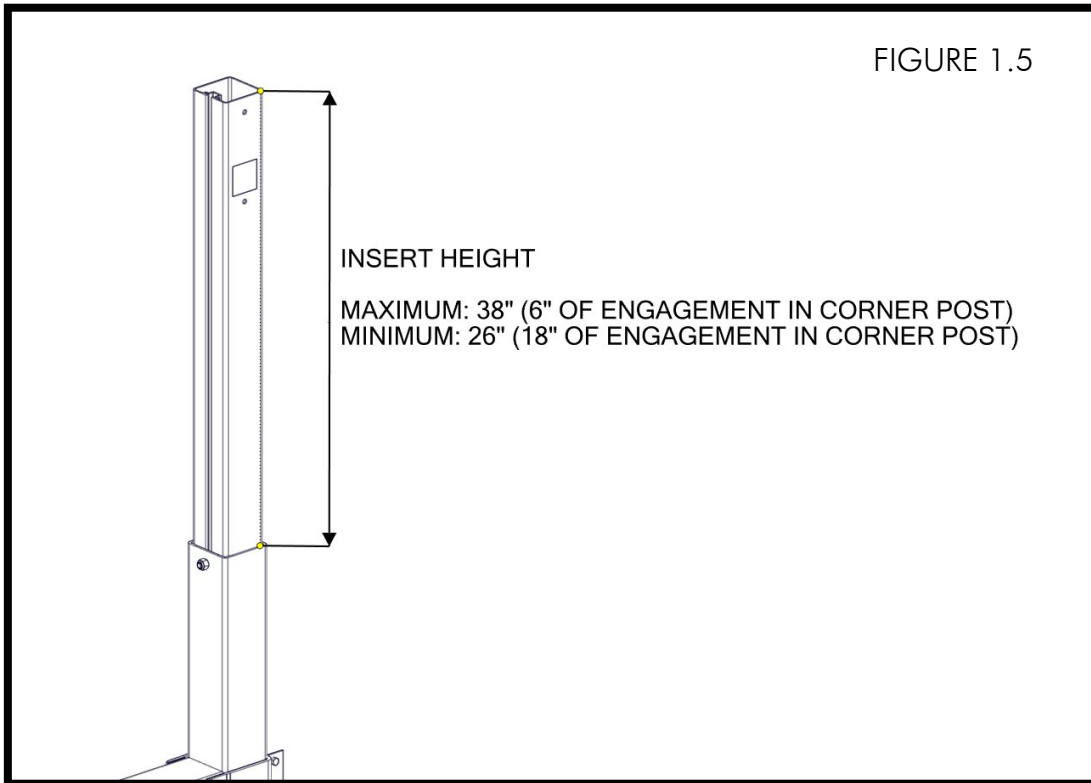

## STEP 2 (IF INSTALLING MAXIS TILTING CANOPY)

INSTALL (1) 1/2" X 1 1/4" BOLT AND (1) 1/2" WASHER INTO EXTENSION TUBE. NOTE THAT THE EXTENSION TUBE IS SLID OVER THE INSERTS ON THE NON-TILTING SIDE. DEPENDING ON THE CONFIGURATION, IT IS EITHER ON THE MOTOR SIDE (CORNER POSTS "B" & "C") OR THE LIFTING SIDE (CORNER POSTS "A" & "D"). FOR EITHER CONFIGURATION, IT IS ALWAYS THE INSERT WITH TWO THROUGH HOLES (112-01075-00) (FIGURE 2.1). START (1) 1/2" NYLOCK NUT ON THE 1/2" BOLT, BUT DO NOT TORQUE. THEN, SLIDE EXTENSION ONTO INSERT (FIGURE 2.2).

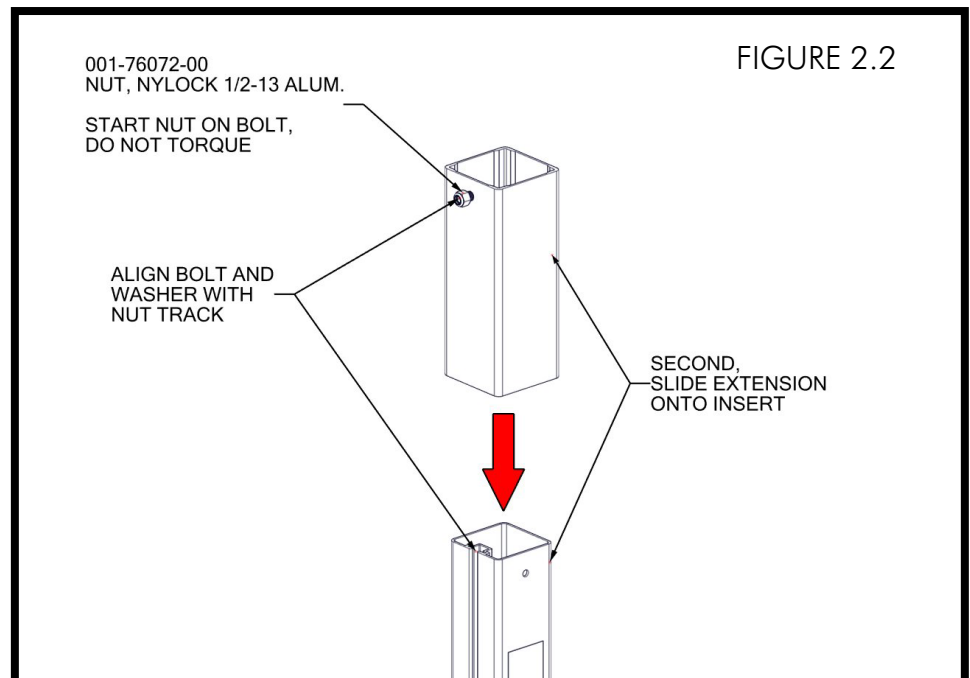
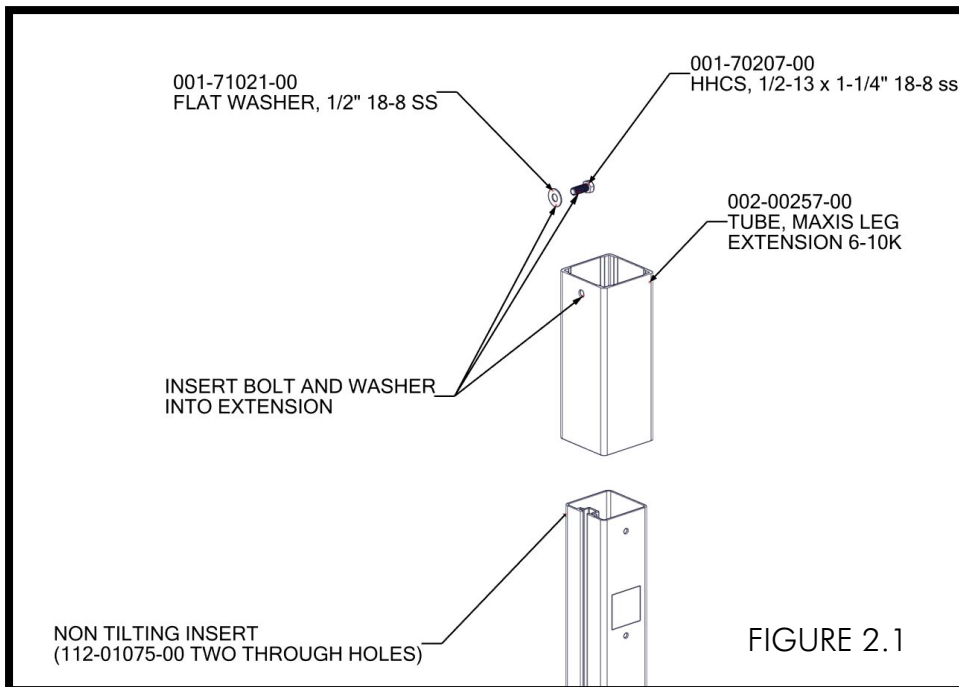

FIRST, SET HEIGHT OF EXTENSION TUBE  $7\frac{3}{8}$ " FROM TOP OF CORNER POST. THEN, SWING LOWER ACTUATOR MOUNT AND ACTUATOR TOWARDS EXTENSION TUBE (FIGURE 2.3). EXTENSION TUBE WILL BE APPROXIMATELY  $5\frac{3}{16}$ " FROM TOP OF TUBE TO TOP OF ACTUATOR MOUNT. TORQUE 60 FT-LBS (FIGURE 2.4).

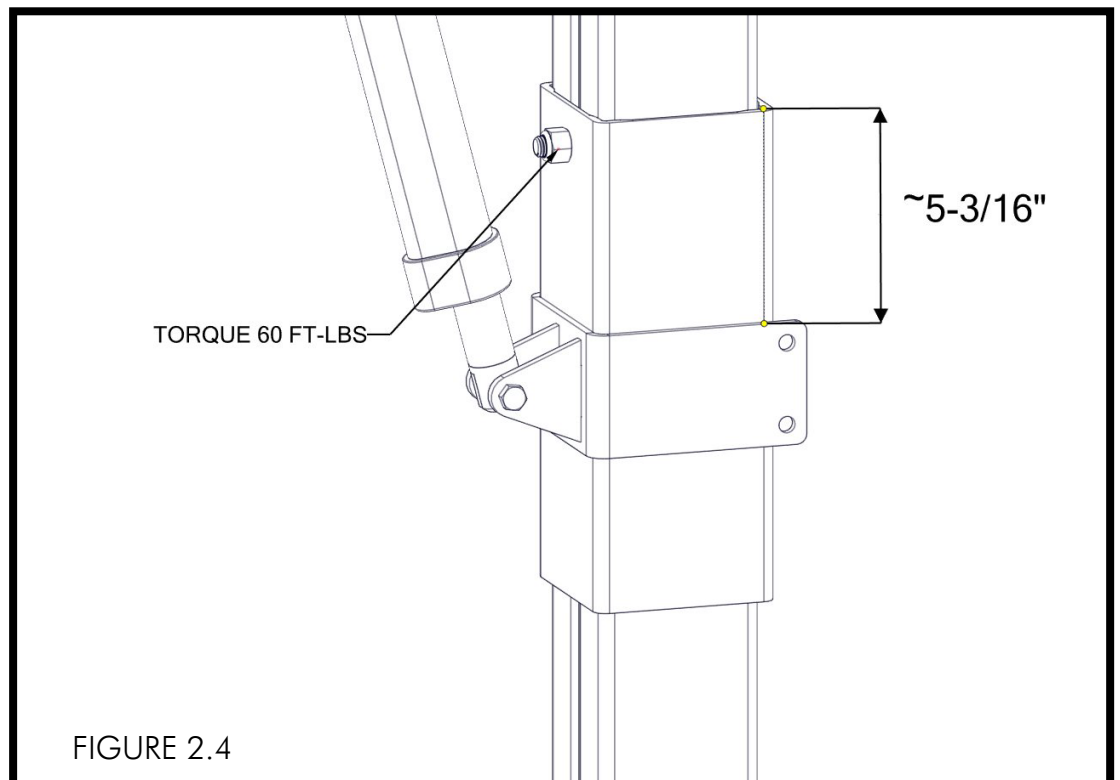
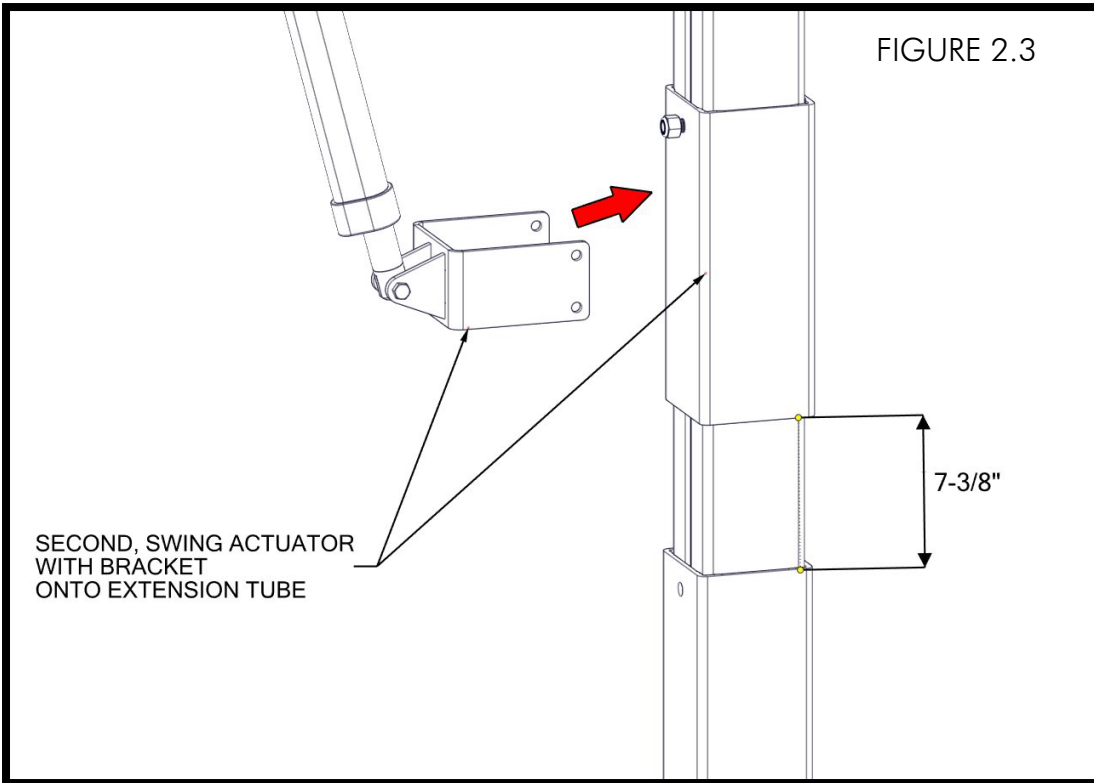

**NOTE (MAXIS TILT KIT INSTALLATIONS)**

