

# FLOE ANCHORING SYSTEM

## P1200, PWC1300, P1600, V1600 PWC

### ASSEMBLY INSTRUCTIONS

KIT P/N 512-00054-00

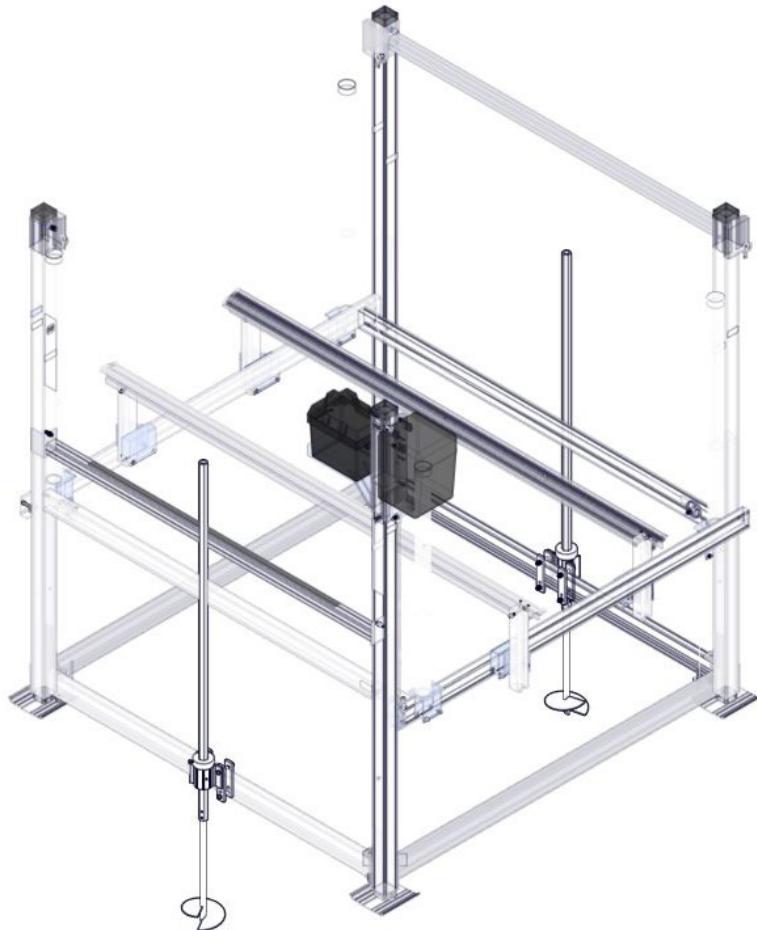

#### IMPORTANT

**DO NOT USE AN IMPACT  
OR CORDLESS DRILL TO  
INSTALL LIFT ANCHORS.**

#### TOOLS REQUIRED

- (2) 9/16" SOCKETS/WRENCHES
- 1-1/8" SOCKET (6 POINT ONLY)
- 1/2" DRIVE RATCHET
- TORQUE WRENCH
- TAPE MEASURE

\*LIFT NOT INCLUDED

#### STORAGE DISCLAIMER

**WHEN STORING THE ANCHORING SYSTEM, THE MAIN TUBE WITH AUGER  
MUST BE CLEANED THOROUGHLY OF ANY DEBRIS (MUD, SAND, ETC.) AND  
PLACED UPSIDE DOWN (AUGER POINTING UPWARDS).**

## BILL OF MATERIALS/EXPLODED VIEW

P/N 512-00054-00		ANCHORING SYSTEM, PIVOT LIFTS & V1600	
NUMBER	PART NUMBER	QTY.	DESCRIPTION
1	001-70107-00	2	HHCS, 3/8-16 x 1 1/4" 18-8 SS
2	001-70113-00	4	HHCS, 3/8-16 x 2-1/2" 18-8 SS
3	001-70114-00	4	HHCS, 3/8-16 x 2-3/4" 18-8 SS
4*	001-70117-00	4	HHCS, 3/8-16 x 3-1/2" 18-8 SS
5*	001-70118-00	4	HHCS, 3/8-16 x 3-3/4" 18-8 SS
6	001-76071-00	8	NUT, NYLOCK 3/8-16 ALUM.
7	002-00198-00	2	SET COLLAR, ANCHORING SYSTEM
8	002-00265-00	4	PLATE, PIVOT ANCHOR POCKET MOUNTING
9	111-00508-01	2	WELD'T, ANCHOR POCKET PIVOT & V1600
10	111-00510-00	2	ASS'Y, BOAT LIFT ANCHOR PIVOT AND V1600

\*USED ON P1600 INSTALLATIONS

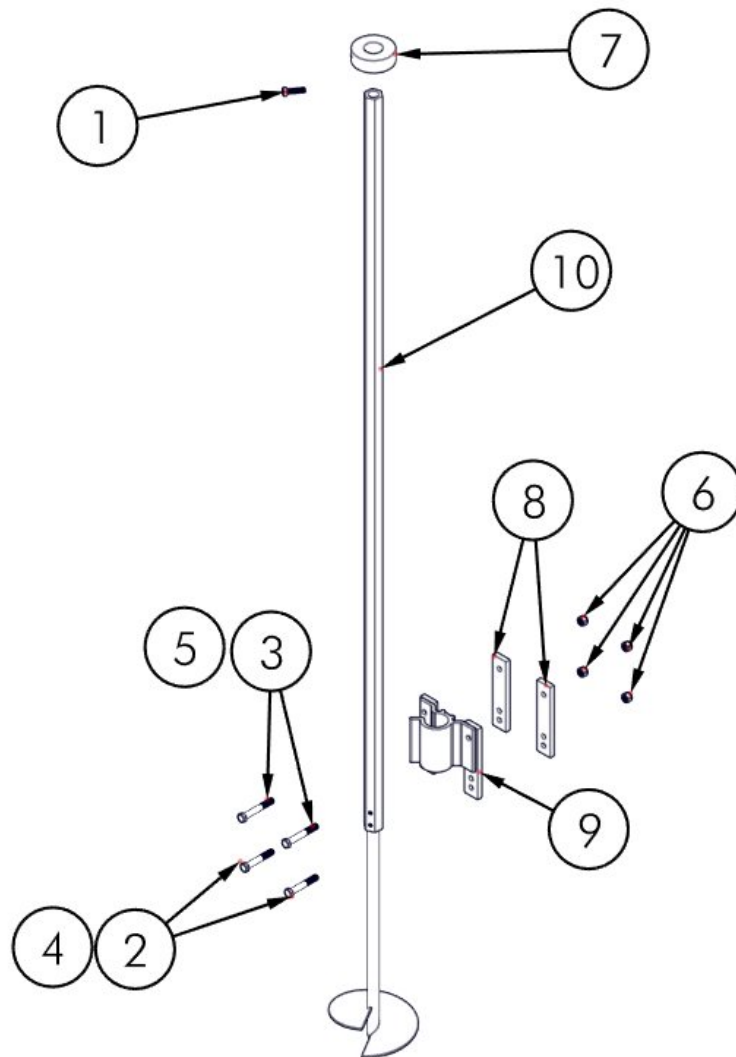

## **INSTALLATION NOTE**

IF A WHEEL KIT IS INSTALLED OR TO BE INSTALLED, POSITION ANCHORING SYSTEM BRACKETS:

- 9" MINIMUM FROM THE WHEEL KIT BRACKET ON V1600 PWC LIFTS
- 12" MINIMUM FROM THE WHEEL KIT BRACKET ON PIVOT LIFTS

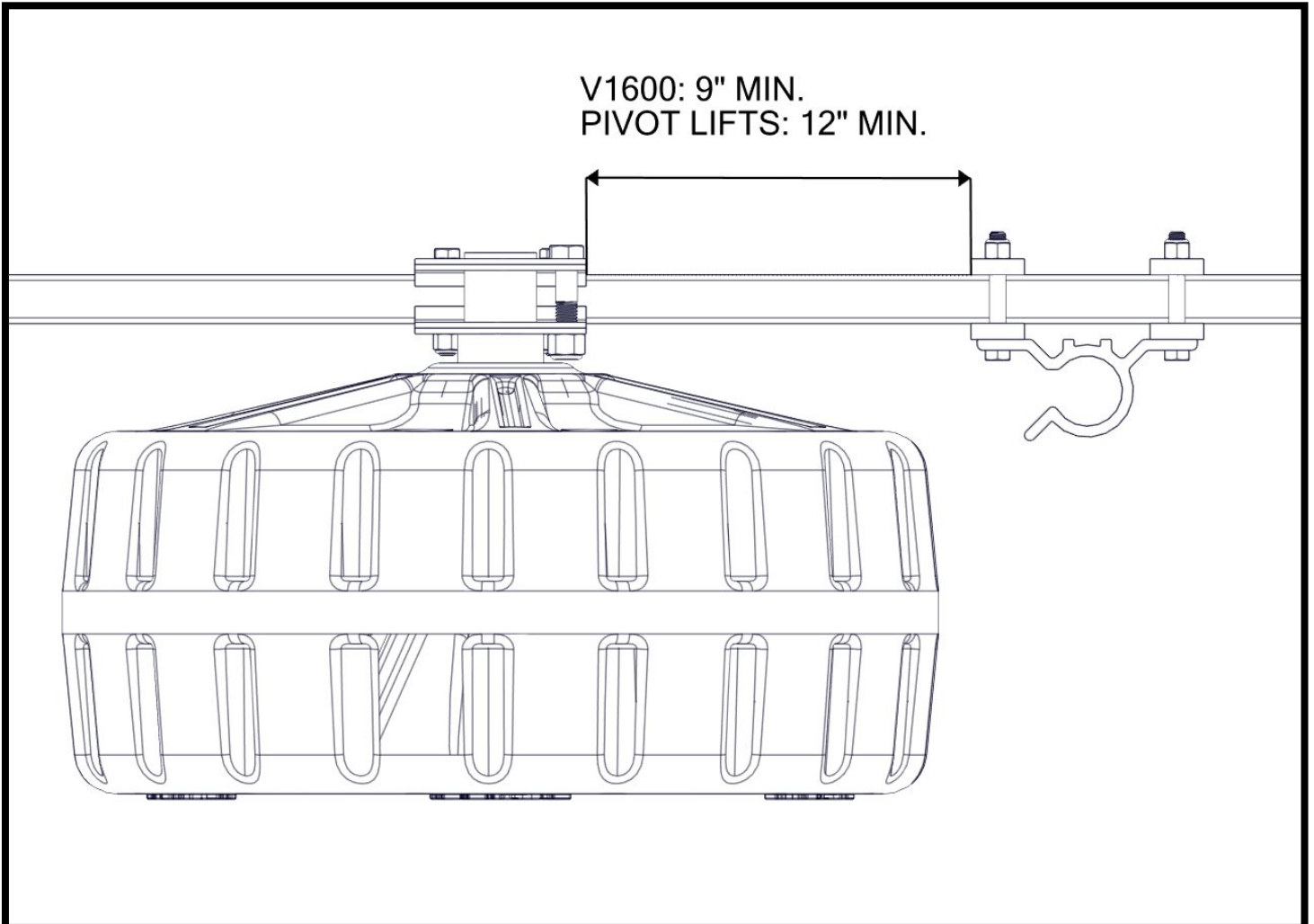

## STEP 1

ANCHORS WILL BE PLACED ON SIDE BEAMS BETWEEN CORNER POSTS "A" & "B" AND CORNER POSTS "C" & "D" (FIGURE 1.1).

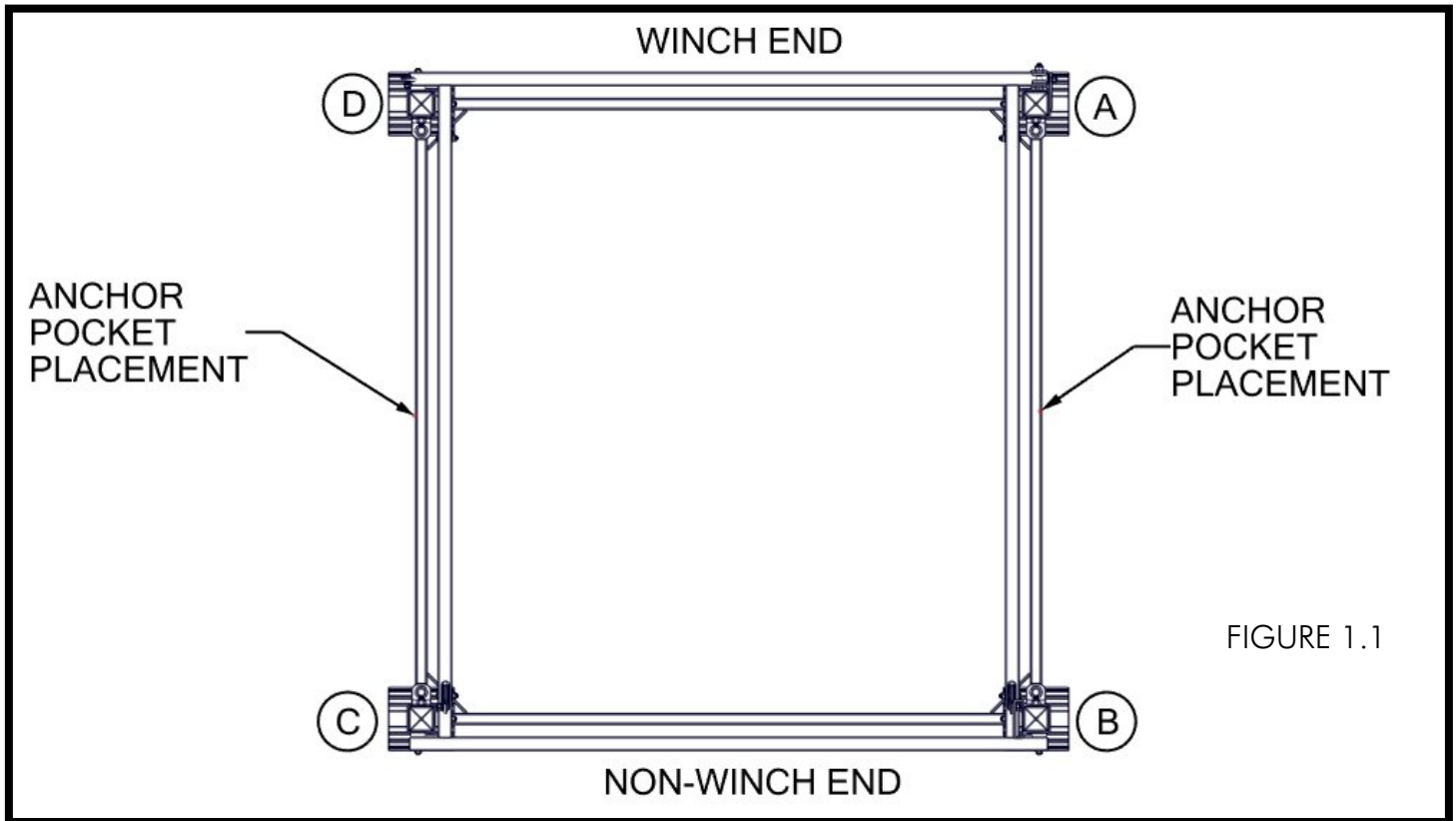

ATTACH PLATES AND POCKET WELDMENT ONTO FRAME BEAM AS SHOWN IN FIGURE 1.2. FOR V1600, P1200, AND PWC 1300 LIFTS, USE (2) 3/8" X 2-1/2" BOLTS FOR THE LOWER HOLES AND (2) 3/8" X 2-3/4" BOLTS FOR THE UPPER HOLES. FOR P1600 LIFTS, USE (2) 3/8" X 3-1/2" BOLTS FOR THE LOWER HOLES AND (2) 3/8" X 3-3/4" BOLTS FOR THE UPPER HOLES. PLACE POCKET AT THE APPROPRIATE DIMENSION FOR YOUR LIFT AS SHOWN IN FIGURE 1.3. MEASURE FROM THE INSIDE OF THE CORNER POST ON THE WINCH END OF THE LIFT TO THE CLAMP. FOR PWC1300 LIFTS, PLACE AT 26" FROM THE CORNER POST. FOR P1200 & P1600 LIFTS, PLACE AT 41" FROM THE CORNER POST. FOR V1600 LIFTS, PLACE AT 29" FROM THE CORNER POST.

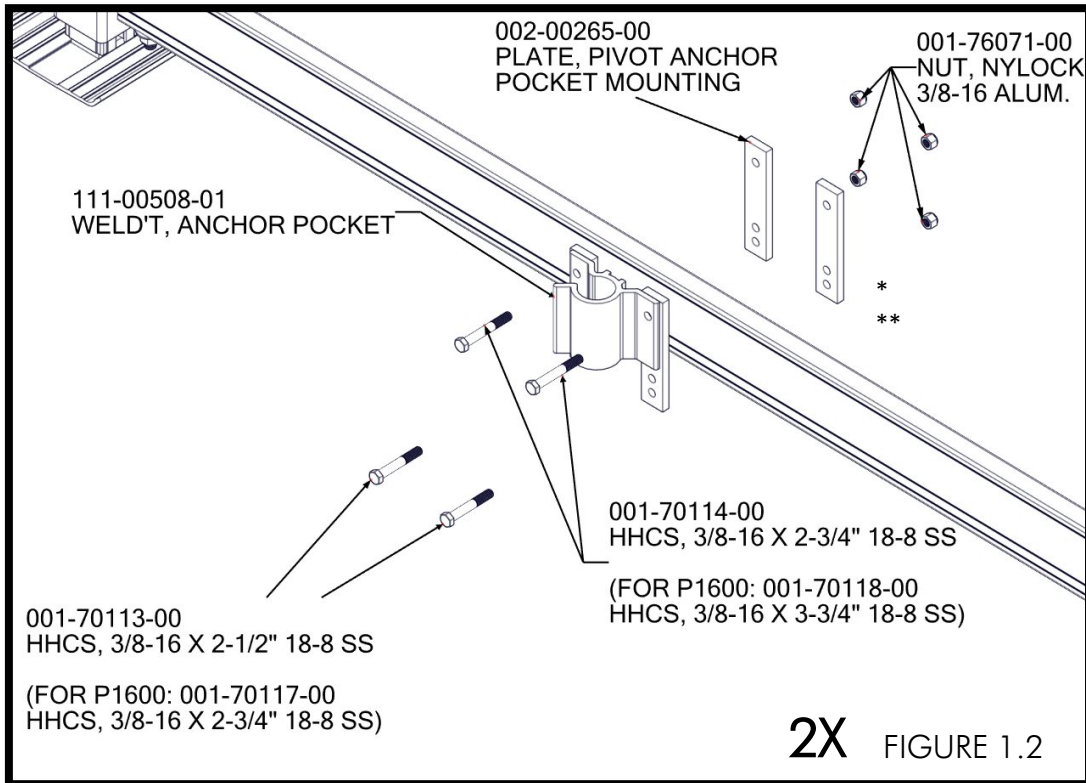

\*TOP HOLE  
- PIVOT LIFTS  
\*\*BOTTOM HOLE  
- V1600

FIGURE 1.2

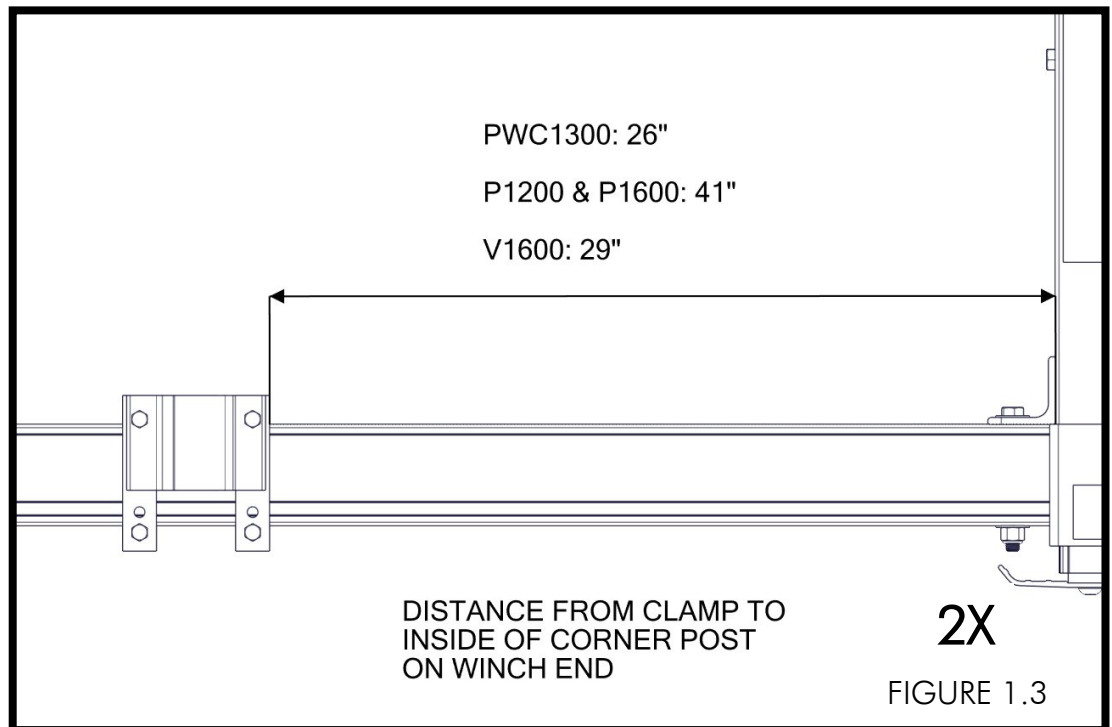

FIGURE 1.3

ONCE PLACEMENT IS FINALIZED, TORQUE TO 35 FT-LBS (FIGURE 1.4).

**IMPORTANT NOTE:** POCKET PLACEMENT MAY HAVE TO BE ADJUSTED BASED UPON POSSIBLE OBSTRUCTIONS ON LAKE BOTTOM OR ABILITY TO DRIVE AUGER TO FULL DEPTH.

FIGURE 1.4

2X

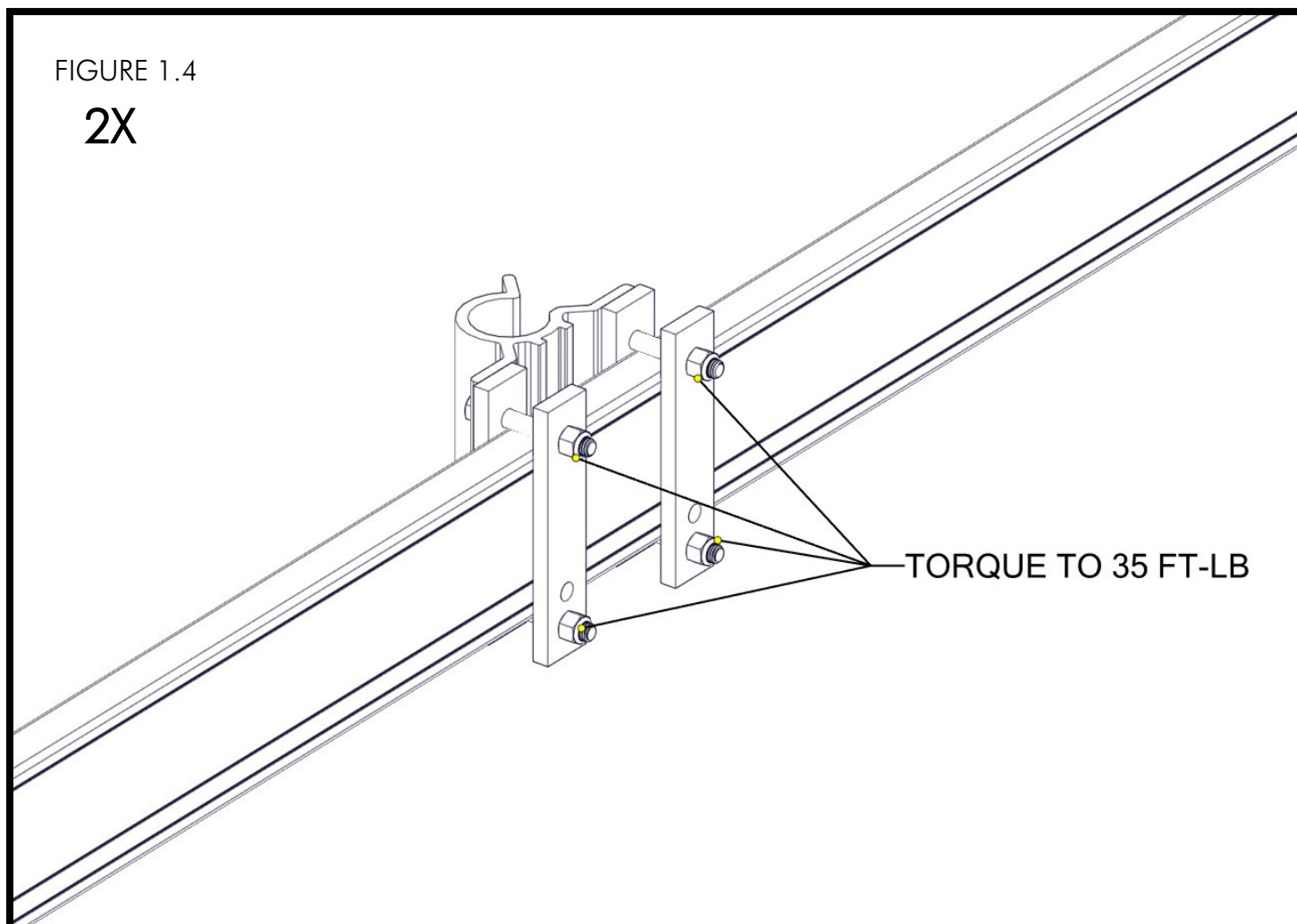

## STEP 2

NOTE: INNER LEG HEIGHT MUST BE SET BEFORE ANCHORS ARE INSTALLED (BOTTOM OF INNER LEG TO BOTTOM OF CORNER POST). SLIDE COLLAR OVER ANCHOR TUBE (FIGURE 2.1). SET HEIGHT OF COLLAR BY TAKING THE MEASUREMENT FROM THE BOTTOM OF COLLAR TO THE TIP OF THE AUGER (FIGURE 2.2). SEE TABLE ON SHEETS 8 FOR COLLAR HEIGHT MEASUREMENTS.

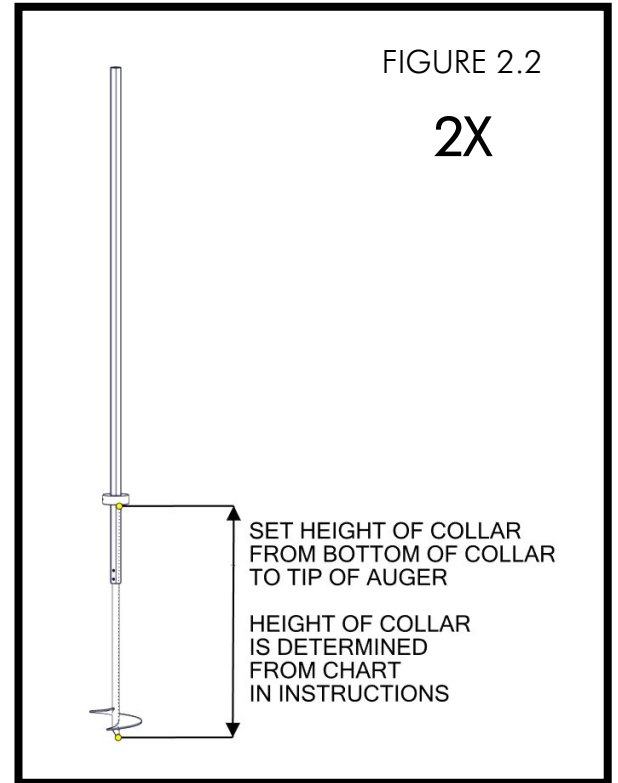
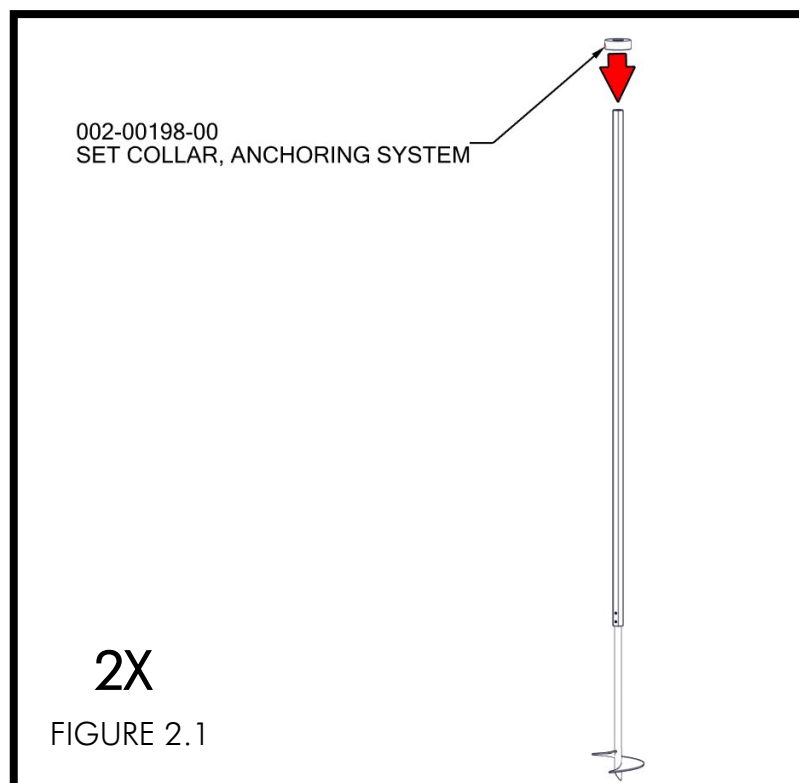
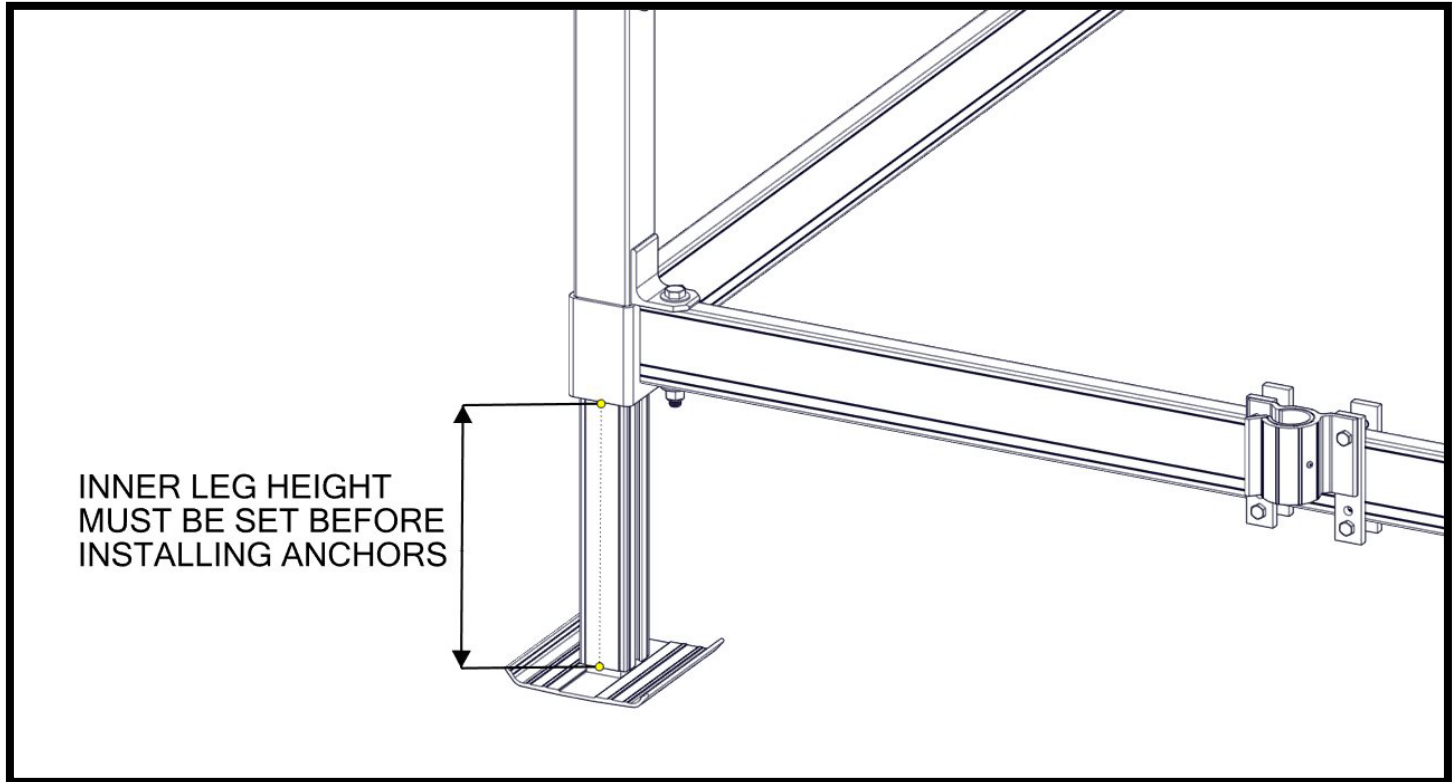

TO DETERMINE COLLAR HEIGHT, THE FOLLOWING TABLE IS USED. REFER TO FIGURE 2.2 ON SHEET 7 ON HOW TO MEASURE FOR COLLAR HEIGHT. INNER LEGS ON INSTALLATIONS HAVE A TRAVEL OF 24 INCHES.

COLLAR HEIGHT SETUP				
EXTENDED LEG LENGTH (INCHES)	1	2	3	4
COLLAR HEIGHT (INCHES)	25	26	27	28
EXTENDED LEG LENGTH (INCHES)	5	6	7	8
COLLAR HEIGHT (INCHES)	29	30	31	32
EXTENDED LEG LENGTH (INCHES)	9	10	11	12
COLLAR HEIGHT (INCHES)	33	34	35	36
EXTENDED LEG LENGTH (INCHES)	13	14	15	16
COLLAR HEIGHT (INCHES)	37	38	39	40
EXTENDED LEG LENGTH (INCHES)	17	18	19	20
COLLAR HEIGHT (INCHES)	41	42	43	44
EXTENDED LEG LENGTH (INCHES)	21	22	23	24
COLLAR HEIGHT (INCHES)	45	46	47	48
EXTENDED LEG LENGTH (INCHES)	25			
COLLAR HEIGHT (INCHES)	49			

FOR EXAMPLE, AN EXTENDED LEG LENGTH OF 12 INCHES WOULD RESULT IN A COLLAR HEIGHT OF 36 INCHES.



ONCE POSITION IS SET, SECURE COLLAR TO HEX TUBE USING (1) 3/8" X 1-1/4" BOLT (FIGURE 2.3) AND TORQUE TO 20 FT-LBS (FIGURE 2.4).

FIGURE 2.3

2X

001-70107-00  
HHCS, 3/8-16 X 1-1/4" 18-8 SS

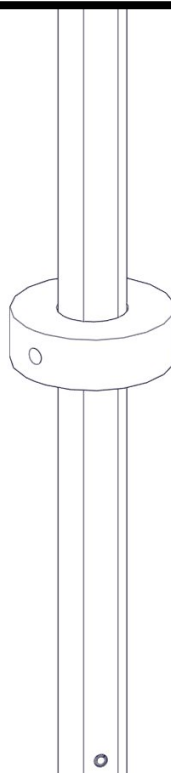
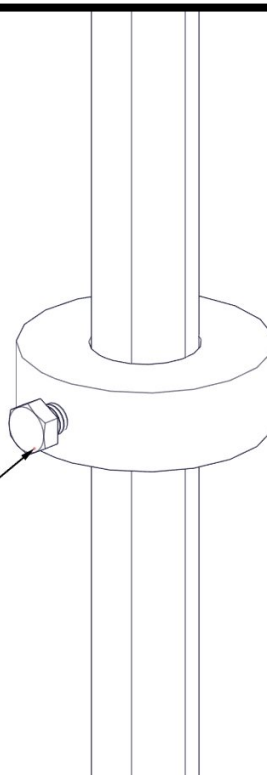

FIGURE 2.4

2X

TORQUE TO  
20 FT-LBS



BRING ANCHOR ASSEMBLY TOWARDS LIFT UNTIL AUGER TOUCHES FRAME BEAM (FIGURE 2.5). LIFT THE ANCHOR ASSEMBLY AND STOP WHEN THE AUGER HELIX TOUCHES THE BOTTOM OF THE FRAME BEAM (FIGURE 2.6).

FIGURE 2.5

2X

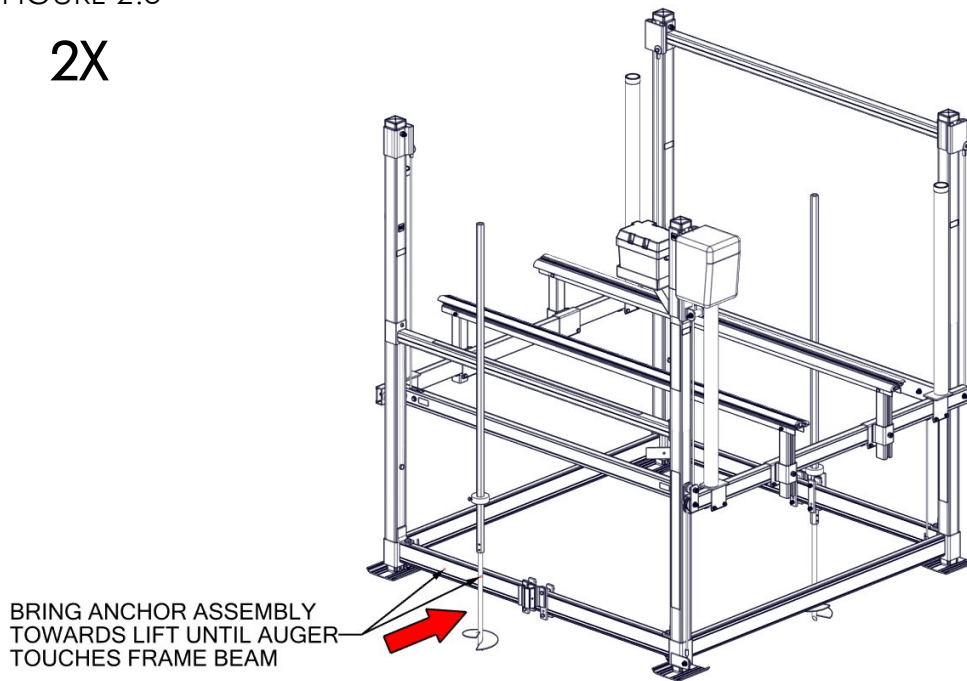
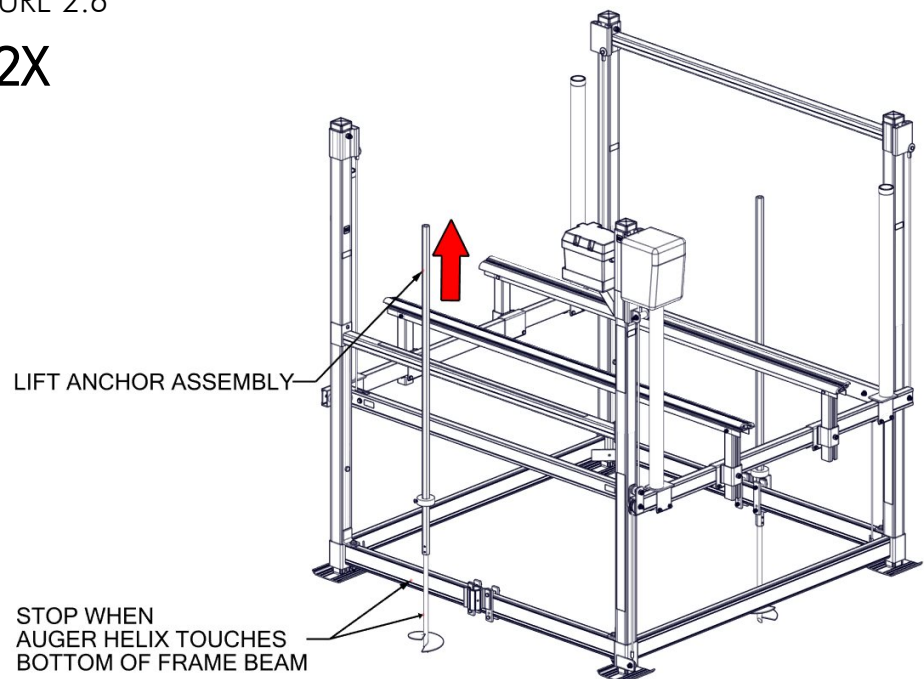
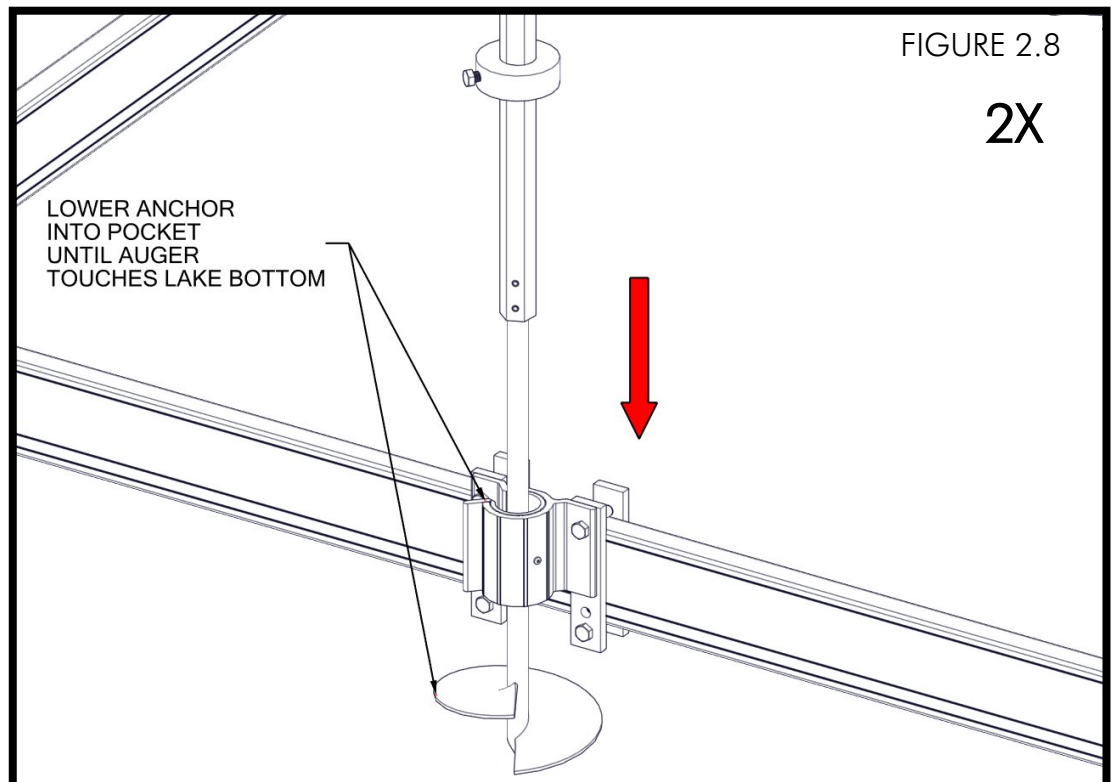
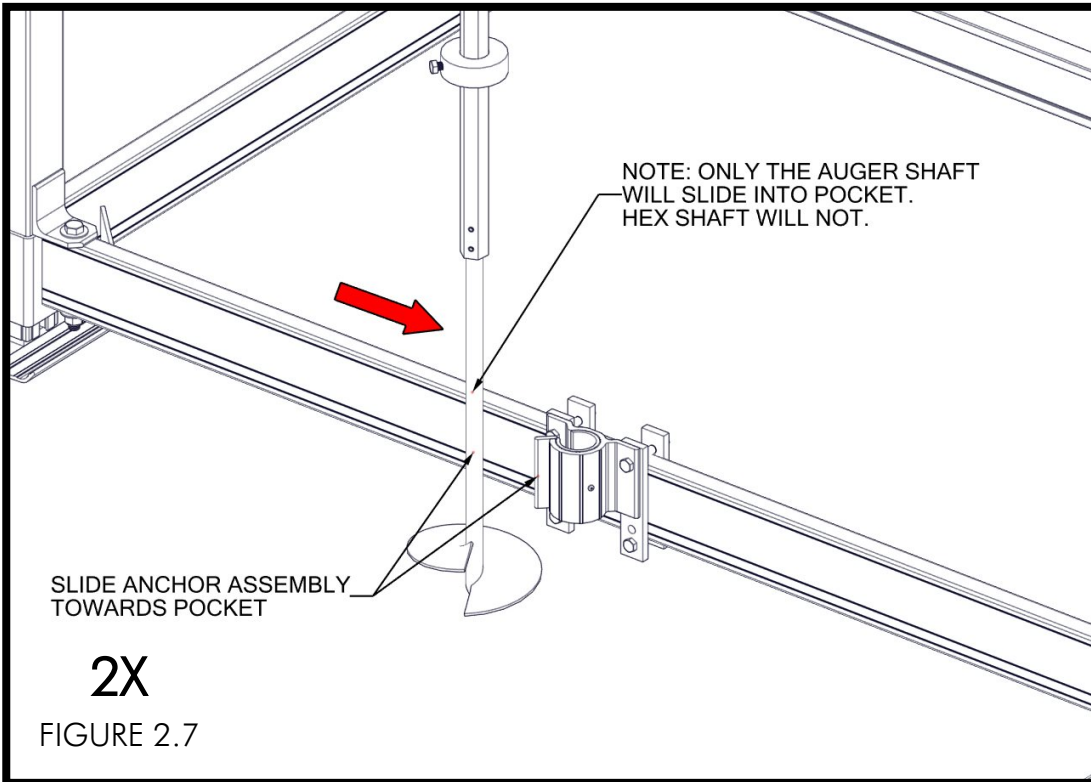

FIGURE 2.6

2X



SLIDE THE ANCHOR ASSEMBLY TOWARDS THE POCKET. NOTE THAT ONLY THE AUGER SHAFT WILL SLIDE INTO THE POCKET, THE HEX SHAFT WILL NOT (FIGURE 2.7). LOWER THE ANCHOR INTO POCKET UNTIL AUGER TOUCHES LAKE BOTTOM (FIGURE 2.8).



IF ADDITIONAL ADJUSTMENT IS REQUIRED, LOOSEN 3/8" NUTS AND SLIDE POCKETS ON FRAME BEAM WITH ANCHOR ASSEMBLIES UNTIL DESIRED POSITION IS FOUND. ONCE POSITION IS SET, RE-TORQUE NUTS TO 35 FT-LBS (FIGURE 2.9).

DRIVE ANCHOR ASSEMBLY INTO LAKE BOTTOM USING 1-1/8" **6 POINT** SOCKET & 1/2" DRIVE RATCHET UNTIL COLLAR TOUCHES TOP OF ANCHOR POCKET (FIGURE 2.10).

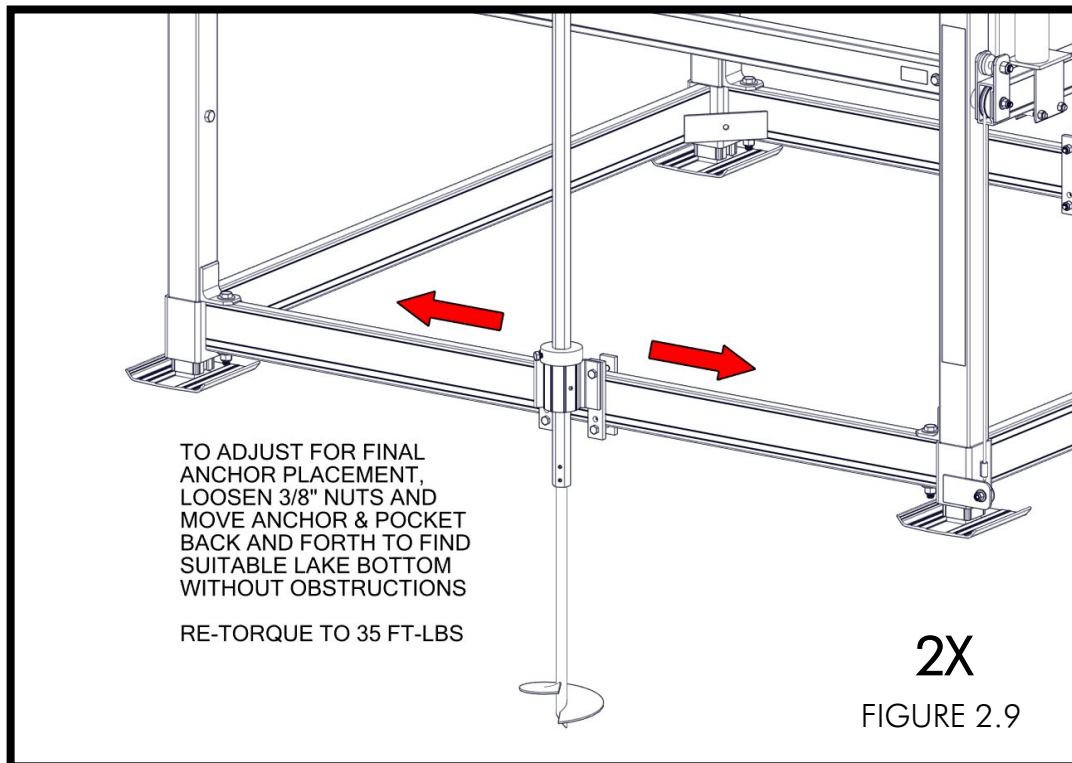

**IMPORTANT**

**DO NOT  
USE AN  
IMPACT OR  
CORDLESS  
DRILL TO  
INSTALL  
LIFT  
ANCHORS.**

**IMPORTANT NOTE:**

ONLY USE A 6  
POINT SOCKET.  
12 POINT SOCKETS  
MAY CAUSE  
DAMAGE TO HEX  
SHAFT.



6 POINT SOCKET



12 POINT SOCKET  
DO NOT USE

