

FLOE 120 VOLT AC ASC UPDATE KIT

3800, 5000, 6000, 6500 & 8000# LIFTS

P/Ns 511-38605-00 & 511-60765-00
ASSEMBLY INSTRUCTIONS



TOOLS REQUIRED:

- (2) 3/4" socket or wrench for 1/2" nuts and bolts
- (1) 9/16" socket or wrench for 3/8" nuts and bolts
- (1) Flat tip screwdriver
- (1) Power hand drill & 3/4" drill bit
- (1) File for deburring

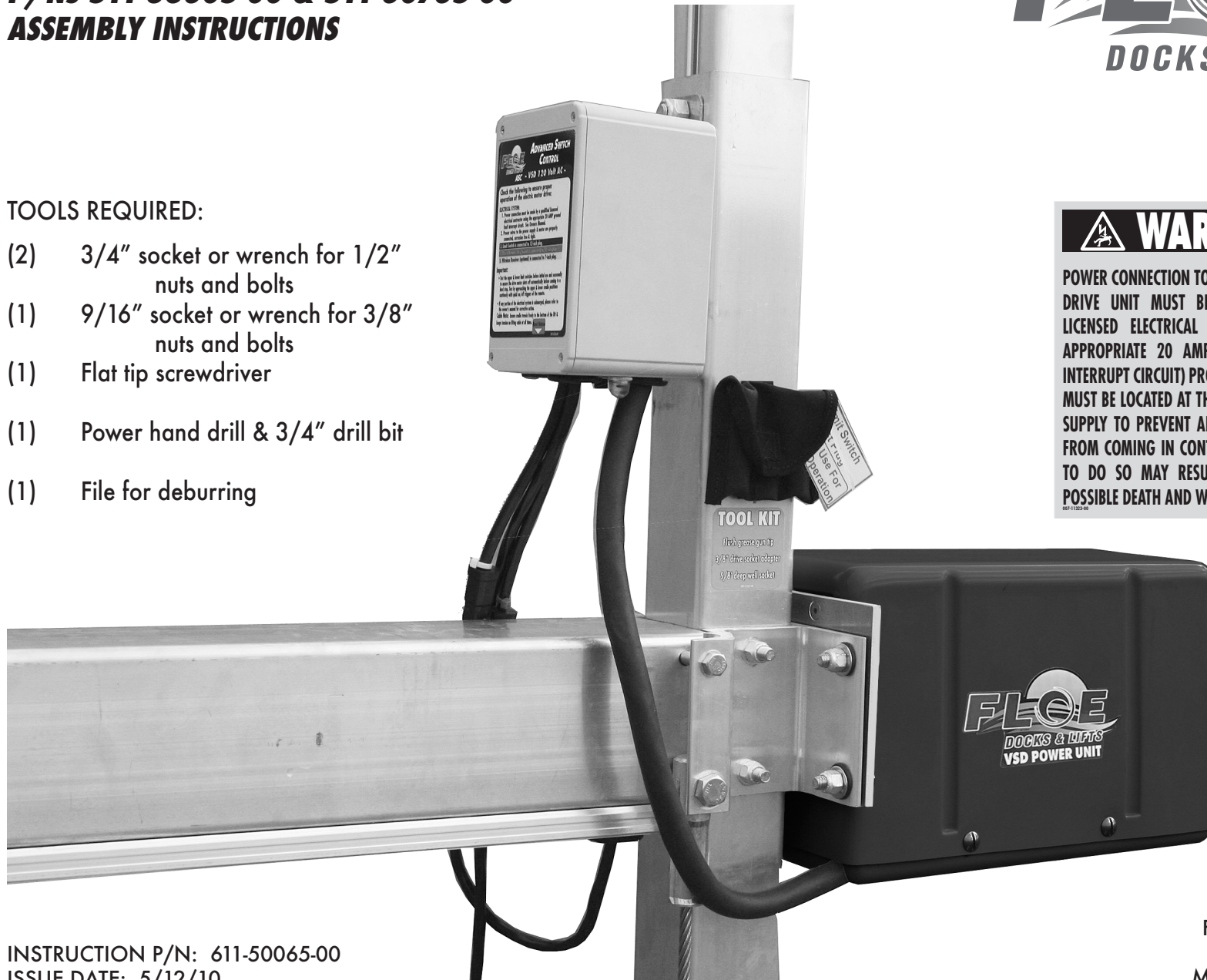

WARNING

POWER CONNECTION TO THE FLOE 120 VOLT AC VSD DRIVE UNIT MUST BE MADE BY A QUALIFIED LICENSED ELECTRICAL CONTRACTOR USING THE APPROPRIATE 20 AMP G.F.I.C. (GROUND FAULT INTERRUPT CIRCUIT) PROTECTION DEVICE. THIS UNIT MUST BE LOCATED AT THE LEAD END OF THE POWER SUPPLY TO PREVENT ANY UNPROTECTED CURRENT FROM COMING IN CONTACT WITH WATER. FAILURE TO DO SO MAY RESULT IN SEVERE INJURY OR POSSIBLE DEATH AND WILL VOID THE WARRANTY.

INSTRUCTION P/N: 611-50065-00
ISSUE DATE: 5/12/10
REVISED: 12/17/21

Manufactured By:
Floe International, Inc.
48473 State Hwy. 65
McGregor, MN 55760

PARTS LIST

- (1) Four 1/4-20 Speed Nuts, 001-46348-00
- (2) One - HHCS 1/2-13 x 3/4" Bolt SS, 001-70203-00
- (3) One - Flat washer, 1/2" SS, 001-71021-00
- (4) One - Nut, 1/2" Aluminum, 001-76350-00
- (5) One - VSD Limit Switch Test Plug, 007-05293-00
- (6) One - VSD Limit Switch Assembly
VSD Limit Switch 3800/5000 Assembly,
111-38500-01 Included with 511-38605-00
VSD Limit Switch 6000/6500/8000 Assembly,
111-60750-00 Included with 511-60765-00
- (7) One - Wired Remote, 111-70010-00
- (8) One - 120 Volt AC VSD Advanced Switch Control,
111-85000-00
- (9) One - 120 Volt AC ASC Update Instructions,
611-50065-00



STEP 1 - - - - -

Disconnect the power supply to the lift.

STEP 2 - - - - -

Clean and adhere the dual lock 5-1/4" down from the top of the corner post. (Fig. 2A) Attach the Advanced Switch Control (ASC) to the hole in the top of the corner post with the nut, bolt, and washer provided. (Fig. 2B) Connect "Advanced Switch Control" to the "VSD Power Unit" by removing the four screws in the bottom cover. Inside the power unit is a black six connector plug. Connect this plug with the plug on the Advanced Switch Control (Fig. 2C). Before re-attaching the base cover, follow the drilling instructions on the base cover template provided (page 4). **NOTE:** If current 1/4-20 speed nuts attached to the base cover are stripped out or rusted, change them with the four replacement speed nuts provided. Replace the cover on the bottom of the VSD power unit.

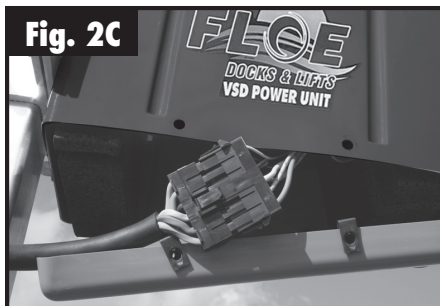
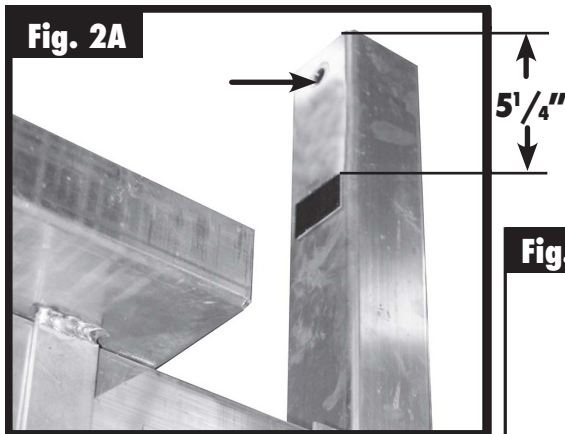

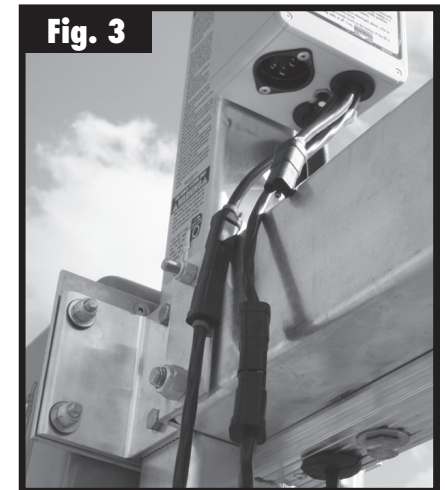

STEP 3 - - - - -

Plug 4 connector wired remote into the corresponding lead of the Advanced System Control box. Note: The wired remote lead is identified by the blue wire tie next to the base of the plug on the ASC as shown. Plug the 4 connector limit switch lead protruding from the bottom of the limit switch housing to the corresponding plug on the ASC. Note: The ASC Limit switch plug does not have a color coded cable tie attached. (Fig. 3) Plug in the power supply cord. SEE WARNING BELOW!!



STEP 4 - - - - -

Secure all loose wires.

**WARNING**

POWER CONNECTION TO THE FLOE 120 VOLT AC VSD DRIVE UNIT MUST BE MADE BY A QUALIFIED LICENSED ELECTRICAL CONTRACTOR USING THE APPROPRIATE 20 AMP G.F.I.C. (GROUND FAULT INTERRUPT CIRCUIT) PROTECTION DEVICE. THIS UNIT MUST BE LOCATED AT THE LEAD END OF THE POWER SUPPLY TO PREVENT ANY UNPROTECTED CURRENT FROM COMING IN CONTACT WITH WATER. FAILURE TO DO SO MAY RESULT IN SEVERE INJURY OR POSSIBLE DEATH AND WILL VOID THE WARRANTY.

007-11223-01

- **DRILL A 3/4" HOLE AT THE SPECIFIED DIMENSIONS. SEE DETAIL "A"**
- **CUT OUT 3/4" OPENING IN THE WALL DIRECTLY NEXT TO THE NEW Ø.750 HOLE. FILE/DEBURR THE CUT EDGES TO AVOID WIRE CHAFFING.**

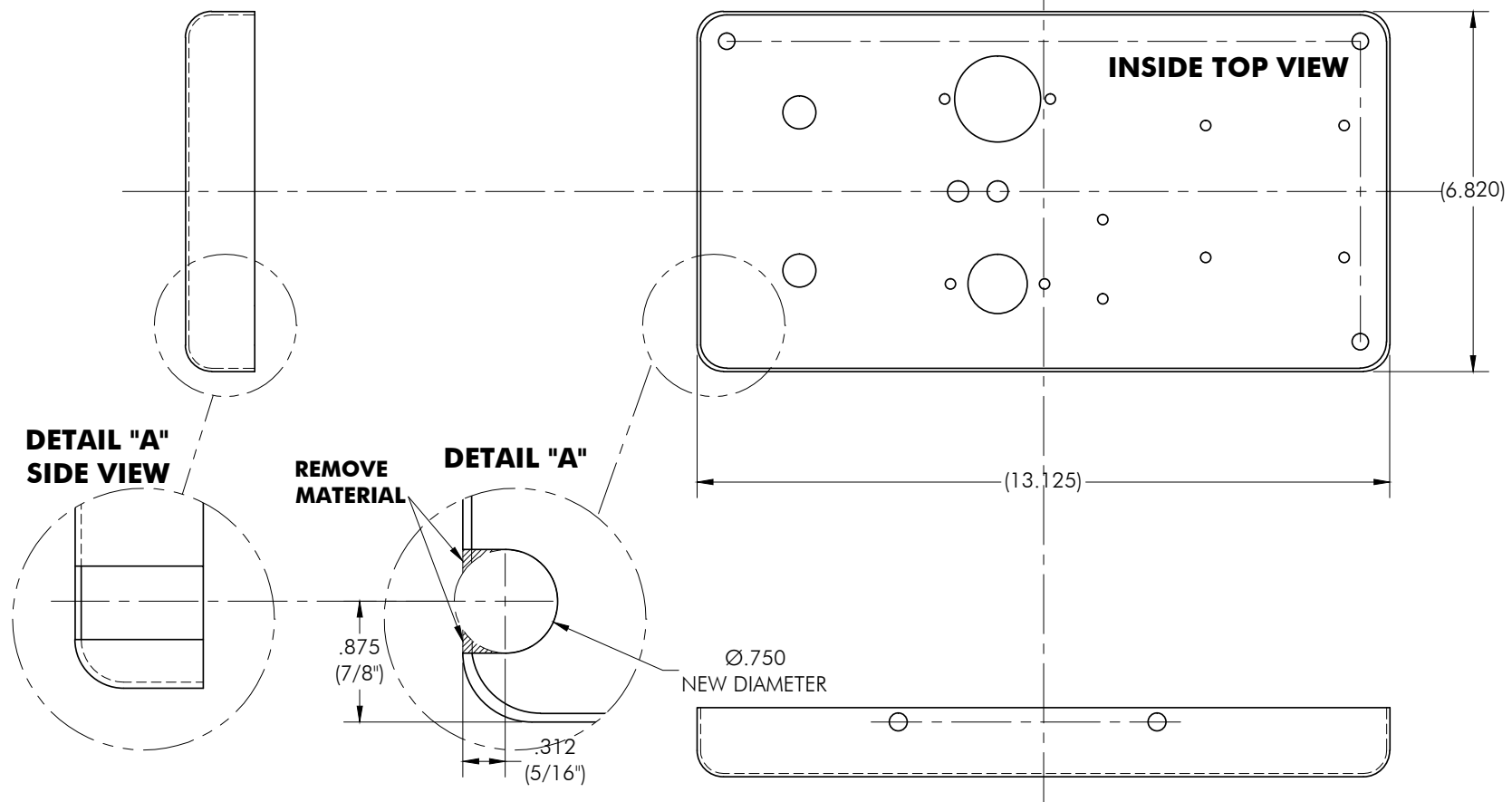



International, Inc.

www.floeintl.com