

FLOE PONTOON 20-1/2" GUIDE INS VSD6500-VSD10,000 WIDE

ASSEMBLY INSTRUCTIONS

KIT P/N 511-02285-00

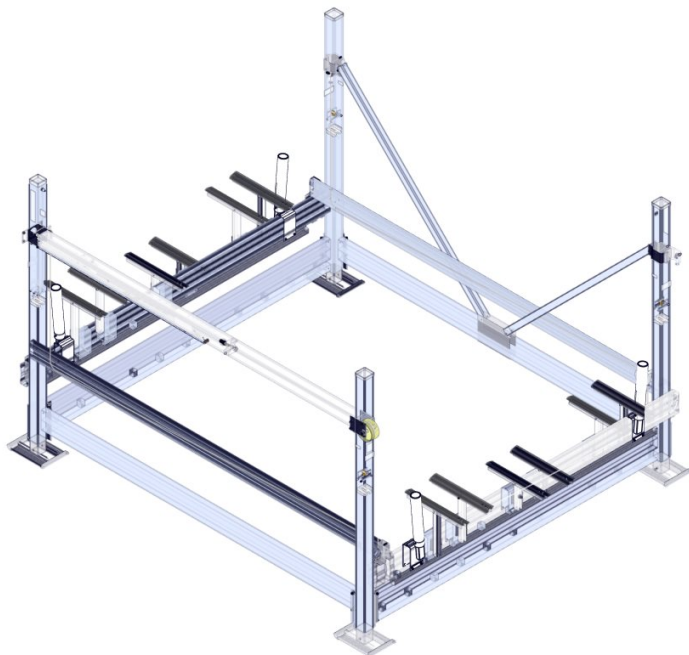

*LIFT & CRADLE PADS NOT INCLUDED

TOOLS REQUIRED

- (2) 7/16" SOCKETS/WRENCHES
- (2) 9/16" SOCKETS/WRENCHES
- TAPE MEASURE
- TORQUE WRENCH
- MARKER
- 0.406" (13/32") DRILL BIT & DRILL
(MAY BE NECESSARY FOR
VSD10,000 WIDE LIFTS LIFTS)

WARNING!!!

IT IS THE INSTALLER'S RESPONSIBILITY TO ENSURE THAT THE GUIDE-INS ARE PROPERLY SET UP SUCH THAT NO PART OF THE GUIDE-INS CAN COME IN CONTACT WITH ANY PART OF THE LIFT, MOTOR, CANOPY RAILS, CANOPY HOOPS, OR CANOPY FABRIC WHILE THE LIFT IS OPERATION. FAILURE TO ADHERE TO THIS WARNING MAY RESULT IN SEVER DAMAGE TO THE LIFT AND/OR ACCESSORIES.

INSTALLATION NOTE

FOR CRADLE PAD/BUNK INSTALLATION, REFER TO THE INCLUDED INSTRUCTIONS WITH THE KIT

BILL OF MATERIALS/EXPLODED VIEW

P/N 511-02285-00		PONTOON GUIDE-INS, 20.5" VSD6500-VSD10K WIDE	
NUMBER	PART NUMBER	QTY.	DESCRIPTION
1	001-70019-00	4	HHCS, 1/4-20 x 4" 18-8 SS
2	001-70119-00	8	HHCS, 3/8-16 x 4" 18-8 SS
3	001-75001-00	4	NUT, NYLOCK 1/4-20 ALUM.
4	001-76349-00	8	NUT, 3/8-16 ALUM.
5	002-04159-00	4	PIPE, PONTOON CRADLE PAD 20.5"
6	002-04285-00	4	CLAMP, BUNK CRADLE (MALE)
7	111-00378-00	2	WELD'T, PONTOON GUIDE-IN SIDE A
8	111-00379-00	2	WELD'T, PONTOON GUIDE-IN SIDE B
9	511-02860-00	1 (4 PER)	VERT. GUIDE-IN COVERS – 18.5"

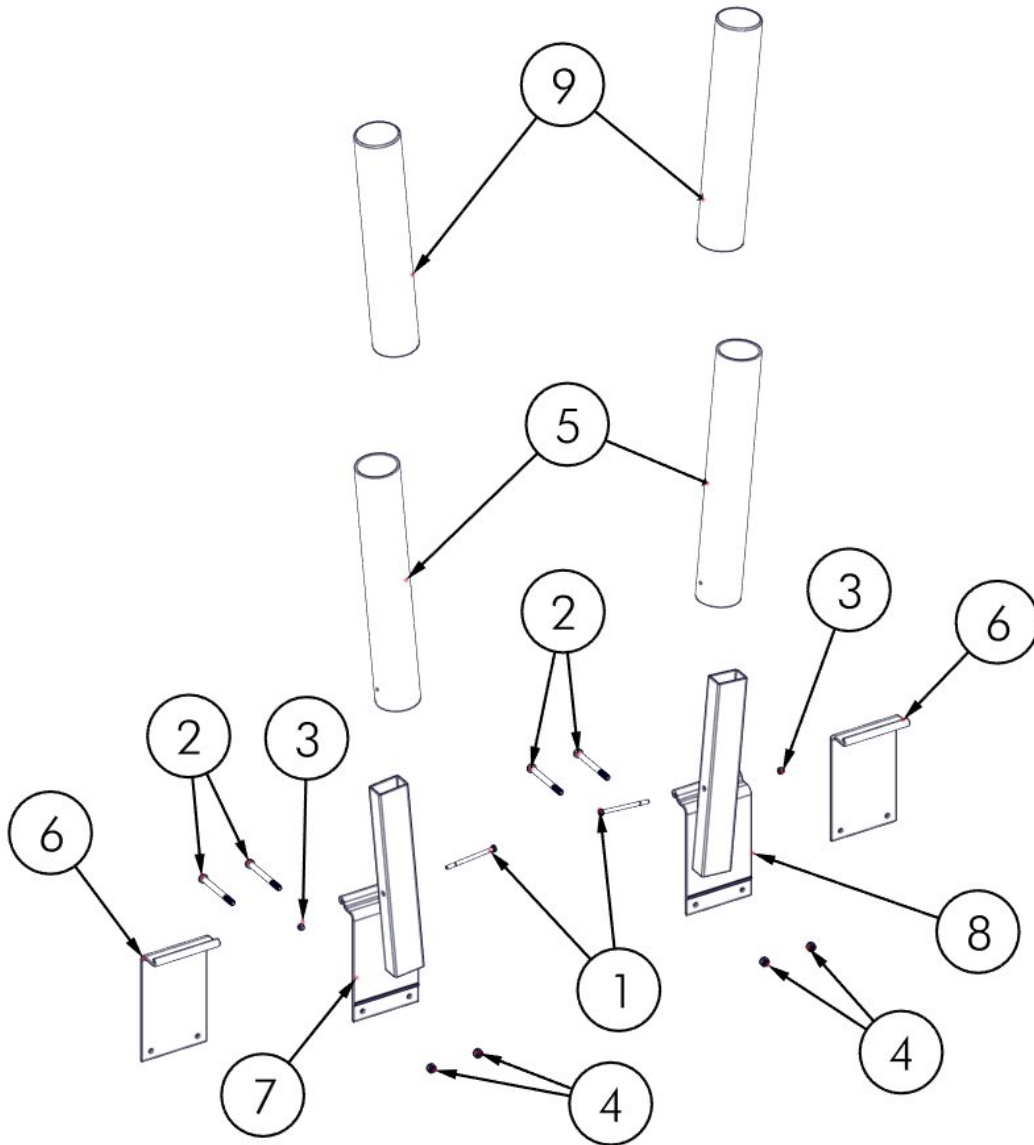

INSTALLATION

INSTALL CRADLE PADS IN DESIRED LOCATIONS (REFER TO INSTRUCTIONS INCLUDED WITH CRADLE PAD/BUNK KIT FOR INSTALLATION AND PLACEMENT. TRI-TOON SETUP IS SHOWN.) (FIGURE 1.1).
SLIDE CLAMPS TOGETHER (FIGURE 1.2).

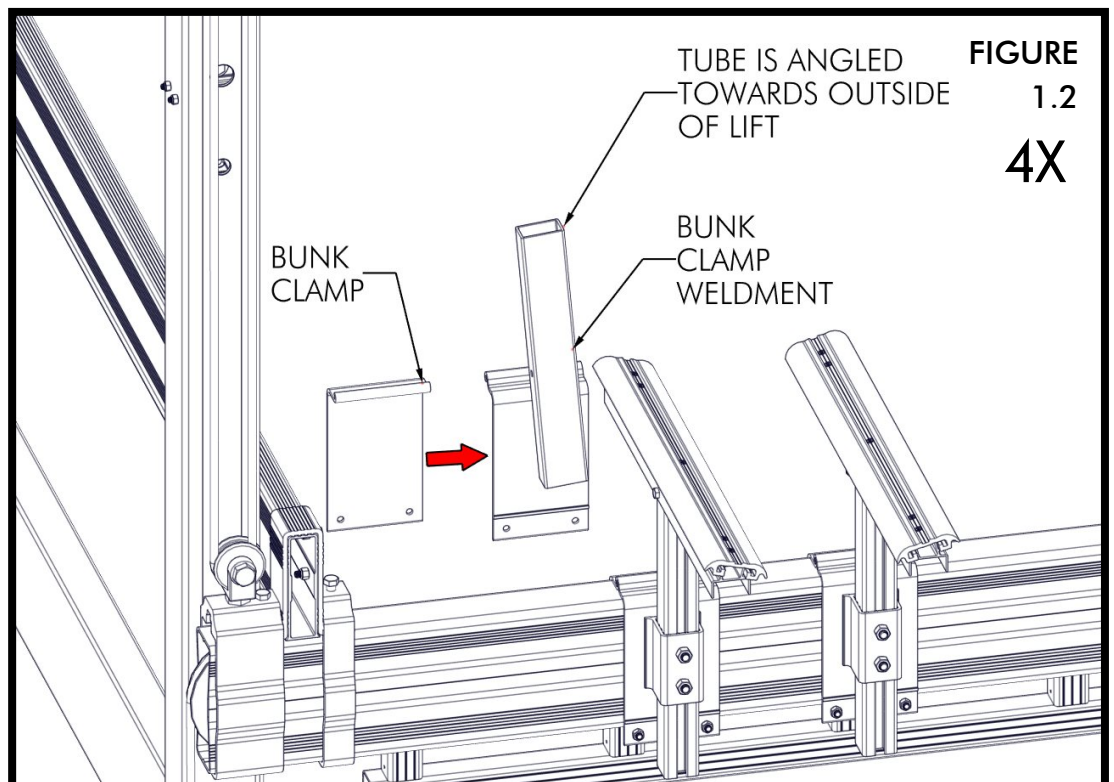
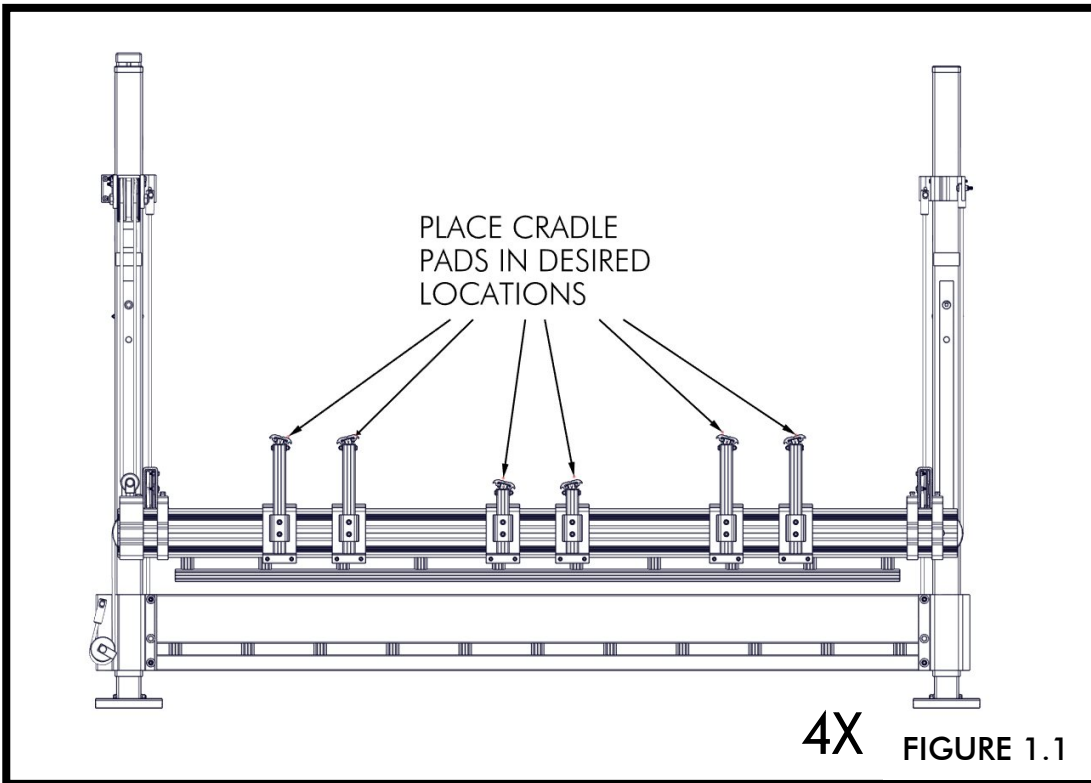

SLIDE GUIDE-IN WELDMENTS ONTO CRADLE BEAMS WITH TUBES ALIGNED TOWARDS THE OUTSIDE OF THE LIFT (FIGURE 1.3). **NOTE: IF CRADLE BEAM WELDMENT IMPEDES BOLT PLACEMENT IN UPRIGHT CLAMPS, DRILL A 13/32" HOLE THROUGH THE 2" TUBES ON THE CRADLE BEAM (VSD10000 INSTALLATIONS ONLY (FIGURE 1.3A).**

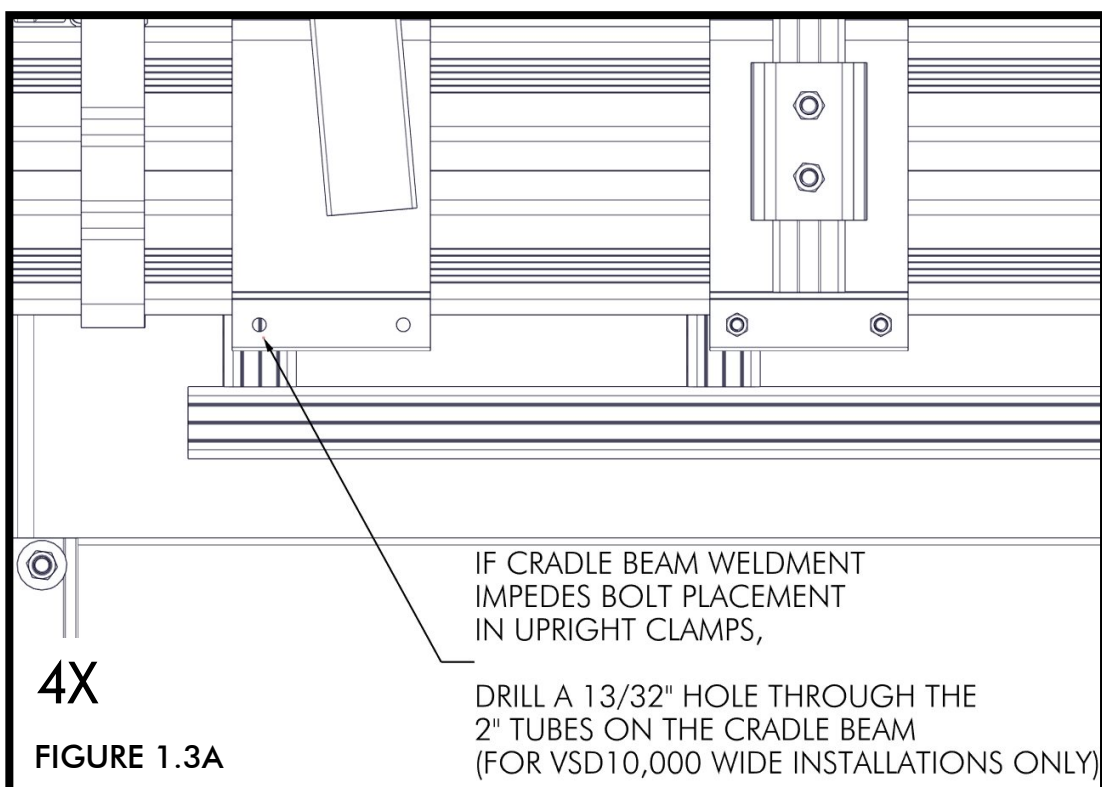
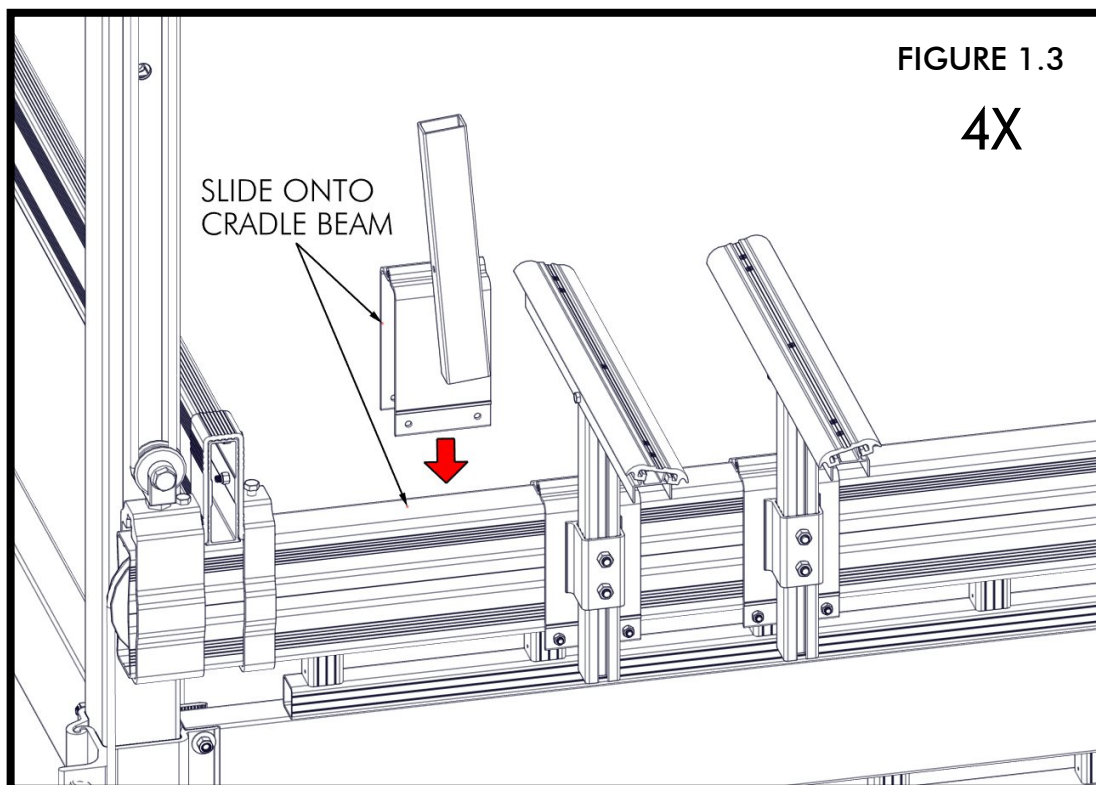

ATTACH WELDMENTS TO THE CRADLE BEAM USING (2) 3/8" X 4" BOLTS AND (2) 3/8" NUTS. DO NOT TORQUE AT THIS TIME (FIGURE 1.4). SLIDE PVC PIPES ONTO THE TUBES ON THE GUIDE-IN WELDMENTS (FIGURE 1.5).

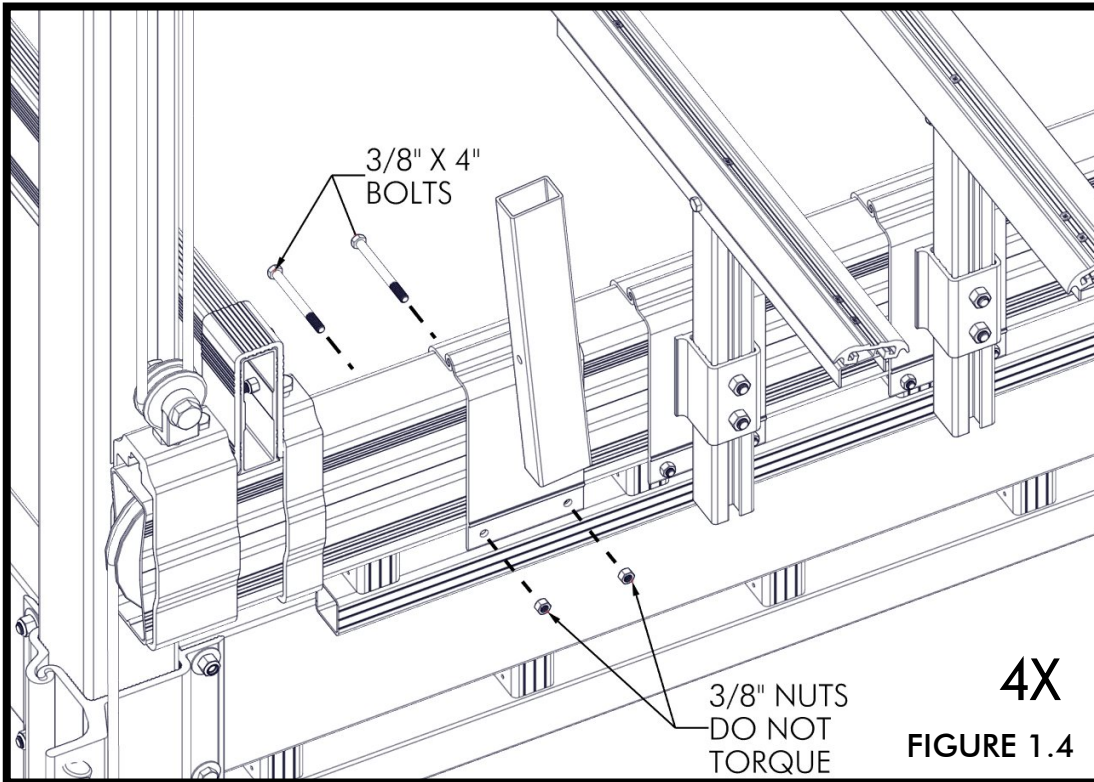

**NOTE: SEE
FIGURE 1.9
FOR GENERAL
GUIDELINES
ON SETUP**

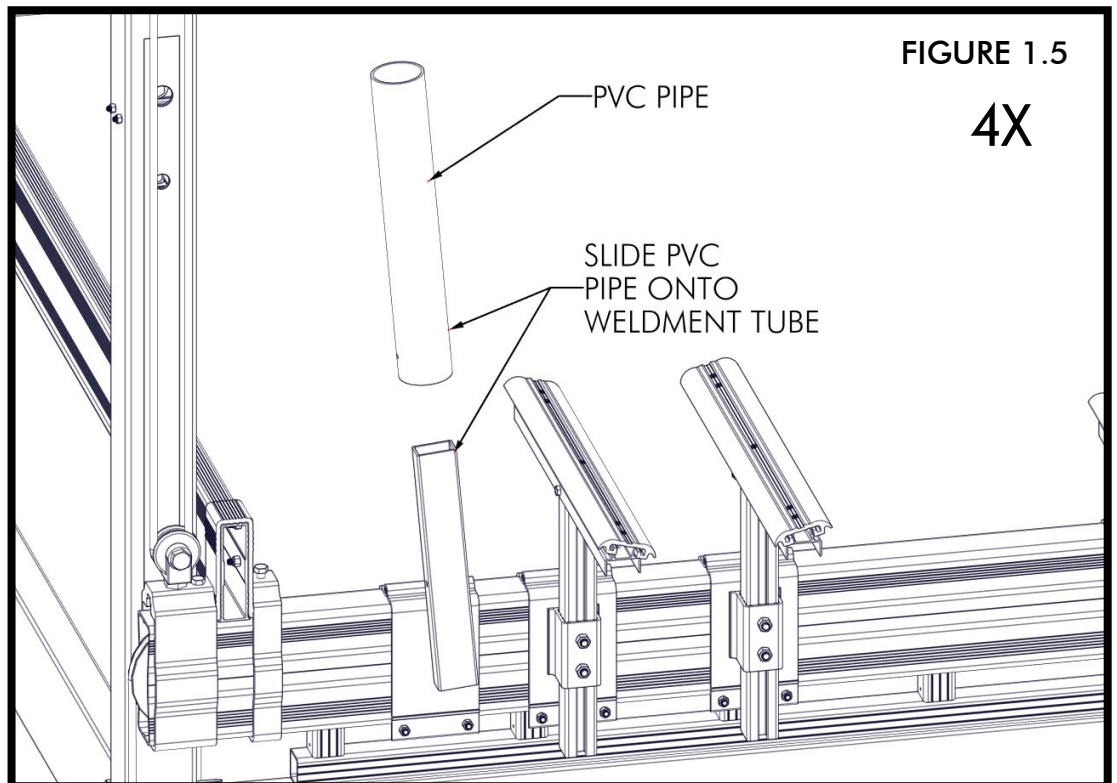

ATTACH USING (1) 1/4" X 4" BOLT AND (1) 1/4" NYLOCK NUT (FIGURE 1.6). TORQUE NUTS TO 10 FT-LB (FIGURE 1.7). SLIDE GUIDE-IN COVERS OVER PVC PIPES (FIGURE 1.8).

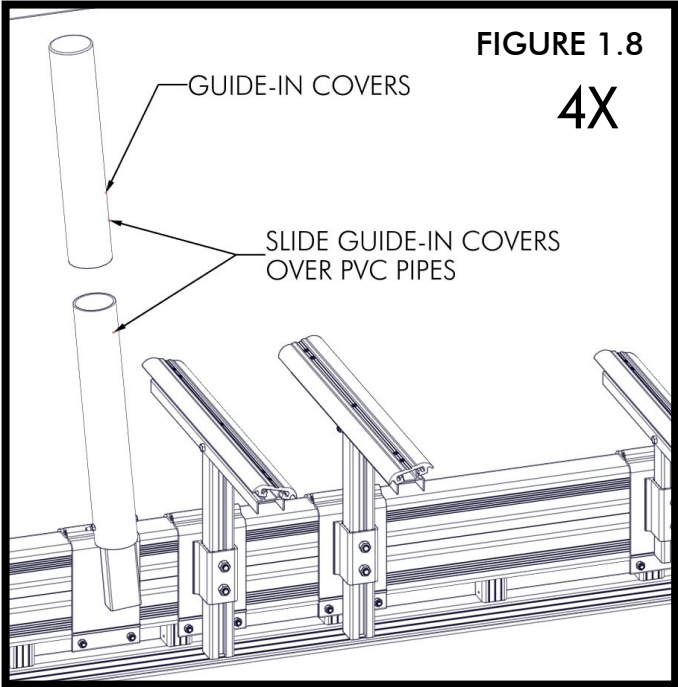
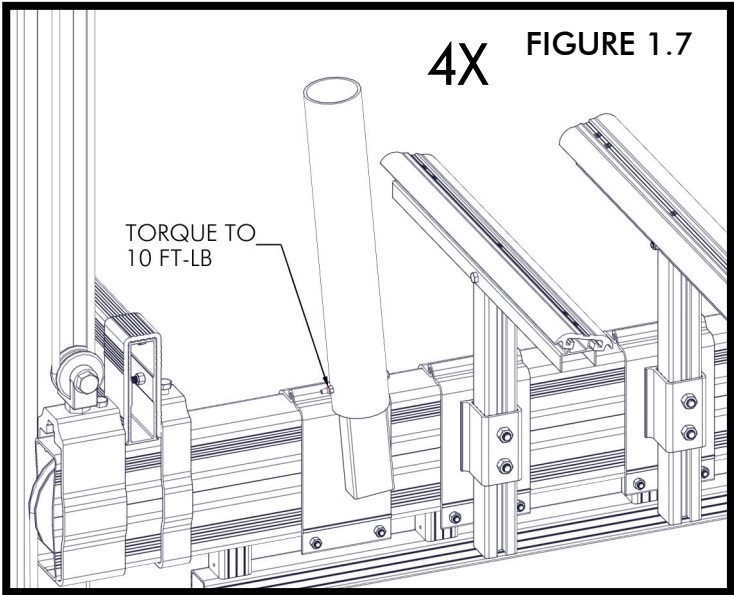
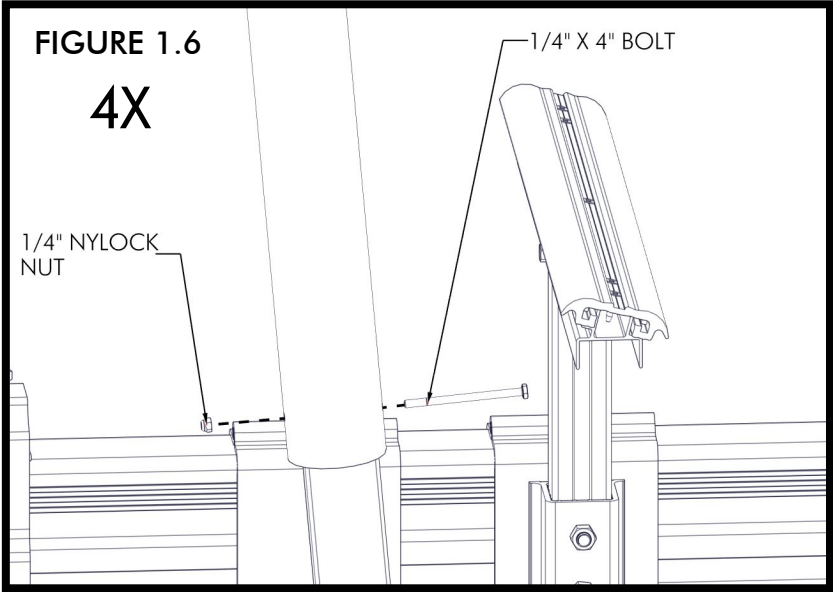

POSITION THE GUIDE-INS SO THEY ARE BUMPING AGAINST THE PONTOONS (TRI-TOON CRADLE PAD SETUP IS SHOWN), BUT NOT BENDING/BINDING WHEN ENTERING OR EXITING THE LIFT. TORQUE 3/8" NUTS TO 35 FT-LB (FIGURE 1.8)

