

# FLOE FRAME CLAMP REPLACEMENT KITS

## NON-LIFTING CORNERS

### ASSEMBLY INSTRUCTIONS

KIT P/N 511-00010-00

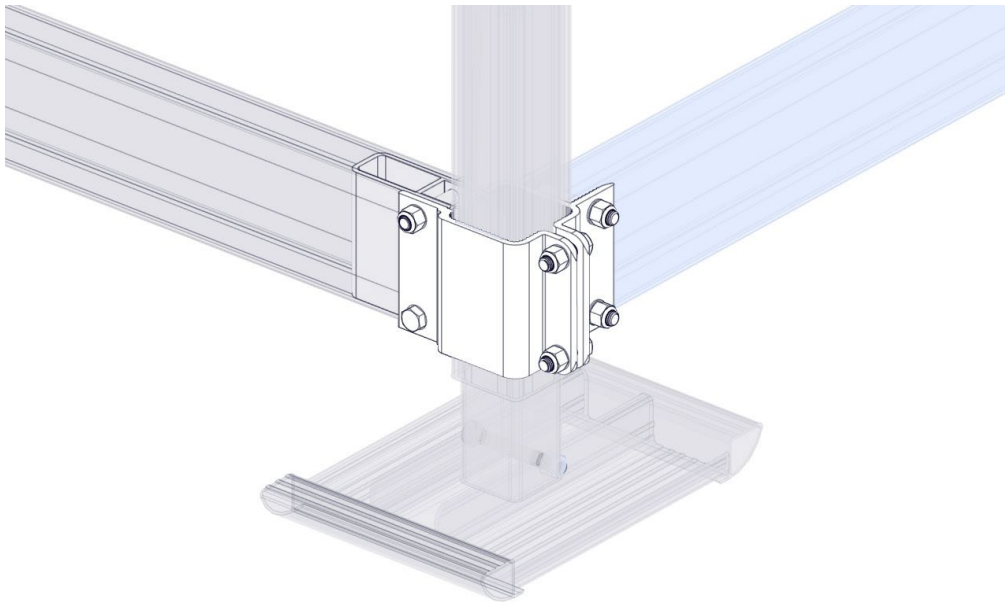

**\*LIFT NOT INCLUDED**

#### TOOLS REQUIRED

- (2) 3/4" SOCKETS/WRENCHES
- (2) 9/16" SOCKETS/WRENCHES
- TAPE MEASURE
- TORQUE WRENCH
- BUCKET (OR EQUIVALENT)
- LIFT INSTRUCTIONS (REFERENCE)

## BILL OF MATERIALS/EXPLODED VIEW

P/N 511-00010-00		KIT, FRAME CLAMP REPL. NON-LIFTING CORNER	
NUMBER	PART NUMBER	QTY.	DESCRIPTION
1	001-70210-00	2	HHCS, 1/2-13 X 1-3/4" 18-8 SS
2	001-70215-00	2	HHCS, 1/2-13 X 3" 18-8 SS
3	001-70217-00	2	HHCS, 1/2-13 X 3-1/2" 18-8 SS
4	001-70219-00	1	HHCS, 1/2-13 X 4" 18-8 SS
5	001-71023-00	12	FLAT WASHER, .5 I.D. X .875" O.D. SS
6	001-76072-00	6	NUT, NYLOCK 1/2-13 ALUM.
7	002-00003-01	1	CLAMP, LOWER FRAME OUTER – 5"
8	002-00005-02	1	CLAMP, FRAME INNER – 4.692" EXT. VERSION

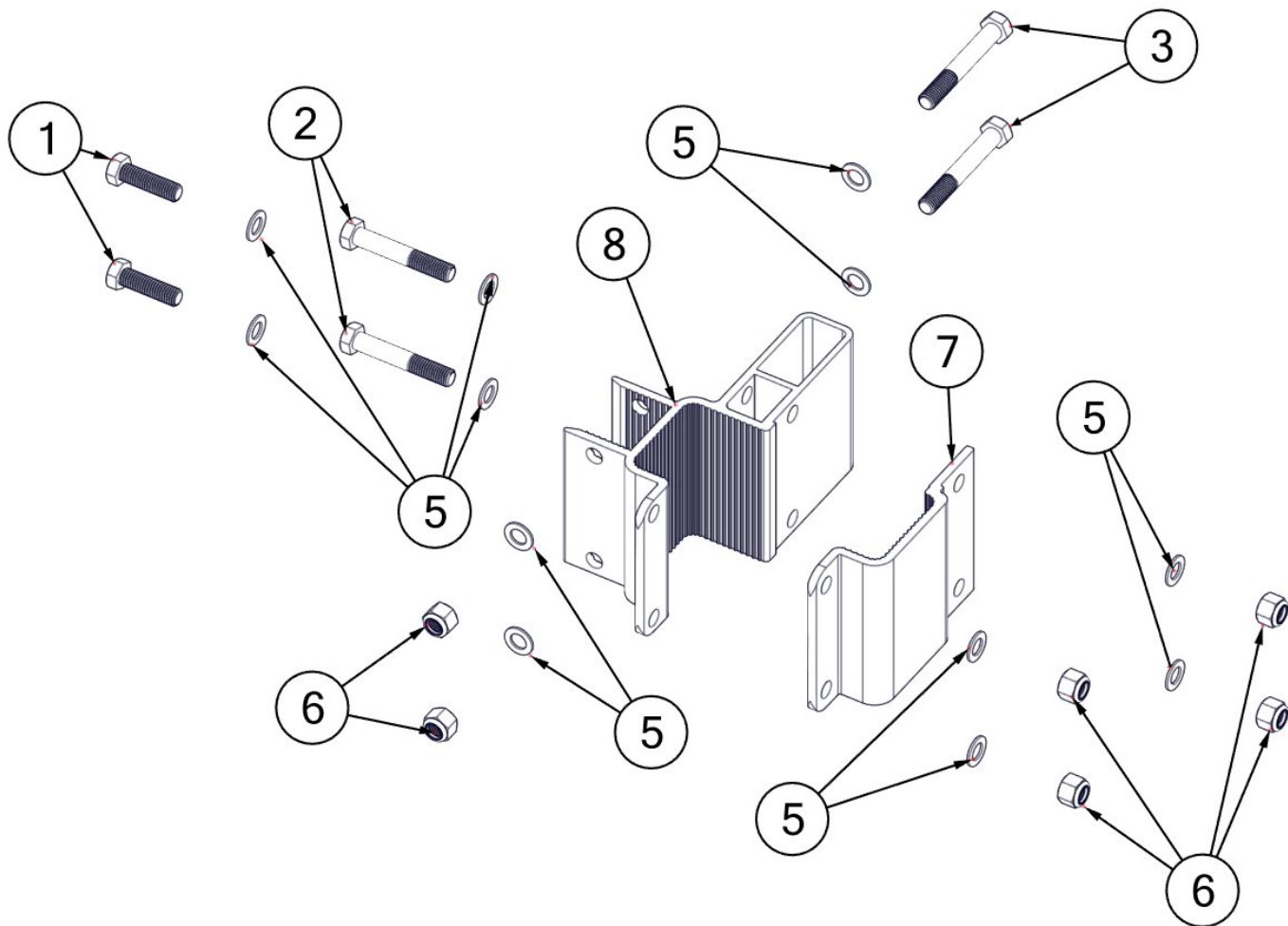

## INSTALLATION

FIRST, LOWER CRADLE COMPLETELY AND SUPPORT USING A BUCKET (OR EQUIVALENT), GIVING ENOUGH CLEARANCE TO REMOVE FRAME BEAM CLAMPS. (FIGURE 1.1). REMOVE HARDWARE HOLDING OUTER CLAMP ONTO FRAME BEAM, REMOVE OUTER CLAMP, AND LOOSEN HARDWARE AT OPPOSITE CORNER POST (FIGURE 1.2).

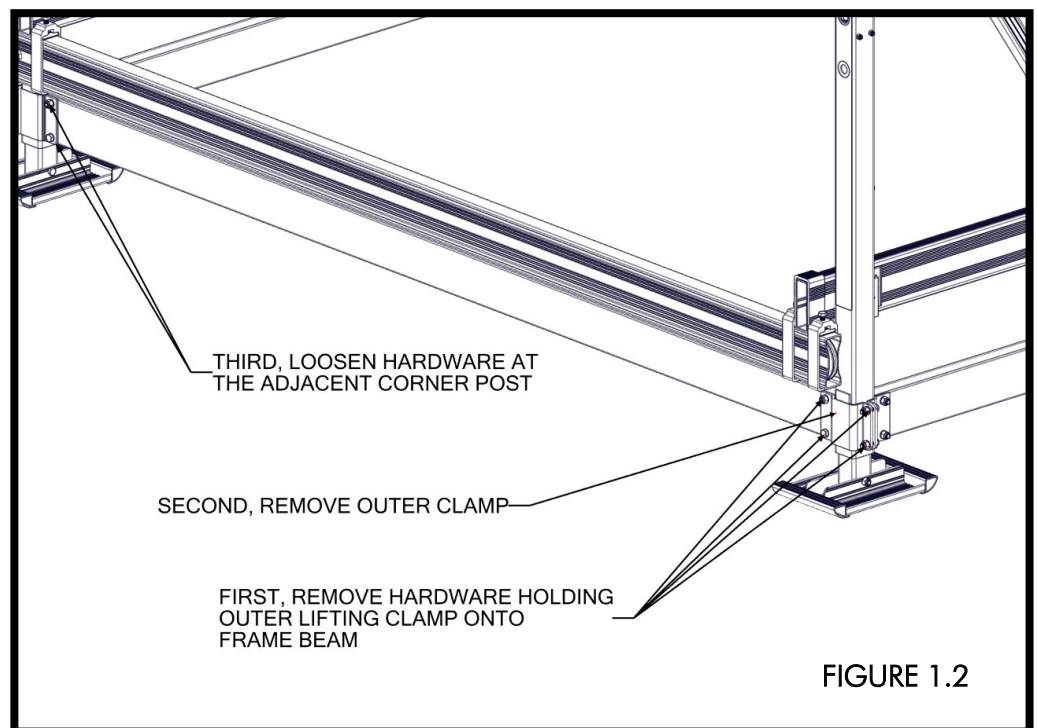
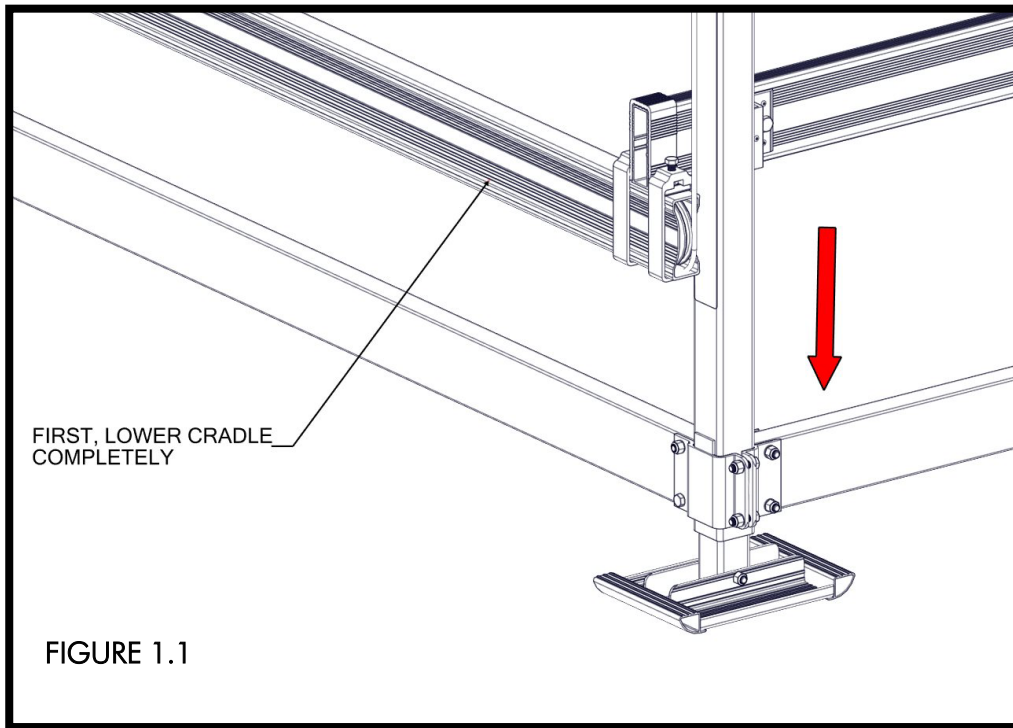

FOR THE V-BRACE SIDE OF THE LIFT, REMOVE V-BRACES AND LOWER V-BRACE CLAMPS WITH ALL HARDWARE, REMOVE HARDWARE HOLDING INNER CLAMP ONTO SIDE FRAME BEAM, LOOSEN HARDWARE AT OPPOSITE CORNER POST, PIVOT SIDE FRAME BEAM OUTWARDS, AND REMOVE INNER CLAMP (FIGURE 1.2A). FOR THE BALL SCREW SIDE OF THE LIFT, REMOVE HARDWARE HOLDING INNER CLAMP ONTO FRAME BEAM, LOOSEN HARDWARE AT OPPOSITE CORNER POST, PIVOT SIDE FRAME BEAM OUTWARDS, AND REMOVE INNER CLAMP (FIGURE 1.2B).

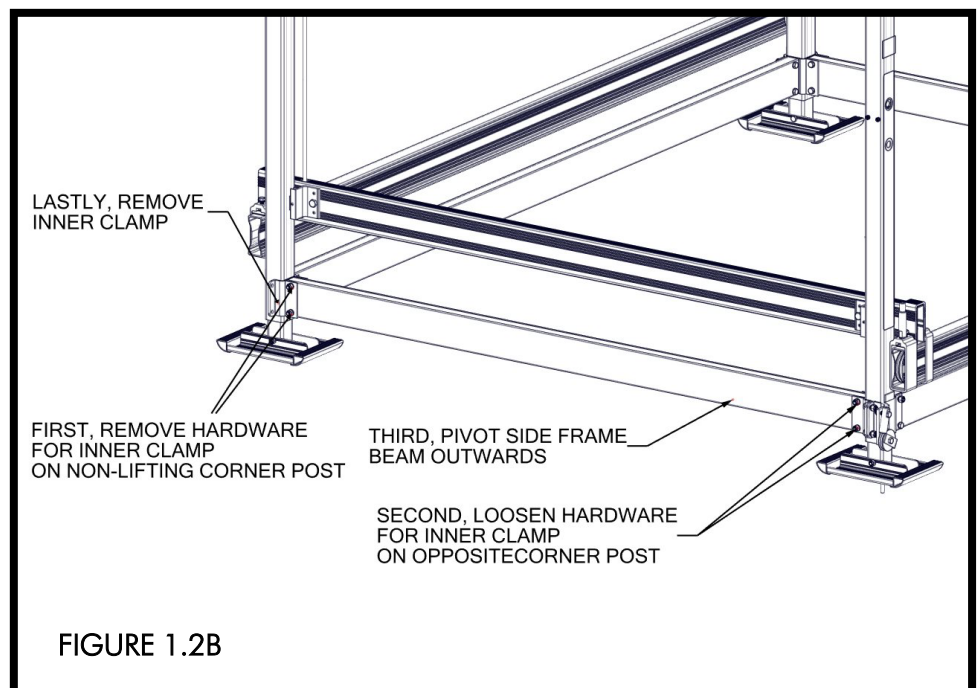
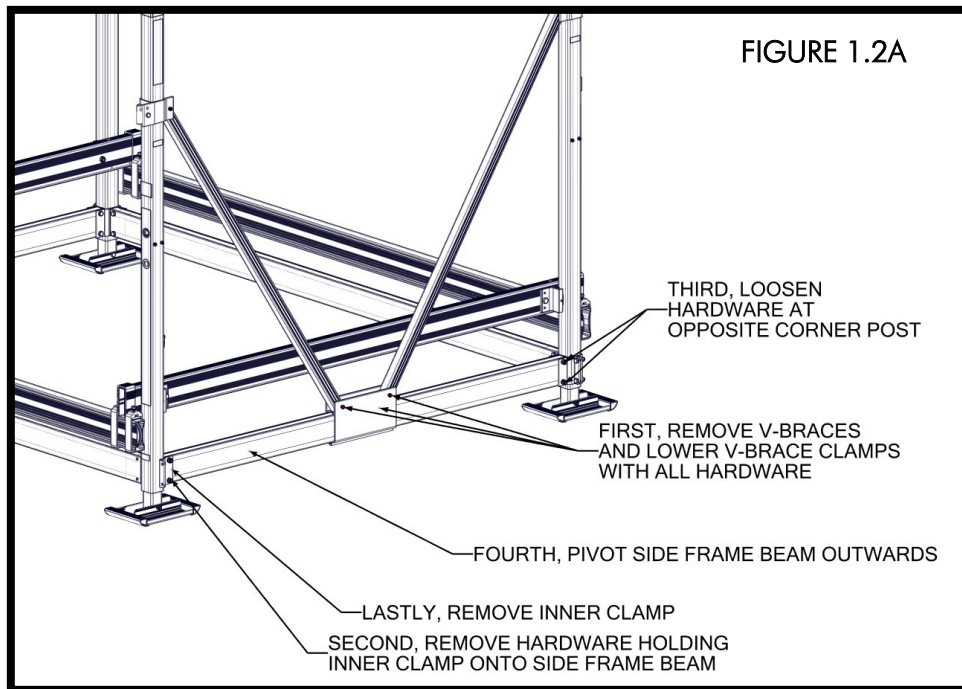

INSERT NEW INNER FRAME BEAM CLAMP INTO FRONT/REAR FRAME BEAM (FIGURE 1.3). PLACE SIDE FRAME BEAM INTO INNER CLAMP (FIGURE 1.4). ATTACH SIDE FRAME BEAM TO INNER CLAMP USING (2) 1/2" X 3-1/2" BOLTS, (4) 1/2" WASHERS, AND (2) 1/2" NYLOCK NUTS. DO NOT TORQUE (FIGURE 1.5).

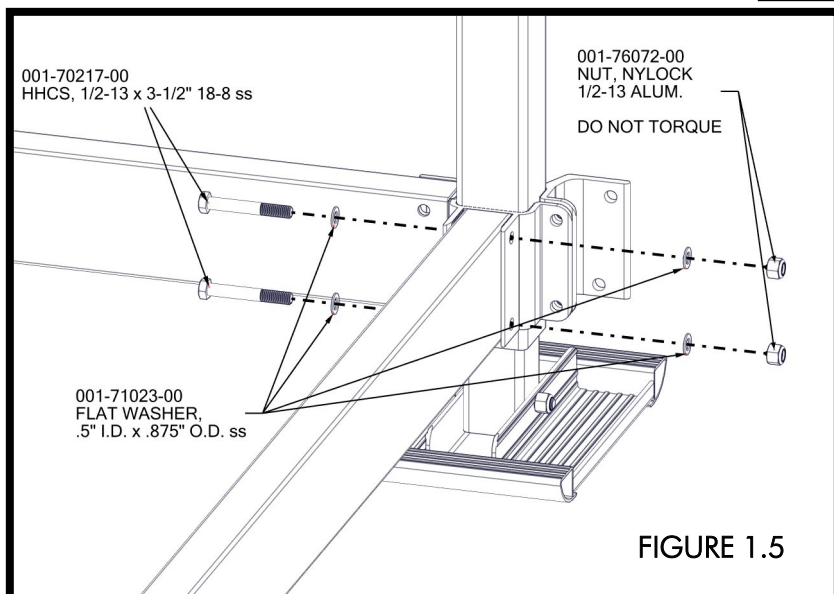
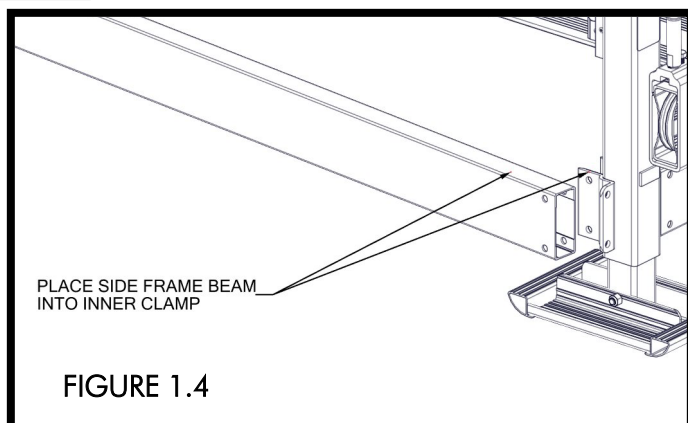
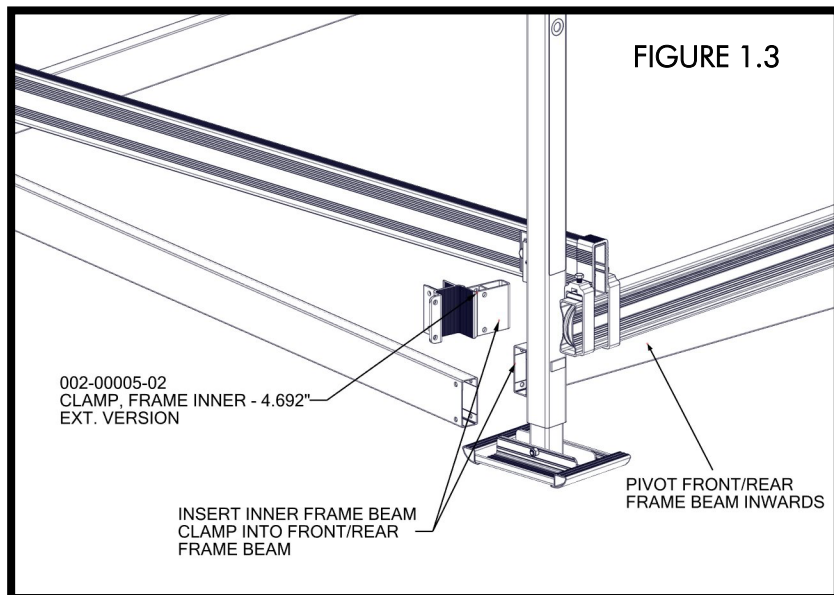



ATTACH OUTER CLAMP TO INNER CLAMP USING (2) 1/2" X 1-3/4" BOLTS, (4) 1/2" WASHERS, AND (2) 1/2" NYLOCK NUTS. ATTACH OUTER CLAMP TO FRONT/REAR FRAME BEAM USING (2) 1/2" X 3" BOLTS, (4) 1/2" WASHERS, AND (2) 1/2" NYLOCK NUT FOR BOTH HOLES IN THE CLAMP (FIGURE 1.6). FOR CORNER POST "D", USE (1) 1/2" X 4" BOLT, (2) 1/2" WASHERS, AND (1) 1/2" NYLOCK NUT FOR THE LOWER HOLE AND SIDE CRADLE CABLE END (FIGURE 1.6A).

ONCE ALL CLAMP BOLTS ARE ATTACHED, TORQUE NUTS FOLLOWING THE TORQUE SEQUENCE SHOWN IN THE FRAME ASSEMBLY INSTRUCTIONS. REPEAT FOR CLAMP HARDWARE AT CORNER POSTS "B" AND "D".

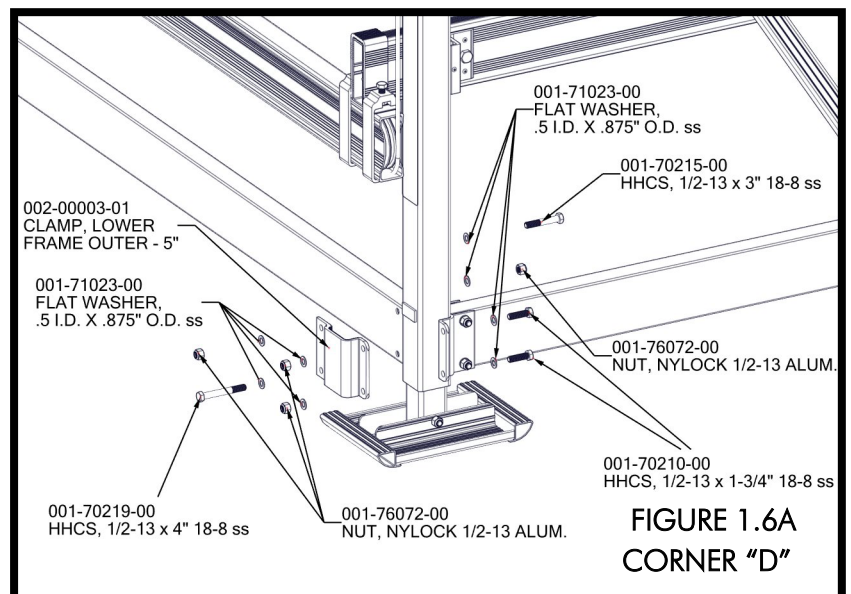
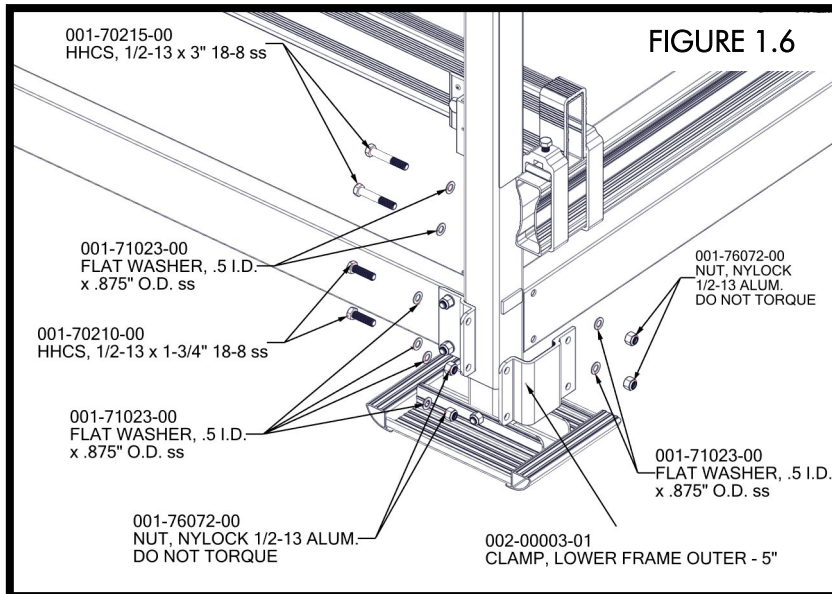

REPLACE THE V-BRACE CLAMPS, V-BRACES, AND HARDWARE. TORQUE NUTS TO 35 FT-LBS (FIGURE 1.7). REFER TO LIFT FRAME INSTRUCTIONS FOR MORE INFORMATION.

