

**FLOE STANDARD ROLL-IN  
LEG CONVERSION KIT**  
(FOR MOUNTING QUICK ATTACH ROLL-IN LEGS  
ON STANDARD ROLL-IN DOCKS)  
ASSEMBLY INSTRUCTIONS  
KIT P/N 510-17700-00

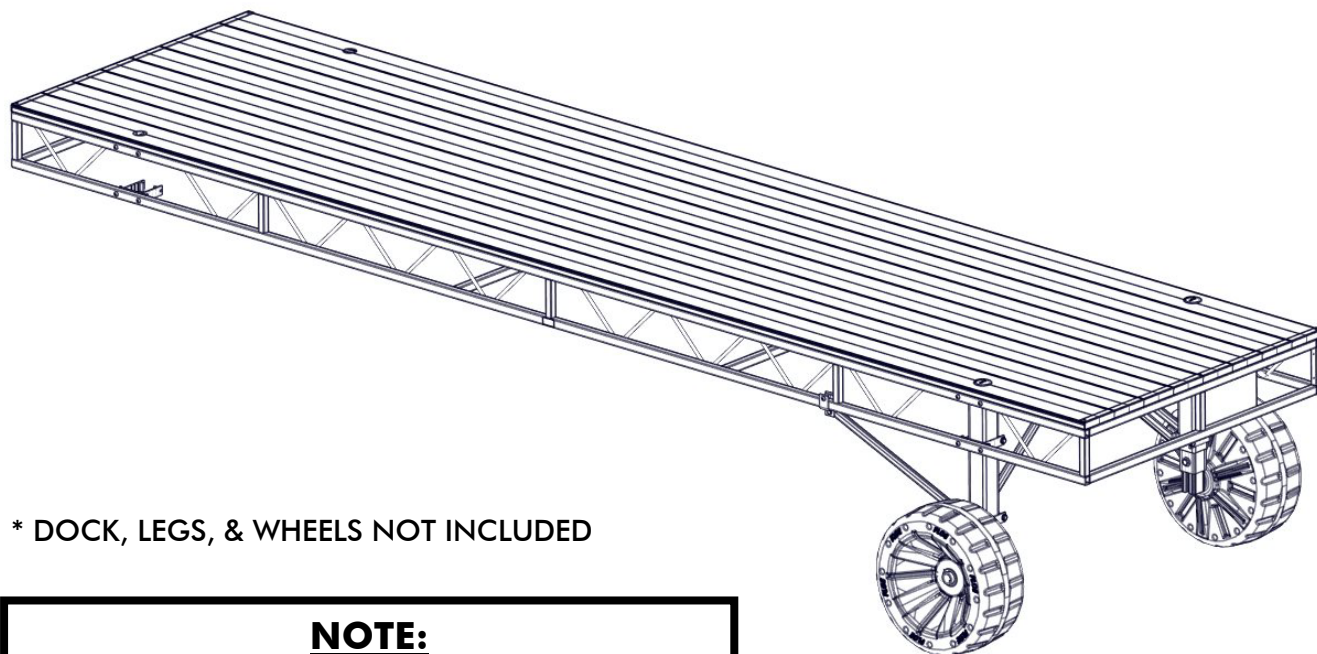

\* DOCK, LEGS, & WHEELS NOT INCLUDED

**NOTE:**  
**REFER TO THE INSTRUCTIONS  
INCLUDED WITH THE WHEEL KIT**

**TOOLS REQUIRED**

- (2) 9/16" SOCKETS/WRENCHES
- TAPE MEASURE
- TORQUE WRENCH

**REFER TO WHEEL KIT INSTRUCTIONS  
FOR ADDITIONAL TOOLS REQUIRED**



NEVER ADJUST YOUR DOCK LEGS WITH  
AN IMPACT WRENCH. NEVER ADJUST  
YOUR DOCK LEGS WITH MORE THAN 15  
FT-LBS OF FORCE. APPLYING TOO MUCH  
FORCE TO YOUR DOCK LEGS WILL  
DAMAGE THE MECHANISM.

## BILL OF MATERIALS/EXPLODED VIEW

P/N 510-17700-00		KIT, STD. ROLL-IN LEG CONVERSION	
NO.	PART NUMBER	DESCRIPTION	QTY
1	001-17700-00	FASTENERS, STD. ROLL-IN LEG CONVERSION KIT	1
1A	001-70113-00	HHCS, 3/8-16 X 2-1/2" 18-8 SS	2
1B	001-70119-00	HHCS, 3/8-16 X 4" 18-8 SS	4
1C	001-71017-00	FLAT WASHER, 3/8" SAE SS 18-8	14
1D	001-73818-00	BHCS, 3/8-16 X 1-3/4" SS 18-8	4
1E	001-76349-00	NUT, 3/8-16 ALUM.	10
2	002-02080-00	CONNECT, QUICK – DOCK	2
3	002-02136-00	BRACKET, DOCK SIDE BRACE	4
4	006-13200-00	CAPLUG, 2" ROUND (DOCK) REV C	2

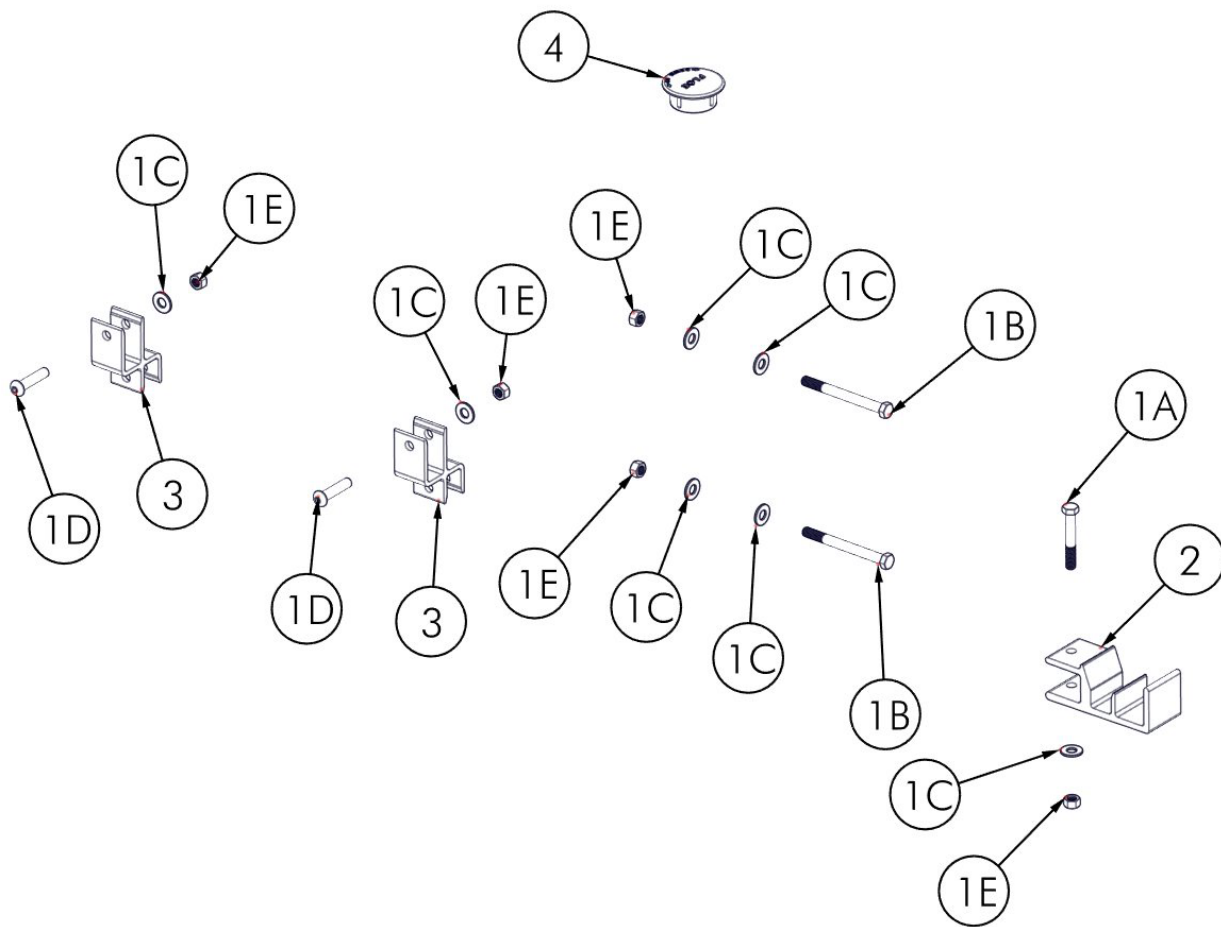

## ASSEMBLY

**NOTE: MEDIUM WHEEL KIT LEGS ARE SHOWN. REFER TO INSTRUCTIONS INCLUDED WITH THE WHEEL KIT.**

TURN DOCK UPSIDE DOWN AND BLOCK CORNERS (OR USE A SOFT SURFACE) TO PROTECT THE DECK SURFACE (FIGURE 1.1). SLIDE THE WHEEL KIT BRACKETS ONTO THE WHEEL KIT LEGS (FIGURE 1.2) (INCLUDED WITH WHEEL KIT).

FIGURE 1.1

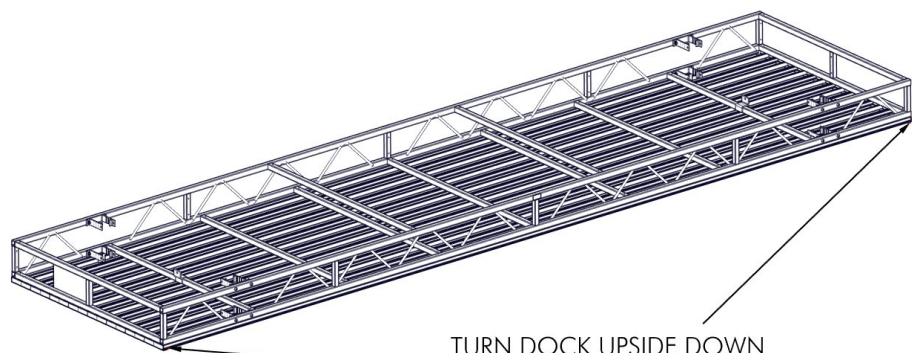

TURN DOCK UPSIDE DOWN

PLACE BLOCKING UNDER  
CORNERS TO PROTECT DECKING

FIGURE 1.2

2X

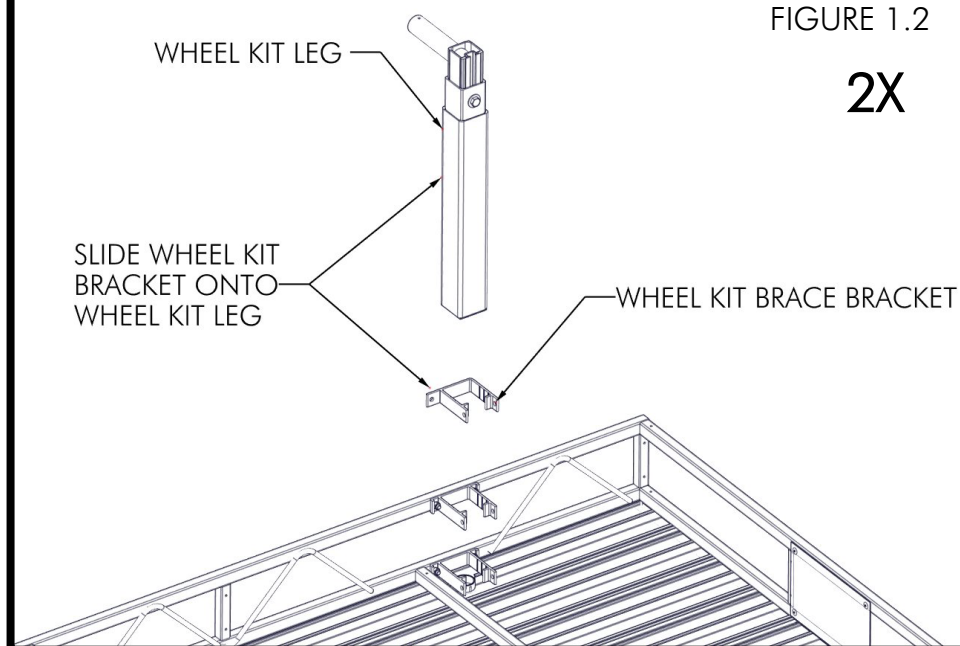

WHEEL KIT LEG

SLIDE WHEEL KIT  
BRACKET ONTO  
WHEEL KIT LEG

WHEEL KIT BRACE BRACKET

INSERT WHEEL KIT LEGS INTO THE BRACKETS THAT ARE INSTALLED ON THE DOCK (FIGURE 1.3). CLAMP THE BRACKETS TO THE LEGS USING (1) 3/8" X 4" BOLT, (2) 3/8" WASHERS, AND (1) 3/8" NUT PER BRACKET. DO NOT TIGHTEN UNTIL BOLT LEGS ARE ASSEMBLED AND ALL BOLTS ARE INSTALLED (FIGURE 1.4).

FIGURE 1.3

2X

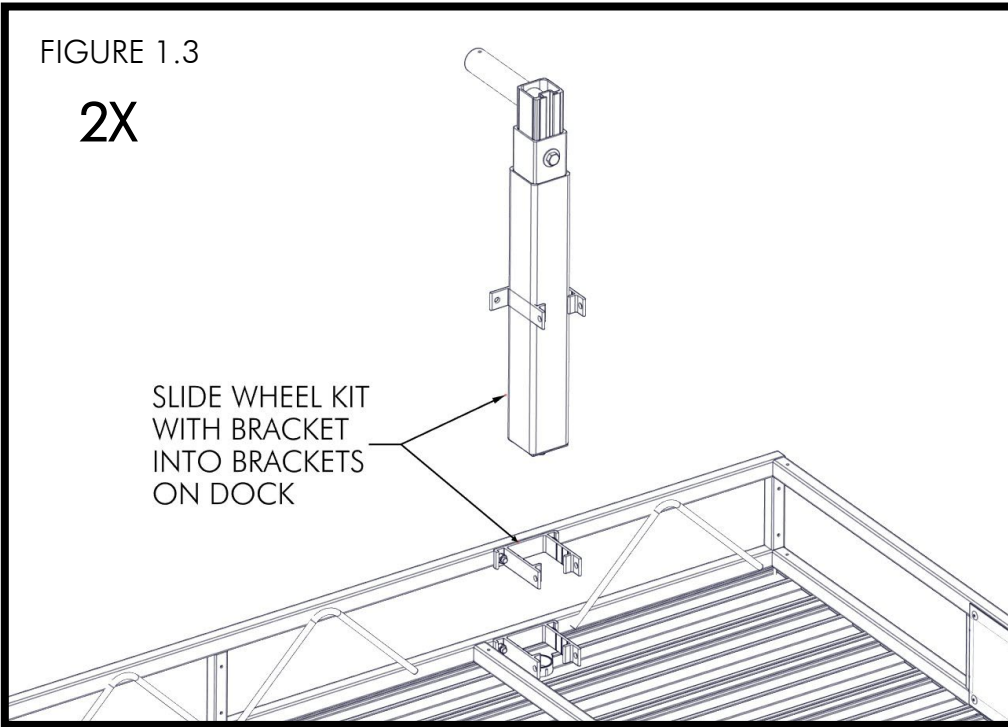
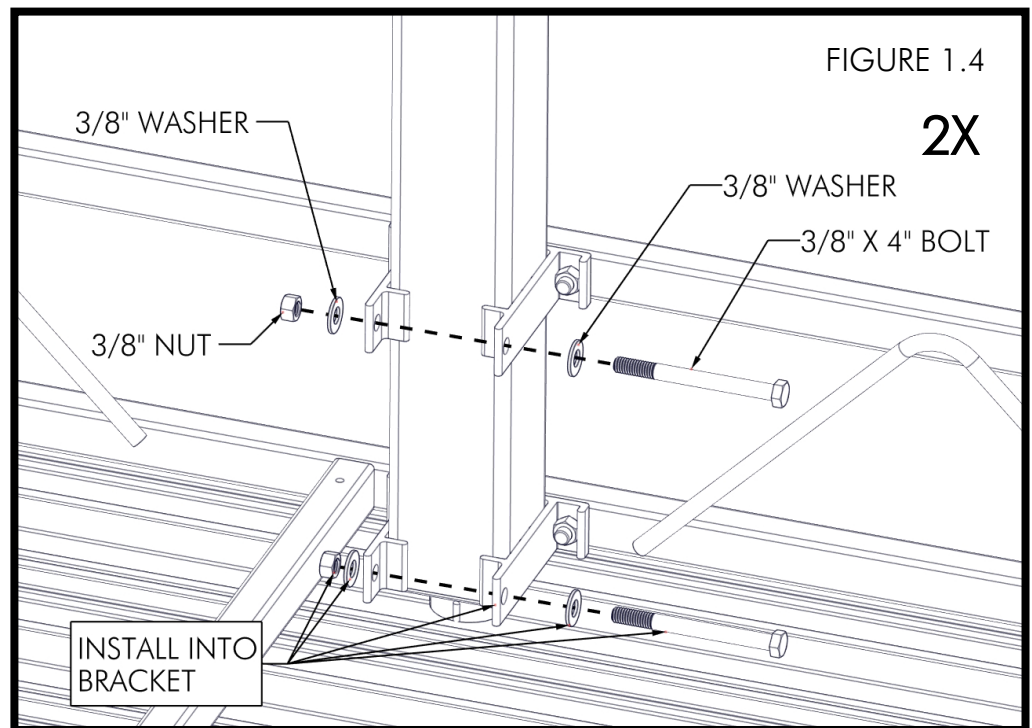

FIGURE 1.4

2X



**NOTE: MEDIUM WHEEL KIT LEG IS SHOWN. REFER TO THE INSTRUCTIONS INCLUDED WITH THE WHEEL KIT.** ATTACH THE 26" CENTER BRACES TO THE WHEEL KIT BRACKET WITH (1) 3/8" X 5" BOLT, (2) 3/8" WASHERS, AND (1) 3/8" NUT PER BRACE (FIGURE 1.5) (INCLUDED WITH WHEEL KIT HARDWARE). ATTACH THE 26" SIDE BRACES TO THE WHEEL KIT BRACKET WITH (1) 3/8" X 1-3/4" BOLT, (2) 3/8" WASHERS, AND (1) 3/8" NUT PER BRACE (FIGURE 1.6) (INCLUDED WITH WHEEL KIT HARDWARE).

FIGURE 1.5

2X

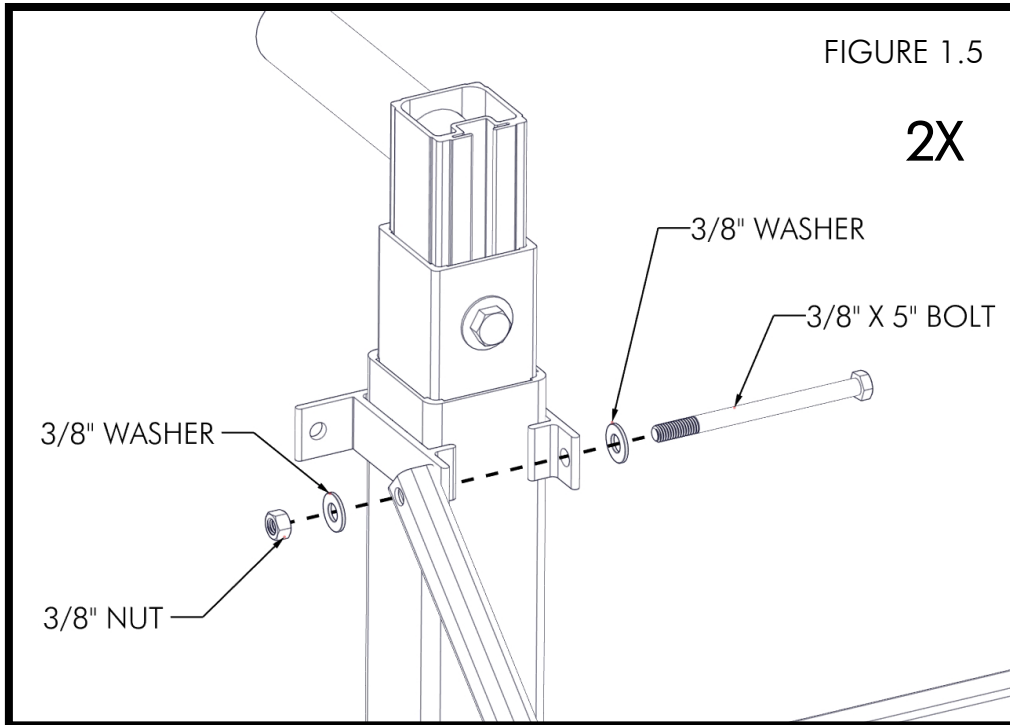
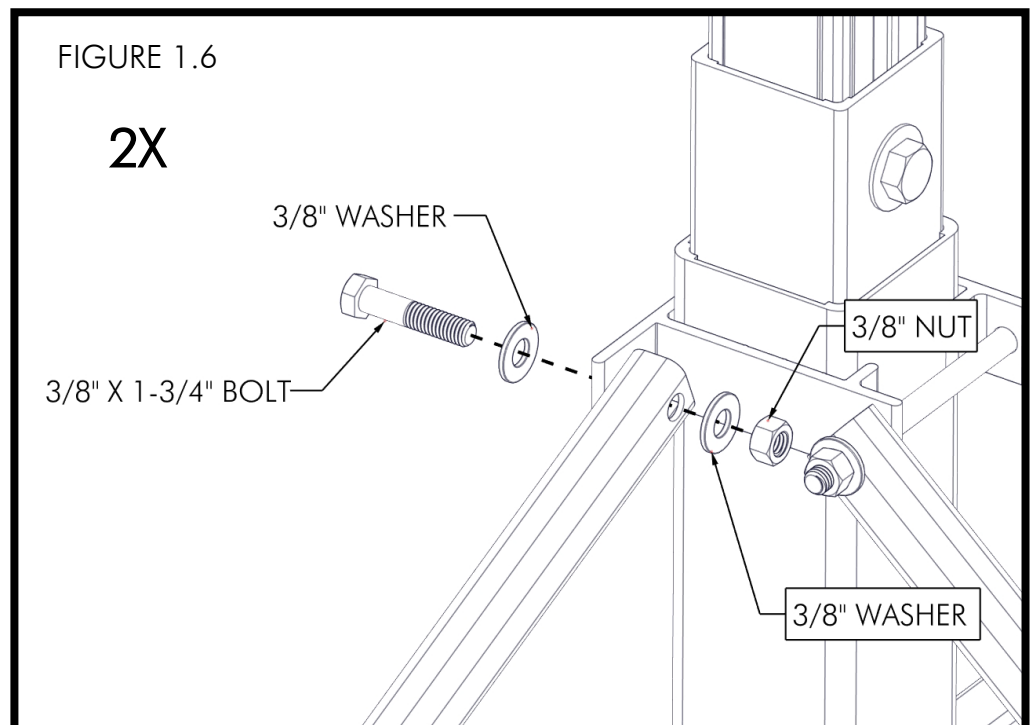

FIGURE 1.6

2X





ATTACH THE 26" SIDE BRACES TO THE SIDE BRACE BRACKET USING (1) 3/8" X 1-3/4" BOLT, (2) 3/8" WASHERS, AND (1) 3/8" NUT PER BRACKET. ATTACH THE SIDE BRACE BRACKET TO THE DOCK USING (1) 3/8" X 1-3/4" BUTTON HEAD BOLT, (1) 3/8" WASHER, AND (1) 3/8" NUT PER BRACKET (FIGURE 1.7) **\*FOR X-DEEP & XX-DEEP WHEEL KITS, THERE ARE (4) DOCK SIDE BRACE BRACKETS FOR ATTACHING THE SIDE BRACES TO THE DOCK FRAME.** CONNECT THE END OF THE (2) CENTER BRACES TO THE BRACKET ON THE DOCK USING (1) 3/8" X 2-3/4" BOLT, (2) 3/8" WASHERS, AND (1) 3/8" NUT (FIGURE 1.8).

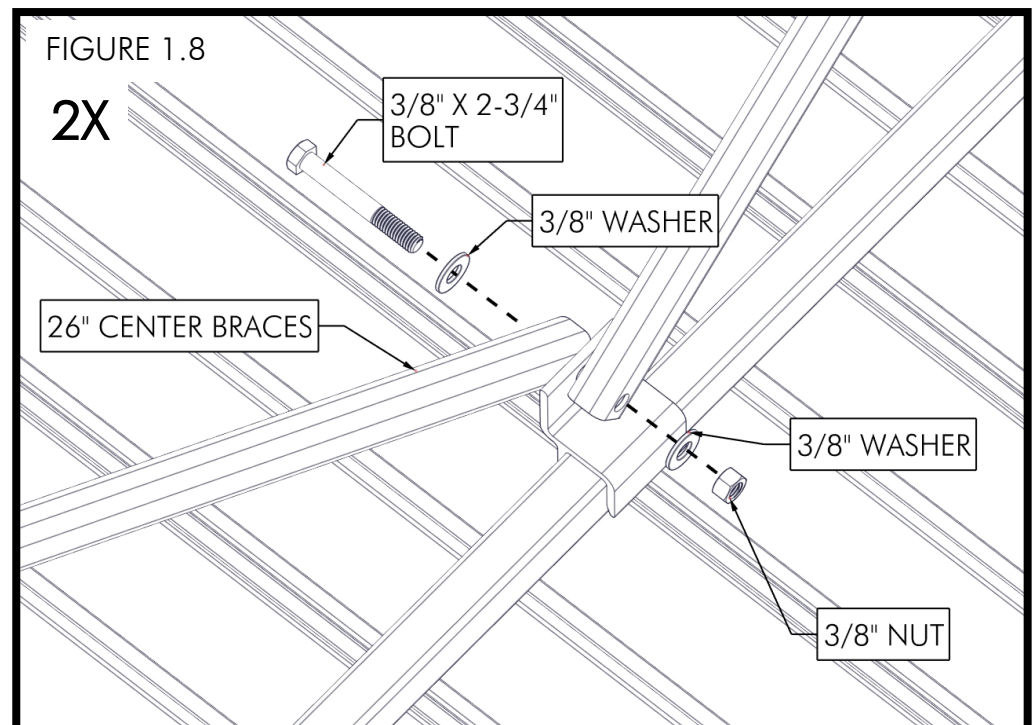
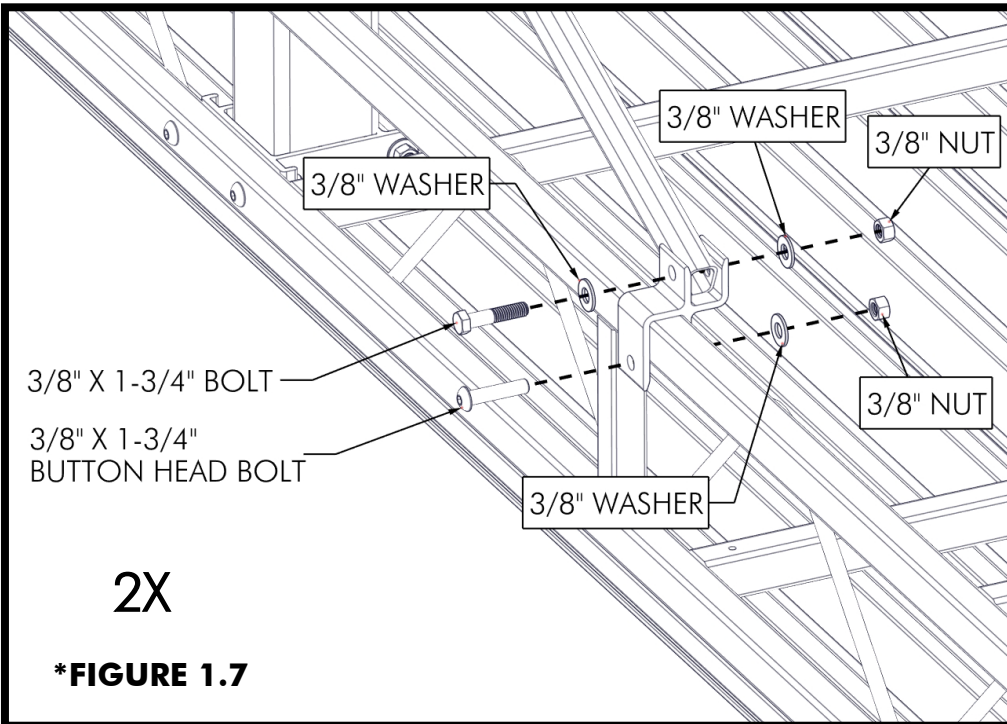

**REFER TO THE WHEEL KIT INSTRUCTIONS FOR ADJUSTING THE INNER LEG (SHALLOW & MEDIUM WHEEL KITS).** SQUARE THE WHEEL KIT LEGS WITH THE DOCK. TIGHTEN ALL NUTS TO THE TORQUE SPECIFICATIONS SHOWN (FIGURE 1.9). SLIDE WHEEL(S) (SOLD SEPARATELY) ONTO THE SPINDLE ON THE WHEEL KIT AND PLACE A 2-1/2" WASHER ONTO THE SPINDLE (FIGURE 1.10).

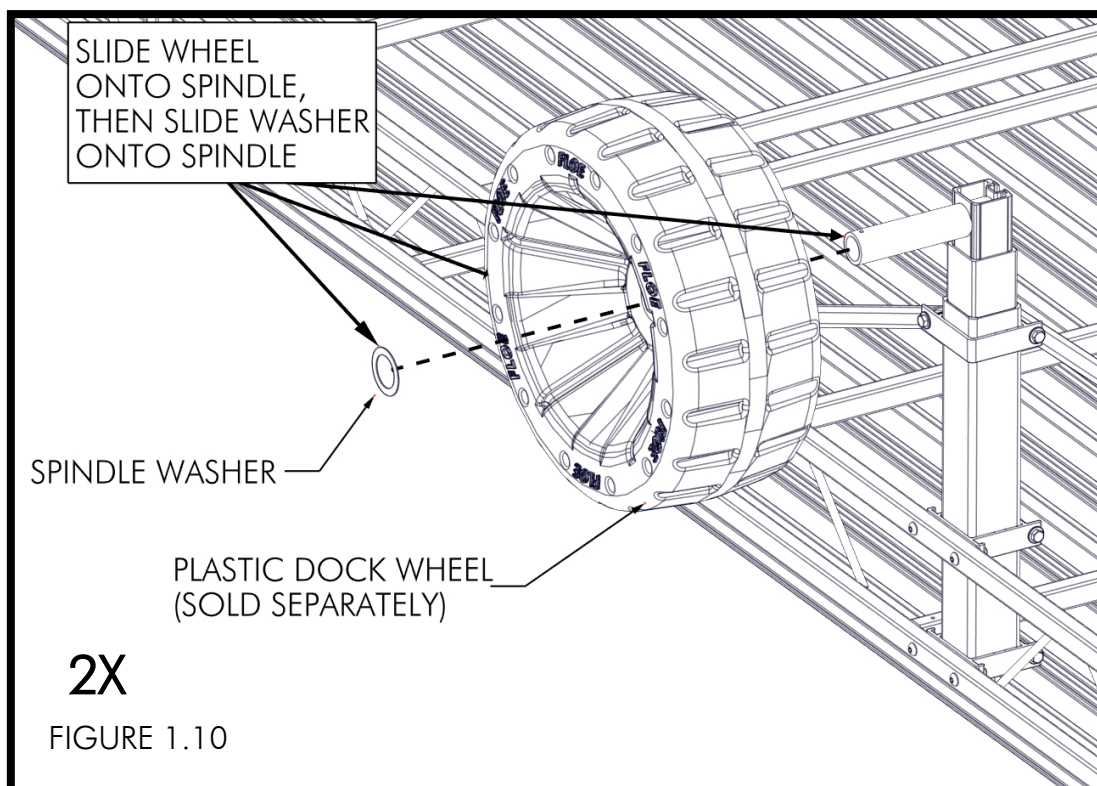
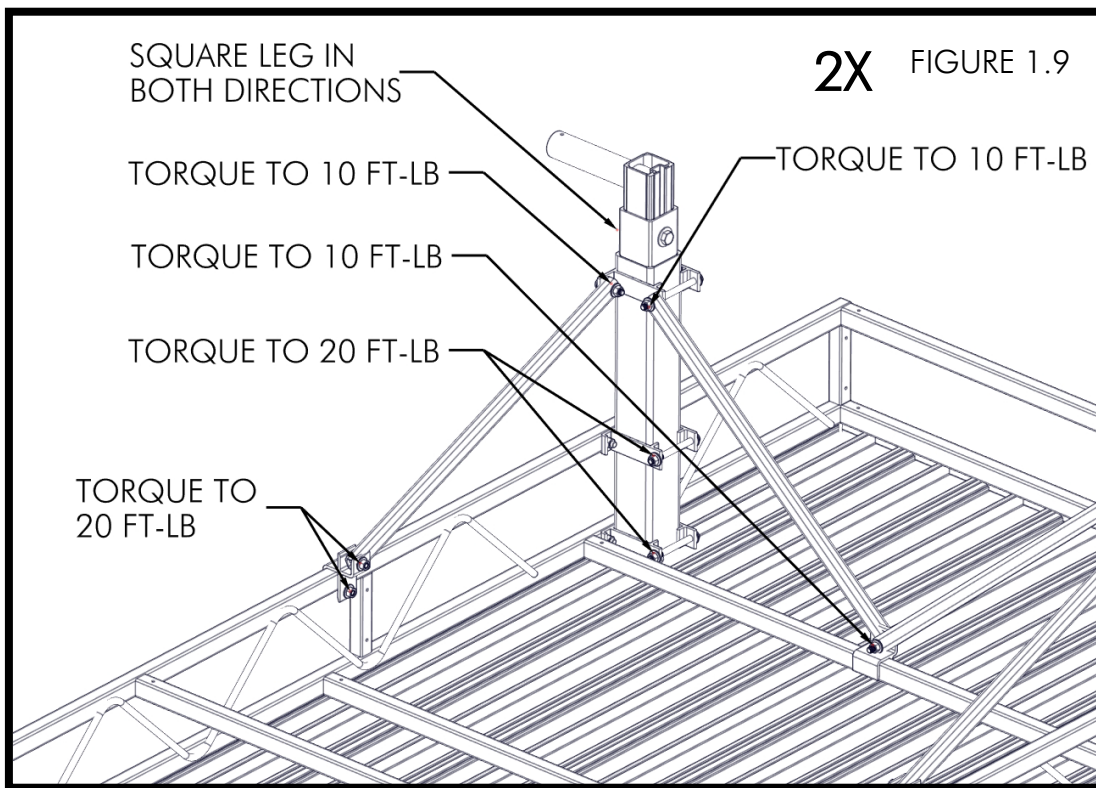

INSERT SPINDLE CLIP LEG INTO ONE OF THE HOLES IN THE SPINDLE, THEN PULL CLIP DOWN TO SNAP OTHER CLIP LEG INTO THE SECOND HOLE (FIGURE 1.11). TURN THE DOCK RIGHT SIDE UP (FIGURE 1.12).

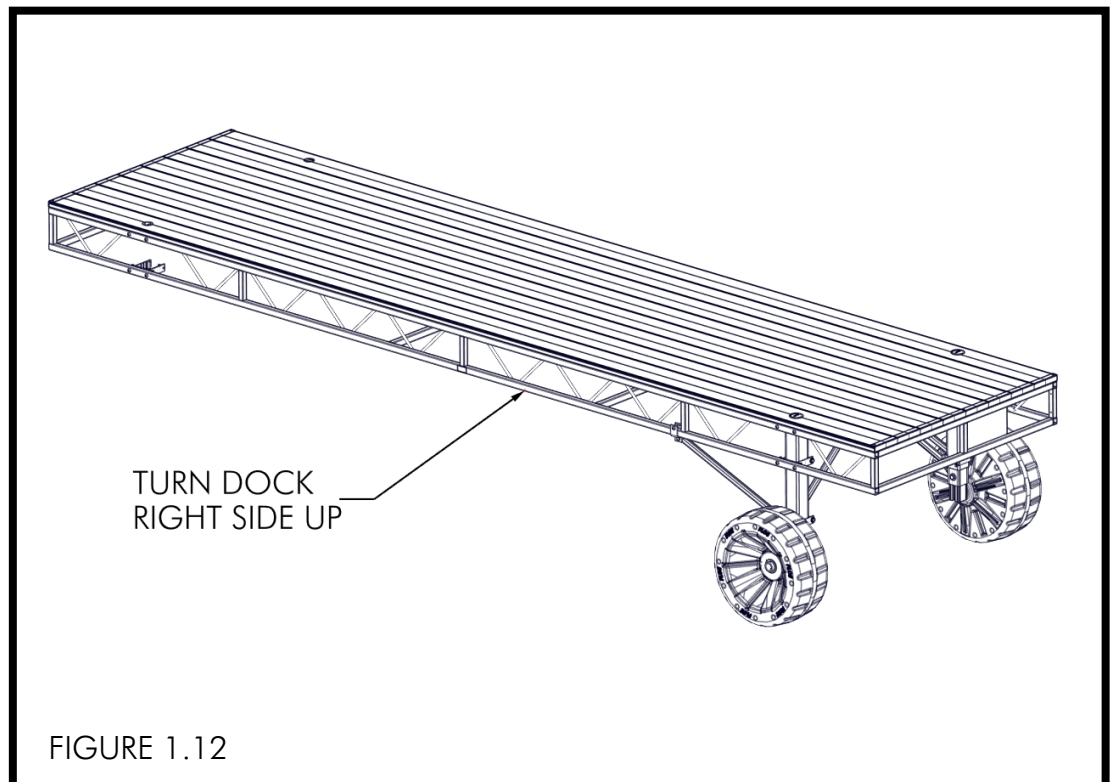
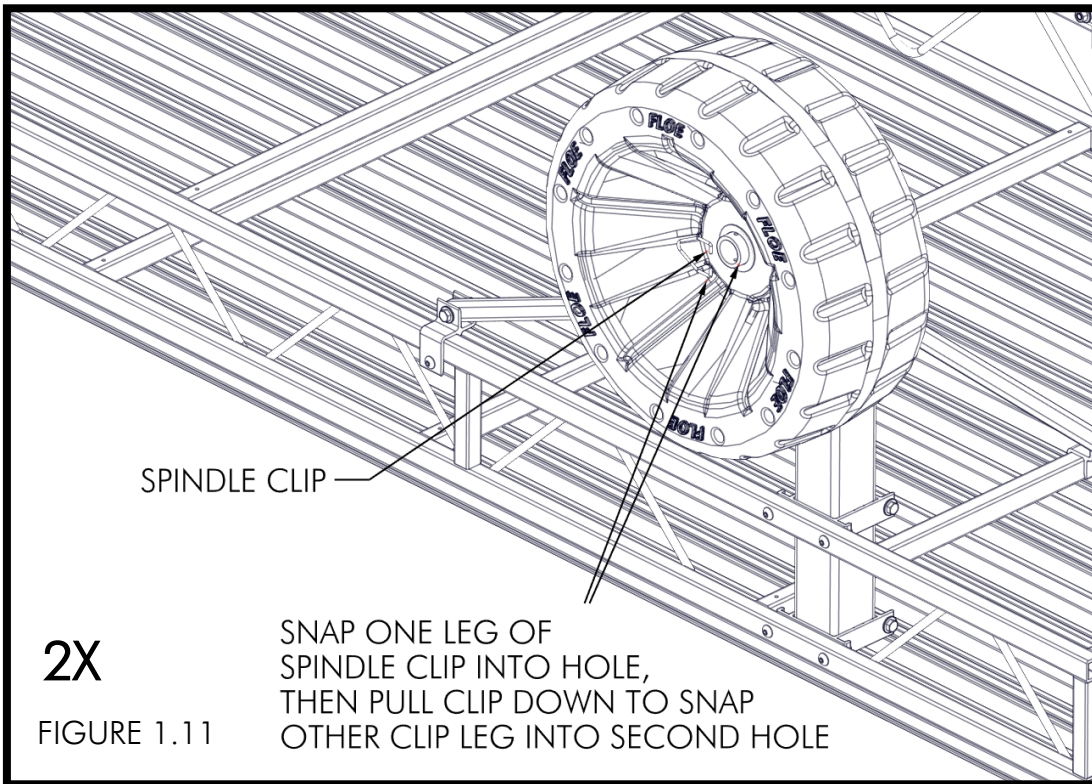



TO ATTACH DOCK SECTIONS IN A STRAIGHT LINE, ATTACH THE QUICK CONNECT TO THE DOCK (FIGURE 1.13) WITH (1) 3/8" X 2-1/2" BOLT, (1) 3/8" WASHER, AND (1) 3/8" NUT PER CONNECT (FIGURE 1.14). WITH THE CONNECTS SPREAD AS FAR APART AS POSSIBLE TO KEEP THE JOINING SECTION FROM SHIFTING SIDWAYS, TORQUE NUTS TO 30 FT-LB (FIGURE 1.15).

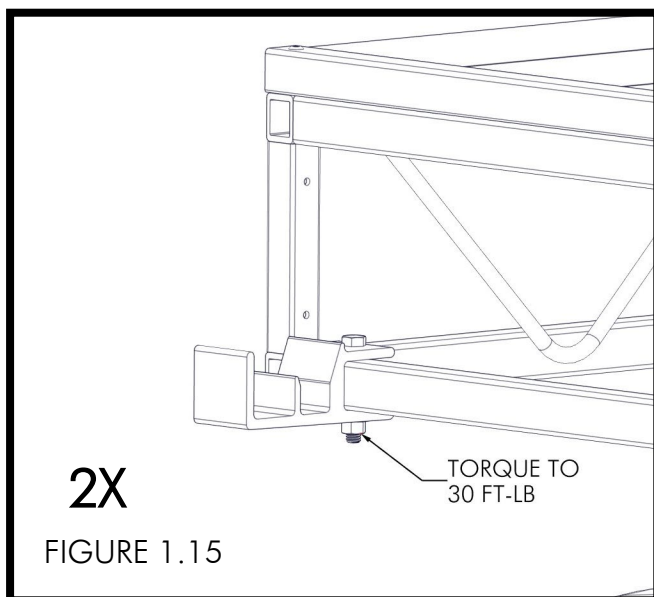
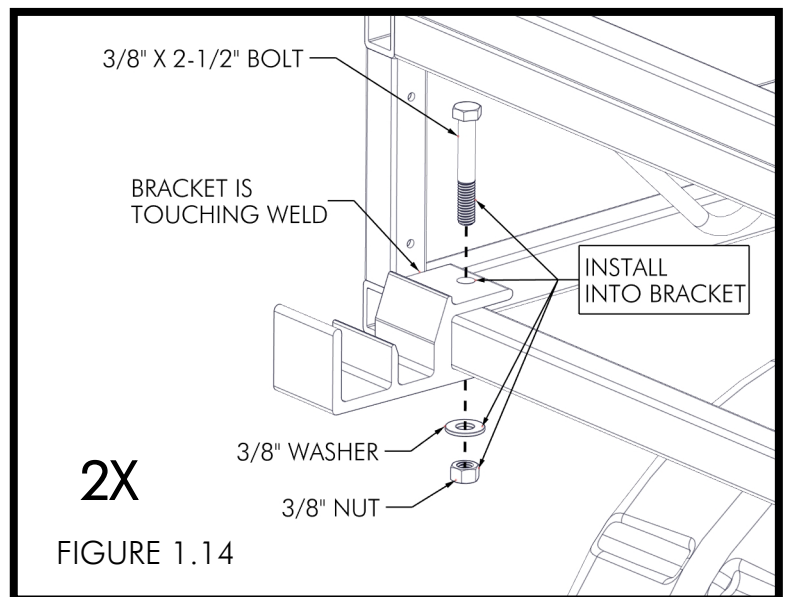
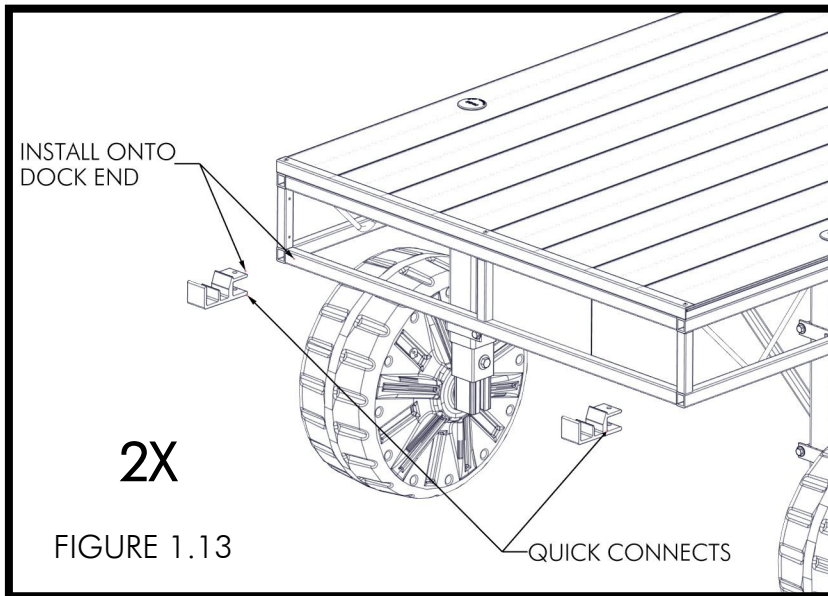

WHEN ANOTHER DOCK SECTION CONNECTS TO A SIDE OF THE DOCK, QUICK CONNECTS SHOULD BE PLACED AS SHOWN (FIGURE 1.16). PLACE CONNECTING DOCK SECTIONS IN THE QUICK CONNECT INSTALLATION/REMOVAL POSITION WHEN INSTALLING OR REMOVING MULTIPLE SECTIONS. PUSH THE DOCKS INTO POSITION IN THE WATER. ONCE THE DOCKS ARE IN POSITION, PUT THEM IN THE QUICK CONNECT'S SET POSITION (FIGURE 1.17).

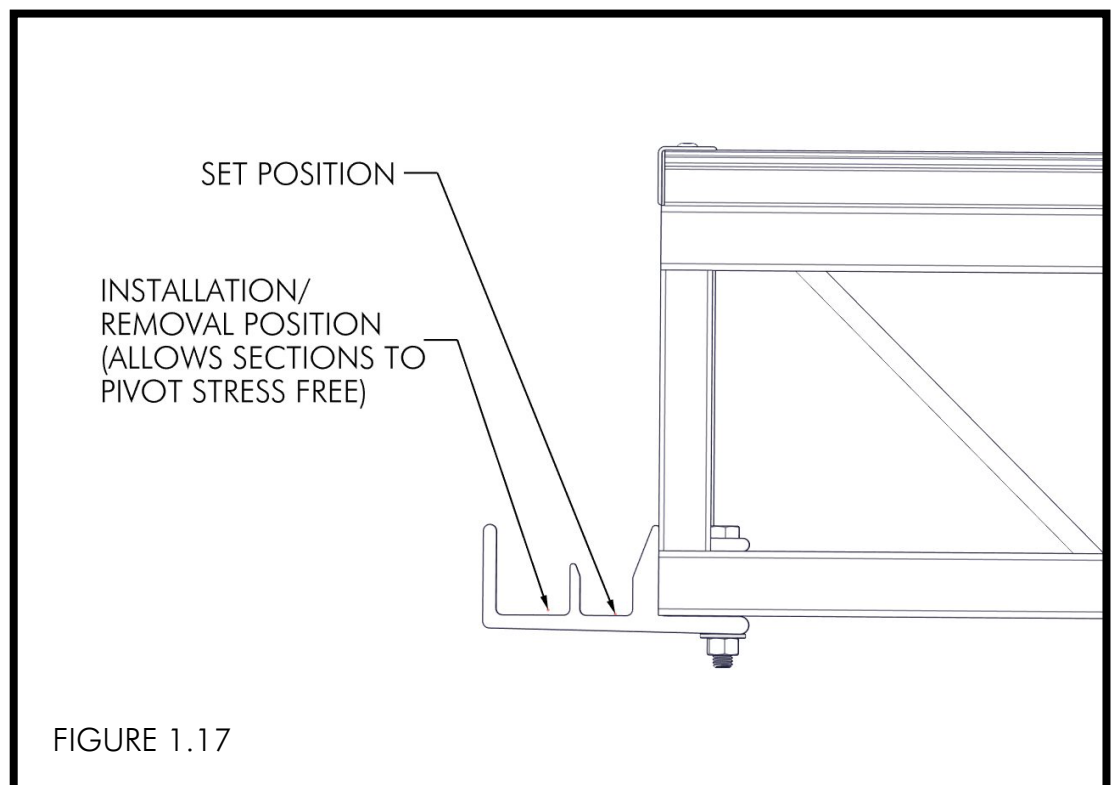
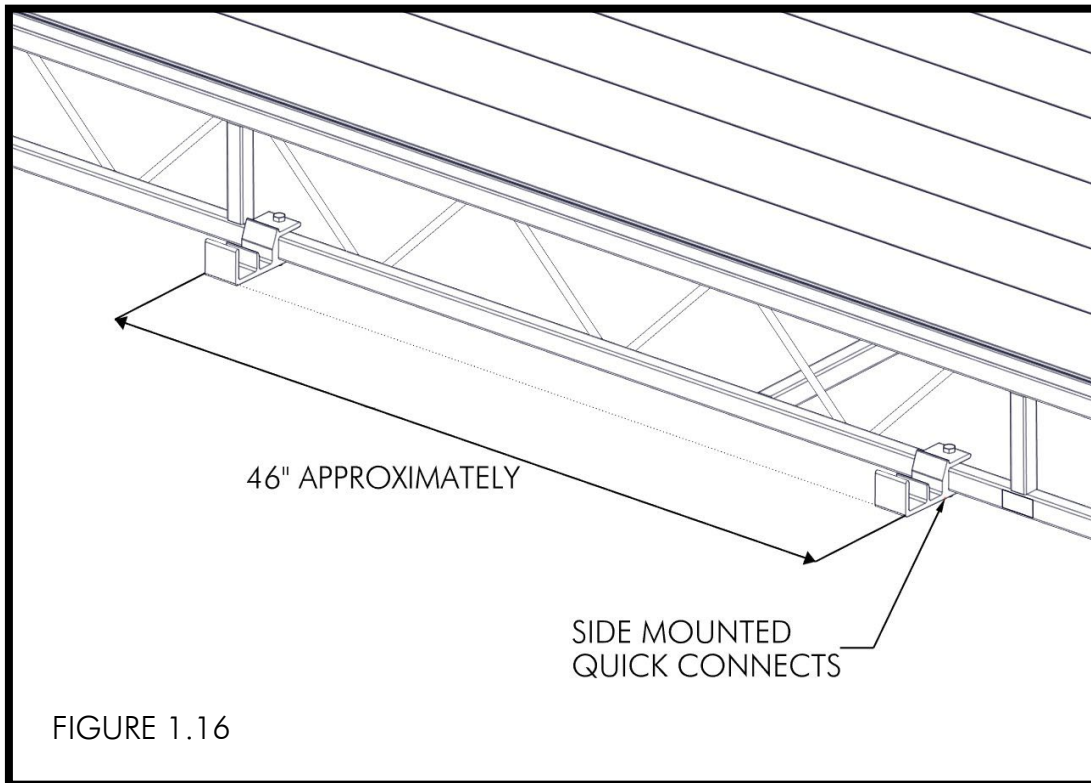

WITH THE CAP REMOVED FROM THE DOCK, USING A FLOE SPEED WRENCH OR 1-1/8" SOCKET AND CORDLESS DRILL, ADJUST THE HEIGHT OF THE DOCK SO THE BOTTOM FRAME OF THE DOCK IS APPROXIMATELY 8" ABOVE THE WATER. TURN THE DOCK ADJUSTING NUT ON THE TOP OF THE DOCK CLOCKWISE TO LOWER AND COUNTERCLOCKWISE TO RAISE. USE A LEVEL TO MAKE SURE ALL DOCK SURFACES ARE LEVEL (FIGURE 1.18). ONCE THE DOCK IS SET IN PLACE AND LEVELLED, INSERT THE PLASTIC CAPS IN THE ADJUSTMENT NUT HOLES (FIGURE 1.19).

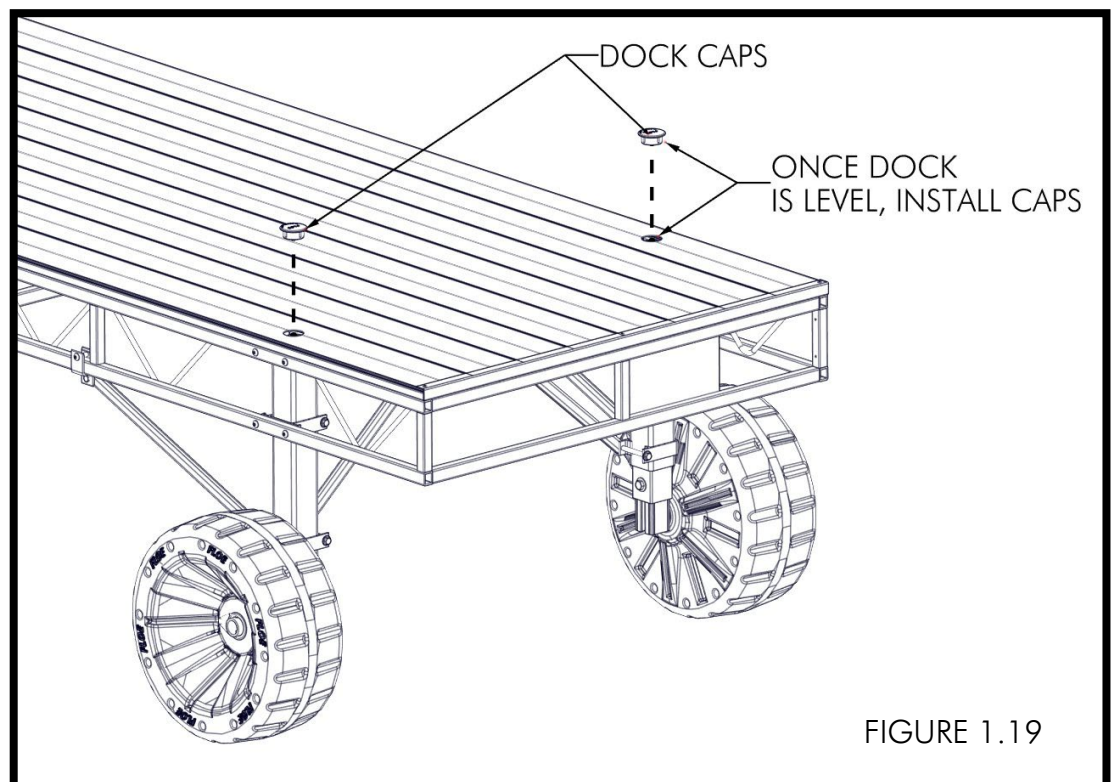
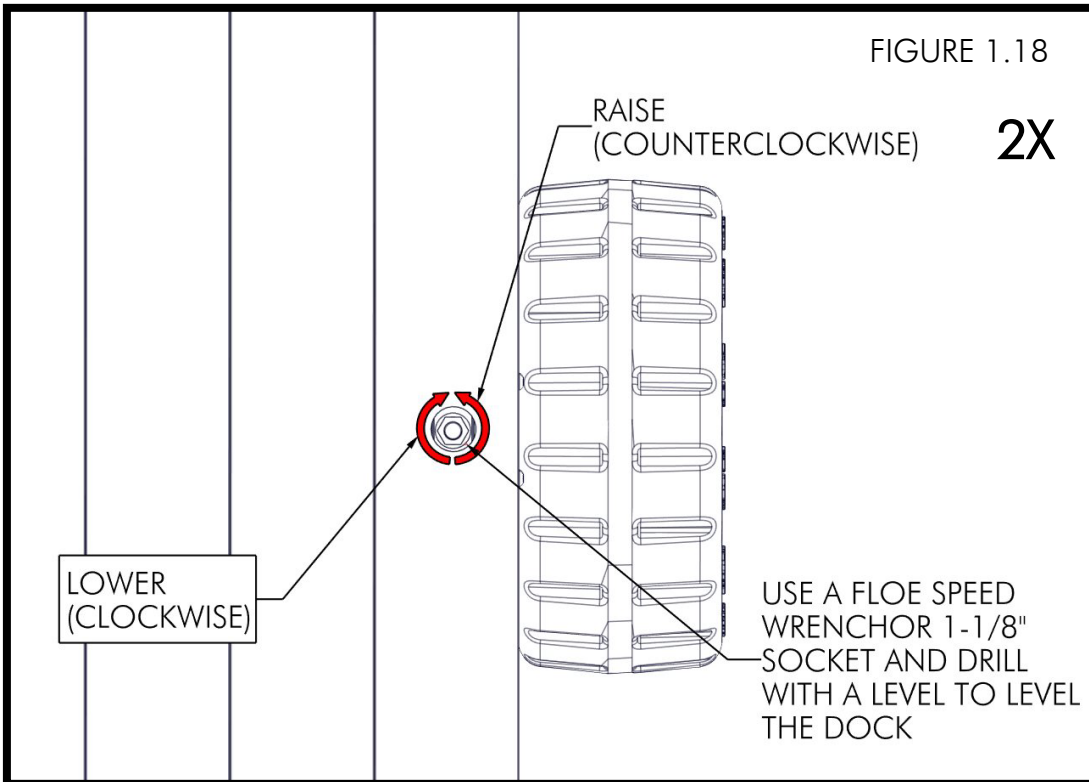

FIGURE 1.19

## WARNINGS



CORDLESS DRILL MAY COME TO A SUDDEN STOP WHEN THE LEG IS FULLY EXTENDED OR RETRACTED.

BE SURE TO HAVE YOUR CORDLESS DRILL IN CLUTCH MODE WHEN ADJUSTING THE LEGS. USE OF A CORDED DRILL MAY CAUSE ELECTROCUTION. FAILURE TO USE DRILL IN CLUTCH MODE MAY CAUSE INJURY TO YOUR HAND OR ARM.



NEVER ADJUST YOUR DOCK LEGS WITH AN IMPACT WRENCH. IF YOU CAN NOT TURN THE ADJUSTING NUT, DO NOT FORCE IT – YOU HAVE REACHED THE END OF THE ADJUSTMENT RANGE. DO NOT EXCEED 15 FT-LBS. APPLYING TOO MUCH FORCE TO YOUR DOCK LEGS WILL DAMAGE THE MECHANISM.