

FLOE ADJUSTABLE CRADLE PADS

ASSEMBLY INSTRUCTIONS

KIT P/N 511-03002-00

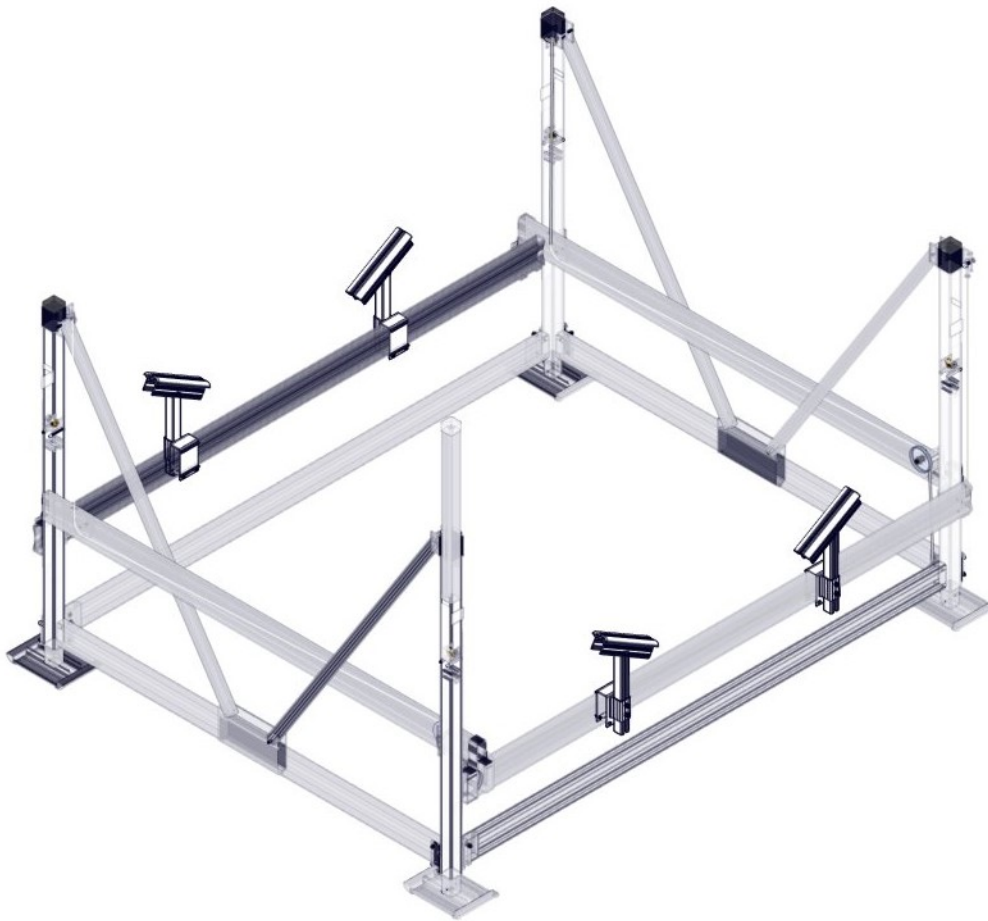

TOOLS REQUIRED

- (2) 9/16" SOCKETS/
WRENCHES
- 3/4" SOCKET
- TAPE MEASURE
- TORQUE WRENCH
- RECIPROCATING SAW OR
EQUIVALENT WITH METAL
BLADE (OPTIONAL, SEE
SHEET 4)

*LIFT NOT INCLUDED

*KIT ONLY INCLUDES PAIR OF CRADLE PADS

BUNK/CRADLE PAD DISCLAIMER

DUE TO THE LARGE VARIETY OF BOAT HULL DESIGNS, WE STRONGLY RECOMMEND THAT YOU CONSULT WITH YOUR BOAT'S MANUFACTURER TO ENSURE THAT YOU ARE SUPPORTING YOUR BOAT PROPERLY TO AVOID ANY POTENTIAL DAMAGE.

BILL OF MATERIALS

P/N 511-03002-00		CRADLE PAD, PIVOT BUNKS	
NUMBER	PART NUMBER	QTY.	DESCRIPTION
1	001-70115-00	4	HHCS, 3/8-16 x 3" 18-8 ss
2	001-70205-00	4	HHCS, 1/2-13 x 1" 18-8 ss
3	001-71022-00	4	FLAT WASHER, 1/2" USS ss 18-8
4	001-76349-00	4	NUT, 3/8-16 ALUM
5	001-76350-00	4	NUT, 1/2-13 ALUM
6	111-00486-00	2	WELD'T, TUBE POCKET 2 HOLE
7	111-00165-00	2	ASS'Y, CRADLE PAD SUPPORT TUBE

P/N 111-00165-00		ASS'Y, CRADLE PAD SUPPORT TUBE	
NUMBER	PART NUMBER	QTY.	DESCRIPTION
7A	001-70115-00	1	HHCS, 3/8-16 x 3" 18-8 ss
7B	001-76071-00	1	NUT, NYLOCK 3/8-16 ALUM.
7C	002-04097-00	1	TUBE, ADJ. CRADLE PAD SUPPORT
7D	111-00164-00	1	ASS'Y, CRADLE PAD

EXPLODED VIEW

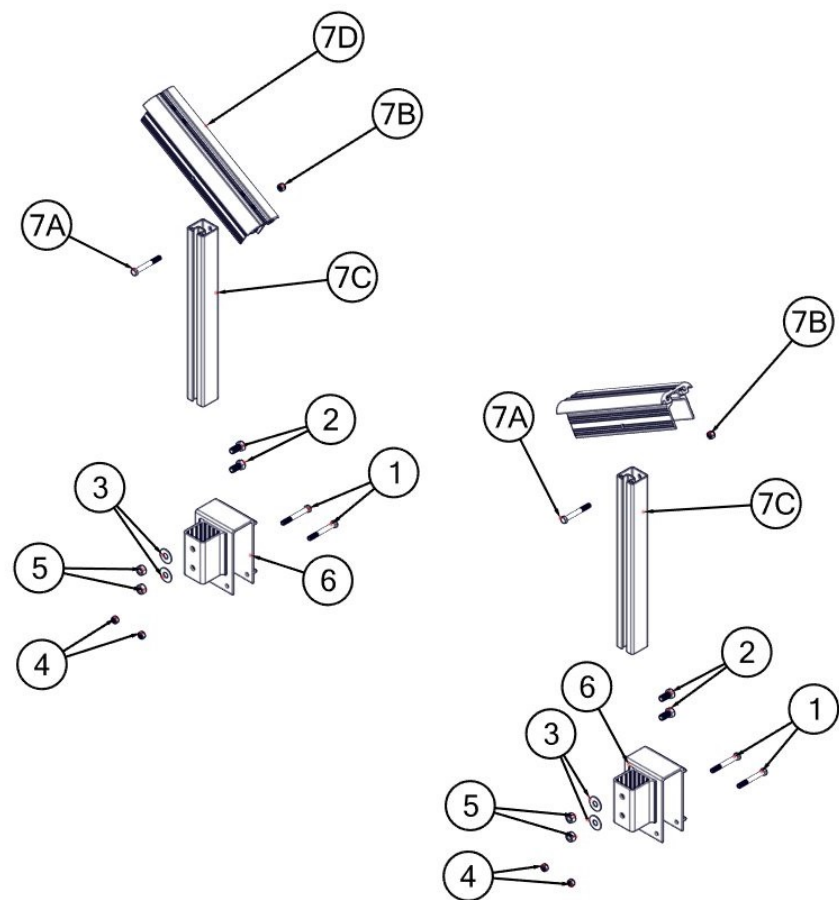

STEP 1

SLIDE CLAMP WELDMENTS ONTO CRADLE BEAM (FIGURE 1.1). PLACE (2) 1/2" X 1" BOLTS AND (2) 1/2" WASHERS INTO EACH CLAMP WELDMENT'S BOLT HOLES (FIGURE 1.2).

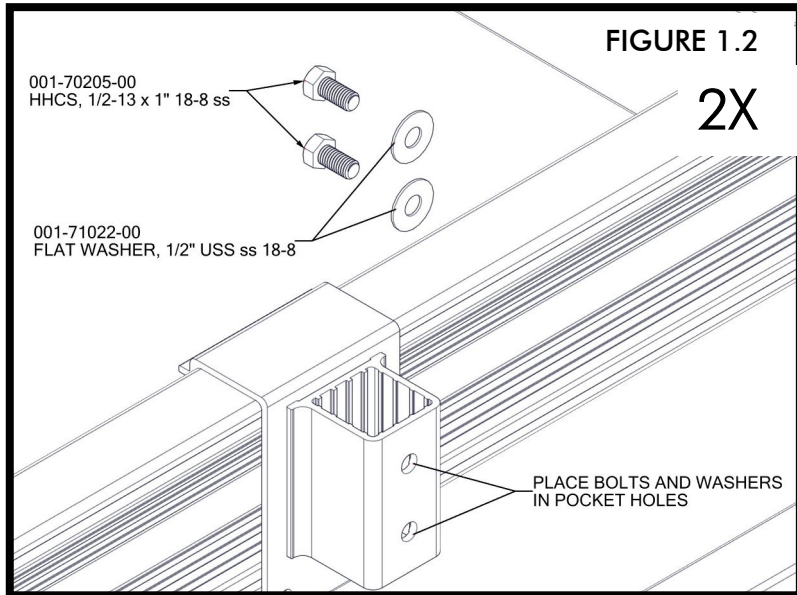
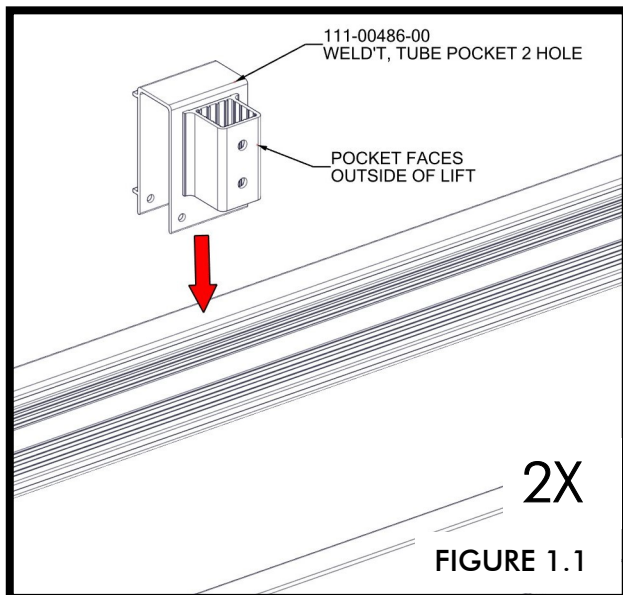

INSERT TUBES INTO CLAMP BRACKETS (FIGURE 1.3) AND ATTACH USING (2) 1/2" NUTS, HAND TIGHT ONLY (FIGURE 1.4).

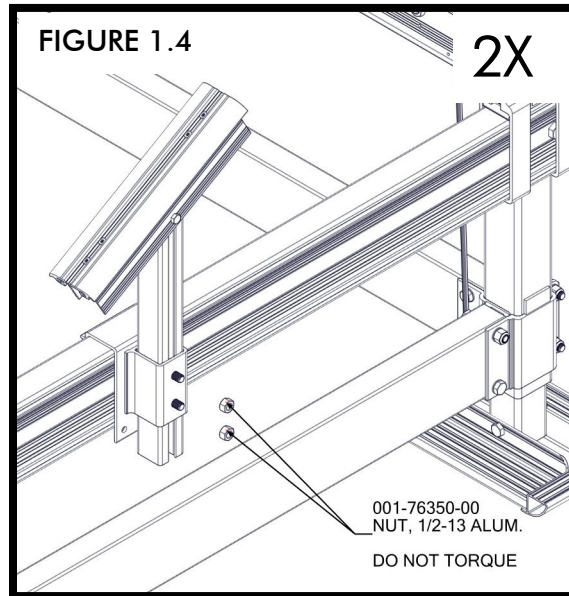
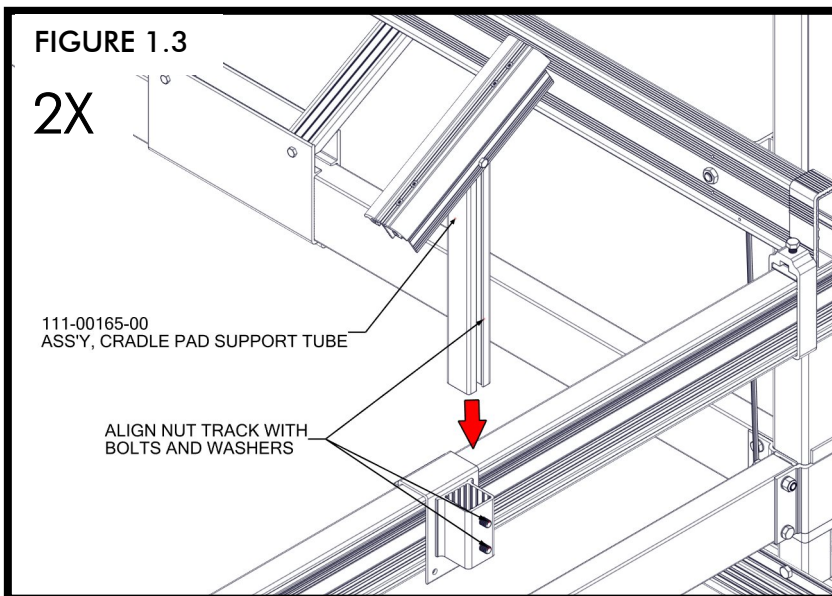

ADJUST HEIGHT AND TORQUE TO 70 FT-LBS (FIGURE 1.5).

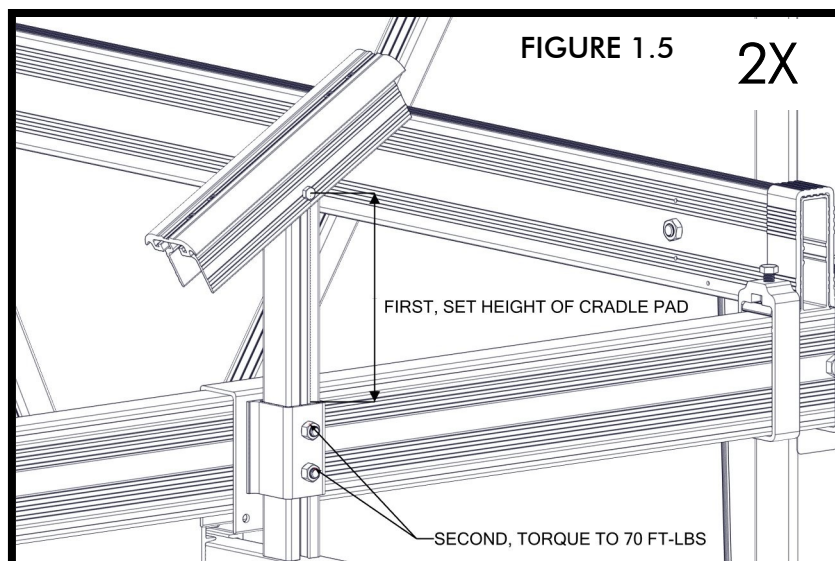

NOTE:
**UPRIGHTS
MAY HAVE TO
BE CUT TO
ALLOW FULL
TRAVEL OF
CRADLE ONCE
FINAL
PLACEMENT IS
ESTABLISHED.**

STEP 2

ATTACH USING (2) 3/8" X 3" BOLTS AND (2) 3/8" NUTS PER CLAMP (FIGURE 2.1). FIRST, FIND CENTER OF CRADLE BEAM AND SET WIDTH BASED ON WATERCRAFT (FIGURE 2.2).

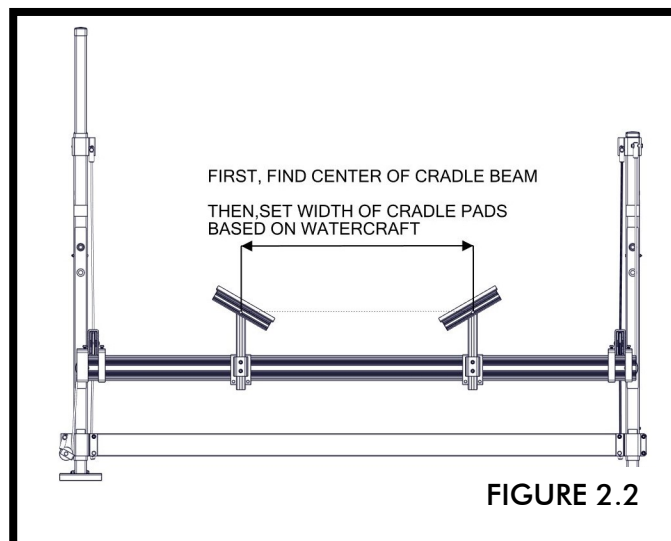
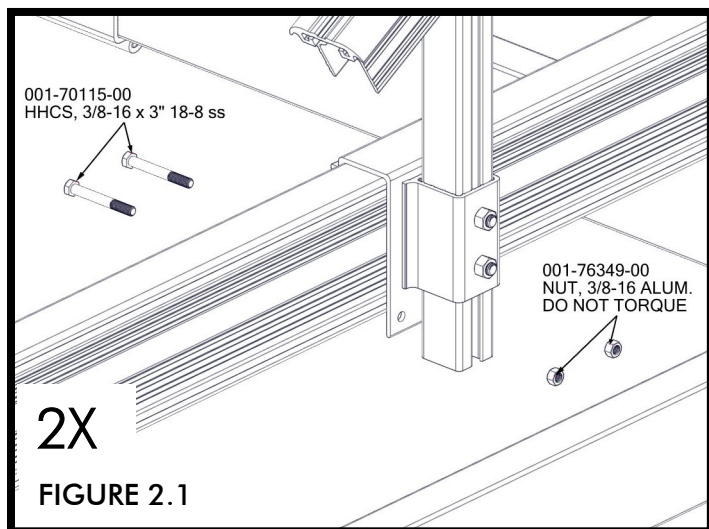

ONCE POSITION IS SET, TORQUE TO 35 FT-LBS (FIGURE 2.3).

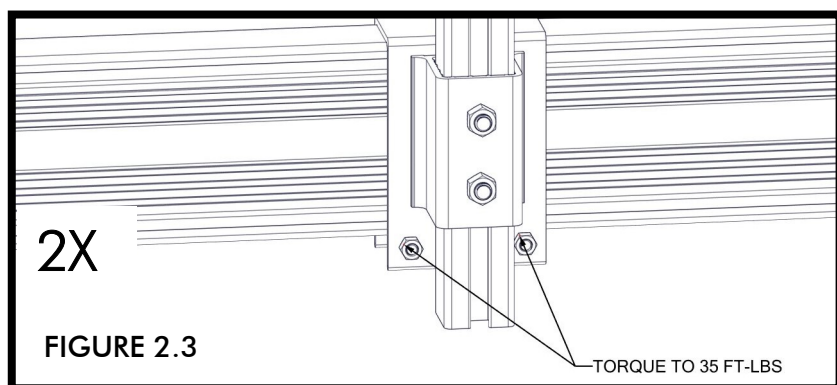

BUNK/CRADLE PAD DISCLAIMER

**DUE TO THE LARGE VARIETY OF
BOAT HULL DESIGNS, WE
STRONGLY RECOMMEND THAT
YOU CONSULT WITH YOUR
BOAT'S MANUFACTURER TO
ENSURE THAT YOU ARE
SUPPORTING YOUR BOAT
PROPERLY TO AVOID ANY
POTENTIAL DAMAGE.**