

FLOE FULL LENGTH PONTOON & TRI-TOON BUNKS LARGE LIFTS

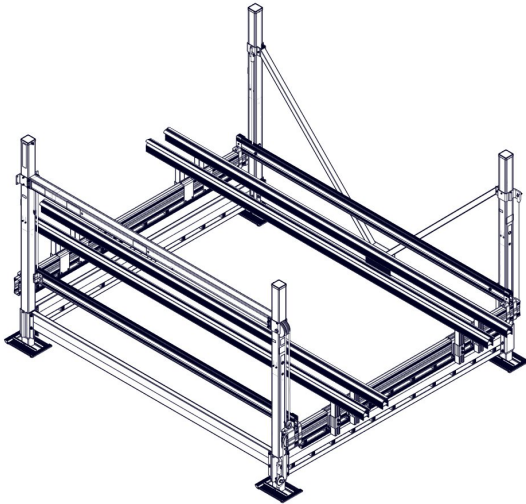

ASSEMBLY INSTRUCTIONS

KIT P/N 511-02477-00, 511-02488-00, 511-02489-00 (TRI-TOON ADD-ON)



VSD10000

TOOLS REQUIRED

- (2) 9/16" SOCKETS/WRENCHES
- 15/16" SOCKET/WRENCH
- TAPE MEASURE
- TORQUE WRENCH
- 0.406" (13/32") DRILL BIT & DRILL (MAY BE NECESSARY FOR 10,000# LIFTS)

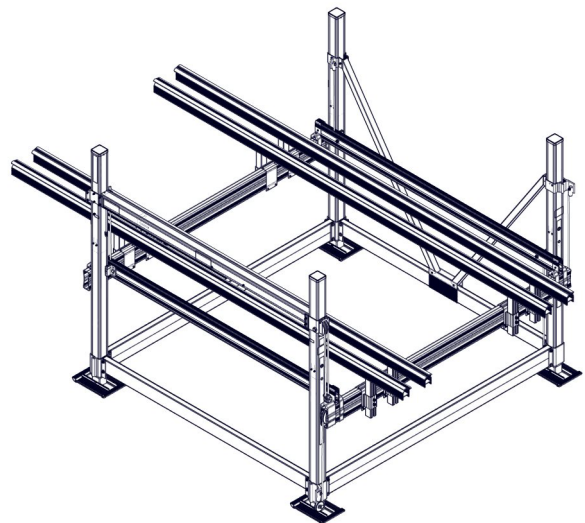

VSD6000-8000 PONTON

*LIFTS NOT INCLUDED

BUNK/CRADLE PAD DISCLAIMER

DUE TO THE LARGE VARIETY OF BOAT HULL DESIGNS, WE STRONGLY RECOMMEND THAT YOU CONSULT WITH YOUR BOAT'S MANUFACTURER TO ENSURE THAT YOU ARE SUPPORTING YOUR BOAT PROPERLY TO AVOID ANY POTENTIAL DAMAGE.

BILL OF MATERIALS/EXPLODED VIEW

P/N 511-02477-00		BUNKS, FULL LEN. 8K PONTOON – 239.5"		
NUMBER	PART NUMBER	QTY.	DESCRIPTION	
1	001-70118-00	8	HHCS, 3/8-16 x 3 3/4" 18-8 ss	
2	001-70119-00	16	HHCS, 3/8-16 x 4" 18-8 ss	
3	001-70305-00	16	HHCS, 5/8-11 x 1" 18-8 ss	
4	001-71025-00	16	FLAT WASHER, 5/8" SAE 18-8 ss	
5	001-76349-00	24	NUT, 3/8-16 ALUM.	
6	001-76351-00	16	NUT, 5/8-11 ALUM	
7	002-00123-00	8	TUBE, BUNK SUPPORT – 17.938" LG. LIFT	
8	002-04285-00	8	CLAMP, BUNK CRADLE (MALE)	
9	111-00359-00	8	WELD'T, LG. BUNK TUBE CLAMP 2 HOLE	
10	111-00499-00	4	ASS'Y, FL 8K PONTOON BUNK – 239.5"	

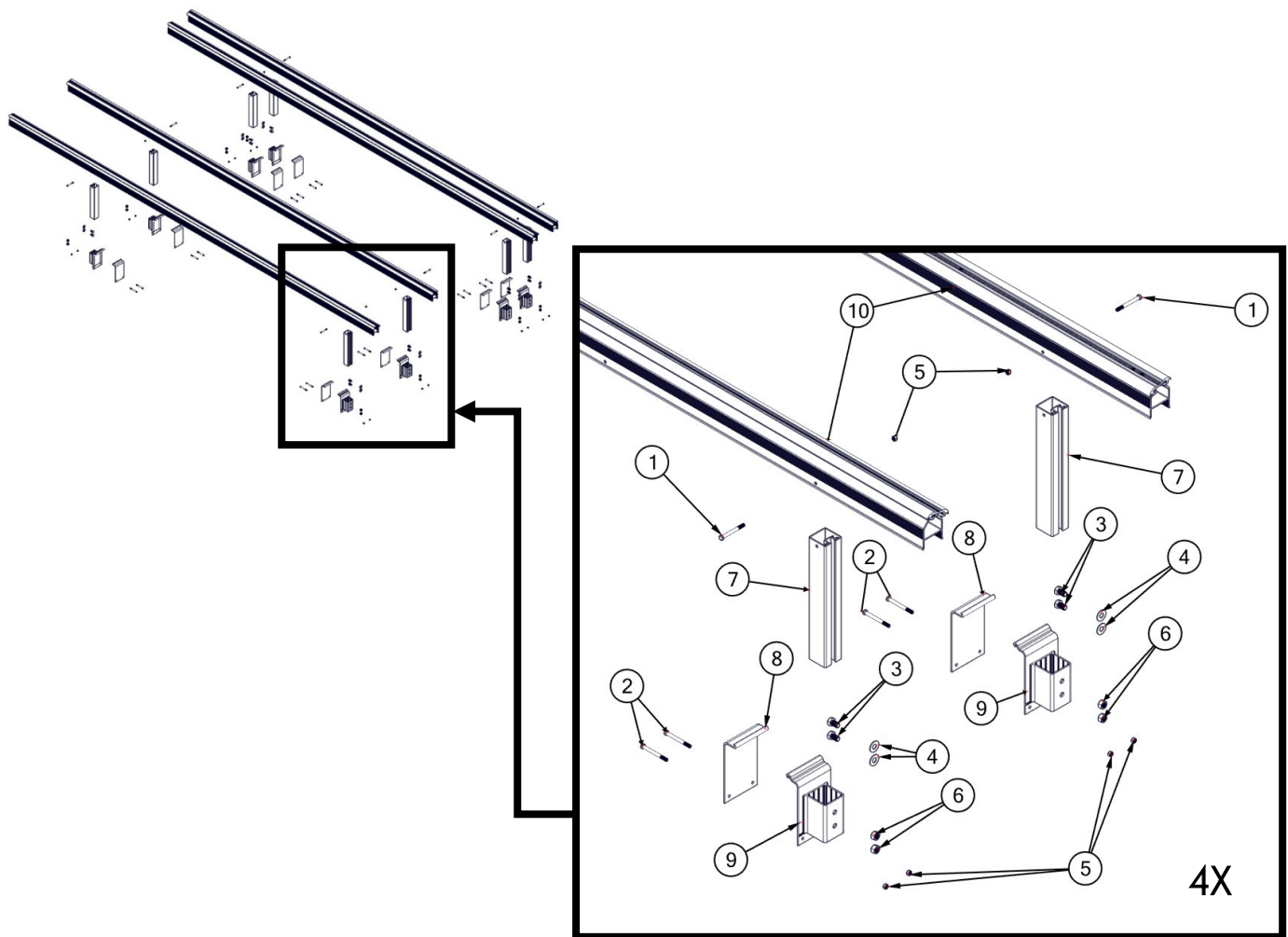

BILL OF MATERIALS/EXPLODED VIEW

P/N 511-02488-00		BUNKS, FULL LENGTH PONTOON 6-10K – 203.5"		
NUMBER	PART NUMBER	QTY.	DESCRIPTION	
1	001-70118-00	8	HHCS, 3/8-16 x 3 3/4" 18-8 ss	
2	001-70119-00	16	HHCS, 3/8-16 x 4" 18-8 ss	
3	001-70305-00	16	HHCS, 5/8-11 x 1" 18-8 ss	
4	001-71025-00	16	FLAT WASHER, 5/8" SAE 18-8 ss	
5	001-76349-00	24	NUT, 3/8-16 ALUM.	
6	001-76351-00	16	NUT, 5/8-11 ALUM	
7	002-00123-00	8	TUBE, BUNK SUPPORT – 17.938" LG. LIFT	
8	002-04285-00	8	CLAMP, BUNK CRADLE (MALE)	
9	111-00359-00	8	WELD'T, LG. BUNK TUBE CLAMP 2 HOLE	
10	111-00452-00	4	ASS'Y, FL PON. BUNK – 203.5"	

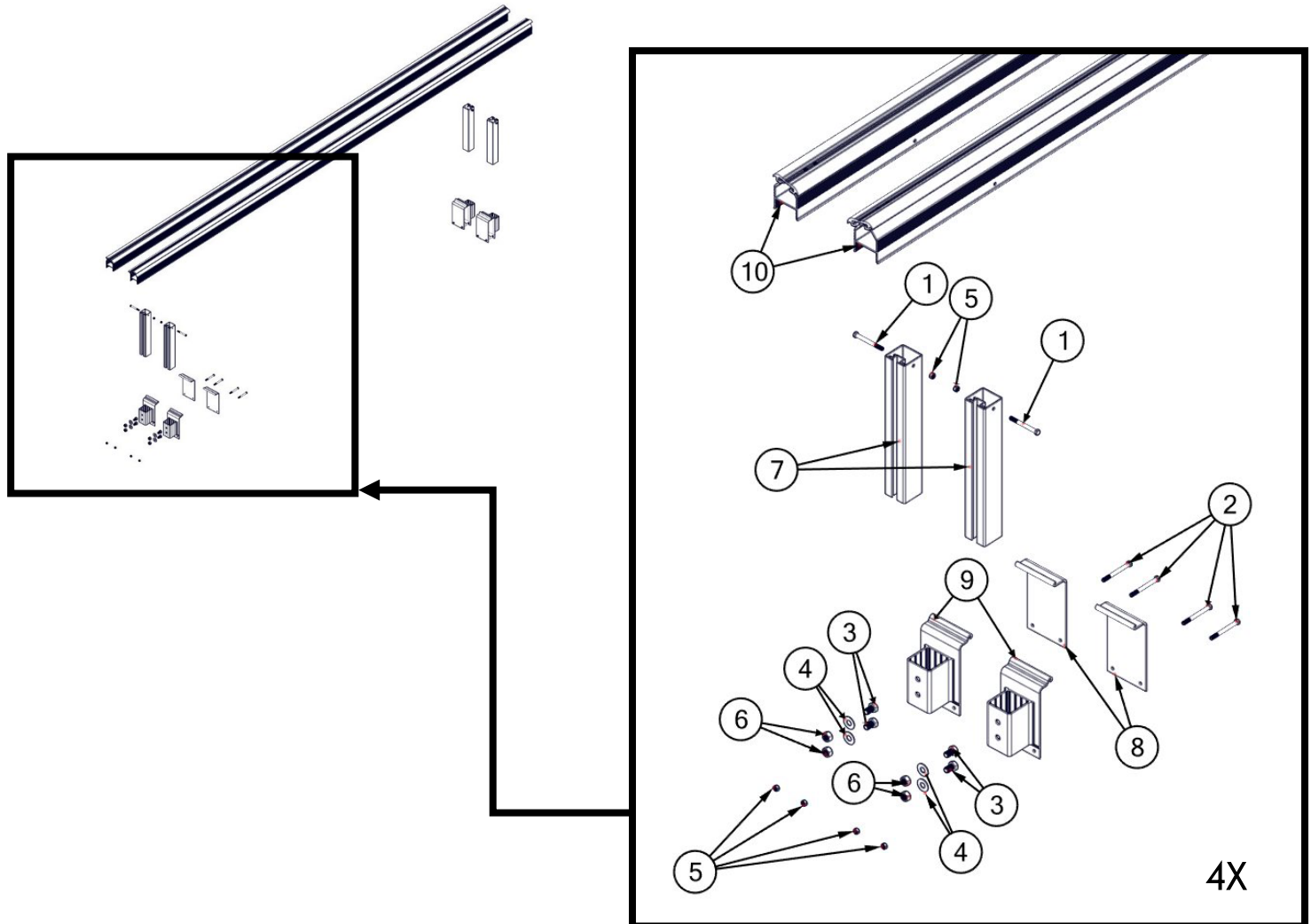

BILL OF MATERIALS/EXPLODED VIEW

P/N 511-02489-00		BUNKS, TRI-TOON ADD ON 6-10K - 203.5"	
NUMBER	PART NUMBER	QTY.	DESCRIPTION
1	001-70118-00	4	HHCS, 3/8-16 x 3 3/4" 18-8 ss
2	001-70119-00	8	HHCS, 3/8-16 x 4" 18-8 ss
3	001-70305-00	8	HHCS, 5/8-11 x 1" 18-8 ss
4	001-71025-00	8	FLAT WASHER, 5/8" SAE 18-8 ss
5	001-76349-00	12	NUT, 3/8-16 ALUM.
6	001-76351-00	8	NUT, 5/8-11 ALUM
7	002-00123-00	4	TUBE, BUNK SUPPORT – 17.938" LG. LIFT
8	002-04285-00	4	CLAMP, BUNK CRADLE (MALE)
9	111-00359-00	4	WELD'T, LG. BUNK TUBE CLAMP 2 HOLE
10	111-00452-00	2	ASS'Y, FL PON. BUNK – 203.5"

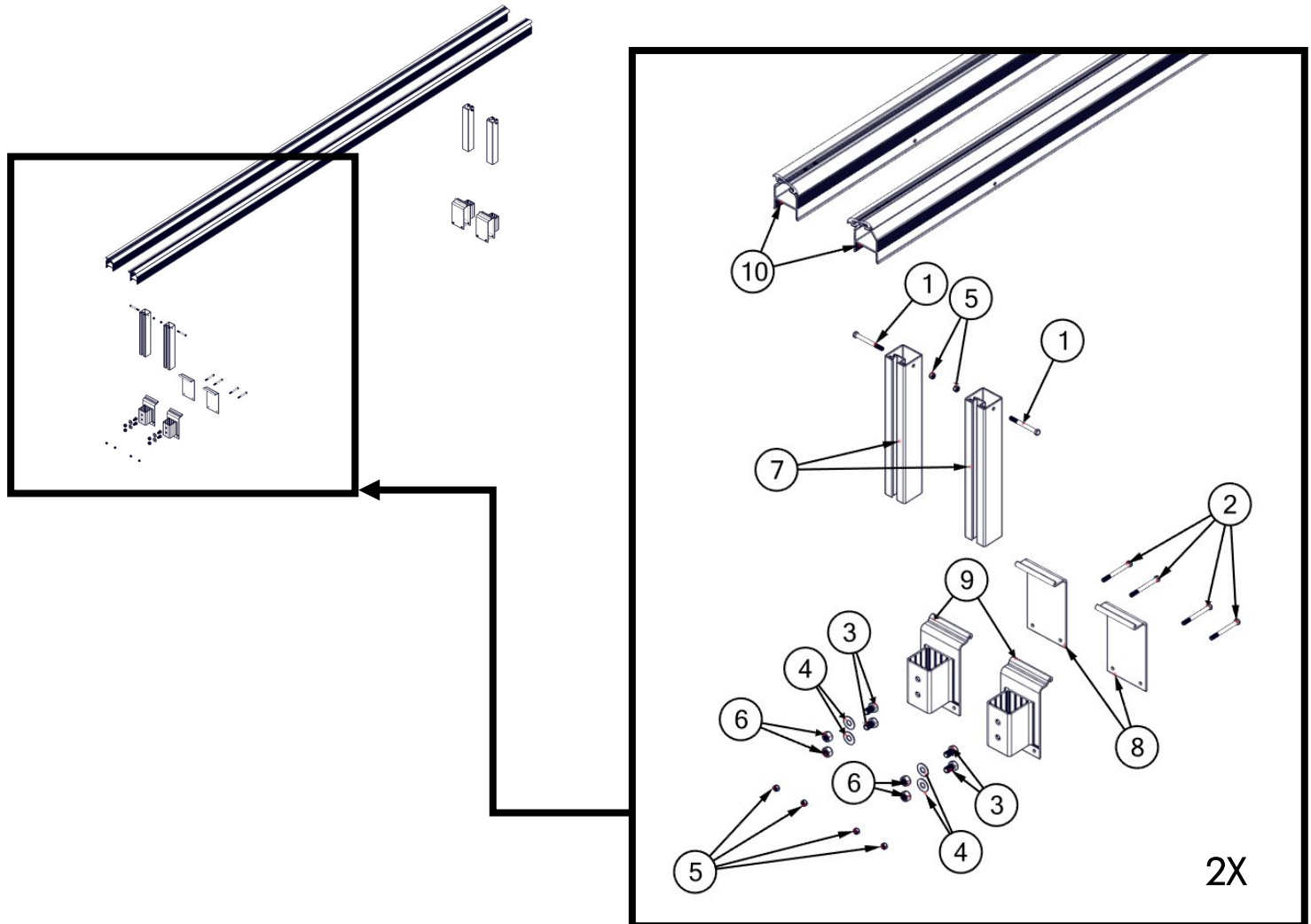

STANDARD PONTOON INSTALLATION

STEP 1

SLIDE CLAMPS TOGETHER (FIGURE 1.1) AND SLIDE PAIRS OVER CRADLE BEAM WITH POCKETS FACING OUTWARDS (FIGURE 1.2). NOTE: IF CRADLE BEAM WELDMENT IMPEDES BOLT PLACEMENT IN UPRIGHT CLAMPS, DRILL A 13/32" HOLE THROUGH THE 2" TUBES ON THE CRADLE BEAM (VSD10000 INSTALLATIONS ONLY (FIGURE 1.3).

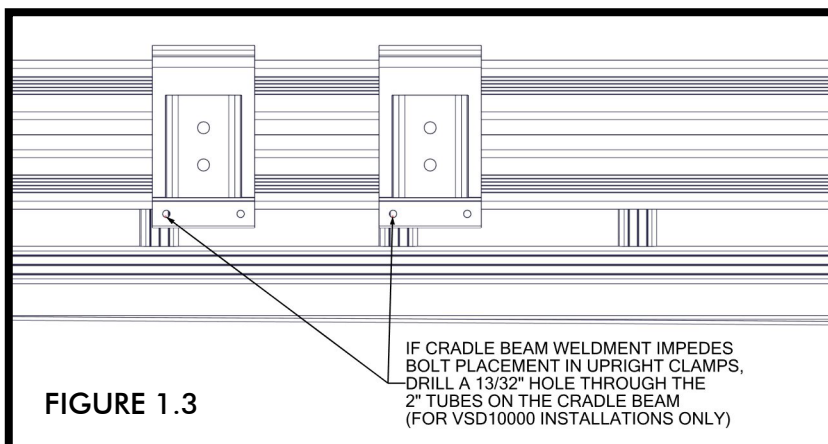
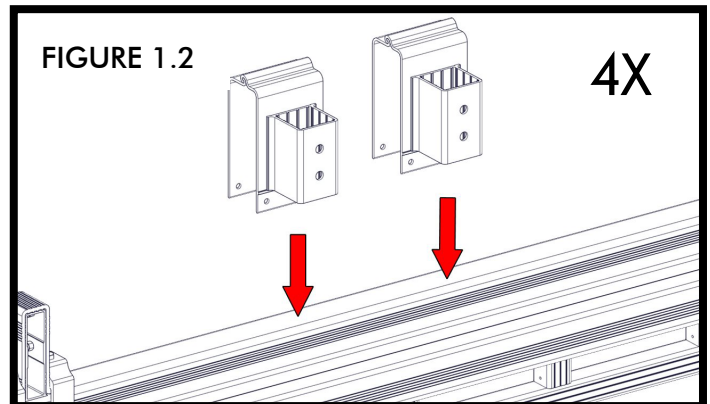
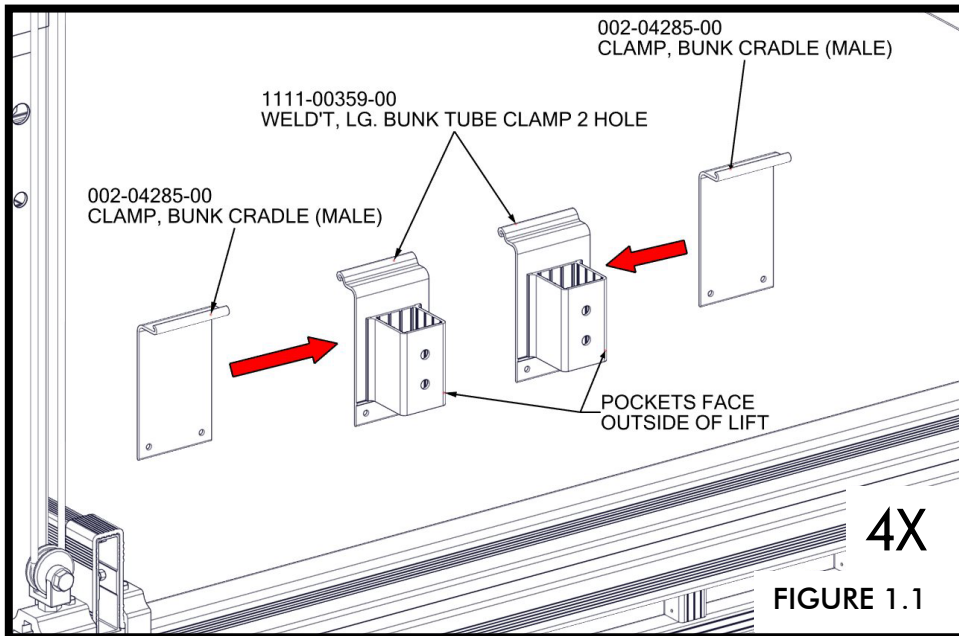

PLACE (2) 5/8" X 1" BOLTS AND (2) 5/8" WASHERS INTO EACH CLAMP WELDMENT POCKET (FIGURE 1.4). INSERT UPRIGHT TUBES INTO CLAMP WELDMENTS AND ATTACH (2) 5/8" NUTS PER POCKET ON BOLTS (FIGURE 1.5).

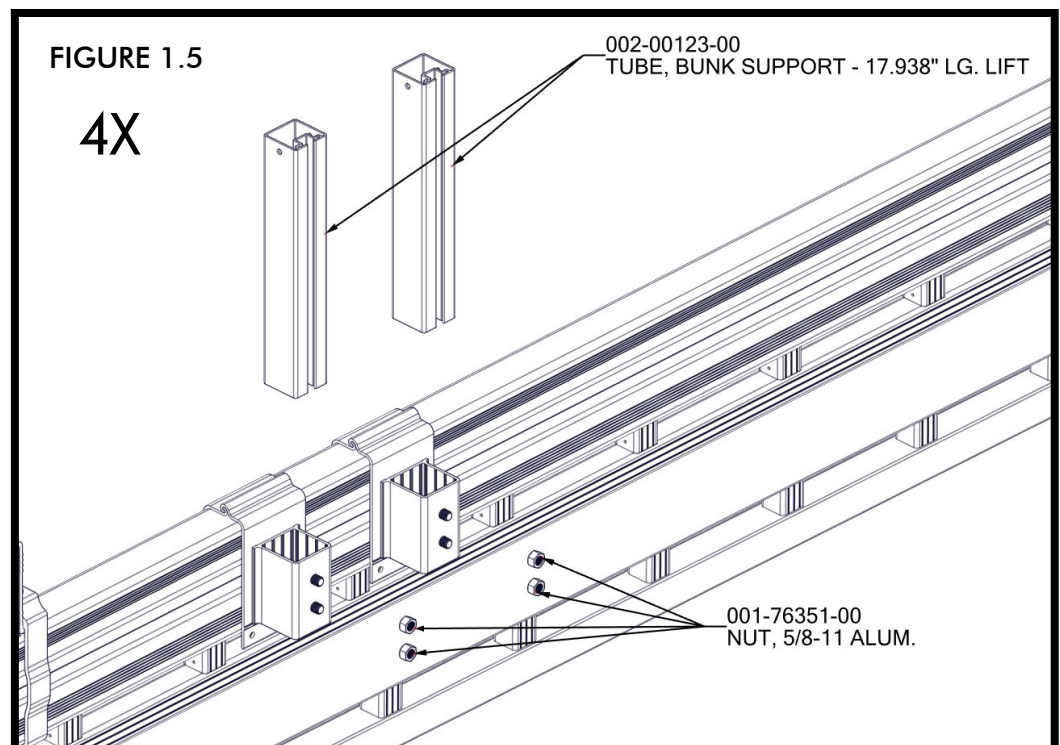
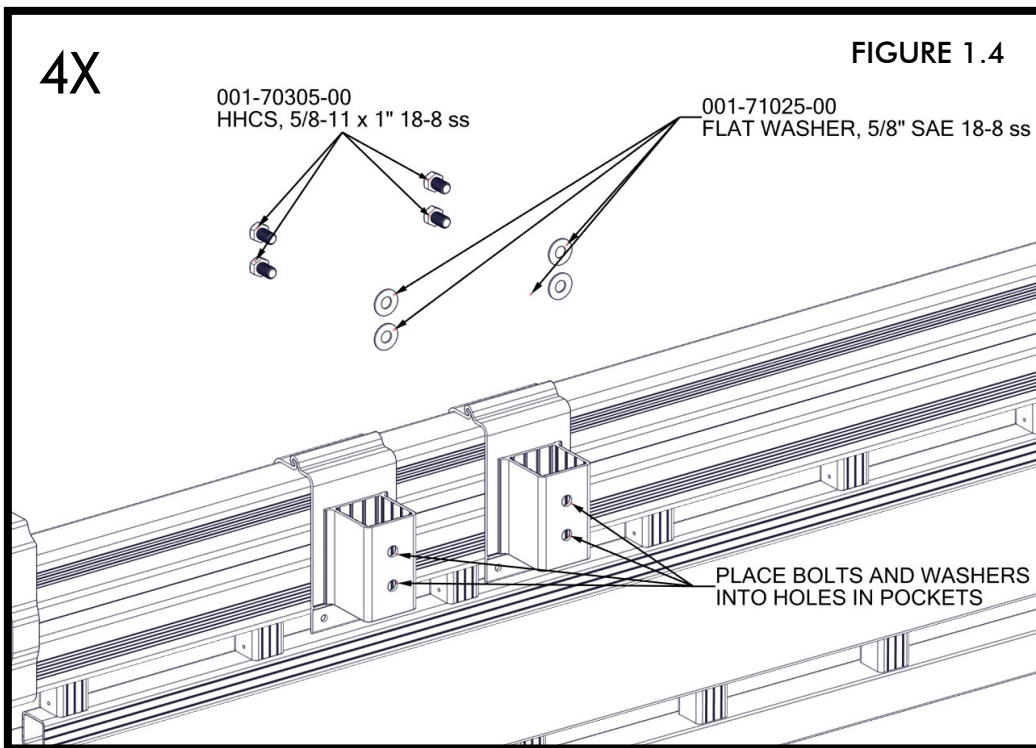

ADJUST HEIGHT AND HAND TIGHTEN ONLY (FIGURE 1.6). ATTACH CLAMP WELDMENTS TO CRADLE BEAM USING (2) 3/8" X 4" BOLTS AND (2) 3/8" NUTS. DO NOT TORQUE (FIGURE 1.7).

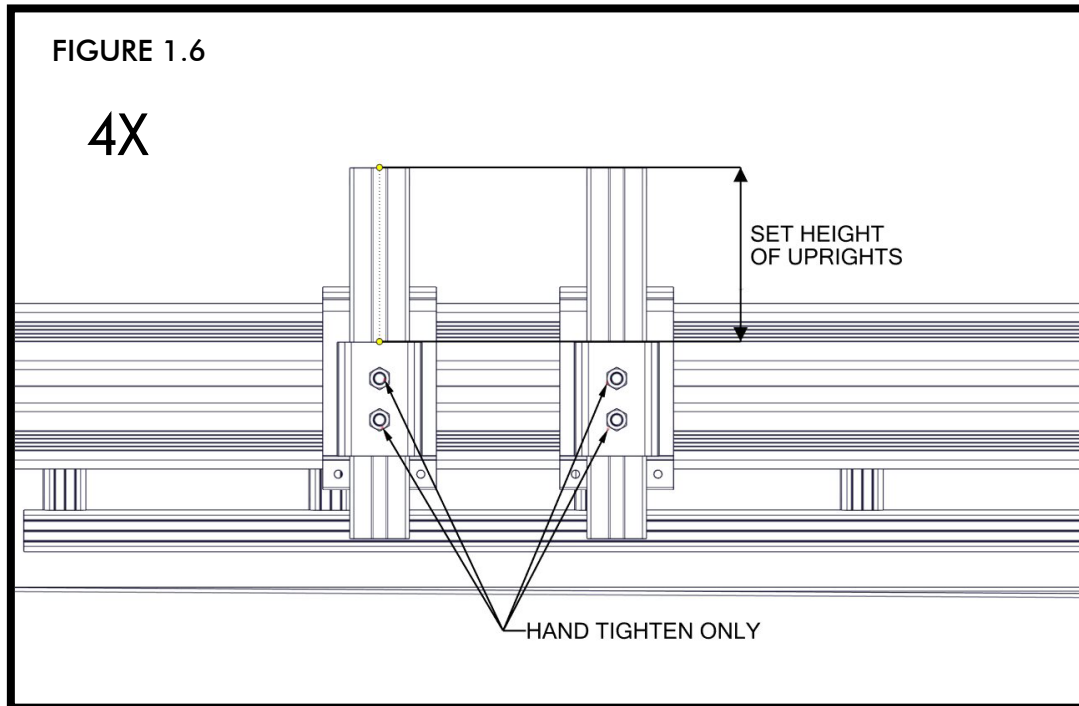

BUNK/CRADLE PAD DISCLAIMER

DUE TO THE LARGE VARIETY OF BOAT HULL DESIGNS, WE STRONGLY RECOMMEND THAT YOU CONSULT WITH YOUR BOAT'S MANUFACTURER TO ENSURE THAT YOUR ARE SUPPORTING YOUR BOAT PROPERLY TO AVOID ANY POTENTIAL DAMAGE.

NOTE: SEE FIGURE 2.5 FOR GENERAL GUIDELINES ON SETUP

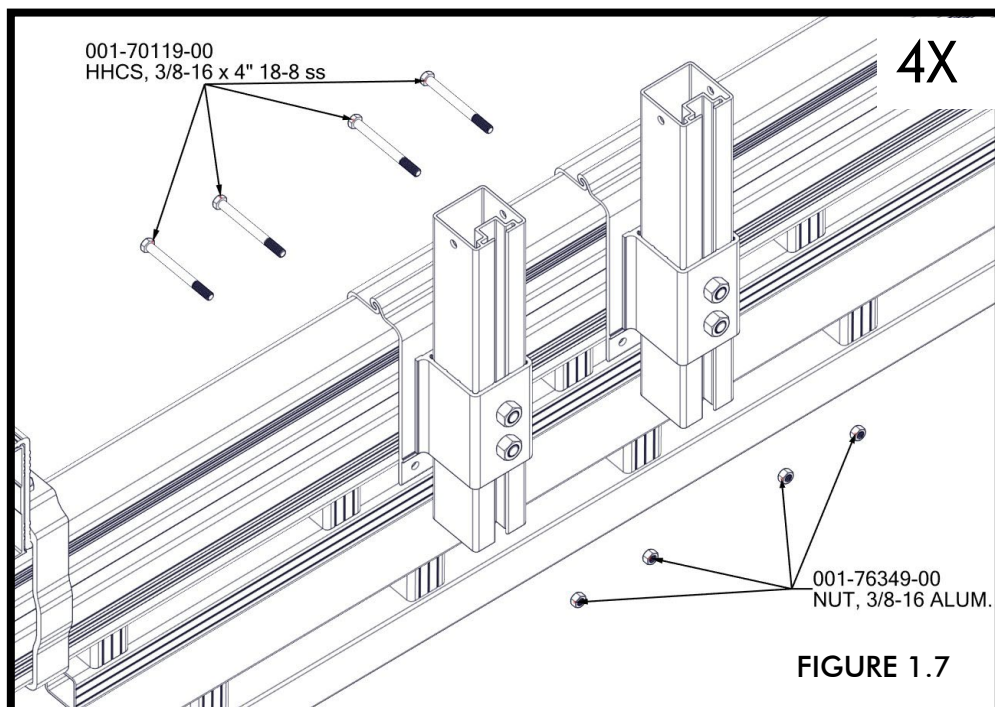

STEP 2

PLACE BUNKS ONTO UPRIGHTS WITH PADS ANGLED TO CRADLE PONTOON (FIGURE 2.1). FOR VSD10000 INSTALLATIONS, THE OUTERMOST HOLE ON THE BUNKS IS USED, THE INNERMOST HOLE IS NOT (FIGURE 2.2). FOR VSD6500/8000 INSTALLATIONS, THE INNERMOST HOLE ON THE BUNKS IS USED, THE OUTERMOST HOLE IS NOT (FIGURE 2.2A). THIS WILL RESULT IN EXTRA OVERHANG OF THE BUNKS.

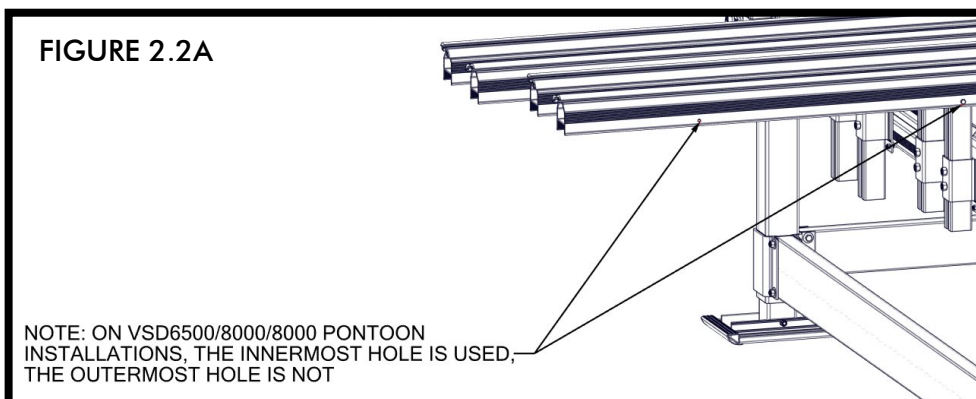
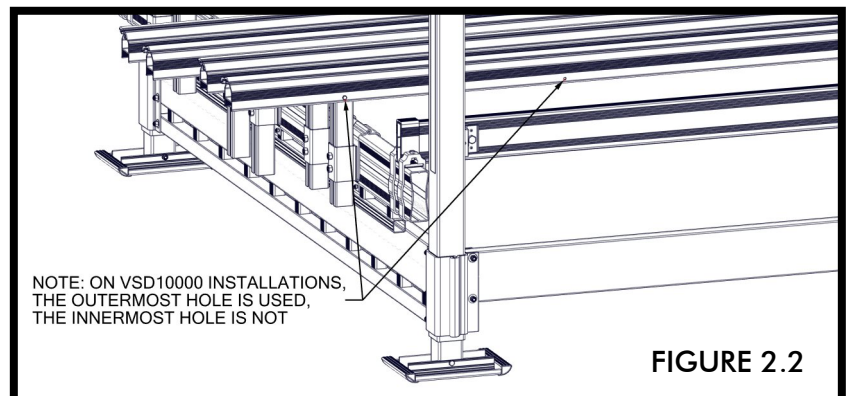
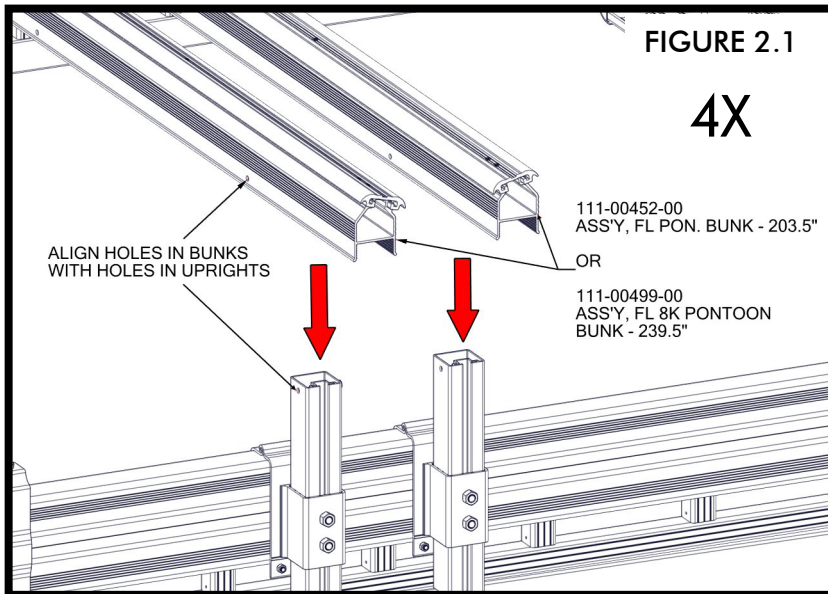

ATTACH USING (2) 3/8" X 3 3/4" BOLTS AND (2) 3/8" NUTS PER UPRIGHT (FIGURE 2.3). TORQUE TO 35 FT-LBS (FIGURE 2.4).

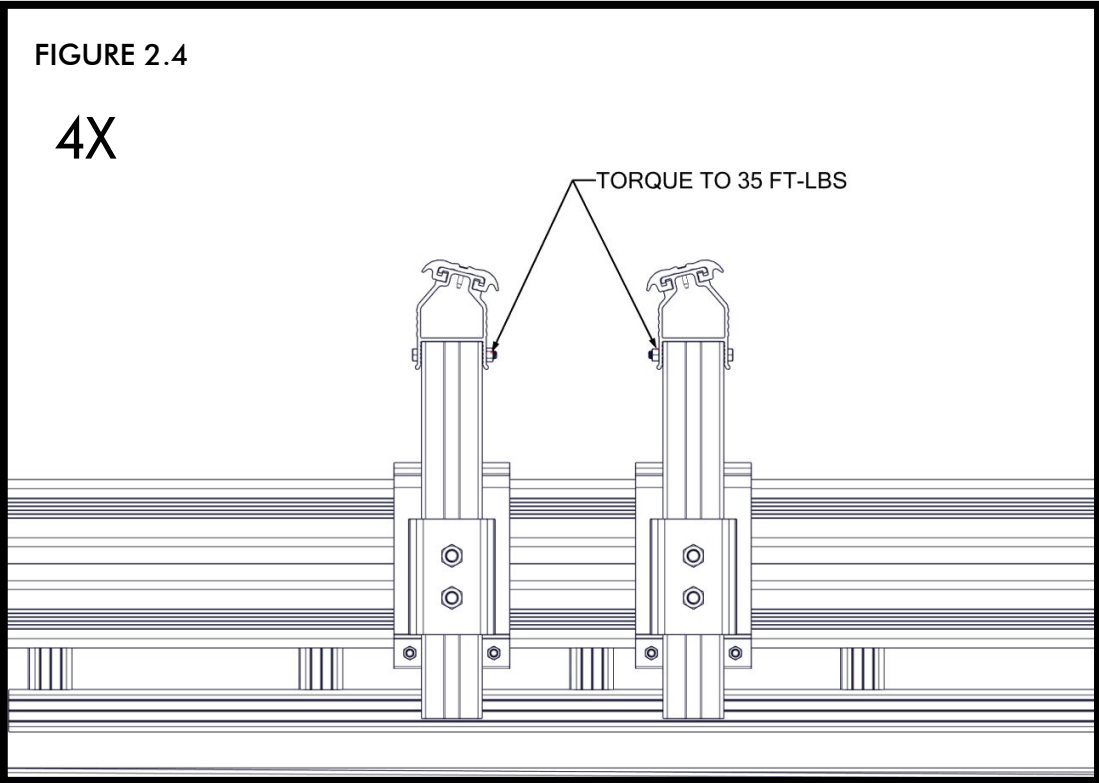
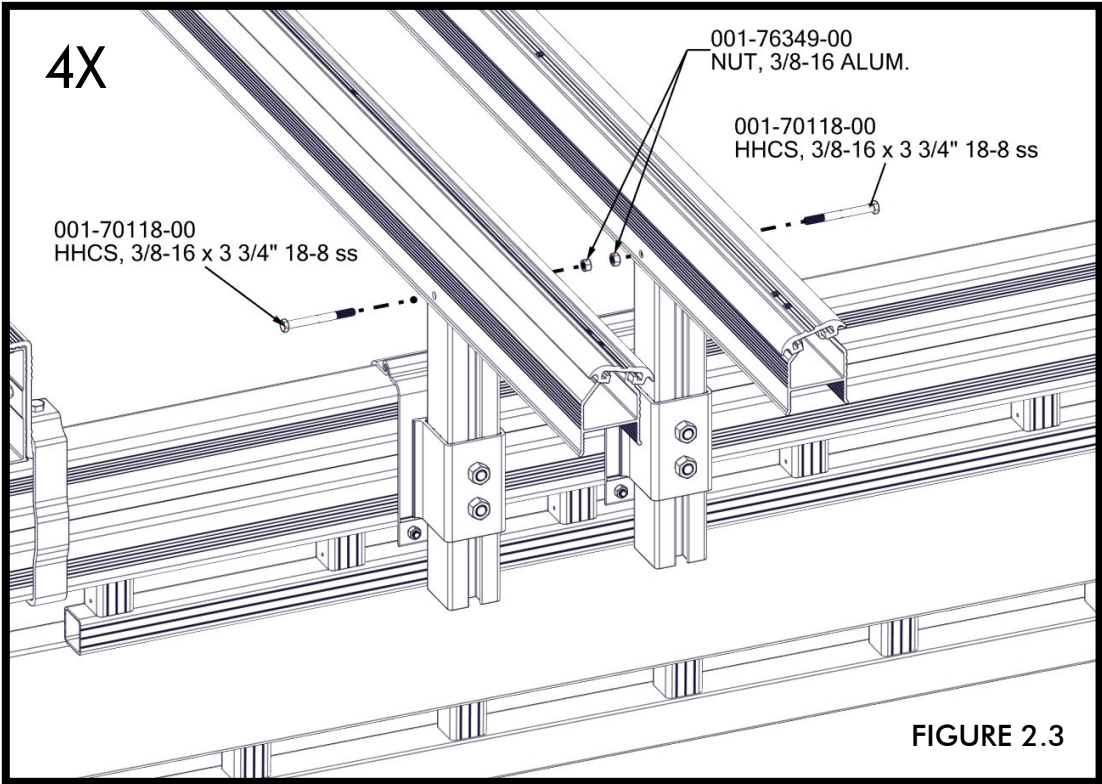

FOLLOW THESE GUIDELINES FOR USING AND LOCATING THE PONTOON BUNKS (FIGURE 2.5).

-THE WIDTH OF THE BUNKS SHOULD KEEP THE PONTOONS OFF THE CRADLE BEAMS.

-THE BUNKS SHOULD BE KEPT AS LOW AS POSSIBLE (NOT QUITE TOUCHING THE CLAMP).

-TO PLACE BUNKS, FIND CENTER BETWEEN PONTOONS AND CENTER OF THE BOAT FROM PONTOONS AND TRANSLATE MEASUREMENT TO CRADLE BEAM TO DETERMINE CENTER OF EACH PAIR OF BUNKS. LOCATE MIDDLE BUNKS AROUND CENTER OF CRADLE BEAM.

-THE REAR OF A 21' PONTOON BOAT SHOULD OVERHANG PAST THE LIFT BY 3 FEET. FOR EVERY ADDITIONAL FOOT IN LENGTH OF THE BOAT, IT SHOULD OVERHANG BY AN ADDITIONAL 6 INCHES BEYOND THE REAR OF THE LIFT. THESE ARE GENERAL GUIDELINES THAT CAN BE ADJUSTED FOR AN INDIVIDUAL'S CIRCUMSTANCES.

-ONCE BUNKS ARE IN THEIR FINAL LOCATION, TORQUE 3/8" NUTS ON CRADLE CLAMPS TO 35 FT-LBS AND 5/8" NUTS ON CRADLE CLAMPS TO 70 FT-LBS (FIGURE 2.5).

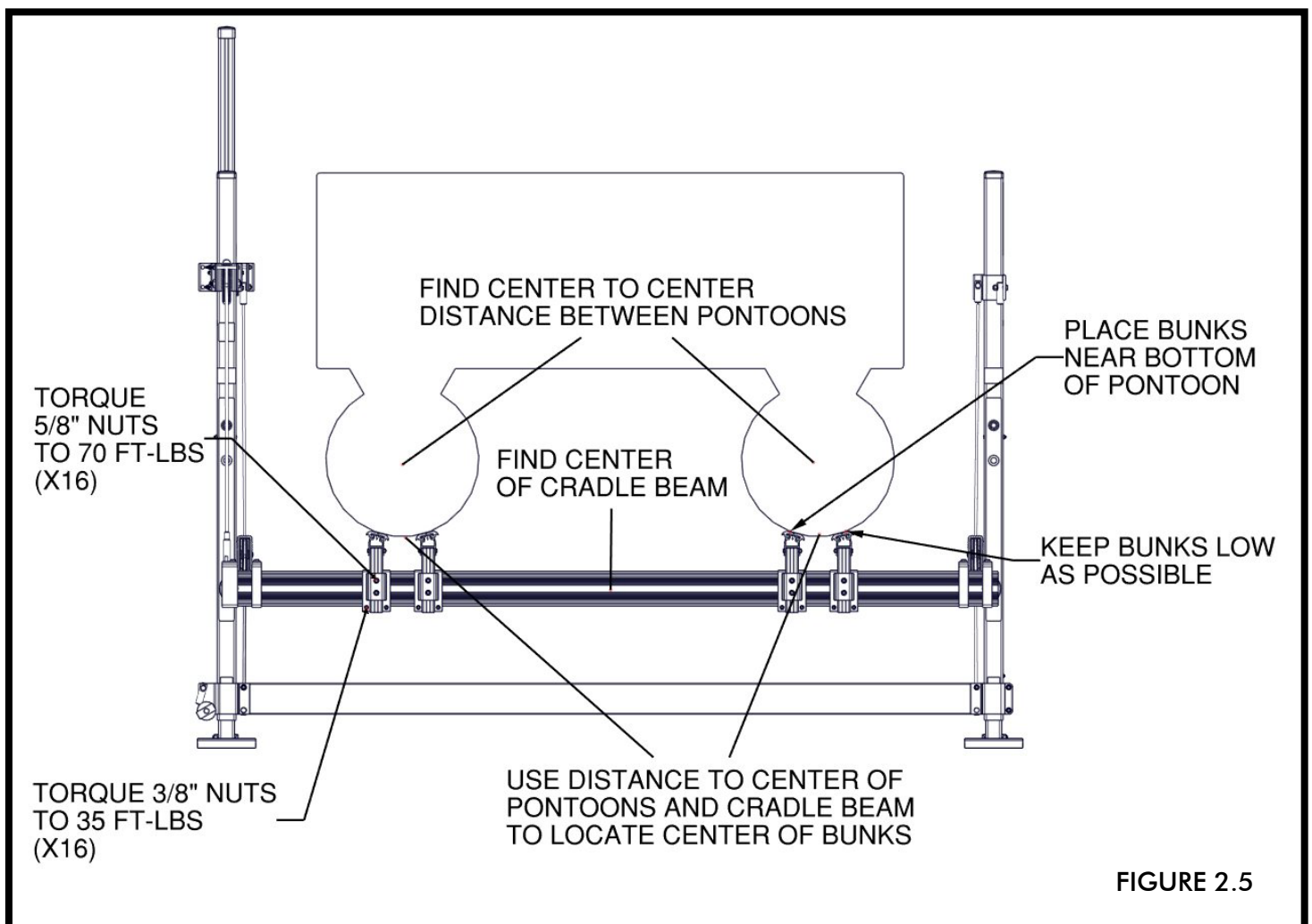

TRI-TOON ADD-ON KIT INSTALLATION

STEP 1

SLIDE CLAMPS TOGETHER (FIGURE 1.1) AND SLIDE PAIRS OVER CRADLE BEAM WITH POCKETS FACING OUTWARDS (FIGURE 1.2). NOTE: IF CRADLE BEAM WELDMENT IMPEDES BOLT PLACEMENT IN UPRIGHT CLAMPS, DRILL A 13/32" HOLE THROUGH THE 2" TUBES ON THE CRADLE BEAM (VSD10000 INSTALLATIONS ONLY (FIGURE 1.3).

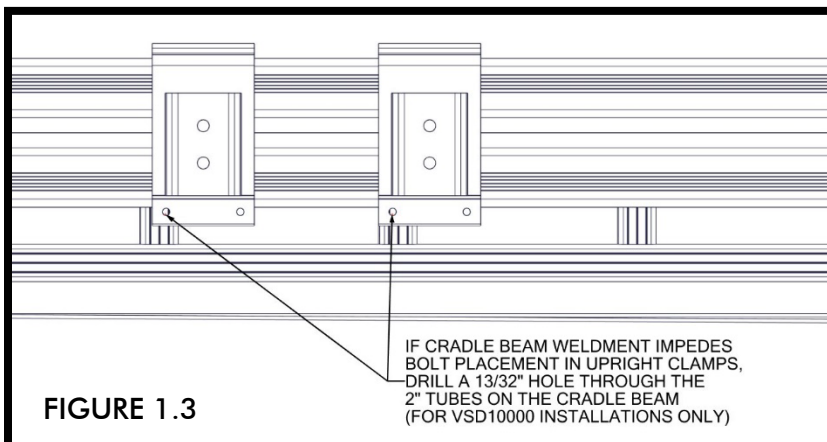
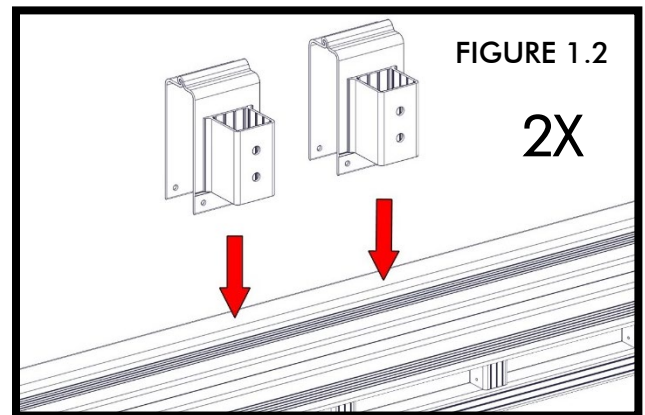
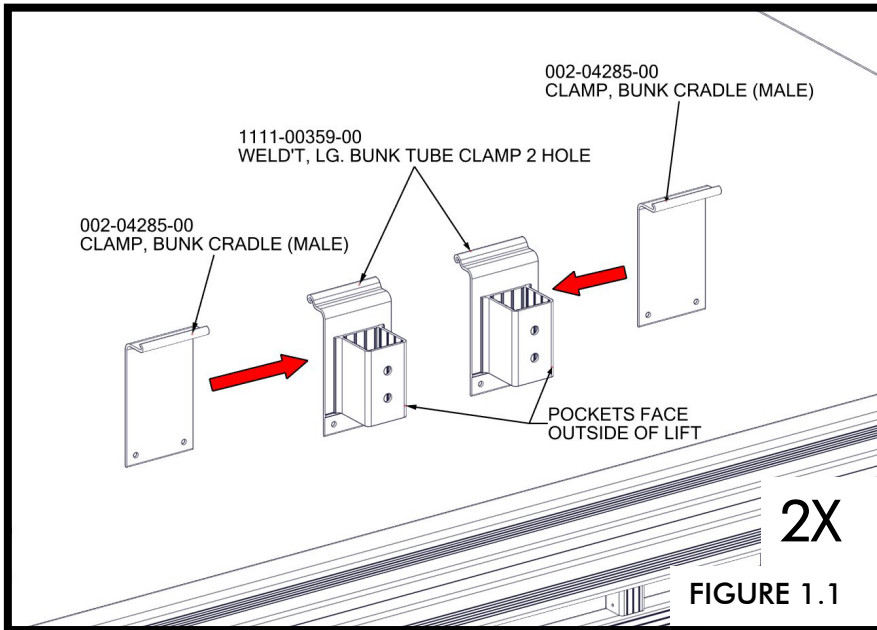

PLACE (2) 5/8" X 1" BOLTS AND (2) 5/8" WASHERS INTO EACH CLAMP WELDMENT POCKET (FIGURE 1.4). INSERT UPRIGHT TUBES INTO CLAMP WELDMENTS AND ATTACH (2) 5/8" NUTS PER POCKET ON BOLTS (FIGURE 1.5).

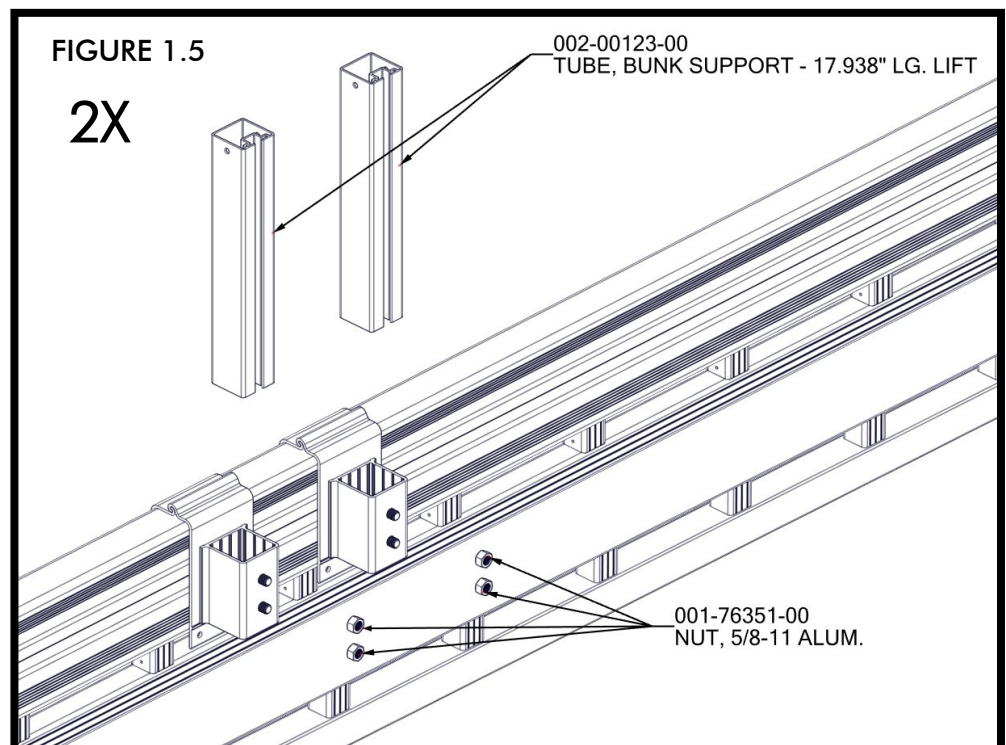
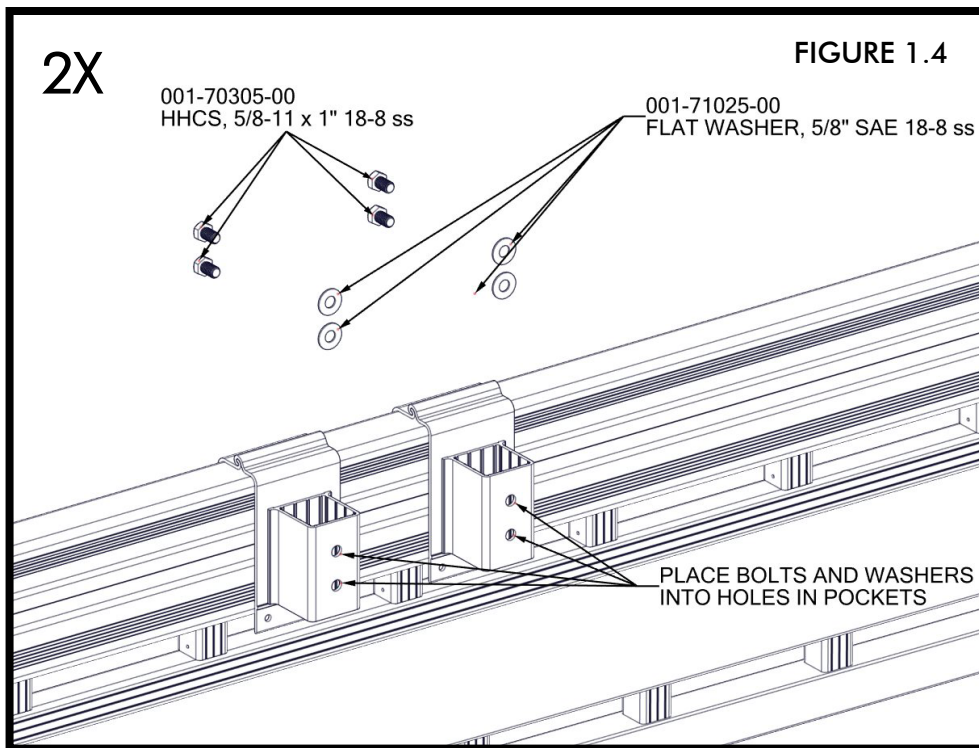

ADJUST HEIGHT AND HAND TIGHTEN ONLY (FIGURE 1.6). ATTACH CLAMP WELDMENTS TO CRADLE BEAM USING (2) 3/8" X 4" BOLTS AND (2) 3/8" NUTS. DO NOT TORQUE (FIGURE 1.7).

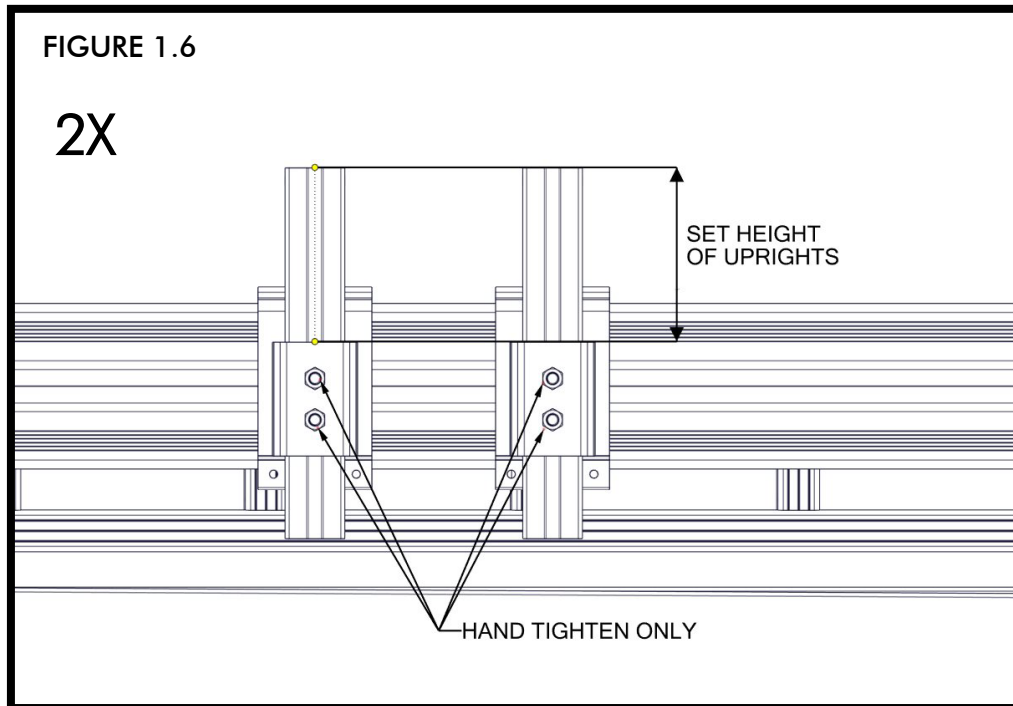

BUNK/CRADLE PAD DISCLAIMER

DUE TO THE LARGE VARIETY OF BOAT HULL DESIGNS, WE STRONGLY RECOMMEND THAT YOU CONSULT WITH YOUR BOAT'S MANUFACTURER TO INSURE THAT YOUR ARE SUPPORTING YOUR BOAT PROPERLY TO AVOID ANY POTENTIAL DAMAGE.

NOTE: SEE FIGURE 2.4 FOR GENERAL GUIDELINES ON SETUP

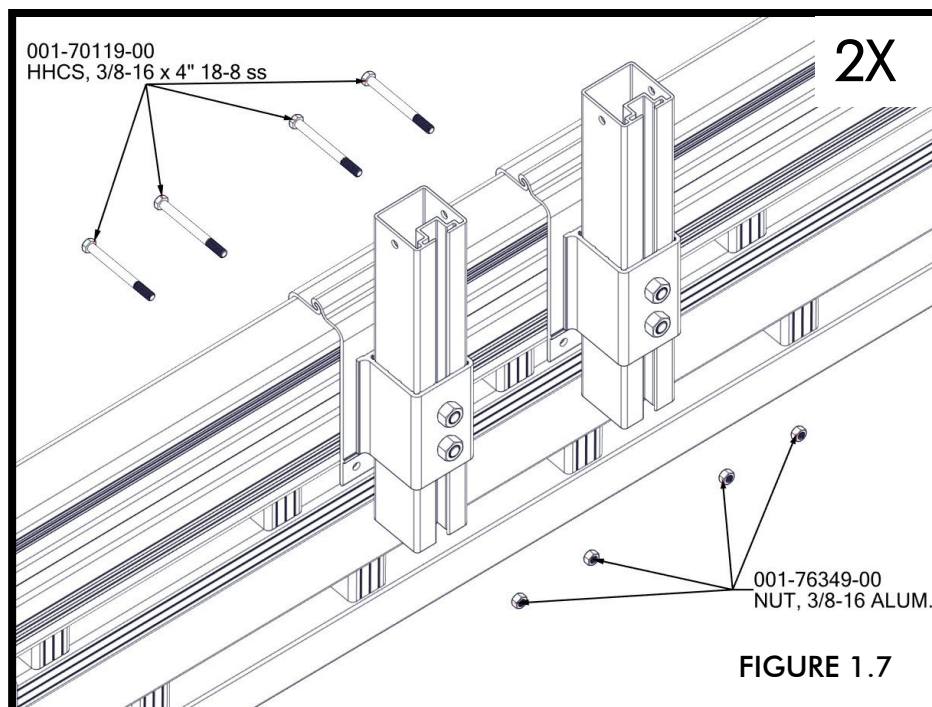

STEP 2

PLACE BUNKS ONTO UPRIGHTS WITH PADS ANGLED TO CRADLE PONTOON (FIGURE 2.1). FOR VSD10000 INSTALLATIONS, THE OUTERMOST HOLE ON THE BUNKS IS USED, THE INNERMOST HOLE IS NOT (FIGURE 2.2). FOR VSD6500/8000 INSTALLATIONS, THE INNERMOST HOLE ON THE BUNKS IS USED, THE OUTERMOST HOLE IS NOT (FIGURE 2.2A). THIS WILL RESULT IN EXTRA OVERHANG OF THE BUNKS.

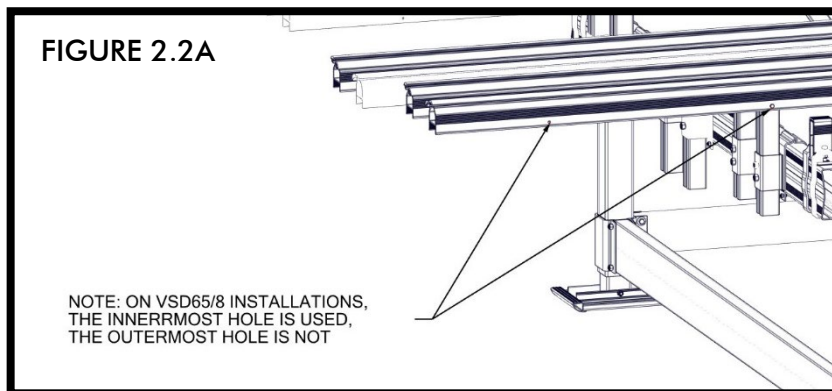
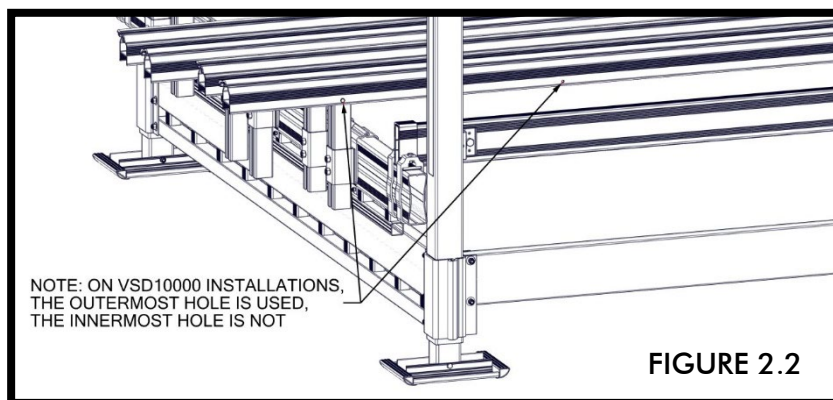
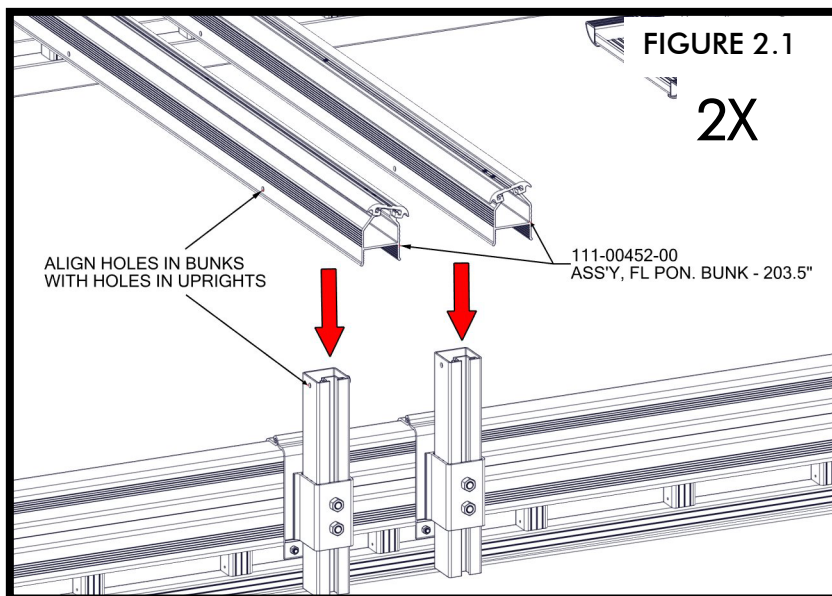

ATTACH USING (2) 3/8" X 3 3/4" BOLTS AND (2) 3/8" NUTS PER UPRIGHT (FIGURE 2.3). TORQUE TO 35 FT-LBS (FIGURE 2.4).

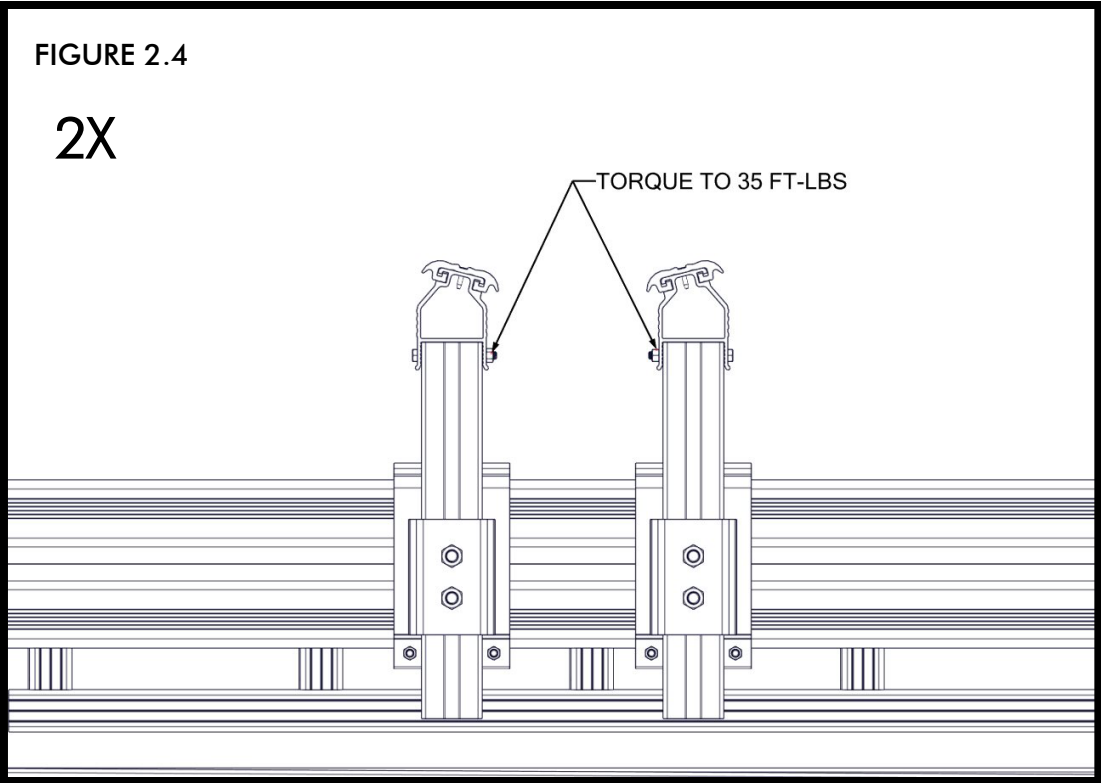
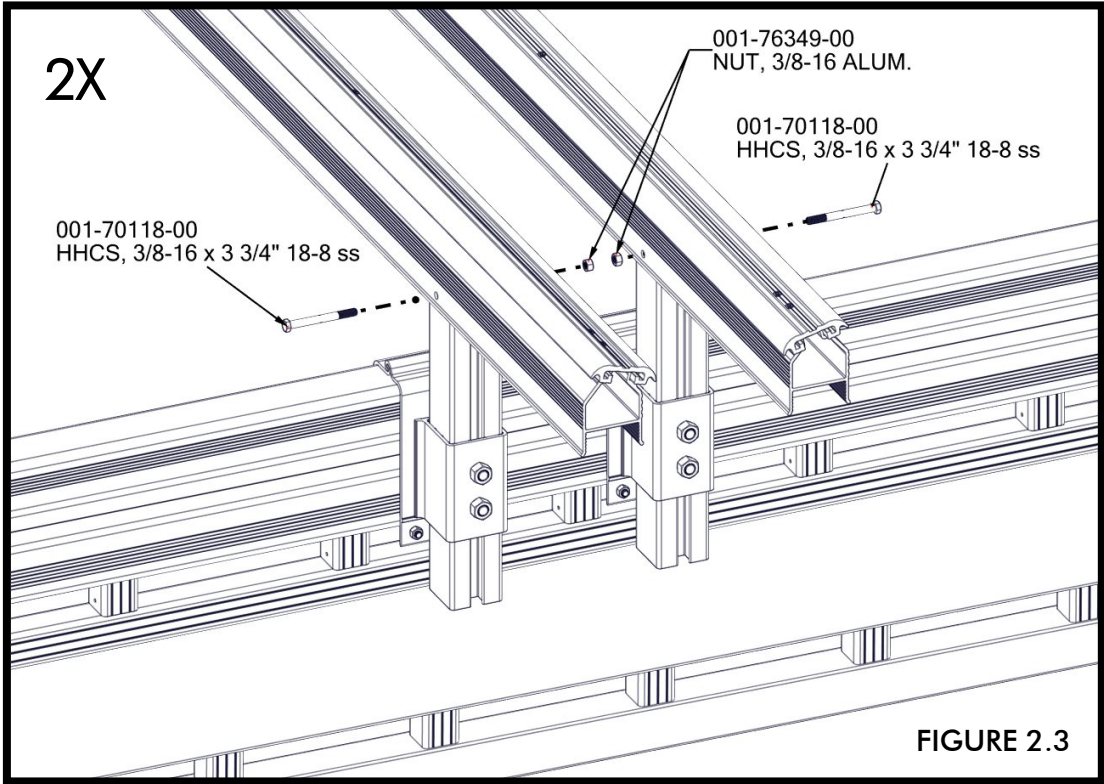

FOLLOW THESE GUIDELINES FOR USING AND LOCATING THE PONTOON BUNKS (FIGURE 2.5).

-THE WIDTH OF THE BUNKS SHOULD KEEP THE PONTOONS OFF THE CRADLE BEAMS.

-THE BUNKS SHOULD BE KEPT AS LOW AS POSSIBLE (NOT QUITE TOUCHING THE CLAMP).

-TO PLACE BUNKS, FIND CENTER BETWEEN PONTOONS AND CENTER OF THE BOAT FROM PONTOONS AND TRANSLATE MEASUREMENT TO CRADLE BEAM TO DETERMINE CENTER OF EACH PAIR OF BUNKS. LOCATE MIDDLE BUNKS AROUND CENTER OF CRADLE BEAM.

-THE REAR OF A 21' PONTOON BOAT SHOULD OVERHANG PAST THE LIFT BY 3 FEET. FOR EVERY ADDITIONAL FOOT IN LENGTH OF THE BOAT, IT SHOULD OVERHANG BY AN ADDITIONAL 6 INCHES BEYOND THE REAR OF THE LIFT. THESE ARE GENERAL GUIDELINES THAT CAN BE ADJUSTED FOR AN INDIVIDUAL'S CIRCUMSTANCES.

-ONCE BUNKS ARE IN THEIR FINAL LOCATION, TORQUE 3/8" NUTS ON CRADLE CLAMPS TO 35 FT-LBS AND 5/8" NUTS ON CRADLE CLAMPS TO 70 FT-LBS (FIGURE 2.5).

