

FLOE PONTOON GUIDE-IN/BUNK VSD6500-VSD10,000 WIDE ASSEMBLY INSTRUCTIONS

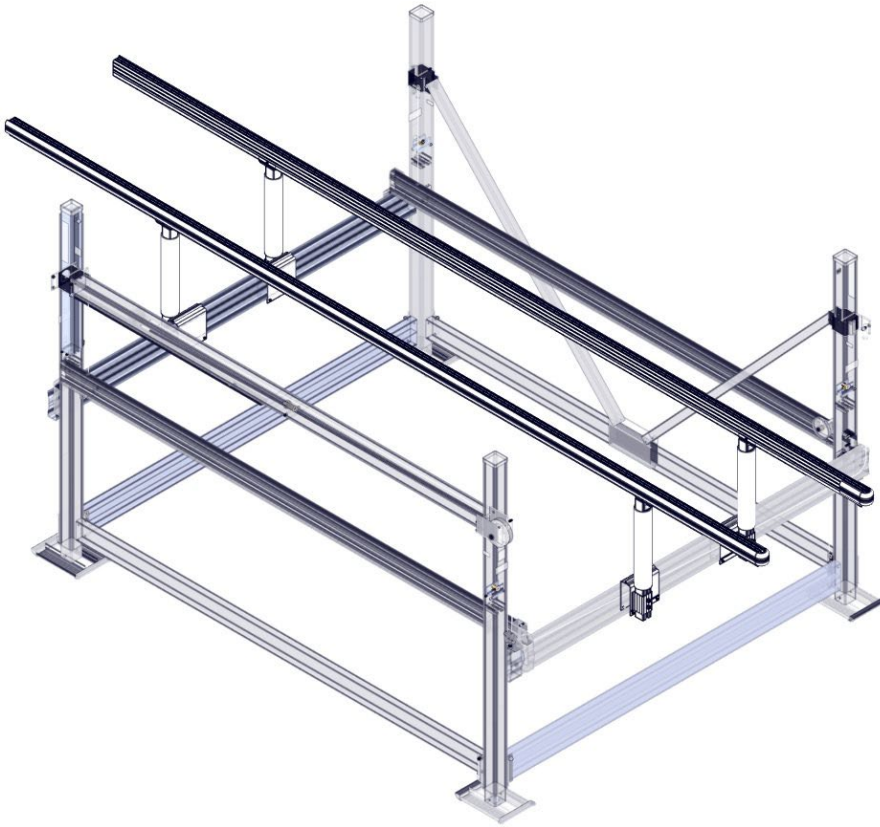

KIT P/N 511-02484-01, 511-02485-01, 511-02486-01



TOOLS REQUIRED

- (2) 9/16" SOCKET/WRENCH
- 15/16" SOCKET/WRENCH
- TAPE MEASURE
- TORQUE WRENCH
- RECIPROCATING SAW OR EQUIVALENT WITH METAL BLADE AND PVC BLADE (OPTIONAL, SEE SHEETS 12 & 16)
- 0.406" (13/32") DRILL BIT & DRILL (MAY BE NECESSARY FOR VSD10,000 WIDE LIFTS LIFTS)

*LIFT NOT INCLUDED

BUNK/CRADLE PAD DISCLAIMER

DUE TO THE LARGE VARIETY OF BOAT HULL DESIGNS, WE STRONGLY RECOMMEND THAT YOU CONSULT WITH YOUR BOAT'S MANUFACTURER TO ENSURE THAT YOU ARE SUPPORTING YOUR BOAT PROPERLY TO AVOID ANY POTENTIAL DAMAGE.

BILL OF MATERIALS

P/N 001-02426-01	FASTENERS, PON. GUIDE/BUNKS		
<u>NUMBER</u>	<u>PART NUMBER</u>	<u>QTY.</u>	<u>DESCRIPTION</u>
1A	001-70114-00	4	HHCS, 3/8-16 x 2 3/4" 18-8 ss
1B	001-70119-00	8	HHCS, 3/8-16 x 4" 18-8 ss
1C	001-70305-00	8	HHCS, 5/8-11 x 1" 18-8 ss
1D	001-71025-00	8	FLAT WASHER, 5/8" SAE 18-8 ss
1E	001-76349-00	12	NUT, 3/8-16 ALUM.
1F	001-76351-00	8	NUT, 5/8-11 ALUM.

P/N 511-02484-01	GI/BUNK, PONTOON 22' VSD6500/8000 PONTOON & 10K WIDE		
<u>NUMBER</u>	<u>PART NUMBER</u>	<u>QTY.</u>	<u>DESCRIPTION</u>
1	001-02426-01	1	FASTENERS, PON. GUIDE/BUNKS
2	002-04287-00	4	CLAMP, BUNK CRADLE (MALE)
3	111-00001-00	4	WELD'T, BUNK UPRIGHT (LARGE)
4	111-00006-01	2	WELD'T, POCKET – CLAMP SIDE (1) 2 HOLE
5	111-00009-01	2	WELD'T, POCKET – CLAMP SIDE (2) 2 HOLE
6	111-00491-00	1	ASS'Y, GUIDE BUNK PONTOON "A" - 264"
7	111-00492-00	1	ASS'Y, GUIDE BUNK PONTOON "B" - 264"

P/N 211-02430-00	KIT, PONTOON GI/BUNK PVC – 4" DIA.		
<u>NUMBER</u>	<u>PART NUMBER</u>	<u>QTY.</u>	<u>DESCRIPTION</u>
11	958-01302-00	4	TUBE, 4" SCH 40 PVC – 23.813"

EXPLODED VIEW

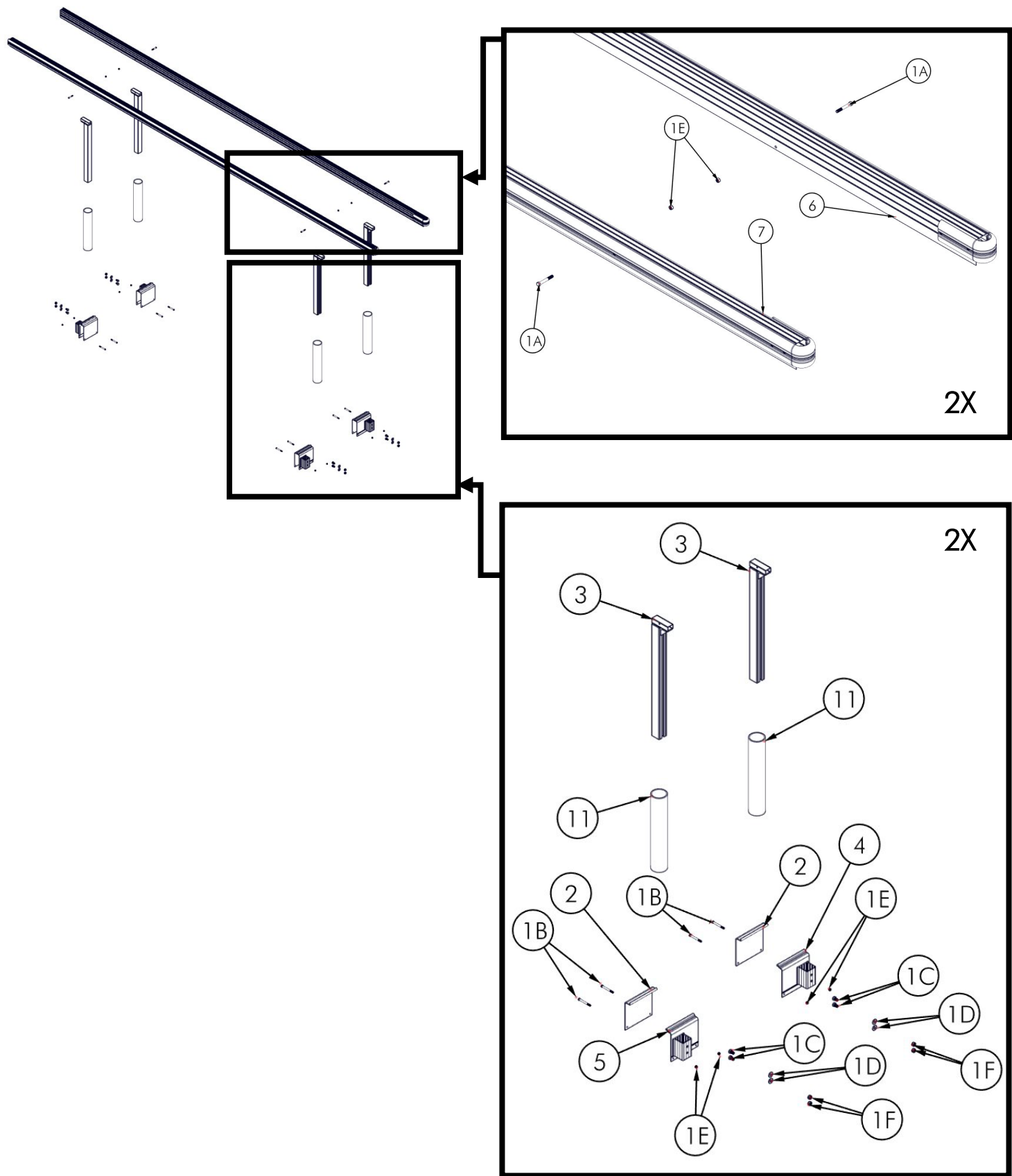

BILL OF MATERIALS/EXPLODED VIEW - BUNKS

P/N 111-00491-00	ASS'Y, BUNK – PONTOON 264" (A)		
P/N 111-00492-00	ASS'Y, BUNK – PONTOON 264" (B)		
NUMBER	PART NUMBER	QTY.	DESCRIPTION
6	111-00491-00	1	ASS'Y, BUNK – PONTOON 264" (A)
A	001-29825-00	13	SCREW, 10-24 X 1" SQWFRTEK
B	001-71000-00	2	FLAT WASHER, 5/16 ID X 7/8" OD SS
C	958-00327-00	1	PVC, BUMPER EXTRUSION – 276.5"
7	111-00492-00	1	ASS'Y, BUNK – PONTOON 264" (B)
A	001-29825-00	13	SCREW, 10-24 X 1" SQWFRTEK
B	001-71000-00	2	FLAT WASHER, 5/16 ID X 7/8" OD SS
C	958-00327-00	1	PVC, BUMPER EXTRUSION – 276.5"

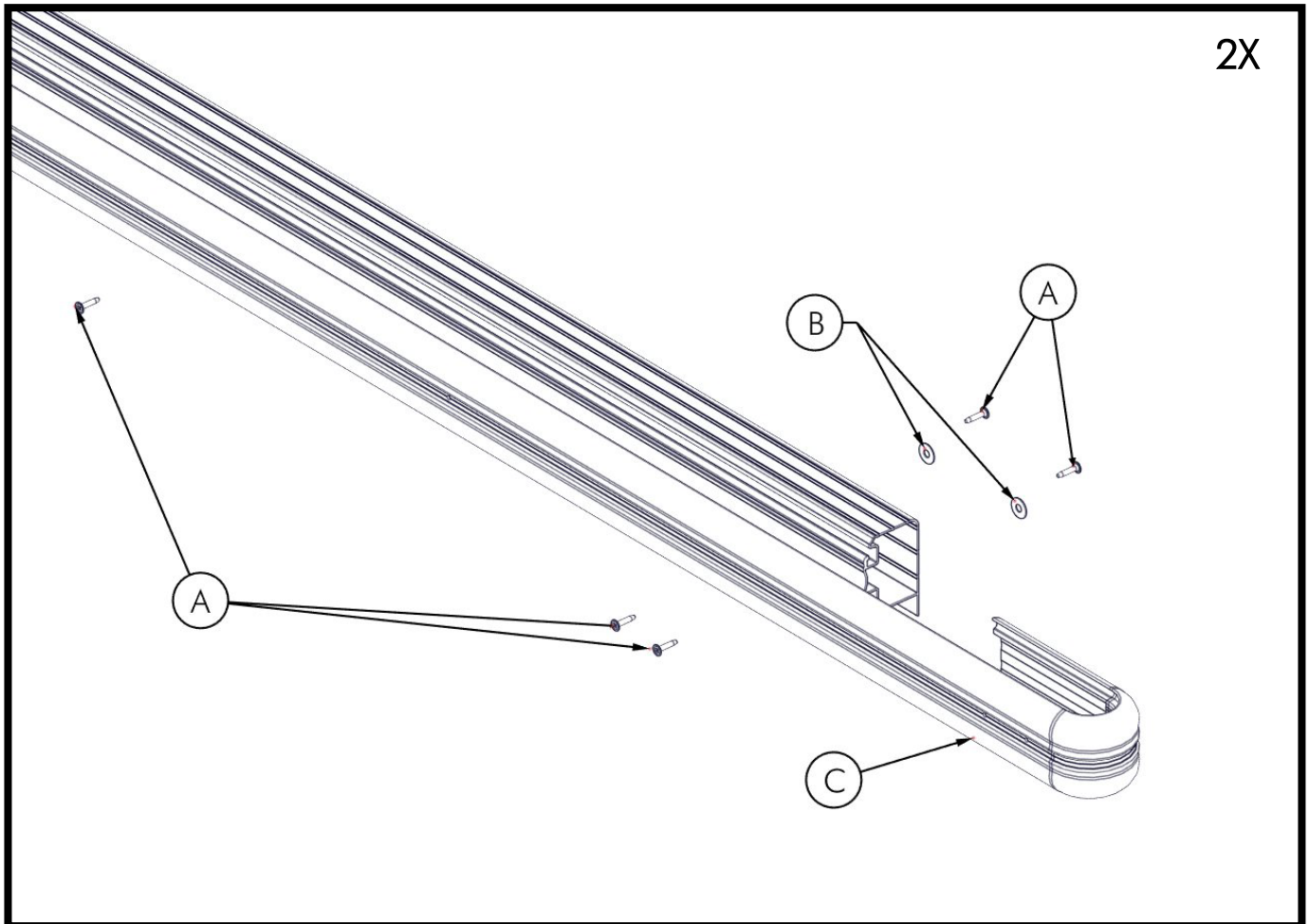

BILL OF MATERIALS

P/N 001-02426-01	FASTENERS, PON. GUIDE/BUNKS		
<u>NUMBER</u>	<u>PART NUMBER</u>	<u>QTY.</u>	<u>DESCRIPTION</u>
1A	001-70114-00	4	HHCS, 3/8-16 x 2 3/4" 18-8 ss
1B	001-70119-00	8	HHCS, 3/8-16 x 4" 18-8 ss
1C	001-70305-00	8	HHCS, 5/8-11 x 1" 18-8 ss
1D	001-71025-00	8	FLAT WASHER, 5/8" SAE 18-8 ss
1E	001-76349-00	12	NUT, 3/8-16 ALUM.
1F	001-76351-00	8	NUT, 5/8-11 ALUM.

P/N 511-02485-01	GI/BUNK, PONTOON 16' VSD6000-8000		
P/N 511-02486-01	GI/BUNK, PONTOON 18' VSD6000-8000		
<u>NUMBER</u>	<u>PART NUMBER</u>	<u>QTY.</u>	<u>DESCRIPTION</u>
1	001-02426-01	1	FASTENERS, PON. GUIDE/BUNKS
2	002-04287-00	4	CLAMP, BUNK CRADLE (MALE)
3	111-00001-00	4	WELD'T, BUNK UPRIGHT (LARGE)
4	111-00006-01	2	WELD'T, POCKET – CLAMP SIDE (1) 2 HOLE
5	111-00009-01	2	WELD'T, POCKET – CLAMP SIDE (2) 2 HOLE
6	111-00370-00	1	ASS'Y, BUNK – PONTOON 192" (A) (PART OF 511-02485-01)
7	111-00371-00	1	ASS'Y, BUNK – PONTOON 192" (B) (PART OF 511-02485-01)
8	111-00385-00	1	ASS'Y, BUNK – PONTOON 216" (A) (PART OF 511-02486-01)
9	111-00386-00	1	ASS'Y, BUNK – PONTOON 216" (B) (PART OF 511-02486-01)

P/N 211-02430-00	KIT, PONTOON GI/BUNK PVC – 4" DIA.		
<u>NUMBER</u>	<u>PART NUMBER</u>	<u>QTY.</u>	<u>DESCRIPTION</u>
11	958-01302-00	4	TUBE, 4" SCH 40 PVC – 23.813"

EXPLODED VIEW

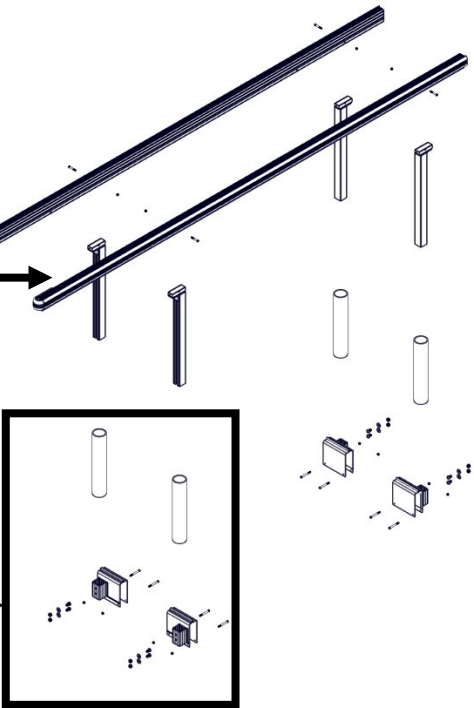
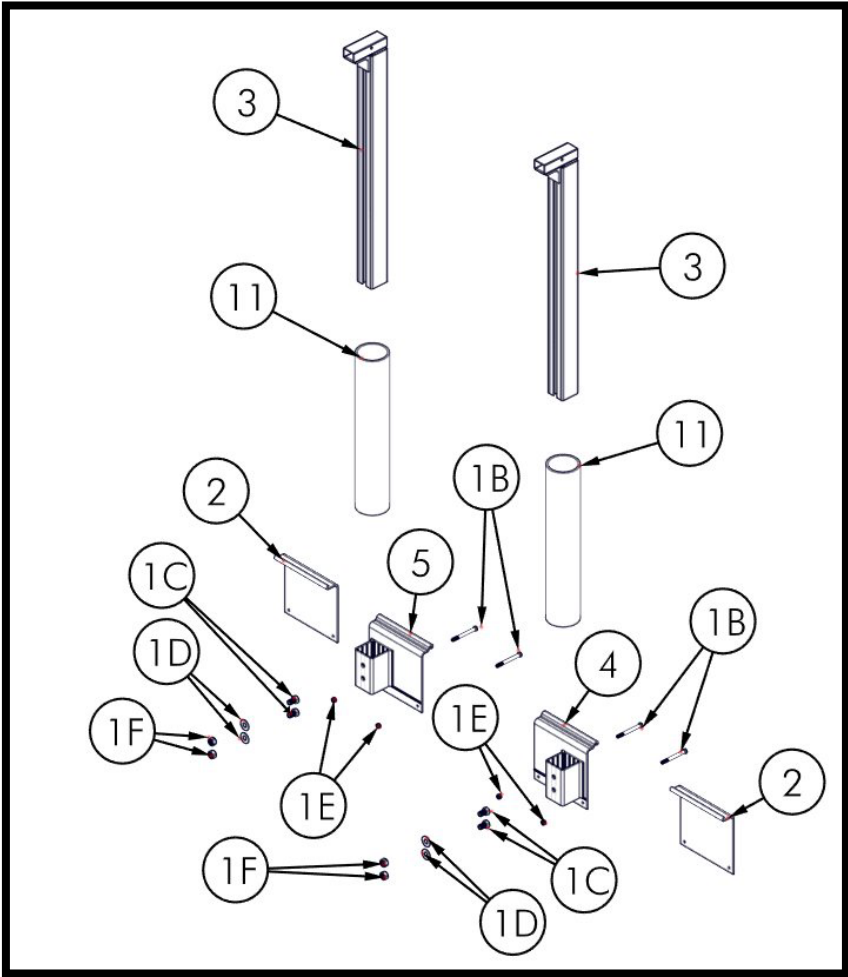
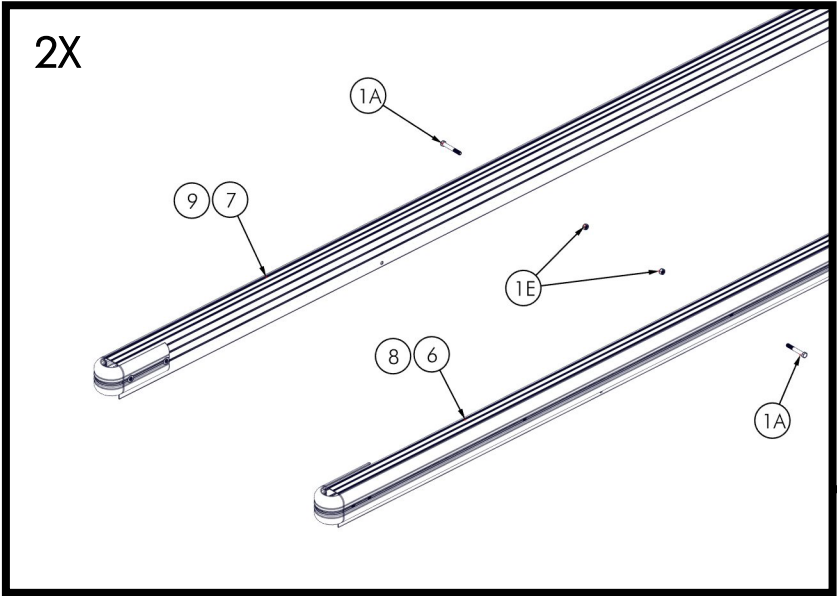

BILL OF MATERIALS - BUNKS

P/N 111-00370-00	ASS'Y, BUNK – PONTOON 192" (A)		
P/N 111-00371-00	ASS'Y, BUNK - PONTOON 192" (B)		
P/N 111-00385-00	ASS'Y, BUNK – PONTOON 216" (A)		
P/N 111-00386-00	ASS'Y, BUNK – PONTOON 216" (B)		
<u>NUMBER</u>	<u>PART NUMBER</u>	<u>QTY.</u>	<u>DESCRIPTION</u>
6	111-00370-00	1	ASS'Y, BUNK – PONTOON 192" (A)
A	001-29825-00	11	SCREW, 10-24 X 1" SQWFRTEK
B	001-71000-00	2	FLAT WASHER, 5/16 ID X 7/8" OD SS
6A	958-00320-00	1	PVC, BUMPER EXTRUSION – 204.5"
7	111-00371-00	1	ASS'Y, BUNK – PONTOON 192" (B)
A	001-29825-00	11	SCREW, 10-24 X 1" SQWFRTEK
B	001-71000-00	2	FLAT WASHER, 5/16 ID X 7/8" OD SS
7A	958-00320-00	1	PVC, BUMPER EXTRUSION – 204.5"
8	111-00385-00	1	ASS'Y, BUNK – PONTOON 216" (A)
A	001-29825-00	12	SCREW, 10-24 X 1" SQWFRTEK
B	001-71000-00	2	FLAT WASHER, 5/16 ID X 7/8" OD SS
8A	958-00322-00	1	PVC, BUMPER EXTRUSION – 228.5"
9	111-00386-00	1	ASS'Y, BUNK – PONTOON 216" (B)
A	001-29825-00	12	SCREW, 10-24 X 1" SQWFRTEK
B	001-71000-00	2	FLAT WASHER, 5/16 ID X 7/8" OD SS
9A	958-00322-00	1	PVC, BUMPER EXTRUSION – 228.5"

EXPLODED VIEW - BUNKS

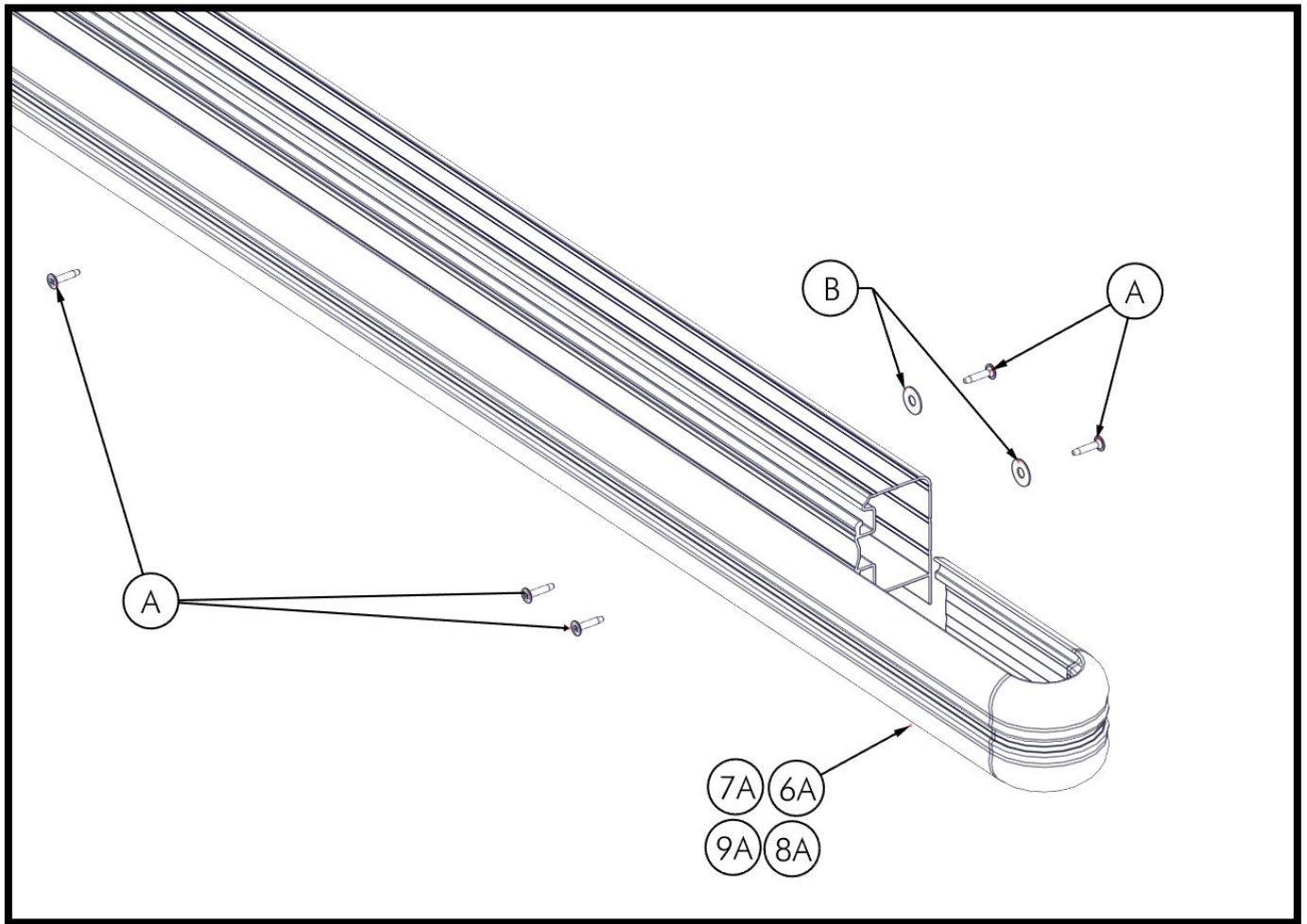

STEP 1

SLIDE CLAMPS TOGETHER (FIGURE 1.1) AND SLIDE PAIRS OVER CRADLE BEAM (FIGURE 1.2).

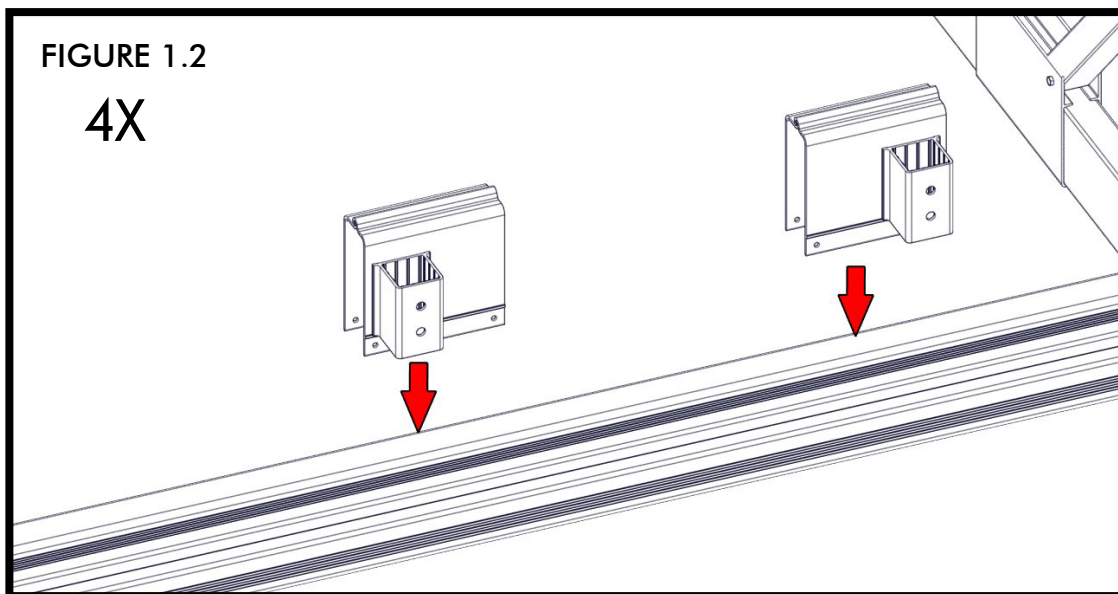
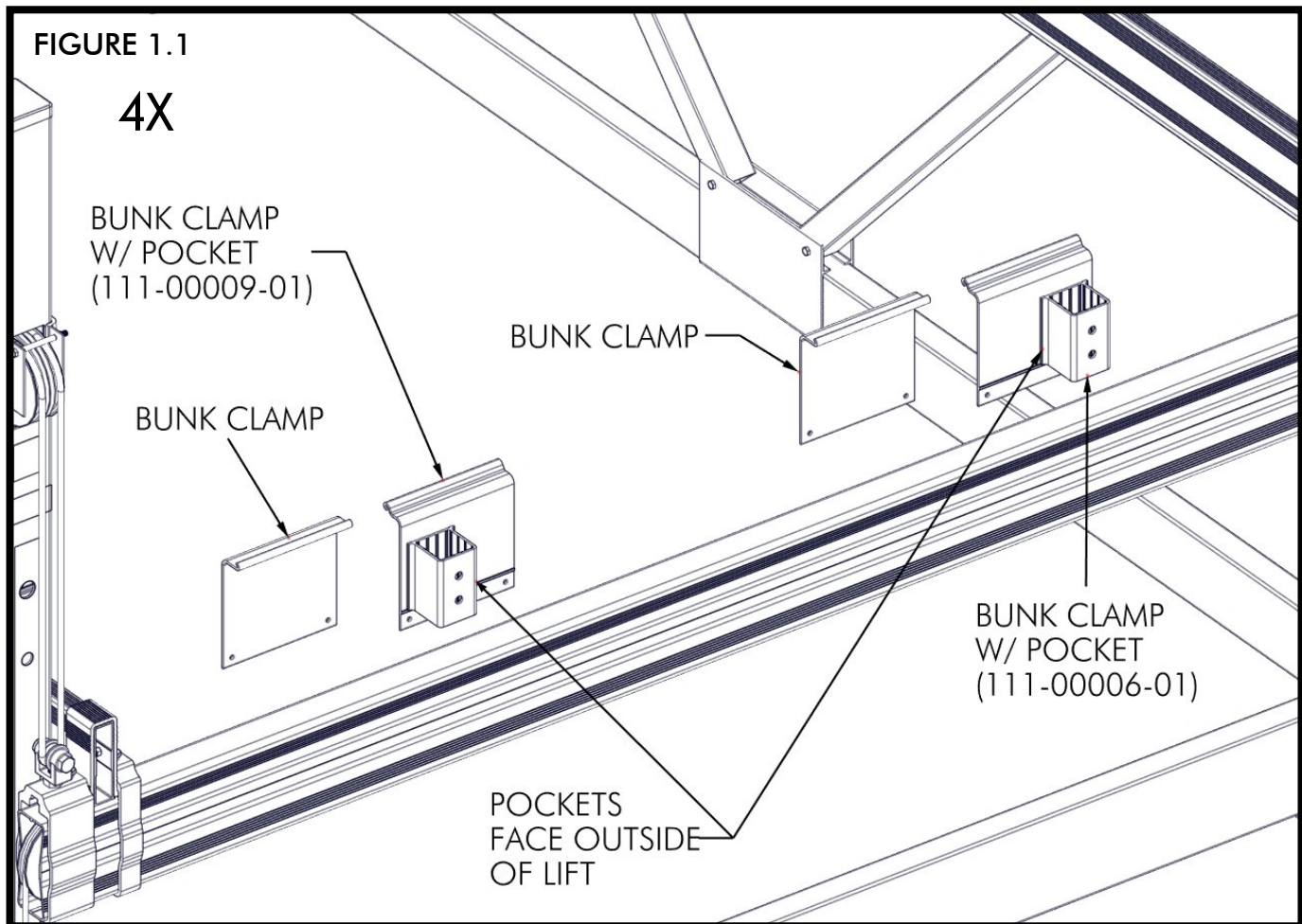

NOTE: IF CRADLE BEAM WELDMENT IMPEDES BOLT PLACEMENT IN UPRIGHT CLAMPS, DRILL A 13/32" HOLE THROUGH THE 2" TUBES ON THE CRADLE BEAM (VSD10000 INSTALLATIONS ONLY (FIGURE 1.2A). PLACE (2) 5/8" X 1" BOLTS AND (2) 1/2" WASHERS INTO EACH CLAMP WELDMENT POCKET (FIGURE 1.3).

FIGURE 1.2A

4X

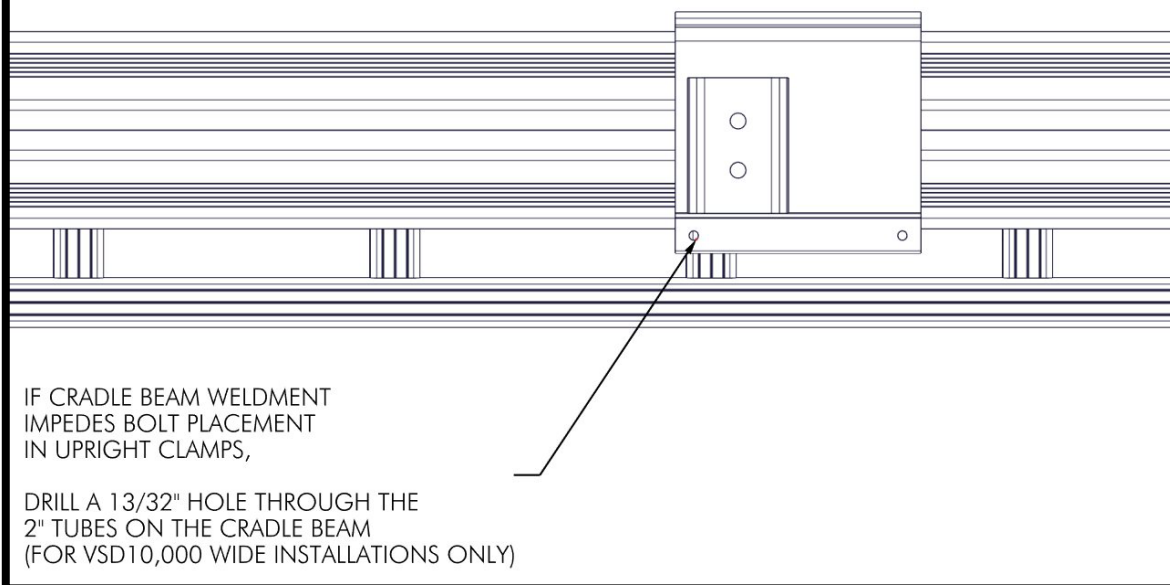
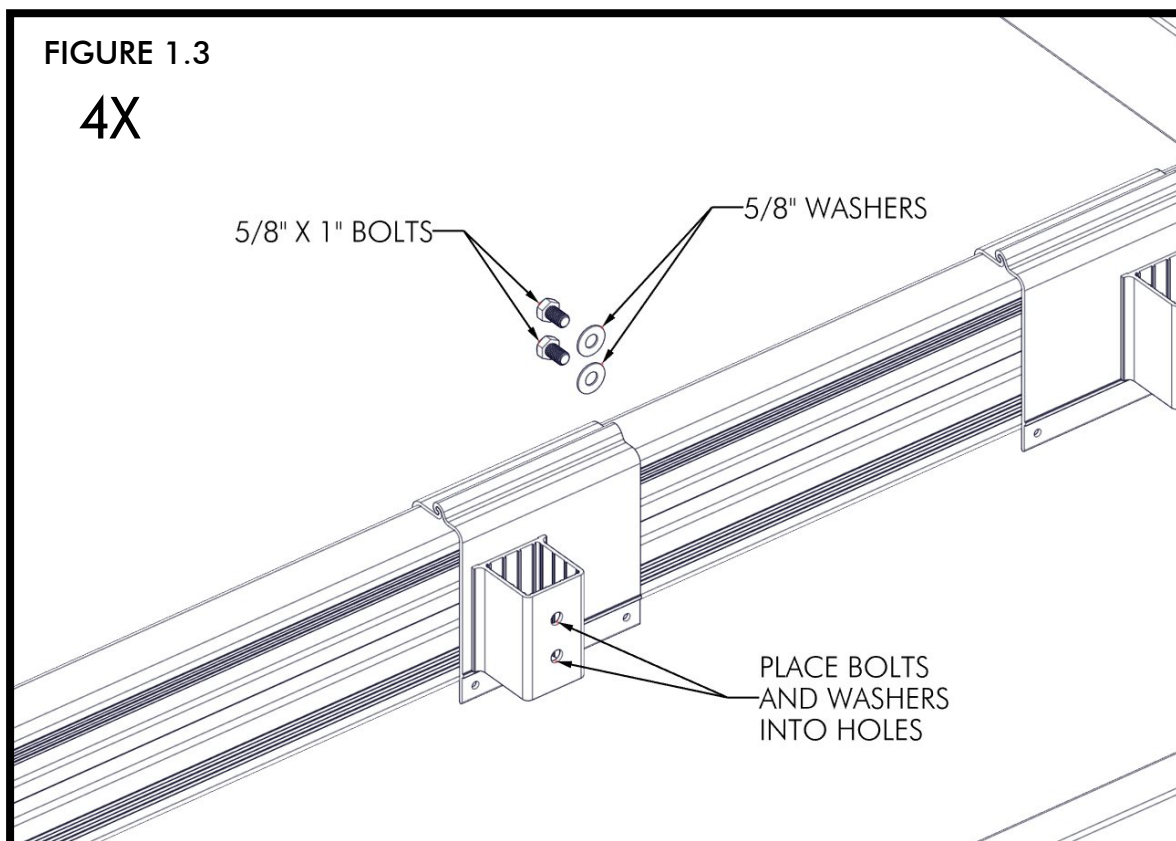
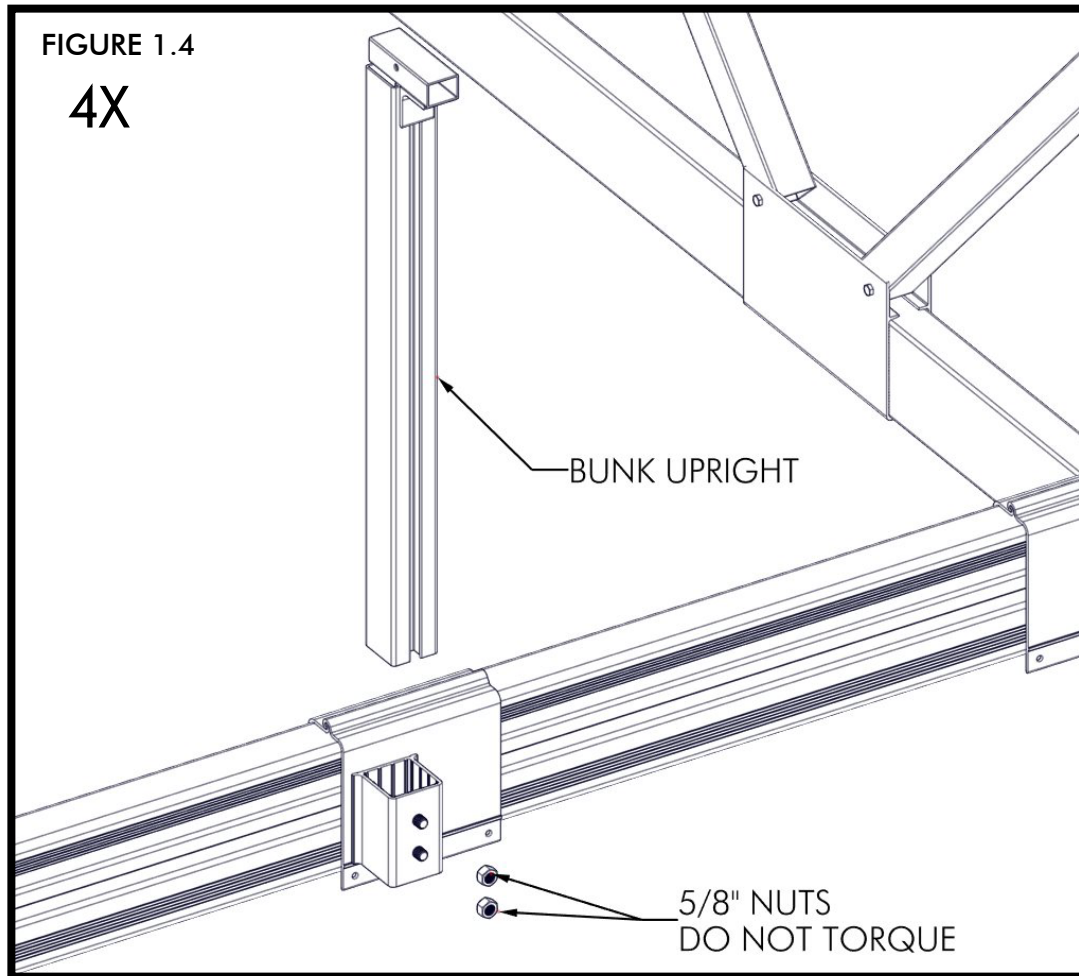

FIGURE 1.3

4X



INSERT UPRIGHT TUBES INTO CLAMP WELDMENTS AND ATTACH USING (2) 5/8" NUTS, HAND TIGHT ONLY (FIGURE 1.4).



ADJUST HEIGHT WHILE REFERRING TO FIGURES 1.5A & 2.5A (FIGURE 1.5). FIGURE 1.5A SHOWS THE DISTANCE FROM THE TOP OF THE BUNK TO THE TOP OF THE UPRIGHT TUBE.

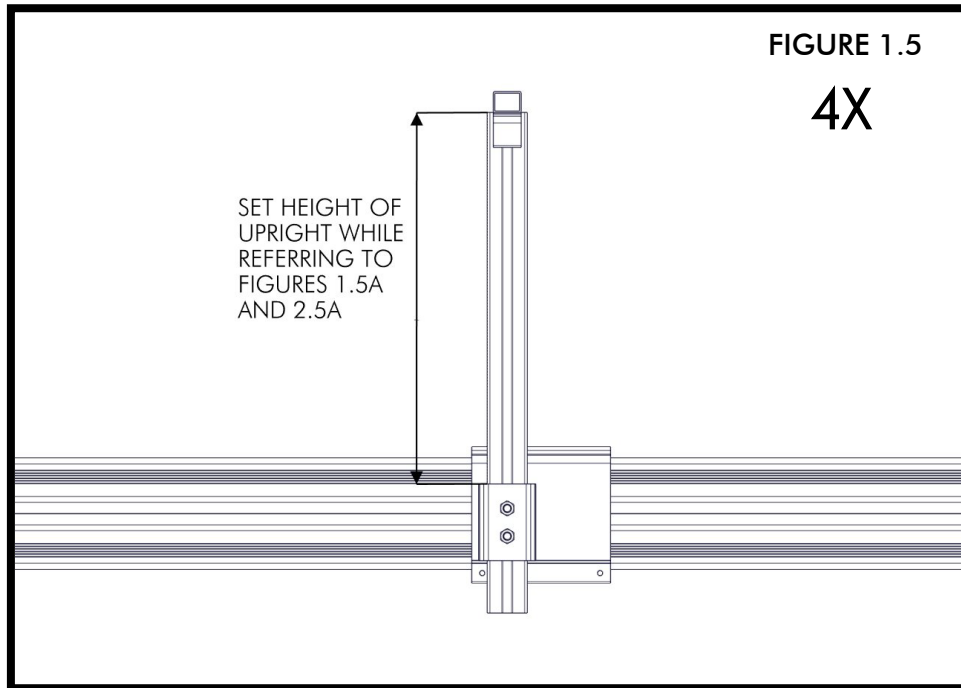

NOTE:

UPRIGHTS MAY HAVE TO BE CUT TO ALLOW FULL TRAVEL OF CRADLE ONCE FINAL PLACEMENT IS ESTABLISHED. PVC MAY ALSO HAVE TO BE CUT TO FIT BETWEEN THE BUNK AND CLAMP.

BUNK/CRADLE PAD
DISCLAIMER

DUE TO THE LARGE VARIETY OF BOAT HULL DESIGNS, WE STRONGLY RECOMMEND THAT YOU CONSULT WITH YOUR BOAT'S MANUFACTURER TO ENSURE THAT YOU ARE SUPPORTING YOUR BOAT PROPERLY TO AVOID ANY POTENTIAL DAMAGE.

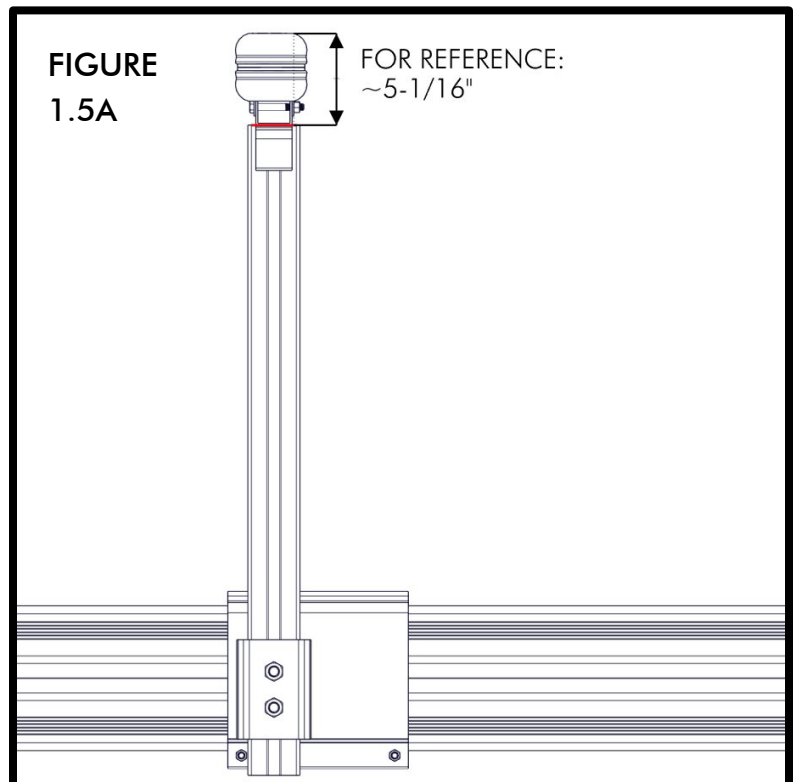

ONCE THE MEASUREMENT IS MADE, REMOVE THE UPRIGHTS, SLIDE THE INCLUDED PVC TUBES OVER THE UPRIGHTS, THEN SLIDE THE UPRIGHTS INTO THE POCKETS (FIGURE 1.6). **NOTE: IF THE SET HEIGHT OF THE UPRIGHTS IS LESS THAN THE LENGTH OF THE PVC TUBES, FIRST MEASURE THE DISTANCE FROM THE TOP OF THE TUBE TO THE TOP OF THE CLAMP, NOT THE TOP OF THE POCKET. THEN, SUBTRACT 2-3/4" FROM THAT MEASUREMENT AND CUT THE PVC TUBE TO THAT LENGTH. TORQUE NUTS TO 70 FT-LB (FIGURE 1.6A).** FIGURE 1.6B SHOWS THE BUNK INSTALLED WITH THE PVC TUBE FITTING BETWEEN THE TOP OF THE CLAMP AND ANGLE WELDED TO THE UPRIGHT.

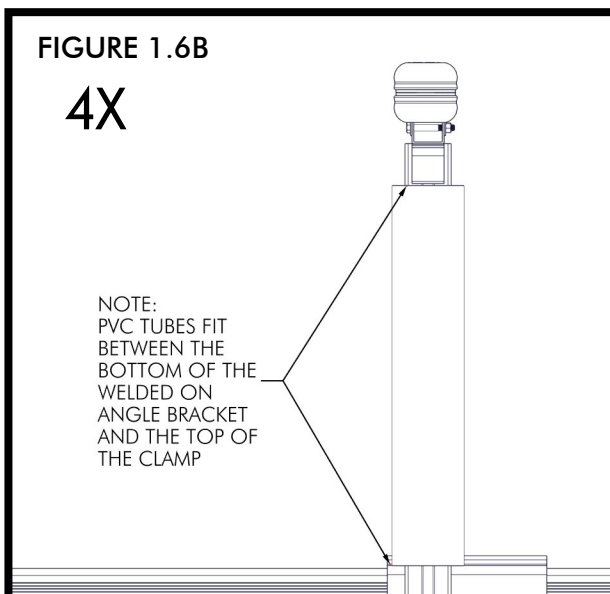
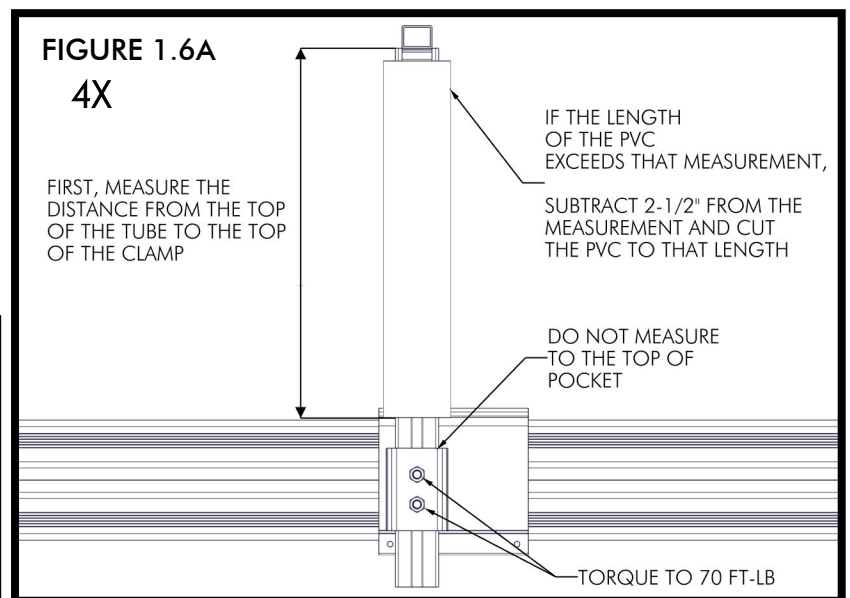
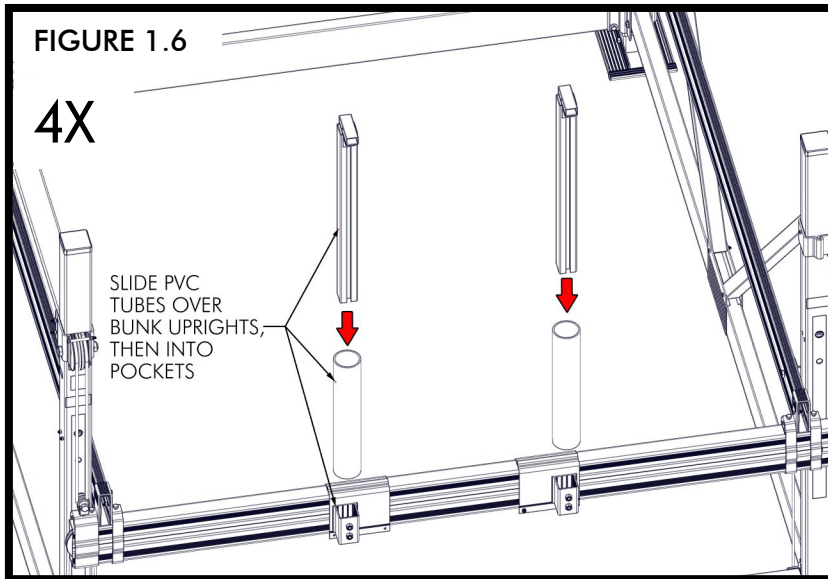

STEP 2

PLACE BUNKS ONTO UPRIGHTS (FIGURE 2.1) AND ATTACH USING (2) 3/8" X 3 3/4" BOLTS AND (2) 3/8" NUTS PER UPRIGHT (FIGURE 2.2).

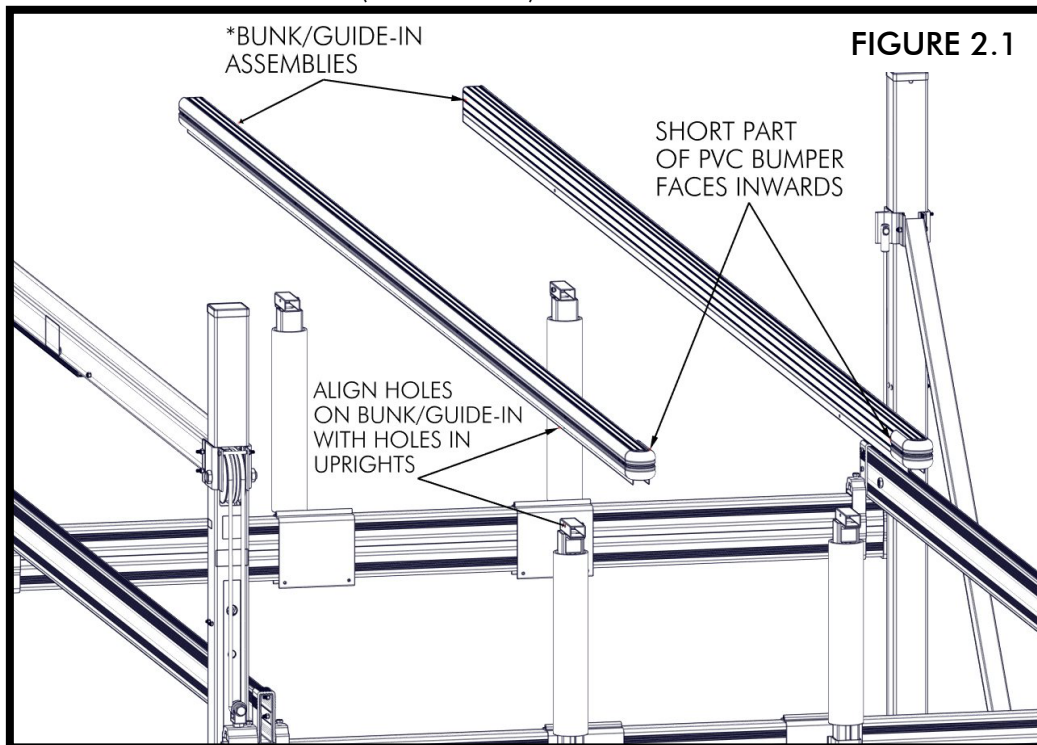

FIGURE 2.1

*111-00491-00 &
111-00492-00
INCLUDED WITH
511-02484-01
(22' PONTOON
BUNKS/GUIDE INS)

*111-00370-00 &
111-00371-00
INCLUDED WITH
511-02485-001
(16' PONTOON
BUNKS/GUIDE-INS)

*111-00385-00 &
111-00386-00
INCLUDED WITH
511-02486-01
(18' PONTOON
BUNKS/GUIDE-INS)

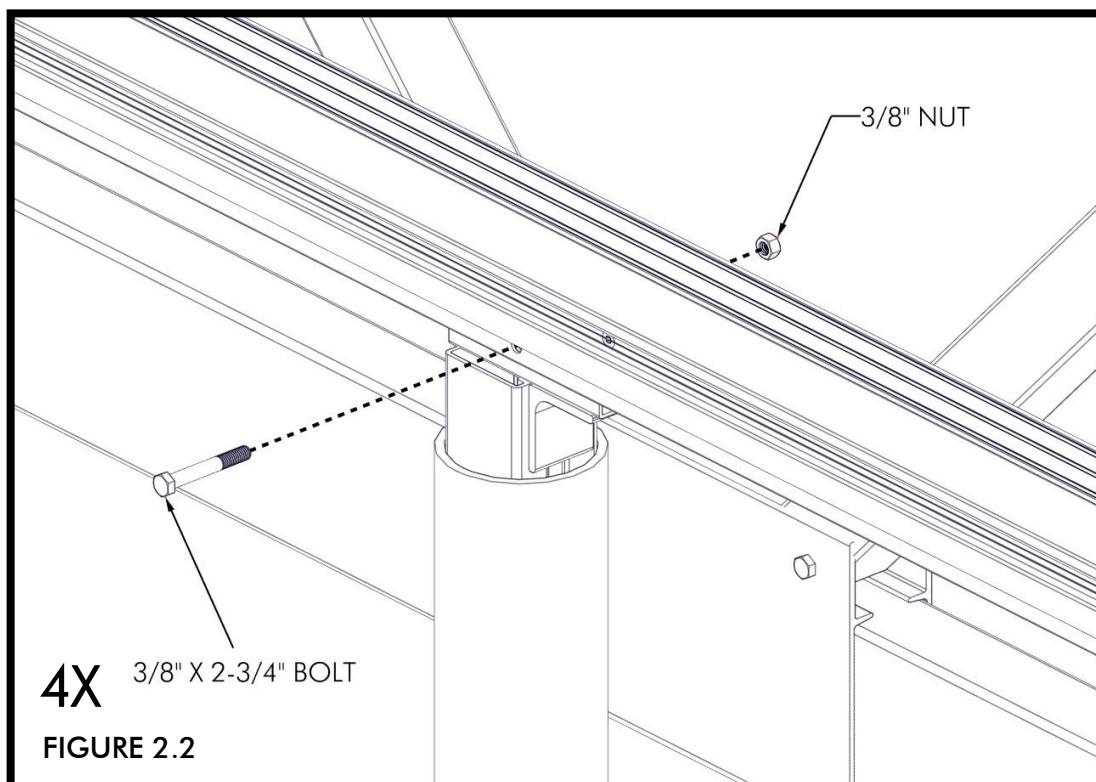
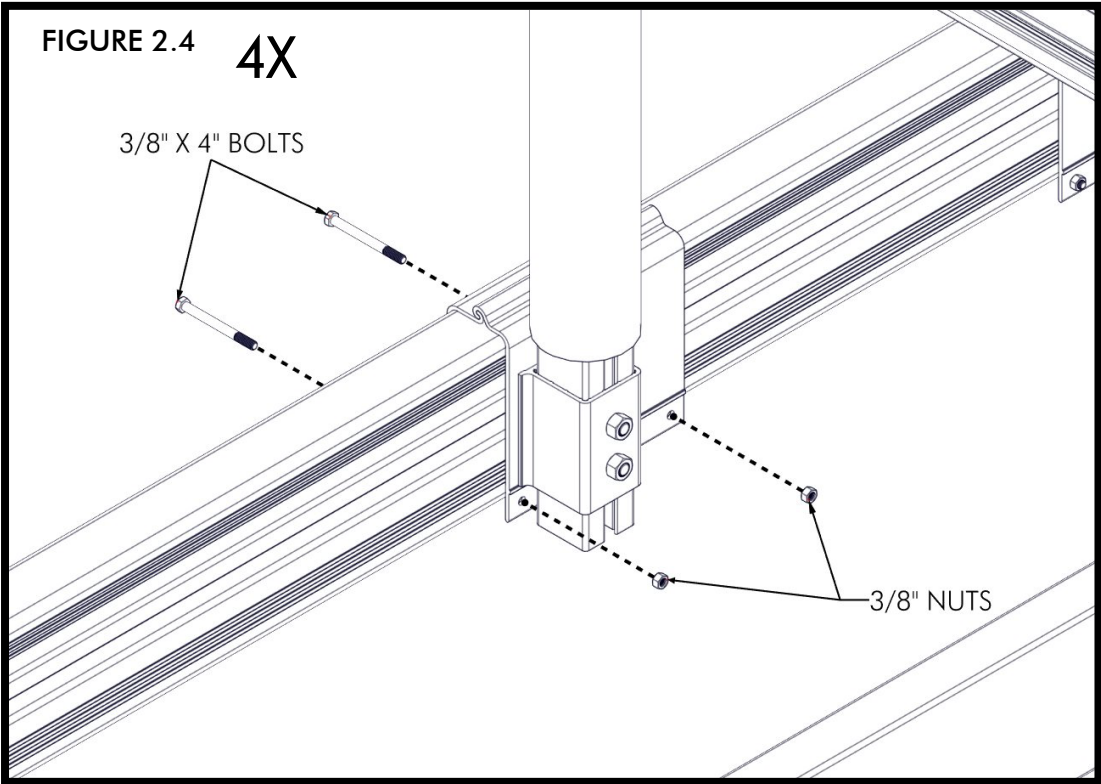
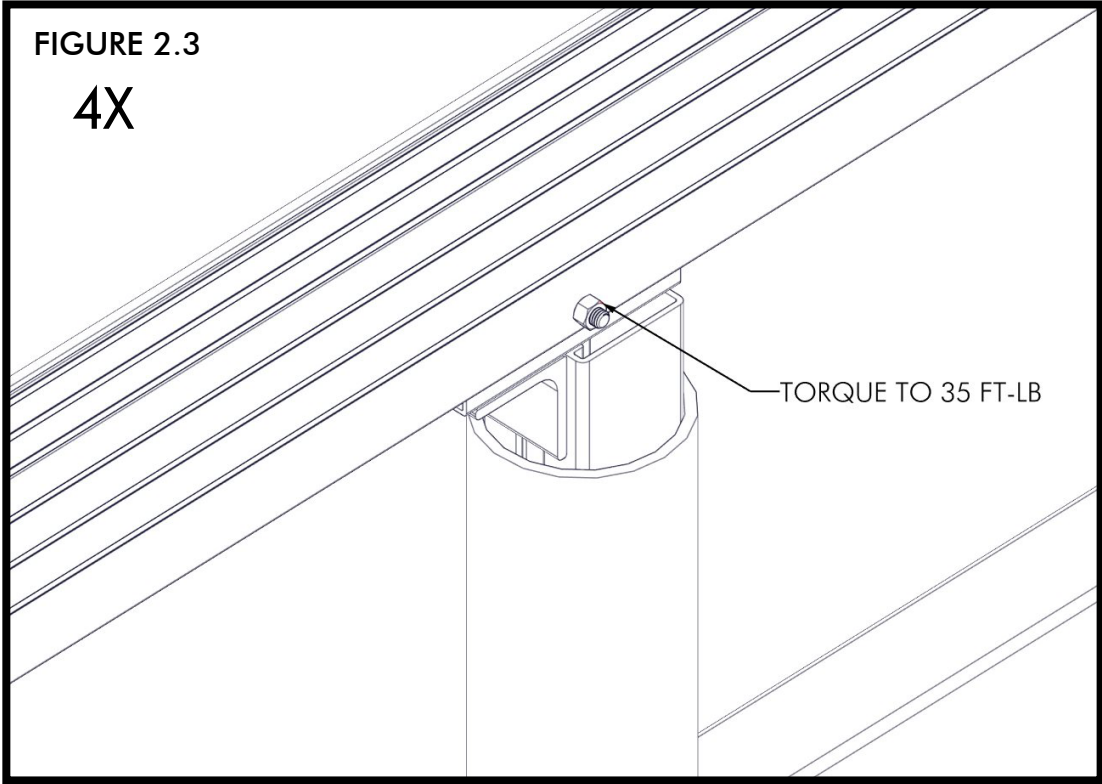

FIGURE 2.2

TORQUE NUTS TO 35 FT-LBS (FIGURE 2.3). ATTACH CLAMP WELDMENT TO CRADLE BEAM USING (2) 3/8" X 4" BOLTS AND (2) 3/8" NUTS (FIGURE 2.4).



FOLLOW THESE GUIDELINES FOR USING AND LOCATING THE PONTOON BUNKS (FIGURE 2.5A & 2.5B).

-THE WIDTH OF THE BUNKS SHOULD BE 1-2 INCHES LESS THAN THE DISTANCE BETWEEN THE PONTOONS.

-TO SET BUNK HEIGHT, MEASURE FROM THE BOTTOM OF THE PONTOON DECK TO THE BOTTOM OF THE PONTOON, THEN ADD 1" TO THAT MEASUREMENT.

-THE REAR OF A 21 FOOT PONTOON BOAT SHOULD OVERHANG PAST THE LIFT BY 3 FEET. FOR EVERY ADDITIONAL FOOT IN LENGTH OF THE BOAT, IT SHOULD OVERHANG BY AN ADDITIONAL 6 INCHES BEYOND THE REAR OF THE LIFT.

THESE ARE THE GENERAL GUIDELINES THAT CAN BE ADJUSTED FOR AN INDIVIDUAL'S CIRCUMSTANCES.

ONCE FINAL POSITION IS SET, TORQUE 3/8" NUTS ON CLAMPS TO 35 FT-LBS (FIGURE 2.6).

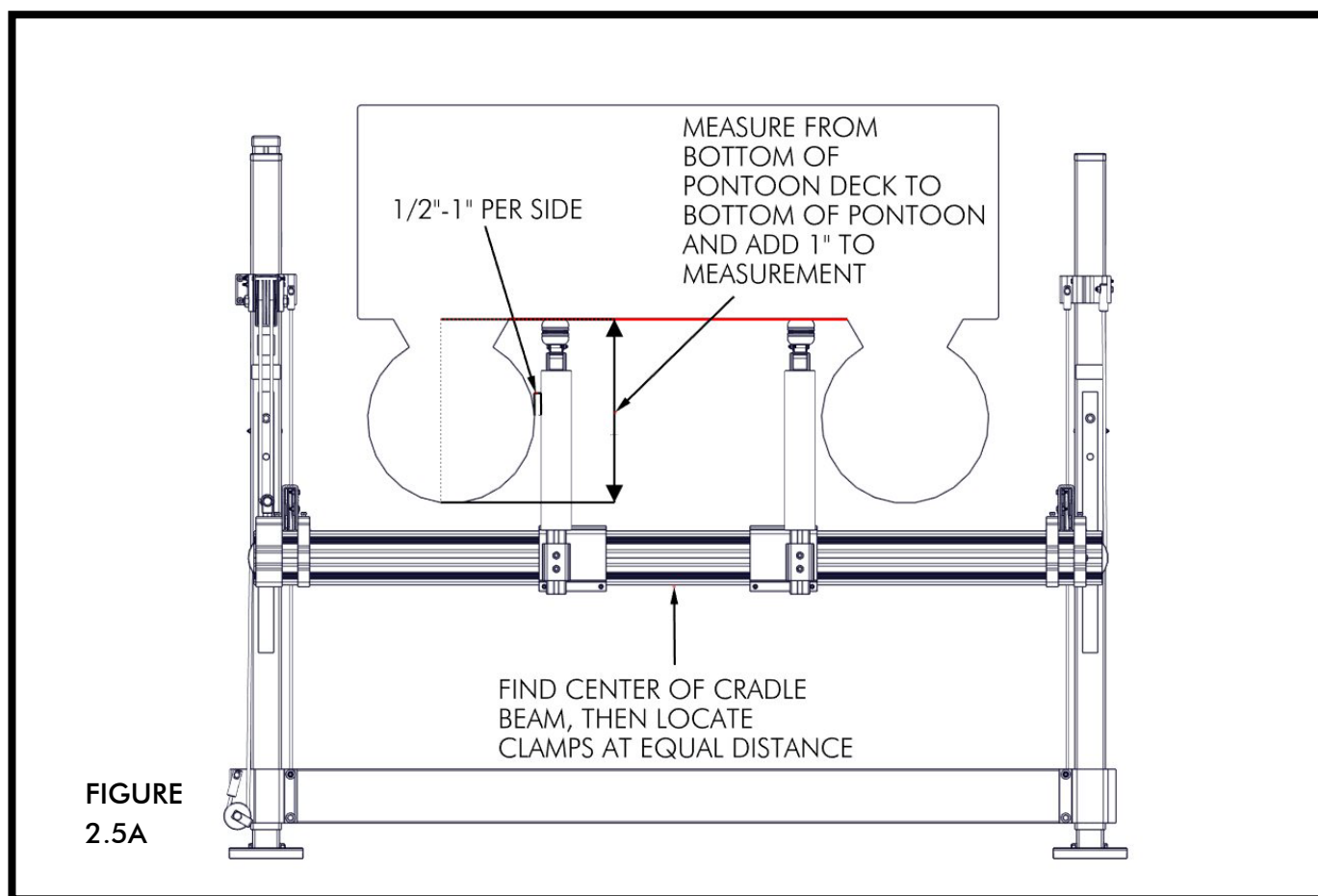

NOTE:

UPRIGHTS MAY HAVE TO BE CUT TO ALLOW FULL TRAVEL OF CRADLE ONCE FINAL PLACEMENT IS ESTABLISHED. PVC MAY ALSO HAVE TO BE CUT TO FIT BETWEEN THE BUNK AND CLAMP.

-WHEN ENTERING OR EXITING LIFT, THE TOP OF THE BUNKS SHOULD BE APPROXIMATELY 4 TO 5 ½ INCHES OUT OF THE WATER, DEPENDING ON BOAT AND AMOUNT OF DRAFT (FIGURE 2.5B).

IMPORTANT: FAILURE TO SET BUNK HEIGHT CORRECTLY WILL RESULT IN DAMAGE TO BOAT, BUNKS, AND/OR LIFT.

FIGURE 2.5B

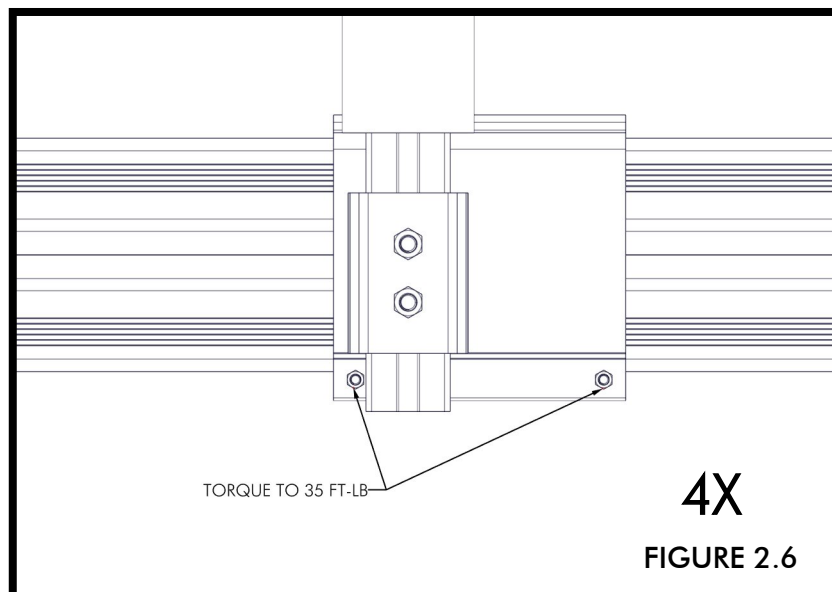
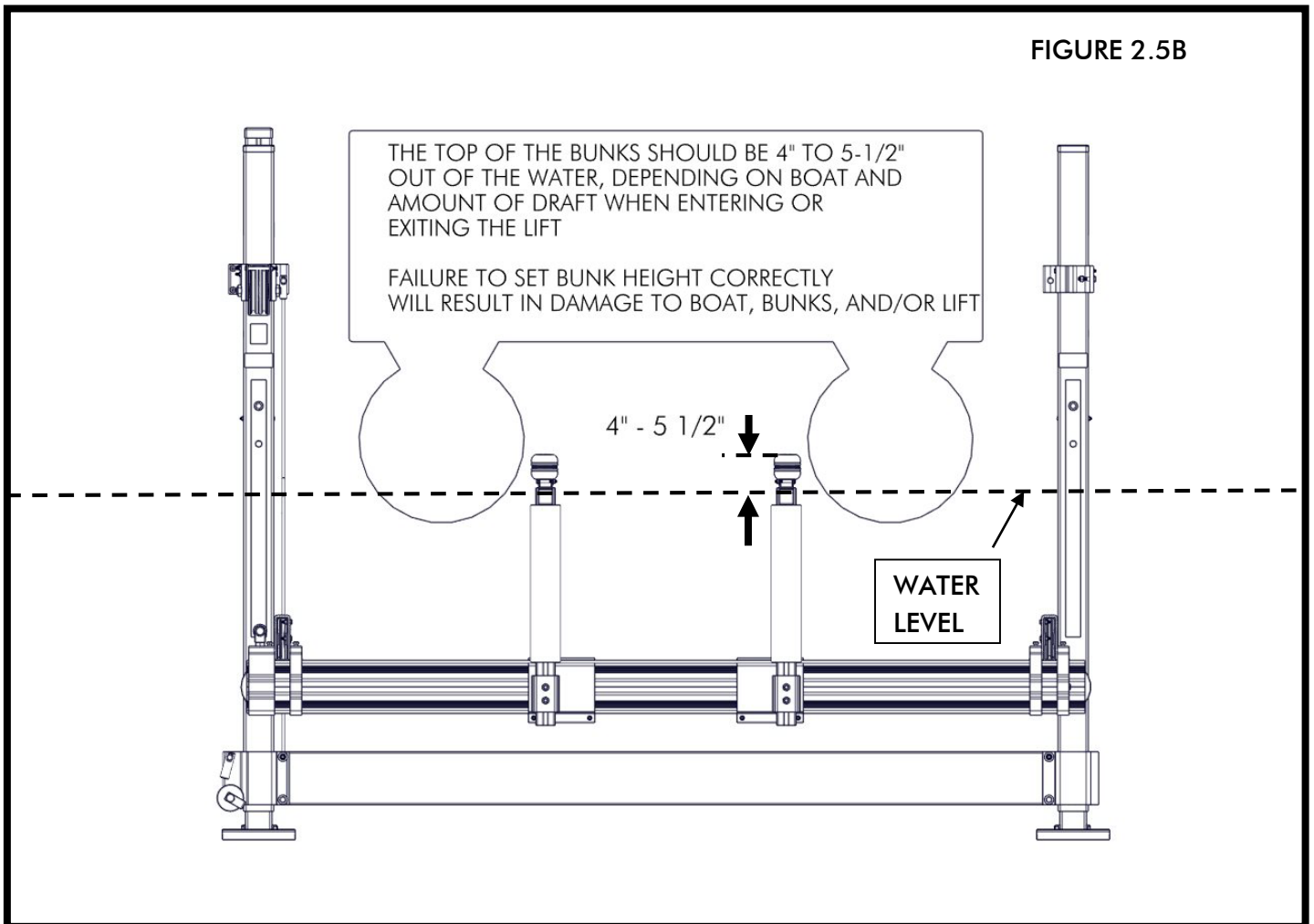

NOTES

NOTES

