

FLOE PERFECT PARK ADJUSTABLE GUIDE-INS PONTOON & DECK BOATS ASSEMBLY INSTRUCTIONS

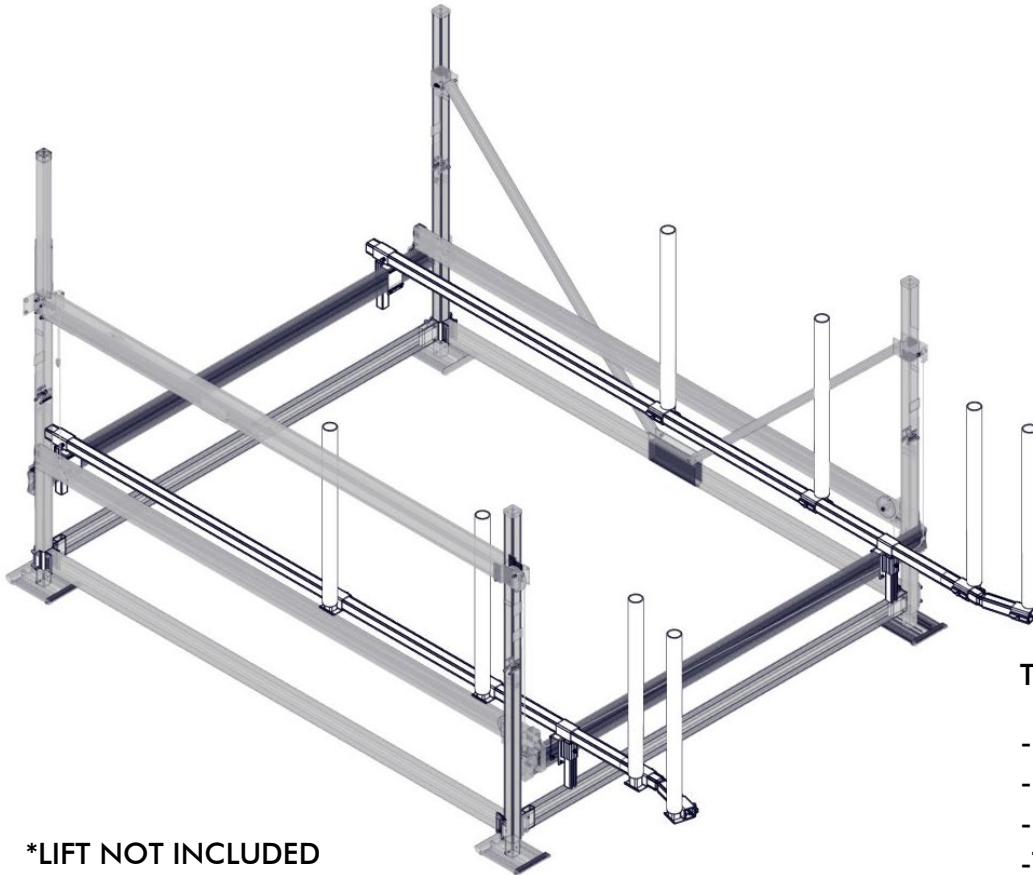

KIT P/N 511-02300-00, 511-02304-00, 511-02306-00, 511-02316-00

ADD ON KIT P/N 511-02308-00



*LIFT NOT INCLUDED

TOOLS REQUIRED

- (2) 9/16" SOCKETS/WRENCHES
- (2) 3/4" SOCKETS/WRENCHES
- (1) 15/16" SOCKET
- TAPE MEASURE
- TORQUE WRENCH

WARNING!!!

IT IS THE INSTALLER'S RESPONSIBILITY TO ENSURE THAT THE GUIDE-IN SYSTEM IS PROPERLY SET UP SUCH THAT NO PART OF THE GUIDE-INS CAN COME IN CONTACT WITH ANY PART OF THE LIFT, MOTOR, CANOPY RAILS, CANOPY HOOPS, OR CANOPY FABRIC WHILE THE LIFT IS IN OPERATION. FAILURE TO COMPLY WITH THIS WARNING MAY RESULT IN SEVERE DAMAGE TO THE LIFT AND/OR ACCESSORIES.

BILL OF MATERIALS

P/N 511-02300-00 GI, PERF. PARK ADJ. VSD 5000 PONT.

P/N 001-02302-00		HDWR, PERF. PARK ADJ. G.I. 3600-5K PON.	
<u>NUMBER</u>	<u>PART NUMBER</u>	<u>QTY.</u>	<u>DESCRIPTION</u>
2A	001-70115-00	8	HHCS, 3/8-16 x 3" 18-8 ss
2B	001-70203-00	8	HHCS, 1/2-13 x 3/4" 18-8 ss
2C	001-70205-00	12	HHCS, 1/2-13 x 1" SS 18-8 ss
2D	001-71022-00	8	FLAT WASHER, 1/2" USS ss 18-8
2E	001-76349-00	8	NUT, 3/8-16 ALUM
2F	001-76350-00	16	NUT, 1/2-13 ALUM

P/N 211-02301-00		BEAMS, PERF. PARK ADJ. G.I. – 192"	
<u>NUMBER</u>	<u>PART NUMBER</u>	<u>QTY.</u>	<u>DESCRIPTION</u>
1	002-00221-00	2	BEAM, PERF. PARK ADJ. G.I. - 192"

P/N 211-02302-00		CLAMPS & VERTICALS, PERF. PARK ADJ. G.I. 5K PON.	
<u>NUMBER</u>	<u>PART NUMBER</u>	<u>QTY.</u>	<u>DESCRIPTION</u>
2	001-02302-00	1	HDWR, PERF. PARK ADJ. G.I. 3600-5K PON.
3	002-00210-00	2	TUBE, PERF. PARK ADJ. G.I. ENTRANCE
4	002-00226-00	2	TUBE, PERF. PARK ADJ. G.I. – 12"
5	111-00163-00	4	WELDMENT, TUBE POCKET
6	111-00472-00	4	WELD'T, PERF. PARK ADJ. G.I. SUPPORT 3.6-5K
7	111-00473-00	8	WELD'T, PERF. PARK ADJ. G.I. VERTICAL -16"

P/N 511-02915-00		ASS'Y, 48" PVC TUBES (2)	
<u>NUMBER</u>	<u>PART NUMBER</u>	<u>QTY.</u>	<u>DESCRIPTION</u>
8	511-02855-00	4 (PAIRS)	VERT GUIDE-IN COVERS (GREY) – 40"
9	958-00707-00	8	PVC PIPE, VERTICAL GUIDE – 47-7/8"

EXPLODED VIEW

P/N 511-02300-00

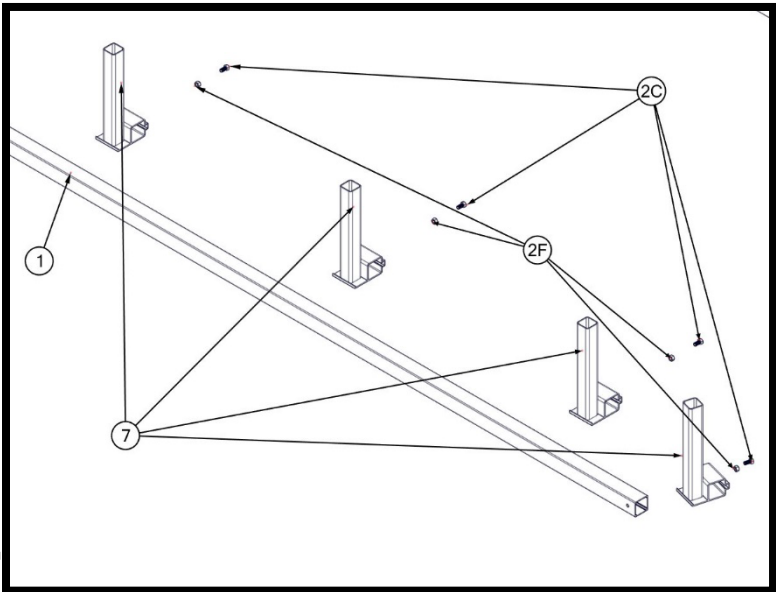
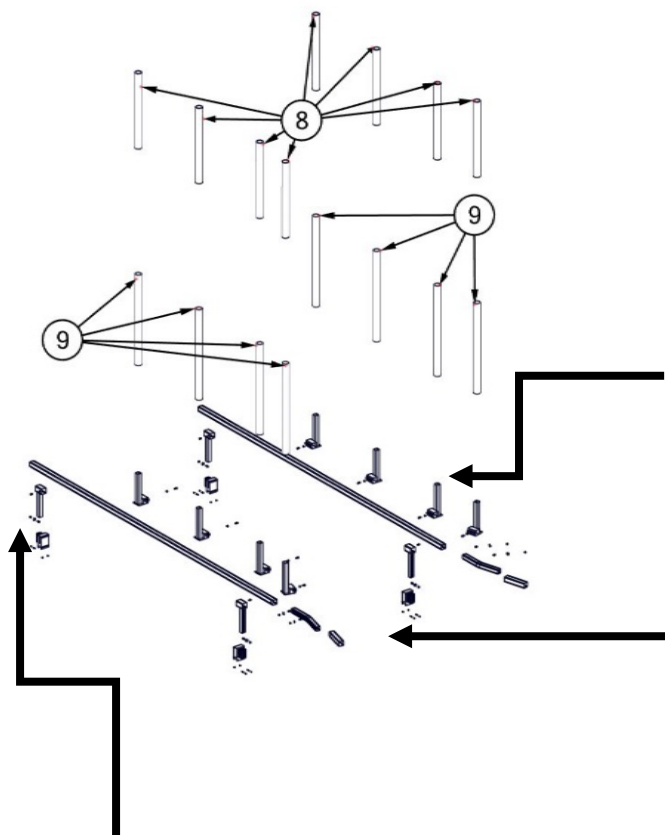

2X

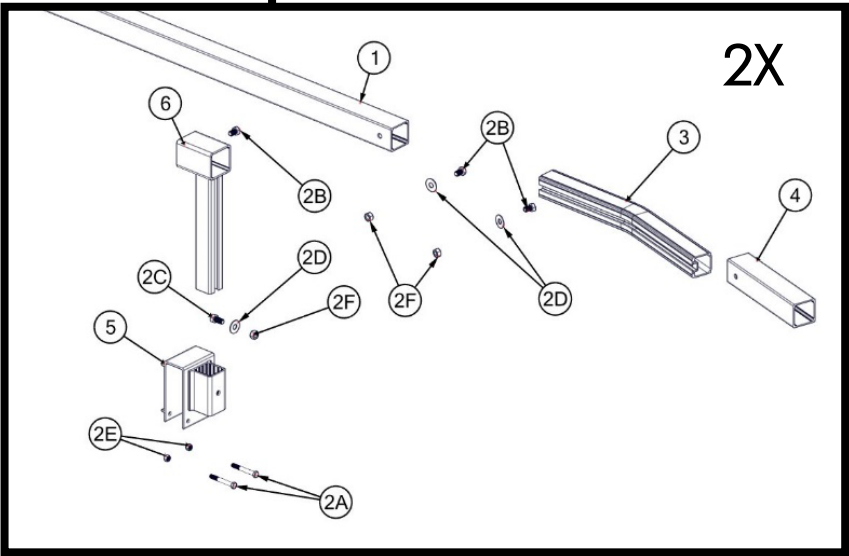
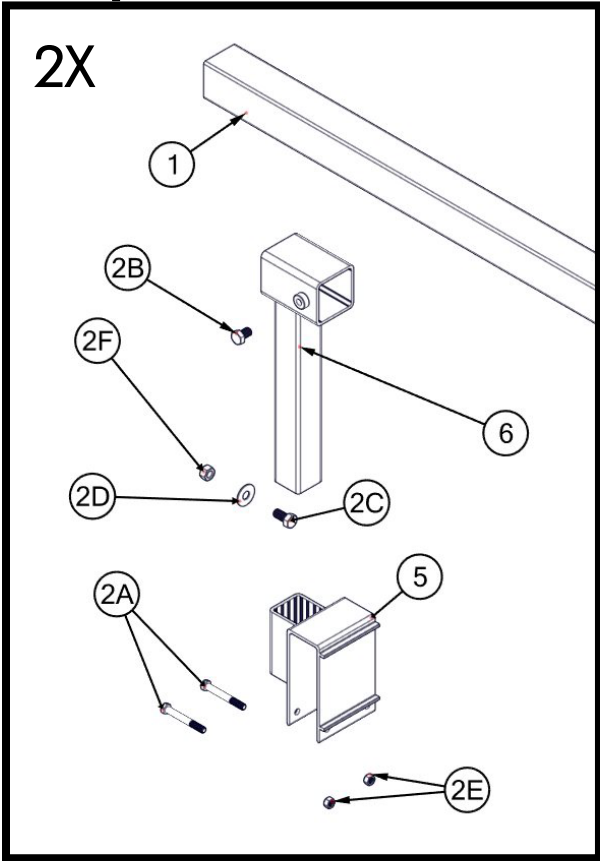

BILL OF MATERIALS

P/N 511-02304-00 GI, PERF. PARK ADJ. V2000-VSD5K (PONT/DECK BOATS)

P/N 001-02302-00	HDWR, PERF. PARK ADJ. G.I. 2000-5K PON.		
<u>NUMBER</u>	<u>PART NUMBER</u>	<u>QTY.</u>	<u>DESCRIPTION</u>
1A	001-70115-00	8	HHCS, 3/8-16 x 3" 18-8 ss
1B	001-70203-00	8	HHCS, 1/2-13 x 3/4" 18-8 ss
1C	001-70205-00	12	HHCS, 1/2-13 x 1" SS 18-8 ss
1D	001-71022-00	8	FLAT WASHER, 1/2" USS ss 18-8
1E	001-76349-00	8	NUT, 3/8-16 ALUM
1F	001-76350-00	16	NUT, 1/2-13 ALUM

P/N 211-02302-00	CLAMPS & VERTICALS, PERF. PARK ADJ. G.I. 2-5K PON.		
<u>NUMBER</u>	<u>PART NUMBER</u>	<u>QTY.</u>	<u>DESCRIPTION</u>
1	001-02302-00	1	HDWR, PERF. PARK ADJ. G.I. 2000-5K PON.
2	002-00210-00	2	TUBE, PERF. PARK ADJ. G.I. ENTRANCE
3	002-00226-00	2	TUBE, PERF. PARK ADJ. G.I. – 12"
4	111-00163-00	4	WELDMENT, TUBE POCKET
5	111-00472-00	4	WELD'T, PERF. PARK ADJ. G.I. SUPPORT 2-5K
6	111-00473-00	8	WELD'T, PERF. PARK ADJ. G.I. VERTICAL -16"

P/N 511-02915-00	ASS'Y, 48" PVC TUBES (2)		
<u>NUMBER</u>	<u>PART NUMBER</u>	<u>QTY.</u>	<u>DESCRIPTION</u>
7	511-02855-00	4 (PAIRS)	VERT GUIDE-IN COVERS (GREY) – 40"
8	958-00707-00	8	PVC PIPE, VERTICAL GUIDE – 47-7/8"

P/N 211-02305-00	BEAMS, PERF. PARK ADJ. GUIDE-INS – 156"		
<u>NUMBER</u>	<u>PART NUMBER</u>	<u>QTY.</u>	<u>DESCRIPTION</u>
9	002-00223-00	2	BEAM, PERF. PARK ADJ. G.I. – 156"

EXPLODED VIEW

P/N 511-02304-00

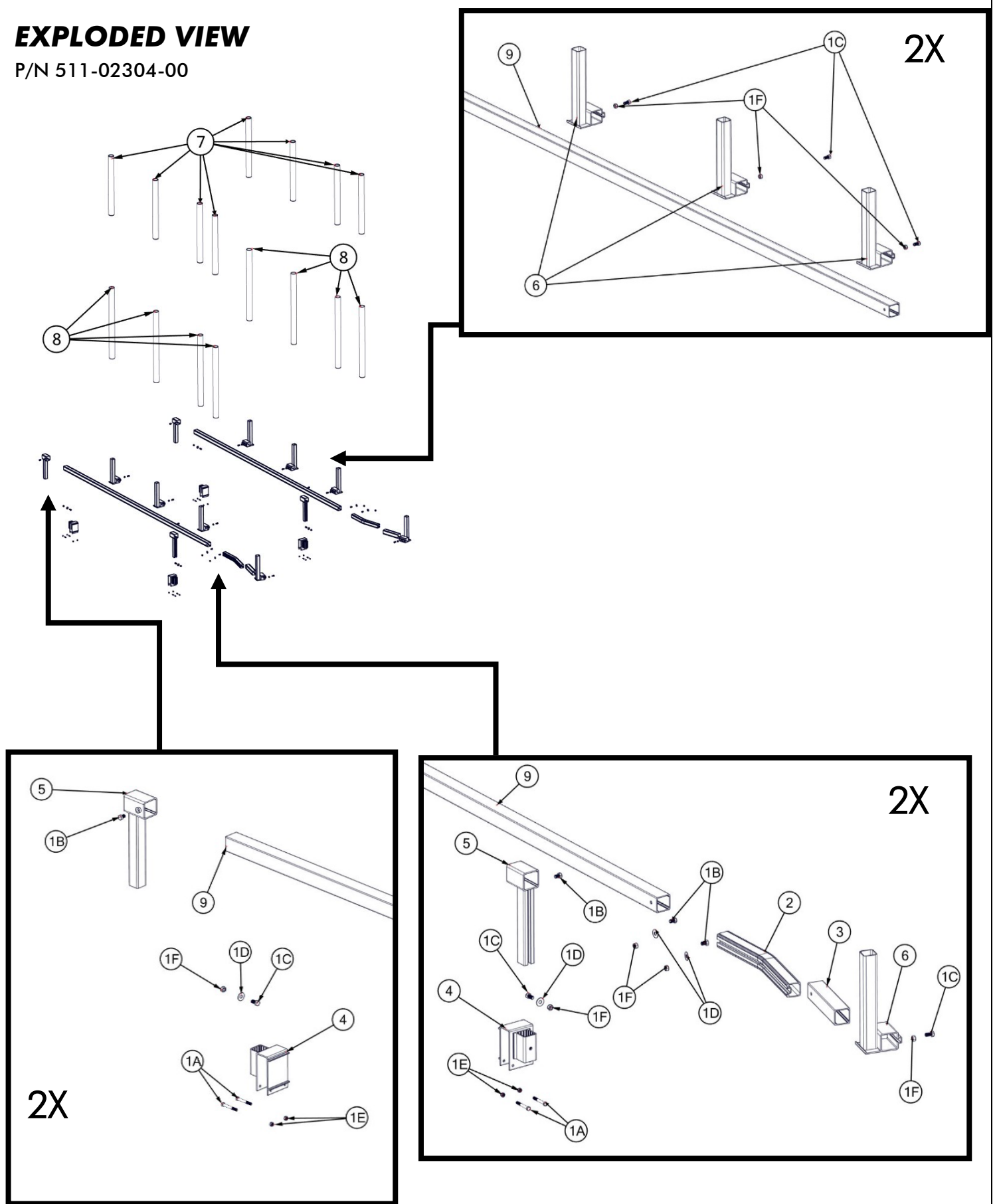

BILL OF MATERIALS

P/N 511-02306-00 GI, PERF. PARK ADJ. VSD6-8K (PONT/DECK BOATS)

P/N 001-02307-00	HDWR, PERF. PARK ADJ. G.I. 6-10K PON.		
<u>NUMBER</u>	<u>PART NUMBER</u>	<u>QTY.</u>	<u>DESCRIPTION</u>
4A	001-70119-00	8	HHCS, 3/8-16 x 4" 18-8 ss
4B	001-70203-00	8	HHCS, 1/2-13 x 3/4" 18-8 ss
4C	001-70205-00	8	HHCS, 1/2-13 x 1" ss 18-8
4D	001-70305-00	4	HHCS, 5/8-11 x 1" 18-8 ss
4E	001-71022-00	4	FLAT WASHER, 1/2" USS ss 18-8
4F	001-71025-00	4	FLAT WASHER, 5/8" SAE 18-8 ss
4G	001-76349-00	8	NUT, 3/8-16 ALUM
4H	001-76350-00	12	NUT, 1/2-13 ALUM
4I	001-76351-00	4	NUT, 5/8-11 ALUM

P/N 511-02915-00	ASS'Y, 48" PVC TUBES (2)		
<u>NUMBER</u>	<u>PART NUMBER</u>	<u>QTY.</u>	<u>DESCRIPTION</u>
1	511-02855-00	4 (PAIRS)	VERT GUIDE-IN COVERS (GREY) – 40"
2	958-00707-00	8	PVC PIPE, VERTICAL GUIDE – 47-7/8"

P/N 211-02305-00	BEAMS, PERF. PARK ADJ. GUIDE-INS – 156"		
<u>NUMBER</u>	<u>PART NUMBER</u>	<u>QTY.</u>	<u>DESCRIPTION</u>
3	002-00223-00	2	BEAM, PERF. PARK ADJ. G.I. – 156"

P/N 211-02307-00	CLAMPS & VERT., PERF. PARK ADJ. G.I. 6-10K PON.		
<u>NUMBER</u>	<u>PART NUMBER</u>	<u>QTY.</u>	<u>DESCRIPTION</u>
4	001-02307-00	1	HDWR, PERF. PARK ADJ. G.I. 6-10K PON.
5	002-00210-00	2	TUBE, PERF. PARK ADJ. G.I. ENTRANCE
6	002-00226-00	2	TUBE, PERF. PARK ADJ. G.I. – 12"
7	002-04285-00	4	CLAMP, BUNK CRADLE (MALE)
8	111-00183-00	4	WELDMENT, BUNK TUBE CLAMP
9	111-00473-00	8	WELD'T, PERF. PARK ADJ. G.I. VERTICAL -16"
10	111-00474-00	4	WELD'T, PERF. PARK ADJ. G.I. SUPPORT 6-8K PON.

EXPLODED VIEW

P/N 511-02306-00

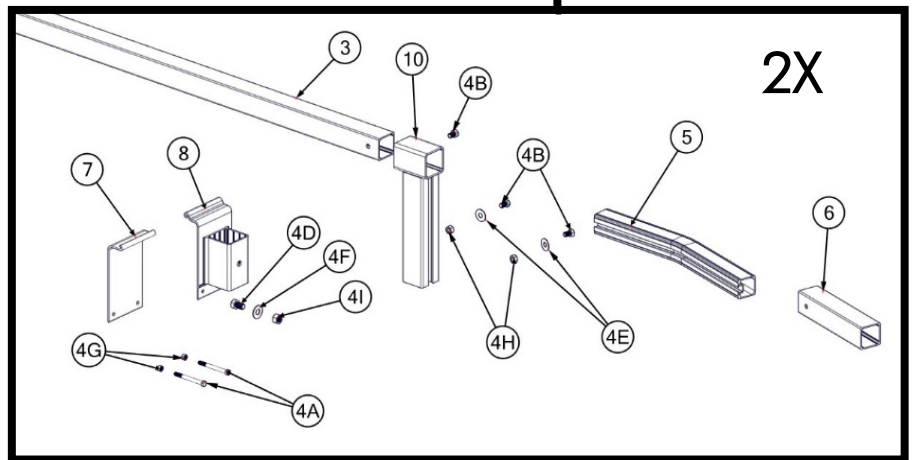
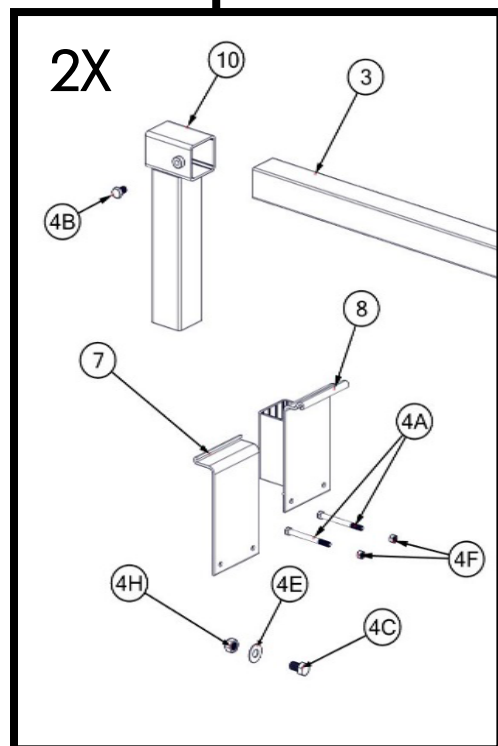
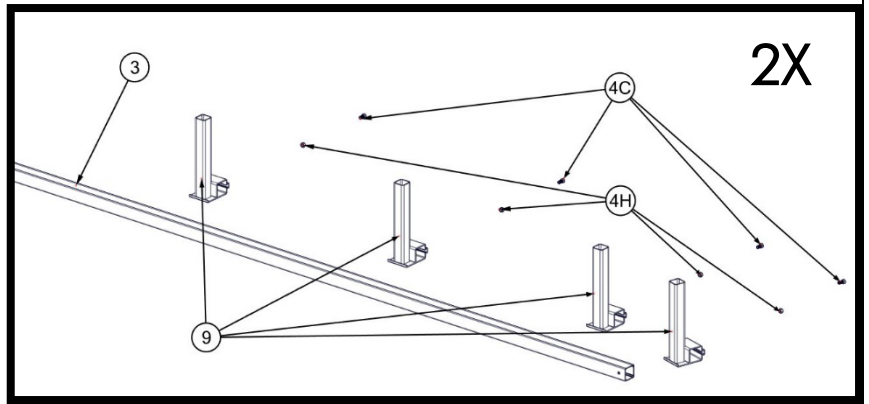
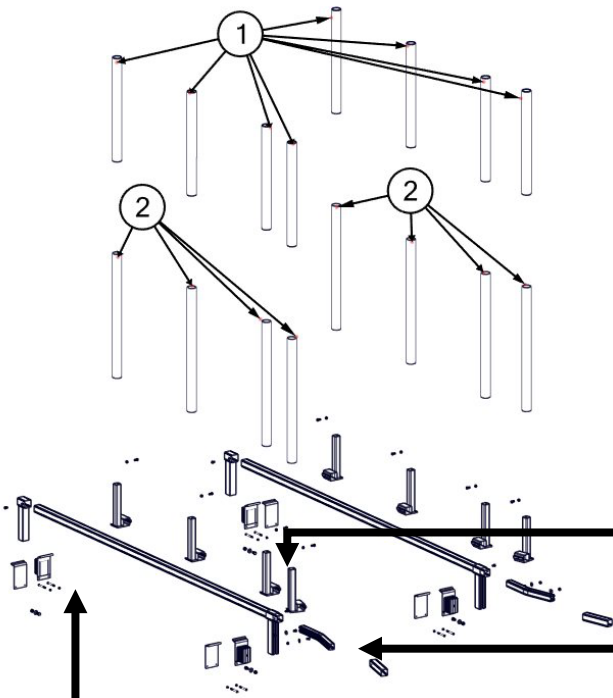

BILL OF MATERIALS

P/N 511-02316-00 GI, PERF. PARK ADJ. VSD 10000 (PONT/DECK)

P/N 001-02307-00	HDWR, PERF. PARK ADJ. G.I. 6-10K PON.		
<u>NUMBER</u>	<u>PART NUMBER</u>	<u>QTY.</u>	<u>DESCRIPTION</u>
4A	001-70119-00	8	HHCS, 3/8-16 x 4" 18-8 ss
4B	001-70203-00	8	HHCS, 1/2-13 x 3/4" 18-8 ss
4C	001-70205-00	8	HHCS, 1/2-13 x 1" ss 18-8
4D	001-70305-00	4	HHCS, 5/8-11 x 1" SS 18-8 ss
4E	001-71022-00	4	FLAT WASHER, 1/2" USS ss 18-8
4F	001-71025-00	4	FLAT WASHER, 5/8" SAE 18-8 ss
4G	001-76349-00	8	NUT, 3/8-16 ALUM
4H	001-76350-00	12	NUT, 1/2-13 ALUM
4I	001-76351-00	4	NUT, 5/8-11 ALUM

P/N 211-02301-00	BEAMS, PERF. PARK ADJ. G.I. – 192"		
<u>NUMBER</u>	<u>PART NUMBER</u>	<u>QTY.</u>	<u>DESCRIPTION</u>
1	002-00221-00	2	BEAM, PERF. PARK ADJ. G.I. – 192"

P/N 511-02915-00	ASS'Y, 48" PVC TUBES (2)		
<u>NUMBER</u>	<u>PART NUMBER</u>	<u>QTY.</u>	<u>DESCRIPTION</u>
2	511-02855-00	4 (PAIRS)	VERT GUIDE-IN COVERS (GREY) – 40"
3	958-00707-00	8	PVC PIPE, VERTICAL GUIDE – 47-7/8"

P/N 211-02307-00	CLAMPS & VERT., PERF. PARK ADJ. G.I. 6-10K PON.		
<u>NUMBER</u>	<u>PART NUMBER</u>	<u>QTY.</u>	<u>DESCRIPTION</u>
4	001-02307-00	1	HDWR, PERF. PARK ADJ. G.I. 6-10K PON.
5	002-00210-00	2	TUBE, PERF. PARK ADJ. G.I. ENTRANCE
6	002-00226-00	2	TUBE, PERF. PARK ADJ. G.I. – 12"
7	002-04285-00	4	CLAMP, BUNK CRADLE (MALE)
8	111-00183-00	4	WELDMENT, BUNK TUBE CLAMP
9	111-00473-00	8	WELD'T, PERF. PARK ADJ. G.I. VERTICAL -16"
10	111-00474-00	4	WELD'T, PERF. PARK ADJ. G.I. SUPPORT 6-8K PON.

EXPLODED VIEW

P/N 511-02316-00

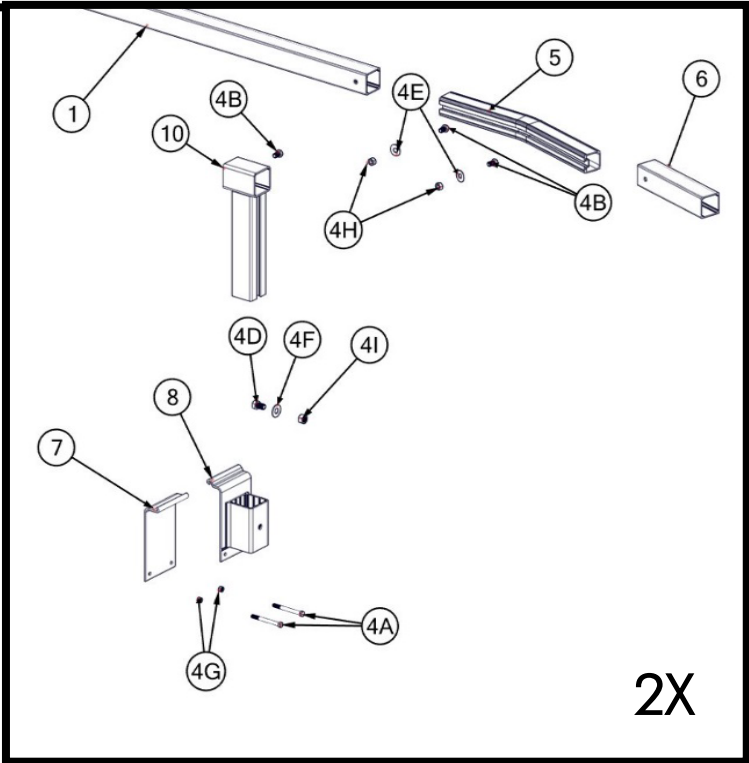
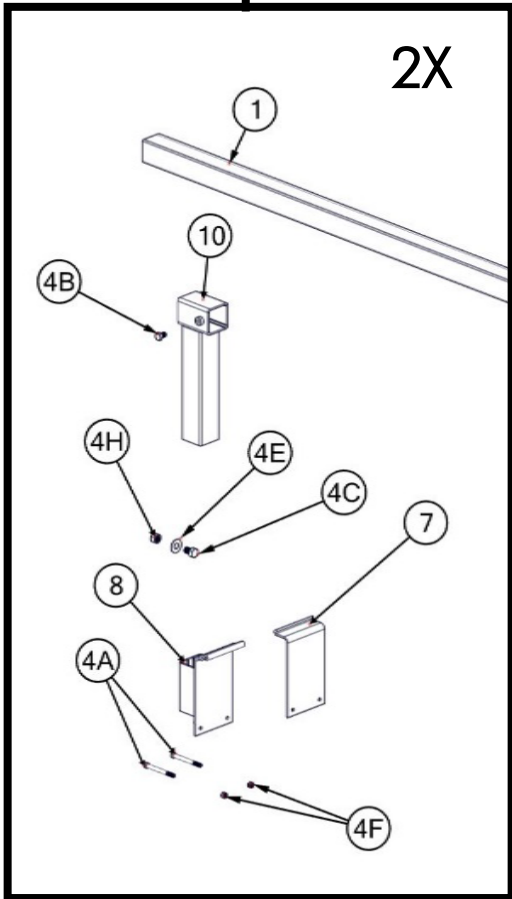
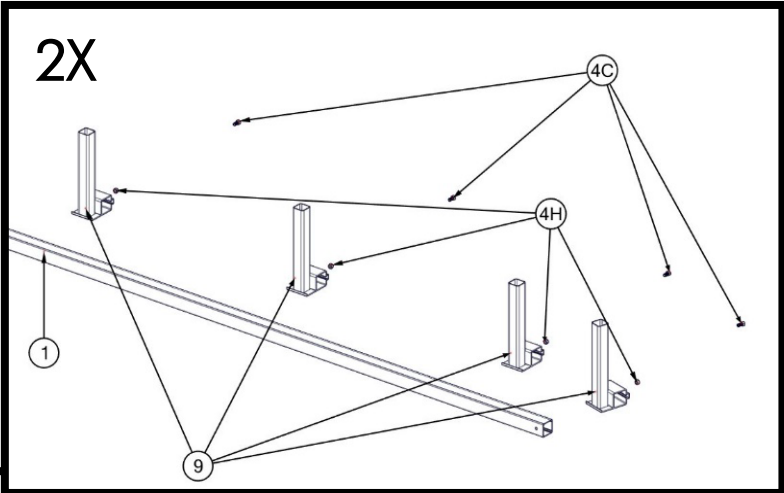
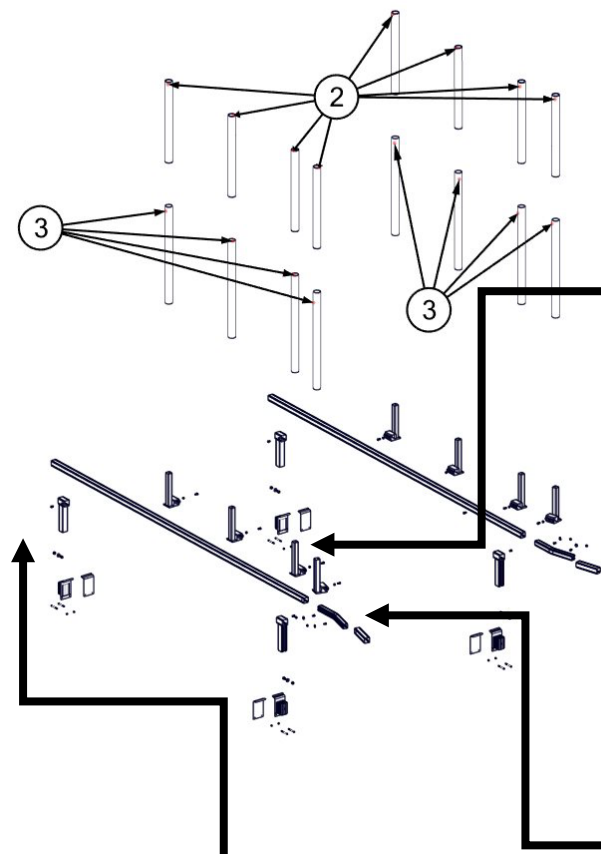

BILL OF MATERIALS

P/N 511-02308-00 GI, PERF. PARK ADJ. ADD-ON KIT PONTOON

P/N 001-02317-00		HARDWARE, PERF. PARK ADJ. G.I. ADD-ON	
NUMBER	PART NUMBER	QTY.	DESCRIPTION
1A	001-70205-00	2	HHCS, 1/2-13 x 1" ss 18-8
1B	001-76350-00	2	NUT, 1/2-13 ALUM

P/N 211-02318-00		PERF PARK ADJ. ADD-ON KIT V3600-VSD5K (V-HULL)	
NUMBER	PART NUMBER	QTY.	DESCRIPTION
1	001-02317-00	1	HARDWARE, PERF. PARK ADJ. G.I. ADD-ON
2	111-00473-00	2	WELD'T, PERF. PARK ADJ. G.I. VERTICAL – 16"

P/N 511-02932-00		ASS'Y, 48" PVC TUBES (2)	
NUMBER	PART NUMBER	QTY.	DESCRIPTION
3	511-02855-00	1 (PAIR)	VERT GUIDE-IN COVERS (GREY) – 40"
4	958-00707-00	2	PVC PIPE, VERTICAL GUIDE – 47 – 7/8"

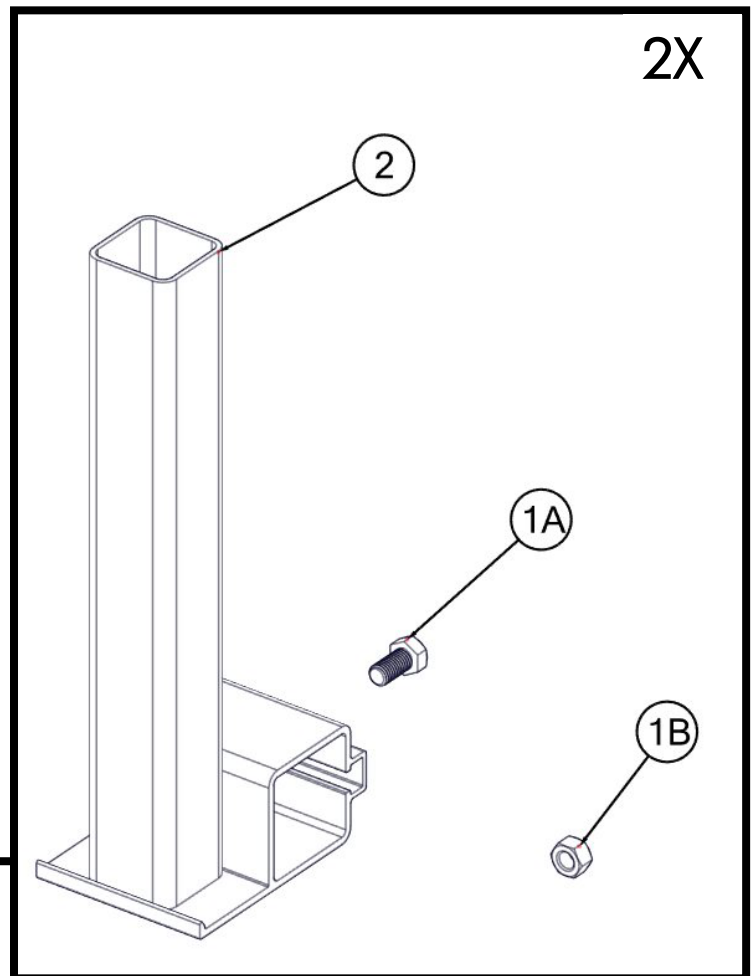
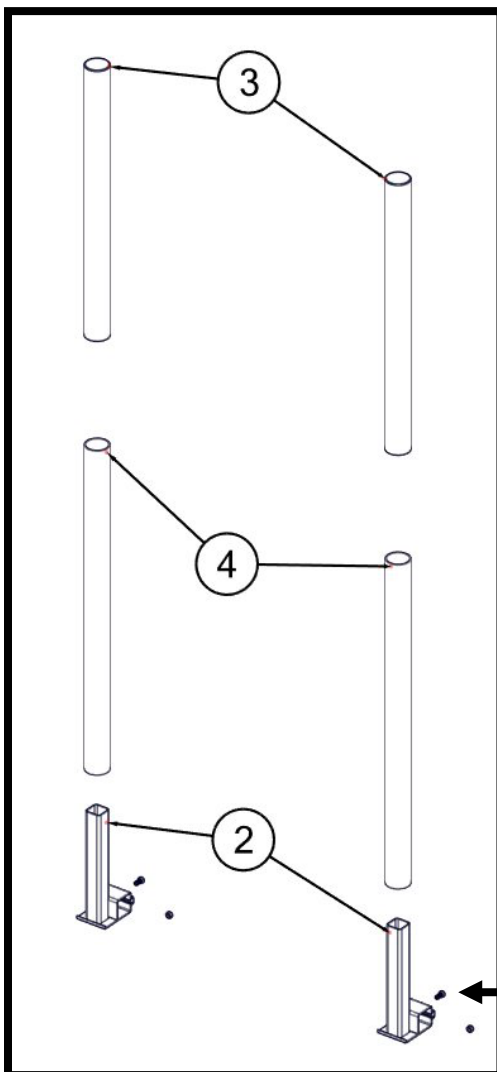

INSTALLATION

PONTOON GUIDE-IN SETUP

P/N 511-02300-00, 511-02304-00, 511-02306-00, 511-02316-00,

STEP 1

-CRADLE CLAMP INSTALLATION

SLIDE (4) CRADLE CLAMPS ONTO FRONT/REAR CRADLE BEAMS (FIGURE 1.1 FOR 1-PIECE CLAMPS, FIGURE 1.2 FOR 2-PIECE CLAMPS).

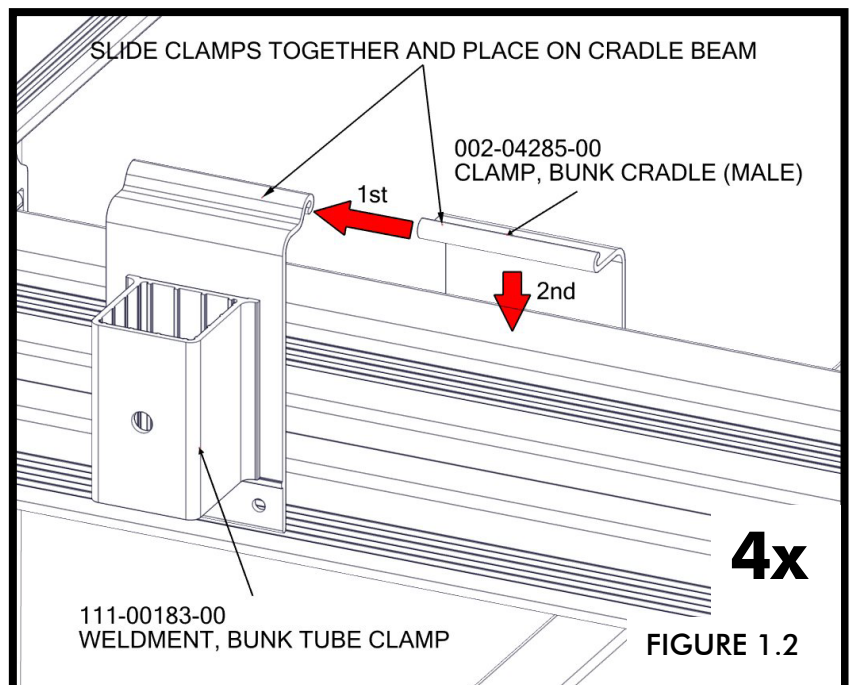
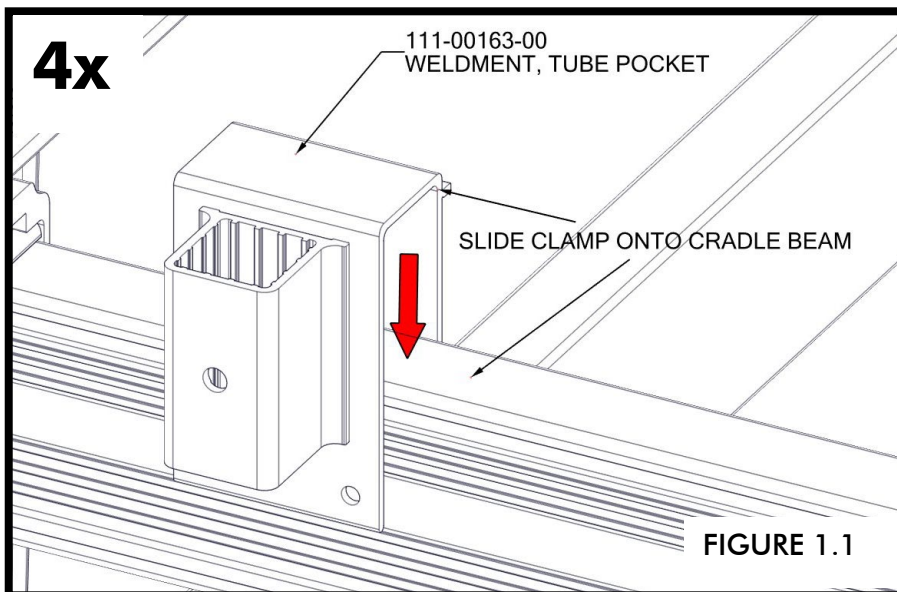

INSERT (2) 3/8-16 x 3" OR (2) 3/8-16 x 4" BOLTS INTO EACH CLAMP (FIGURE 1.3 FOR 1-PIECE CLAMPS, FIGURE 1.4 FOR 2-PIECE CLAMPS). PLACE 3/8-16 NUTS ONTO EACH BOLT. POSITION WILL BE DETERMINED IN THE NEXT STEP. **DO NOT TORQUE UNTIL FINAL POSITION IS SET.**

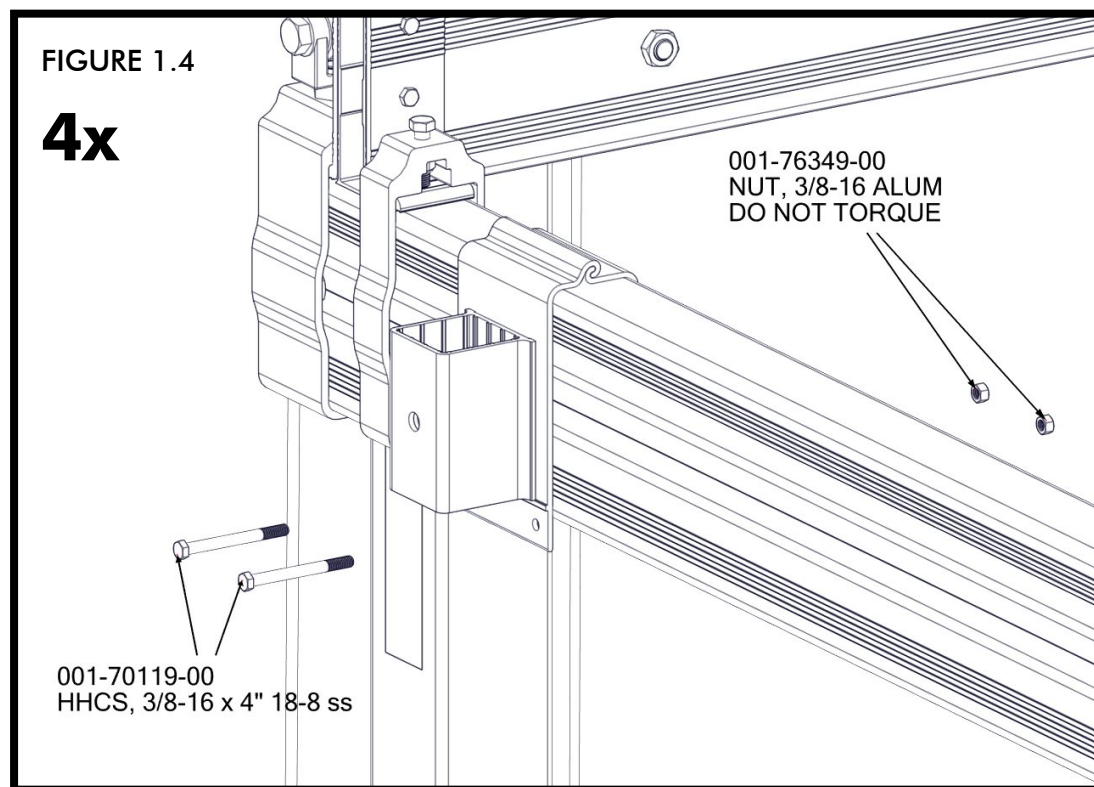
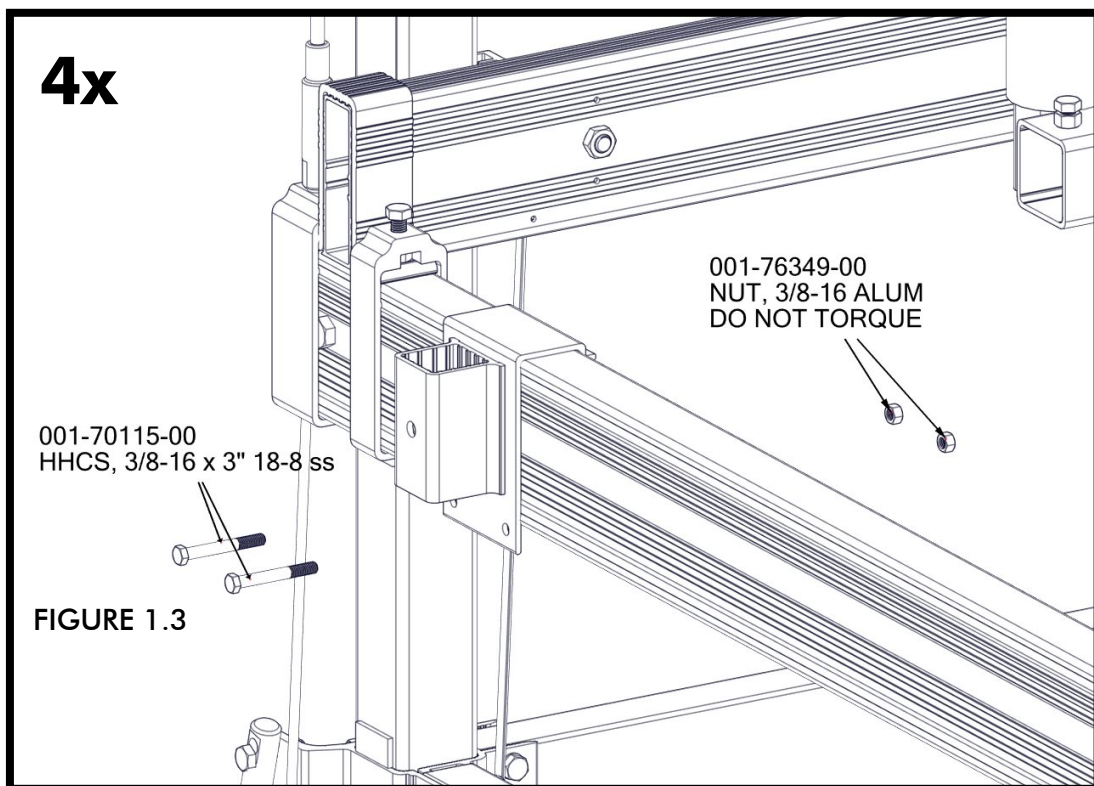

STEP 2

-BEAM ASSEMBLY

IMPORTANT: HOLE IN GUIDE-IN BEAM (BOTH 156" & 192" BEAMS) MUST BE ON ENTRANCE SIDE OF LIFT AND ON SIDE OF BEAM FACING OUTSIDE OF LIFT.

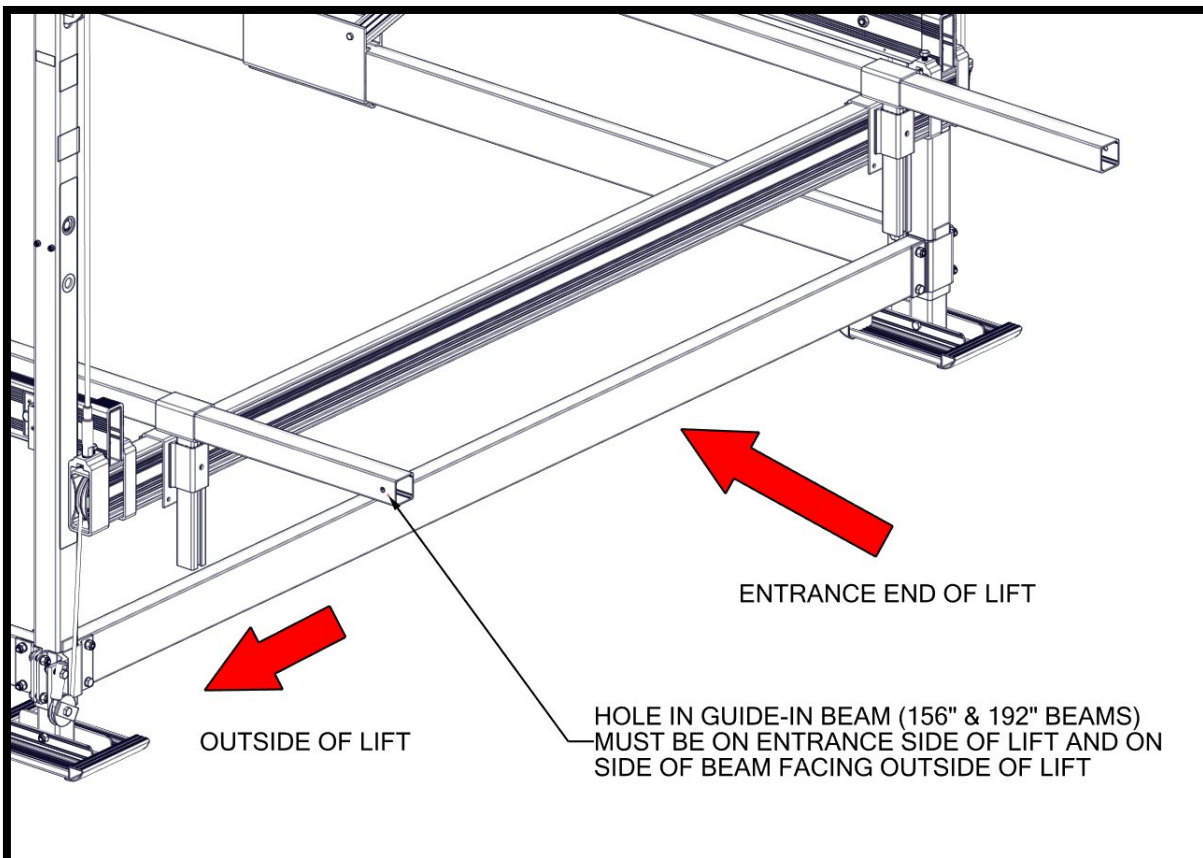
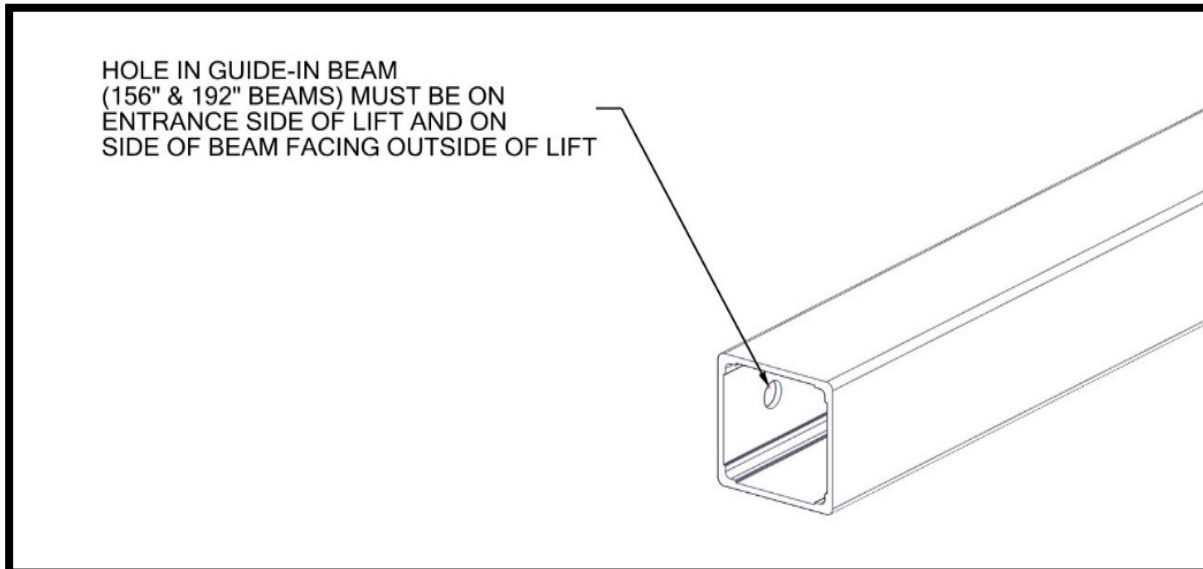

SLIDE (2) VERTICAL GUIDES ONTO EACH GUIDE-IN BEAM. THESE GUIDES WILL BE PLACED BETWEEN THE SUPPORTS. NOTE THAT VERTICAL TUBE ON GUIDE IS PLACED ON THE **OUTSIDE** OF THE GUIDE-IN BEAM. PLACE THE FIRST VERTICAL GUIDE *50.5" FROM END OF GUIDE-IN BEAM (ENTRANCE SIDE) AND SECOND VERTICAL GUIDE *48" FROM FIRST VERTICAL GUIDE (FIGURE 2.1).

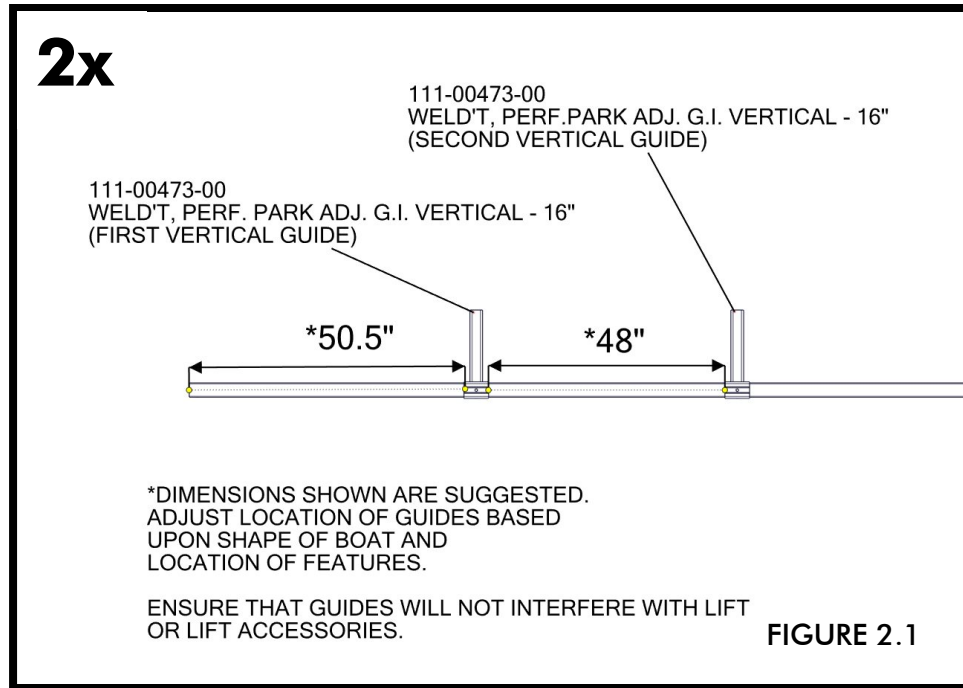

*DIMENSIONS ARE SUGGESTED. ADJUST LOCATION OF GUIDES BASED UPON SHAPE OF BOAT AND LOCATION OF BOAT FEATURES. ENSURE THAT GUIDES WILL NOT INTERFERE WITH LIFT OR LIFT ACCESSORIES.

ATTACH USING $\frac{1}{2}$ -13 x 1" BOLTS AND $\frac{1}{2}$ " NUTS (FIGURE 2.2). **DO NOT TORQUE UNTIL FINAL POSITION IS SET.**

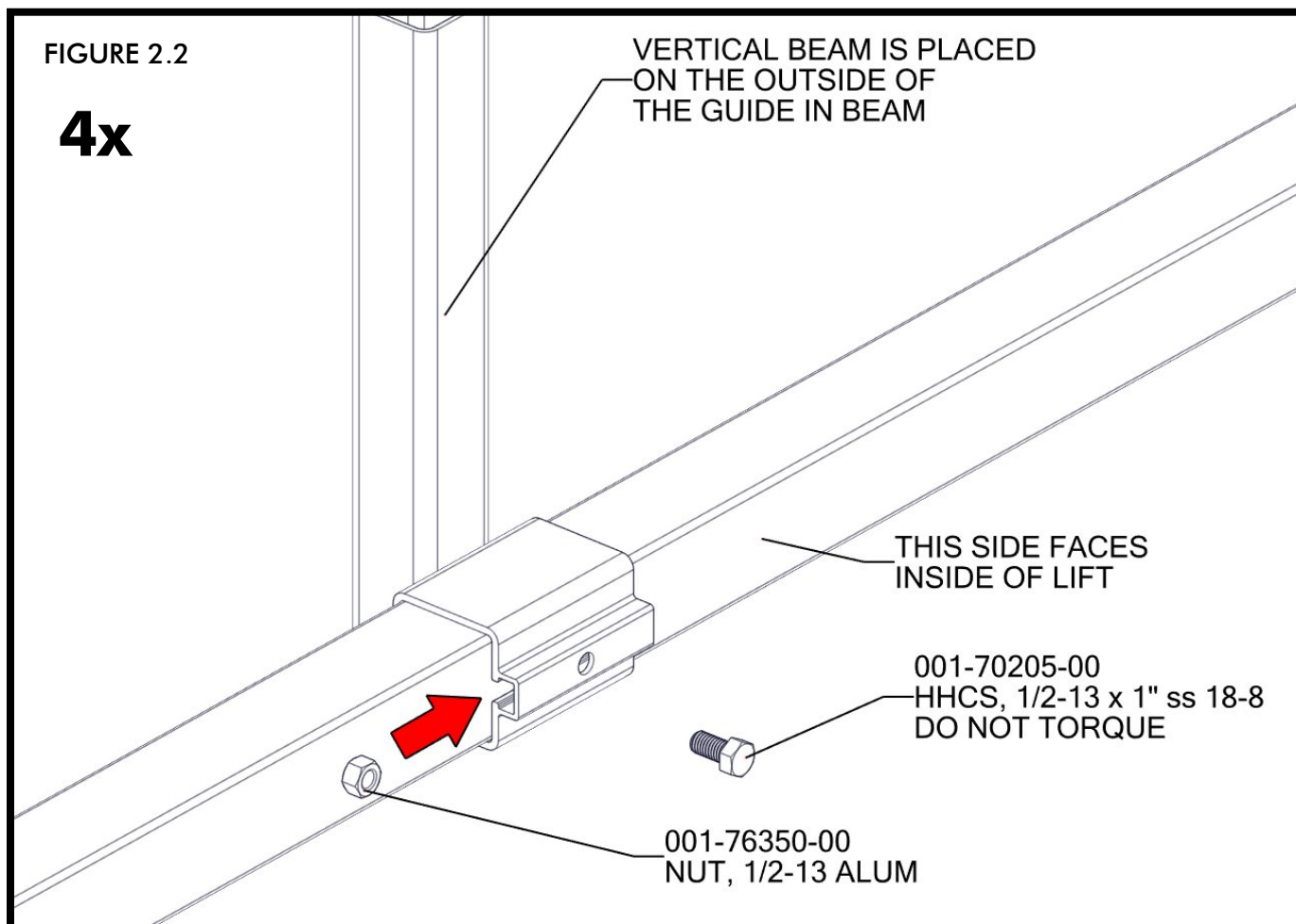

SLIDE SUPPORTS ONTO GUIDE-IN BEAM ON BOTH ENDS OF BEAM AND ATTACH WITH $\frac{1}{2}$ -13 x $\frac{3}{4}$ " BOLT. **DO NOT TORQUE** (FIGURE 2.3). ASSEMBLE BOLTS, WASHERS, AND NUTS AS SHOWN (REFER TO FIGURE 2.4 FOR 1-PIECE CLAMPS USING $\frac{1}{2}$ -13 x 1" BOLTS, $\frac{1}{2}$ " WASHERS, AND $\frac{1}{2}$ " NUTS. REFER TO FIGURE 2.5 FOR 2-PIECE CLAMPS USING $\frac{5}{8}$ -11 x 1" BOLTS, $\frac{5}{8}$ " WASHERS, AND $\frac{5}{8}$ " NUTS.).

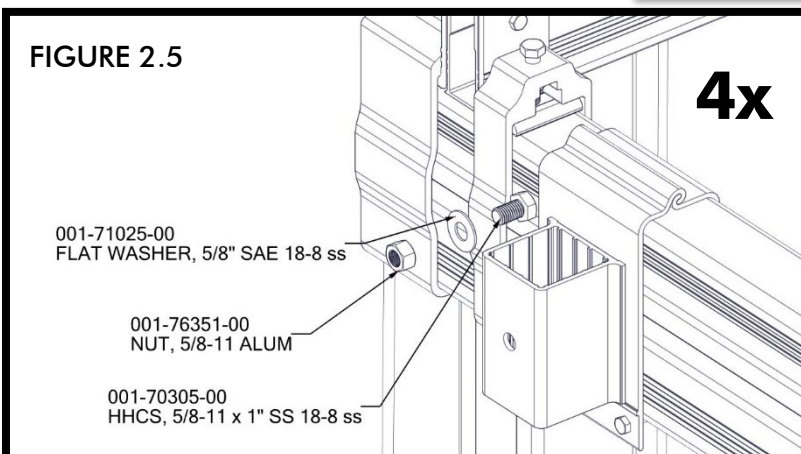
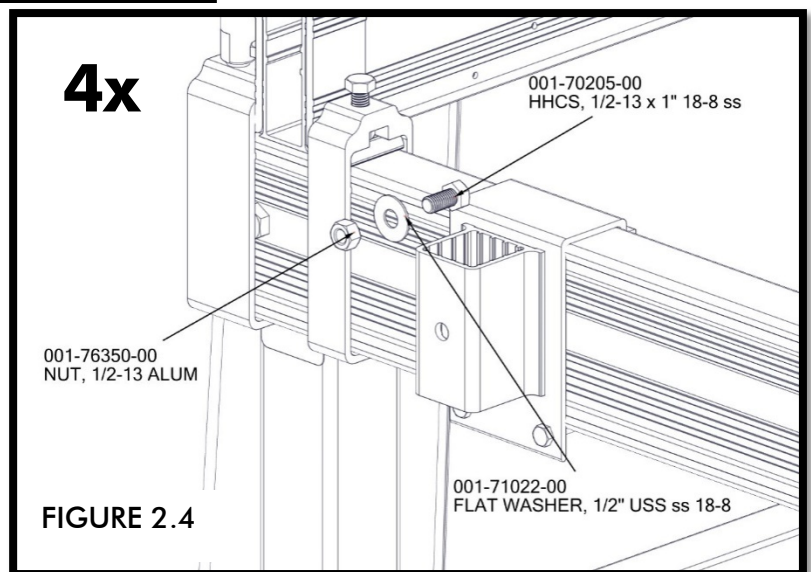
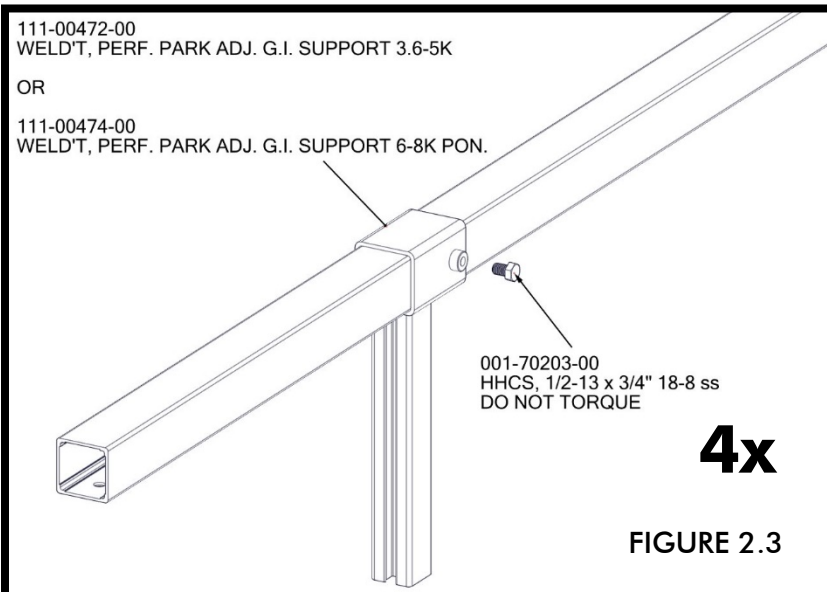

SEE FIGURE 2.6 FOR ALIGNMENT OF FASTENERS IN CLAMP. SLIDE SUPPORTS INTO CLAMP POCKET (FIGURE 2.7). SUGGESTED HEIGHT MEASURED FROM TOP OF CLAMP POCKETS IS *0.75". TORQUE 1/2" NUT OR 15/16" NUT TO 70 FT-LBS (FIGURE 2.8).

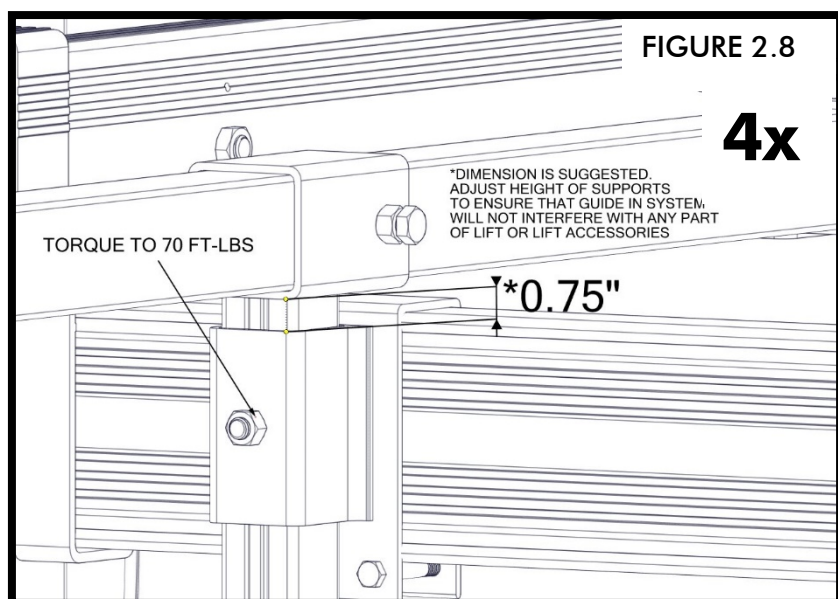
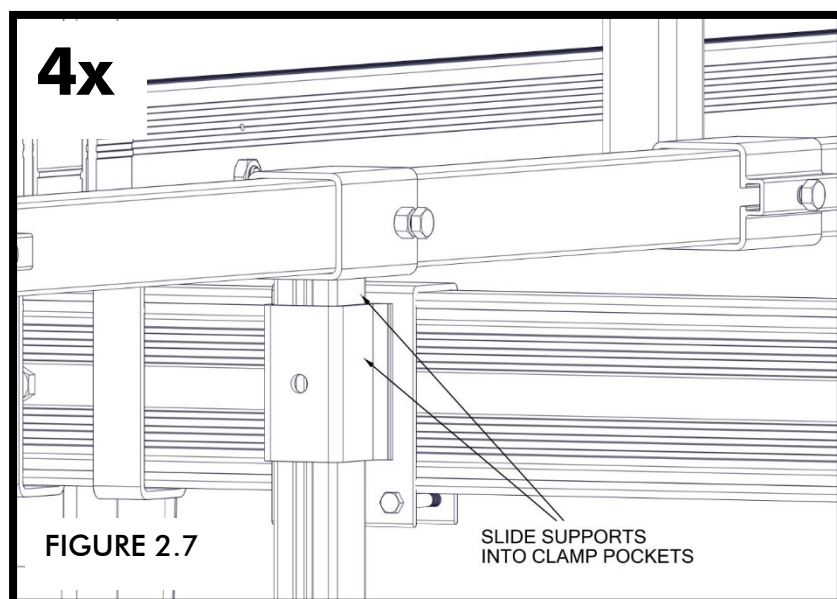
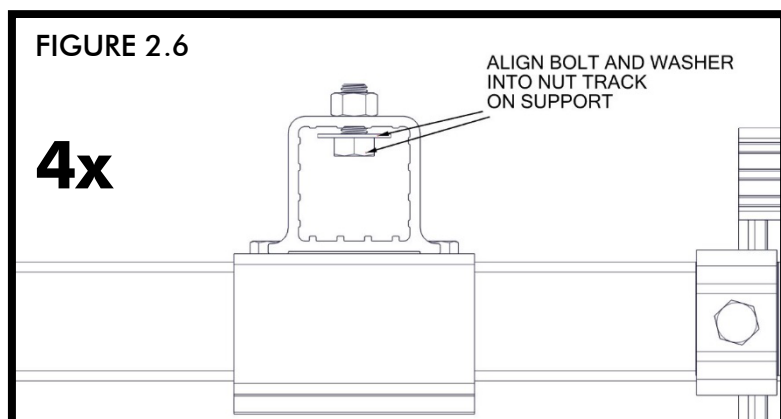

*DIMENSION IS SUGGESTED. ADJUST HEIGHT OF SUPPORTS TO ENSURE THAT GUIDE-IN SYSTEM WILL NOT INTERFERE WITH ANY PART OF LIFT OR LIFT ACCESSORIES.

ALSO ENSURE THAT THERE IS A SUFFICIENT LENGTH OF THE GUIDE-IN BEAM ENGAGED THROUGH THE SUPPORT ON THE OPPOSITE CRADLE BEAM.

PLACE END OF BEAM *26.5" FROM OUTER EDGE OF SUPPORT ON FRONT/ENTRANCE SIDE OF LIFT.
TORQUE BOLTS ON ALL SUPPORTS TO 20 FT-LBS (FIGURE 2.9).

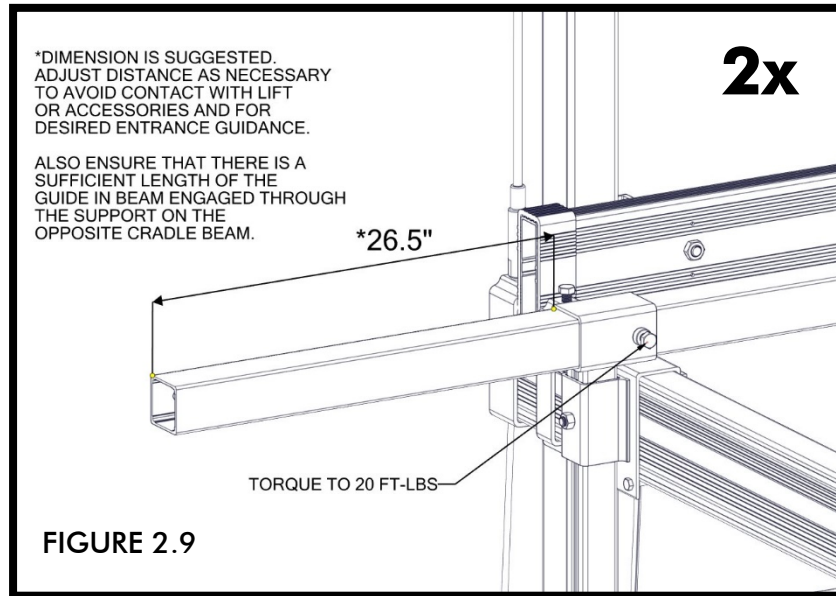

*DIMENSION IS SUGGESTED. ADJUST DISTANCE AS NECESSARY TO AVOID CONTACT WITH LIFT OR ACCESSORIES AND FOR DESIRED ENTRANCE GUIDANCE. ALSO ENSURE THAT THERE IS A SUFFICIENT LENGTH OF THE GUIDE-IN BEAM ENGAGED THROUGH THE SUPPORT ON THE OPPOSITE CRADLE BEAM.

SLIDE NEXT VERTICAL GUIDE ASSEMBLY ONTO GUIDE-IN BEAMS, PLACE *2.5" FROM END OF GUIDE-IN BEAM, AND ATTACH USING (1) 1/2-13 x 3/4" BOLT AND (1) 1/2" NUT (FIGURE 2.10). **DO NOT TORQUE UNTIL FINAL POSITION IS SET.**

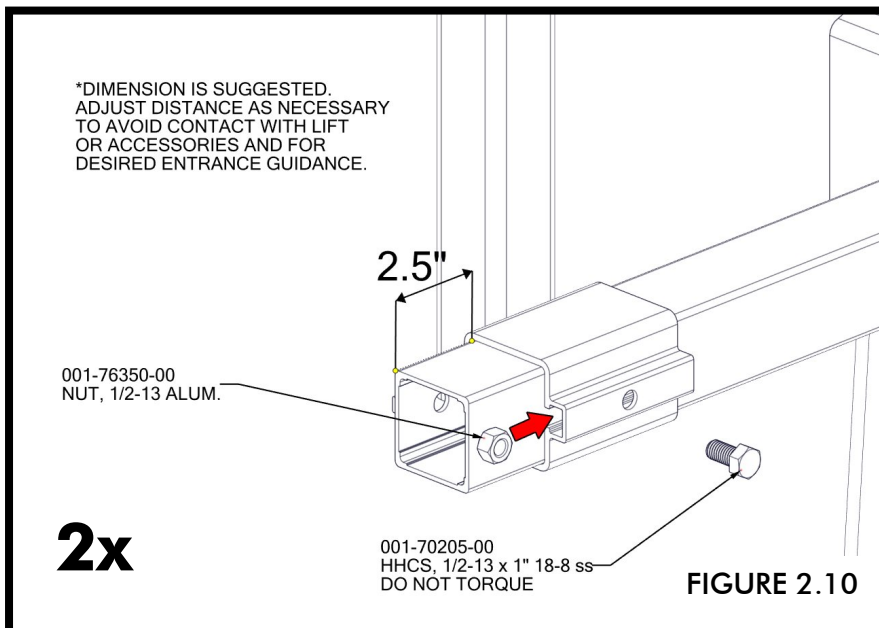

*DIMENSION IS SUGGESTED. ADJUST DISTANCE AS NECESSARY TO AVOID CONTACT WITH LIFT OR ACCESSORIES AND FOR DESIRED ENTRANCE GUIDANCE.

ATTACH ENTRANCE TUBES TO EACH GUIDE-IN BEAM USING (1) 1/2-13 x 3/4" BOLT, (1) 1/2" WASHER, AND (1) 1/2" NUT (FIGURE 2.11). SLIDE TUBES INTO BOTH GUIDE-IN BEAMS AND **ENSURE THAT THERE IS A MINIMUM OF 6" OF OVERLAP** (FIGURE 2.12& 2.13).

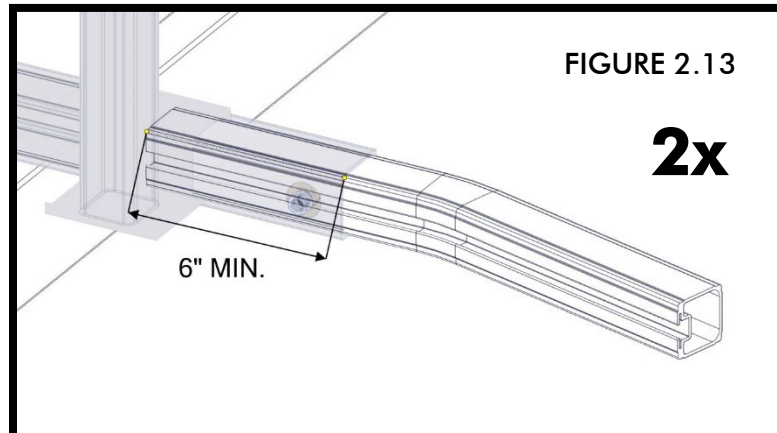
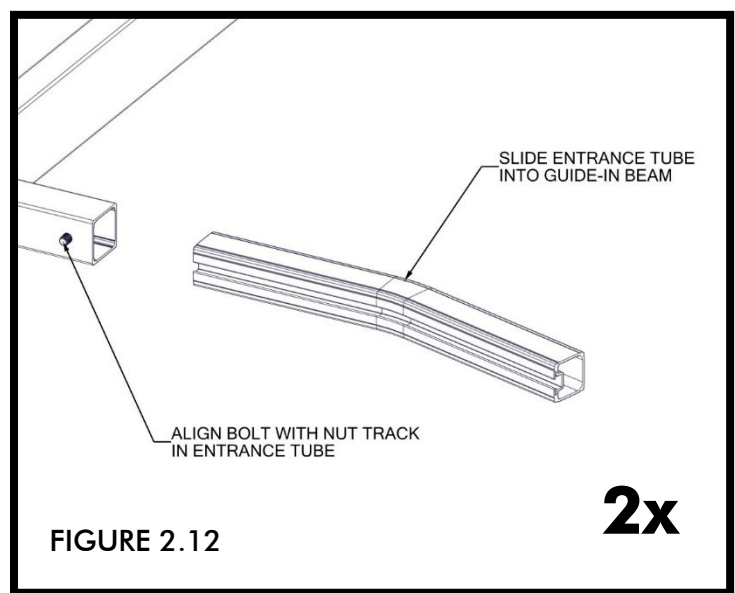
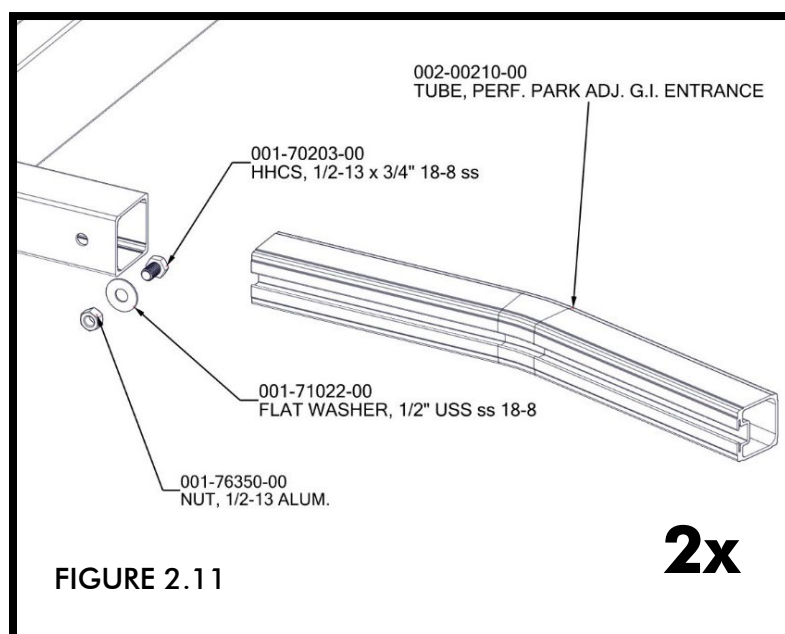

SLIDE EXTENSION TUBE ONTO BOTH ENTRANCE TUBES AND ATTACH TO EACH GUIDE-IN BEAM USING A 1/2-13 x 3/4" BOLT, 1/2" WASHER, AND 1/2" NUT (FIGURES 2.14 & 2.15). **ENSURE THAT THERE IS A MINIMUM OF 6" OF OVERLAP (FIG. 2.16).**

FIGURE 2.14

2x

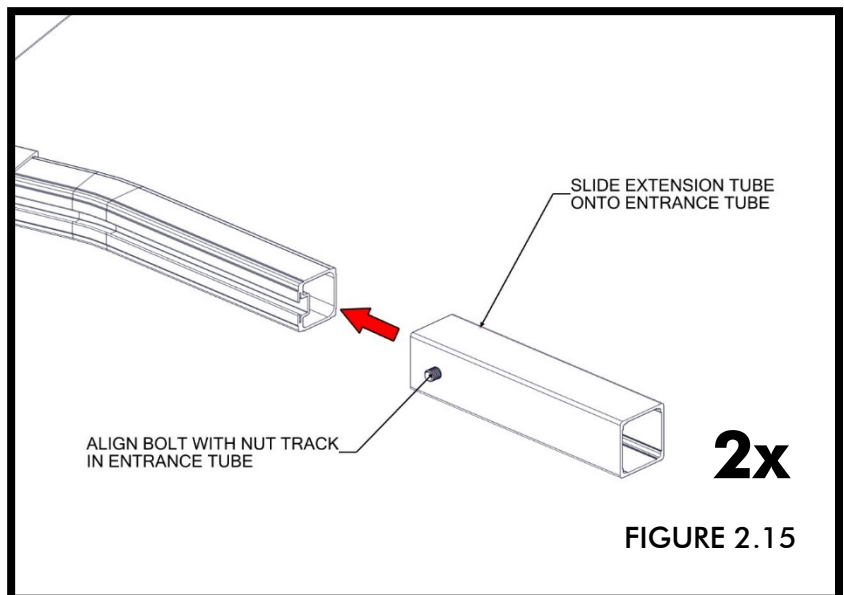
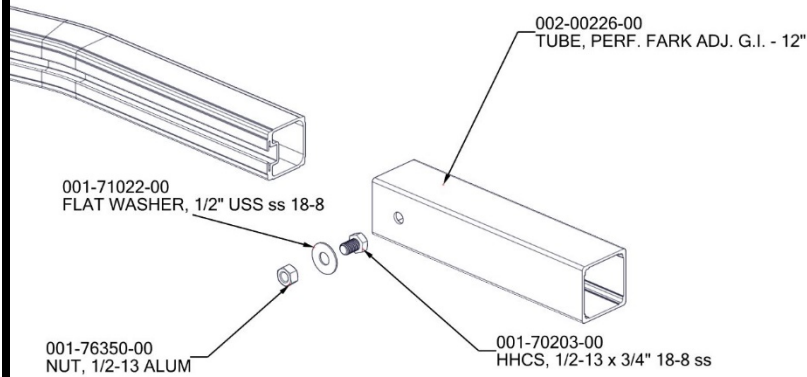
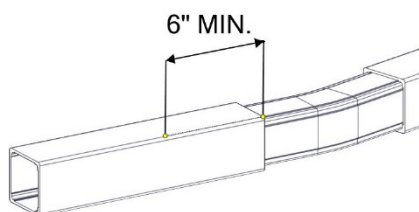

FIGURE 2.15

FIGURE 2.16

2x



TORQUE NUTS ON ENTRANCE TUBES AND EXTENSION TUBES TO 70 FT-LBS ONCE FINAL POSITION IS SET (FIGURE 2.17).

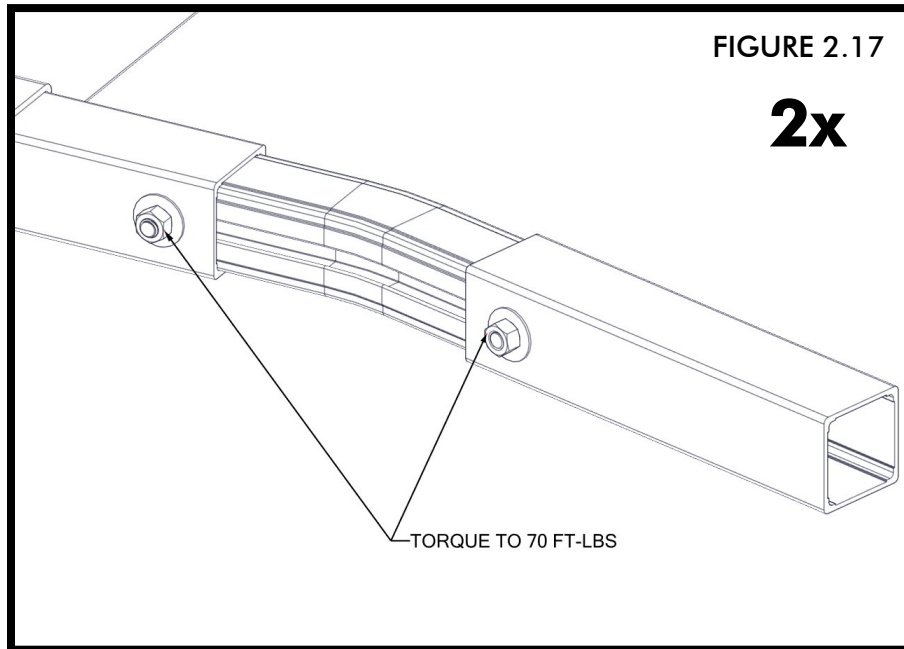

SLIDE REMAINING VERTICAL GUIDE ASSEMBLIES ONTO GUIDE-IN BEAMS, PLACE FLUSH WITH END OF ADJUSTMENT TUBES, AND ATTACH USING A 1/2-13 x 3/4" BOLT AND 1/2" NUT (FIGURE 2.18).

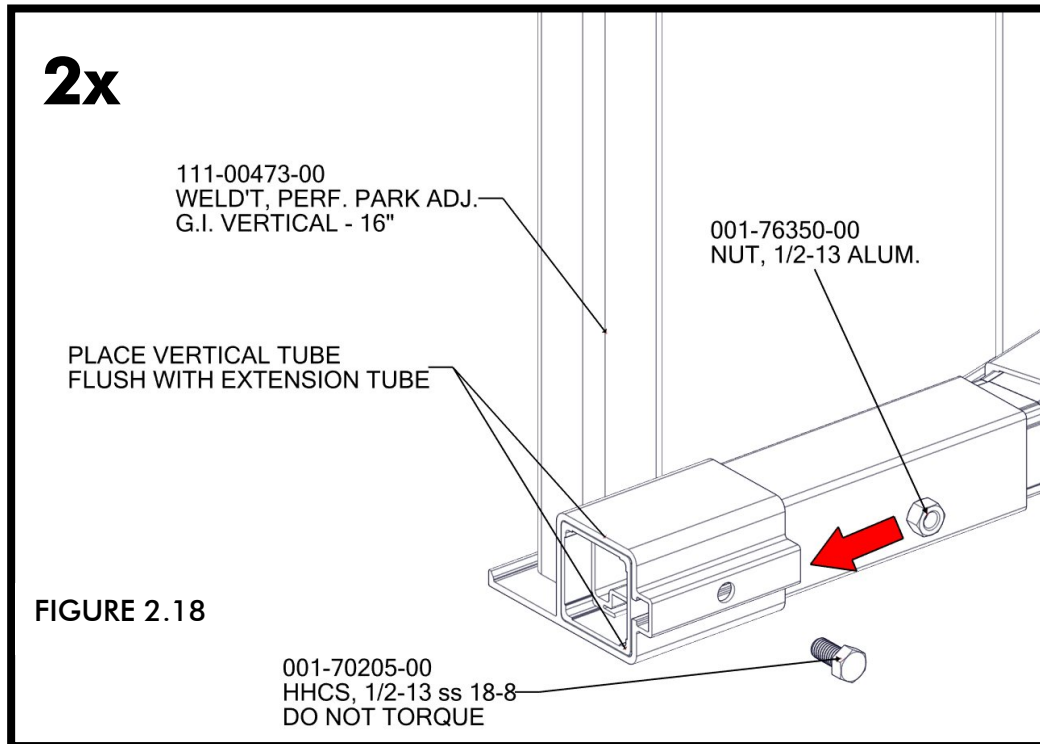

SLIDE (8) PVC TUBES OVER VERTICAL GUIDES (FIGURE 2.19).

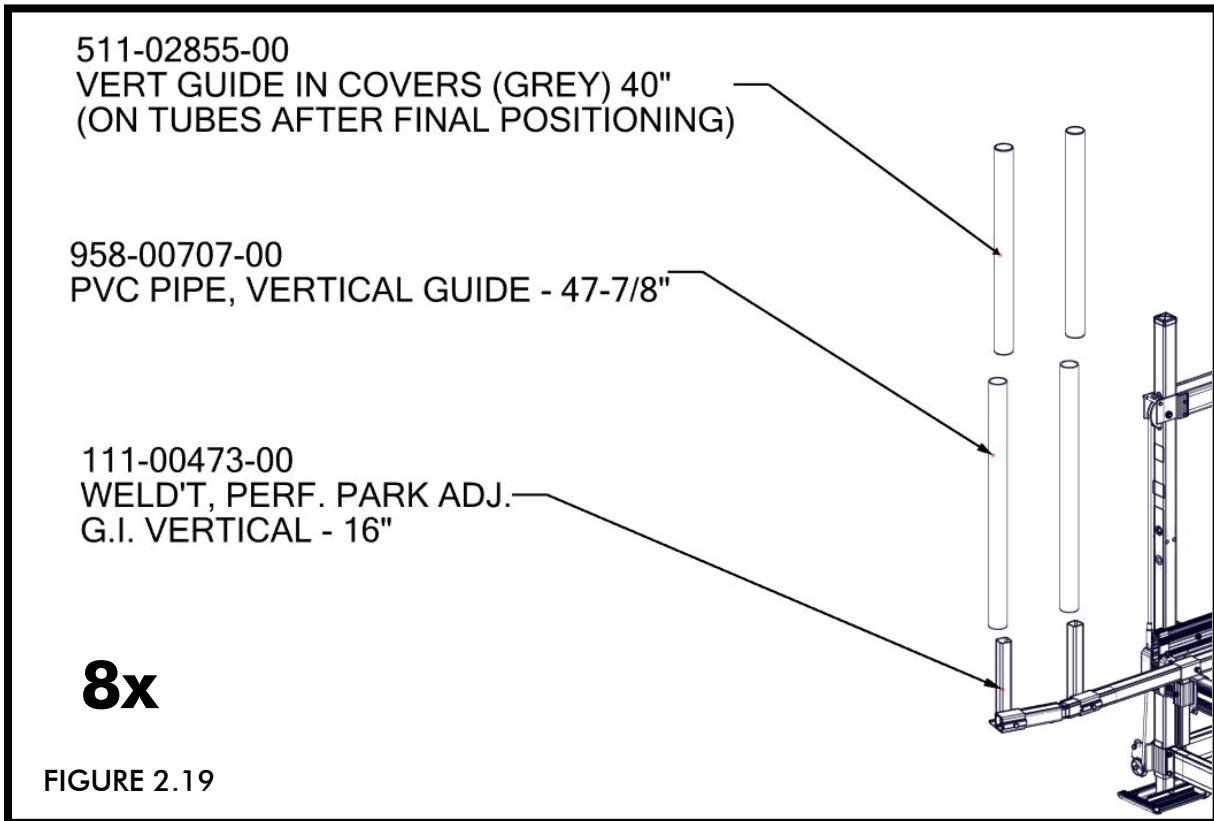

FOR FINAL POSITIONING, MEASURE WIDTH OF BOAT AND MATCH THIS DIMENSION WITH THE INSIDE DISTANCE BETWEEN THE PVC TUBES (FIGURE 2.20).

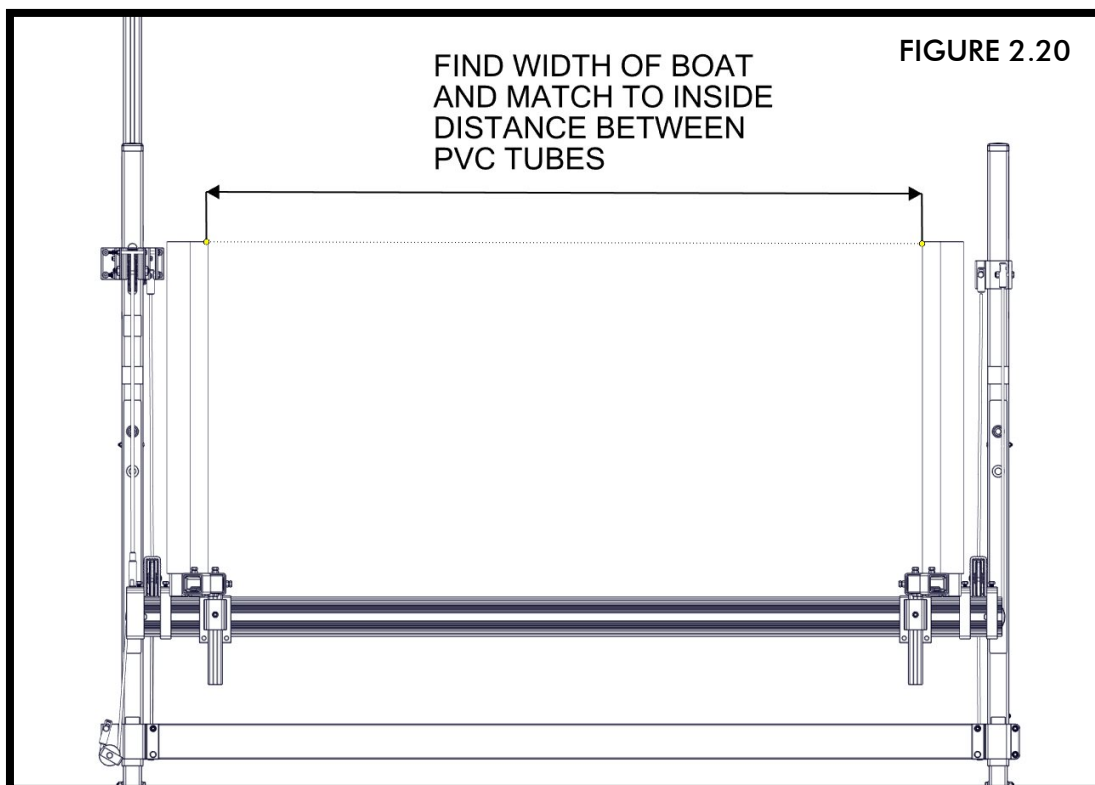

TORQUE $\frac{1}{2}$ " BOLTS ON ALL (8) VERTICAL GUIDES TO 20 FT-LBS ONCE FINAL POSITION IS SET (FIGURE 2.21).

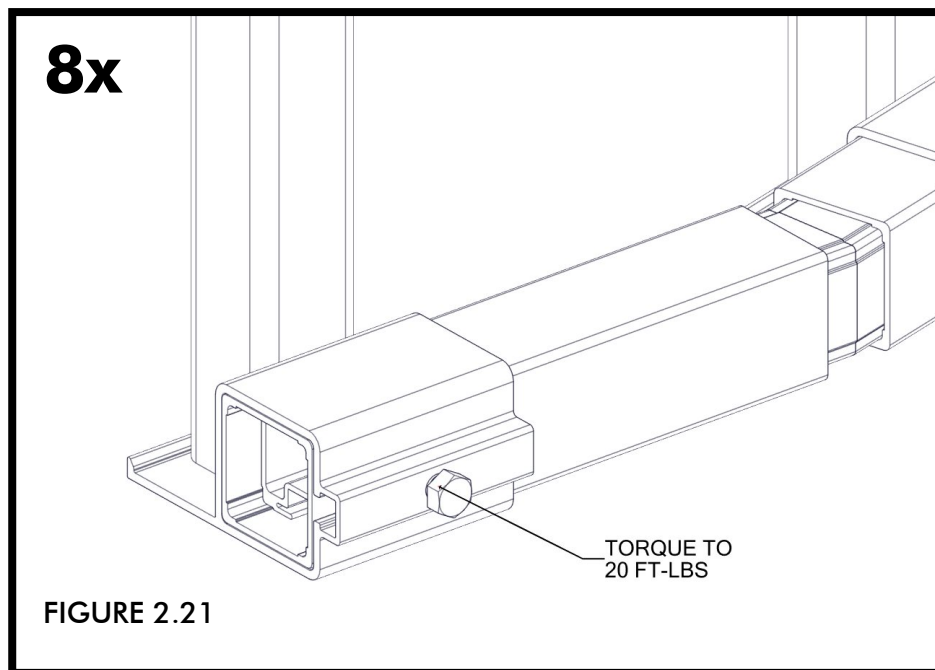

TORQUE $\frac{3}{8}$ " NUTS ON CRADLE BEAM CLAMPS TO 35 FT-LBS (FIGURE 2.22). PLACE COVERS ON TUBES (FIG 2.19).

