

BENCH

ALUMA-GRAIN W/ARMREST

GRAY ALUM. W/ARMRESTS

FOR ROLL-IN AND SECTIONAL DOCKS



ASSEMBLY INSTRUCTIONS

KIT P/N 510-41613-00 Aluma-Grain

KIT P/N 510-41615-00 Gray

SCAN QR CODE BELOW FOR LINK TO
ASSEMBLY VIDEO
(ALSO COVERS ATTACHMENT TO
QUICK ATTACH SECTIONAL DOCK)

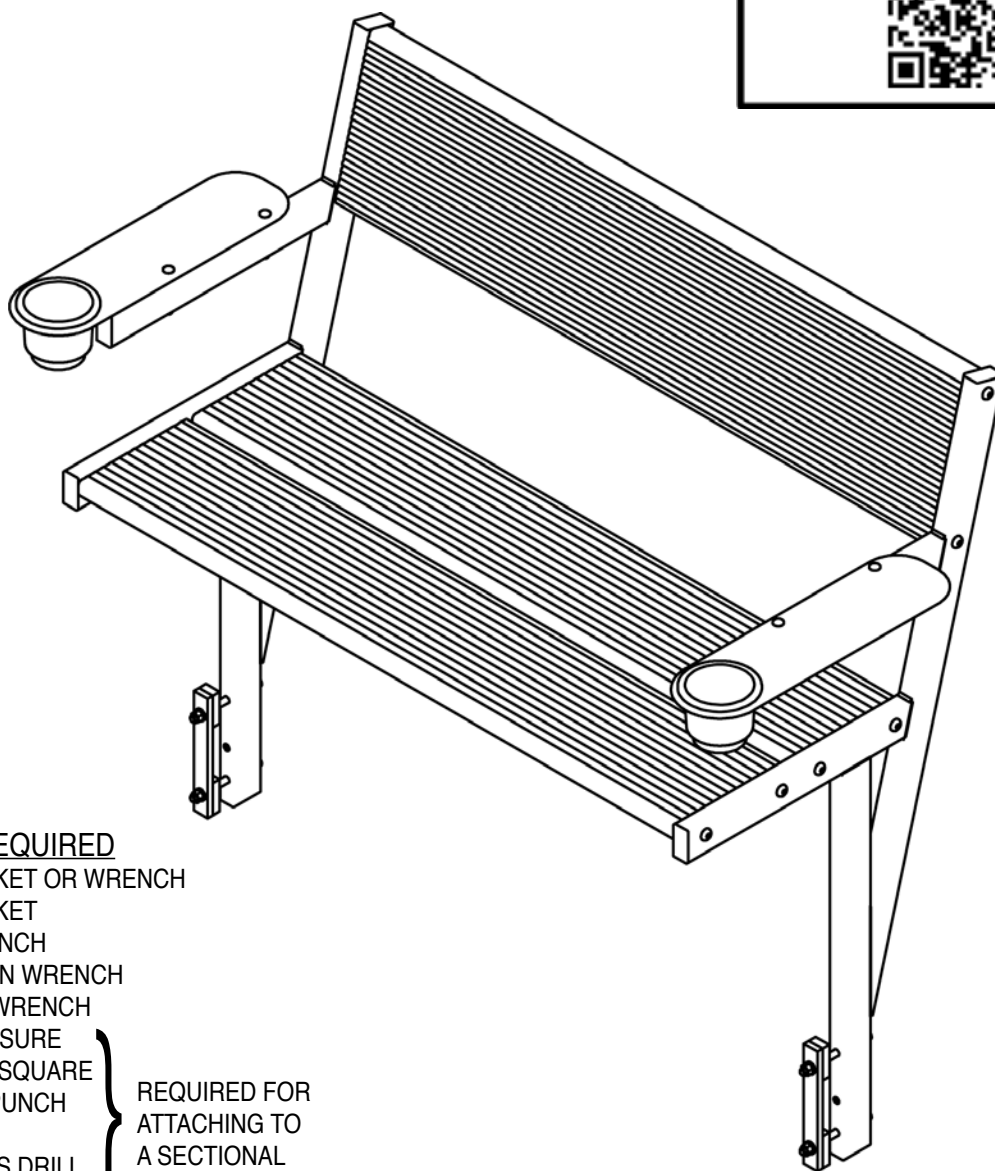

TOOLS REQUIRED

- 7/16" SOCKET OR WRENCH
 - 9/16" SOCKET
 - 9/16" WRENCH
 - 7/32" ALLEN WRENCH
 - TORQUE WRENCH
 - TAPE MEASURE
 - FRAMING SQUARE
 - CENTER PUNCH
 - HAMMER
 - CORDLESS DRILL
 - 13/32" DRILL BIT
- REQUIRED FOR
ATTACHING TO
A SECTIONAL
DOCK.

BENCH

EXPLODED VIEW

AND PARTS LIST

KIT P/N 510-41613-00 Aluma-Grain

KIT P/N 510-41615-00 Gray

Item	Part No.	Qty	Description
1	001-70960-00	4	Nut, Acorn 1/4-20 SS
2	001-71067-00	4	Lock Washer, 3/8" SS
3	001-72940-00	4	HHCS, 3/8-16 X 4 1/2" Full Thread SS
4	001-73819-00	12	BHCS, 3/8-16 X 2" SS
5	001-74424-00	4	CB, 1/4-20 X 2 1/2" SS
6	001-76349-00	4	Nut 3/8" Aluminum
7	002-02203-00	2	Plate, Dock Accessory
8	002-02204-00	4	Spacer, Dock Accessory
9	006-12300-00	6	Cap Plug, 1" X 2"
10	010-00024-00	2	Cupholder, Armrest
11	002-00116-00	1	Plank, Dock Bench A.G.(10" W)
12	002-00118-00	2	Plank, Dock Bench A.G. (8" W)
13	010-00567-00	2	Armrest, Bench Aluma-Grain
14	002-00117-00	1	Plank, Dock Bench Grey (10"W)
15	002-00119-00	2	Plank, Dock Bench Grey (8"W)
16	010-00735-00	2	Armrest, Bench - Gray
17	110-00096-00	2	WELD'T Bench Frame W/Armrest

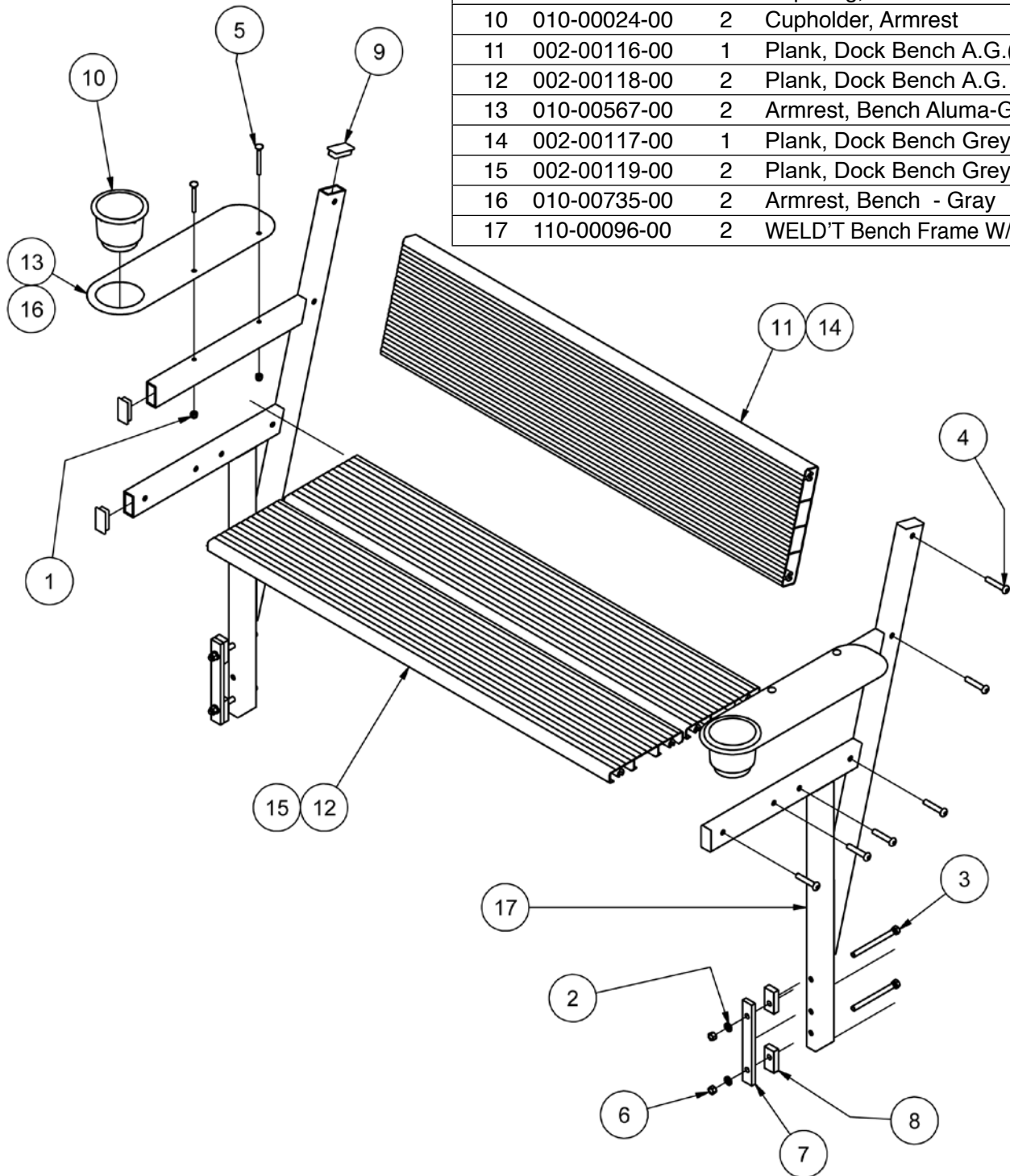

ASSEMBLY INSTRUCTIONS FOR ROLL-IN AND SECTIONAL DOCKS

KIT P/N 510-41613-00 Aluma-Grain

KIT P/N 510-41615-00 Gray

STEP 1

- Fasten 10" back rest plank to bench frames with (4) 3/8" x 2" button head screws as shown in Fig. 1.
- Fasten both 8" seat planks to bench frames with (8) 3/8" x 2" button head screws as shown in Fig. 1.
- Torque to 10 ft/lbs. **WARNING: DO NOT OVER TIGHTEN**

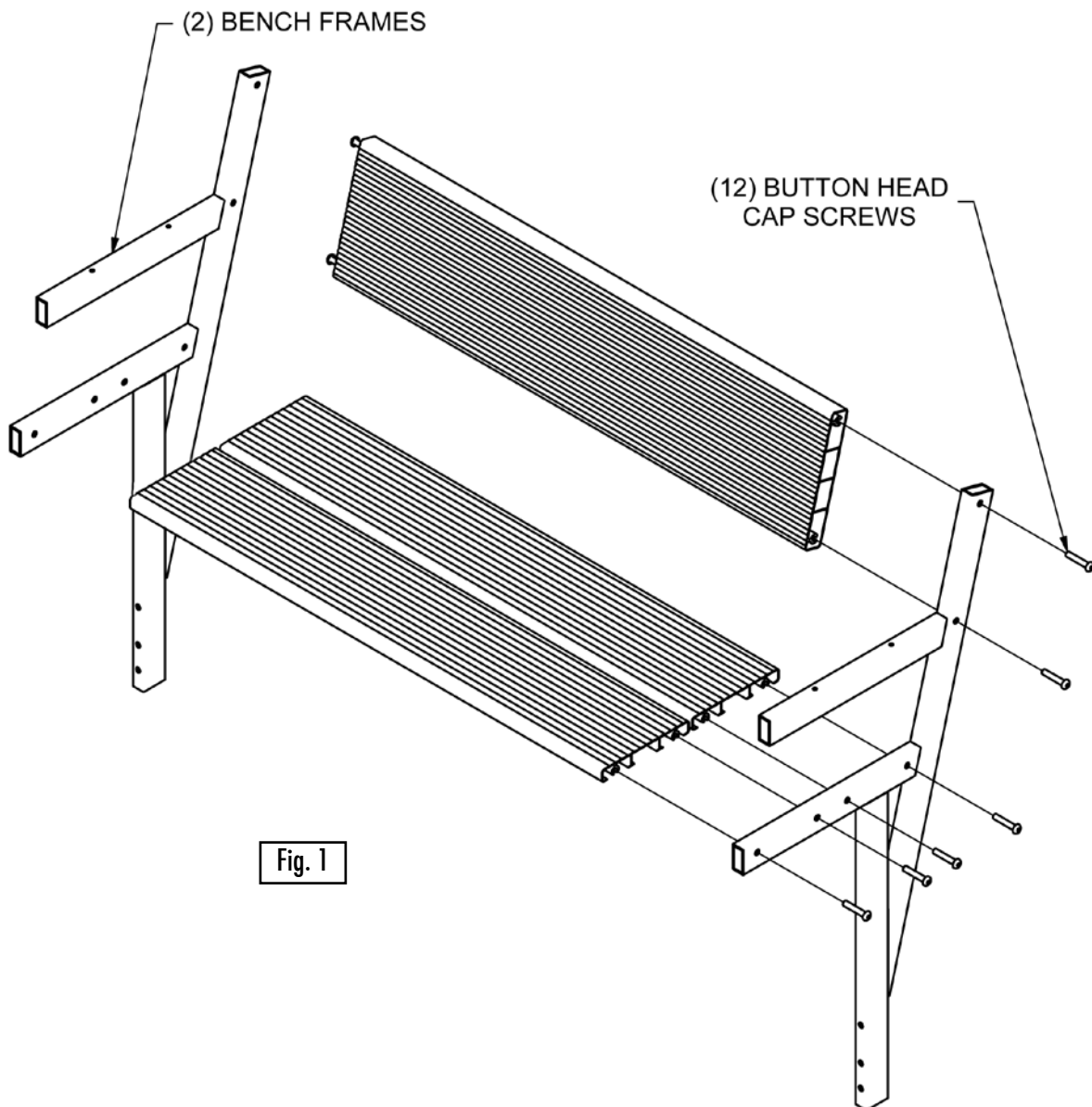

STEP 2

- Install (6) cap plugs into the ends of the 1 x 2" tubes on bench frames where illustrated in Figure 2.
- Do not use on the bench legs.

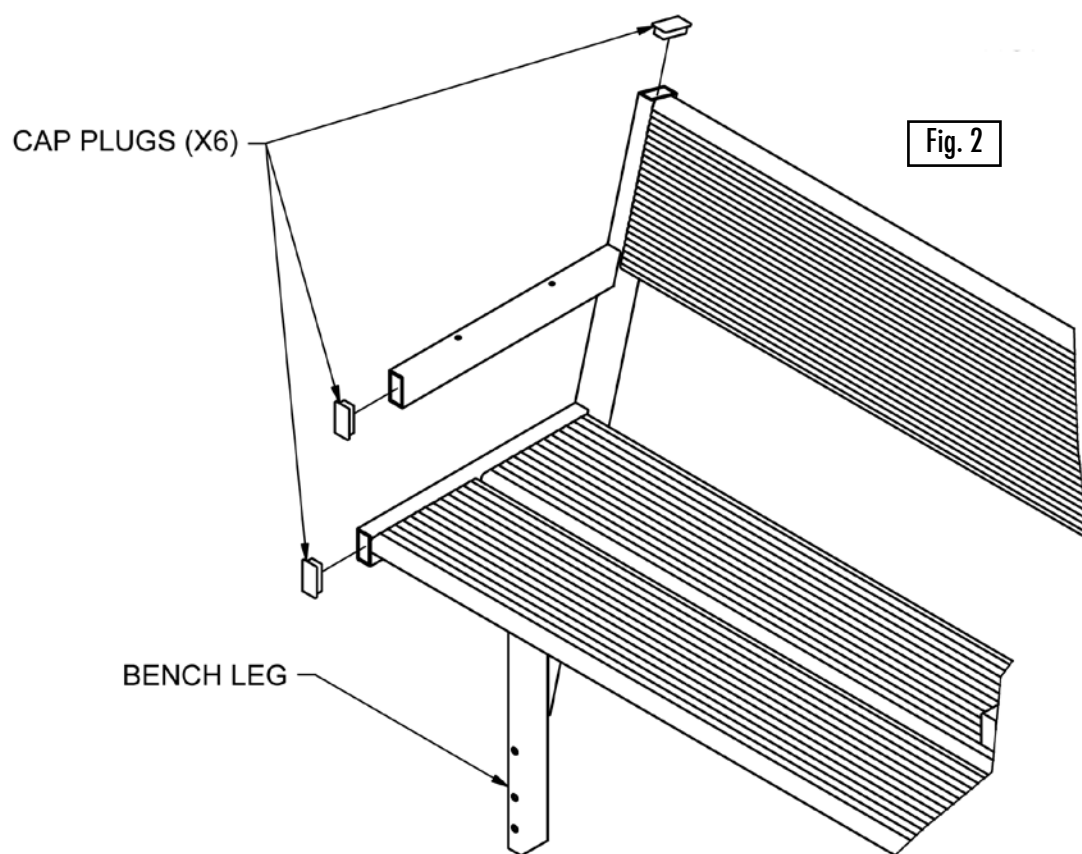

STEP 3

- Attach the armrest as shown in Figure 3 using (4) 1/4 X 2-1/2" carriage bolts and (4) 1/4" Acorn nuts.
- Torque to 10 ft/lbs.

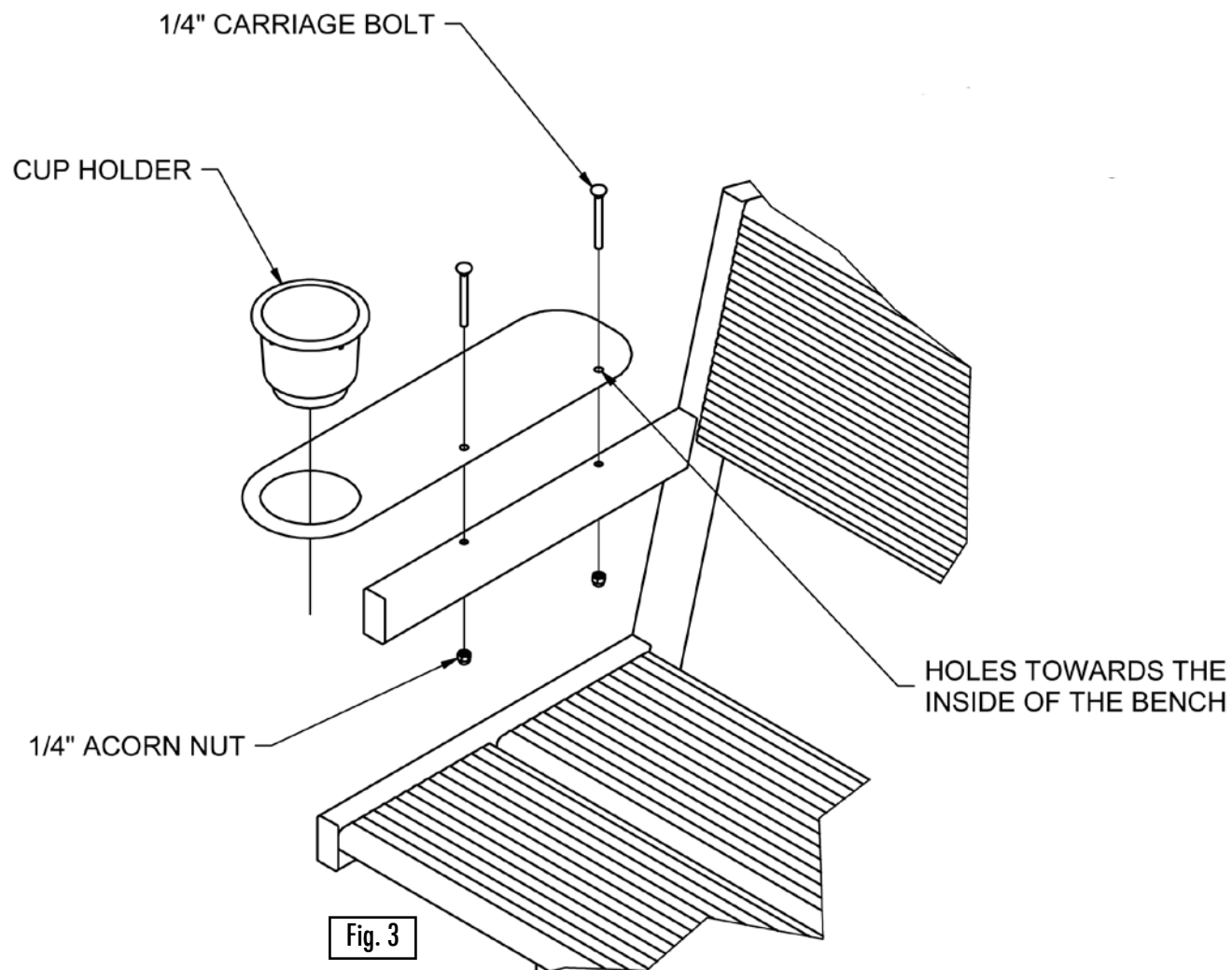

ASSEMBLY INSTRUCTIONS FOR ROLL-IN DOCKS

KIT P/N 510-41613-00 Aluma-Grain

KIT P/N 510-41615-00 Gray

- Insert 3/8" x 4 1/2" bolts into (4) holes on bench. Bolts go through upper and lower holes on bench for roll-in docks.
- Set bench so bottom bolt rests on bottom rail of dock.
- Recommended that you clamp bench in place.
- Slide 1 spacer over each bolt.
If bolt is close to webbing. Do not add spacer. The webbing will act as the spacer
- Slide dock plate over bolts.
- Slide 3/8" lock washers over bolts.
- Install 3/8" aluminum nut.
- Torque to 25 ft/lbs.

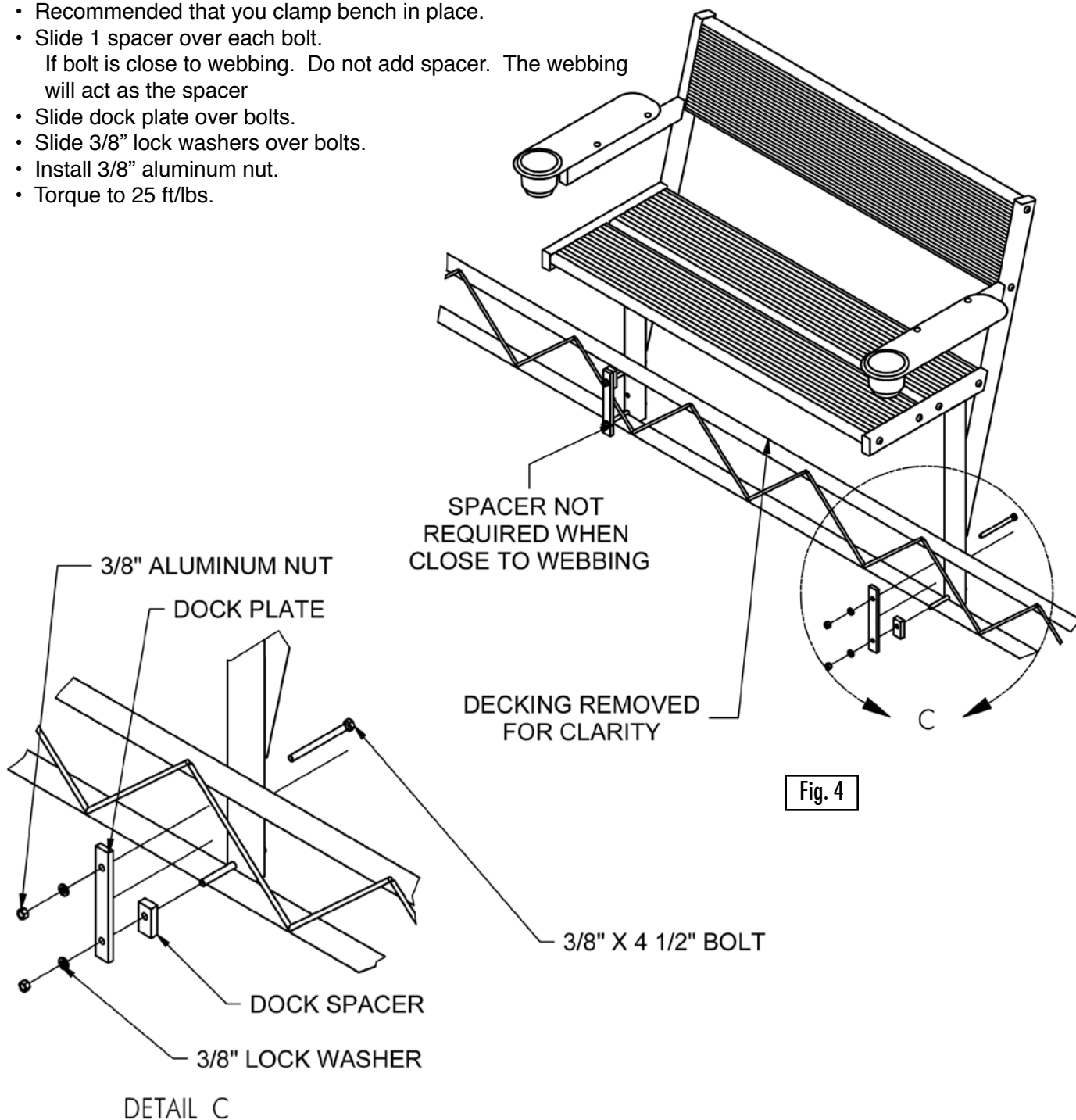

ASSEMBLY INSTRUCTIONS FOR SECTIONAL DOCKS

KIT P/N 510-41613-00 Aluma-Grain

KIT P/N 510-41615-00 Gray

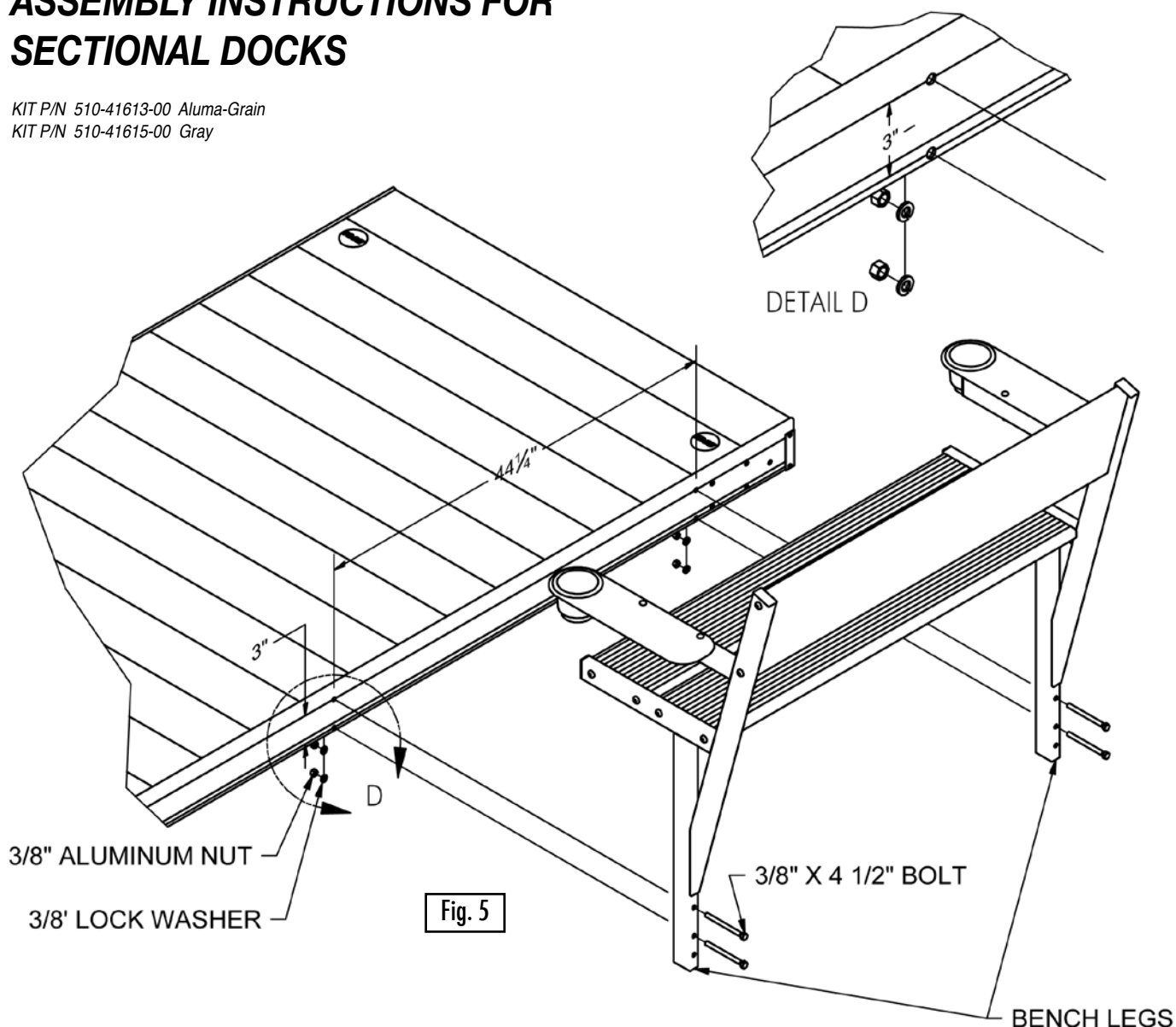

- For attachment to sectional docks, mounting holes must be drilled using a 13/32" drill bit.
- After determining the location of the bench, use a framing square and mark a vertical line across the top and bottom serration (these serrations are 3" apart and are intended to act as a hole spacing reference; refer to Detail D).
- Mark a second line 44-1/4" from the first as shown in Fig. 5.
- Use the hammer and center punch to make a dimple for the drill bit. This helps to prevent the drill from wandering during the drilling process. Keep the drill bit perpendicular to the dock frame while drilling.
- Insert (4) 3/8" x 4 1/2" bolts through the bench legs and the dock side. Bolts go through upper and middle hole on bench for sectional docks.
- Place (4) 3/8" lock washer and (4) 3/8" aluminum nuts on the bolts. Torque to 25 ft/lbs.
- **MAKE SURE THE BENCH IS SQUARE TO THE DOCK.**

