

# FLOE DOCK LADDER FLOATING DOCKS ASSEMBLY INSTRUCTIONS

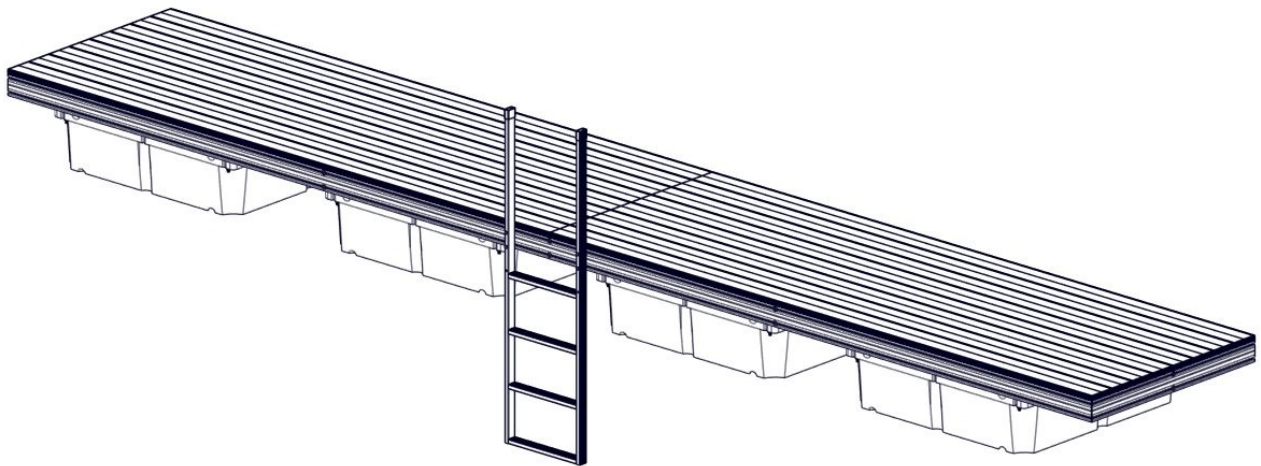

KIT P/N 510-41406-00



**\*DOCK SECTION NOT INCLUDED**

## TOOLS REQUIRED

- 9/16" SOCKET/WRENCH
- TORQUE WRENCH

# BILL OF MATERIALS

511-41406-00

NUMBER	PART NUMBER	QTY.	DESCRIPTION
1	001-70114-00	4	HHCS, 3/8-16 x 2-3/4" 18-8 SS
2	001-71017-00	4	FLAT WASHER, 3/8" SAE SS 18-8
3	001-76071-00	4	NUT, NYLOCK 3/8-16 ALUM.
4	006-13700-00	2	CAP, VINYL 1" x 2" x 2" LONG
5	110-00065-00	1	WELDMENT, DOCK LADDER – 70"

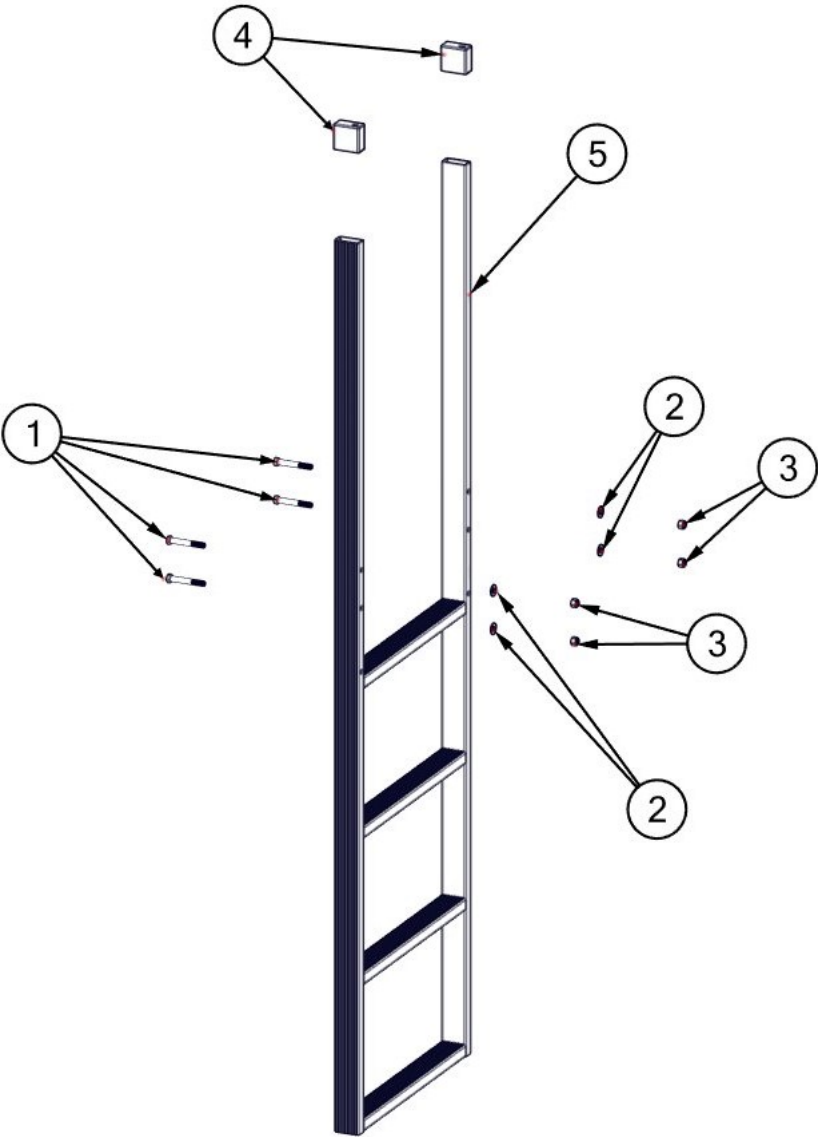

# INSTALLATION

3/8" NYLOCK NUTS AND 3/8" WASHERS ARE PLACED INSIDE THE HOLES IN THE FRAME (FIGURE 1.1). FIRST, INSERT THE NYLOCK NUTS INTO THE FRAME AND SLIDE TO THE DESIRED POSITION IN THE DOCK SIDE. THEN, INSERT THE 3/8" WASHERS INTO THE FRAME AND SLIDE TO THE SAME POSITION AS THE NYLOCK NUTS (FIGURE 1.2).

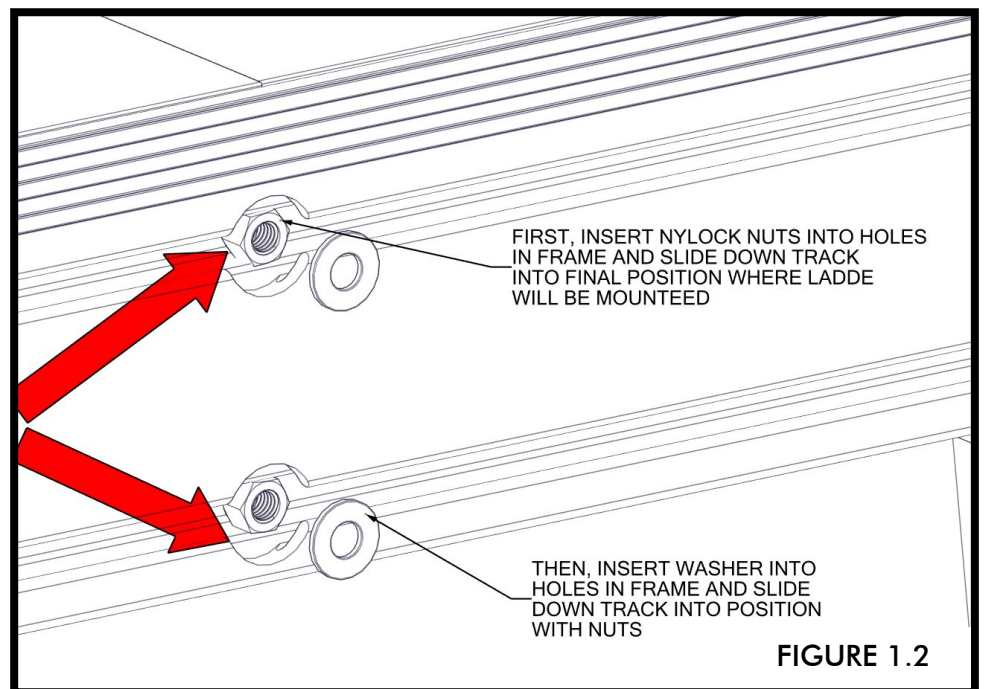
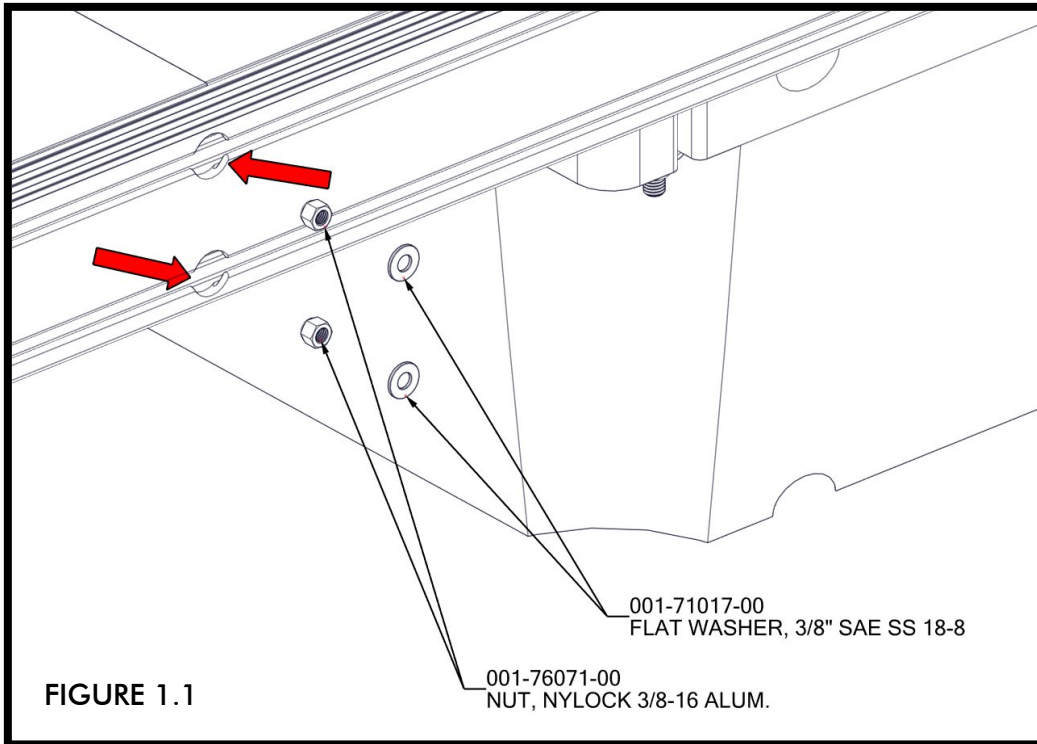

ATTACH LADDER TO DOCK SIDE USING (4) 3/8" X 2-3/4" BOLTS. SLIDE THROUGH THE UPPERMOST HOLES IN THE LADDER AND INTO THE WASHERS AND NYLOCK NUTS (FIGURE 1.3). ADJUST LADDER POSITION IF NECESSARY, THEN TORQUE TO 30 FT-LBS (FIGURE 1.4).

