

FLOE STANDARD SECTIONAL TO QUICK ATTACH SECTIONAL CONNECTION BRACKET ASSEMBLY INSTRUCTIONS

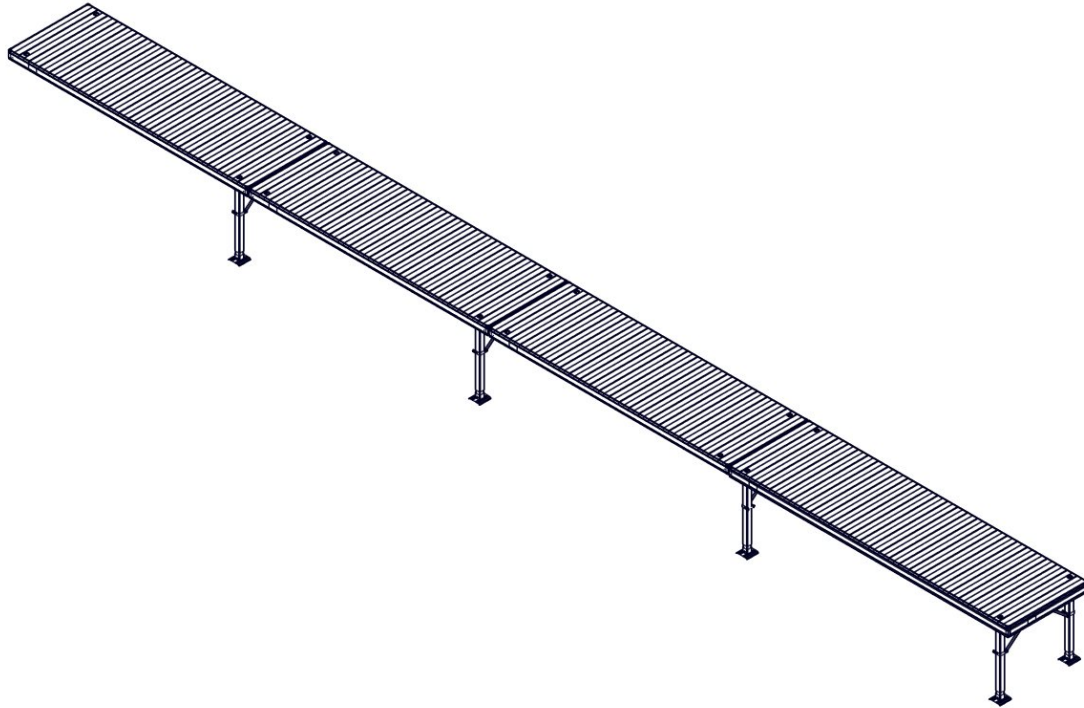

KIT P/N 510-02583-00



TOOLS REQUIRED

- 9/16" SOCKET/WRENCH
- TORQUE WRENCH

*DOCKS, LEGS, SAFETY CONNECTS, AND
QUICK CONNECTS NOT INCLUDED

BILL OF MATERIALS

510-02583-00	KIT, CONNECTION STD. SCTN'L TO QA SCTN'L		
NUMBER	PART NUMBER	QTY.	DESCRIPTION
1	001-70105-00	4	HHCS, 3/8-16 X 1" SS
2	110-00278-00	1	ASS'Y, STD. SCTN'L TO QA SCTN'L BRACKET (A)
3	110-00279-00	1	ASS'Y, STD. SCTN'L TO QA SCTN'L BRACKET (B)

110-00278-00	ASS'Y, STD. SCTN'L TO QA SCTN'L BRACKET (A)		
NUMBER	PART NUMBER	QTY.	DESCRIPTION
2A	001-70103-00	1	HHCS, 3/8-16 X 3/4" 18-8 SS
2B	110-00273-00	1	WELD'T, STD. SCTN'L TO QA SCTN'L BRACKET (A)

110-00279-00	ASS'Y, STD. SCTN'L TO QA SCTN'L BRACKET (B)		
NUMBER	PART NUMBER	QTY.	DESCRIPTION
3A	001-70103-00	1	HHCS, 3/8-16 X 3/4" 18-8 SS
3B	110-00274-00	1	WELD'T, STD. SCTN'L TO QA SCTN'L BRACKET (B)

EXPLODED VIEW

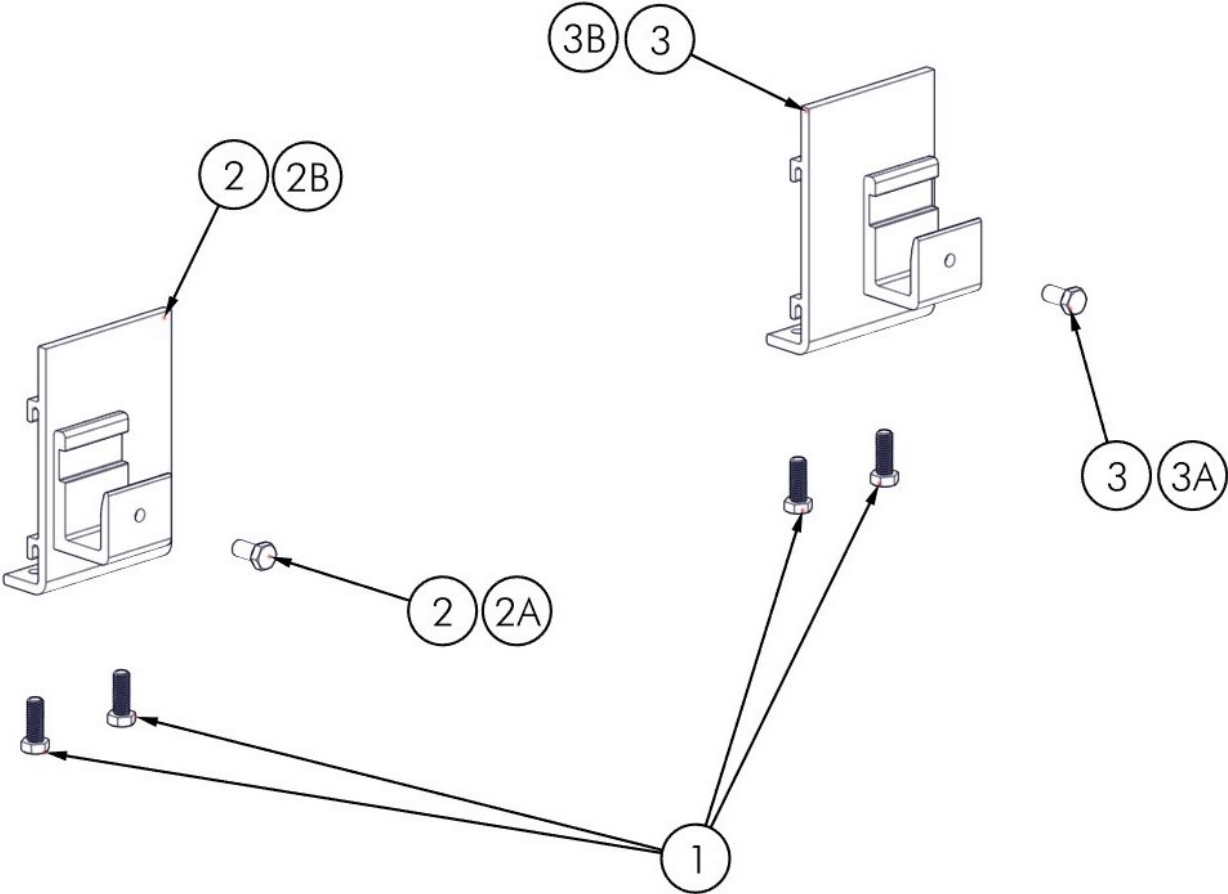

INSTALLATION

INSTALL BRACKETS ONTO DOCK SIDE (FIGURE 1.1) AND PLACE THEM AS FAR OUT AS POSSIBLE (OUTER EDGE OF BRACKET TOUCHES THE CORNER CAP) (FIGURE 1.2).

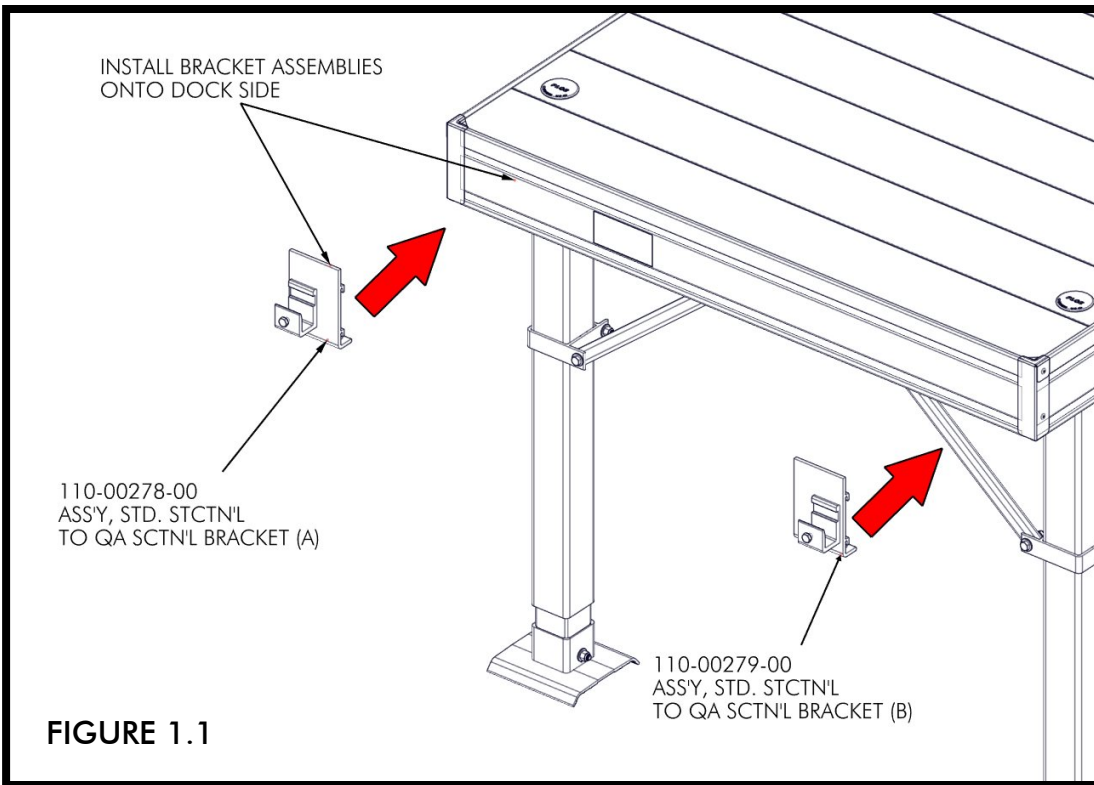

FIGURE 1.1

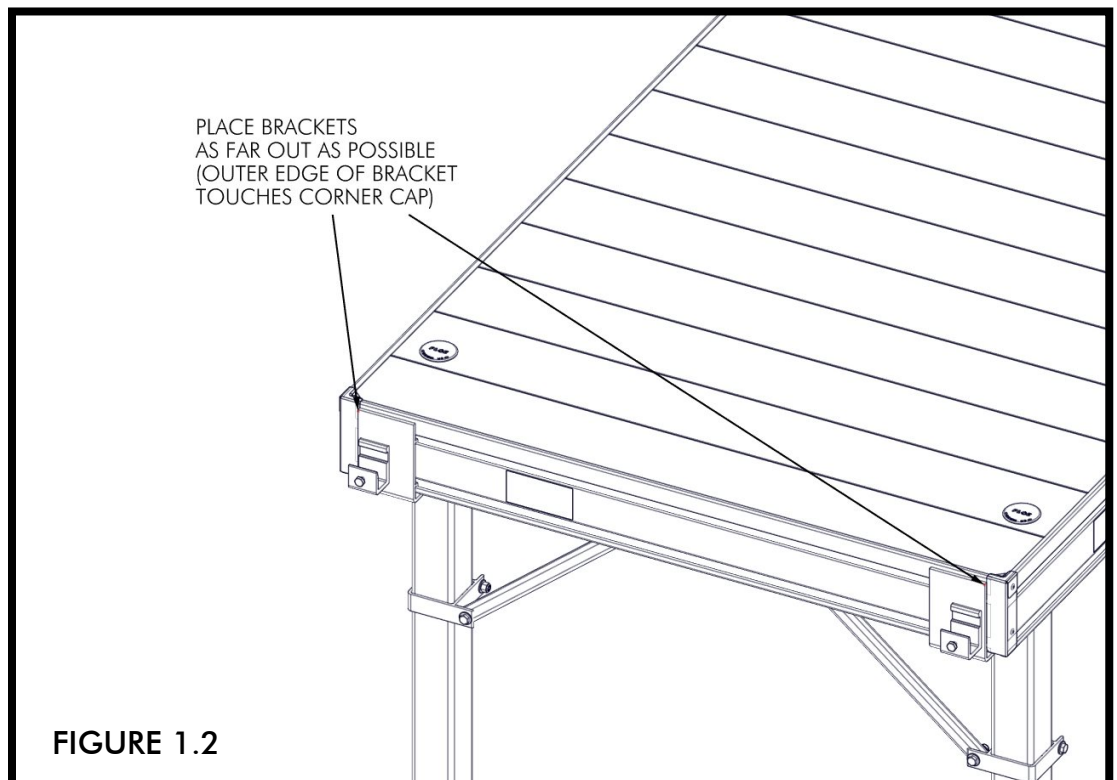

FIGURE 1.2

INSTALL (2) 3/8" X 1" BOLTS INTO EACH BRACKET (FIGURE 1.3). TORQUE TO 6 FT-LBS MAXIMUM (FIGURE 1.4).

FIGURE 1.3

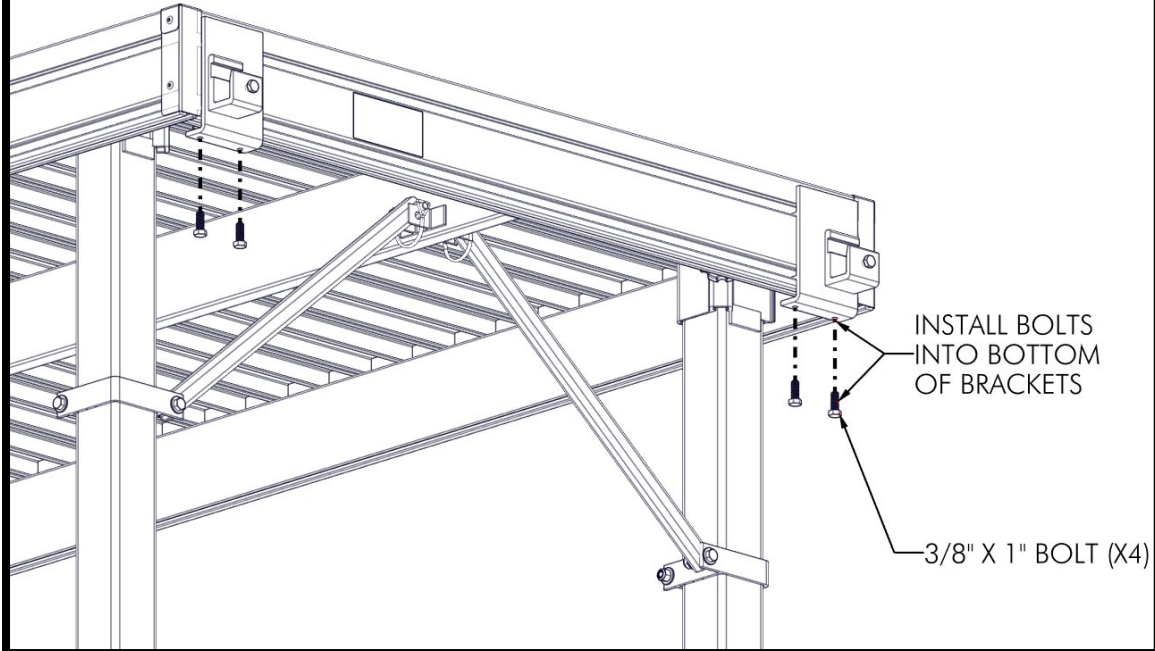
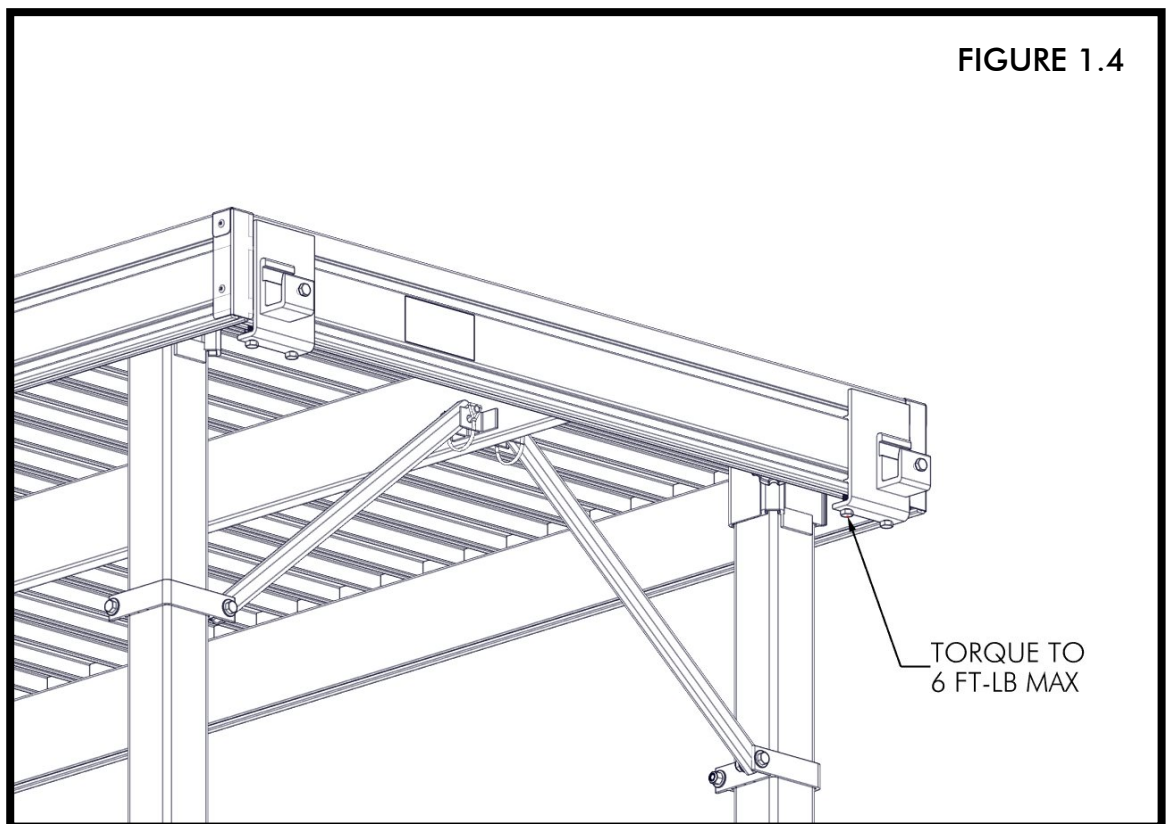
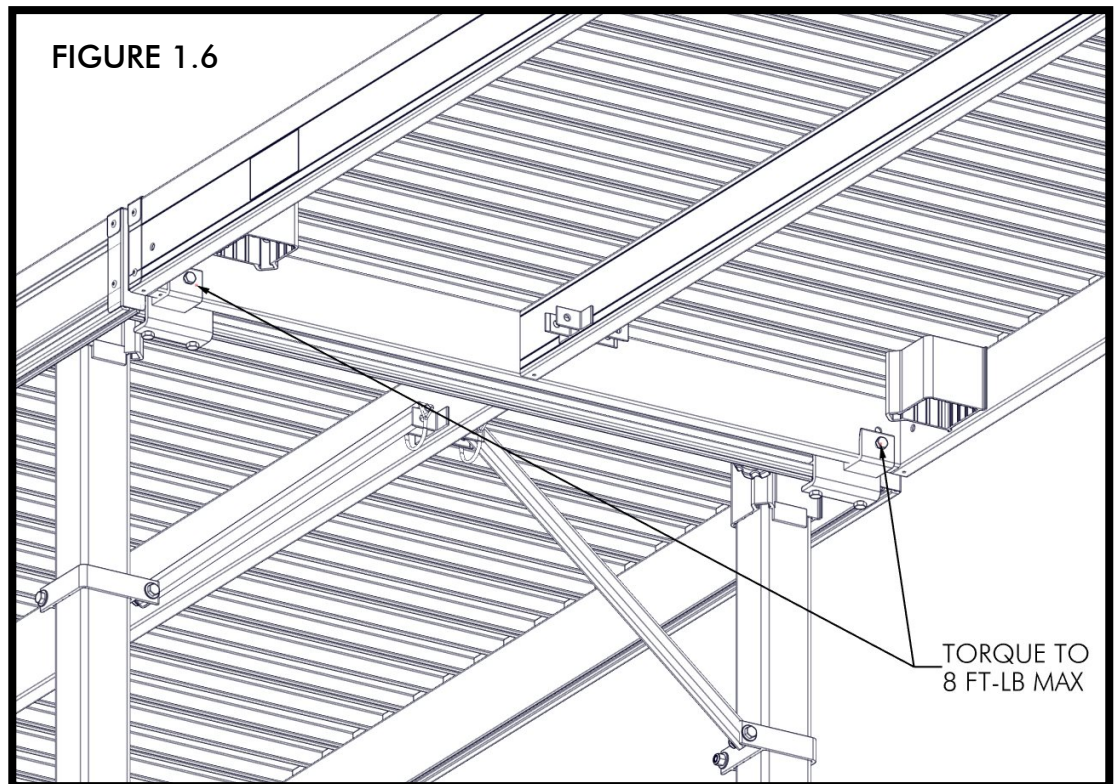
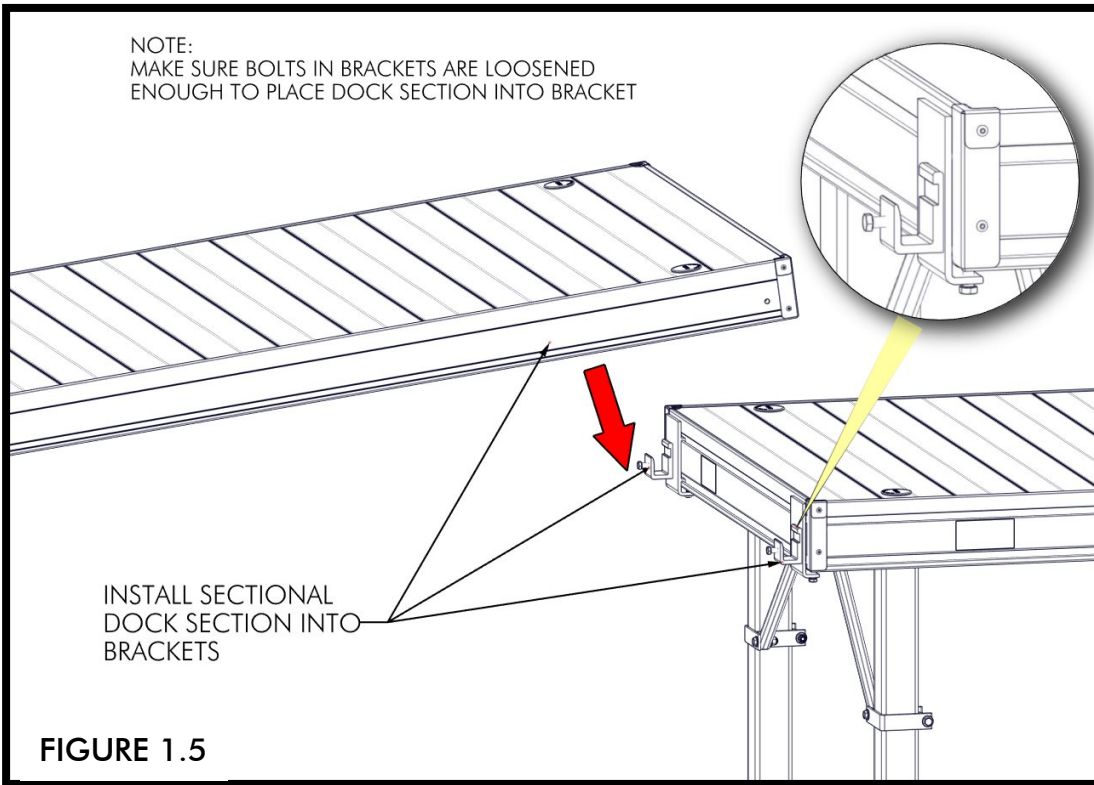

FIGURE 1.4



PLACE STANDARD SECTIONAL DOCK SECTION INTO BRACKETS. NOTE: MAKE SURE BOLTS IN BRACKETS ARE LOOSENEED ENOUGH TO PLACE DOCK SECTION INTO BRACKET (FIGURE 1.5). TORQUE PRE-INSTALLED BOLTS TO 8 FT-LB MAXIMUM (FIGURE 1.6).



WHEN USING THESE STANDARD SECTIONAL TO QUICK ATTACH SECTIONAL CONNECTION BRACKETS, THE FIRST STANDARD SECTIONAL DOCK CONNECTED WILL NOT HAVE ANY LEGS INSTALLED ON IT (FIGURE 1.7). THE SECOND STANDARD SECTIONAL DOCK CONNECTIONS WILL BE MADE WITH QUICK CONNECTS (SOLD SEPARATELY) AND WILL HAVE LEGS INSTALLED ON IT. THE THIRD STANDARD SECTIONAL DOCK CONNECTION WILL BE MADE WITH SAFETY CONNECTS (SOLD SEPARATELY) AND WILL HAVE LEGS INSTALLED ON IT (FIGURE 1.8).

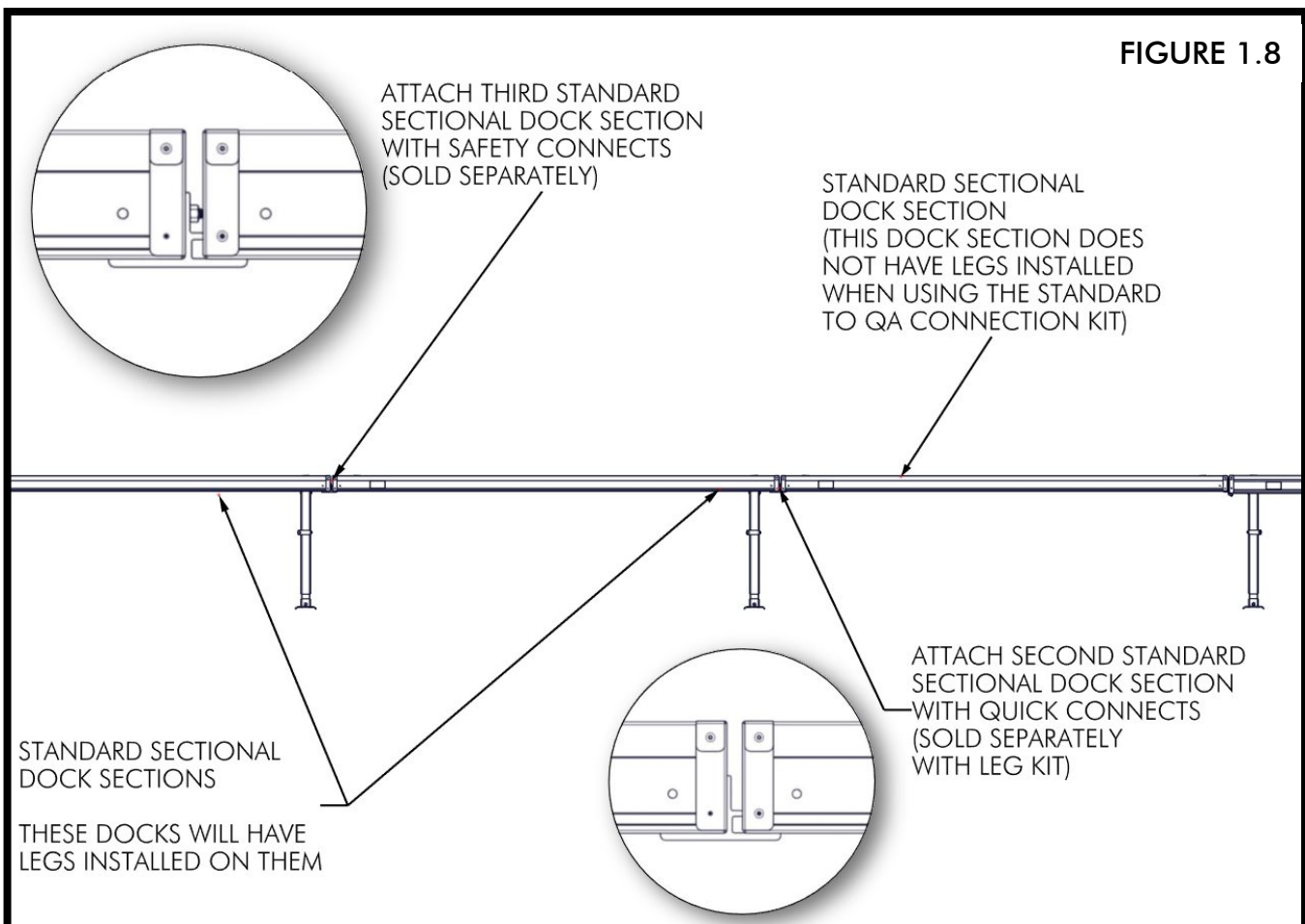
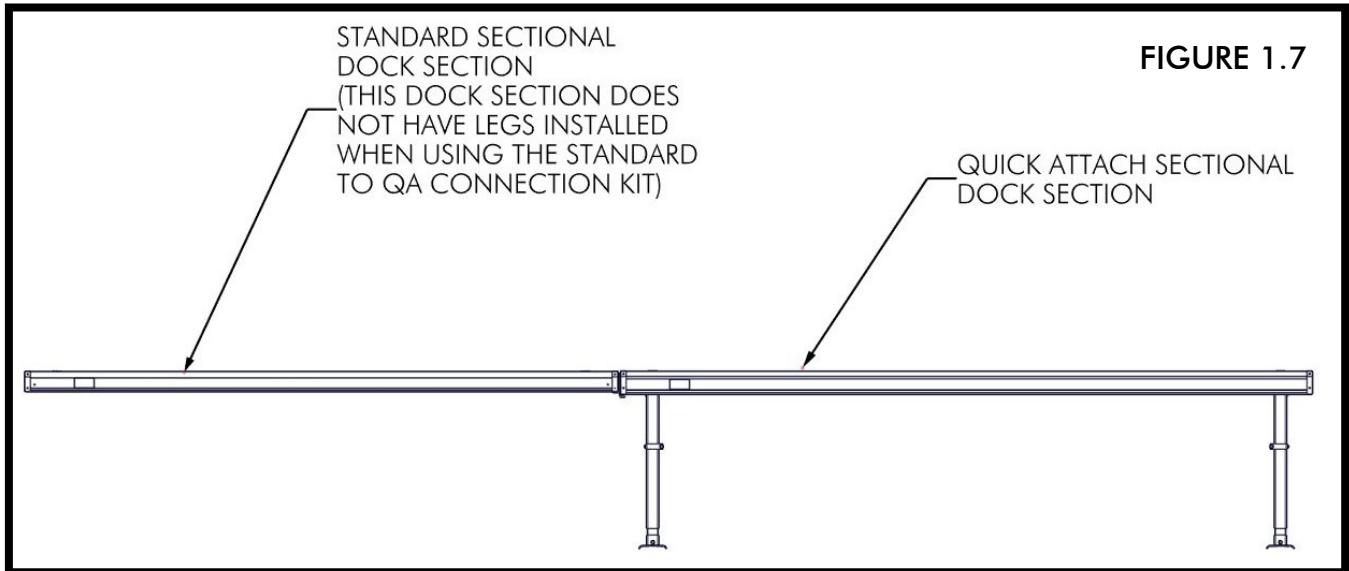

THE FIGURE BELOW SHOWS THE ARRANGEMENT OF DOCKS AND LOCATIONS OF THE CONNECTION BRACKETS.

FIGURE 1.9

