

FLOE ROLL-IN DOCK HAMMOCK FRAME

ASSEMBLY INSTRUCTIONS

KIT P/N: 510-00110-00



Tools Required:

- (2) 9/16" Sockets and/or wrenches
- (1) 7/32" Allen wrench

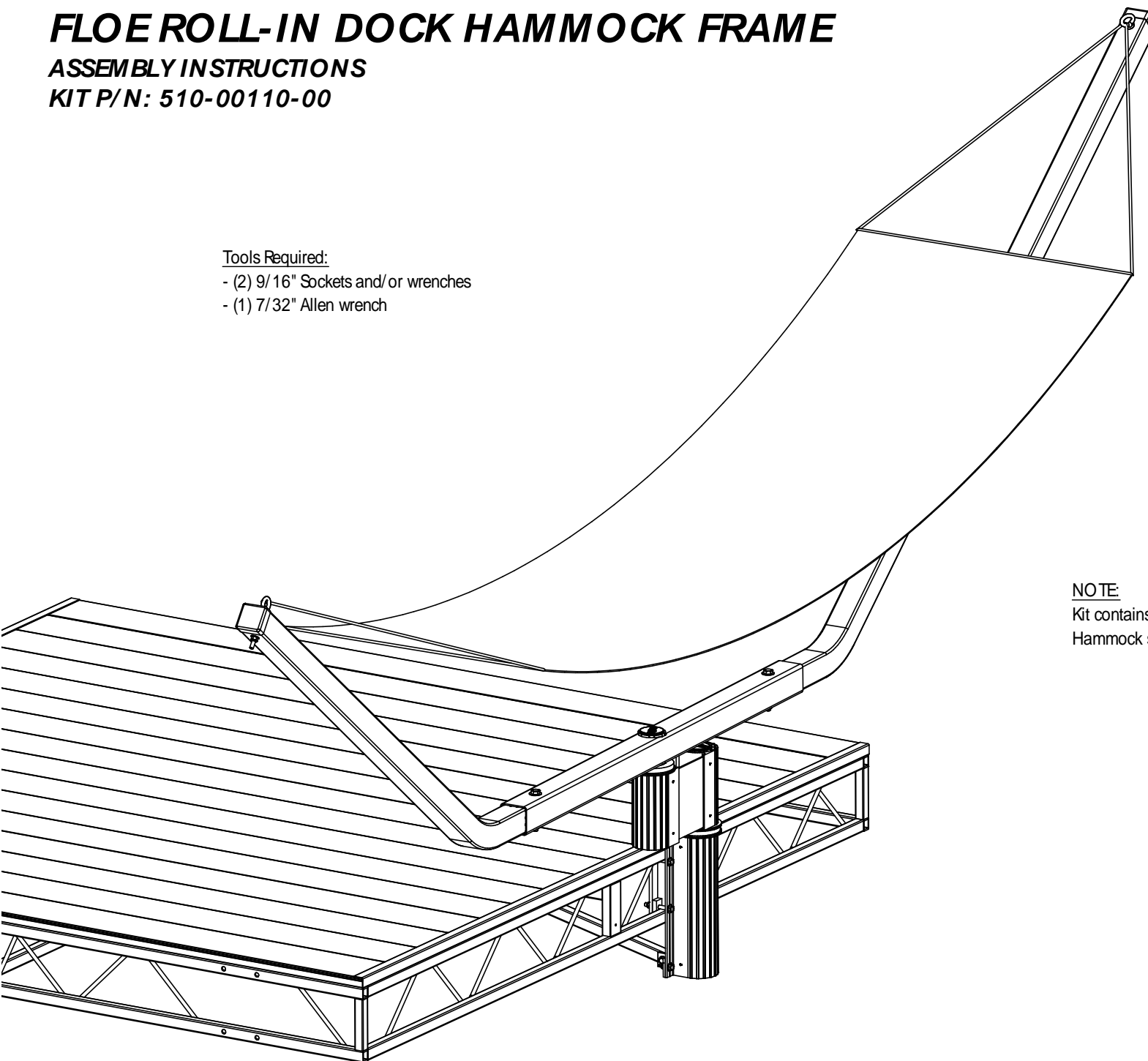

NOTE:

Kit contains hammock frame only.
Hammock shown is not included.

FLOE ROLL-IN DOCK HAMMOCK FRAME

Kit Includes:

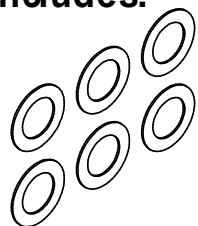

(6) UHMW Pivot Washers
P/N 010-00025-00

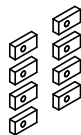

(8) Dock Accessory Spacer
P/N 002-02204-00

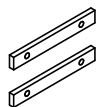

(2) Dock Accessory Plate
P/N 002-02203-00



(2) Plastic Caps
P/N 006-13200-00

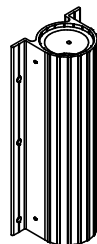

(1) Hammock Mount Assembly
P/N 110-00119-00

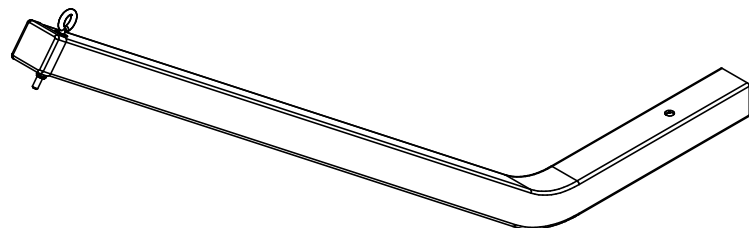

(1) Short Hammock Leg Ass'y
P/N 110-00114-00

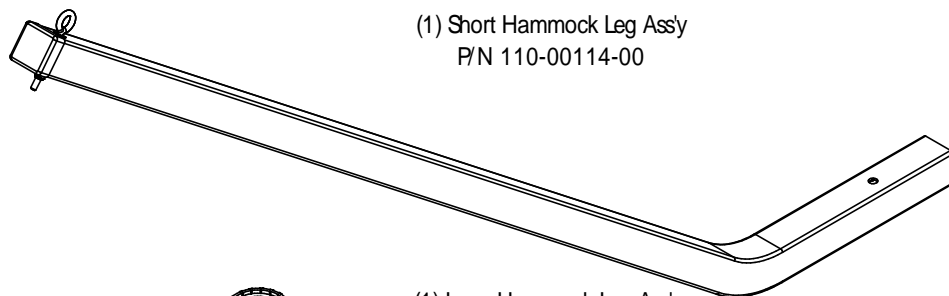

(1) Long Hammock Leg Ass'y
P/N 110-00113-00

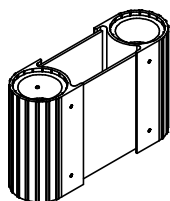

(1) Hammock Pivot Extension
P/N 110-00116-00



(1) Front Hammock Mount
P/N 110-00118-00

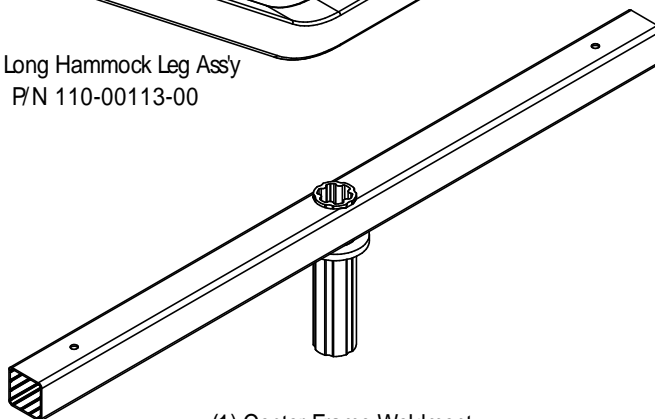

(1) Center Frame Weldment
P/N 110-00110-00

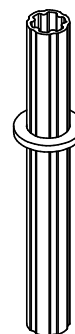

(1) Hammock Mounting Post
P/N 110-00112-00

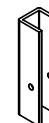

(1) Rear Hammock Mount
P/N 002-00110-00



(1) Hammock Attachment Plate
P/N 002-00113-00



(1) Hammock Support Tube
P/N 002-00111-00

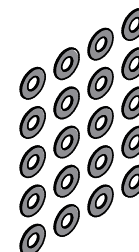

(20) 3/8" SAE Flat Washer
P/N 001-71017-00

Fastener Kit:



(2) 3/8" x 2 3/4" ss Bolts
P/N 001-70114-00

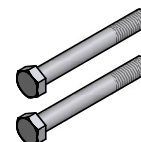

(2) 1/2" x 4" ss Bolts
P/N 001-70219-00

(2) 3/8" x 1 1/4" ss Bolts
P/N 001-70107-00



(4) 1/2" Flat Washers
P/N 001-71021-00



(10) 3/8" Alum. Nylock Nuts
P/N 001-76071-00

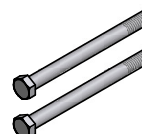

(2) 3/8" x 4 1/2" ss Bolts
P/N 001-70121-00



(2) 1/2" Alum. Nylock Nuts
P/N 001-76072-00

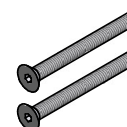

(2) 3/8" x 4" FHSCS
P/N 001-73940-00

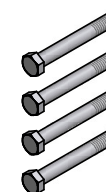

(4) 3/8" x 3" ss Bolts
P/N 001-70115-00

FLOE ROLL-IN DOCK HAMMOCK FRAME

| Parts List | | | |
|------------|-----|--------------|-------------------------------------|
| ITEM | QTY | PART NUMBER | DESCRIPTION |
| 1 | 2 | 001-70107-00 | HHCS, 3/8-16 x 1 1/4" 18-8 ss |
| 2 | 2 | 001-70114-00 | HHCS, 3/8-16 x 2 3/4" 18-8 ss |
| 3 | 4 | 001-70115-00 | HHCS, 3/8-16 x 3" 18-8 ss |
| 4 | 2 | 001-70121-00 | HHCS, 3/8-16 x 4 1/2" 18-8 ss |
| 5 | 2 | 001-70219-00 | HHCS, 1/2-13 x 4" 18-8 ss |
| 6 | 22 | 001-71017-00 | Flat Washer, 3/8" SAE 18-8 ss |
| 7 | 4 | 001-71021-00 | Flat Washer, 1/2" 18-8 ss |
| 8 | 2 | 001-73940-00 | FHSCS, 3/8-16 x 4" 18-8 ss |
| 9 | 2 | 001-74667-00 | Eye Bolt, 3/8-16 x 4" ss |
| 10 | 12 | 001-76071-00 | Nut, Nylock 3/8-16 Aluminum |
| 11 | 2 | 001-76072-00 | Nut, Nylock 1/2-13 Aluminum |
| 12 | 1 | 002-00100-00 | Leg, Hammock (Long) |
| 13 | 1 | 002-00101-00 | Leg, Hammock (Short) |
| 14 | 2 | 002-00106-00 | Spacer, .675 OD x .085 x 2.296" Lg. |
| 15 | 1 | 002-00110-00 | Support Mount, Hammock (Rear) |
| 16 | 1 | 002-00111-00 | Support Tube, Hammock - 46.063" |
| 17 | 1 | 002-00113-00 | Plate, Hammock Attachment |
| 18 | 2 | 002-02203-00 | Plate, Dock Accessory |
| 19 | 8 | 002-02204-00 | Spacer, Dock Accessory |
| 20 | 2 | 006-13200-00 | Cap, 1.875 Dia. |
| 21 | 2 | 006-15013-00 | Cap, Hammock - Gray Vinyl |
| 22 | 6 | 010-00025-00 | Washer, Pivot - Hammock |
| 23 | 1 | 110-00110-00 | Weldment, Center Hammock Frame |
| 24 | 1 | 110-00112-00 | Weldment, Hammock Mounting Post |
| 25 | 1 | 110-00116-00 | Ass'y, Pivot Extension |
| 26 | 1 | 110-00118-00 | Weldment, Front Support Mount |
| 27 | 1 | 110-00119-00 | Ass'y, Hammock Mount |

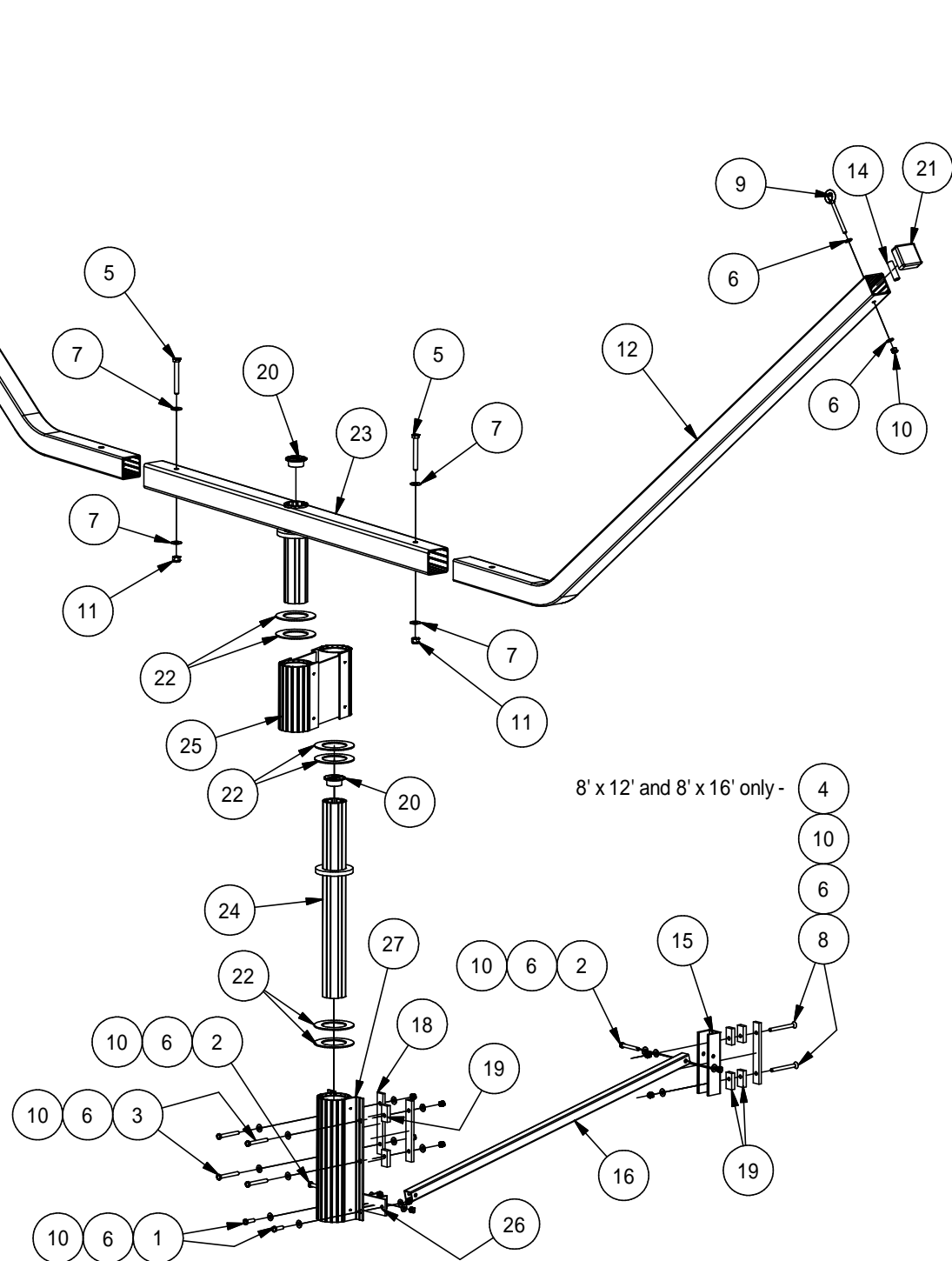

FLOE ROLL-IN DOCK HAMMOCK FRAME

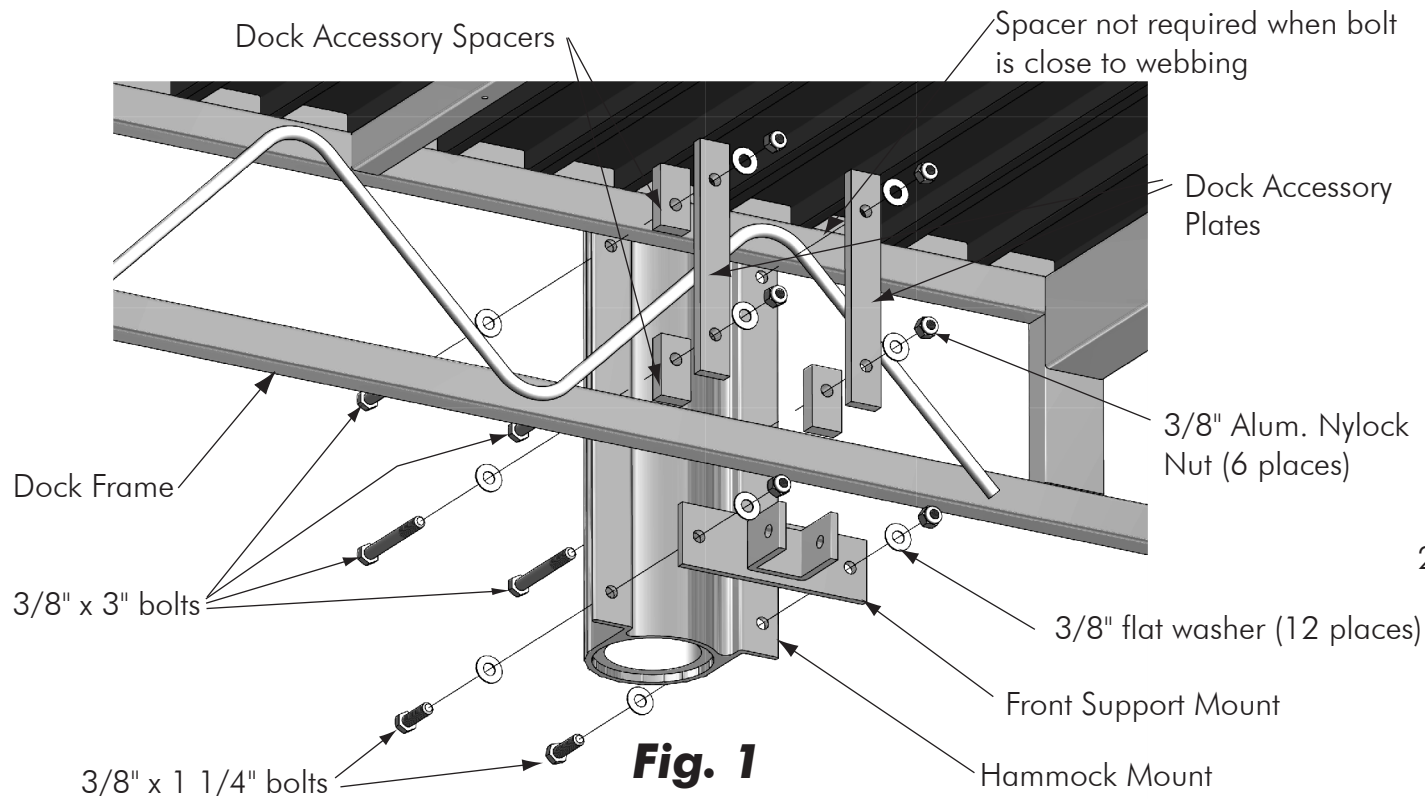

1. Attach the hammock mount to the side of the dock using (4) 3/8" x 3" bolts, (8) 3/8" flat washers and (4) 3/8" nylock nuts as shown in Fig. 1. Insert the bolts through the top four holes in the hammock mount with the bolts between the two dock frames. Slide one spacer over each bolt on the inside of the dock. If a bolt is too close to the webbing, do not use a spacer as the webbing will act as a spacer. Slide the accessory plates on and fasten with 3/8" flat washers and nylock nuts. Torque to 35 ft/lbs.
2. Fasten the front support mount to the hammock mount using (2) 3/8" x 1 1/4" bolts, (4) 3/8" flat washers and (2) 3/8" nylock nuts as shown in Fig. 1. Torque to 35 ft/lbs.

3. For mounting hammock frames to docks other than 8' x 8' sundecks, see page 5. On an 8' x 8' sundeck, attach the rear support mount to the center web frame of the dock as shown in Fig. 2. The rear support mount should be located so it is centered and in-line with the hammock mount installed in step 1. Insert the 3/8" x 4" Flat head bolts through the hammock attachment plate from the back side (arrange so that bolt heads seat in attachment plate countersunk holes). Slide (2) accessory spacers over each bolt, unless the webbing is too close to a bolt, in which case only one spacer is needed. Attach the rear support so the side brace hole is located closest to the dock decking. Fasten with 3/8" flat washers and nylock nuts. Torque to 35 ft/lbs. See Fig. 2.

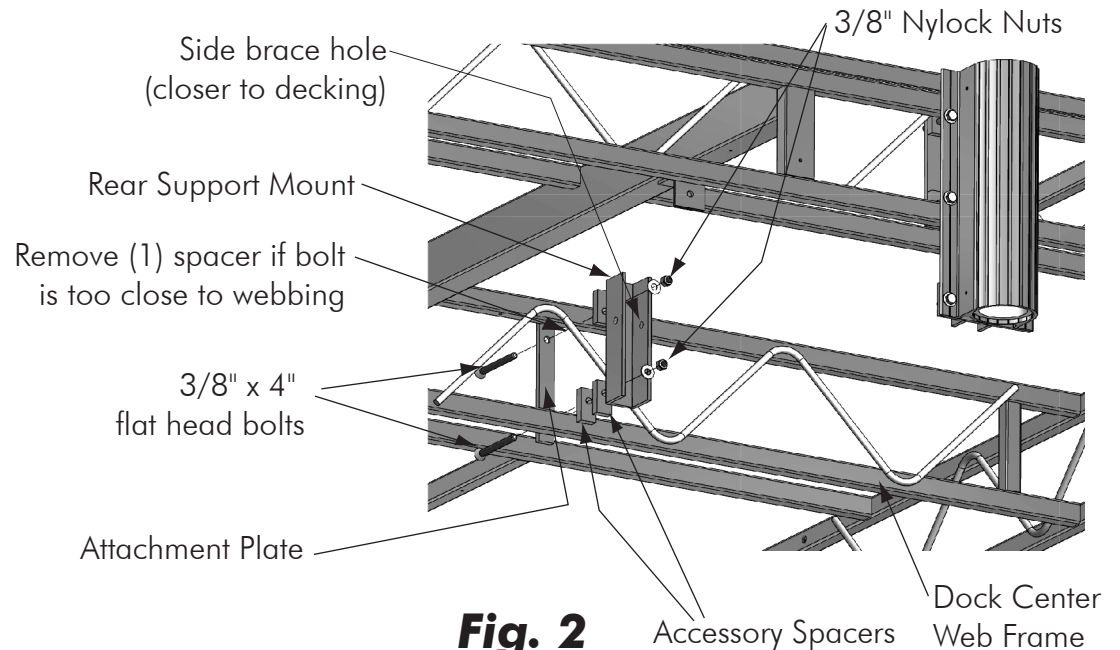

(8 x 8 sundecks only)

FLOE ROLL-IN DOCK HAMMOCK FRAME

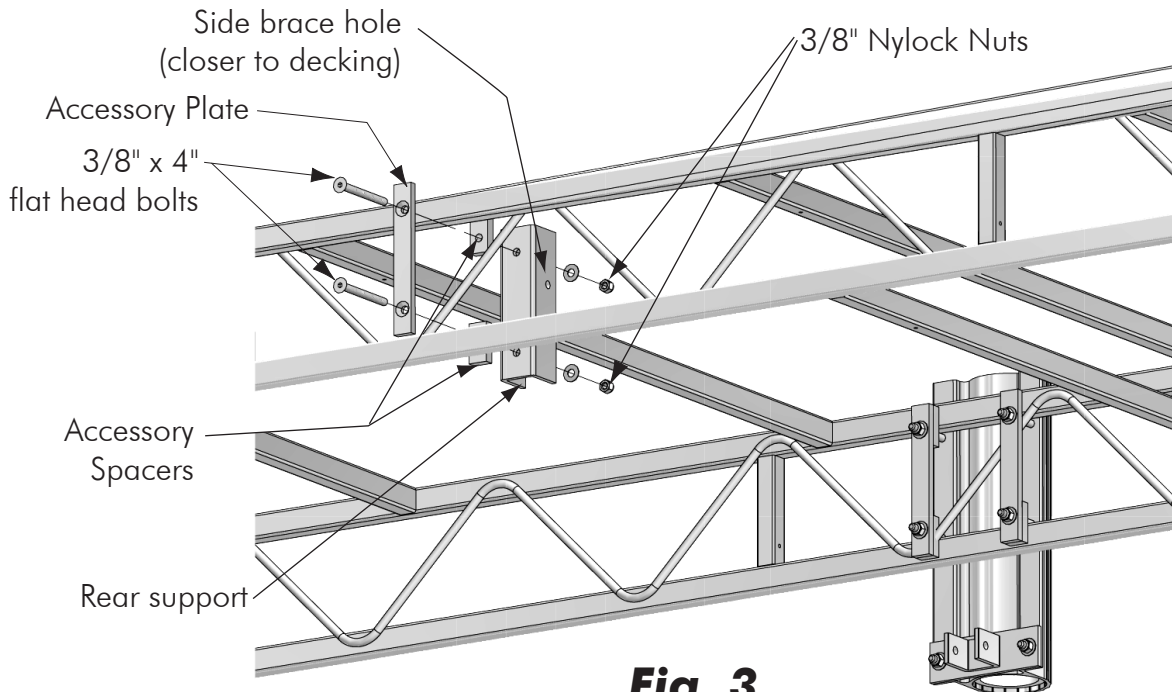

Fig. 3

(4' and 6' wide docks)

- For 8 x 12 and 8 x 16 sundecks, attach the rear support to the center dock frame as shown in Fig. 4. Insert the 3/8" x 4 1/2" bolts through the small holes in the attachment plate (not the countersunk side) and slide one accessory spacer on each bolt, unless the webbing is too close, in which case only one spacer is needed. Slide two more spacers on the other side of the dock frame, unless the bolts are too close to the webbing. Slide the rear support over the bolts so the side brace hole is closest to the decking and fasten with 3/8" flat washers and nylock nuts. Torque to 35 ft/lbs.

- On 4' and 6' wide dock sections, attach the rear support to the opposite side of the dock as shown in Fig. 3. The rear support should be attached so it is centered and in-line with hammock mount installed in step 1. Insert the 3/8" x 4" flat head bolts through the attachment plate so the bolts seat in the attachment plate countersunk holes. Slide (2) accessory spacers over each bolt, unless the webbing is too close, in which case only one spacer is needed. Slide the rear support over the bolts so the side brace hole is closest to the decking and fasten with 3/8" flat washers and nylock nuts. Torque to 35 ft/lbs.

CAUTION: To prevent a 4' or 6' wide dock section from tipping when using the hammock, a counterweight or screw auger should be used on the opposite side.

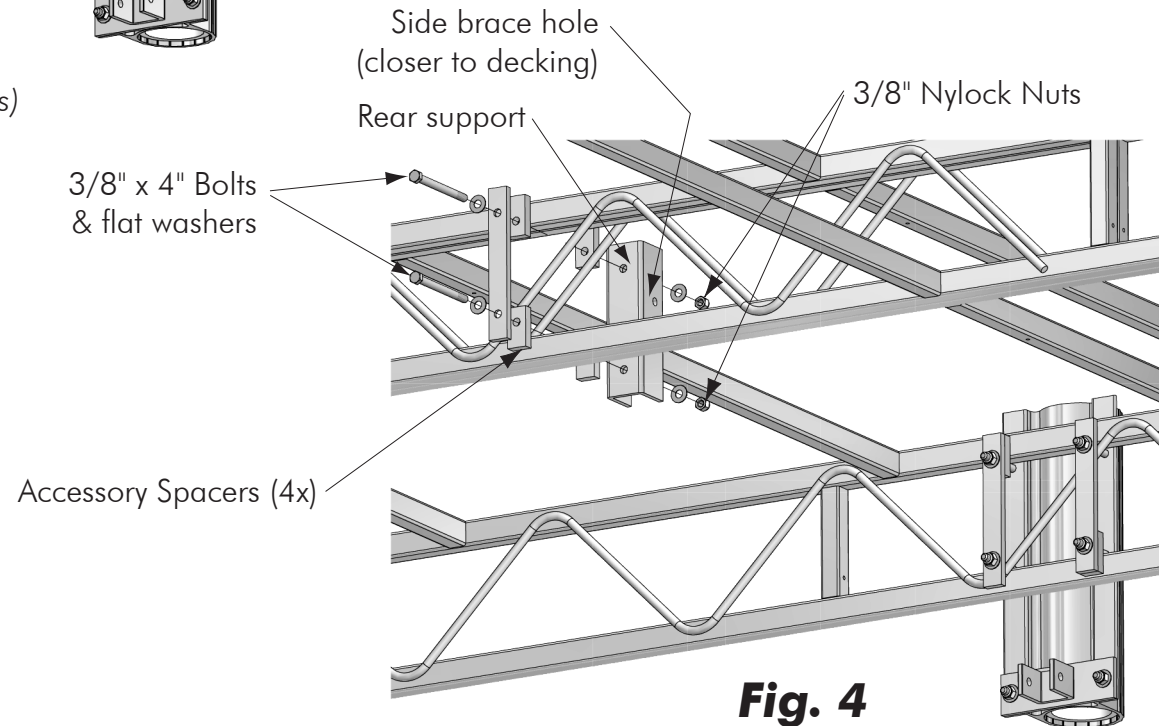

Fig. 4

(8 x 12 & 8 x 16' Sundecks)

FLOE ROLL-IN DOCK HAMMOCK FRAME

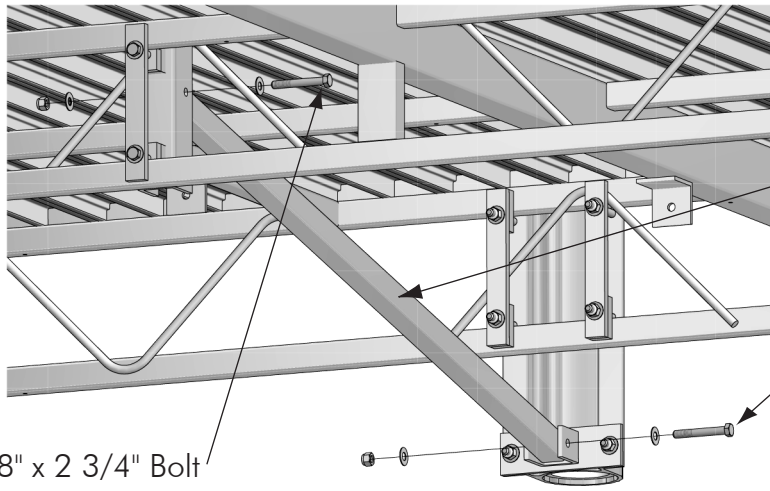

Fig. 5

7. Place (2) pivot washers on the hammock mount and insert the hammock mounting post (long end first). The post should be flush with the bottom of the hammock mount. Slide (2) pivot washers of the mounting post and down to the welded ring. Slide the pivot extension on the mounting post. Place two more pivot washers on top of the opposite sleeve of the pivot extension. The round tube of the center frame is inserted through the two pivot washers and into the pivot extension. Place the two caps in tubes as shown in Fig. 6.
8. Insert a canopy leg into each end of the center frame and line up the holes. Fasten each using a 1/2" x 4" bolt, (2) 1/2" flat washers and a 1/2" nylock nut. Torque to 35 ft/lbs. See Fig. 6.
9. Attach hammock (not included) to eye bolts on hammock legs and adjust as required.

6. Attach the hammock support tube to the front and rear support mounts as shown in Fig. 5. Each end is fastened using a 3/8" x 2 3/4" bolt, (2) 3/8" flat washers and a 3/8" nylock nut. Torque to 25 ft/lbs.

46 1/16" Hammock support tube
 - 69 11/16" support tube required for
 6' wide docks (not included) P/N 002-00112-00

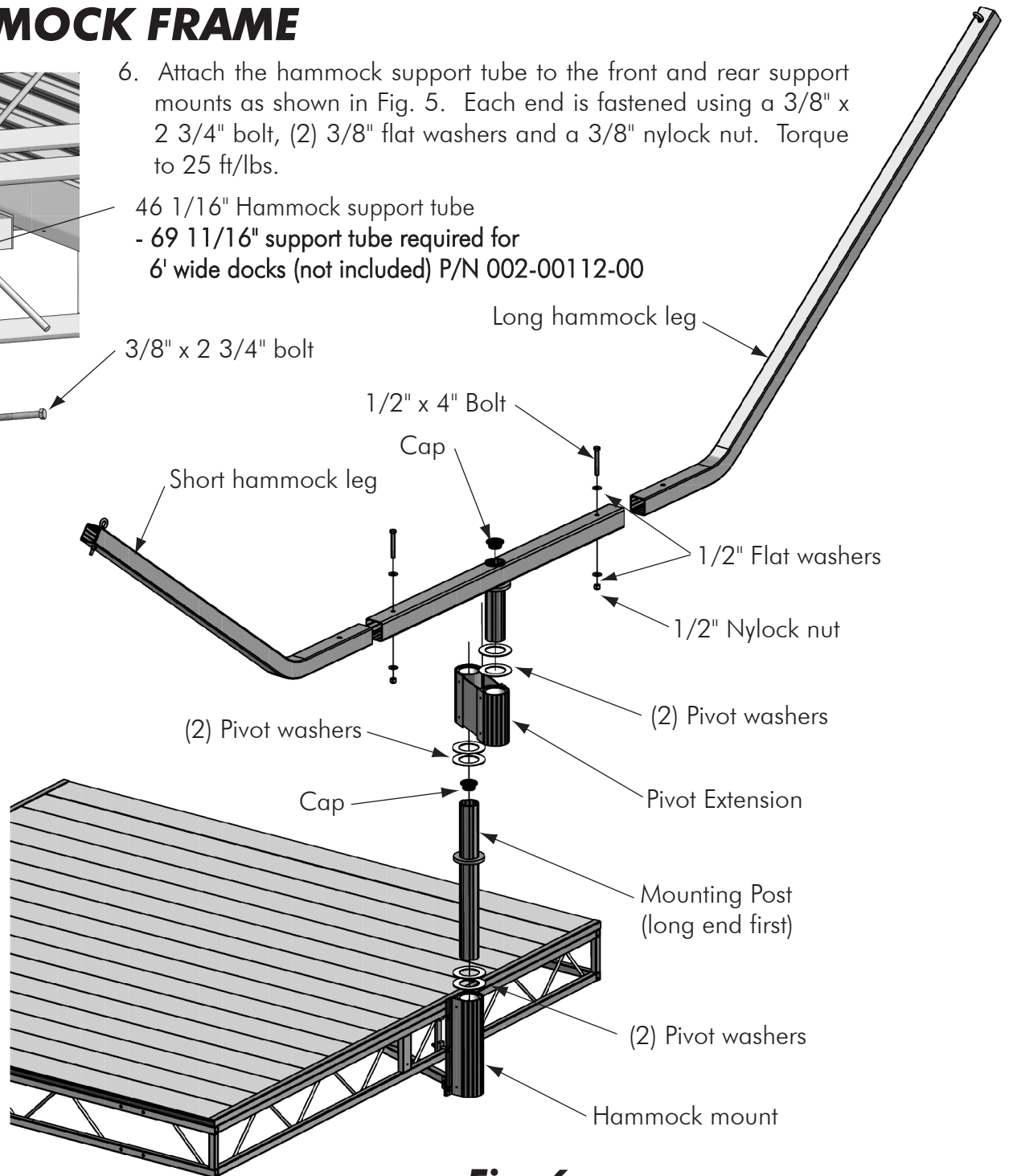

Fig. 6